

ALASKA LEGISLATURE COMMITTEE FILES 1900-1900

4105 SJUD SB 341 (FILE 6) - SB 344

985

1 appropriations made to the department. Contracting for services under  
2 this section is governed by AS 36.30 (State Procurement Code).

3 \* Sec. 30. AS 33.30.062(a) is amended to read:

4 (a) The commissioner may enter into an agreement with a private-  
5 ly operated correctional facility, but only if the facility is located  
6 in the state and if the purpose of the agreement is to involve prison-  
7 ers in a work or rehabilitation furlough program established under  
8 this chapter, to provide necessary facilities under AS 33.30.282 -  
9 33.30.288, or to confine prisoners convicted of a misdemeanor. An  
10 [NOTWITHSTANDING AS 37.05.230(1)(B), AN] agreement awarded under this  
11 subsection is governed by AS 36.30 (State Procurement Code) [SHALL BE  
12 BASED ON COMPETITIVE BIDS].

13 \* Sec. 31. AS 33.32.015(b) is amended to read:

14 (b) The commissioner of corrections may

15 (1) subject to AS 36.30 (State Procurement Code) [THE  
16 FISCAL PROCEDURES ACT (AS 37.05)], use, purchase, lease, equip, and  
17 maintain buildings, machinery, and other equipment, and may purchase  
18 materials and enter into contracts, which may be necessary for the  
19 correctional industries program;

20 (2) provide for prisoners to be employed in rendering  
21 services and producing articles, materials, and supplies needed by a  
22 state agency, a political subdivision of the state, an agency of the  
23 federal government, other states or their political subdivisions, or  
24 for use by nonprofit organizations;

25 (3) if the Correctional Industries Commission established  
26 in AS 33.32.070 approves, employ prisoners to provide services or  
27 products as needed by private industry if the services or products  
28 have potential for contributing to the economy of the state and will  
29 have minimal negative impact on an existing private industry or labor

1 force in the state.

2 \* Sec. 32. AS 35.05.010 is amended to read:

3 Sec. 35.05.010. PLANNING AND CONSTRUCTION. The department is  
4 responsible for the planning and construction of public works except  
5 as provided for court facilities in AS 22.05.025. Contracts for  
6 planning and construction of public works are governed by AS 36.30  
7 (State Procurement Code).

8 \* Sec. 33. AS 35.05.020 is amended to read:

9 Sec. 35.05.020. RULES AND REGULATIONS. The department shall  
10 adopt [RULES AND] regulations that [WHICH] it considers necessary to  
11 carry out the purpose of this title. The regulations may not conflict  
12 with AS 36.30 (State Procurement Code) or the regulations adopted by  
13 the Department of Administration under that chapter.

14 \* Sec. 34. AS 35 is amended by adding a new section to read:

15 Sec. 35.10.195. CONFORMANCE WITH AS 36.30. The contractual  
16 techniques for the procurement of labor, materials, and contractual  
17 services under the policies developed under this chapter must conform  
18 to the requirements of AS 36.30 (State Procurement Code).

19 \* Sec. 35. AS 35.15.010(a) is amended to read:

20 (a) Except as provided in [AS 36.98 AND] AS 44.33.300, it is  
21 [SHALL BE] the general policy of the state [DEPARTMENT] to require the  
22 construction of all public works under bid contract in accordance with  
23 AS 36.30 (State Procurement Code). However, when the estimated cost  
24 of a construction project is less than \$100,000, or when it appears to  
25 be in the best interests of the state, the department may perform the  
26 work, notwithstanding any other provisions of law. A complete record  
27 shall be kept by the commissioner or the commissioner's designee of  
28 all transactions entered into under this section including names of  
29 employees involved in the transactions.

1 \* Sec. 36. AS 35.15.020 is repealed and reenacted to read:

2       Sec. 35.15.020.   REQUEST FOR PUBLIC BIDS.   The solicitation of  
3 bids for construction of public works is governed by AS 36.30 (State  
4 Procurement Code).   The request for bids may require the contractor to  
5 furnish equipment, labor, materials, and supplies for the project, or  
6 it may state that the department will furnish the materials and sup-  
7 plies.   If the department elects to provide materials and supplies for  
8 a project, it shall make the election at the time it adopts the con-  
9 struction program.   The department shall acquire these materials and  
10 supplies under AS 36.30 by requesting bids for them according to the  
11 class, type, and nature of the materials and supplies.   The contract  
12 may be awarded either upon the basis of delivery to the construction  
13 project directly or to a central storehouse or storehouses maintained  
14 by the department.   Those materials and supplies so purchased by the  
15 department may be delivered to the project site without expense to the  
16 contractor, or it may sell them to the contractor at cost and make the  
17 materials and supplies a part of the construction cost.

18 \* Sec. 37. AS 35.15.040 is repealed and reenacted to read:

19       Sec. 35.15.040.   PROCEDURES FOR THE AWARD OF CONTRACTS.   Award of  
20 a contract for the construction of a public work shall comply with  
21 this title, AS 36.30 (State Procurement Code), and the regulations  
22 adopted under those laws.

23 \* Sec. 38. AS 35.20.010 is amended to read:

24       Sec. 35.20.010.   ACQUISITION OF LAND, RIGHTS-OF-WAY, AND MATE-  
25 RIALS BY PURCHASE OR EMINENT DOMAIN.   The department, on behalf of the  
26 state and as part of the cost of constructing or maintaining a public  
27 work, may purchase in the open market, acquire, take over, or condemn  
28 under the right and power of eminent domain land in fee simple or  
29 easements which it considers necessary for present public use, either

1 temporary or permanent, or which it considers necessary and reasonable  
2 for the public use. By the same means, the department may obtain  
3 material including clay, gravel, sand, or rock or the land necessary  
4 to obtain the material, and the necessary land easements to provide  
5 access to it. The department may acquire the land or material not-  
6 withstanding the fact that the title to it is in the state or a  
7 department, agency, commission or institution of the state. Acquisi-  
8 tion of material in the open market under this section is governed by  
9 AS 36.30 (State Procurement Code).

10 \* Sec. 39. AS 37.05 is amended by adding a new section to read:

11 Sec. 37.05.232. PETTY CASH ACCOUNTS. The department shall  
12 determine the amount of the petty cash accounts needed by each state  
13 agency and inspect the petty cash accounts at least once each year to  
14 determine that the total plus amounts of receipts for unreplenished  
15 disbursements is equal to the fixed sum of cash set aside. Shortages  
16 in petty cash accounts are a personal liability of the responsible  
17 head of the agency to whom the account is set aside. The department  
18 shall adopt necessary regulations governing use and replenishment of  
19 petty cash funds.

20 \* Sec. 40. AS 37.05.316 is amended to read:

21 Sec. 37.05.316. GRANTS TO NAMED RECIPIENTS. When an amount is  
22 appropriated or allocated to a department as a grant for a named  
23 recipient that [WHICH] is not a municipality, the department to which  
24 the appropriation or allocation is made shall promptly notify the  
25 named recipient of the availability of the grant and request the named  
26 recipient to submit a proposal to provide the goods or services speci-  
27 fied in the appropriation act [, OR BOTH,] for which the appropriation  
28 or allocation is made. At the same time, the department may issue a  
29 request for proposals from other qualified persons to provide the same

1 goods or services [, OR BOTH,] in the same area. The department shall  
2 award the grant to [CONTRACT WITH] the named recipient unless the  
3 Office of the Governor, with due regard for the [ANY] local expertise  
4 or experience of [AMONG] those making proposals, determines that an  
5 award [OF THE CONTRACT] to a different party would better serve the  
6 public interest. If the grant [CONTRACT] is awarded to a [ANOTHER]  
7 party other than that named by the legislature, the basis of that  
8 action shall be stated in writing at the time the grant is issued and  
9 a copy of the written statement shall be sent to the Legislative  
10 Budget and Audit Committee. A grant agreement must [CONTRACT SHALL]  
11 be executed within 60 days after the effective date of the  
12 appropriation or allocation. [THE PURCHASE OF THE GOODS OR SERVICES,  
13 OR BOTH, SHALL BE IN ACCORDANCE WITH AS 37.05.230(1)(B).]

14 \* Sec. 41. AS 41.21.020(a) is amended to read:

15 (a) The Department of Natural Resources shall

16 (1) develop a continuing plan for the conservation and  
17 maximum use in the public interest of the scenic, historic, archaeo-  
18 logic, scientific, biological, and recreational resources of the  
19 state;

20 (2) plan for and develop a system of state parks and recre-  
21 ational facilities, to be established as the legislature authorizes  
22 and directs;

23 (3) acquire by gift, purchase, or transfer from state or  
24 federal agencies, or from individuals, corporations, partnerships or  
25 associations, land necessary, suitable and proper for roadside, pic-  
26 nic, recreational or park purposes;

27 (4) control, develop and maintain state parks and recrea-  
28 tional areas;

29 (5) provide for the acquisition, care, control,

1 supervision, improvement, development, extension and maintenance of  
2 public recreational land, and make necessary arrangements, contracts  
3 or commitments for the improvement and development of land acquired  
4 under AS 41.21.010 - 41.21.040; contracting for improvement and  
5 development under this paragraph is governed by AS 36.30 (State  
6 Procurement Code);

7 (6) adopt, in accordance with this section and the Adminis-  
8 trative Procedure Act (AS 44.62), regulations governing the use and  
9 designating incompatible uses within the boundaries of state park and  
10 recreational areas to protect the property and to preserve the peace;

11 (7) cooperate with the United States and its agencies and  
12 local subdivisions of the state to secure the effective supervision,  
13 improvement, development, extension, and maintenance of state parks,  
14 state monuments, state historical areas, and state recreational areas,  
15 and secure agreements or contracts for the purpose of AS 41.21.010 -  
16 41.21.040;

17 (8) encourage the organization of state public park and  
18 recreational activities in the local political subdivisions of the  
19 state;

20 (9) provide for consulting service designed to develop  
21 local park and recreation facilities and programs;

22 (10) provide clearing-house services for other state agen-  
23 cies concerned with park and recreation matters; and

24 (11) perform other duties as are prescribed by executive  
25 order or by law;

26 (12) maintain memorials to Alaska veterans located in state  
27 parks;

28 (13) adopt, in accordance with the Administrative Procedure  
29 Act (AS 44.62), regulations governing the use of the Chena River State

1 Recreation Area and designating incompatible uses within the bound-  
2 aries of the Chena River State Recreation Area in accordance with  
3 AS 41.21.490.

4 \* Sec. 42. AS 42.40.920(b) is amended to read:

5 (b) Unless specifically provided otherwise in this chapter, the  
6 following laws do not apply to the operations of the corporation:

7 (1) AS 19;

8 (2) AS 30.15;

9 (3) AS 35;

10 (4) AS 36.30, except as specifically provided in AS 36.30

11 (State Procurement Code);

12 (5) AS 37.05;

13 (6) [(5)] AS 37.07;

14 (7) [(6)] AS 37.10.010 - 37.10.060;

15 (8) [(7)] AS 37.10.085;

16 (9) [(8)] AS 37.20;

17 (10) [(9)] AS 37.25;

18 (11) [(10)] AS 38;

19 (12) [(11)] AS 44.62.040 - 44.62.320.

20 \* Sec. 43. AS 44.21.310(a) is amended to read:

21 (a) The telecommunications divisions, as directed by the deputy  
22 commissioner, shall

23 (1) advise the governor on matters of policy and comprehen-  
24 sive state planning for telecommunications services;

25 (2) make an annual report to the governor and to the legis-  
26 lature on the activities of the telecommunications divisions;

27 (3) coordinate, manage, and supervise state programs in  
28 telecommunications, including the management of those telecommunica-  
29 tion services for the state obtained from common carriers and from the

1       communications industry;

2               (4) when requested, provide technical and consulting assis-  
3       tance to the executive, judicial, and legislative branches of state  
4       government, to the University of Alaska, and to private noncommercial  
5       entities which request that assistance in facility procurement and  
6       leasing and in identifying long-range goals and objectives for the  
7       state and its political subdivisions in all aspects of telecommunica-  
8       tions, including public, educational, and instructional telecommunica-  
9       tions;

10              (5) prepare and maintain a state comprehensive telecommu-  
11       nications development plan to further state telecommunications devel-  
12       opment and to meet state telecommunications needs and prepare and  
13       maintain a comprehensive inventory of all state communications facil-  
14       ities;

15              (6) whenever feasible, procure services from private enter-  
16       prise or certified and franchised utilities and contract for the  
17       construction, management, operation and maintenance of telecommunica-  
18       tions systems, and develop a procurement policy consistent with  
19       AS 36.30 (State Procurement Code) [UNDER AS 37.05.010 - 37.05.410];  
20       the procurement policy must seek to achieve the maximum benefit to the  
21       public, and methods of procurement, including lease, purchase, rental,  
22       or combinations of lease, purchase, and rental, must be selected on  
23       the basis of factors such as the ratio of long-range costs versus  
24       benefits, life cycle costing, and the costs to the communications  
25       industry to the extent that these costs may affect local and long  
26       distance basic telephone rates; procurement, contracting, construc-  
27       tion, and maintenance under this paragraph is governed by AS 36.30;

28              (7) provide information and assistance to state agencies to  
29       promote governmental coordination and unity in the preparation of

1 agency plans and programs involving the use of telecommunications;

2 (8) apply for and accept federal and private money, proper-  
3 ty, or assistance, that may be appropriated, granted, or otherwise  
4 made available to the telecommunications divisions and use and dis-  
5 burse money and property for purposes consistent with AS 44.21.300 -  
6 44.21.330 and AS 44.21.256 - 44.21.290, subject to reasonable limita-  
7 tions imposed by the grantor;

8 (9) participate with other governmental units in planning,  
9 and assist local governments and governmental conferences and councils  
10 in the state in planning and coordinating their activities relating to  
11 telecommunications;

12 (10) provide for the orderly transition to new telecommu-  
13 nications services and systems by state agencies;

14 (11) serve as a clearinghouse for information, data, and  
15 other materials which may be necessary or helpful to federal, state,  
16 or local governmental agencies in the development of telecommunication  
17 systems;

18 (12) coordinate their services and activities with those of  
19 other state departments and agencies to the fullest extent possible to  
20 avoid unnecessary duplication; and

21 (13) provide that all activities of the telecommunications  
22 divisions are responsive to state statutes and regulations, and to the  
23 regulations and rulings of the Federal Communications Commission.

24 \* Sec. 44. AS 44.19.144(b) is amended to read:

25 (b) The director may

26 (1) with the written concurrence of the governor, enter  
27 into contracts and subcontracts on behalf of the state to carry out  
28 the provisions of AS 44.19.141 - 44.19.152; contracting under this  
29 paragraph is governed by AS 36.30 (State Procurement Code);

1 (2) act for the state in the initiation, investigation,  
2 evaluation of or participation in any program relative to the stated  
3 purpose of AS 44.19.141 - 44.19.152 which may involve more than one  
4 government or governmental unit;

5 (3) on behalf of the state, accept and expend any gifts or  
6 grants made to the state with the approval of the governor where such  
7 gifts or grants were made for the purposes of furthering the objec-  
8 tives of the office.

9 \* Sec. 45. AS 44.33.300 is amended to read:

10 Sec. 44.33.300. WAIVER OF CERTAIN PROVISIONS. When the gover-  
11 nor has by proclamation declared an area impacted by an economic  
12 disaster, the following provisions regarding public contracts may be  
13 waived to the extent specified in the proclamation:

14 (1) the requirement of a contractor's bond as prescribed in  
15 AS 36.25.010 may be waived if the contract amount does not exceed  
16 \$100,000;

17 (2) the public bid requirements as contained in AS 19.10.-  
18 170, AS [19.10.190,] 19.30.191(b), AS 35.15.010 - 35.15.020, and  
19 AS 36.30 (State Procurement Code) [AND AS 35.15.010 - 35.15.030] may  
20 be waived if the contract is to be performed by a contractor whose  
21 principal office is in the designated area and the contract amount  
22 does not exceed \$50,000;

23 (3) the general policy to require all construction to be  
24 under bid contract as contained in AS 19.10.170, AS 35.15.010, and  
25 AS 36.30 (State Procurement Code) may be waived if the contract is to  
26 be performed by the state, another governmental entity, or a nonprofit  
27 entity.

28 \* Sec. 46. AS 44.47.250 is amended by adding a new subsection to read:

29 (c) Contracts with persons or nongovernmental entities under

1 this section are governed by AS 36.30.

2 \* Sec. 47. AS 44.47.490(a) is amended to read:

3 (a) The director may establish field offices under this chapter,  
4 may hire one or more lending officers, and, under AS 36.30 (State  
5 Procurement Code), may contract for the services of

6 (1) real property appraisers who are familiar with rural  
7 construction; and

8 (2) engineers who are familiar with engineering problems in  
9 arctic and subarctic regions.

10 \* Sec. 48. AS 44.47.730(a) is amended to read:

11 (a) The commissioner shall contract for a study of the feasibil-  
12 ity of establishing a borough in the unorganized borough by following  
13 the procedures under AS 36.30 (State Procurement Code) [SET OUT IN  
14 AS 36.98]. The commissioner shall include terms in the contract that  
15 provide for

16 (1) public participation in the preparation of the study;

17 (2) completion of the study not later than June 30 of the  
18 third year after the year the contract is executed.

19 \* Sec. 49. AS 44.62.175(a) is amended to read:

20 (a) The lieutenant governor shall publish or contract for the  
21 publication of the Alaska Administrative Journal. The journal shall  
22 be published weekly. The journal must include

23 (1) notices of proposed actions given under AS 44.62.-  
24 190(a);

25 (2) notices of state agency meetings required under AS 44.-  
26 62.310(e), even if the meeting has been held;

27 (3) notices of solicitations to bid issued under AS 36.30.-  
28 130 [AS 37.05.230];

29 (4) notices of state agency requests for proposals issued

1 under AS 18.55.255, 18.55.320; [AS 19.10.190; AS 19.40.020; AS 35.15.-  
2 030; AS 36.98.030; AS 37.05.230,] AS 37.05.315(d); AS 38.05.120; and  
3 AS 43.40.010;

4 (5) executive orders and administrative orders issued by  
5 the governor;

6 (6) written delegations of authority made by the governor  
7 or the head of a principal department under AS 44.17.010;

8 (7) the text or a summary of the text of a regulation or  
9 order of repeal of a regulation for which notice is given under AS  
10 44.62.190(a), including an emergency regulation or repeal whether or  
11 not it has taken effect;

12 (8) a summary of the text of recently issued formal opin-  
13 ions and memoranda of advice of the attorney general; and

14 (9) a list of vacancies on boards, commissions, and other  
15 bodies whose members are appointed by the governor.

16 \* Sec. 50. AS 44.71.010 is amended to read:

17 Sec. 44.71.010. DISPOSITION OF OBSOLETE OR SURPLUS STATE PROP-  
18 ERTY. The Department of Administration shall take possession of  
19 obsolete or surplus property of the state for which there is no imme-  
20 diate or prospective use, except abandoned or obsolete school build-  
21 ings and other school property. It shall also take possession of  
22 property remaining in the control of a commission or board of the  
23 state government after the commission or board stops functioning. The  
24 Department of Administration shall sell, lease, license, or dispose of  
25 the property on the terms it considers for the best interests of the  
26 state in conformance with regulations adopted under AS 36.30 (State  
27 Procurement Code).

28 \* Sec. 51. AS 44.77.010(a) is amended to read:

29 (a) Except as provided in (d) of this section, every [EVERY]

1 claim for reimbursement for money expended, or for compensation for  
2 labor, materials, or supplies furnished, or services given to or for  
3 the state, whether based on a contract or on a ratification, shall be  
4 promptly presented to the appropriate administrative or executive  
5 officer for approval and payment.

6 \* Sec. 52. AS 44.77.010 is amended by adding a new subsection to read:

7 (d) A claim that is governed by AS 36.30.560 - 36.30.699 is not  
8 governed by this chapter.

9 \* Sec. 53. AS 44.85.120 is amended to read:

10 Sec. 44.85.120. CARE AND CUSTODY OF BONDS. The bond bank  
11 authority, in accordance with AS 36.30 (State Procurement Code), may  
12 enter into agreements or contracts with a bank, trust company, banking  
13 or financial institution inside or outside the state as may be neces-  
14 sary, desirable or convenient, in the opinion of the bond bank author-  
15 ity, for rendering services in connection with the care, custody or  
16 safekeeping of municipal bonds or other investments held or owned by  
17 the bond bank authority, for rendering services in connection with the  
18 payment or collection of amounts payable as to principal or interest,  
19 and for rendering services in connection with the delivery to the bond  
20 bank authority of municipal bonds or other investments purchased by it  
21 or sold by it, and to pay the cost of those services. The bond bank  
22 authority may also, in connection with any of the services to be  
23 rendered by a bank, trust company or banking or financial institution  
24 as to the custody and safekeeping of its municipal bonds or invest-  
25 ments, require security in the form of collateral bonds, surety agree-  
26 ments or security agreements in such form and amount as, in the opin-  
27 ion of the bond bank authority, is necessary or desirable.

28 \* Sec. 54. AS 44.99.001 is amended to read:

29 Sec. 44.99.001. ADMINISTRATION OF HIGHWAY SAFETY PROGRAM. The

1 governor may contract and do all other things necessary on behalf of  
2 this state under 23 U.S.C. 401-404 (Highway Safety Act of 1966), and  
3 may cooperate with interested persons and agencies to effectuate the  
4 purposes of that Act. Contracting under this section is governed by  
5 AS 36.30 (State Procurement Code). The governor may designate a  
6 person to serve as the governor's highway safety representative;  
7 however, the governor is the official in this state having the ulti-  
8 mate responsibility for dealing with the federal government with  
9 respect to programs and activities under the Federal Highway Safety  
10 Act of 1966. The governor shall coordinate the activities relating to  
11 highway safety of state departments, agencies and subdivisions and of  
12 the Governor's Commission on Transportation Safety established in  
13 AS 44.19.190.

14 \* Sec. 55. AS 46.04.090(a) is amended to read:

15 (a) The department, when feasible, shall enter into contracts  
16 with persons or private organizations to provide the personnel, equip-  
17 ment, or other services or supplies which may be required to carry out  
18 this chapter. Contracts under this section are governed by AS 36.30  
19 (State Procurement Code). When private contracting is not feasible,  
20 the department may establish and maintain at ports, harbors, or other  
21 locations in the state, the cleanup personnel, equipment, and supplies  
22 which, in its judgment, are necessary to carry out this chapter.

23 \* Sec. 56. AS 46.07.040(a) is amended to read:

24 (a) The commissioner shall provide for the construction of  
25 facilities under this chapter, and is authorized to provide for the  
26 construction by contract or through grants to public agencies or  
27 private nonprofit organizations, or otherwise. A [NO] contribution  
28 toward the cost of the construction of a facility may not be required  
29 from its users. Construction under this section by contract is

1 governed by AS 36.30 (State Procurement Code).

2 \* Sec. 57. AS 46.15.020(a) is amended to read:

3 (a) The commissioner shall exercise all those powers and do all  
4 those acts necessary to carry out the provisions and objectives of  
5 this chapter. The commissioner may

6 (1) subject to AS 36.30 (State Procurement Code), enter  
7 into contractual agreements necessary to carry out the provisions of  
8 this chapter including agreements with federal, state and local agen-  
9 cies;

10 (2) apply for, accept, administer and expend grants, gifts,  
11 and loans from the federal government and any other public or private  
12 sources for the purposes of this chapter, and adopt procedures and do  
13 acts not otherwise restricted by law which are necessary to qualify  
14 the state to receive grants, gifts and loans;

15 (3) establish a division of water in the Department of  
16 Natural Resources and assign to that division the responsibility for  
17 carrying out the provisions of this chapter.

18 \* Sec. 58. AS 47.05.015(c) is amended to read:

19 (c) A contract authorized under this section is exempt from the  
20 competitive bid requirements of AS 36.30 (State Procurement Code)  
21 [AS 37.05.230]. In awarding a contract under this section the depart-  
22 ment shall [PUBLISH A] request [FOR] proposals in accordance with  
23 regulations of the Department of Administration under AS 36.30 (State  
24 Procurement Code) [DEPARTMENT].

25 \* Sec. 59. AS 47.30.350(a) is amended to read:

26 (a) The department shall

27 (1) develop and submit to the Surgeon General of the United  
28 States Public Health Service a comprehensive program for the con-  
29 structing and equipping of hospitals and other facilities for the

1 examination, observation, care, and treatment of the mentally ill;

2 (2) develop and submit to the Surgeon General plans and  
3 specifications for the constructing and equipping of the hospitals and  
4 other facilities;

5 (3) construct and equip the hospitals and other facilities  
6 in accordance with the program, plans, and specifications approved by  
7 the Surgeon General; construction and equipping under this paragraph  
8 is governed by AS 36.30 (State Procurement Code);

9 (4) cooperate, coordinate, and contract, wherever indicated  
10 and desirable, with other state boards, departments and agencies, and  
11 agencies of the United States in the construction program, and hire  
12 necessary personnel and enter into contracts with private individuals  
13 and companies, to the end that the hospitals and other facilities are  
14 constructed in the most economical and expeditious manner; contracting  
15 and construction under this section are governed by AS 36.30 (State  
16 Procurement Code).

17 \* Sec. 60. AS 47.30.660 is amended to read:

18 Sec. 47.30.660. POWERS AND DUTIES OF DEPARTMENT. The depart-  
19 ment is the mental health authority of the state and shall

20 (1) administer a comprehensive program for the prevention  
21 of mental illness and the care and treatment of the mentally ill,  
22 including inpatient and outpatient care and treatment and the procure-  
23 ment of services of specialists or other persons on a contractual or  
24 other basis;

25 (2) take the actions and undertake the obligations which  
26 are necessary to participate in federal grants-in-aid programs and  
27 accept federal or other financial aid from whatever sources for the  
28 study, examination, care, and treatment of the mentally ill;

29 (3) administer AS 47.30.660 - 47.30.915;

1 (4) designate, operate, and maintain treatment facilities  
2 equippe and qualified to provide inpatient and outpatient care and  
3 treatment for the mentally ill;

4 (5) provide for the placement of mentally ill patients in  
5 designated treatment facilities;

6 (6) enter into arrangements with governmental agencies for  
7 the care or treatment of the mentally ill in facilities of the govern-  
8 mental agencies in the state or in another state;

9 (7) enter into contracts with treatment facilities for the  
10 custody and care or treatment of the mentally ill; contracts under  
11 this paragraph are governed by AS 36.30 (State Procurement Code);

12 (8) enter into contracts which incorporate safeguards  
13 consistent with AS 47.30.660 - 47.30.915 and the preservation of the  
14 civil rights of the patients; with another state for the custody and  
15 care or treatment of patients previously committed from this state  
16 under 48 U.S.C., sec. 46 et seq., and P.L. 830, 84th Congress, 2nd  
17 Session, 70 Stat. 709;

18 (9) prescribe the form of applications, records, reports,  
19 requests for release, and consents to medical or psychological treat-  
20 ment required by AS 47.30.660 - 47.30.915;

21 (10) require reports from the head of a treatment facility  
22 concerning the care of patients;

23 (11) visit each treatment facility at least annually to  
24 review methods of care or treatment for patients;

25 (12) investigate complaints made by a patient or an inter-  
26 ested party on behalf of a patient;

27 (13) delegate upon mutual agreement to another officer or  
28 agency of it, or a political subdivision of the state, or a treatment  
29 facility designated, any of the duties and powers imposed upon it by

1 AS 47.30.660 - 47.30.915; and

2 (14) adopt regulations to implement the provisions of  
3 AS 47.30.660 - 47.30.915.

4 \* Sec. 61. AS 47.35.010(a) is amended to read:

5 (a) The department may

6 (1) license and supervise boarding homes, foster homes,  
7 group homes, nurseries, institutions caring for children and foster  
8 homes, group homes and institutions caring for dependent adults;

9 (2) investigate and supervise licensees;

10 (3) enforce the standards established by it;

11 (4) contract with private or municipal agencies to investi-  
12 gate and make recommendations to the department for the licensing and  
13 supervision of boarding homes, foster homes, group homes, nurseries,  
14 institutions caring for children and foster homes, group homes and  
15 institutions caring for dependent adults under procedures and stan-  
16 dards of operation established by the department; contracts with  
17 private agencies under this paragraph are governed by AS 36.30 (State  
18 Procurement Code).

19 \* Sec. 62. AS 47.37.030 is amended to read:

20 Sec. 47.37.030. POWERS OF OFFICE. The office may

21 (1) plan, establish, and maintain treatment programs as  
22 appropriate;

23 (2) make contracts and award grants necessary or incidental  
24 to the performance of its duties and the execution of its powers,  
25 including contracts with and grants to public and private agencies,  
26 organizations, and individuals, to pay them for services rendered or  
27 furnished to alcoholics or intoxicated persons; to the maximum extent  
28 possible, contracts and grants shall be for a period of two years;  
29 contracts under this paragraph are governed by AS 36.30 (State

1 Procurement Code);

2 (3) solicit and accept for use a gift of money or property  
3 or a grant of money, services, or property from the federal govern-  
4 ment, the state, or a political subdivision of it or a private source,  
5 and do all things necessary to cooperate with the federal government  
6 or any of its agencies in making an application for a grant;

7 (4) administer or supervise the administration of the  
8 provisions relating to alcoholics and intoxicated persons of any state  
9 plan submitted for federal funding under federal health, welfare, or  
10 treatment legislation;

11 (5) coordinate its activities and cooperate with alcoholism  
12 programs in this and other states, and make contracts and other joint  
13 or cooperative arrangements with state, local, or private agencies for  
14 the treatment of alcoholics and intoxicated persons and for the common  
15 advancement of alcoholism programs in this and other states;

16 (6) keep records and engage in research and the gathering  
17 of relevant statistics;

18 (7) do other acts necessary to implement the authority  
19 expressly granted to it;

20 (8) acquire, hold, or dispose of real property or any  
21 interest in it, and construct, lease, or otherwise provide treatment  
22 facilities for alcoholics and intoxicated persons; however, the office  
23 shall encourage local initiative, involvement and financial participa-  
24 tion under grants-in-aid whenever possible in preference to the con-  
25 struction or operation of facilities directly by the office; contract-  
26 ing and construction under this paragraph are governed by AS 36.30  
27 (State Procurement Code).

28 \* Sec. 63. AS 47.37.130(g) is amended to read:

29 (g) The office may contract for the use of any facility as an

1 approved public treatment facility if the coordinator, subject to the  
2 regulations of the department, considers this an effective and econom-  
3 ical course to follow. Contracting under this subsection is governed  
4 by AS 36.30 (State Procurement Code).

5 \* Sec. 64. AS 47.40.041(b) is amended to read:

6 (b) Notices published by the department concerning the opening  
7 of the application process for a grant award shall specify the geo-  
8 graphical area in which services are needed, the type of services, the  
9 number of beds anticipated to be needed, the maximum number of days of  
10 care, and any other requirements established by the department.  
11 Grants authorized under this section are exempt from the competitive  
12 bid requirements of AS 36.30 [AS 37.05.230].

13 \* Sec. 65. AS 47.90.010(a) is amended to read:

14 (a) The commissioner, in consultation with state and local  
15 government agencies, community groups, and groups concerned with  
16 displaced homemakers, may

17 (1) contract with eligible private profit and nonprofit  
18 corporations for multipurpose service centers for displaced home-  
19 makers; contracting under this paragraph is governed by AS 36.30  
20 (State Procurement Code); and

21 (2) coordinate existing state programs for displaced home-  
22 makers.

23 \* Sec. 66. AS 47.40.041(b) is amended to read:

24 (b) Notices published by the department concerning the opening  
25 of the application process for a grant award shall specify the geo-  
26 graphical area in which services are needed, the type of services, the  
27 number of beds anticipated to be needed, the maximum number of days of  
28 care, and any other requirements established by the department.  
29 Grants authorized under this section are exempt from AS 36.30 (State

1        Procurement Code) [THE COMPETITIVE BID REQUIREMENTS OF AS 37.05.230].

2        \* Sec. 67. REPORT. By December 1, 1987, the commissioner of adminis-  
3 tration and the commissioner of transportation and public facilities shall  
4 report to the legislature concerning procurements by state agencies during  
5 the first six months of 1987. The report must include

6            (1) the records prepared under AS 36.30.510(4);

7            (2) recommendations for changes in AS 36.30 or other laws based  
8 on implementation of AS 36.30 in those six months; and

9            (3) a description of any matters that involved litigation con-  
10 cerning AS 36.30 during those six months.

11        \* Sec. 68. REGULATIONS DEADLINE. The regulations required under  
12 AS 36.30 as added by sec. 2 of this Act, shall be adopted by January 1,  
13 1987 and shall be effective on that date. Regulations adopted under laws  
14 repealed in sec. 69 of this Act become ineffective January 1, 1987.

15        \* Sec. 69. REPEALER. The following laws are repealed: AS 14.40.340;  
16 AS 19.10.190, 19.10.210; AS 24.23; AS 35.15.030, 35.15.050; AS 36.98;  
17 AS 37.05.220, 37.05.230, 37.05.231, 37.05.240, 37.05.250, 37.05.260, 37.-  
18 05.270, 37.05.280, 37.05.290, 37.05.400(2) and (3); AS 44.65; AS 44.77.-  
19 010(c); and AS 47.90.010(c).

20        \* Sec. 70. Section 68 of this Act takes effect immediately in accor-  
21 dance with AS 01.10.070(c).

22        \* Sec. 71. Except as provided in sec. 70, this Act takes effect Janu-  
23 ary 1, 1987.



# RECORDS CERTIFICATION



I, the undersigned, an employee of the State of Alaska, do hereby certify that the microfilm images on this microform are accurate reproductions of the original records of the State of Alaska as accumulated during the regular course of business, and that it is the established policy and practice of this State to microfilm its records and to dispose of the original records after microfilm reproductions have been made.

*James O. Smith*  
Signature of Camera Operator

*11/7/89*  
Date

S B

3 4 4

BILL CONTACT/ACTION

DATE	CONTACT/ACTION
1/30	Back-up requested - Kerttula's office
	Art Snowden
	<del>Full</del> <del>for</del> the - Court System - need testify
2/3	Art Snowden will bring fiscal note 7/4



## Trial Courts

State of Alaska

FIRST JUDICIAL DISTRICT  
415 MAIN STREET  
ROOM 206  
KETCHIKAN, ALASKA 99901  
(907) 225-9875

KRISTEN CARLISLE  
AREA COURT ADMINISTRATOR

January 30, 1986

The Honorable Robert H. Ziegler, Sr.  
Alaska Senate  
P.O. Box V  
Juneau, Alaska 99811 (Mail Stop 3100)

The Honorable John Sund  
Alaska House of Representatives  
P.O. Box V  
Juneau, Alaska 99811 (Mail Stop 3100)

The Honorable Robin L. Taylor  
Alaska House of Representatives  
P.O. Box V  
Juneau, Alaska 99811 (Mail Stop 3100)

Re: Ketchikan Judgeship Position

Dear Senator Ziegler, Representatives Sund and Taylor:

The growing need for an additional Superior Court Judge in the Ketchikan Trial Courts has been more apparent in the past five years. Presiding Judge Thomas E. Schulz and I feel that it has now reached a critical situation and are requesting your support in obtaining an additional position for a Superior Court Judge in Ketchikan.

I have gathered some statistical information to support our request. I will be happy to share the sources of this information with you if you wish.

Ketchikan Gateway Borough and the Outer Ketchikan Census Division have experienced a 15% population increase in 1984 over 1980. Total population for the area is 17,357. If the rate of increase remains constant for the next five years the population will be 19,960 by 1990. This compares with a current estimated

Hon. Robert H. Ziegler, Sr.  
Hon. John Sund  
Hon. Robin L. Taylor

-2-

January 30, 1986

population for the Juneau area of 25,964. Juneau has had two Superior Court Judges for approximately 10 years.

During the period of 1980 to 1984 there was a 41% increase in the estimated local workforce despite slow downs in the local pulp mill and fishing industries. The State will be constructing a Ferry Maintenance Facility in Ketchikan next year which is estimated to create up to 200+ new jobs in the area. If the long pending mining ventures planned for the Ketchikan area actually commence, the population and workforce estimates will, of course, be increased significantly.

The 1985 Bar roster shows there are 39 attorneys practicing in Ketchikan which is a 39% increase over 1980. There is also a 44% increase in the number of police/troopers in the area. Ketchikan's total of 46 law enforcement personnel compares with 43 law enforcement personnel in Juneau.

The Ketchikan jury costs have increased 163% over FY 1981. It's total FY'85 costs of \$65,575 is 10% higher than Juneau at \$59,739. The increase in jury trials has had a major impact on the processing of cases on a timely basis through the Ketchikan Trial Courts. Superior Court case filings excluding all probate and domestic relation cases, have increased 70% in the last five years. These types of cases require a great deal of pre-trial and motion activity and therefore have a significant impact on the court operations and the judge's time.

Ketchikan has had the caseload of more than one Superior Court Judge for the last several years. To meet this increased demand, Ketchikan has used a very high rate of visiting or retired judges appointed on a pro tem basis. In 1983 Ketchikan received the assistance of a visiting or pro tem judge for approximately 126 days, and in 1984 130 days. This is approximately 60% of a Full Time Equivalent (FTE) judge. In 1985 and in 1986, these figures are expected to be much higher because of a long murder case that is being tried in Ketchikan. The Wrangell/Petersburg Superior Court Judge has spent an average of two weeks a month in Ketchikan for the past several years in order to assist Judge Schulz with the growing caseload. The caseloads in Wrangell and Petersburg are also growing and the demands on that judge's time have significantly increased. While the use of pro tem and visiting judges has allowed us to function, it is very dependent on the schedules of those judges. Retired judges work when their schedule permits, and are not always available when required. Although we have had very good relations with Judges Henry C. Keene, Jr. and Thomas B. Stewart, both retired First District Judges, their personal lives and retirement plans sometimes take precedence over the needs of the Ketchikan Trial Courts. It is difficult to assign them a regular

Hon. Robert H. Ziegler, Sr.  
Hon. John Sund  
Hon. Robin L. Taylor

-3-

January 30, 1986

caseload and they have been used most often on an emergency basis.

Primarily due to the increase in jury trials and motion practice, Judge Schulz's bench time has increased tremendously in the last several years. He is also the Presiding Judge for the district which requires significant administrative duties. In order to keep up with these demands, Judge Schulz has continually worked long hours and weekends. Even with this, it has become impossible for the Ketchikan Trial Courts to accommodate anything out of the ordinary. For instance, in 1985 a civil case projected to last 10 days ended up lasting nine weeks. In addition, the murder case of State vs John Kenneth Peel has required an inordinate amount of special attention. While these cases are not routine, the Ketchikan Trial Courts operate on a very narrow margin and anything unusual seriously to disrupt the timely disposition of other cases.

It is hoped that this information will assist you in obtaining the necessary backing for another Superior Court judgeship position in Ketchikan. Judge Schulz and I wish to thank you for your continued support and would be glad to supply any other information that you may deem necessary.

Sincerely,

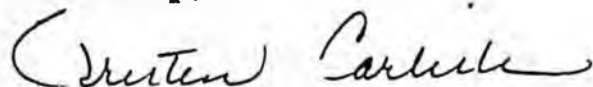

Kristen Carlisle  
Area Court Administrator

KC:cwt

cc: Presiding Superior Court Judge Thomas E. Schulz  
Representative John Binkley



# CITY OF PALMER



231 W. EVERGREEN AVE  
PALMER, ALASKA 99645



Phone (907) 745-3271

A HOME RULE CITY

February 18, 1986

The Honorable Patrick Rodey  
Senator  
Pouch V  
Juneau, Alaska 99811

RE: SB 344

Dear Senator Rodey,

I would personally like to thank you for taking time from your busy schedule to be in attendance at Senator Kerttula's teleconference last Thursday, February 13, 1986.

This teleconference aptly depicted the burgeoning caseload here in the Matanuska Valley with a doubling of the population in five years. Consistent with a large caseload is the lack of space to provide proper work areas, courtrooms and attorney/client conference areas.

The City of Palmer has recognized the inadequacy of the present court facility and has made a new courthouse its number one priority for the 1986 Legislative Session. This information is included for your information. Presently, the City of Palmer has paid out-of-pocket for the preliminary design of a new courthouse which was coordinated with the Court System and several meetings with Judge Beverly Cutler.

We believe an additional Superior Court Judge is needed and support SB 344.

Further, the need for a new courthouse has to be addressed since the current facility lacks the space and courtrooms to properly construct all the court-related functions.

Should you have any questions, please contact me.

Yours truly,

  
David L. Soulak  
City Manager  
City of Palmer

DLS/cac

Enclosure

cc: Senator Jalmar Kerttula

# CITY OF PALMER



231 W. EVERGREEN AVE  
PALMER, ALASKA 99645

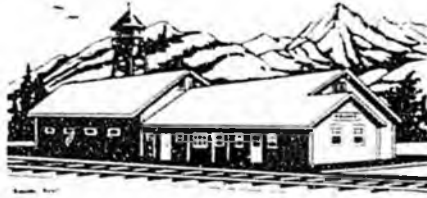

Phone (907) 745-3271

A HOME RULE CITY

---

February 20, 1986

The Honorable Patrick Rodey  
Senator  
State of Alaska  
Pouch V  
Juneau, Alaska 99811

Dear Senator Rodey,

Enclosed please find the information on the Palmer Courthouse priority which was inadvertently omitted from the letter I wrote on February 18, 1986.

Should you have any questions, please contact me.

Yours truly,

---

David L. Soulak  
City Manager  
City of Palmer

DLS/cac

Enclosure

CITY OF PALMER, ALASKA  
1986 LEGISLATIVE PRIORITIES

INDEX

	<u>Page</u>
Introduction	i
Priority List	ii
Palmer Public Safety Phase III - Palmer Courthouse	1
Alaska State Fair Agri-Business and Multi-Purpose Pavilion	14

## INTRODUCTION

Each year the City of Palmer has to make capital project decisions which will benefit the community, stabilize employment and taxes and enhance the quality of life.

All of the decisions are predicated on methodic long-range planning and implementation of a Comprehensive Plan. The Comprehensive Plan is a compilation of input from a Citizen Advisory Committee, Planning and Zoning Advisory Commission, numerous public hearings and finally close City Council scrutiny.

From this plan, the City Council relies heavily on the formulation of its capital project list.

On September 24, 1985 after publishing a notice in the "Frontiersman", the City Council held a Public Hearing on the Capital Project Priorities for 1986. The 1986 Priorities are based on the public hearing, comprehensive plan and City of Palmer's goal to be the government center of the Matanuska-Susitna Borough.

CITY OF PALMER, ALASKA  
1986 LEGISLATIVE PRIORITIES

<u>Priority</u>	<u>Ranking</u>	<u>Capital Item</u>	<u>Estimated Cost</u>
1	1	Palmer Public Safety Phase III-Palmer Courthouse	\$4,500,000
1	2	Alaska State Fair Agri-Business and Multi-Purpose Pavilion	\$5,750,000
		TOTAL COST ALL PRIORITIES	\$10,250,000

## PALMER PUBLIC SAFETY PHASE III - PALMER COURTHOUSE

In 1982, following the completion of a Comprehensive Plan update prepared by Ch2M Hill, the City of Palmer embarked upon the construction of a Public Safety Complex to serve the burgeoning population of the Matanuska-Susitna Valley and environs.

The population of the Matanuska-Susitna Borough has increased 139% from the 1980 population of 17,186 to an estimated 1985 population of 41,093 people.

The Public Safety Complex first started with a new City of Palmer Police Station with a twelve cell modular jail. This modular jail was the first of its type in the State of Alaska. This building was completed in March of 1983. A state grant of \$1,500,000 was received for the construction of Phase I.

The City of Palmer then received another state grant of \$1,500,000 for the construction of Phase II of the Public Safety Complex. This building was constructed to house the Alaska State Troopers, Fish and Wildlife Protection and Division of Motor Vehicles. Since state funds were used to construct this building, the City of Palmer leases this approximately 9,100 square foot building to the State for operation and maintenance costs or approximately \$0.27 per square foot per year. Since state funds were received for the construction and state agencies are using the entire facility, the city feels that only the operation and maintenance costs need to be recovered. A lease agreement has been entered into with the State covering only these costs.

In 1984, the Department of Corrections received a \$4,500,000 appropriation from the Legislature to construct a new pre-trial facility in the Matanuska-Susitna Borough. The City of Palmer offered to donate 2.48 acres to the Department of Corrections for the building site of this facility. This site is directly east of and adjacent to the Public Safety Complex Phase I and Phase II. The City in 1984 entered into a TORA agreement with DOT/PF and Corrections for

the construction of this new building. The scope of this agreement covered architect selection, bidding and construction management for the building which will cost approximately \$3,800,000. Completion is anticipated to be March 31, 1986 and prisoner occupancy July 1, 1986.

As a part of the Phase I building, the City constructed twelve cells. When the new pre-trial facility is completed, the Department of Corrections intends to lease this portion of the facility and increase their bed capacity to 44 beds. This lease like the Phase II lease only covers operation and maintenance costs since State funds were received for the construction of the building.

Palmer being the government center has always had the court system located within its boundaries. Prior to 1982, the Magistrate handled misdemeanor and civil cases which were within his purview with all other cases being referred to Anchorage. Then in 1982, a Superior Court Judgeship was created and the Honorable Beverly Cutler was appointed to fill this important position.

Through the years, the Alaska Court System has leased space which in most instances was adequate when only the Magistrate Court was held with periodic Superior Court trials. The creation of the new judgeship in 1982 required more office space to serve this position. Remodeling was made to the existing leased building to accommodate, as best possible, a judge's chamber and office for a law clerk and secretary. The District Attorney and Public Defender were housed in a building across the street from the court building. Current lack of space has resulted in misdemeanor cases being dangerously close to the 4 month rule when they are tried.

The number of cases handled by District Court has increased by 77% since FY 1981. In FY 1981, the District Court had 6,545 cases filed and in FY 1985 11,600 cases were filed.

FY 1983 was the first full year for the Supreme Court operation and during this period of time 501 cases were filed. In FY 1985, this same Superior Court had 1,148 cases filed, an astonishing 129% increase in just two years.

As the existing Superior Court is set up, there are no witness/attorney conference rooms, jury assembly rooms, which requires jurors to go into the hallways. The second jury deliberation room is a small office. This Court has only one courtroom and one hearing room totally inadequate for even a small caseload not to mention the volume now being handled.

To further amplify the caseload, in 1978, 230 jurors were paid \$6,799 which in 1984 this increased to 817 jurors and jury costs were \$58,060.

Criminal cases filed in FY 1981 totaled 834 with 68 being felony and 766 misdemeanors. For FY 1985, 136 felony cases were filed and 2,163 misdemeanor cases, a combined felony/misdemeanor caseload increase of 176%.

The civil case filing for the same period has increased 75% in the past few years or for FY 1981 case filings totaled 1,241 cases and FY 1985, 2,167 cases were filed.

Traffic citations in the five year period of FY 81-85 increased 80%, with 6,545 citations in FY 81 and 11,600 in FY 85.

Just from the sheer actual numbers, this court system in Palmer is experiencing a case filing almost directly in proportion to the population growth of the Matanuska-Susitna Borough. All of the increased caseload filings and traffic citations have been conducted in a 6,810 square foot lease area.

Before a Supreme Court Judge was appointed to Palmer, the Alaska Court System was aware of the lack of space and attempted to lease more space to fill those requirements. Only a partial filling of the needs occurred since the existing court building has space leased to the U.S. Department of Agriculture.

Since the appointment of Ms. Beverly Cutler to be the Superior Court Judge in Palmer, the Alaska Court System as well as some local legislators have been fully aware of the short comings of the existing cramped quarters.

The City of Palmer is fully aware of the lack of space since we transport all prisoners from our jail to the court system for arraignment. In addition, our Police Department has been called to assist in recapturing escaped prisoners

brought to the court system by other agencies. Inadequate prisoner holding facilities is attributed to these escapes. While all escapees have been apprehended, many man-hours by State and local police were expended needlessly.

To this point, mention has been made of only the City of Palmer and the Court System singling out the inadequacies of the presently leased office. In September of 1984, the Matanuska Bar Association pointed out to the Court System that they, as lawyers, see the inefficiencies and inadequacies of the present set up and urge that a new courthouse be built to provide a higher level of professional service to the public.

This present acute situation has been realized by the City of Palmer so that it can be of any assistance to the Alaska Court System. On September 10, 1985 the City retained the architectural firm of McCool-McDonald of Alaska, Inc. to prepare schematic drawings and preliminary cost estimates which will incorporate all the Alaska Court System needs. The schematic plans and cost estimates have been prepared for a ground cover area building of 25,700 square feet.

The building with usable basement area and prisoner mezzanine corridor results in a total usable area of 29,256 square feet.

The design, courtroom arrangement, judge chambers, holding cells, grand jury room, clerk's office as well as all other court-related functions were designed with concurrence from the Alaska Court System both in Anchorage and Palmer. The end result is a totally compact and extremely functional courthouse.

The Matanuska Bar Association appointed two lawyers to review the design of this facility to help assure that their concerns for an efficient and effective function were being met in this new building.

This schematic design and preliminary cost estimates have cost the City of Palmer \$46,046.12 of its own funds.

With the current lease of the Hillstrom Building due to expire on June 30, 1987, the City of Palmer feels strongly in the need for a new courthouse. So much so, that the City entered into an agreement with McCool-McDonald of Alaska, Inc. for a resumption of the design, if funding becomes available

this legislative session. The City of Palmer feels that this project has the most merits to be its number one priority.

First, this project will allow for the needed expansion of the court system. Second, the site for the new facility is to be located across the street from the new Mat-Su Pre-Trial Facility on a 3.10 acre site owned by the City of Palmer. Third, the design has taken into consideration the need for future expansion. This can be accomplished within the site and no disruption to the court operation. Fourth, prisoner transportation is being held to a minimum with this design. Future construction calls for a pedestrian overpass linking the courthouse with the Pre-Trial Facility. Fifth, all the utilities about this site, such as sanitary sewer, water, storm sewer, natural gas, electricity, oversized telephone cable. Sixth, the courthouse is consistent with the 1982 and 1985 City of Palmer Comprehensive Plan. Seventh, courtroom acoustics have been designed after consultation with the Alaska Court System to insure the maximum ideal courtroom conditions. Eighth, prisoner access to the courtrooms eliminates all contact with visitors. Ninth, judges are provided access to the Clerk's office via a basement causeway, thereby avoiding contact with attorneys needless interruptions. Tenth, the design increases the court system efficiency by having ample record storage capacity and finally, being a single story building, handicap accessibility requirements are readily met.

The final commitment to the Alaska Court System is that the actual cost over the life of the structure will be actual operation and maintenance costs similar to the agreement currently in place with the Department of Public Safety for Phase II of the Public Safety Complex.

This facility has the support of the Alaska Court system, as well as Department of Corrections and Department of Public Safety. The last two agencies can see the savings in man-hours once this proposed facility is constructed and in operation.

Attached is a copy of the Palmer Trial Court Activity to further verify the increased case filings.

CONSTRUCTION COST BREAKDOWN

Construction Cost (See Attached Estimate)	\$3,716,441
Contingency 10%	371,644
Architect-Design-Contract Administration	252,753
Landscaping	121,998
Art (1%)	37,164
	<hr/>
	\$4,500,000

PALMER TRIAL COURT ACTIVITY  
 CASES FILED FY 81 - FY 85  
 (FY = 7/1 - 6/30)

	CASES FILED FY 81	CASES FILED FY 82	CASES FILED FY 83	CASES FILED FY 84	CASES FILED FY 85	% CHANGE '81-'85	% CHANGE '84-'85
<b>CRIMINAL</b>							
Felony	68	79	177	141	136	+100%	- 4%
Misdemeanor	766	1059	1313	1808	2163	+182%	+ 20%
Criminal Sub Totals	<u>834</u>	<u>1138</u>	<u>1483</u>	<u>1949</u>	<u>2299</u>	<u>+176%</u>	<u>+ 18%</u>
<b>CIVIL</b>							
D.C. Civil	310	419	67	49	104	- 66%	+112%
S.C. Civil	*	*	92	139	229	*+149%	+ 65%
Dom. Relations	*	*	314	442	578	*+ 84%	+ 31%
Probate	*	*	58	72	98	*+ 69%	+ 36%
Small Claims	931	841	578	651	1158	+ 24%	+ 78%
Civil Sub Totals	<u>1241</u>	<u>1250</u>	<u>1109</u>	<u>1353</u>	<u>2167</u>	<u>+ 75%</u>	<u>+ 73%</u>
CHILDREN'S MATTERS	*	*	25	71	107	*+328%	+ 51%
TOTAL NON-TRAFFIC	<u>2075</u>	<u>2388</u>	<u>2617</u>	<u>3373</u>	<u>4573</u>	<u>+120%</u>	<u>+ 36%</u>
TRAFFIC CITATIONS	6545	5473	7298	7618	11600	+ 80%	+ 62%
	=====	=====	=====	=====	=====	=====	=====
COURT TOTALS	8620	7861	9915	11021	16173	+ 88%	+ 47%

\* Superior court established in Palmer as of 7/1/82. Superior court judgeship filled effective 10/26/82. Percentage change from FY81-FY85 for Superior Court Civil, Domestic Relations, Probate and Children's Matters categories are actually the percentage change in filings between FY83 and FY85 for these categories.

**ESTIMATE SUMMARY REPORT**

---

PROJECT NAME: PALMER COURT HOUSE  
 ESTIMATE NUMBER: 1  
 DATE OF ESTIMATE: 10/16/85

PROJECT NO: P175  
 LOCATION: PALMER, ALASKA

QUANTITIES BY: ACMI  
 PRICES BY: ACMI  
 TOTAL AREA: 27,050

BID DATE: 08/15/85  
 BID TIME: 2 PM  
 PLACE: PALMER ALASKA

ARCHITECT: MCCOOL/MCDONALD AIA  
 CONTRACTOR: FAIR COST  
 ESTIMATOR: ACMI  
 OWNER: CITY OF PALMER

LIQUIDATED DAMAGES:  
 COMPLETION DATE: 10/15/87  
 PRINT DATE: 10/15/85

	LABOR	MATERIALS	EQUIPMENT	SUBCONTRACTS	TOTALS
DIVISION 1 GENERAL CONDITIONS	255,656	17,570	29,350	20,350	322,926
DIVISION 2 SITE WORK	33,942	198,958	168,739	132,207	533,846
DIVISION 3 CONCRETE	101,224	69,061	3,305	1,000	174,590
DIVISION 4 MASONRY	0	0	0	44,538	44,538
DIVISION 5 METALS	13,055	10,994	1,880	0	25,929
DIVISION 6 CARPENTRY	171,492	87,317	28,800	0	287,609
DIVISION 7 MOISTURE PROTECTION	23,268	33,925	2,660	239,715	299,588
DIVISION 8 DOORS & WINDOWS	30,764	76,925	3,200	72,720	183,609
DIVISION 9 FINISHES	210,909	123,847	27,600	83,195	445,551
DIVISION 10 SPECIALTIES	8,893	28,268	544	5,000	42,705
DIVISION 11 EQUIPMENT	240	4,000	48	0	4,288
DIVISION 12 FURNISHINGS	17,932	122,600	1,280	61,000	202,812
DIVISION 15 MECHANICAL	104,682	112,149	0	152,583	369,414
DIVISION 16 ELECTRICAL	0	0	0	378,700	378,700

\$ 972,057      \$ 885,614      \$ 267,426      \$ 1,191,008      \$ 3,316,105

LABOR MARK-UP..... 15.0  
 MATERIAL MARK-UP..... 10.0  
 EQUIPMENT MARK-UP..... 10.0  
 CONTRACTS MARK-UP..... 8.0

MARK-UPS      145,808      88,561      26,742      95,280      356,393

TOTAL      \$ 3,672,498

MANAGEMENT FEE ..... 0.0      0  
 BIDDERS RISK INSURANCE.. 0.2      7,344  
 CONTRACT BOND..... 1.0      36,798  
 CONTINGENCY ..... 0.0      0

TOTAL BID      \$ 3,716,641

COST PER SQUARE FOOT \$ 137.39

# ALASKA STATE COURTHOUSE PALMER, ALASKA

SCHEMATIC DESIGN SUBMITTAL  
OWNER: CITY OF PALMER

**McCool-McDonald**  
OF ALASKA INC. ARCHITECTS  
801 W 24TH AVE. ANCHORAGE, ALASKA 99502 • (907) 843 6474

DATE: 1988  
DRAWN BY: M. CARLSON  
CHECKED BY: M. CARLSON  
DATE: 12 OCT 1988



SHEET NO  
**A1**  
OF 4

## STANDARD ABBREVIATIONS

AC	ACROSS	AD	ADD	AL	ALUMINUM	AN	ANNEAL	AP	APPLY	AS	ASSEMBLY	AT	AT THE	AV	AVERAGE
BA	BATH	BB	BUTT	BL	BRASS	BO	BOND	BR	BRAZED	BS	BUILDING	BT	BUTT	BU	BURN
CA	CASE	CB	CORNER	CC	CORRUGATED	CD	CUT	CE	CEMENT	CF	CORRUGATED	CG	CORNER	CH	CHINA
CL	CLASH	CM	CORNER	CO	COPPER	CP	CUT	CR	CORRUGATED	CS	CORRUGATED	CT	CORNER	CU	CUP
DA	DRAWING	DB	DRAWING	DC	DRAWING	DD	DRAWING	DE	DRAWING	DF	DRAWING	DG	DRAWING	DH	DRAWING
EA	ELECTRICAL	EB	ELECTRICAL	EC	ELECTRICAL	ED	ELECTRICAL	EE	ELECTRICAL	EF	ELECTRICAL	EG	ELECTRICAL	EH	ELECTRICAL
FA	FLOOR	FB	FLOOR	FC	FLOOR	FD	FLOOR	FE	FLOOR	FF	FLOOR	FG	FLOOR	FH	FLOOR
GA	GALVANNEAL	GB	GALVANNEAL	GC	GALVANNEAL	GD	GALVANNEAL	GE	GALVANNEAL	GF	GALVANNEAL	GG	GALVANNEAL	GH	GALVANNEAL
HA	HARDWARE	HB	HARDWARE	HC	HARDWARE	HD	HARDWARE	HE	HARDWARE	HF	HARDWARE	HG	HARDWARE	HH	HARDWARE
IA	IRON	IB	IRON	IC	IRON	ID	IRON	IE	IRON	IF	IRON	IG	IRON	IH	IRON
JA	JUNCTION	JB	JUNCTION	JC	JUNCTION	JD	JUNCTION	JE	JUNCTION	JF	JUNCTION	JG	JUNCTION	JH	JUNCTION
KA	KITCHEN	KB	KITCHEN	KC	KITCHEN	KD	KITCHEN	KE	KITCHEN	KF	KITCHEN	KG	KITCHEN	KH	KITCHEN
LA	LATH	LB	LATH	LC	LATH	LD	LATH	LE	LATH	LF	LATH	LG	LATH	LH	LATH
MA	MASONRY	MB	MASONRY	MC	MASONRY	MD	MASONRY	ME	MASONRY	MF	MASONRY	MG	MASONRY	MH	MASONRY
NA	NAIL	NB	NAIL	NC	NAIL	ND	NAIL	NE	NAIL	NF	NAIL	NG	NAIL	NH	NAIL
OA	OPEN	OB	OPEN	OC	OPEN	OD	OPEN	OE	OPEN	OF	OPEN	OG	OPEN	OH	OPEN
PA	PAPER	PB	PAPER	PC	PAPER	PD	PAPER	PE	PAPER	PF	PAPER	PG	PAPER	PH	PAPER
QA	QUARTZ	QB	QUARTZ	QC	QUARTZ	QD	QUARTZ	QE	QUARTZ	QF	QUARTZ	QG	QUARTZ	QH	QUARTZ
RA	ROOF	RB	ROOF	RC	ROOF	RD	ROOF	RE	ROOF	RF	ROOF	RG	ROOF	RH	ROOF
SA	STEEL	SB	STEEL	SC	STEEL	SD	STEEL	SE	STEEL	SF	STEEL	SG	STEEL	SH	STEEL
TA	TILE	TB	TILE	TC	TILE	TD	TILE	TE	TILE	TF	TILE	TG	TILE	TH	TILE
UA	UPPER	UB	UPPER	UC	UPPER	UD	UPPER	UE	UPPER	UF	UPPER	UG	UPPER	UH	UPPER
VA	VANISHED	VB	VANISHED	VC	VANISHED	VD	VANISHED	VE	VANISHED	VF	VANISHED	VG	VANISHED	VH	VANISHED
WA	WALL	WB	WALL	WC	WALL	WD	WALL	WE	WALL	WF	WALL	WG	WALL	WH	WALL
XA	X-RAY	XB	X-RAY	XC	X-RAY	XD	X-RAY	XE	X-RAY	XF	X-RAY	XG	X-RAY	XH	X-RAY
YA	YIELD	YB	YIELD	YC	YIELD	YD	YIELD	YE	YIELD	YF	YIELD	YG	YIELD	YH	YIELD
ZA	ZINC	ZB	ZINC	ZC	ZINC	ZD	ZINC	ZE	ZINC	ZF	ZINC	ZG	ZINC	ZH	ZINC

	DETAIL SYMBOL		WALL SECTION SYMBOL
	BLDG. SECTION SYMBOL		INTERIOR ELEVATION
	DOOR KEY		WINDOW KEY
	ROOM / APT. NO.		

## INDEX OF DRAWINGS

- A1 COVER SHEET
- A2 SCHEMATIC SITE PLAN
- A3 SCHEMATIC FLOOR PLAN
- A4 SCHEMATIC SECTIONS / ELEVATIONS
  
- S1 FOUNDATION & BASEMENT PLAN
- S2 ROOF FRAMING PLAN
  
- M1 MECHANICAL BASEMENT PLAN
- M2 MECHANICAL FIRST FLOOR PLAN
  
- E1 ELECTRICAL FLOOR PLAN



VICINITY MAP



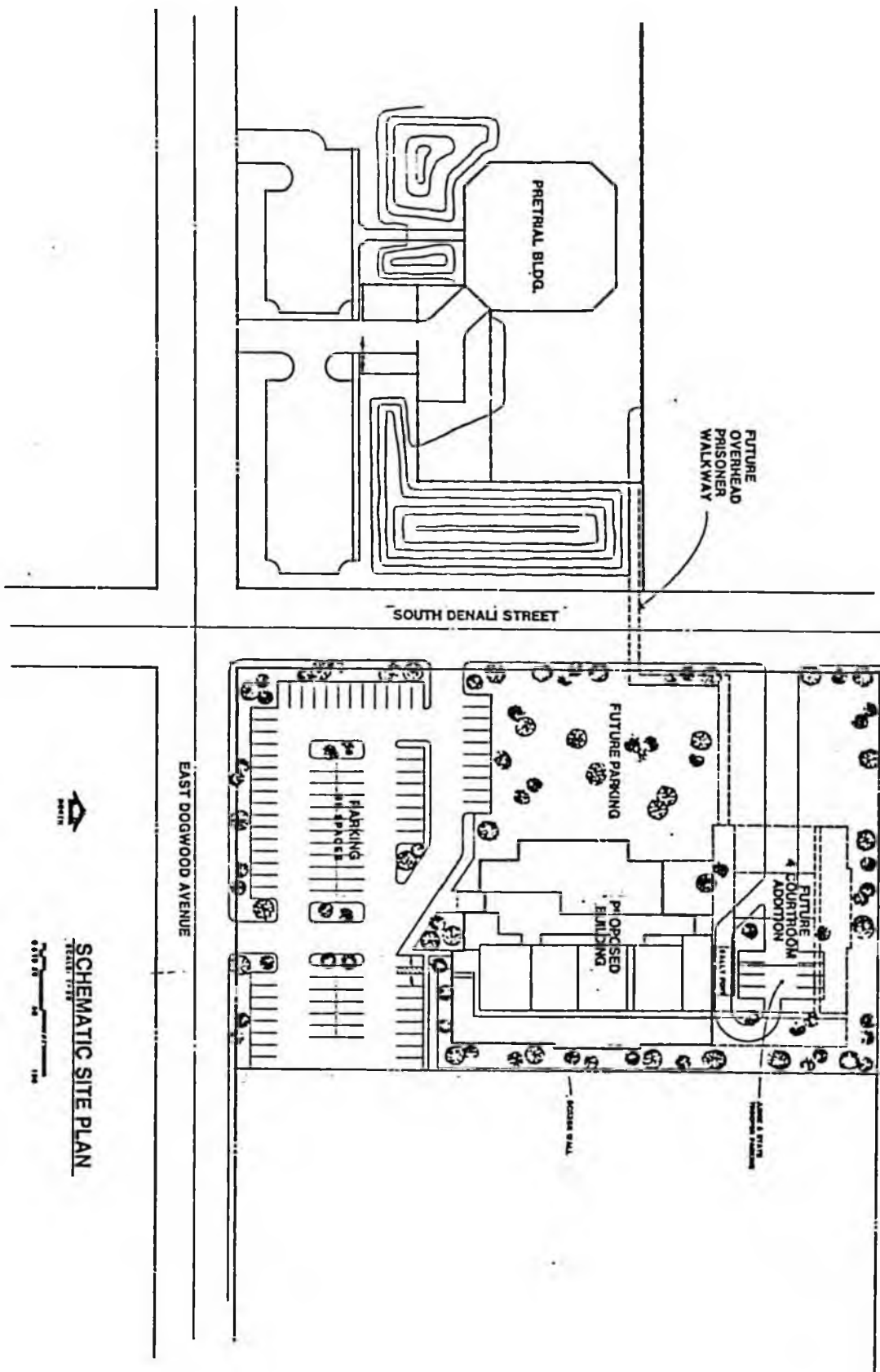

SCHEMATIC SITE PLAN  
 0 20 40 60 80 100  
 FEET

SHEET NO  
**A 2**  
 OF 4

PALMER COURTHOUSE  
 SITE PLAN - SCHEMATIC

DATE	REVISION

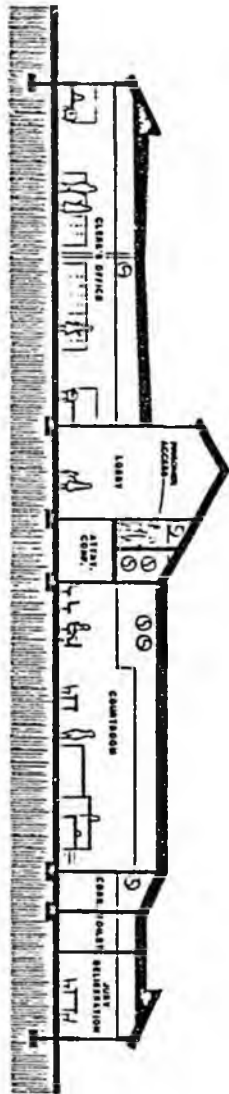

4  
3  
BUILDING CROSS SECTION  
SECTION TITLE

SOUTH ELEVATION (EAST DOBWOOD AVENUE)

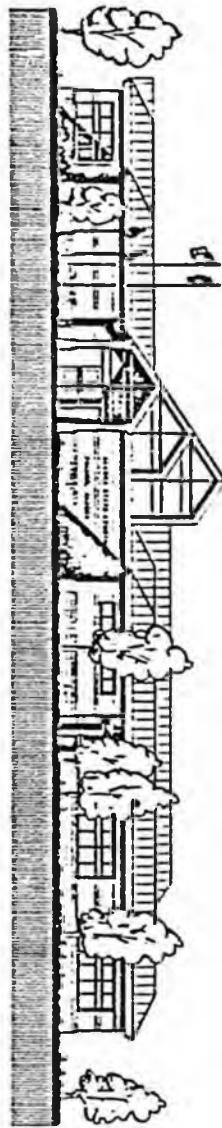

WEST ELEVATION (SOUTH DENALI STREET)

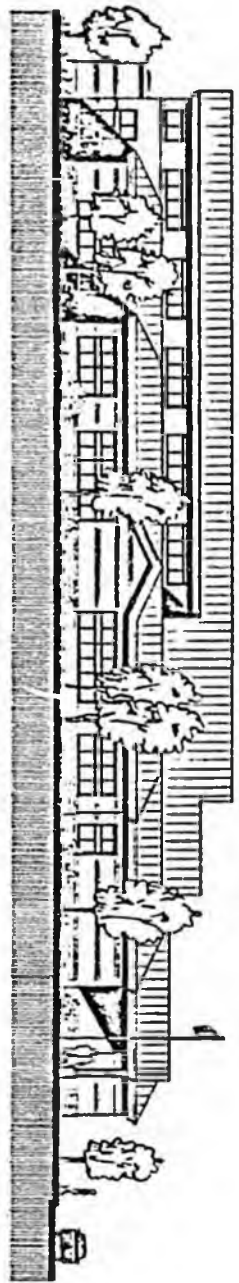

SHEET NO  
**A 4**  
OF 4

PALMER COURTHOUSE  
ELEVATIONS / SECTIONS - SCHEMATIC

DATE	08/11
BY	LM
CHECKED	LM
DATE	19 OCT 1988
PROJECT	



FLOOR PLAN  
SCALE 1/8" = 1'-0"

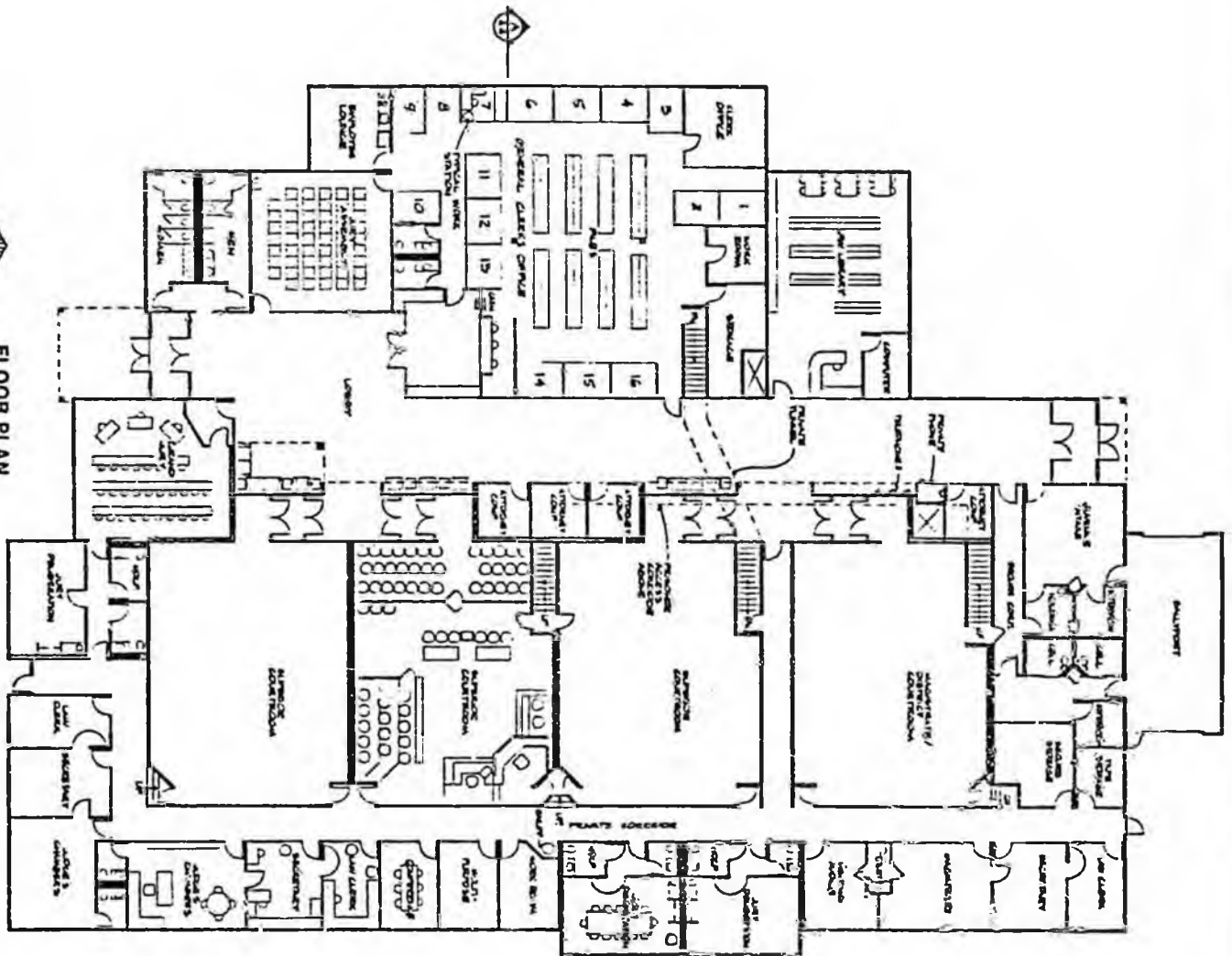

SHEET NO.  
**A 3**  
OF 8

PALMER COURTHOUSE  
FLOOR PLAN - SCHEMATIC

-13-

**M** McCOOL-McDONALD  
OF ALASKA P.C. ARCHITECTS  
611 S. 9TH AVE. ANCHORAGE, ALASKA 99501

DATE	12/15/88
SCALE	1/8" = 1'-0"
DRAWN BY	J.M.
CHECKED BY	J.M.
PROJECT NO.	88-001
DATE	12/15/88
SCALE	1/8" = 1'-0"
DRAWN BY	J.M.
CHECKED BY	J.M.

## ALASKA STATE FAIR AGRI-BUSINESS AND MULTI-PURPOSE PAVILION

From the time the first fair was held in the Matanuska Valley by the colonists back in 1935, this annual event has grown in size and scope so that in 1984 an estimated 321,000 people visited the Alaska State Fair.

At the same time from the humble beginnings, the fairgrounds has grown to a 222 acre site located adjacent to the Glenn Highway in the City of Palmer.

The Fair's primary goal is to support and make Alaskans aware of the agriculture products produced in the State. It is estimated that 99.9% of all the food eaten in Alaska is shipped in from Outside. The awareness that Alaskan grown produce and dairy products is a stigma the Fair first and foremost is trying to overcome. The State of Alaska has a major investment in the agriculture business, yet it, too, has not been able to make Alaskans aware of what is produced in-state. A joint State Fair/State of Alaska effort will go a long way in accomplishing this goal.

During the past few years, the Alaska State Fair has strived to encourage as many users as possible of its facility during non-fair dates. The users are KSKA Annual Bluegrass Festival, Breed Horse Shows, Rodeos, 4-H Club Rabbit Show, the Home Field for the Mat-Su Miners baseball team and home of Valley Performing Arts.

The philosophy of the Alaska State Fair Board of Directors to ultimately make the use of the fairgrounds a 365 day event is consistent with the Master Plan prepared by Albert P. Morrow Associates, Ltd., dated December 1981.

To reach this goal, all new facilities being built and proposed for the future are designed so that they are to be used as a multi-purpose function. The partially constructed Agri-Business and Multi-Purpose Pavilion is a prime example of this goal.

Although the Alaska State Fair is located in Palmer and the Matanuska Valley, the visitors who attend the eleven (11) day fair are mainly from Anchorage/Mat-S area. However, 52.5% of the sample survey visitors were from the Anchorage-Eagle River-Chugiak area. Consistent with the average age of Alaskans, 70.2% of the sample survey<sup>2</sup> were under the age of forty (40). The survey<sup>3</sup> indicates that 79.3% have been to more than one previous fair. The popularity of this event has grown from an estimated 137,151 visitors in 1975 to an estimated 321,000 visitors in 1984.

To accommodate the increasing number of visitors each year, the Alaska State Fair has made many improvements on the 222 acre site, such as water mains for fire protection and daily use, sewer system to eliminate septic tanks, increased parking areas, additional restroom facilities, new electric system eliminating potential life-safety conflicts and most of all spent \$3,986,321.66 to date on the Agri-Business and Multi-Purpose building, which is partially completed and the reason for this request.

Tourism is and has been touted as an area where Alaska could make significant inroads. A clear, non-polluting industry. The monetary impact of the Fair can be derived from the facts according to the sample survey<sup>1</sup> that the average female fairgoer spent between \$43.00-\$46.00 while the male fairgoer spent an average of \$45.00.

Even though the highlight at this time of the fairgrounds usage is for the annual State Fair, the number of events with a significant number (over 100) of people in attendance has shown a dramatic increase in the past two years. In 1983, it was estimated that 12,985 attended various non-fair same timed functions while in 1985 to date it is estimated that 18,775 people attended these events.

<sup>1</sup>Table 4, Alaska State Fair Survey Results, Making a Better Fair, Ms. Gail L. Smoke Statistical Consultant, October, 1985.

<sup>2</sup>Table 5, Ibid.

<sup>3</sup>Table 6, Ibid.

In the Matanuska Valley, the arts, or a lack of, is a growing concern. The Valley Performing Arts has made arrangements with the fair to use their buildings to put on various dramas for the interested public. The Valley Performing Arts anticipates the 1985-86 season to have 7,500 attendees in comparison to the 1982-83 season only 2,900 attendees. This 200% increase in attendance is indicative of the hunger for more of the arts.

The Mat-Su Miners, whose home is Hermon Brothers Field, play all their home games on land which is a part of the 222 acre complex. The Miners Baseball team, a member of the Alaska Baseball League, uses this field 60 days a year including playoffs with a total attendance of 5,750.

To assist the various functions who use the facilities as well as maintain and over-see the entire fair operations requires manpower. The many requirements in 1983 required a permanent staff of 8 people and 154 part-time people. In 1985, just two short years, this has increased to a permanent staff of 9 and 209 part-time people. The annual payroll has increased from \$256,294.98 in 1983 to \$389,764.18 (thru 10/31/85) in 1985.

As has been alluded to earlier, the goal of the fair is to be a 365 day per year function. This type of usage is beginning to show dramatic results. For example, in 1985, the fairgrounds will have an estimated 379 interim day use. (One or more functions at the same time).

To further provide public service, the completion of the Agri-Business and Multi-Purpose Pavilion needs to be accomplished. In previous years, \$3,986,321. has been spent to pay for the basic structure which includes the steel framing, footings, foundation, roof, underground plumbing and partial concrete block walls. Building this facility in stages has resulted in high construction costs because of the start/up-shut/down costs.

The primary function of the building is for use as an exhibition pavilion for fair-related activities. These include livestock exhibiting and showing, junior market livestock auctions, milking parlor and educational exhibiting, and rabbit and poultry exhibits. Other community, regional and statewide activities may include sporting events such as ice hockey, figure and ballet skating, gymnastic meets, horse shows and rodeos. Home shows, arts and cultural displays, leisure and recreational exhibits, educational and musical events, and meetings and seminars may also be accommodated.

While the prime use is to promote the agri-business aspect of the area and State as a whole, this facility will be able to fill the voids for the entire Mat-Su/Anchorage area that now exist in the arts, sports, exhibition hall for all types, meeting area and musical events year round. There is no such facility in the Matanuska-Susitna Valley. The 40,000 plus people in the Mat-Su Borough are thirsting for an indoor facility of this type. The Cook Inlet Nature-Spirit Days held at the fairgrounds this past summer would possibly have enjoyed a larger attendance if it were held in a facility such as this.

When the Agri-Business and Multi-Purpose Building is completed, it will contain approximately 77,000 square feet of enclosed multi-purpose area on the main floor, approximately 19,000 square feet of enclosed area on the mezzanine level and 17,000 square feet under the covered arcade. All the architectural/engineer work has been completed by David Fritz Consultants of Anchorage. This project is bid ready awaiting the remainder appropriation of \$5,750,000 to complete this project.

Initially, this facility will require a full-time staff of 3 plus an estimate part-time support staff of 20 people or more depending upon the event being held.

The construction completion is projected to need 5,650 man-days with an estimated construction payroll of \$1,900,000. The number of construction tradesmen on-site will vary between 30 and 50 during the facility completion. It is estimated that the project duration will be nine (9) months.

A final point is that the Agri-Business/Multi-Purpose Pavilion is consistent with the City of Palmer's 1985 Comprehensive Plan.

ESTIMATED CONSTRUCTION COSTS

General Conditions	\$400,000
Concrete Floor System	650,000
Walls (In-Out), Partitions, Decks, Floors, Ceilings, Doors (In-Out), Entrances, Insulation	1,190,000
Stairs, Elevators, Restrooms	325,000
Lighting and Electrical System	575,000
Mechanical, Ventilating, Plumbing	860,000
Fixtures & Furnishings, Bleacher Seats, Livestock Corral	580,000
Hockey and Ice Facilities	480,000
Landscaping, Exterior Work	300,000
Surveys, Design, Construction Administration	390,000
	<hr/>
	5,750,000

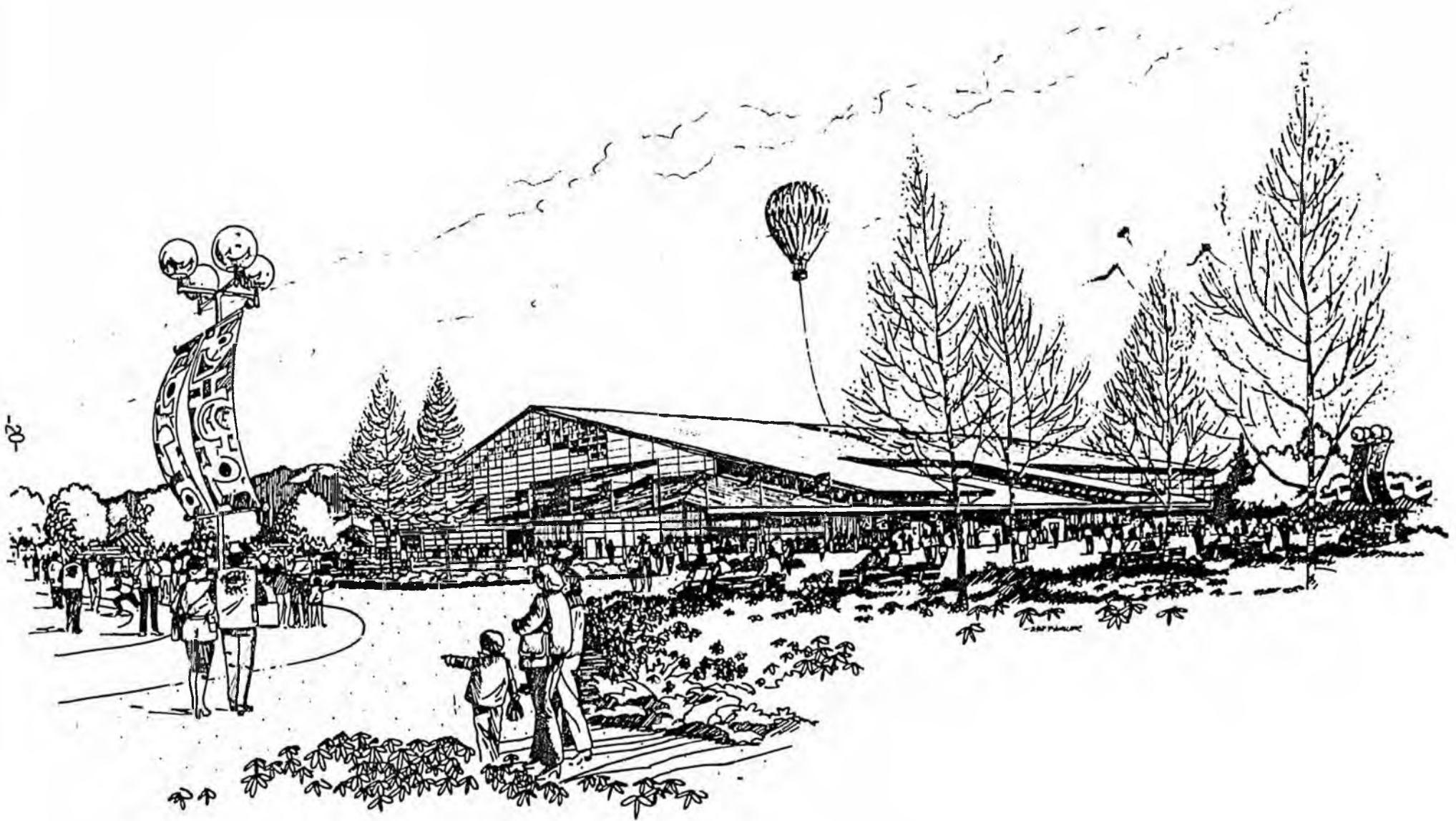

Handwritten notes in cursive script, including the words "LIVESTOCK" and "PAVILION", are written across the top of the page.

-21-

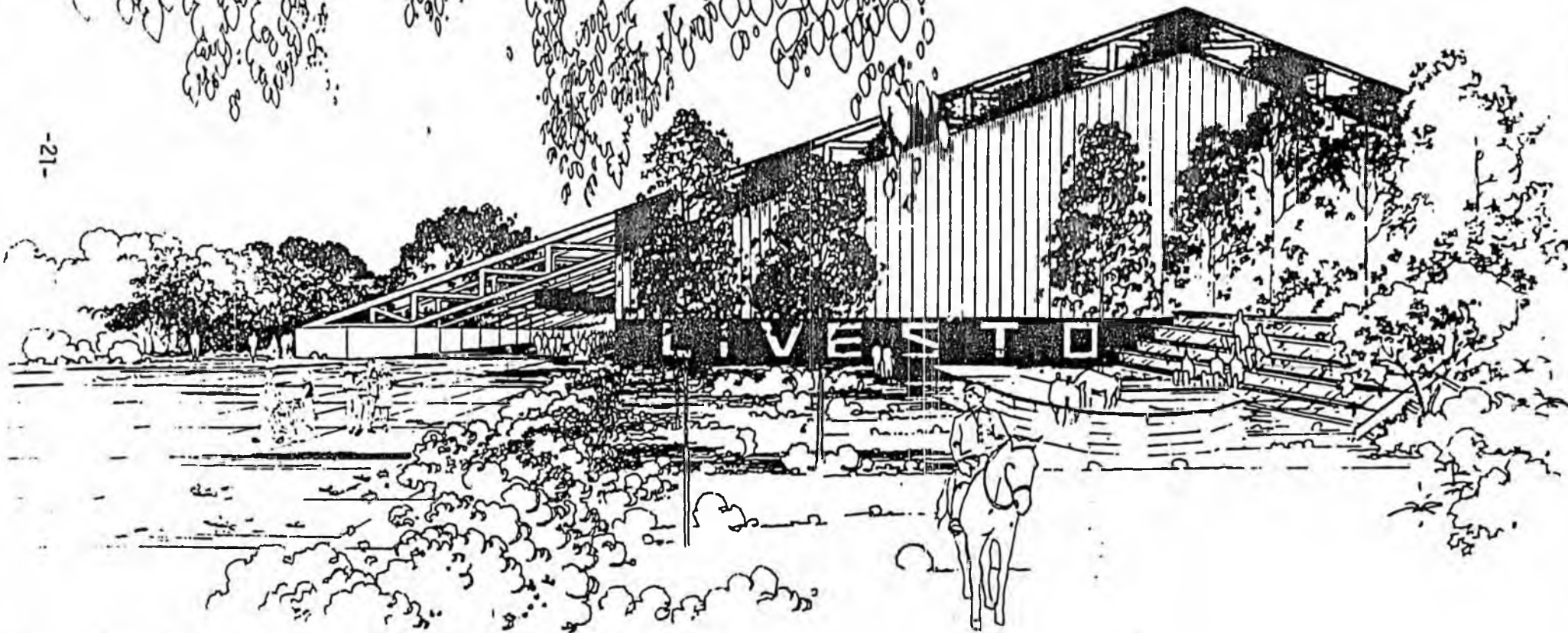

Livestock Pavilion

-22-

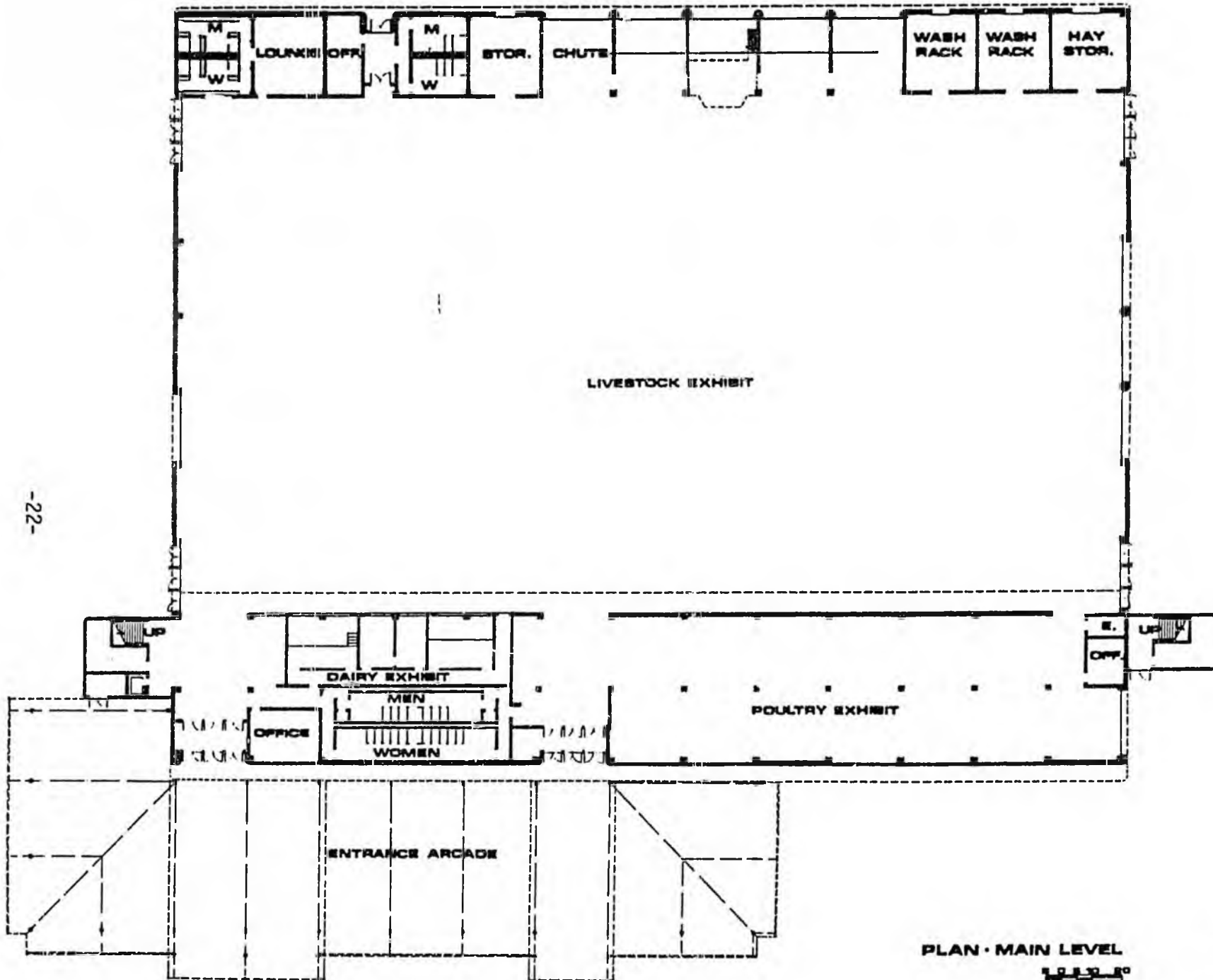

PLAN - MAIN LEVEL  
 1 2 3 4 5 6 7 8 9 10 11 12 13 14 15 16 17 18 19 20

DAVID PRY  
 CONSULTANT

PROJECT MANAGER  
 (TELEPHONE NUMBER)

LEADER  
 ASSOCIATES  
 ARCHITECTS  
 PLANNERS

210 W STREET  
 SUITE 100  
 ANCHORAGE, ALASKA

807 276 4473  
 REVISED  
 CHRISTIAN  
 CONSULTING  
 ARCHITECTS  
 LOS ANGELES  
 CALIFORNIA 90008

LIVESTOCK PAVILION  
 ALASKA STATE FAIR INC  
 ALASKA STATE FARM BLDG  
 P.O. BOX 11000 PALMER, ALASKA 99574

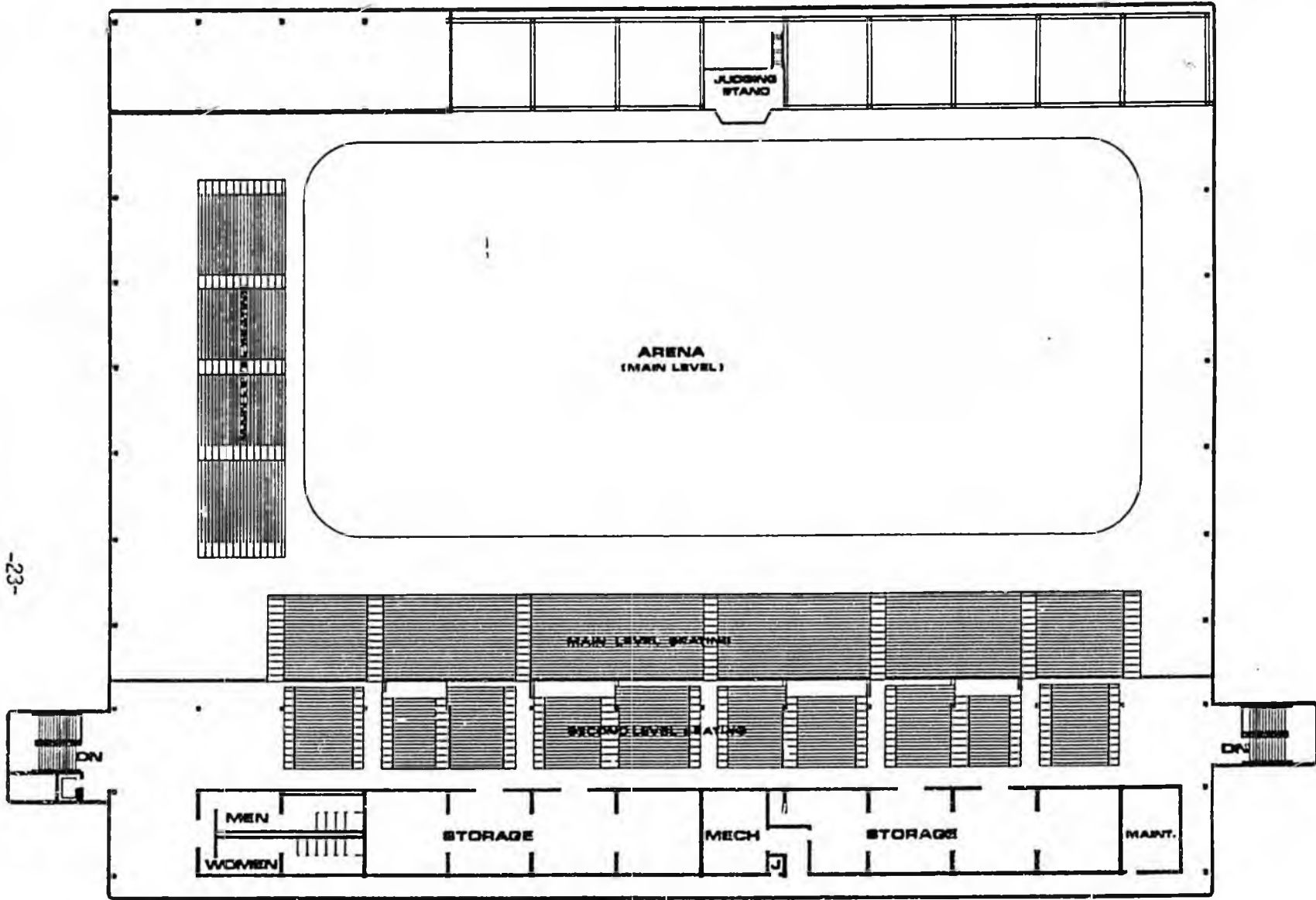

DAVID FRITZ  
CONSULTANTS  
1140 21<sup>ST</sup> STREET, 21<sup>ST</sup>  
DENVER, COLORADO 80202

1114 H STREET  
SUITE 100  
MID-CORNER ALASKA  
DENVER  
801 277 1200

LEADER  
ASSOCIATES  
ARCHITECTS  
PLANNERS

210 H STREET  
SUITE 100  
MID-CORNER ALASKA  
DENVER  
801 276 4475

RYON B  
CHRISTIAN  
CONSTRUCTION  
ARCHITECTS  
LOS ANGELES  
CALIFORNIA 90048

PLAN - SECOND LEVEL  
8 0 8 30 80

LIVESTOCK PAVILION  
ALASKA STATE FAIR INC.  
ALASKA STATE FARMHOUSE  
PO BOX 1188 PALMER ALASKA 99547

Ford  
2/7/86 ✓

Original sponsors: Kerttula, P.Fischer  
and DeVries

1  
2  
3  
4  
5  
6  
7  
8  
9  
10  
11  
12  
13  
14  
15  
16  
17  
18  
19  
20  
21  
22  
23  
24  
25  
26  
27  
28  
29

IN THE SENATE BY THE JUDICIARY COMMITTEE  
CS FOR SENATE BILL NO. 344 (Judiciary)  
IN THE LEGISLATURE OF THE STATE OF ALASKA  
FOURTEENTH LEGISLATURE - SECOND SESSION  
A BILL

For an Act entitled: "An Act relating to the number of superior court judges in the first and third judicial districts; and providing for an effective date."

BE IT ENACTED BY THE LEGISLATURE OF THE STATE OF ALASKA:

\* Section 1. AS 22.10.120 is amended to read:

Sec. 22.10.120. NUMBER OF JUDGES. The superior court consists of 32 [29] judges, six [FIVE] of whom shall be judges in the first judicial district, three of whom shall be judges in the second judicial district, 18 [16] of whom shall be judges in the third judicial district, and five of whom shall be judges in the fourth judicial district. At the time of submitting the names of nominees to the governor to fill a vacancy on the superior court bench, the judicial council shall also designate the district in which the appointee is to reside and serve.

\* Sec. 2. This Act takes effect immediately in accordance with AS 01.-10.070(c).

STATE OF ALASKA 1986 LEGISLATIVE SESSION  
FISCAL NOTE

Revision Date: \_\_\_\_\_

REQUEST

Bill/Resolution No.: CS SB 344 (TUD)  
 Title: "An Act relating to the number of Superior Court judges..."

Sponsor: Senator Kertulla  
 Requester: Senate Judiciary  
 Date of Request: February 11, 1986

FISCAL DETAIL

Agency Affected: Department of Administration  
 BRU: Public Defender Agency

Components: First Judicial District  
Third Judicial District

**EXPENDITURES/REVENUES : (Thousands of Dollars)**

OPERATING	FY 86	FY 87	FY 88	FY 89	FY 90	FY 91
PERSONAL SERVICES		271.9	282.8	294.1	305.9	318.1
TRAVEL		10.0	10.4	10.8	11.2	11.7
CONTRACTUAL		22.0	13.5	14.0	14.6	15.2
SUPPLIES		5.0	5.2	5.4	5.6	5.8
EQUIPMENT		10.5				
LAND & STRUCTURES						
GRANTS, CLAIMS						
MISCELLANEOUS						
<b>TOTAL OPERATING</b>	<b>-0-</b>	<b>319.4</b>	<b>311.9</b>	<b>324.3</b>	<b>337.3</b>	<b>350.8</b>

CAPITAL						
---------	--	--	--	--	--	--

REVENUE						
---------	--	--	--	--	--	--

**FUNDING : (Thousands of Dollars)**

GENERAL FUND	-0-	319.4	311.9	324.3	337.3	350.8
FEDERAL FUNDS						
OTHER						
<b>TOTAL</b>						

**POSITIONS :**

FULL-TIME	-0-	5.0	5.0	5.0	5.0	5.0
PART-TIME						
TEMPORARY						

ANALYSIS : Attach a separate page if necessary

(See attached page)

Prepared by: Dana Fabe, Public Defender  
 Division: Public Defender Agency

Phone: 279-7541  
 Date: February 11, 1986

Approved by Commissioner: Eleanor Anderson  
 Agency: Administration

Date: 2/18/86

Distribution (by Agency preparing fiscal note):

- Legislative Finance
- Legislative Sponsor
- Requestor
- Office of Management and Budget
- Impacted Agency(ies)

# CONTINUATION of FISCAL NOTE ANALYSIS

For Bill/Resolution No. CS SB 344

The Alaska Court System is requesting three new Superior Court Judges, one for the First Judicial District to be located in Ketchikan, and two for the Third Judicial District to be located in Palmer and Kenai. The addition of judges in any court location results in a substantial increase in required court appearances for attorneys in the Public Defender Agency. The Agency must have attorneys available to appear at the additional court hearings scheduled before the new judges along with necessary support staff in order to avoid unnecessary delays and continuances.

## BUDGET ANALYSIS

### First District

Ketchikan - Attorney III	64.0		
100	Personal Services	64.0	
200	Travel	2.5	
300	Contractual (includes space)	6.0	
400	Supplies	1.0	
500	Equipment (one-time)	<u>1.5</u>	
	TOTAL		75.0

### Third District

Palmer - Attorney III	66.1		
Paralegal II	44.9		
Kenai - Attorney III	68.0		
Clerk/Typist III	28.9		
100	Personal Services	207.9	
200	Travel	7.5	
300	Contractual (includes space)	16.0	
400	Supplies	4.0	
500	Equipment (one-time)	<u>.9.0</u>	
	TOTAL		244.4

GRAND TOTAL      319.4

Position Title <b>Attorney III</b>			No. of Positions <b>1</b>	Range/Step <b>22A</b>	Barg. Unit <b>PX</b>	Gov.	Approv.	Disapp
Time Status <b>PFT</b>	Staff Months <b>12.0</b>	RP Number	Location <b>Ketchikan</b>		Election District <b>1</b>	Leg.		
Type of Expenditure			Justification					
		Amount	<p>CS SB 344 establishes a new Superior Court judge in Ketchikan. This is in addition to the present Superior Court judge, District Court judge and magistrate. The Agency has two permanent attorneys assigned here and would require another assistant public to cover the caseload and mandatory court appearances. The Ketchikan office also covers Superior Court travelling calendars in the area.</p>					
1	2	3						
Salary	\$4095 x 12	49,140						
Benefits		14,810						
Premium Pay								
Other								
Total Personal Services		63,950						
Travel		2,500						
Contractual		6,000						
Commodities		1,000						
Equipment		1,500						
Other								
Total Cost		74,950						
Receipt Code	Funding Source							
	Federal Receipts 1002							
	G. F. Match 1003							
	General Funds 1004		74,950					
	I-A Receipts 1005							
	Program Receipts 1028							
	CIP Receipts 1061							
	Other							
For B&M Use Only Key Number _____								

**Request For  
New Position**

Agency Department of Administration  
 BRU Public Defender Agency  
 Component First Judicial District

**FY 87**

Page 3 of 7  
 Revised Date \_\_\_\_\_

Position Title <b>Attorney III</b>			No. of Positions <b>1</b>	Range/Step <b>22A</b>	Barg. Unit <b>PX</b>	Gov.	Approv.	Disapp.	
Time Status <b>PFT</b>	Staff Months <b>12.0</b>	RP Number	Location <b>Palmer</b>		Election District <b>16</b>	Leg.			
Type of Expenditure			Justification						
		Amount	<p>CS SB 344 establishes a new Superior Court judge in Palmer. This is in addition to the present Superior Court judge and magistrate. At the present time, the Agency has only two permanent attorney positions established for Palmer. A new judicial position would require a third assistant public defender as well as a paralegal assistant to ensure that mandatory court appearances are covered.</p>						
<b>1</b>	<b>2</b>	<b>3</b>							
Salary	\$4246 x 12	50,952							
Benefits		15,142							
Premium Pay									
Other									
Total Personal Services		66,094							
Travel		2,500							
Contractual		6,000							
Commodities		1,000							
Equipment		1,500							
Other									
Total Cost		77,094							
Receipt Code	Funding Source								
	Federal Receipts	1002							
	G. F. Match	1003							
	General Funds	1004							77,094
	I-A Receipts	1005							
	Program Receipts	1028							
	CIP Receipts	1061							
	Other								
For B&M Use Only Key Number _____									

**Request For  
New Position**

Agency Department of Administration  
 BRU Public Defender Agency  
 Component Third Judicial District

**FY 87**

Page 4 of 7  
 Revised Date \_\_\_\_\_

Position Title <b>Paralegal Assistant II</b>			No. of Positions <b>1</b>	Range/Step <b>16A</b>	Barg. Unit <b>GG</b>	Gov.	Approv.	Disapp.
Time Status <b>PFT</b>	Staff Months <b>12.0</b>	RP Number	Location <b>Palmer</b>		Election District <b>16</b>	Leg.		
Type of Expenditure			Justification					
		Amount	<p>CS SB 344 establishes a new Superior Court judge in Palmer. This is in addition to the present Superior Court judge and magistrate. At the present time, the Agency has only two permanent attorney positions established for Palmer. A new judicial position would require a third assistant public defender as well as a paralegal assistant to ensure that mandatory court appearances are covered.</p>					
1	2	3						
Salary	\$2804 x 12	33,648						
Benefits		11,240						
Premium Pay								
Other								
Total Personal Services		44,888						
Travel		2,500						
Contractual		3,000						
Commodities		1,000						
Equipment		1,500						
Other								
Total Cost		52,888						
Receipt Code	Funding Source							
	Federal Receipts 1002							
	G. F. Match 1003							
	General Funds 1004		52,888					
	I-A Receipts 1005							
	Program Receipts 1028							
	CIP Receipts 1061							
	Other							
For B&M Use Only								
Key Number _____								

**Request For  
New Position**

Agency Department of Administration  
 BRU Public Defender Agency  
 Component Third Judicial District

Page 5 of 7  
 Revised Date \_\_\_\_\_

**FY 87**

Position Title <b>Attorney III</b>			No. of Positions <b>1</b>	Range/Step <b>22A</b>	Bar Unit <b>PX</b>	Gov.	Approv.	Disapp.
Time Status <b>PFT</b>	Staff Months <b>12.0</b>	RP Number	Location <b>Kenai</b>		Election District <b>5</b>	Leg.		
Justification								
Type of Expenditure			Amount					
1			2			3		
Salary <b>\$4379 x 12</b>			<b>52,548</b>					
Benefits			<b>15,434</b>					
Premium Pay								
Other								
Total Personal Services						<b>67,982</b>		
Travel						<b>2,500</b>		
Contractual						<b>6,000</b>		
Commodities						<b>1,000</b>		
Equipment						<b>1,500</b>		
Other								
Total Cost						<b>78,982</b>		
Receipt Code		Funding Source						
		Federal Receipts 1002						
		G. F. Match 1003						
		General Funds 1004		<b>78,982</b>				
		I-A Receipts 1005						
		Program Receipts 1028						
		CIP Receipts 1061						
		Other						
For B&M Use Only Key Number _____								

CS SB 344 establishes a new Superior Court judge in Kenai. This is in addition to the present Superior Court judge and magistrate. The Agency has three attorneys and a para-legal assigned here and the new judicial position would require another assistant public defender and a clerk/typist. They are necessary to cover the caseload and mandatory court appearances.

**Request For  
New Position**

Agency Department of Administration  
 BRU Public Defender Agency  
 Component Third Judicial District

Page 6 of 7  
 Revised Date \_\_\_\_\_

**FY 87**

Position Title <b>Clerk/Typist III</b>			No. of Positions <b>1</b>	Range/Step <b>8A</b>	Barg. Unit <b>GG</b>	Gov.	Approv.	Disapp.
Time Status <b>PFT</b>	Staff Months <b>12.0</b>	RP Number	Location <b>Kenai</b>	Election District <b>5</b>		Leg.		
Type of Expenditure			Justification					
		Amount	<p>CS SB 344 establishes a new Superior Court judge in Kenai. This is in addition to the present Superior Court judge and magistrate. The Agency has three attorneys and a paralegal assigned here and the new judicial position would require another assistant public defender and a clerk/typist. They are necessary to cover the caseload and mandatory court appearances.</p>					
1	2	3						
Salary	\$1731 x 12	20,772						
Benefits		8,098						
Premium Pay								
Other								
Total Personal Services		28,870						
Travel		-0-						
Contractual		1,000						
Commodities		1,000						
Equipment		4,500						
Other								
Total Cost		35,370						
Receipt Code	Funding Source							
	Federal Receipts	1002						
	G. F. Match	1003						
	General Funds	1004	35,370					
	I-A Receipts	1005						
	Program Receipts	1028						
	CIP Receipts	1061						
	Other							
<div style="border: 1px solid black; padding: 5px; width: fit-content;"> For B&amp;M Use Only  Key Number _____ </div>								

Request For  
New Position

Agency Department of Administration  
BRU Public Defender Agency  
Component Third Judicial District

FY 87

Page 7 of 7  
Revised Date

FEB 11 '86 13:07 ACA 2ND JUD DIST FAX276-6342

## STATE OF ALASKA 1986 LEGISLATIVE SESSION FISCAL NOTE

Revision Date : \_\_\_\_\_

**REQUEST**

Bill/Resolution No. : SB344  
 Title : an Act Relating to the number  
of judges  
 Sponsor : \_\_\_\_\_  
 Requestor : Senate Judiciary Committee  
 Date of Request : 2/11/86

**FISCAL DETAIL**

Agency Affected : ALASKA COURT SYSTEM  
 BRU : Trial Courts  
 Components : \_\_\_\_\_

**EXPENDITURES/REVENUES : (Thousands of Dollars)**

OPERATING	FY 86	FY 87	FY 88	FY 89	FY 90	FY 91
PERSONAL SERVICES		862.2	913.9	968.7	1,026.8	1,088.4
TRAVEL						
CONTRACTUAL		17.7	18.8	19.9	21.2	22.4
SUPPLIES		6.0	6.4	6.8	7.2	7.6
EQUIPMENT		51.1				
LAND & STRUCTURES						
GRANTS, CLAIMS						
MISCELLANEOUS						
<b>TOTAL OPERATING</b>		<b>937.0</b>	<b>939.1</b>	<b>995.4</b>	<b>1,055.1</b>	<b>1,118.4</b>
<b>CAPITAL</b>						
<b>REVENUE</b>						

**FUNDING : (Thousands of Dollars)**

GENERAL FUND	937.0	939.1	995.4	1,055.1	1,118.4
FEDERAL FUNDS					
OTHER					
<b>TOTAL</b>	<b>937.0</b>	<b>939.1</b>	<b>995.4</b>	<b>1,055.1</b>	<b>1,118.4</b>

**POSITIONS :**

FULL-TIME	12	12	12	12	12
PART-TIME	1	1	1	1	1
TEMPORARY					

**ANALYSIS :** Attach a separate page if necessary

See attached page.

Prepared by : Robert G. Fisher Phone : 264-8215  
 Division : Alaska Court System Date : 2/11/86

Approved by Commissioner : *Adrian Fisher* Date : 2/11/86  
 Agency : Alaska Court System

Distribution (by Agency preparing fiscal note) :

- Legislative Finance
- Legislative Sponsor
- Requestor
- Office of Management and Budget
- Impacted Agency(ies)

FEB 11 '86 13:08 AOA 2ND JUD DIST FAX276-6342

ALASKA COURT SYSTEM  
SB 344 - AN ACT INCREASING  
THE NUMBER OF JUDGES

FISCAL IMPACT

PERSONAL SERVICES:	Salary	Benefits	Total Costs
Kenai: Superior Court Judge	\$82,716	\$96,245	\$178,961
In-Court Clerk (PFT, range 12B)	27,432	9,247	36,679
Secretary (PFT, range 12B)	27,432	9,247	36,679
Law Clerk (PFT, range 13A)	28,380	9,462	37,842
Palmer: Superior Court Judge	80,004	96,155	176,159
In-Court Clerk (PFT, range 12B)	26,604	9,059	35,663
Secretary (PFT, range 12B)	26,604	9,059	35,663
Law Clerk (PFT, range 13A)	27,432	9,247	36,679
Wetchikan: Superior Court Judge	77,304	93,066	170,370
In-Court Clerk (PFT, range 12B)	25,740	8,864	34,604
Secretary (PFT, range 12B)	25,740	8,864	34,604
Law Clerk (PFT, range 13A)	26,604	9,059	35,663
Bailiff (PFT, 6 months, range 6A)	9,042	3,564	12,606
			-----
Total Personal Services			862,172
CONTRACTUAL:			
Telephone and postage costs			6,000
Word processors			11,700
			-----
Total Contractual			17,700
SUPPLIES:			
			6,000
EQUIPMENT: (one-time items)			
Office furniture			36,942
Reference materials (chambers and courtroom)			14,193
			-----
Total Equipment			51,135
			-----
TOTAL COST			\$937,007
			=====

Subsequent fiscal years adjusted to reflect 6% inflation.

FEB 11 '86 13:08 PCA END JUD DIST FR:276-6842

ALASKA COURT SYSTEM  
 SB 344 - AN ACT INCREASING  
 THE NUMBER OF JUDGES

FISCAL IMPACT

PERSONAL SERVICES:		Salary	Benefits	Total Costs
Kenai:	Superior Court Judge	\$82,716	\$96,245	\$178,961
	In-Court Clerk (PFT, range 12B)	27,432	9,247	36,679
	Secretary (PFT, range 12B)	27,432	9,247	36,679
	Law Clerk (PFT, range 13A)	28,380	9,462	37,842
Palmer:	Superior Court Judge	80,004	96,155	176,159
	In-Court Clerk (PFT, range 12B)	26,604	9,059	35,663
	Secretary (PFT, range 12B)	26,604	9,059	35,663
	Law Clerk (PFT, range 13A)	27,432	9,247	36,679
Ketchikan:	Superior Court Judge	77,304	93,066	170,370
	In-Court Clerk (PFT, range 12B)	25,740	8,864	34,604
	Secretary (PFT, range 12B)	25,740	8,864	34,604
	Law Clerk (PFT, range 13A)	26,604	9,059	35,663
	Bailiff (PPT, 6 months, range 6A)	9,042	3,564	12,606
				-----
Total Personal Services				862,172
 CONTRACTUAL:				
	Telephone and postage costs			6,000
	Word processors			11,700
				-----
Total Contractual				17,700
 SUPPLIES:				
				6,000
 EQUIPMENT: (one-time items)				
	Office furniture			36,942
	Reference materials (chambers and courtroom)			14,193
				-----
Total Equipment				51,135
				-----
TOTAL COST				\$937,007
				=====

Subsequent fiscal years adjusted to reflect 6% inflation.

ALASKA COURT SYSTEM  
SB 344 - AN ACT INCREASING  
THE NUMBER OF JUDGES

FISCAL IMPACT

PERSONAL SERVICES:		Salary	Benefits	Total Costs
Kenai:	Superior Court Judge	\$82,716	\$96,245	\$178,961
	In-Court Clerk (PFT, range 12B)	27,432	9,247	36,679
	Secretary (PFT, range 12B)	27,432	9,247	36,679
	Law Clerk (PFT, range 13A)	28,380	9,462	37,842
Palmer:	Superior Court Judge	80,004	96,155	176,159
	In-Court Clerk (PFT, range 12B)	26,604	9,059	35,663
	Secretary (PFT, range 12B)	26,604	9,059	35,663
	Law Clerk (PFT, range 13A)	27,432	9,247	36,679
Ketchikan:	Superior Court Judge	77,304	93,066	170,370
	In-Court Clerk (PFT, range 12B)	25,740	8,864	34,604
	Secretary (PFT, range 12B)	25,740	8,864	34,604
	Law Clerk (PFT, range 13A)	26,604	9,059	35,663
	Bailiff (PPT, 6 months, range 6A)	9,042	3,564	12,606
Total Personal Services				862,172
 CONTRACTUAL:				
	Telephone and postage costs			6,000
	Word processors			11,700
Total Contractual				17,700
 SUPPLIES:				
				6,000
 EQUIPMENT: (one-time items)				
	Office furniture			36,942
	Reference materials (chambers and courtroom)			14,193
Total Equipment				51,135
 TOTAL COST				 \$937,007 =====

Subsequent fiscal years adjusted to reflect 6% inflation.

# STATE OF ALASKA 1986 LEGISLATIVE SESSION FISCAL NOTE

Revision Date : \_\_\_\_\_

**REQUEST**

Bill/Resolution No. : SB344

Title : " An Act increasing the number of superior court judges..."

Sponsor : Senator Kertulla

Requestor : Senate Judiciary

Date of Request : \_\_\_\_\_

**FISCAL DETAIL**

Agency Affected : Public Safety

BRU : Alaska State Troopers

Components : Judicial Services

**EXPENDITURES/REVENUES : (Thousands of Dollars)**

OPERATING	FY 86	FY 87	FY 88	FY 89	FY 90	FY 91
PERSONAL SERVICES		129.7	137.5	145.7	154.5	163.7
TRAVEL		4.0	4.2	4.5	4.8	5.0
CONTRACTUAL		22.4	23.7	25.2	26.7	28.3
SUPPLIES		6.6	7.0	7.4	7.9	8.3
EQUIPMENT		38.4				
LAND & STRUCTURES						
GRANTS, CLAIMS						
MISCELLANEOUS						
<b>TOTAL OPERATING</b>		<b>201.1</b>	<b>172.4</b>	<b>182.8</b>	<b>193.9</b>	<b>205.3</b>

<b>CAPITAL</b>						
----------------	--	--	--	--	--	--

<b>REVENUE</b>						
----------------	--	--	--	--	--	--

**FUNDING : (Thousands of Dollars)**

GENERAL FUND		201.1	172.4	182.8	193.9	205.3
FEDERAL FUNDS						
OTHER						
<b>TOTAL</b>						

**POSITIONS :**

FULL-TIME		2	2	2	2	2
PART-TIME						
TEMPORARY						

**ANALYSIS :** Attach a separate page if necessary

See Attachment

Prepared by : Francis C. Allan *F.C.A.*

Division : Alaska State Troopers

Phone : 269-5691

Date : 2/6/86

Approved by Commissioner : *[Signature]*

Agency : Department of Public Safety

Date : 2/10/86

Distribution (by Agency preparing fiscal note):

- Legislative Finance
- Legislative Sponsor
- Requestor
- Office of Management and Budget
- Impacted Agency(ies)

The additional two judges will force an increase in work load for for the Judicial Services Component that will need to be covered by two additional State Trooper personnel. Current staffing levels will be unable to cover any increases. The positions will be used to provide court security, move prisoners and serve civil and criminal process. Related clerical activities can be handled by current staff. These positions will be located in Palmer and Kenai/Soldotna at the same locations as the judges. Costs are as follows:

Alaska State Troopers Judicial Services			
	Palmer	Kenai	FY87 Total
Personal Services	\$63.8	\$ 65.9	\$129.7
Travel	2.0	2.0	4.0
Contractual	11.2	11.2	22.4
Supplies	3.3	3.3	6.6
Equipment	19.2	19.2	38.4
Total	<u>\$99.5</u>	<u>\$101.6</u>	<u>\$201.1</u>

Assumptions: The fiscal note was prepared on the basis that equipment would be needed in the first year only and that a 6% inflation will take place each year after FY87.



PALMER

Trooper

PERSONAL SERVICES - 100

\$3,363 x 12 months =	\$40,356	
+ 180 hours OT	5,587	
SUB TOTAL	<u>\$45,943</u>	
+ .261327% Benefits	12,006	
+ .0613 SBS	2,800	
+ Health Benefits	<u>3,006</u>	
TOTAL PERSONAL SERVICES		\$63,755

TRAVEL & PER DIEM - 200

Average - This will vary		
TOTAL TRAVEL & PER DIEM		2,000

CONTRACTUAL - 300

Telephone/Postage, \$85 per month x 12	1,020	
Photo Processing, \$40 per month x 12	480	
PSEA Physical Exam, Average	300	
Uniform PSEA Cleaning Allowance	636	
HWCF Vehicle - Monthly Cost Replacement \$292 per month + 1,500 miles x .29	<u>8,724</u>	
TOTAL CONTRACTUAL		11,160

SUPPLIES AND MATERIALS - 400

Uniforms/with all accessories; jacket, hats, handcuffs, etc.	1,900	
Film Supplies + Office Supplies	750	
Vehicle Accessories - Blanket, tire chains, snow tires, flares, etc.	<u>650</u>	
TOTAL SUPPLIES AND MATERIALS		3,300

EQUIPMENT - 500

Patrol - Vehicle - initial cost	12,000	
Underhood Speaker	100	
Car Radio	3,000	
Siren/Amplifier	250	
MX 360 Radio-Portable w/charger	3,200	
Firearms (revolver, shotgun, & rifle)	<u>650</u>	
TOTAL EQUIPMENT		<u>19,200</u>

TOTAL TROOPER COST TO THE BRU		\$99,415
-------------------------------	--	----------

Position Title State Trooper			No. of Positions 1	Range/Step 76/A	Base Unit PSEA	Gov.	Approv.	Disapp.
Time Status PFT	Staff Months 12	RP Number	Location Kenai		Election District 16	Leg.		
Type of Expenditure			Justification					
			This commissioned State Trooper will be needed to provide court security, move prisoners and serve criminal and civil process. The position will provide coverage for the increased workload created by the additional superior court judge proposed. Current staff cannot handle the increase.					
Amount								
1	2	3						
Salary	41,880							
Benefits	18,266							
Premium Pay	5,799							
Other								
Total Personal Services		65.9						
Travel		2.0						
Contractual		11.2						
Commodities		3.3						
Equipment		19.2						
Other								
Total Cost		101.6						
Receipt Code	Funding Source							
	Federal Receipts 1002							
	G. F. Match 1003							
	General Funds 1004		101.6					
	I-A Receipts 1005							
	Program Receipts 1028							
	CIP Receipts 1061							
	Other							
For B&M Use Only Key Number _____								

Request For  
New Position

Agency Public Safety  
 BRU Alaska State Troopers  
 Component Judicial Services

Page 2 of 2  
 Revised Date \_\_\_\_\_

FY 87

Kenai/Soldotna

Trooper

PERSONAL SERVICES - 100

\$3,990 x 12 months =	\$41,880	
+ 180 hours OT	5,799	
SUB TOTAL	<u>\$47,679</u>	
+ .261327% Benefits	12,460	
+ .0613 SBS	2,800	
+ Health Benefits	<u>3,006</u>	
TOTAL PERSONAL SERVICES		\$65,945

TRAVEL & PER DIEM - 200

Average - This will vary		
TOTAL TRAVEL & PER DIEM		2,000

CONTRACTUAL - 300

Telephone/Postage, \$85 per month x 12	1,020	
Photo Processing, \$40 per month x 12	480	
PSEA Physical Exam, Average	300	
Uniform PSEA Cleaning Allowance	636	
HWCF Vehicle - Monthly Cost Replacement \$292 per month + 1,500 miles x .29	<u>8,724</u>	
TOTAL CONTRACTUAL		11,160

SUPPLIES AND MATERIALS - 400

Uniforms/with all accessories; jacket, hats, handcuffs, etc.	1,900	
Film Supplies + Office Supplies	750	
Vehicle Accessories - Blanket, tire chains, snow tires, flares, etc.	<u>650</u>	
TOTAL SUPPLIES AND MATERIALS		3,300

EQUIPMENT - 500

Patrol - Vehicle - initial cost	12,000	
Underhood Speaker	100	
Car Radio	3,000	
Siren/Amplifier	250	
MX 360 Radio-Portable w/charger	3,200	
Firearms (revolver, shotgun, & rifle)	<u>650</u>	
TOTAL EQUIPMENT		<u>19,200</u>

TOTAL TROOPER COST TO THE BRU		\$101,605
-------------------------------	--	-----------

# ALASKA COURTS FILINGS

FY 85

LOCATION	SUPERIOR COURT	DISTRICT COURT	TOTAL	% OF STATE-WIDE TOTAL	FILINGS PER JUDGE
Anchorage	11602	69992	81594	49.5	2720
Barrow	285	574	859	.5	430
Bethel	469	1585	2054	1.2	1027
Cordova		501	501	.3	501
Dillingham		817	817	.5	817
Fairbanks	3448	14660	18108	11.0	1646
Glennallen		882	882	.5	882
Homer		2779	2779	1.7	2779
Juneau	1211	7714	8925	5.4	2975
Kenai	928	7570	8498	5.2	4249
Ketchikan	813	4669	5482	3.3	1827
Kodiak	455	3733	4188	2.5	2094
Kotzebue	263	1109	1372	.8	686
Nome	330	814	1144	.7	572
Palmer	1148	11600	12748	7.8	6374
Petersburg		598	598	.4	598
Seward		3121	3121	1.9	3121
Sitka	322	2371	2693	1.6	1347
Tok		1044	1044	.6	1044
Unalaska		429	429	.3	429
Valdez	133	743	876	.5	876
Wrangell	219	599	818	.5	409
OTHER (Low Vol.)		5042	5042	3.1	140
<b>TOTAL</b>	21626	142946	164570	100	1496

## BY JUDICIAL DISTRICT

First	2565	17427	19992	12.1	1052
Second	878	2797	3675	2.2	245
Third	14266	103096	117362	71.3	2395
Fourth	3917	19626	23543	14.3	872

FISCAL YEAR JULY 1 — JUNE 30

Superior

# ALASKA COURTS DISPOSITIONS

FY 85

LOCATION	SUPERIOR COURT	DISTRICT COURT	TOTAL	% OF STATE-WIDE TOTAL	DISPOSITIONS PER JUDGE
Anchorage	9491	61580	71071	47.8	2369
Barrow	213	496	709	.5	355
Bethel	465	1508	1973	1.3	987
Cordova		475	475	.3	475
Dillingham		758	758	.5	758
Fairbanks	3632	13850	17482	11.8	1589
Glennallen		847	847	.6	847
Homer		2474	2474	1.7	2474
Juneau	977	6719	7696	5.2	2565
Kenai	873	7525	8398	5.7	4199
Ketchikan	616	4471	5087	3.4	1696
Kodiak	290	3764	4054	2.7	2027
Kotzebue	300	1140	1440	.9	720
Nome	263	696	959	.6	480
Palmer	825	10684	11509	7.7	5755
Petersburg		619	619	.4	619
Seward		3108	3108	2.1	3108
Sitka	334	2453	2787	1.9	1394
Tok		1004	1004	.7	1004
Unalaska		390	390	.3	390
Valdez	97	799	896	.6	896
Wrangell	185	509	694	.5	347
OTHER (Low Vol.)		4120	4102	2.8	114
<b>TOTAL</b>	<b>18561</b>	<b>129971</b>	<b>148532</b>	<b>100</b>	<b>1350</b>

## BY JUDICIAL DISTRICT

First	2112	15842	17954	12.1	945
Second	776	2567	3343	2.3	223
Third	11576	93217	104793	70.6	2139
Fourth	4097	18345	22442	15.1	831

FISCAL YEAR JULY 1 — JUNE 30

# ALASKA COURTS AUTHORIZED JUDICIAL POSITIONS

FY 85

LOCATION	SUPERIOR COURT	DISTRICT COURT	MAGISTRATES	MASTERS	TOTAL	% OF STATE-WIDE TOTAL
Anchorage	12	9	5	4	30	27.2
Barrow	1		1		2	1.8
Bethel	1		1		2	1.8
Cordova			1		1	.9
Dillingham			1		1	.9
Fairbanks	4	4	2	1	11	10.0
Glennallen			1		1	.9
Homer		1			1	.9
Juneau	2	1			3	2.7
Kenai	1		1		2	1.8
Ketchikan	1	1	1		3	2.7
Kodiak	1		1		2	1.8
Kotzebue	1		1		2	1.8
Nome	1		1		2	1.8
Palmer	1		1		2	1.8
Petersburg			1		1	.9
Seward			1		1	.9
Sitka	1		1		2	1.8
Tok			1		1	.9
Unalaska			1		1	.9
Valdez	1				1	.9
Wrangell	1		1		2	1.8
OTHER (Low Vol.)			36		36	32.7
<b>TOTAL</b>	<b>29</b>	<b>16</b>	<b>60</b>	<b>5</b>	<b>110</b>	<b>100</b>

Alaska Court System Personnel Roster June 30, 1985

## BY JUDICIAL DISTRICT

First	5	2	12	0	19	17.3
Second	3	0	12	0	15	13.6
Third	16	10	19	4	49	44.5
Fourth	5	4	17	1	27	24.5

FISCAL YEAR JULY 1 — JUNE 30

## SUPERIOR COURT

### Introduction

The superior court is the trial court of general jurisdiction, with original jurisdiction in all civil and criminal matters. Appeals to the superior court from final judgments of the district court are a matter of right. The superior court has exclusive jurisdiction in all domestic relations matters, children's proceedings, probate, guardianship and civil commitments.<sup>1</sup>

### FY 85 Caseload - Superior Courts

Superior court case filings statewide increased 6% from FY 84. Total dispositions increased by 16%. While cases are still being filed in the state's superior courts at a rate faster than available judicial resources can decide them, this marks the second year that overall dispositions have increased from the preceding year. A significant change during FY 85 was the increase in the ratio of "cases disposed of" to "cases filed" from 78% to 86%.

During FY 85, the Valdez superior court, created in 1984, was fully operational. Two additional superior court positions were filled in January 1985.

Table II provides summary caseload statistics for each superior court location for fiscal year 1985.

<sup>1</sup>For more information about superior court jurisdiction see Profile, supra.

TABLE II  
SUPERIOR COURTS  
CASELOAD SUMMARY FY 85  
7/1/84 - 6/30/85

Court	FY 85 Filings	FY 85 Dispositions	Percent Change in Filings From FY84	Ratio of Dispositions to Filings	
				FY84	FY85
Anchorage	11,602	9,491	+ 9%	76%	82%
Barrow	285	213	+14%	88%	75%
Bethel	469	465	+11%	86%	99%
Fairbanks	3,448	3,632	- 4%	79%	105%
Juneau	1,211	977	+ 3%	76%	81%
Kenai	928	873	- 2%	76%	94%
Ketchikan	813	616	0%	86%	76%
Kodiak	455	290	+ 6%	77%	64%
Kotzebue	263	300	-22%	99%	114%
Nome	330	263	+15%	103%	80%
Palmer	1,148	825	+32%	70%	72%
Sitka	322	334	-17%	82%	104%
Valdez (1)	133	97	(1)	(1)	73%
Wrangell/(2) Petersburg	219	185	+12%	71%	84%
<b>TOTALS</b>	<b>21,626</b>	<b>18,561</b>	<b>+ 6%</b>	<b>78%</b>	<b>86%</b>

BY JUDICIAL DISTRICT

First	2,565	2,112	0%	80%	82%
Second	878	776	0%	97%	88%
Third	14,266	11,576	+11%	76%	81%
Fourth	3,917	4,097	- 5%	80%	105%

(1) Valdez was upgraded to a superior court in FY84 but did not commence operations until FY85.

(2) Wrangell & Petersburg operate a combined superior court but separate district courts.