

2345

SHESS

SB 267

-

SB 282

2345

have substantial security specifications, is that its construction generally commits the State to a fixed kind of space limited in function. Should Alaska's correctional needs change in the future its ability to adapt will be shaped by the kind of space that has already been constructed.⁵ The construction of two units would allay this commitment. For example, suppose the State's max needs halved over a period of time, one unit could be more easily converted to serve some other purpose.

- o Transfer of Inmates -- An undesirable possibility in corrections is the formation of cliques and organizations among the inmate population for purposes of disruption. The most efficacious action by management is transferring key inmates, preferably to a different unit. This, obviously, can only be accomplished if there is another unit available.

- o Control of the Institution -- From administrators contacted there was unanimous agreement that the smaller the institution the easier it is to control the inmate population, even where the same staff to inmate ratio existed. The main reason was due to the ability of staff to establish rapport with the inmates and diffuse quickly and efficiently potentially dangerous situations. In larger institutions the mere number of interactions which occur tends to inhibit this important function.

⁵Adult Corrections In Alaska, p. 41.

o Smaller Prisons Are More Humane and Safer For Staff and Community -- Conrad sees prisons as inevitable in modern society, but advocates they need not be inhumane, dehumanizing, brutal holding tanks for inmates. Rather, the solution lies in designing and building smaller institutions that would reduce the inhumanity that breeds in the larger institutions. Conrad argues that continued use of brutal maximum security prisons not only affects the inmates, but degrades all of society. This argument is supported in a study which established the inmate's perception of density was directly related to rate of assaultive behaviors by inmates on other inmates and staff. It is likely that perception of density is directly related to the size of the institution.

As Roger Endell noted, other states have found that the larger the facility the higher the incidence of prison violence. He further attributed the relative absence of violence in Alaska's prisons to its small prison capacities. Dana Fabe, head of the Public Defenders in Alaska, also concurs and stresses the need to establish several small maximum security facilities. "Ms. Fabe believes that this approach would also strengthen the Division's ability to separate dissimilar groups of maximum security prisoners; e.g., sex offenders could be housed apart from other classes of prisoners."

o Other Institutional Advantages -- In an interview with many of the staff at the Fairbanks Office of Adult Probation and parole, several additional advantages were cited. Staff and inmate attitudes would be much more positive in smaller prisons. The reasons given for positive inmate attitudes was that in smaller prisons the inmate retains his sense of individuality as opposed to simply being a nameless face and number among many. As for positive staff attitudes these would occur because of the ability among small staffs to "get to know each other" and form supportive relationships. Higher levels of face-to-face communication would also reduce the possibility of inmate manipulation of one staff member against another.

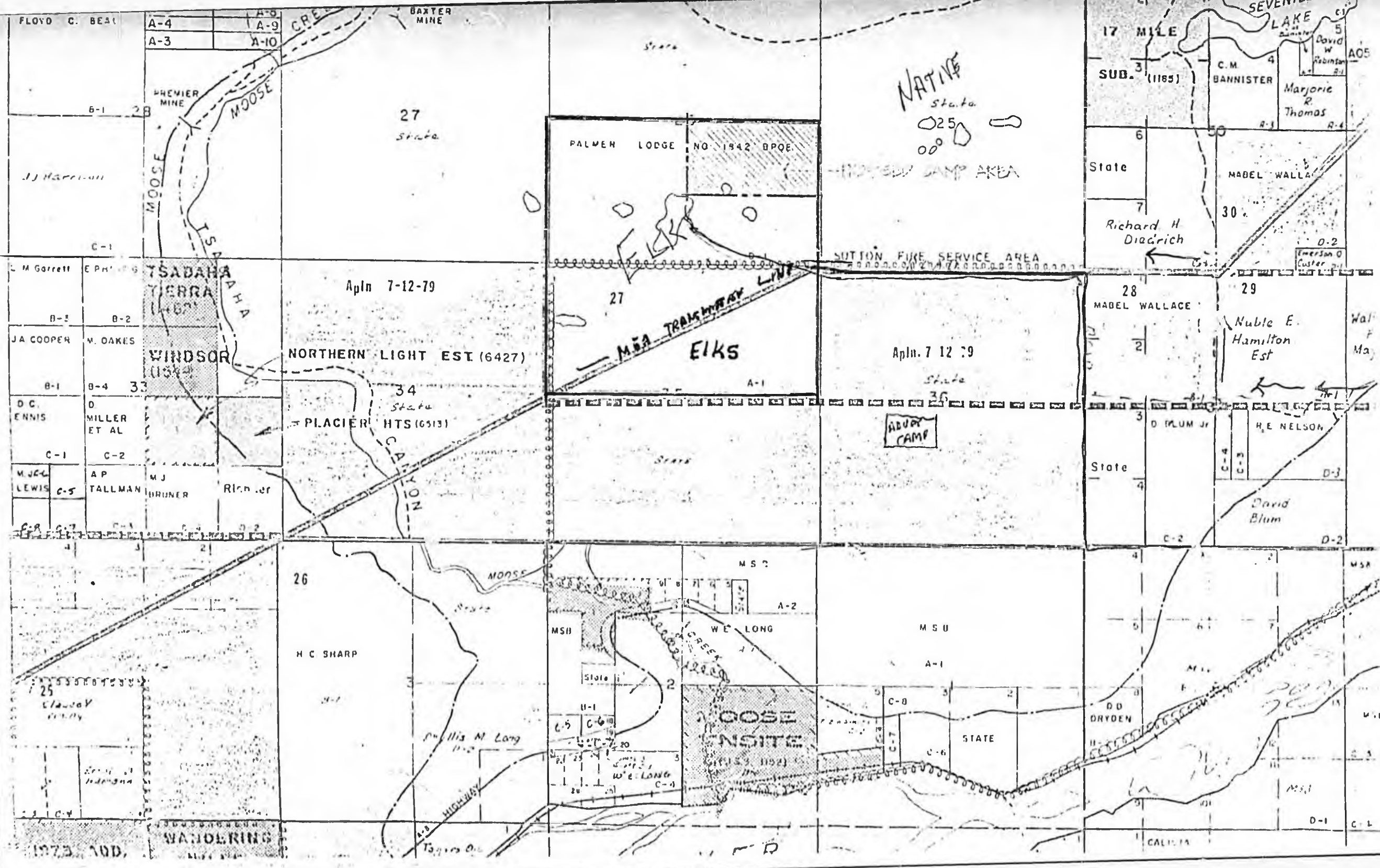

FLOYD C. BEAT

A-4
A-3
A-9
A-10

PREMIER MINE
MOOSE

27
State

PALMER LODGE NO. 1942 BPOE

NATIVE
State
25

SEVENTEEN MILE LAKE
17 MILE
SUB. (1185)
C.M. BANNISTER
Marjorie R. Thomas
AOS
R-3
R-4

State
6
7
Richard H. Diarrich
MABEL WALLACE
30
0.2
Emerson O. Custer

C. M. Garrett

TSADAH
TIERRA
WINDSOR
(1984)

Apr 7-12-79

27

M.S.A. TRAILWAY LINE
EIKS

SUTTON FIRE SERVICE AREA

28
MABEL WALLACE
29
Nuble E. Hamilton Est
W. Ma

JA COOPER

M. OAKES

NORTHERN LIGHT EST (6427)

Apr. 7 12 79

D.C. ENNIS

O. MILLER ET AL

PLACIER HTS (6513)

34
State

ADULT CAMP

State
3
D. BLUM JR.
H. E. NELSON
D-3
David Blum
D-2

M. J. LEWIS

A. P. TALLMAN
M. J. BRUNER

26
H. C. SHARP

M.S.B.
M.S.C.
W.C. LONG
MOOSE SITE
(1953, 1954)

M.S.U.
A-1

State
4
D.D. DRYDEN
STATE
C-0
C-6
D-1
C-1

25
State

W.C. Long

W.C. LONG
C-5
C-6
C-7

WANDERING

1973 ADD.

S

B

282

IN THE SENATE

BY FERGUSON BY REQUEST

SENATE BILL NO. 282

IN THE LEGISLATURE OF THE STATE OF ALASKA
THIRTEENTH LEGISLATURE - FIRST SESSION

A BILL.

For an Act entitled: "An Act relating to chief school administrators; and providing for an effective date."

BE IT ENACTED BY THE LEGISLATURE OF THE STATE OF ALASKA:

* Section 1. AS 14.14.130 is amended by adding new subsections to read:

(d) A person employed as the chief school administrator for a regional education attendance area may not accept any other employment during the school year. The salary, including cost of living and longevity adjustments and with the monetary value of all benefits received, may not in the aggregate exceed the annual salary of the governor under AS 39.20.010 as adjusted in the manner provided by AS 39.27.020 unless approved by the school board and the legislative Budget and Audit Committee.

(e) A contract with a person employed as the chief school administrator may not provide for deferred benefits following termination of employment except for those deferred benefits available to all certified employees of the district.

(f) A person employed as the chief school administrator for a regional education attendance area may not be absent from the district for more than 6 consecutive days while school is in session unless on sick or military leave approved by the school board and the legislative Budget and Audit Committee.

(g) A person employed as the chief school administrator for a regional education attendance area may take sabbatical leave only if the leave is approved by the school board and the legislative Budget

and Audit Committee. The chief school administrator for a regional education attendance area may not receive more than one-half salary during absence for sabbatical. If the chief school administrator for a regional education attendance area is not employed by the district for three consecutive years upon returning from sabbatical, unless incapacitated due to medical reasons approved by the school board and the legislative Budget and Audit Committee, all compensation paid by the district during sabbatical must be repaid at the rate of one-third for each year not served.

(h) A contract issued to the chief school administrator for a regional education attendance area may not exceed three years in duration and negotiations for its renewal may not commence prior to 180 days before its expiration.

* Sec. 2. AS 14.20.207(1) is amended to read:

(1) "teacher" means a person serving in a teaching, counseling, or administrative capacity and required to be certificated in order to hold the position, but does not mean a person employed as chief school administrator for the purpose of 14.20.150;

* Sec. 3. This Act takes effect immediately in accordance with AS 01.10.070(c).

A SPECIAL REVIEW OF THE
DEPARTMENT OF EDUCATION
BERING STRAIT REAA
ADVENTURE-BASED EDUCATION PROGRAM

For the Fiscal Year Ended June 30, 1981

AUDIT CONTROL NUMBER
05-012-0004-S

Commissioner, Department of Education

Marshall L. Lind

Deputy Commissioner, Department of
Education

Robert Van Slyke

STATE OF ALASKA

THE LEGISLATURE

BUDGET AND AUDIT COMMITTEE

AUDIT DIVISION
POUCH W—ALASKA OFFICE BUILDING

FINANCE DIVISION
POUCH WF—STATE CAPITOL

JUNEAU, ALASKA 99811

October 1, 1981

Members of the
Legislative Budget and Audit Committee:

In accordance with Title 24 of the Alaska Statutes and a special request of the Legislative Budget and Audit Committee, the attached report is submitted for your review.

A SPECIAL REVIEW OF THE
DEPARTMENT OF EDUCATION
BERING STRAIT REAA
ADVENTURE-BASED EDUCATION PROGRAM

For the Fiscal Year Ended June 30, 1981



Gerald L. Wilkerson, CPA
Legislative Auditor
Division of Legislative Audit

TABLE OF CONTENTS

	<u>Page</u>
Purpose of the Review.	1
Organization and Function.	2
Findings and Recommendations	3
Chronology of Events Regarding Adventure-Based Education Funds.	5
Schedules:	
Summary Schedule of Project	
Expenditures by Object Group	7
Analysis of Expenditures by Project.	8
Notes to Analysis of Expenditures by Project.	15
Agency Response:	
Department of Education.	16

PURPOSE OF THE REVIEW

In accordance with a Legislative Budget and Audit Committee request, and the provisions of Title 24 of the Alaska Statutes, a special review of funds appropriated in 1980 to the Department of Education for a grant to the Bering Strait REAA for adventure-based education projects was conducted to determine the current status of the appropriation.

ORGANIZATION AND FUNCTION

Section 16, Chapter 50, SLA 1980 appropriated \$300,000 to the Department of Education to be awarded in the form of a grant to the Bering Strait REAA for adventure-based education.

AS 14.30.500 states that an adventure-based education program should be designed to bring adventure-based education to high school students and appropriate juvenile offenders. The program should include provisions for basic skills-learning and skills-generalization. Skills-learning includes physical conditioning, technical training, and safety training, while skills-generalization includes vocational counseling and placement, family and interpersonal counseling, community service systems, etc.

The responsibility for determining the acceptability of projects submitted by the Bering Strait REAA rested with the Department of Education.

FINDINGS AND RECOMMENDATIONS

Recommendation No. 1

The Department of Education should establish a firm date when the \$300,000 encumbrance for adventure-based education will lapse.

Section 16, Chapter 50, SLA 1980 appropriated \$300,000 to the Department of Education. The funds were to be awarded by the Department as a grant to the Bering Strait REAA for adventure-based education projects.

AS 14.30.500 sets forth the criteria which an adventure-based program/project must meet in order to qualify for State support.

On September 29, 1980, the Attorney General issued an opinion based on a review of the proposal submitted by the Bering Strait REAA that projects sponsored by the REAA did not meet the conditions required by AS 14.30.500. The opinion pointed out that students who did not qualify had participated in the projects, and the projects included in the proposal did not meet the criteria required by AS 14.30.500, e.g., basic skills-learning and skills-generalization. Skills-learning includes physical conditioning, technical training and safety training, while skills-generalization includes vocational counseling and placement, family and interpersonal counseling, community service systems, etc. As a result of the Attorney General's opinion, the Department of Education elected not to release the funds to the REAA.

In May of 1981 the Department of Education requested appropriate information which would allow the Department to release the funds. The REAA submitted data to the Department. However, the Attorney General stated that the information did not satisfy the criteria included in AS 14.30.500.

On June 23, 1981, the Department of Education again contacted the REAA requesting information which would allow the Department to release the funds. The Department encumbered the \$300,000 on June 24, 1981, in order to prevent the funds from lapsing before the REAA had sufficient time to furnish appropriate documentation for approximately \$228,000 in expenditures.

As of October 1, 1981, the REAA had not furnished any additional documentation to support its Fiscal Year 1981 adventure-based education projects expenditures.

In order to expedite disposing of the encumbrance, the Department of Education should establish a firm date by which the Bering Strait REAA must provide the required documentation. If adequate documentation has not been submitted by that time, the encumbrance should be reversed and the appropriation lapsed to the General Fund.

STATE OF ALASKA
 DEPARTMENT OF EDUCATION
 BERING STRAIT REAA
 ADVENTURE-BASED EDUCATION PROGRAM
 CHRONOLOGY OF EVENTS REGARDING
ADVENTURE-BASED EDUCATION FUNDS
 For the Fiscal Year Ended June 30, 1981

<u>Date</u>	<u>Description</u>
August 30, 1979	Section 3, Chapter 86, SLA 1979, adding a section to Title 14 of the Alaska Statutes with regard to adventure-based education, becomes effective.
May 31, 1980	Section 16, Chapter 50, SLA 1980 appropriated \$300,000 from the General Fund to the Department of Education, special programs, for payment as a grant to the Bering Strait REAA for an adventure-based education program.
August 4, 1980	Bering Strait REAA requests that the Department of Education disburse \$300,000 for adventure-based education programs.
September 19, 1980	Bering Strait REAA advised by the Commissioner of the Department of Education that there is a question regarding the Department's legal authority to release the funds.
September 29, 1980	The Attorney General issues an opinion stating that the Bering Strait REAA is not in compliance with the provisions of AS 14.30.500 regarding qualifications for adventure-based programs. The Attorney General states that funding should be withheld by the Department pending compliance by the REAA.
September 30, 1980	Bering Strait REAA requests transfer of \$300,000 in Fiscal Year 1981 adventure-based education funds from the Department of Education.

(continued next page)

STATE OF ALASKA
DEPARTMENT OF EDUCATION
BERING STRAIT REAA
ADVENTURE-BASED EDUCATION PROGRAM
CHRONOLOGY OF EVENTS REGARDING
ADVENTURE-BASED EDUCATION FUNDS
For the Fiscal Year Ended June 30, 1981

<u>Date</u>	<u>Description</u>
November 3, 1980	The Department of Education advises Bering Strait REAA that funding of the adventure-based education projects initiated by the REAA would be withheld pending submission of an acceptable proposal by the REAA.
May 1, 1981	The Department of Education informs the Bering Strait REAA that an acceptable proposal must be submitted by May 15, 1981.
May 19, 1981	Bering Strait REAA submits a proposal to the Department of Education.
May 26, 1981	The Commissioner of Education requests an opinion of the Attorney General regarding the REAA's proposal.
June 1, 1981	The Attorney General advises the Commissioner of the Department of Education that the program described in the proposal does not meet statutory adventure-based education criteria.
June 2, 1981	The Department of Education again denies funding to Bering Strait REAA.
June 23, 1981	The Commissioner of the Department of Education informs the Superintendent of the Bering Strait REAA that the \$300,000 appropriation has been encumbered so that reimbursement to the REAA for expenses in the operation of the project can be initiated upon the receipt of proper documentation.

STATE OF ALASKA
DEPARTMENT OF EDUCATION
BERING STRAIT REAA
ADVENTURE-BASED EDUCATION
SUMMARY OF PROJECT EXPENDITURES BY OBJECT GROUP
For the Fiscal Year Ended June 30, 1981

Description	Program Adminis- trative Costs	Soapy Smith	Bechel Musical	Juneau Survival Training	Anchorage Music	European Tour	Ski Trip	Totals
Consultant Fees	\$18,530.00	\$19,850.00	\$ 5,910.00	\$12,000.00	\$24,000.00	\$24,943.85	\$ 500.00	\$106,033.85
Communications	2,788.45	-0-	73.75	-0-	-0-	-0-	-0-	2,862.20
Travel	9,155.58	2,224.26	4,403.08	127.00	-0-	64,854.00	7,649.87	88,413.79
Purchased Services	351.45	1,715.21	2,528.89	9,938.20	-0-	375.00	405.00	15,313.75
Teaching Supplies	-0-	-0-	57.80	-0-	-0-	753.19	222.63	1,033.62
Office Supplies	160.60	-0-	14.90	-0-	-0-	-0-	-0-	175.50
Food	-0-	-0-	-0-	3,593.92	-0-	-0-	-0-	3,593.92
Other Supplies	-0-	604.42	-0-	-0-	-0-	-0-	-0-	604.42
Equipment	264.95	1,004.47	507.30	6,694.48	-0-	-0-	2,150.00	10,621.20
<u>Totals</u>	<u>\$31,551.03</u>	<u>\$25,398.36</u>	<u>\$13,495.72</u>	<u>\$32,353.60</u>	<u>\$24,000.00</u>	<u>\$90,926.04</u>	<u>\$10,927.50</u>	<u>\$228,652.25</u>

STATE OF ALASKA
DEPARTMENT OF EDUCATION
BERING STRAIT REAA
ADVENTURE-BASED EDUCATION
ANALYSIS OF EXPENDITURES BY PROJECT
For the Fiscal Year Ended June 30, 1981
(Note 1)

<u>Project</u>	<u>Date</u>	<u>Amount</u>
<u>Program Administrative Costs</u>		
<u>Consultant Fees</u>		
C. Basler - 06/15/80-06/30/80	07/14/80	\$ 1,000.00
C. Basler - 07/01/80-07/31/80	07/02/80	2,000.00
C. Basler - 08/01/80-08/31/80	08/05/80	2,000.00
C. Basler - 09/01/80-09/30/80	09/05/80	2,000.00
C. Basler - 10/01/80-10/31/80	09/26/80	2,000.00
C. Basler - 11/01/80-11/30/80	11/10/80	2,000.00
C. Basler - 12/01/80-12/31/80	11/24/80	2,000.00
C. Basler - Overpayment	1. 22/80	1,000.00
C. Basler - 82 hours additional between 01/13/81 and 06/26/81 (Note 2)	07/10/81	3,280.00
P. Fisher - 11/01/80-11/20/80	11/01/80	575.00
T. Miller - 07/01/80-07/31/80	07/14/80	975.00
		18,830.00
<u>Total Consultant Fees</u>		
<u>Communications</u>		
Telephone Bill	08/04/80	389.05
Telephone Bill	09/11/80	299.59
Telephone Bill	10/15/80	214.22
Telephone Bill	11/12/80	424.32
Telephone Bill	12/18/80	598.65
Telephone Bill	12/19/80	263.00
Unidentified		210.85
Telephone Bill - C. Basler	02/19/81	388.77
		2,788.45
<u>Total Communications</u>		
<u>Travel</u>		
<u>Airfare</u>		
M. Goodhue	09/12/80	254.00
J. Tongen	07/22/80	54.11
R. Hohman	08/21/80	1,618.35
C. Basler	09/10/80	222.00
M. Thomas	10/01/80	212.20
K. Hohman	10/09/80	601.30
R. Hohman	12/17/80	772.00
R. Hohman	12/17/80	864.04
R. Hohman	01/30/81	552.00
C. Basler	09/07/80	228.00
C. Basler	08/21/80	246.00
C. Basler	07/25/80	95.00
C. Basler	10/10/80	190.00
C. Basler	10/10/80	290.00
C. Basler	01/14/81	290.00
C. Basler	01/14/81	228.00
C. Basler	01/28/81	484.18
C. Basler	02/19/81	104.47
C. Basler	07/10/81	326.25
C. Basler	09/21/81	212.00
C. Basler	10/26/81	289.86
<u>Per Diem</u>		
M. Goodhue	09/12/80	60.00
C. Basler	07/23/80	136.47
C. Basler	09/02/80	104.70
C. Basler - lodging	09/02/80	229.58
C. Basler	09/03/80	200.00
C. Basler - lodging	10/15/80	62.09
C. Basler	11/12/80	168.98

(continued next page)

STATE OF ALASKA
 DEPARTMENT OF EDUCATION
 BERING STRAIT REAA
 ADVENTURE-BASED EDUCATION
 ANALYSIS OF EXPENDITURES BY PROJECT
 For the Fiscal Year Ended June 30, 1981
 (Note 1)

<u>Project</u>	<u>Date</u>	<u>Amount</u>
<u>Program Administrative Costs (cont'd)</u>		
<u>Travel (cont'd)</u>		
<u>Goldstreak</u>		
Wien	10/10/80	\$ 30.00
Wien	10/10/80	30.00
<u>Total Travel</u>		<u>9,155.58</u>
<u>Various Vendors</u>		
Adj. Entries		351.45
<u>Total Various Vendors</u>		<u>351.45</u>
<u>Office Supplies</u>		
Petty Cash and Miscellaneous Supplies	07/11/80	100.00
Storage Charge - Hortons Auke Bay	10/22/80	60.60
<u>Total Office Supplies</u>		<u>160.60</u>
<u>Equipment</u>		
Yukon Office Supply	09/03/80	264.95
<u>Total Equipment</u>		<u>264.95</u>
<u>Total Program Administrative Costs</u>		<u>31,551.03</u>
<u>Soapy Smith</u>		
<u>Consultant Fees</u>		
T. Biss	07/01/80	2,250.00
T. Biss	07/15/80	750.00
T. Biss	07/30/80	1,500.00
T. Biss	08/13/80	2,000.00
T. Biss	08/29/80	1,000.00
Ekvall-Stern Communication Group	07/01/80	3,150.00
Ekvall-Stern Communication Group	07/15/80	1,050.00
Ekvall-Stern Communication Group	07/30/80	2,100.00
Ekvall-Stern Communication Group	09/11/80	2,450.00
C. Yager	07/14/80	525.00
C. Yager	08/18/80	1,050.00
C. Yager	09/11/80	525.00
T. Eckles	08/13/80	1,500.00
<u>Total Consultant Fees</u>		<u>19,850.00</u>
<u>Travel</u>		
<u>Airfare</u>		
Ekvall-Stern Communication Group	07/01/80	222.00
T. Biss	07/01/80	457.00
T. Eckles	08/13/80	241.00
Ekvall-Stern Communication Group	09/11/80	228.00
T. Biss	10/31/80	90.00
<u>Car Rental</u>		
C. Yager	07/28/80	20.26
Unidentified 07/10/80-08/11/80	09/02/80	900.00

(continued next page)

STATE OF ALASKA
DEPARTMENT OF EDUCATION
BERING STRAIT REAA
ADVENTURE-BASED EDUCATION
ANALYSIS OF EXPENDITURES BY PROJECT
For the Fiscal Year Ended June 30, 1981
(Note 1)

<u>Project</u>	<u>Date</u>	<u>Amount</u>
<u>Soapv Smith (cont'd)</u>		
<u>Travel (cont'd)</u>		
<u>Freight</u>		
Wien Goldstreak	07/31/80	\$ 30.00
Wien Goldstreak	08/07/80	30.00
D&G Express	09/02/80	6.00
<u>Total Travel</u>		<u>2,224.26</u>
<u>Purchased Services</u>		
C. Yager	07/29/80	77.35
Blaines Art Frame	07/29/80	107.65
Air Freight - Wien	07/31/80	30.00
Lang Enterprises - Electrical	09/02/80	32.00
Air Freight - Lighting - Wien	10/10/80	392.24
Alaska Stagecraft Lighting Rental	11/30/80	1,075.97
<u>Total Purchased Services</u>		<u>1,715.21</u>
<u>Other Supplies</u>		
Blaines Art Frame	07/29/80	50.00
Caroles Custom Shop	07/29/80	125.00
Stagecraft Industries	08/14/80	185.00
Ekvall-Stern Communication Group - Supplies	09/11/80	244.42
<u>Total Other Supplies</u>		<u>604.42</u>
<u>Equipment</u>		
Pictures	08/01/80	1,004.47
<u>Total Equipment</u>		<u>1,004.47</u>
<u>Total Soapv Smith</u>		<u>25,398.36</u>
<u>Musical</u>		
<u>Consultant Fees</u>		
J. Ingalls	07/01/80	281.00
J. Ingalls	07/14/80	281.00
J. Ingalls	07/26/80	563.00
P. Fisher	07/01/80	281.00
P. Fisher	07/14/80	281.00
P. Fisher	07/26/80	1,413.00
B. Roderick	07/01/80	281.00
B. Roderick	07/01/80	844.00
T. Tibbett	07/01/80	281.00
T. Tibbett	07/14/80	281.00
T. Tibbett	07/26/80	563.00
M. Bean	07/15/80	100.00
J. Chief, Jr.	07/15/80	100.00
Reimburse Payment to Dancers - J. Ingalls	07/26/80	360.00
<u>Total Consultant Fees</u>		<u>5,910.00</u>
<u>Communications</u>		
Telephone Bill - Legislative Affairs	09/02/80	73.75
<u>Total Communications</u>		<u>73.75</u>

(continued next page)

STATE OF ALASKA
DEPARTMENT OF EDUCATION
SERING STRAIT REAA
ADVENTURE-BASED EDUCATION
ANALYSIS OF EXPENDITURES BY PROJECT
For the Fiscal Year Ended June 30, 1981
(Note 1)

<u>Project</u>	<u>Date</u>	<u>Amount</u>
<u>Musical (cont'd)</u>		
<u>Travel</u>		
<u>Airfare</u>		
Wien - four passengers	07/01/80	\$ 444.00
T. Tibbett	07/02/80	394.00
B. Roderick	09/10/80	283.00
T. Tibbett	07/26/80	241.00
J. Ingalls	10/10/80	241.00
P. Fisher	10/10/80	241.00
C. Basler	10/10/80	114.00
Journal Entry	08/31/80	241.00
<u>Per Diem</u>		
T. Tibbett	07/02/80	104.00
Migration Music - T. Tibbett	07/14/80	262.50
B. Roderick	07/14/80	262.50
Crackling Goose Productions	07/14/80	262.50
J. Ingalls	07/14/80	262.50
B. Roderick	07/26/80	262.50
Crackling Goose Productions - P. Fisher	07/26/80	262.50
J. Ingalls	07/26/80	262.50
T. Tibbett	07/26/80	262.50
<u>Total Travel</u>		<u>4,403.00</u>
<u>Purchased Services</u>		
Airfreight - Bagpipes	07/09/80	21.50
Airfreight - Camera	07/09/80	20.75
Airfreight - Bagpipes	07/11/80	106.23
Airfreight - Various	07/14/80	115.91
D&E Express	07/24/80	6.00
Wien	08/27/80	20.00
Swansons	08/14/80	857.98
Tundra Drums	08/14/80	44.00
Art Supply	08/14/80	76.06
Tundra Drums	09/11/80	102.00
Airfreight	10/15/80	15.50
Airfreight	10/15/80	50.95
D&E Express	10/15/80	6.00
Swansons - Equipment	11/30/80	765.71
Miscellaneous Freight Charges JE2-6	02/27/81	356.25
Check #151 - Not Paid		(44.00)
<u>Total Purchased Services</u>		<u>2,528.89</u>
<u>Teaching Supplies</u>		
Art Supplies	09/11/80	57.80
<u>Total Teaching Supplies</u>		<u>57.80</u>
<u>Office Supplies</u>		
Legislative Information - Xerox Copies	09/02/80	14.90
<u>Total Office Supplies</u>		<u>14.90</u>

STATE OF ALASKA
 DEPARTMENT OF EDUCATION
 BERING STRAIT REAA
 ADVENTURE-BASED EDUCATION
 ANALYSIS OF EXPENDITURES BY PROJECT
 For the Fiscal Year Ended June 30, 1981
 (Note 1)

<u>Project</u>	<u>Date</u>	<u>Amount</u>
<u>Musical (cont'd)</u>		
<u>Equipment</u>		
Olympus OM3 Camera	07/02/80	\$ 444.80
Unidentified	07/15/80	62.50
<u>Total Equipment</u>		<u>507.30</u>
<u>Total Musical</u>		<u>13,495.72</u>
<u>Juneau</u>		
<u>Consultant Fees</u>		
C. Thoma	08/07/80	2,400.00
C. Thoma	09/09/80	3,600.00
C. Thoma	09/18/80	3,000.00
C. Thoma	09/22/80	3,000.00
<u>Total Consultant Fees</u>		<u>12,000.00</u>
<u>Travel</u>		
R. Sievenpiper	10/10/80	127.00
<u>Total Travel</u>		<u>127.00</u>
<u>Purchased Services</u>		
Micro Bottles	08/04/80	35.00
Freight on Bottles	10/21/80	23.00
Boat Rental - Grizzly Bear Tours	08/15/80	1,750.00
Boat Rental - Grizzly Bear Tours	09/09/80	1,750.00
Boat Rental - Grizzly Bear Tours	09/17/80	3,500.00
Boat Rental - Grizzly Bear Tours	10/22/80	2,880.20
<u>Total Purchased Services</u>		<u>9,938.20</u>
<u>Food</u>		
Mark N' Pack	09/12/80	979.82
Mark N' Pack	11/30/80	2,614.10
<u>Total Food</u>		<u>3,593.92</u>
<u>Equipment</u>		
C. Thoma - Advance on Equipment	08/07/80	500.00
Chandler Suggat Sports	09/12/80	420.56
Dorchas Water & Sewer Supply Company	09/12/80	1,004.51
Sunshine Sports	09/12/80	2,067.40
Home Reconditioning - Spray Covers	11/30/80	593.40
Juneau Surplus Div. Equip.	11/30/80	451.05
B&A Distributing Company	11/30/80	1,493.45
Ace Hardware	11/30/80	164.11
<u>Total Equipment</u>		<u>6,694.48</u>
<u>Total Juneau</u>		<u>32,352.60</u>

9

(continued next page)

STATE OF ALASKA
DEPARTMENT OF EDUCATION
SERING STRAIT REA
ADVENTURE-BASED EDUCATION
ANALYSIS OF EXPENDITURES BY PROJECT
For the Fiscal Year ended June 30, 1981
(Note 1)

<u>Project</u>	<u>Date</u>	<u>Amount</u>
<u>Anchorage</u>		
<u>Consultant Fees</u>		
Kastan School of Music	08/11/80	\$ 4,800.00
Kastan School of Music	09/11/80	3,200.00
Kastan School of Music	10/13/80	3,800.00
Kastan School of Music	11/30/80	3,600.00
Kastan School of Music	12/19/80	3,400.00
<u>Total Consultant Fees</u>		<u>24,000.00</u>
<u>Total Anchorage</u>		<u>24,000.00</u>
<u>European Trip</u>		
<u>Consultant Fees</u>		
C. Yager	09/11/80	350.00
C. Yager	11/01/80	1,800.00
D. Maddox	07/31/80	5,000.00
D. Maddox	09/17/80	2,733.00
D. Maddox	09/17/80	2,100.00
Pd. to T. Miller for Wire Advance to Maddox	08/14/80	1,000.00
Cackling Goose Productions	08/18/80	1,000.00
Cackling Goose Productions	08/30/80	2,000.00
Cackling Goose Productions	09/14/80	3,000.00
Cackling Goose Productions	09/22/80	1,000.00
C. Collins	11/01/80	600.00
C. Collins	05/18/81	150.00
P. Dean	11/01/80	600.00
P. Dean	05/18/81	150.00
R. Richardson - Payment to Legislative Affairs for Ruth Richardson Salary 09/26/80-10/31/80	12/19/80	4,435.85
Refund Miller (Ref. Check No. 155)		(975.00)
<u>Total Consultant Fees</u>		<u>24,943.85</u>
<u>Travel</u>		
Anchorage Hotel - European Travelers	11/30/80	925.58
Allways Travel - Bus Charter	11/30/80	520.00
Allways Travel - Airline Tickets	09/09/80	14,248.00
Wien - D. Maddox	09/08/80	114.00
D. Maddox - Airfare - Liverpool	09/17/80	542.00
Allways Travel - Airline Tickets	09/18/80	5,125.00
Goldstreak - Alaska Airlines	09/22/80	23.00
British Airways - C. Basler	09/25/80	533.00
Goldstreak - Alaska Airlines	09/18/80	46.00
Allways Travel	10/15/80	25.00
Wien Air Freight, Bethel - Liverpool		
Journal Entry	06/30/81	1,587.42
Wien - Excess Baggage Charge	11/01/80	105.00
J. Barber - Passport Photos	09/02/80	290.00
Legislative Affairs - Maddox Ticket to London and Return	08/13/80	1,153.00
H. Thomas - Travel Advance	10/07/80	2,500.00
H. Thomas	10/09/80	398.78
Travel Expenses Paid Out of Barclay's Bank Account (\$42,500 Deposited and \$6,806.78 Returned).		35,693.22
Check Not Clearing Bank 1/95		(25.00)
Cackling Goose Per Diem	08/18/80	350.00
Cackling Goose Per Diem	08/30/80	175.00
Cackling Goose Per Diem	09/14/80	525.00
<u>Total Travel</u>		<u>64,354.00</u>

(continued next page)

STATE OF ALASKA
DEPARTMENT OF EDUCATION
BERING STRAIT REAA
ADVENTURE-BASED EDUCATION
ANALYSIS OF EXPENDITURES BY PROJECT
For the fiscal year ended June 30, 1981
(Note 1)

<u>Project</u>	<u>Date</u>	<u>Amount</u>
<u>European Trip (cont'd)</u>		
<u>Various Vendors</u>		
Alaska Stagecraft - Lights Rental	10/31/80	\$ 375.00
<u>Total Various Vendors</u>		<u>375.00</u>
<u>Teaching Supplies</u>		
Swansons - Tour Boxes	09/11/80	550.33
C. Yager - Materials	09/11/80	11.62
Cackling Goose Productions - Equipment	10/22/80	62.99
Alaskan School Supplies	10/01/80	127.75
<u>Total Teaching Supplies</u>		<u>753.19</u>
<u>Total European Trip</u>		<u>90,926.04</u>
<u>Ski Trip</u>		
<u>Consultant Fees</u>		
Consultant Fees	02/17/81	500.00
<u>Total Consultant Fees</u>		<u>500.00</u>
<u>Travel</u>		
Various Vendors	02/17/81	2,739.37
Alaska Airlines	04/09/81	2,840.50
National Car Rental	04/09/81	175.53
Gene's Auto	03/05/81	204.72
Alaska Railroad	08/17/81	349.75
Bering Air	03/13/81	1,340.00
<u>Total Travel</u>		<u>7,649.87</u>
<u>Purchased Services</u>		
Various Vendors	02/17/81	405.00
<u>Total Purchased Services</u>		<u>405.00</u>
<u>Teaching Supplies</u>		
Detail Available	02/17/81	222.63
<u>Total Teaching Supplies</u>		<u>222.63</u>
<u>Equipment</u>		
Detail Available	02/17/81	2,150.00
<u>Total Equipment</u>		<u>2,150.00</u>
<u>Total Ski Trip</u>		<u>10,927.50</u>
<u>Total Adventure-Based Education</u>		<u>\$228,652.25</u>

STATE OF ALASKA
DEPARTMENT OF EDUCATION
BERING STRAIT REAA
ADVENTURE-BASED EDUCATION
NOTES TO ANALYSIS OF EXPENDITURES BY PROJECT
For the Fiscal Year Ended June 30, 1981

Note 1 - Expenditures

This schedule includes all expenditures made to date in connection with Fiscal Year 1981 adventure-based education projects financed and directed by the Bering Strait REAA. In connection with the projects, the REAA paid some of the expenditures directly. In other instances, monies were disbursed to a temporary organization established by the REAA which paid for expenditures from a separate checking account. The disbursements to the temporary organization are not included herein, but the checks issued by the organization for expenditures are included.

Note 2 - Additional Compensation - Christian Basler

The contract between Christian Basler and the Bering Strait REAA called for the payment of \$13,000 at the rate of \$2,000 per month for the period June 15, 1980, through December 31, 1980. Any additional compensation required a written agreement. Mr. Basler submitted a claim for an additional 82 hours work performed between January 13, 1981, and June 26, 1981, at the rate of \$40 per hour. No written agreement was in evidence.

JAY S. HAMMOND
GOVERNOR

DEPARTMENT OF EDUCATION

OFFICE OF THE COMMISSIONER

POUCH F
STATE OFFICE BUILDING
JUNEAU, ALASKA 99811
PHONE:

January 5, 1982

RECEIVED
JAN 07 1982

LEGISLATIVE
AUDIT

Gerald L. Wilkerson, CPA
Legislative Auditor
Division of Legislative Audit
Alaska Office Building
Pouch W
Juneau, Alaska 99811

Dear Mr. Wilkerson:

We have reviewed the Preliminary Audit reports on:

A Special Review of the Department of Education/Bering Strait REAA Adventure Based Education Program for the Fiscal Year ended June 30, 1981.

A Letter Report of the Department of Education, Northwest Arctic REAA, November 6, 1981.

The Special Review had one recommendation: "The Department of Education should establish a firm date when the \$300,000 encumbrance for Adventure Based Education will lapse." The Department of Education agrees with this finding.

Attached is a copy of a letter sent to the superintendent of the Bering Strait REAA notifying that district of our intention to lapse the encumbrance as of February 4.

The district was also notified that any request for reimbursement of funds expended must contain the information concerning program activities and participants required by the Attorney General's Opinion of September 29, 1980.

Any reimbursement requests meeting these criteria and received prior to February 4, 1982 will be honored; unexpended portions of the authorization will lapse on February 4, 1982.

Gerald L. Wilkerson

-2-

January 5, 1982

The Letter Report on the Northwest Arctic School District has been reviewed. There are no recommendations contained in the Letter Report; therefore, no action is contemplated by the department.

Sincerely,

Marshall L. Lind
Marshall L. Lind *RLD*
Commissioner

January 4, 1982

Ron Hekman, Superintendent
Bering Strait Schools
Box 1088
Nome, Alaska 99762

Dear Mr. Hekman:

On December 21, this department received the preliminary draft of the Legislative Audit report on a Special Review of the Department of Education/Bering Strait RMA Adventure Based Education Program. A copy of the report is enclosed.

The report recommends that the "Department of Education should establish a firm date when the \$200,000 encumbrance for Adventure Based Education will lapse." In order to establish that date, I am requesting that your district forward additional documentation on the ABE projects administered during the FY 81 fiscal year, in order that we may make a determination as to what, if any, expenditures are eligible for reimbursement under the Adventure Based Education appropriation.

In supplying the documentation, I refer you to the Attorney General's letter to me of September 29, 1980, and to my letter to you of June 23, 1981. Both of these documents clearly outline the kinds of detail concerning programs and participants that we will need to make our determination.

As you recall, we notified you on June 2, 1981, that the backup information which you have furnished does not meet the requirements of the statute. Therefore, if you do not have, or wish to submit, further information, the encumbrance will lapse on February 4, 1982.

Sincerely,

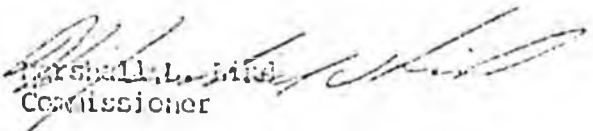
Marshall L. Jirik
Commissioner

PLEASE NOTE: THE FOLLOWING PAGES WERE TREATED
AS A UNIT IN THE ORIGINAL DOCUMENT

STATE OF ALASKA

A SPECIAL REPORT ON
THE DEPARTMENT OF EDUCATION
BERING STRAIT SCHOOL DISTRICT

July 1, 1980 - December 31, 1982

Audit Control Number



DIVISION OF LEGISLATIVE AUDIT
Juneau, Alaska

A SPECIAL REPORT ON
THE DEPARTMENT OF EDUCATION
BERING STRAIT SCHOOL DISTRICT

July 1, 1980 - December 31, 1982

Audit Control Number

05-4159-83-S

Commissioner, Department of
Education

Marshall L. Lind

Deputy Commissioner, Department
of Education

Robert Van Slyke

STATE OF ALASKA

AUDIT DIVISION
POUCH W
JUNEAU, ALASKA 99811

THE LEGISLATURE

BUDGET AND AUDIT COMMITTEE

March 25, 1983

Members of the
Legislative Budget and Audit Committee:

In accordance with the provisions of Title 24 of the Alaska Statutes, the attached report is submitted for your review.

A SPECIAL REPORT ON
THE DEPARTMENT OF EDUCATION
BERING STRAIT SCHOOL DISTRICT

July 1, 1980 - December 31, 1982



Gerald L. Wilkerson, CPA
Legislative Auditor
Division of Legislative Audit.

TABLE OF CONTENTS

	<u>Page</u>
Purpose of the Report.	1
Organization and Function.	3
Schedules:	
Summary of Salary and Other Benefits	5
Notes to the Summary of Salary and Other Benefits.	9
Summary of District Travel	11
Schedule of Board Travel	13
Schedule of Superintendent's Travel.	15
Notes to the Schedule of Superintendent's Travel	23
Schedule of Deputy Superintendent's Travel	25
Notes to the Schedule of Deputy Superintendent's Travel	29
Schedule of Travel - Other Key Personnel	31
Response:	
Pering Strait School District.	39

PURPOSE OF THE REPORT

In accordance with a Legislative Budget and Audit Committee request and Title 24 of the Alaska Statutes, this special report has been prepared to document the salaries, benefits and travel expenses of key personnel of the Bering Strait School District.

(Intentionally left blank)

ORGANIZATION AND FUNCTION

Alaska Statute 14.08 provides for public education in unorganized boroughs of the State to be administered by the regional school boards of each regional educational attendance area (also commonly referred to as school districts).

Title 14 also provides that, under the general supervision of the Department of Education, a regional educational attendance area shall be operated on an area-wide basis under the management and control of a regional school board. Powers vested with regional school boards include determining its own fiscal procedures; employing a chief school administrator; approving the employment of the professional administrators, teachers and noncertified personnel necessary to operate its schools; and establishing the salaries to be paid its employees.

(Intentionally left blank)

STATE OF ALASKA
DEPARTMENT OF EDUCATION
BERING STRAIT SCHOOL DISTRICT
SUMMARY OF SALARY AND OTHER BENEFITS
For the Fiscal Years 1983, 1982, 1981

Position	Fiscal Year		
	1982/83	1981/82	1980/81
<u>Superintendent</u>			
Salary (Note 1)	\$77,500	\$77,500	\$55,000
Annual/Sick Leave (days per year)	36/16	36/16	36/16
Health Insurance	Full Family Coverage	Full Family Coverage	Full Family Coverage
Life Insurance (Note 2)	Employee	Employee	Employee
Private Vehicle	\$250/mo. + Expenses + Insurance	\$250/mo. + Expenses + Insurance	\$250/mo. + Expenses + Insurance
Private Aircraft	\$75/hr. + Expenses	\$75/hr. + Expenses	\$75/hr. + Expenses
Rent Subsidy (Note 3)	\$230/mo.	\$230/mo.	\$230/mo.
Transportation	Actual	Actual	Actual
Lodging	(Note 4)	Actual	Actual
Food Allowance	(Note 4)	Actual	Actual
Entertainment	(Note 4)	Subject to Board Approval	Subject to Board Approval
Per Diem (Note 4)	\$115/day	_____	_____
Other Benefits	(Note 5)	(Note 5)	_____
<u>Deputy Superintendent</u>			
Salary	\$66,245	\$66,245	\$59,950
Annual/Sick Leave (days per year)	36/16	36/16	36/16
Health Insurance	Full Family Coverage	Full Family Coverage	Full Family Coverage
Life Insurance (Note 2)	Employee	Employee	Employee
Private Vehicle	\$300/mo. + Insurance	\$300/mo. + Insurance	\$250/mo.
Rent Subsidy (Note 3)	\$480/mo.	\$580/mo. ('81) \$480/mo. ('82)	\$450/mo. ('80) \$580/mo. ('81)
Transportation	Actual	Actual	Actual
Lodging	Actual	Actual	Actual
Food Allowance	\$30/day	\$30/day	\$30/day
Entertainment	Sup't. Prior Approval	Sup't. Prior Approval	Sup't. Prior Approval

STATE OF ALASKA
DEPARTMENT OF EDUCATION
BERING STRAIT SCHOOL DISTRICT
SUMMARY OF SALARY AND OTHER BENEFITS
For the Fiscal Years 1983, 1982, 1981

Position	Fiscal Year		
	1982/83	1981/82	1980/81
<u>Assistant Superintendent of Vocational Education</u>			
Salary	\$59,400	\$55,000	\$48,720
Annual/Sick Leave (days per year)	30/16	30/16	30/16
Health Insurance	Full Family Coverage	Full Family Coverage	Full Family Coverage
Life Insurance (Note 2)	Employee	Employee	Employee
Rent Subsidy (Note 3)	\$380/mo.	\$455/mo. ('81) \$380/mo. ('82)	\$455/mo.
Transportation	Actual	Actual	Actual
Lodging	Actual	Actual	Actual
Food Allowance	\$30/day	\$30/day	\$30/day
Entertainment	Sup't. Prior Approval	Sup't. Prior Approval	Sup't. Prior Approval
<u>Assistant Superintendent of Curriculum</u>			
Salary	\$56,160	\$52,000	\$43,260
Annual/Sick Leave (days per year)	30/16	24/16	5/16
Health Insurance	Full Family Coverage	Full Family Coverage	Full Family Coverage
Life Insurance (Note 2)	Employee	Employee	Employee
Rent Subsidy (Note 3)	\$380/mo.	\$215/mo. ('81) \$380/mo. ('82)	\$215/mo.
Transportation	Actual	Actual	Actual
Lodging	Actual	Actual	Actual
Food Allowance	\$30/day	\$30/day	\$30/day
Entertainment	Sup't. Prior Approval	Sup't. Prior Approval	Sup't. Prior Approval
<u>Business Manager</u>			
Salary	\$57,500	\$47,000	\$47,000
Annual/Sick Leave (days per year)	30/16	24/16	24/16
Health Insurance	Full Family Coverage	Full Family Coverage	Full Family Coverage

STATE OF ALASKA
DEPARTMENT OF EDUCATION
BERING STRAIT SCHOOL DISTRICT
SUMMARY OF SALARY AND OTHER BENEFITS
For the Fiscal Years 1983, 1982, 1981

Position	Fiscal Year		
	1982/83	1981/82	1980/81
<u>Business Manager (cont'd)</u>			
Life Insurance (Note 2)	Employee	Employee	Employee
Private Vehicle	\$300/mo.	_____	\$150/mo.
Rent Subsidy (Note 3)	\$480/mo.	\$215/mo. ('81) \$480/mo. ('82)	\$215/mo.
Transportation	Actual	Actual	Actual
Lodging	Actual	Actual	Actual
Food Allowance	\$30/day	\$30/day	\$30/day
Entertainment	Sup't. Prior Approval	Sup't. Prior Approval	Sup't. Prior Approval
<u>Director of Administration</u>			
Salary	\$54,006	_____	_____
Annual/Sick Leave (days per year)	24/16	_____	_____
Health Insurance	Full Family Coverage	_____	_____
Life Insurance (Note 2)	Employee	_____	_____
Rent Subsidy (Note 3)	\$480/mo.	_____	_____
Transportation	Actual	_____	_____
Lodging	Actual	_____	_____
Food Allowance	\$30/day	_____	_____
<u>Director of Curriculum and Instruction</u>			
Salary	\$50,623	_____	_____
Annual/Sick Leave (days per year)	24/16	_____	_____
Health Insurance	Full Family Coverage	_____	_____
Life Insurance (Note 2)	Employee	_____	_____
Rent Subsidy (Note 3)	\$480/mo.	_____	_____
Transportation	Actual	_____	_____
Lodging	Actual	_____	_____
Food Allowance	\$30/day	_____	_____

STATE OF ALASKA
DEPARTMENT OF EDUCATION
BERING STRAIT SCHOOL DISTRICT
SUMMARY OF SALARY AND OTHER BENEFITS
For the Fiscal Years 1983, 1982, 1981

<u>Position</u>	<u>Fiscal Year</u>		
	<u>1982/83</u>	<u>1981/82</u>	<u>1980/81</u>
<u>Director of Bilingual-Bicultural Education</u>			
Salary (10 months)	\$47,115	\$43,625	\$43,260
Annual/Sick Leave (days per year)	5/13	5/13	5/15
Health Insurance	Full Family Coverage	Full Family Coverage	Full Family Coverage
Life Insurance (Note 2)	Employee	Employee	Employee
Transportation	Actual	Actual	Actual
Lodging	Actual	Actual	Actual
Food Allowance	\$30/day	\$30/day	\$30/day
<u>Director of Special Education</u>			
Salary (10 months)	\$44,786	\$49,658	\$44,940
Annual/Sick Leave (days per year)	5/13	5/13	5/15
Health Insurance	Full Family Coverage	Full Family Coverage	Full Family Coverage
Life Insurance (Note 2)	Employee	Employee	Employee
Transportation	Actual	Actual	Actual
Lodging	Actual	Actual	Actual
Food Allowance	\$30/day	\$30/day	\$30/day
<u>Director of Transportation</u>			
Salary (10 months)	\$42,697	_____	_____
Annual/Sick Leave (days per year)	5/13	_____	_____
Health Insurance	Full Family Coverage	_____	_____
Life Insurance (Note 2)	Employee	_____	_____
Rent Subsidy (Note 3)	\$380/mo.	_____	_____
Transportation	Actual	_____	_____
Lodging	Actual	_____	_____
Food Allowance	\$30/day	_____	_____

STATE OF ALASKA
DEPARTMENT OF EDUCATION
BERING STRAIT SCHOOL DISTRICT
NOTES TO SUMMARY OF SALARY AND OTHER BENEFITS
For the Fiscal Years 1983, 1982, 1981

Note 1 - Superintendent's Salary

The Superintendent's 1980/81 contract provided for an annual salary of \$55,000. However, actual salary paid to the Superintendent totaled \$35,300 as a result of the school board authorizing leave without pay while he was lobbying for the Bering Strait, Northwest Arctic, and Yukon Koyukuk School Districts. The lobbying agreement between the districts and the Alaska Association of Schools Alliance, Inc., Ron Honman, Executive Director, required each district to pay the Corporation \$25,000 a year for the 1980, 1981 and 1982 legislative sessions.

The Superintendent's current contract, entered on September 24, 1981, provides for an annual salary of \$77,500. During Fiscal Year 1981/82, the Superintendent was actually paid \$70,400 in salary plus the Corporation's compensation provided for in the lobbying agreement from two districts. According to the Superintendent, the Northwest Arctic School District did not pay the 1982 contract amount.

Note 2 - Life Insurance

The District provides life insurance coverage valued at the employee's annual salary.

Note 3 - Rent Subsidy

The employees are assessed \$270 per month and the District pays their housing costs. The rent subsidy was calculated by subtracting the \$270 from the estimated monthly value of the housing. The estimated value was provided by the District Business Manager.

Note 4 - Superintendent's Travel Expenses

During Fiscal Years 1980/81 and 1981/82, the Superintendent was reimbursed for actual costs of lodging, food and entertainment. During Fiscal Year 1982/83, the Superintendent receives \$115 per day as per diem while on travel status and is no longer paid actual costs of lodging, food, and entertainment.

Note 5 - Superintendent's Other Benefits

On September 24, 1981, the Superintendent's contract was renegotiated for another three year period. In addition to the salary and benefits listed in the preceding Summary of Salary and Other Benefits, the new contract covering Fiscal Years 1981/82 through 1983/84 provides for the following:

A. Membership - Full reimbursement for memberships in the American Association of School Administrators, the Alaska Association of School Administrators and other memberships which the Superintendent feels are necessary to maintain his professional skills.

~~Attendance at Seminars, Programs, Courses~~ - The District shall permit the Superintendent a reasonable amount of release time ~~as he deems appropriate~~ to attend programs, seminars and courses which will lead to professional growth. The district will pay the necessary travel and subsistence expenses as approved by the District in its annual budget.

~~Service as a Consultant~~ - The Superintendent may serve as a consultant to other districts and educational agencies, and engage in other activities of short-term duration at his discretion. Board approval is required for all activities which require absence in excess of five days. The Superintendent, with board approval, can continue to draw salary and benefits while engaged in these activities.

D. Payment of Retirement Arrearages - The District agrees to pay 2½ years of arrearages to the Teachers' Retirement System for experience of the Superintendent between 1965 and 1967.

~~Sabbatical Year~~ - The District shall grant a one year Sabbatical (Fiscal Year 1983/84) with all regular compensation and benefits. The District may require quarterly reports from the Superintendent regarding academic/program advancement.

F. Spouse's Travel - The District will pay the costs for the Superintendent's spouse for travel to a professional or District board meeting.

~~Contract Renewal~~ - If the District does not notify the Superintendent in writing before December 31, that the contract will not be renewed, it shall be deemed that the District has renewed the contract for one year extending from the termination date of the contract.

STATE OF ALASKA
DEPARTMENT OF EDUCATION
BERING STRAIT SCHOOL DISTRICT
SUMMARY OF DISTRICT TRAVEL - KEY PERSONNEL
Fiscal Years 1981, 1982, 1983 (through 12/31/82)

<u>Position</u>	<u>Total In-District Travel</u>	<u>Total Out- Of-District Travel</u>	<u>Total Travel</u>
<u>1980/81</u>			
Board Members	\$82,682.69	\$ 56,366.82	\$139,049.51
Superintendent	1,599.72	27,460.25	29,059.97
Deputy Superintendent	794.38	12,372.44	13,166.82
Assistant Superintendent - Vocational Education	2,603.85	8,850.58	11,454.43
Assistant Superintendent - Curriculum	3,629.70	4,926.35	8,556.05
Business Manager	1,135.48	6,257.26	7,392.74
Director of Administration	N/A	N/A	N/A
Director of Curriculum and Instruction	N/A	N/A	N/A
Director of Bilingual/ Bicultural Education	932.25	749.72	1,681.97
Director of Special Education	983.95	3,222.67	4,206.62
Director of Transportation	N/A	N/A	N/A
<u>Total 1980/81</u>	<u>\$94,362.02</u>	<u>\$120,206.09</u>	<u>\$214,568.11</u>
<u>1981/82</u>			
Board Members	\$62,287.11	\$ 40,747.47	\$103,034.58
Superintendent	1,138.59	27,679.52	28,818.11
Deputy Superintendent	1,498.28	12,799.74	14,298.02
Assistant Superintendent - Vocational Education	1,657.70	11,104.38	12,762.08
Assistant Superintendent - Curriculum	4,603.54	4,611.62	9,215.16
Business Manager	155.00	6,978.93	7,133.93
Director of Administration	N/A	N/A	N/A
Director of Curriculum and Instruction	N/A	N/A	N/A
Director of Bilingual/ Bicultural Education	102.50	712.82	815.32
Director of Special Education	537.26	784.58	1,321.84
Director of Transportation	N/A	N/A	N/A
<u>Total 1981/82</u>	<u>\$71,979.98</u>	<u>\$105,419.06</u>	<u>\$177,399.04</u>
<u>1982/83 (through 12/31/82)</u>			
Board Members	\$42,395.37	\$ 2,863.00	\$ 45,258.37
Superintendent	4,731.02	14,878.54	19,609.56
Deputy Superintendent	98.18	1,197.67	1,295.85
Assistant Superintendent - Vocational Education	584.00	3,675.70	4,259.70
Assistant Superintendent - Curriculum	1,370.79	2,093.45	3,464.24
Business Manager	581.11	8,445.20	9,026.31
Director of Administration	2,945.46	4,307.72	7,253.18
Director of Curriculum and Instruction	767.42	1,835.30	2,602.72
Director of Bilingual/ Bicultural Education	940.00	1,112.24	2,052.24
Director of Special Education	-0-	749.00	749.00
Director of Transportation	-0-	1,934.08	1,934.08
<u>Total 1982/83</u>	<u>\$54,413.35</u>	<u>\$ 43,091.90</u>	<u>\$ 97,505.25</u>

(Intentionally left blank)

STATE OF ALASKA
DEPARTMENT OF EDUCATION
BERING STRAIT SCHOOL DISTRICT
SCHEDULE OF BOARD TRAVEL
Fiscal Years 1981, 1982, and 1983 (through 12/31/82)

<u>Destination</u>	<u>Purpose of Trip</u>	<u>Airfare</u>	<u>Per Diem</u>	<u>Stipend</u> (Note 1)	<u>Other</u>	<u>Lodging</u>	<u>Total</u>
<u>1980 - 1981</u>							
<u>Out-of-State Travel</u>							
Honolulu, Hawaii (2 Board Members)	Telecommunications Conference	\$ 2,803.45	\$ 480.00	\$ 1,840.00	\$	\$	\$ 5,123.45
Dallas, Texas	NSBA Convention				1,295.00		1,295.00
Washington, D.C. (3 Board Members)	BIA Transfer	4,056.88	990.00	3,795.00	231.46	1,445.90	10,519.24
Minnesota, Montana, Washington (1 Board Member)	Teacher Recruitment	1,528.41	510.00	1,955.00		84.00	4,077.41
<u>Total Out-of-State Travel</u>		<u>8,388.74</u>	<u>1,980.00</u>	<u>7,590.00</u>	<u>1,526.46</u>	<u>1,529.90</u>	<u>21,015.10</u>
<u>Total Out-of-District-In-State Travel</u>		<u>8,850.78</u>	<u>3,750.00</u>	<u>14,030.00</u>	<u>3,574.85</u>	<u>5,146.09</u>	<u>35,351.72</u>
<u>Total In-District Travel</u>		<u>45,132.74</u>	<u>6,960.00</u>	<u>26,335.00</u>	<u>861.71</u>	<u>3,393.24</u>	<u>82,682.69</u>
<u>Total Travel 1980 - 1981</u>		<u>\$62,372.26</u>	<u>\$12,690.00</u>	<u>\$47,955.00</u>	<u>\$5,963.02</u>	<u>\$10,069.23</u>	<u>\$139,049.51</u>
<u>1981 - 1982</u>							
<u>Out-of-State Travel</u>							
Honolulu, Hawaii (3 Board Members)	Telecommunications Conference	\$ 3,533.21	\$ 840.00	\$	\$ 960.00	\$ 1,904.00	\$ 7,237.21
Seattle, Washington (1 Board Member)	Construction Design Meeting	856.09			121.57	493.39	1,471.05
Atlanta, Georgia (5 Board Members)	NSBA Convention	5,056.10			1,200.00		6,256.10
Minnesota, Montana, Washington (1 Board Member)	Teacher Recruitment	1,601.22	510.00	1,955.00			4,066.22
<u>Total Out-of-State Travel</u>		<u>11,046.62</u>	<u>1,350.00</u>	<u>1,955.00</u>	<u>2,281.57</u>	<u>2,397.39</u>	<u>19,030.58</u>
<u>Total Out-of-District-In-State Travel</u>		<u>8,515.75</u>	<u>2,010.00</u>	<u>8,375.00</u>	<u>436.59</u>	<u>2,379.55</u>	<u>21,716.89</u>
<u>Total In-District Travel</u>		<u>30,935.94</u>	<u>5,340.00</u>	<u>20,815.00</u>	<u>2,067.91</u>	<u>3,128.26</u>	<u>62,287.11</u>
<u>Total Travel 1981 - 1982</u>		<u>\$50,498.31</u>	<u>\$8,700.00</u>	<u>\$31,145.00</u>	<u>\$4,786.07</u>	<u>\$ 7,905.20</u>	<u>\$103,034.58</u>
<u>1982 - 1983</u>							
<u>Total Out-of-District-In-State Travel</u>		<u>\$ 340.00</u>	<u>\$</u>	<u>\$ 690.00</u>	<u>\$ 160.00</u>	<u>\$ 1,673.00</u>	<u>\$ 2,863.00</u>
<u>Total In-District Travel</u>		<u>20,813.09</u>		<u>21,045.00</u>	<u>117.92</u>	<u>419.36</u>	<u>42,395.37</u>
<u>Total Travel 1982 - 1983</u> <u>@ 12/31/82</u>		<u>\$21,153.09</u>	<u>\$</u>	<u>\$21,735.00</u>	<u>\$ 277.92</u>	<u>\$ 2,092.36</u>	<u>\$ 45,258.37</u>

Note 1 - Stipend does not include a total of \$53,900 paid to the members of the Executive Committee of the Board in the form of a \$350 per month honorarium. During Fiscal Years 1981, 1982, and 1983, to date, the honorarium amounted to \$19,950; \$19,600; and \$14,350, respectively.

(Intentionally left blank)

BERING STRAIT SCHOOL DISTRICT
 SCHEDULE OF SUPERINTENDENT'S TRAVEL
 FY81, FY82 and FY83 (Through 12/31/82)

Travel Dates	Destination	Purpose of Trip	Voucher Date	Voucher Number	Airfare	Food/Drinks (Note 1)	Lodging	Taxi Auto	Registration	Other	Totals
FY81 Out-of-District Travel (Note 2)											
07/18/80 07/27/80	Anc/Juneau/Anc Juneau/Anc/None	ABE proposal submittal/meet with legislators	08/21/80	43244	\$ 1,169.00	\$196.25	\$ 221.85	\$ 31.25	\$	\$	\$ 1,618.35
07/29/80 08/13/80	Anc/Juneau/Seattle/ Anc/Juneau/None/ UNK/None	DOE Supt-Conference/ UNK facility/Leg. Oversight Comm/Board Mtg.	08/21/80 08/04/80	43242 43010	1,358.04	171.92	169.64 72.00	75.49			1,775.09 72.00
08/21/80 09/02/80	None/Juneau/Seattle/ Portland/Los Angeles/	Meetings re: D.O. Facility Design/Mtg. at Insgroup in IA on policy and staff development/D.O. relocation	09/05/80	43456	1,698.48	485.34	347.65	302.61			2,834.08
09/07/80 10/01/80	None/Juneau/Seattle/ Flint, MI/Wash. DC/ Juneau/None	UNK Facility Meeting/ NASA Resolution Chairman Committee/ABE	10/09/80	43972	1,369.01 (Note 3)	815.67	481.12	340.74			3,006.54
10/07/80 10/26/80	None/Anc/Fairbanks/ Juneau/Anc/None	NASA Conf./AFN Con- vention/ABE	12/17/80	44917	754.00	479.21	847.40	173.99	60.00	4.58	2,319.18
10/27/80	None/Kotzebue		12/02/80	44702	66.11						66.11
10/31/80 11/05/80	None/Anc/Juneau/ None	ABE foreign study program/meet at DOE re: ABE	12/17/80	44918	484.18	238.38	87.98	53.50			864.04
11/08/80 11/26/80	None/Anc/Juneau/ Unalakleet/None	NASB Conv./State Board Mtg./ Cap.Proj./meet w/Don Ericksen	12/18/80	44920	1,227.00	494.71	388.44	90.13		8.61	2,208.69
12/05/80 12/15/80	None/Jacksonville, FL/ Seattle/Anc/None	NASA Workshop/meeting re: UNK Facilities/ D.O. and 5-plex Work Study Program Student Housing	12/17/80	44919	1,629.64 (Note 3)	167.25	174.34	88.85			2,060.08
12/17/80 12/18/80	None/Anc/Seattle/ Juneau		02/26/81	45695	566.32						566.32
01/06/81 01/10/81	Juneau/Anc/None Juneau	Meetings re: FY82 Budget, staffing, life-safety code deficiencies upgrade w/BIA	03/04/81	45823	543.86		38.88	85.37		5.50	673.61
01/18/81 01/21/81	Juneau/Anc/Juneau	Meet w/Board members re: legislation	03/04/81	45823	229.00	254.75	113.50	11.69			608.94
01/28/81 01/31/81	Juneau/Anc/None Juneau	Meet w/State Board & Commissioner re: life- safety code upgrade deficien- cies - BIA	03/04/81	45823	513.86	9.15		213.05			736.06
		Adventure Based Ed.	01/30/81	45439	552.00						552.00
02/06/81 02/17/81	Juneau/Atlanta GA/Juneau	NASA Convention/Resolution Comm. Chairperson	03/04/81	45821	895.30	533.27	631.02	90.74	498.00		2,648.33

STATE OF ALASKA

-15-

DIVISION OF LEGISLATIVE AUDIT

BERING SITAIT SCHOOL DISTRICT
 SCHEDULE OF SUPERINTENDENT'S TRAVEL
 FY81, FY82 and FY83 (Through 12/31/82)

Travel Dates	Destination	Purpose of Trip	Voucher Date	Voucher Number	Airfare	Food/Drinks (Note 1)	Lodging	Taxi Auto	Registration	Other	Totals
FY81 Out-of-District Travel (continued)											
02/24/81 02/27/81	Juneau/Tik./Anc Tik.	Staff Dev. Session at Yukon-Koyukuk/meet with auditor/meet Exec. Com	03/04/81	45822	418.95	219.25	42.00	49.50			729.70
03/04/81 03/05/81	None/Juneau	Meet with legislators/Beltz lawsuit/ABE/Teacher In-Service/Accountability	03/27/81	46103	285.60						285.60
03/18/81 03/20/81	Juneau/UNK/Tik.	Legislative Audit review of travel	03/27/81	46103	254.00						254.00
04/16/81 04/17/81	Juneau/Seattle/Juneau	Meet w/Blackstock re: UNK facility	07/09/81	47162		23.05	30.57	66.23			119.85
05/15/81	Juneau/Anc/Tik./Juneau	FY'82 Budget/Staffing/Organization	07/09/81	47161	508.00		44.28				552.28
05/26/81 05/31/81	Juneau/Anc/Tik./Juneau	Board Meeting at Teller	07/09/81	47161	417.00	10.50		61.85		9.70	499.05
06/03/81 06/04/81	Juneau/Anc/Juneau	Interview mtce. supervisor candidates	07/09/81	47161	286.00						286.00
06/11/81	Juneau/Anc/None/Anc	Interview mtce. supervisor candidate	07/09/81	47161	548.00			34.00			582.00
04/28/81 05/08/81	Juneau/New Orleans/Juneau	MSE Leadership Conference	07/09/81	47163	1,166.53 (Note 3)		296.70	18.92		60.00	1,542.15
Total FY81 Out-of-District Travel					16,939.88	4,098.70	3,987.37	1,787.91	558.00	88.39	27,460.25
Total FY81 In-District Travel					1,589.72		10.00				1,600.72
Total Travel (Note 2)					\$18,529.60	\$4,098.70	\$3,997.37	\$1,787.91	\$558.00	\$88.39	\$29,059.97

STATE OF ALASKA

- 16 -

DIVISION OF LEGISLATIVE AUDIT

REUN: STRAIT SCHOOL DISTRICT
 SCHEDULE OF SUPERINTENDENT'S TRAVEL
 FY81, FY82 and FY83 (Through 12/31/82)

Travel Dates	Destination	Purpose of Trip	Voucher Date	Voucher Number	Airfare	Food/Drinks (Note 1)	Lodging	Taxi Auto	Registration	Other	Totals
FY82 Out-of-District Travel (Note 2)											
07/11/81	Juneau/Juneau	Meet legislators & Gov re: CIP & Oper. Approp.	08/24/81	47355	\$ 274.00	\$	\$	\$	\$	\$	\$ 274.00
07/19/81 07/20/81	Juneau/Seattle/Juneau	House trailers for Brevig teachers/interview Bob Collins	08/24/81	47555	357.56	31.43	30.57	24.33			443.89
07/24/81 07/25/81	Juneau/Anch/Juneau	Meet w/attorney re: UNK Native Corp. agreement	08/24/81	47555	286.00	167.85	51.09	42.67			547.61
08/03/81 08/07/81	Juneau/Los Angeles/Seattle/Juneau	DOE Fupt. Orientation In-Servi e/Brevig teacher housing/meet B. Monroe re: policy revisions & communications	08/24/81	47555	510.18	161.95	232.63	281.83		65.72	1,252.31
08/11/81	Juneau/Anch/Juneau	Re: Foundation Adj.	09/24/81	47970	274.00	29.60					303.60
08/12/81 08/15/81	Juneau/Anch/Juneau	Meet w/attorney/BIA Closure	09/24/81	47970	349.00	106.19	189.67	95.16			820.02
08/22/81 09/01/81	Juneau/Anch/Juneau	Committee Meetings UNK	09/24/81	47970	274.00	169.02					443.02
09/09/81 09/19/81	Juneau/Anch/Juneau/Juneau	Meet w/attorney/State Board Meeting	09/24/81	47970	450.00	132.71	92.88			93.86	769.45
09/25/81 09/26/81	Juneau/Anch/Juneau	Review of ABE/meet w/Cymm. re: Beltz lawsuit & E.A. closures & Jr. High Program	11/02/81	48604	443.00	10.10	51.84	67.87			580.81
10/07/81 10/10/81	Juneau/Skagway/Juneau	ANCA Conference	09/15/81 11/02/81 11/24/81 11/05/81	47073 48604 48804 40580		28.41	200.00 63.31	28.80		243.90	200.00 243.90
10/17/81 10/27/81	Juneau/Juneau/Seattle/Juneau/Juneau	Attend bond closing D.O. UNK bldg./meet w/Auditor	11/05/81	48605	923.68	204.13	340.00	334.31		25.62	1,827.74
11/01/81 11/04/81	Juneau/Juneau/Juneau	Meeting re: design-build concept for Shis. & Mt. Mun.	01/13/82	49475	592.00		42.28				634.28
11/06/81 11/12/81	Juneau/Anch/Juneau/North Anch/Juneau/Juneau	"05" reqs & waiver letters to DOE/meeting at NW Res Lab re: computers	11/24/81	48804	904.66	13.92	53.00	167.27	110.00		1,328.85
11/24/81	Juneau/Anch/Juneau	Meet w/auditor/Facility Committee re: Shis & Mt. Mun.	01/23/82 01/06/82	49475 50445	279.00	274.23		79.76			353.99 279.00

STATE OF ALASKA

- 17 -

DIVISION OF LEGISLATIVE AUDIT

BERING STRAIT SCHOOL DISTRICT
 SCHEDULE OF SUPERINTENDENT'S TRAVEL
 FY81, FY82 and FY83 (Through 12/31/82)

Travel Dates	Destination	Purpose of Trip	Voucher Date	Voucher Number	Airfare	Food/Drinks (Note 1)	Lodging	Taxi Auto	Registration	Other	Totals
FY82 Out-of-District Travel (continued)											
01/14/82	Nome/Anc/Juneau	Meet with Dist. auditor re:	04/06/82	50445	279.00						279.00
01/15/82		Business Operations	05/26/82	51262		23.25					23.25
01/15/82	Juneau/Honolulu/Juneau	Pacific Telecommunications	05/27/82	51249	1,755.52	346.83	1,108.35	357.08	102.00	92.18	3,761.96
01/26/82	(Includes spouse travel)	Conference	03/01/82	50012					320.00		320.00
02/06/82	Juneau/Anc/Juneau	Interview & meet w/Dist.Aud.	05/26/82	51262	296.00						296.00
02/08/82	Anchorage/ANK	Board Meeting in ANK	04/06/82	50445	140.00						140.00
02/10/82	Nome/Anc	Screen Bus.Mjr. applications	04/06/82	50445	170.00	5.25	112.93				288.18
02/12/82	Anc/Juneau	MSA Juneau Fly-In	12/10/81	49090		20.00					20.00
			04/06/82	50445	148.00	42.17					190.17
			05/04/82	50859					210.00		210.00
02/16/82	Juneau/Anc/Anch	Meetings	04/06/82	50445	293.00						293.00
02/19/82	Nome/Anc/Juneau	Meet with Dist. auditor	04/06/82	50445	293.00						293.00
02/20/82											
02/21/82	Juneau/New Orleans/	MSA Convention	02/05/82	49771	794.48						794.48
03/03/82	Juneau		12/01/81	48955					581.00		581.00
			04/06/82	50445		534.45	390.00	77.00		34.00	1,035.45
			05/01/82	50753			185.00				185.00
03/04/82	Juneau/Anc/Juneau	Interviews at Job Fair/	04/06/82	50445	296.00						296.00
03/06/82		Bus.Mjr. applicants					125.51				421.51
03/13/82	Juneau/Anc/Anch/	Applicant Interview -	05/26/82	51262	309.50	172.55	103.20	17.50			602.25
03/18/82	Anch/Juneau	Sam Twardak	04/06/82	50445			81.99				81.99
04/01/82	Juneau/Anc/Anch	ANC/PWC Meeting	05/26/82	51262	293.00						293.00
04/05/82	Nome/Anc	Interview Bus.Mjr. applicant	05/26/82	51262	170.00		48.00				218.00
04/13/82	Nome/Atlanta, GA/	NSSE Convention	11/22/82	53740	495.44	64.58	123.48	86.66		55.14	825.30
04/16/82	Juneau		06/17/82	51408					240.00		240.00
05/10/82	Nome/Atlantic City/	MSA Leadership	05/26/82	51240	270.64	205.44	291.86	53.17			821.11
05/18/82	Seattle/Juneau	Conference			(Note 3)						

STATE OF ALASKA

- 18 -

DIVISION OF LEGISLATIVE AUDIT

BERING STRAIT SCHOOL DISTRICT
 SCHEDULE OF SUPERINTENDENT'S TRAVEL
 FY81, FY82 and FY83 (Through 12/31/82)

STATE OF ALASKA

- 14 -

DIVISION OF LEGISLATIVE AUDIT

<u>Travel Dates</u>	<u>Destination</u>	<u>Purpose of Trip</u>	<u>Voucher Date</u>	<u>Voucher Number</u>	<u>Airfare</u>	<u>Food/Drinks</u> (Note 1)	<u>Lodging</u>	<u>Taxi Auto</u>	<u>Registration</u>	<u>Other</u>	<u>Totals</u>
FY82 Out-of-District Travel (continued)											
05/18/82 05/20/82	Juneau/UNK/Juneau	AEC/PAC Workshop/Board Mtg Stebbins, St. Michael, UNK	11/22/82	53740		69.39	59.40	10.00			138.79
06/03/82 06/14/82	UNK/Anc/Juneau/ Juneau/UNK	Meet with Governors Transition task force/and code deficiencies - BIA Bldgs.	11/22/82	53740	293.00	515.00	635.00				1,443.00
06/16/82 06/30/82	UNK/Wash. DC/ Flagstaff/Juneau/UNK	MSA Instructional Mgmt.	11/22/82	53740	1,079.99	640.09	1,487.14	121.93		51.44	3,380.59
Total FY82 Out-of-District Travel					<u>13,373.65</u>	<u>4,056.54</u>	<u>6,179.13</u>	<u>1,845.34</u>	<u>1,806.90</u>	<u>417.96</u>	<u>27,679.52</u>
Total FY82 In-District Travel					<u>1,103.80</u>	<u>34.79</u>					<u>1,138.59</u>
Total Travel (Note 2)					<u>\$14,477.45</u>	<u>\$4,091.33</u>	<u>\$6,179.13</u>	<u>\$1,845.34</u>	<u>\$1,806.90</u>	<u>\$417.96</u>	<u>\$28,818.11</u>

BEERING STRAIT SCHOOL DISTRICT
 SCHEDULE OF SUPERINTENDENT'S TRAVEL
 FY81, FY82 and FY83 (Through 12/31/82)

STATE OF ALASKA

- 20 -

DIVISION OF LEGISLATIVE AUDIT

Travel Dates	Destination	Purpose of Trip	Voucher Date	Voucher Number	Airfare	Per Diem	Taxi Auto	Regis- tration	Other	Totals
FY83 Out-of-District Travel (Note 2)										
07/02/82 07/03/82	UNK/Juneau/ UNK	Review Summer Maintenance schedules	11/22/82	53740	\$ 107.00	\$ 115.00	\$	\$	\$	\$ 222.00
07/13/82 07/14/82	UNK/Anch/Juneau Anch	Re: Life-safety code upgrade deficiencies	11/22/82	53740	614.00	287.50				901.50
07/29/82 07/30/82	Anch/Juneau/ UNK	Life-safety code upgrade deficiencies	11/22/82	53740	170.00	230.00				400.00
vs.	UNK/Juneau/Anch/UNK	Life-safety code def.	11/22/82	53740	750.00					750.00
08/06/82 08/07/82	UNK/Anch/ Juneau	Supt. Orientation In-service meeting	11/22/82	53740	340.00	115.00				455.00
08/15/82	Juneau/UNK		11/22/82	53740		115.00				115.00
08/24/82	UNK/Juneau		11/22/82	53740	96.00	115.00				211.00
08/30/82 09/06/82	UNK/Anch/Juneau UNK	Life safety code upgrade deficiencies - BIA facilities	11/22/82	53740	318.23	920.00				1,238.23
10/08/82 10/13/82	UNK/Anch/Juneau UNK	Life-safety code upgrade deficiencies - BIA facilities	11/22/82	53740	546.00	345.00				891.00
10/15/82 10/21/82	UNK/Juneau UNK	MSA Fall Conference/ Meeting w. R. Holden	11/22/82 11/04/82	53740 53526	608.00 188.76	920.00				1,528.00 188.76
11/03/82 11/08/82	UNK/Anch/Juneau/ UNK	Develop Computer Bid Specs.	11/22/82	53740	608.00	575.00				1,183.00
11/12/82	UNK/Juneau/UNK	Meeting with DOE re: 1st Quarter Report	11/22/82	53740	456.00	345.00				801.00
11/22/82 12/04/82	UNK/Juneau/Anch/ UNK	Attend Biocycle Bid Specs meeting/Review life- Safety Deficiencies/State Board Meeting	12/08/82	54228	608.00	1,322.50	109.00			2,039.50

BEKING STRAIT SCHOOL DISTRICT
 SCHEDULE OF SUPERINTENDENT'S TRAVEL
 FY81, FY82 and FY83 (through 12/31/82)

STATE OF ALASKA

<u>Travel Dates</u>	<u>Destination</u>	<u>Purpose of Trip</u>	<u>Voucher Date</u>	<u>Voucher Number</u>	<u>Airfare</u>	<u>Per Diem</u>	<u>Taxi Auto</u>	<u>Regis- tration</u>	<u>Other</u>	<u>Totals</u>
FY83 Out-of-District Travel (continued)										
12/10/82	UNK/Savannah, GA/	MASA Workshop		54455	1,321.59 (Note 3)	690.00	60.00			2,071.59
12/15/82	Juneau/UNK									
12/20/82 01/07/83	UNK/Juneau/UNK	State Board Meeting/Meet w/Holden re: Life-Safety & Code upgrade/meet re: preventive maintenance	01/12/83	54647	567.00	1,265.00	14.21		36.75	1,882.96
Total FY83 Out-of-District Travel					<u>7,298.58</u>	<u>7,360.00</u>	<u>183.21</u>		<u>36.75</u>	<u>14,878.54</u>
Total FY83 In-District Travel					<u>4,731.02</u>					<u>4,731.02</u>
Total Travel (Note 2)					<u>\$12,029.60</u>	<u>\$7,360.00</u>	<u>\$183.21</u>		<u>\$36.75</u>	<u>\$19,609.56</u>

(Intentionally left blank)

STATE OF ALASKA
DEPARTMENT OF EDUCATION
BERING STRAIT SCHOOL DISTRICT
NOTES TO THE SCHEDULE OF SUPERINTENDENT'S TRAVEL
Fiscal Years 1981, 1982, and 1983 (through 12/31/82)

Note 1 - Food and Drinks

During Fiscal Years 1981 and 1982, the Superintendent was reimbursed for actual costs of food and drinks. However, not all costs of food and drinks were incurred while on travel status as shown in this Schedule. During Fiscal Years 1981 and 1982, the Superintendent was also reimbursed for in-district food and drink costs in the amount of \$1,554 and \$1,154, respectively.

During Fiscal Year 1983, the Superintendent receives \$115 per day per diem, and is no longer reimbursed actual costs of lodging, food and drinks.

Note 2 - Travel Status vs. Out-of-District

The Schedule of Superintendent's Travel reflects only those dates he was on official travel status, reimbursed by the District. Not reflected in this Schedule, is the Superintendent's time spent out of the district for Board approved lobbying efforts during Fiscal Years 1981 and 1982. Between 7/1/80 and 6/30/81, and between 7/1/81 and 6/30/82, the superintendent spent approximately 38% and 34%, respectively, of his time in the District. The remainder of time was spent on official travel status as listed in this Schedule or in Juneau on lobbying efforts.

From 7/1/82 to 12/31/82, the Superintendent spent 62% of his time in the District. For our calculation, the dates of departure from the District and return to the District were considered days in the District.

Note 3 - AASA Reimbursement

Airfare relating to the American Association of School Administrators is subject to a 75% reimbursement by the Association.

(Intentionally left blank)

BERING STRAIT SCHOOL DISTRICT
 SCHEDULE OF DEPUTY SUPERINTENDENT'S TRAVEL
 FY81, FY82 and FY83 (Through 12/31/82)

STATE OF ALASKA

- 25 -

DIVISION OF LEGISLATIVE AUDIT

Travel Dates	Destination	Purpose of Trip	Voucher Date	Voucher Number	Airfare	Food/Drinks (Note 1)	Lodging	Taxi Auto	Registration	Other	Totals
FY81 Out-of-District Travel											
06/30/80 08/02/80	Nome/Boise, ID/ Nome	Teacher Interviews	08/05/80	43016	\$	\$ 37.76	\$ 81.11	\$ 104.02	\$	\$ 42.92	\$ 265.81
08/06/80 08/08/80	Nome/Anchorage	Budget Oversight Comm. Hearing	08/12/80	43075	290.00	24.00	38.30	49.90		2.00	404.20
09/11/80 09/12/80	Nome/Anchorage	Re: Stebbins & St. Michael Const.	09/17/80	43645	290.00	25.45		26.50		2.18	344.13
09/23/80 09/26/80	Nome/Anchorage	Re: URK Facility	09/29/80	43799	290.00	255.00	125.16				670.16
09/29/80 10/01/80	Nome/Anchorage	Re: Const./Meet with Attorneys	10/01/80	43867	293.86	37.25	100.92	45.58			477.61
10/15/80 10/17/80	Nome/Fairbanks/ Nome	NSA Meeting	10/30/80	44234	269.80	119.17	179.26	16.00			584.23
10/27/80 10/29/80	Nome/Kotzebue/Nome	State Board Meeting	10/27/80	44236	132.22	32.00					164.22
11/12/80 11/15/80	Nome/Anchorage	Facilities Comm. Meeting	11/19/80	44557	289.72	52.25	140.26	73.20		42.75	598.18
12/11/80 12/15/80	Nome/Anchorage	Meet w/Attorney Construction Meetings	12/17/80	44908	289.72	100.00	203.06	117.06		14.00	723.84
02/09/81 02/18/81	Nome/Atlanta/Nome	NSA Convention	02/25/81 10/23/80 02/18/81	45668 44147 45575	144.86 1,041.77	272.39	655.46	62.20	465.00	6.00	1,140.91 465.00 1,041.91
03/25/81 03/27/81	Nome/Anchorage	Rural Schools Conference	03/27/81	46171	192.00		196.20	83.06		29.00	500.26
03/30/81 04/04/81	Nome/Juneau/Nome	NSA Meeting	04/06/81	46207	553.00		232.33	3.00	286.00		1,074.33
04/22/81 04/25/81	Nome/Anchorage	State Task Force	04/28/81 05/29/81	46533 46869	304.93 304.00	120.00	221.33	122.20		65.00	833.43 304.00
05/04/81 05/10/81	Nome/Anchorage	Facility Committee Meeting	05/15/81	47619		61.00	188.44	123.00		10.00	382.44

BERING STRAIT SCHOOL DISTRICT
 SCHEDULE OF DEPUTY SUPERINTENDENT'S TRAVEL
 FY81, FY82 and FY83 (Through 12/31/82)

<u>Travel Dates</u>	<u>Destination</u>	<u>Purpose of Trip</u>	<u>Voucher Date</u>	<u>Voucher Number</u>	<u>Airfare</u>	<u>Food/ Drinks (Note 1)</u>	<u>Lodging</u>	<u>Taxi Auto</u>	<u>Registration</u>	<u>Other</u>	<u>Totals</u>
FY81 Out of district Travel (continued)											
06/03/81 06/05/81	None/None/None	Interview Construction Coordinators	06/08/81	46938	328.00	99.18	167.04	88.40			682.62
06/15/81 06/19/81	None/None/None	ASB Meeting/meet with Attorney	06/22/81	46990	328.00	31.86	222.89	117.95			700.70
06/27/81 06/29/81	None/None/Juneau/None	State Board/Meet with Attorney	07/02/81	47100	581.00	123.20	245.10	65.29			1,014.59
Total FY81 Out-of-District Travel					<u>5,922.85</u>	<u>1,390.51</u>	<u>2,996.87</u>	<u>1,097.36</u>	<u>751.00</u>	<u>213.85</u>	<u>12,372.44</u>
Total FY81 In-District Travel					<u>794.38</u>						<u>794.38</u>
Total Travel					<u>\$6,717.23</u>	<u>\$1,390.51</u>	<u>\$2,996.87</u>	<u>\$1,097.36</u>	<u>\$751.00</u>	<u>\$213.85</u>	<u>\$13,166.82</u>

STATE OF ALASKA

226 -

DIVISION OF LEGISLATIVE AUDIT

BERING STRAIT SCHOOL DISTRICT
 SCHEDULE OF DEPUTY SUPERINTENDENT'S TRAVEL
 FY81, FY82 and FY83 (Through 12/31/82)

STATE OF ALASKA

- 2 -

DIVISION OF LEGISLATIVE AUDIT

Travel Dates	Destination	Purpose of Trip	Voucher Date	Voucher Number	Airfare	Food/Drinks (Note 1)	Lodging	Taxi Auto	Registration	Other	Totals
FY82 Out-of-District Travel											
07/15/81 07/18/81	Nome/Anc/Nome	Meet w/Attorney	07/20/81	47246	\$ 328.00	\$ 29.58	\$ 193.40	\$ 89.34	\$	\$	\$ 640.32
07/29/81 08/02/81	Nome/Anc/Juneau/ Nome	State Supt. Meeting/ Capital Budget	08/07/81	47444	501.00	62.00	267.41	80.27			970.68
08/12/81 08/15/81	Nome/Anc/Nome	Diocese School Const/ Budget Oversight Comm.	08/21/81	47553	328.00	125.33	293.09	94.94			841.36
10/05/81 10/21/81	Nome/Anc/Juneau/Skagway Juneau/Anc/Nome	MSA Conference	10/19/81	48299 49935	459.00	27.43	309.62	58.20			395.25 459.00
11/07/81 11/15/81	Nome/Anc/Juneau Anchorage/Nome	Legislative Budget & Audit Meeting/State Board Meeting/ASB Meeting	12/01/81	48895	558.09	343.69	472.61	39.75			1,414.14
12/13/81 12/16/81	Nome/Anc/Juneau/Nome	Facilities Comm. Meeting	12/11/81	49104	558.00	214.26	340.80	84.94			1,198.00
02/19/82 03/07/82	Nome/Anc/Juneau/ New Orleans/ /Nome	MSA Convention	02/05/82 11/24/81 05/18/82 12/01/81 04/08/82	49771 48883 51129 48954 50489	1,345.02		101.00 318.41		523.00		1,345.02 101.00 318.41 523.00 1,731.98
04/06/82 04/12/82	UNK/Anc/Juneau/UNK	Meeting at DOE	04/21/82	50654	599.00	6.00	185.14	52.36			842.50
06/01/82 06/05/82	UNK/Anc/UNK	Education Facilities Meeting	06/29/82	51523	340.00	121.00	345.21	156.55			962.76
06/08/82 06/12/82	UNK/Anc/UNK	Re: Construction - White Mountain	06/17/82	51404	340.00	205.45	259.99	165.69		65.19	1,016.13
Total FY82 Out-of-District Travel					5,436.11	1,523.02	4,000.15	1,252.27	523.00	65.19	12,799.74
Total FY82 In-District Travel					1,498.28						1,498.28
Total Travel					\$6,934.39	\$ 1,523.02	\$4,000.15	\$1,252.27	\$523.00	\$ 65.19	\$14,298.02

HEMLOCK STRAIT SCHOOL DISTRICT
 SCHEDULE OF EMPLOY SUPPLEMENTARY'S TRAVEL
 FY81, FY82 and FY83 (through 12/31/82)

Travel Dates	Destination	Purpose of Trip	Voucher Date	Voucher Number	Airfare	Food/In Miles	Lodging	Taxi Auto	Other	Totals
FY83 Out-of-District Travel										
10/11/82	UNK/Anc/ARR	ANSA Fall Conference	10/27/82	53384	\$ 447.00	\$ 90.00	\$ 108.20	\$ 58.42	\$ 42.75	\$ 746.37
10/16/82										
12/04/82	UNK/Anc	Meeting re: Certified negotiations	12/08/82	54205	228.00		118.05	79.25	26.00	451.30
12/06/82					675.00	90.00	226.25	137.67	68.75	1,197.67
					78.18	20.00				98.18
		Total FY83 Out-of-District Travel			\$ 753.18	\$ 110.00	\$ 226.25	\$ 137.67	\$ 68.75	\$ 1,295.85
		Total FY83 In-District Travel								
		Total Travel								

STATE OF ALASKA
DEPARTMENT OF EDUCATION
BERING STRAIT SCHOOL DISTRICT
NOTES TO THE SCHEDULE OF DEPUTY
SUPERINTENDENT'S TRAVEL

Fiscal Years 1981, 1982 and 1983 (through 12/31/82).

Note 1 - Food and Drinks

During Fiscal Years 1981 and 1982, the Deputy Superintendent was reimbursed for actual costs of food and drinks. However, not all costs of food and drinks were incurred while on travel status as shown in this Schedule. During Fiscal Years 1981 and 1982, the Deputy Superintendent was also reimbursed for in-district food and drink costs in the amount of \$1,436 and \$768, respectively.

(Intentionally left blank)

BERING STRAIT SCHOOL DISTRICT
 SCHEDULE OF TRAVEL - OTHER KEY PERSONNEL
 FY81, FY82 and FY83 (through 12/31/82)

STATE OF ALASKA

- 31 -

DIVISION OF LEGISLATIVE AUDIT

Travel Dates	Destination	Purpose of Trip	Voucher Date	Voucher Number	Airfare	Food/Drinks	Lodging	Taxi Auto	Registration	Other	Totals
ASSISTANT SUPERINTENDENT OF VOCATIONAL EDUCATION											
FY81 Out-of-District Travel											
To 12/31/80		DOE Evaluations/ASAA meeting/recruiting ABE Evaluation			\$ 880.00	\$ 192.95	\$ 266.00	\$ 151.79	\$ 255.00	\$ 68.88	\$ 1,814.62
										1,938.76	1,938.76
	None/New Orleans/None	National AVA Convention	01/13/81	45151	995.00	115.93	290.20	107.86		29.99	1,528.98
	None/None/None	ASAA Meeting	02/02/81	45392	289.72	24.85	84.00	46.99		12.45	460.01
	None/None/None	AVA Meeting	03/10/81	45868	192.00	103.55	172.80	141.45	100.00	4.25	770.05
	None/Bismidji, MN/None, IA	Teacher Recruitment	05/05/81	46604	132.00	214.45	443.07	781.19		76.40	1,647.11
	Ellensburg, WA/None										
	None/None/None	Vocational Administration	05/22/81	46815	325.00	86.52	126.00	171.93		29.60	739.05
		Total FY81 Out-of-District Travel			2,813.72	738.25	1,382.07	1,401.21	355.00	2,160.33	8,850.58
		Total FY81 In-District Travel			2,603.85						2,603.85
		Total Travel			\$5,417.57	\$ 738.25	\$1,382.07	\$1,401.21	\$ 355.00	\$2,160.33	\$ 11,454.43
FY82 Out-of-District Travel											
	None/Columbia, OH/None	Shopsmith Academy	07/07/81	47140	\$1,453.96	\$ 124.48	\$ 121.83	\$ 48.00	\$	\$ 74.23	\$ 1,822.50
	None/Skagway/None	ASAA Meeting	10/19/81	48307		151.22	119.83	90.91	217.40	24.75	604.11
	None/None/None	Voc. Ed. Adm. Conference	10/19/81	48306	328.00	134.75	90.00	202.68		7.17	762.60
	None/None/None	Professional Upgrade	11/20/81	48841	334.00	62.80	136.09	161.69		54.35	748.92
	None/Atlanta, GA/None	AVA Meeting	01/07/82	49373	1,655.57	143.01	217.87	30.00	35.50		2,081.95
	None/None/None	PMA Program	01/27/82	49866	334.00	28.05	96.00	132.23		16.65	606.93
	None/None/None	Interview Mtce. Cand.	04/06/82	50458	227.00	57.25	207.36	20.00		303.75	815.36
	None/Bismidji, MN/None, IA	Teacher Recruitment	05/17/82	51104	1,610.22	232.34	532.38	497.07		32.08	2,904.09
	Kansas City/Ellensburg/None		06/29/82	51522				40.00			40.00
	None/None/None	Exposite Materials	06/07/82	51337	340.00	85.45	237.60	46.00		8.87	717.92
		Total FY82 Out-of-District Travel			6,282.75	1,019.35	1,758.95	1,268.58	252.90	521.65	11,703.20
		Total FY82 In-District Travel			1,657.70						1,657.70
		Total Travel			\$7,940.45	\$1,019.35	\$1,758.95	\$1,268.58	\$ 252.90	\$ 521.65	\$ 12,762.08

BERING STRAIT SCHOOL DISTRICT
 SCHEDULE OF TRAVEL - OTHER KEY PERSONNEL
 FY81, FY82 and FY83 (Through 12/31/82)

<u>Travel Dates</u>	<u>Destination</u>	<u>Purpose of Trip</u>	<u>Voucher Date</u>	<u>Voucher Number</u>	<u>Airfare</u>	<u>Food/Drinks</u>	<u>Lodging</u>	<u>Taxi Auto</u>	<u>Registration</u>	<u>Other</u>	<u>Totals</u>
ASSISTANT SUPERINTENDENT OF VOCATIONAL EDUCATION											
FY83 Out-of-District Travel											
	Missoula, MT/Alliance, MT/ Missoula, MT	Equipment Purchase	07/14/82	51698	\$ 512.00	\$ 34.81	\$ 143.49	\$ 5.00	\$	\$	\$ 695.30
	UNK/Anc/UNK	State Board Meeting	10/13/82	53168	356.11	90.00	260.00	101.30		6.40	1
	UNK/St. Louis, MO/ UNK	Interview Voc.Ed. Teachers/AVA Conference	12/22/82	54504	<u>1,508.62</u>	<u>210.00</u>	<u>260.50</u>	<u>45.80</u>	<u>112.00</u>	<u>29.67</u>	<u>2,166.59</u>
	Total FY83 Out-of-District Travel				<u>2,376.73</u>	<u>334.81</u>	<u>663.99</u>	<u>152.10</u>	<u>112.00</u>	<u>36.07</u>	<u>3,675.70</u>
	Total FY83 In-District Travel				<u>584.00</u>						<u>584.00</u>
	Total Travel				<u>2,960.73</u>	\$ <u>334.81</u>	\$ <u>663.99</u>	\$ <u>152.10</u>	\$ <u>112.00</u>	\$ <u>36.07</u>	\$ <u>4,259.70</u>

BERING STRAIT REGIONAL DISTRICT
 SCHEDULE C - TRAVEL - OTHER REVENUE PERSONNEL
 FY81, FY82 and FY83 (through 12/31/82)

Travel Dates	Destination	Purpose of Trip	Voucher Date	Voucher Number	Airfare	Food/Drinks	Lodging	Taxi Auto	Regis- tration	Other	Totals
ASSISTANT SUPERINTENDENT - CURRICULUM											
FY81 Out-of-District Travel											
To 12/31/80					\$1,309.52	\$ 406.82	\$ 744.07	\$ 166.49	\$	\$	\$ 2,706.90
	Nome/Las Vegas/Anch		01/08/81	45128		327.25	208.27	38.79			574.31
	Nome/Anch/Anch		03/08/81	45858	384.00	158.00	210.00	242.38			994.38
	Nome/Anch/Anch		04/01/81	46136	192.00	84.99	190.40	173.29	10.00		550.68
	Total FY81 Out-of-District Travel				1,885.52	1,057.06	1,352.82	620.95	10.00		4,926.35
	Total FY81 In-District Travel				2,484.00	1,145.70					3,629.70
	Total Travel				\$4,369.52	\$2,202.76	\$1,352.82	\$ 620.95	\$ 10.00	\$	\$ 8,556.05
FY'82 Out-of-District Travel											
	Nome/Colorado Springs/Anch	Nat. Curriculum Study Instruction	07/15/81	47189	\$	\$ 190.05	\$ 128.56	\$ 244.85	\$	\$	\$ 563.46
	Nome/Seward/Anch	NSA Conference	10/19/81	48302		281.43	273.15	40.17	400.00	45.50	1,040.25
	Nome/Las Vegas/Anch	NSP - PESI meeting	01/14/82	48900	712.82	336.94	172.80	15.00			1,237.56
	Nome/Anch/Anch	Staff Development	01/14/82	49491		68.79	178.20	16.00		1.26	254.25
	Nome/Anch/Anch	Educ. Fac. Workshop	06/16/82	51386		553.69	356.60	238.01			1,148.30
	Nome/Anch/Anch		04/06/82	50456	1,010.82	1,430.90	1,145.11	554.03	400.00	46.76	4,611.62
	Total FY82 Out-of-District Travel				3,448.45	227.86		927.29			4,603.54
	Total FY82 In-District Travel				\$6,479.27	\$ 1,658.70	\$ 1,169.11	\$ 554.03	\$ 400.00	\$ 974.05	\$ 9,235.16
	Total Travel				\$10,127.72	\$3,866.46	\$2,521.93	\$1,178.28	\$800.00	\$1,448.81	\$13,870.31
FY83 Out-District Travel											
	UAK/Denver/URK	ASCD National Study Institute	09/08/82	52587	\$ 853.24	\$ 260.60	\$ 128.00	\$ 95.00			\$ 1,336.84
	URK/Anch/URK	National Regional Board Planning Meeting	09/08/82	52586	316.00	80.00	165.00	56.00			557.00
			11/29/82	53863							
	Total FY83 Out-of-District Travel				1,169.24	340.60	293.00	290.61			2,093.45
	Total FY83 In-District Travel				1,370.79						1,370.79
	Total Travel				\$2,540.03	\$ 340.60	\$ 293.00	\$ 250.61			\$ 3,464.24

BERING STAFF SCHOOL DISTRICT
 SCHEDULE OF TRAVEL - OTHER KEY PERSONNEL
 FY81, FY82 and FY83 (Through 12/31/82)

Travel Dates	Destination	Purpose of Trip	Voucher Date	Voucher Number	Airfare	Food/Drinks	Lodging	Taxi Auto	Registration	Other	Totals
BUSINESS MANAGER											
FY81 Out-of-District Travel											
To 12/31/80					\$3,142.40	\$ 705.06	\$ 603.75	\$ 445.04	\$	\$ 52.00	\$ 4,948.25
None/None/None		Ed. Board Meeting	01/02/81	45058	290.00	83.40	84.00	16.00		26.70	500.10
None/Atlanta, GA/None		NASA Meeting	02/15/81	45659		59.34		5.50	140.00		204.84
None/None/None		ALASIS	04/27/81	46480		82.00	135.52	9.00		2.50	228.52
None/None/None		Staff Recr	06/01/81	46884	304.00	16.65	44.00	10.40			375.05
Total FY81 Out-of-District Travel					3,736.40	946.45	867.27	485.94	140.00	81.20	6,156.26
Total FY81 In-District Travel					1,071.69	23.79	40.00				1,135.48
Total Travel					\$4,808.09	\$ 970.24	\$ 907.27	\$ 485.94	\$ 140.00	\$ 81.20	\$ 7,392.74
FY82 Out-of-District Travel											
None/None/None		Nat. Sch. Lunch Prog.	08/11/81	47460	\$ 328.00	\$ 87.00	\$ 149.05	\$ 125.73			\$ 689.78
None/None/None		Legislative Committee	08/26/81	47637	342.00	135.75	112.85	27.00			617.60
None/None/None		POE - Chapter 134	12/16/81	49156	334.00	42.75	47.61	33.20			457.56
None/None/None		Popul Trans. Washp.	01/14/82	49479	334.00	82.00	155.52	97.41			668.93
URK/None/URK		MASSO Conventio	05/13/82	51017	255.00	275.00	636.88	411.30		37.99	1,616.17
Dayton/URK/Dayton		Staffing and Budget	06/17/82	51348	1,307.85	150.00	149.55	91.40			1,698.80
URK/None/URK		Relocation D.O.	06/22/82	51524	466.00	181.87	173.34	18.60			839.81
URK/None/URK		Review Insurance	06/29/82	51601	296.00	44.60	49.68				390.28
Total FY82 Out-of-District Travel					3,662.85	998.97	1,474.48	804.64		37.99	6,978.93
Total FY82 In-District Travel					155.00						155.00
Total Travel					\$3,817.85	\$ 998.97	\$1,474.48	\$ 804.64		\$ 37.99	\$ 7,133.93

HERRING STRAIT SCHOOL DISTRICT
 SCHEDULE OF TRAVEL - OTHER KEY PERSONNEL
 FY81, FY82 and FY83 (Through 12/31/82)

Travel Dates	Destination	Purpose of Trip	Voucher Date	Voucher Number	Airfare	Food/Drinks	Lodging	Taxi Auto	Other	Totals
FY83	Out-of-District Travel									
	ARR/ANC/ARR	Asc. BIA Upgrade	07/13/82	52100	\$ 466.00	\$ 60.65	\$ 32.40	\$ 18.00	\$ 4.80	\$ 581.85
	ARR/ANC/ARR	Engineer and Attorney/EW	10/06/82	53081	761.59	193.05	185.20	104.14		1,243.98
	ARR/ANC/ARR	State Fin. Comm.	10/06/82	53081	304.00	180.00	149.04	147.70		780.74
	ARR/ANC/ARR	State Fin. Comm./Holden and Associates	10/27/82	53365	229.00	120.00	116.66	55.62	22.80	544.08
	ARR/ATLANTA/ARR	SEO Official	11/01/82	43722	1,417.00	348.70	565.81	107.00		2,438.51
	ARR/ANC/ARR	Discrete Const. Meeting	12/17/82	54461	229.00	355.50	237.60	210.00	19.08	1,051.18
	ARR/ANC/ARR	Financial Planning	01/25/83	54788	555.00	270.00	572.52	396.26	11.08	1,804.86
		Total FY82 Out-of District Travel			<u>3,961.59</u>	<u>1,527.90</u>	<u>1,859.23</u>	<u>1,038.72</u>	<u>57.76</u>	<u>8,445.20</u>
		Total FY83 In-District Travel			<u>581.11</u>					<u>581.11</u>
		Total Travel			<u>\$4,542.70</u>	<u>\$1,527.90</u>	<u>\$1,859.23</u>	<u>\$1,038.72</u>	<u>\$ 57.76</u>	<u>\$ 9,026.31</u>

BERING STRAIT SCHOOL DISTRICT
 SCHEDULE OF TRAVEL - OTHER KEY PERSONNEL
 FY81, FY82 and FY83 (through 12/31/82)

<u>Travel Dates</u>	<u>Destination</u>	<u>Purpose of Trip</u>	<u>Voucher Date</u>	<u>Voucher Number</u>	<u>Airfare</u>	<u>Food/Drinks</u>	<u>Lodging</u>	<u>Taxi Auto</u>	<u>Regis-tration</u>	<u>Other</u>	<u>Totals</u>
DIRECTOR OF ADMINISTRATION											
FY83 Out-of-District Travel											
Missoula/Chicago/Missoula		ASA Wksp/Computer Wksp.	08/05/82	52108	\$ 518.00	\$ 67.05	\$ 125.91	\$ 150.09	\$ 285.55	\$	\$ 1,146.60
URK/Anc/URK		Met at DUP/PF	10/18/82	53257	304.00	75.22	89.46	129.53		20.72	618.93
URK/Anc/URK		Re: Construction	11/22/82	53739	332.00	166.55	226.80	13.00		20.81	759.16
URK/Anc		Jury for Dismale Const.	12/09/82	54250	229.00	116.10	267.41	10.00		11.33	633.84
URK/Anc/URK		Dismale Const.	01/12/83	54648	532.00	43.24	384.00	189.95			1,149.19
Total FY83 Out-of-District Travel					<u>1,915.00</u>	<u>468.16</u>	<u>1,093.58</u>	<u>492.57</u>	<u>285.55</u>	<u>52.86</u>	<u>4,307.72</u>
Total FY83 In-District Travel					<u>2,846.19</u>	<u>99.27</u>					<u>2,945.46</u>
Total Travel					<u>\$4,761.19</u>	<u>\$ 567.43</u>	<u>\$1,093.58</u>	<u>\$ 492.57</u>	<u>\$ 285.55</u>	<u>\$ 52.86</u>	<u>\$ 7,253.18</u>
DIRECTOR OF CURRICULUM AND INSTRUCTION											
FY83 Out-of-District Travel											
Chicago		ASA Wksp/Computer Wksp.	08/23/82	52329	\$	\$ 79.65	\$ 125.91	\$	\$		\$ 205.56
URK/Anc/URK		Region I Sch. Act. Assoc.	10/13/82	53144	304.00	37.50	89.10				430.60
URK/Seattle/URK		IM School Accred.	12/15/82	54376	687.35	194.79	229.50	67.50	20.00		1,199.14
Total FY83 Out-of-District Travel					<u>991.35</u>	<u>311.94</u>	<u>444.51</u>	<u>67.50</u>	<u>20.00</u>		<u>1,835.30</u>
Total FY83 In-District Travel					<u>767.42</u>						<u>767.42</u>
Total Travel					<u>\$1,758.77</u>	<u>\$ 311.94</u>	<u>\$ 444.51</u>	<u>\$ 67.50</u>	<u>\$ 20.00</u>		<u>\$ 2,602.72</u>

BERING STRAIT SCHOOL DISTRICT
 SCHEDULE OF TRAVEL - OTHER KEY PERSONNEL
 FY81, FY82 and FY83 (through 12/31/82)

Travel Dates	Destination	Purpose of Trip	Traveler Name	Traveler Title	Traveler No.	Airfare	Food/Drinks	Lodging	Taxi Auto	Registration	Other	Totals
DIRECTOR OF SPECIAL EDUCATION												
FY81	Out-of-District Travel											
To 12/31/80						\$ 870.00	\$ 88.80	\$ 129.60	\$ 217.23			\$ 1,305.63
	UNK/Los Angeles/UNK	Rural CAP Meeting		01/26/81	45318		150.00	242.54	200.27			592.81
	UNK/ANC/UNK	DOE Meeting		01/01/81	46182		100.35	237.60	137.04			474.99
	UNK/Sitka/UNK	Sp. Ed. Dir. Conf.		05/26/81	46822		146.76	308.00	21.05			475.81
	UNK/UNK/UNK	Title I Workshop		05/26/81	46823		86.15	164.00	123.28			373.43
		Total FY81 Out-of-District Travel				870.00	572.06	1,081.74	698.87			3,222.67
		Total FY81 In-District Travel				770.00	213.95					983.95
		Total Travel				\$1,640.00	\$ 786.01	\$1,081.74	\$ 698.87			\$ 4,206.62
FY82 Out-of-District Travel												
	UNK/UNK/UNK	Sp. Ed. Conference		11/19/81	48825	\$ 328.00	\$ 11.15	\$ 272.41	\$ 158.02	\$ 15.00		\$ 784.58
		Total FY82 In-District Travel				537.26						537.26
		Total Travel				\$ 865.26	\$ 11.15	\$ 272.41	\$ 158.02	\$ 15.00		\$ 1,321.64
FY83 Out-of-District Travel and Total												
	UNK/UNK/UNK	Sp. Ed. Dir. Meeting		10/27/82	51381	\$ 304.00	\$ 150.00	\$ 275.00	\$ 20.00			\$ 749.00

BERING STRAIT SCHOOL DISTRICT
 SCHEDULE OF TRAVEL - OTHER NEW PERSONNEL
 FY81, FY82 and FY83 (through 12/31/82)

Travel Dates	Destination	Purpose of Trip	Voucher Date	Voucher Number	Airfare	Food/Drinks	Lodging	Taxi Auto	Registration	Other	Totals	
	DIRECTOR OF BILMUTUAL/BIOLOGICAL EDUCATION											
	Total FY81 Out-of-District Travel				\$ 749.72						\$ 749.72	
	Total FY81 In-District Travel				932.25						932.25	
	Total Travel				\$1,681.97						\$ 1,681.97	
	FY82 Out-of-District Travel											
	June/July Vegas/Las Vegas	ASCD-PCSI Meeting	01/14/82	48900	\$ 712.82						\$ 712.82	
	Total FY82 In-District Travel				102.50						102.50	
	Total Travel				\$ 815.32						\$ 815.32	
	FY83 Out-of-District Travel											
	Aug/Eugene, OR/tnk	ASCD National Study	09/08/82	52387	\$ 853.24	\$29.00	\$40.00			\$190.00	\$ 1,112.24	
	Total FY83 In-District Travel				940.00						940.00	
	Total Travel				\$1,793.24	\$29.00	\$40.00			\$190.00	\$ 2,052.24	
	DIRECTOR OF TRANSPORTATION											
	FY83 Out-of-District Travel											
	Aug/Seattle WRK/Seattle/WRK	Re: Construction HW School Accted.	08/23/82 12/13/82	52328 54322	\$ 516.92 824.62	\$ 25.00 142.00	\$ 130.28 207.26	\$ 10.00 58.00	\$ 20.00		\$ 682.20 1,251.68	
	Total FY83 Out-of-District Travel				\$1,341.54	\$ 167.00	\$ 337.54	\$ 68.00	\$ 20.00		\$ 1,934.08	

DISTRICT OFFICE

BERING STRAIT SCHOOL DISTRICT

P.O. BOX 225

UNALAKLEET, ALASKA 99684

(907) 624-3611

BERING STRAIT SCHOOL DISTRICT ANALYSIS OF TRAVEL, SALARY AND BENEFITS

APRIL, 1983

BREVIK MISSION

COUNCIL

DIOMEDE

ELIM

GAMBELL

GOLOVIN

KOYUK

SAINT MICHAEL

SAVCONGA

SHAKTOOLIK

SHISHMAREF

STEBBINS

TELLER

UNALAKLEET

WALES

WHITE MOUNTAIN

Presented To: Legislative Budget and Audit Committee

**Presented By: Ronald W. Hohman
Superintendent
Bering Strait School District**

DISTRICT OFFICE

BERING STRAIT SCHOOL DISTRICT

P.O. BOX 225

UNALAKLEET, ALASKA 99684

(907) 624-3611

April 15, 1983

Mr. Gerald Wilkerson, Legislative Auditor
Legislative Budget and Audit
Pouch W
Juneau, Alaska 99811

BREVIQ MISSION

COUNCIL

DIOMEDE

ELIM

GAMBELL

GOLOVIN

KOYUK

SAINT MICHAEL

SAVOONGA

SHAKTOOLIK

SHISHMAHEF

STEBBINS

TELLER

UNALAKLEET

WALES

WHITE MOUNTAIN

Dear Mr. Wilkerson:

The audit recently completed by Mr. Hugh Ford presents several years of information relative to Board travel, Administrative travel and Administrative Salary and Benefits of the Bering Strait School District. The audit period as defined by Legislative Budget and Audit begins with FY-81 and presents activity through December 31, 1982, a time span which included much growth for the Bering Strait School District. To present this type of information without explanation as to reasons for the activity would be certainly assuming that both the legislature and public had a basic understanding of the needs of the Bering Strait School District. I think you would agree that this assumption is somewhat heroic and therefore demands additional information to place the data collected by the auditor in the proper perspective.

Having reviewed the rough draft prepared by Mr. Ford and Mr. Welker, it would appear that the most appropriate method of providing this information is to address each schedule separately. However, prior to analyzing the three individual schedules it is necessary to present general background information relative to the huge Bering Strait School District. Hopefully the complete package of information being provided by the Bering Strait School District will facilitate any analysis and enhance the value of information presented by Legislative Budget and Audit.

Therefore, I respectfully request that this information packet be included with your schedules when presented to the Legislative Budget and Audit Committee.

Thank you for your attention to this very important matter.

Sincerely,

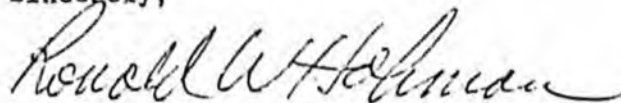

Ronald W. Hohman, Superintendent
Bering Strait School District

RWH/lkl

Enclosures

BERING STRAIT SCHOOL DISTRICT

GENERAL INFORMATION

FY-83

SECTION I

The Bering Strait School District has experienced significant growth in its scope and intensity of operations during the past five fiscal years. Students, staff, facilities and funding levels have combined to show growth patterns that demanded a management structure and style truly conducive to continuous change and turbulence. The information presented in the next several pages is intended to provide the reader with an appreciation for the environment in which the Bering Strait School District has provided a quality educational program during the period in question.

The first three pages demonstrate that the district has tripled its enrollment, increased staff by fivefold and operated four times as many facilities as it did when the district was formed. During this time period the Board of Education and Administration have worked diligently to expend the maximum proportion of funds available on the instructional programs. During fiscal year 1977 the district provided 1,160,460 student contact hours at a cost of approximately \$1.84 per student contact hour while in fiscal year 1982 8,178,480 students contact hours were provided at an approximate cost per student contact hour of \$.96. It is clear that although the district covers 80,000 square miles an area approximately equal to Michigan and Ohio and although growth during the past three years has been staggering, the 48% reduction in cost per student contact hour provided is indicative of a management style that has met the educational and community needs of rural Alaska without compromising any of the tenets of public service accountability. It would indeed be interesting to assess the comparability of

other districts, rural or urban, which have experienced similar change patterns during the period.

During the same time period the district has administered in excess of forty four million dollars in capital improvement projects including new construction, facility renovation, energy improvement, water projects and health code and life safety upgrade. Needless to say, the district has been both active and progressive in its efforts to deliver the best and safest possible educational program and community services to the people of the Eering Strait Region.

The remainder of Section I of this report presents the following exhibits:

Exhibit	Context	Page
Graph I	Trend of Average Daily Membership	FY77-FY85
Table I	Average Daily Membership Statistics	FY77-FY83
Graph II	Trend of Number of Classroom Teachers	FY77-FY83
Table II	Classroom Teacher Statistics	FY77-FY83
Graph III	Trend of Number of District Facilities	FY77-FY83
Table III	District Facility Statistics	FY77-FY83
Graph IV	Combined Trend of Pupil/Teacher, Staff	FY77-FY83
Table IV	District Wide Statistics - Pupil/Teacher Rates, Students per Unit, Unit Values	FY77-FY83
Graph V	Distribution of Total Expenditure Trend	FY77-FY83
Table V	Distribution of Total Expenditure Statistics	FY77-FY83
Exhibit I	Capital Project Inventory	FY77-FY83

Each of the exhibits presented in this section of the report describes a dimension both current and historical of the Bering Strait School District. At best it will provide the reader with a limited overview of the dynamic nature, accomplishments and activities that are part of the day to day life in the district. In concluding this section a partial list of FY83 year to date accomplishments with respect to students is presented for considerations. It is to be kept in mind that these results have been realized due to a continuous monitoring of progress toward the stated goals of the Bering Strait School District. These goals are:

1. IMPROVEMENT OF COMMUNICATIONS WITH STUDENTS, STAFF, PARENTS AND PUBLIC.
2. IMPROVEMENT OF COMMUNITY RELATIONS AND IMAGE
3. DEVELOPMENT AND REFINEMENT OF AN EDUCATIONAL MANAGEMENT SYSTEM
4. RELOCATION OF THE DISTRICT OFFICE TO UNALAKLEET
5. DEVELOPMENT OF A PROGRAM OF FOCUS FOR STUDENT ACHIEVEMENT
6. SUPPORT AND IMPLEMENT THE ACCREDITATION OF OUR HIGH SCHOOL PROGRAMS
7. DEVELOPMENT OF A PLAN FOR IMPLEMENTATION OF THE LATEST TELECOMMUNICATIONS TECHNOLOGY
8. UPGRADE THE DISTRICT'S FACILITIES FOR LIFE SAFETY/CODE DEFICIENCIES
9. REFINEMENT OF BOARD POLICY AND ADMINISTRATIVE PROCEDURES MANUALS
10. IMPROVEMENT OF COORDINATED TRAVEL SCHEDULES FOR STUDENTS, STAFF AND BOARD

A more complete explanation of the goals of the Bering Strait School District along with a midyear evaluation of goal attainment can be found in the publication entitled Focus on Goals, Bering Strait School District Mid-Year Report 1982-83.

Student accomplishments for fiscal year 1983 include but are not limited to:

Student Achievements

- . Anne Marie Anasogak - Voc. Ed., OEA, State Comp., Finished in Top Five in Secretarial Skills Competition
- . Barbara Apangalook - Alaskan of the Year Scholarship; Alaska Airlines Scholarship; Voc. Ed. State OEA Comp., Placed Third in Proofreading and Spelling, qualifying for National OEA Comp.
- . Paul Lincoln - Cross Country Skiing Champion
- . Ben Rupert - U.S. Air Force Academy Nominee
- . Alfred Kuzsruk - U. of A./State of Alaska Art Contest Winner
- . Shishmaref Girls Basketball Team - Region I, Division II Runner Up Champions
- . Alaska Future Problem Solving - Meredith Guthridge, Thor Ryan, Leon Gonion, Darlene Olanna
- . Jennifer Degnan - Koyuk and Unalakleet Spelling Bee Champion
- . Hilda Saccheus - Voc. Ed. State OEA Comp., Placed 5th in Records Management
- . Monica Thomas - Voc. Ed. State OEA, Secretary-Elect
- . Zilma Nowpakahok - Voc. Ed. State OEA Comp., 3rd Place Verbal Communications - qualifying for National OEA Comp.

Scholarship Winners

- . BSNC Scholarship
- . Alaska Airlines - Barbara Apangalook
- . Bill King Scholarship
- . Sheldon Jackson College - Debbie Bradley, Allan Sagoonick, Alvin Pootoogooluk Jr., Carol Seetomona, Barbara Ningeulook, Edward Tocktoo, Perry Barr, Barbara Apangalook, Sheery Apatiki, Harold

Koonooka, Zilma Nowpakahok, Eddie Ungott, Rodney Ungwiluk, Jr.

- . Nick Begich Scholarship Fund - Zilma Nowpakahok
- . Gambell Native Corporation - Barbara Apangalook, Harold Koonooka
- . City of Gambell - Barbara Apangalook, Harold Koonooka
- . The Mukluk Telephone Company's Martin L. Olson Science Scholarship

It is to be noted that this list of student achievements is what the Bering Strait School District is about and under the direction of this School Board and Superintendent the focus will remain on opportunities and experiences for students.

BERING STRAIT SCHOOL DISTRICT
 AVERAGE DAILY MEMBERSHIP
 FISCAL YEAR 1977-83
 GRAPH I

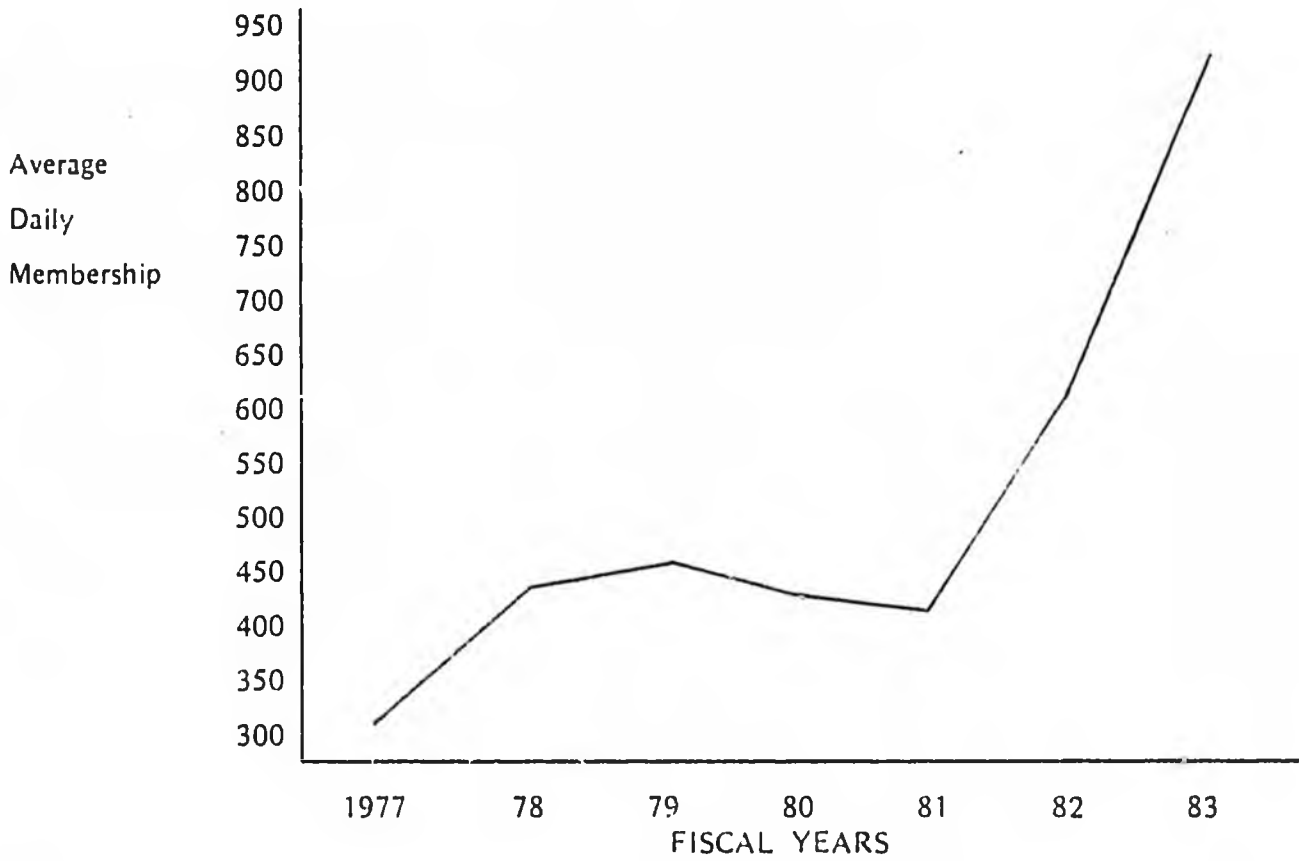

BERING STRAIT SCHOOL DISTRICT
 AVERAGE DAILY MEMBERSHIP
 FISCAL YEAR 1977-83
 TABLE I

<u>Fiscal Year</u>	<u>Average Daily Membership</u>	<u>% of Change</u>
1977	307	
1978	443	44.3
1979	451	1.8
1980	441	- 2.2
1981	440	- 3
1982	614	39.5
1983	920	49.8