

ALASKA LEGISLATION COMPILED 1901-1902 86/2

1221 HCRA NOMENCLATURE ANNEXATION - REVENUE SHARING

122

- Darrell Hargarves representing the school board.
Supported because the school district has 88 students outside the city limits attending Nome Public Schools. The REAA now has the ability to threaten to pull these studnets out of the public schools. This can be held as a club over the Nome City School District and if more clearly defined lines are drawn it will enhance the relationship between the two school districts.
- Myron Michaels lives outside present city limits. Objects because wasn't brought before the people for a vote.
- Judy Martinson ojects because city can't provide adequate services to those presently within its boundaries.
- Francis Elmore objects because city has no concrete plan for services. Believes those who are going to come under jurisdiction of a new governing body have the right to know what is and is not going to happen.
- Bonnie Hahn objects because of the probable increase in taxes.
- Neil Foster ojects as he owns an air taxi service and feel they already get sufficient services at the airport from the state. Also presented a resolution from Gambell City Council urging that the

- Martin Olesen expressed opposition to the manner in which the Commission was considering the revised plan. Was unfair to the residents who didn't have time to consider the new plan
- Leo Rasumssen supported and commented that any property taxes could be cut in half or be eliminated based on the Governor's proposals for this year.

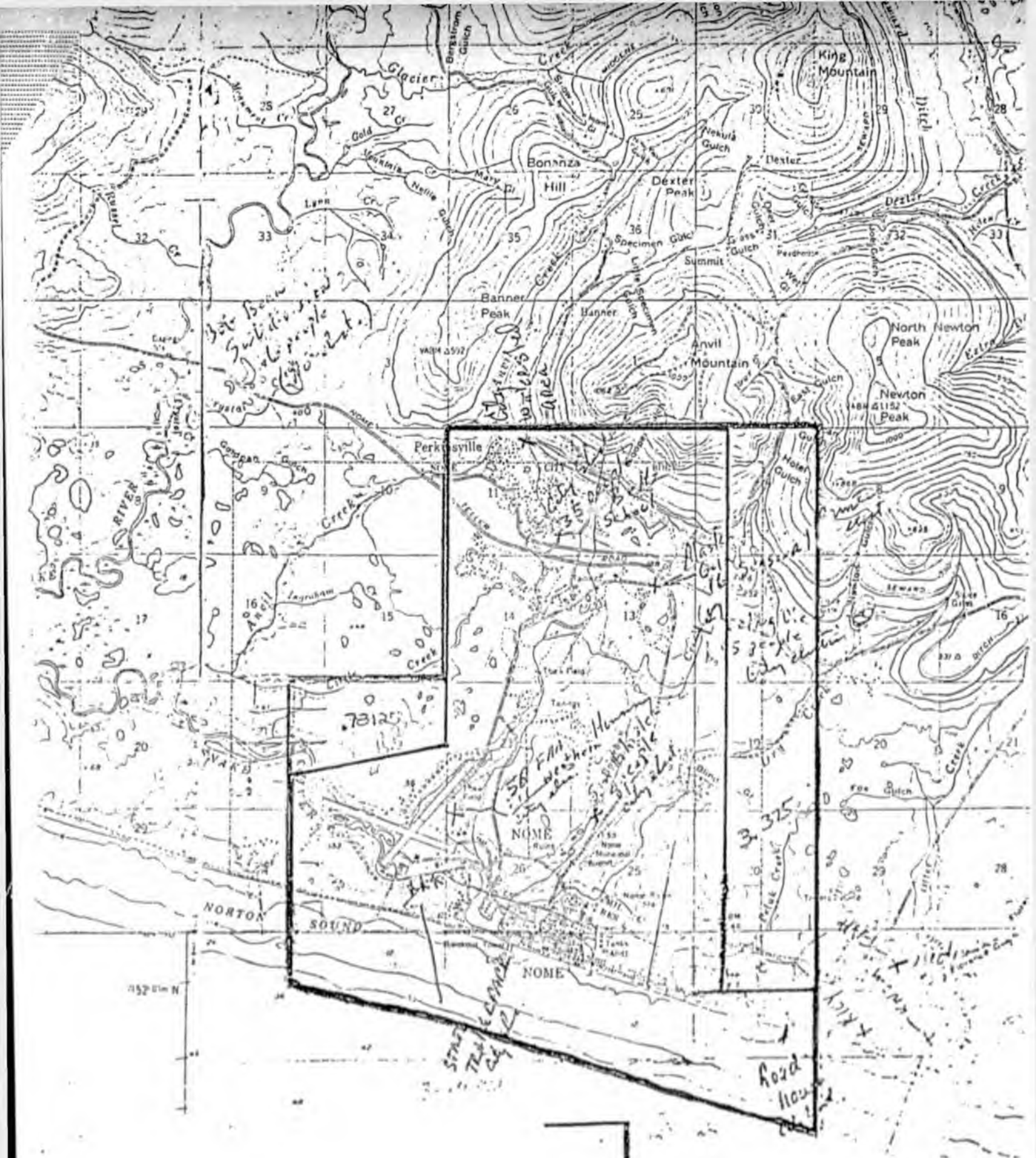

ATTACHMENT A
 LOCAL BOUNDARY COMMISSION
 STATEMENT OF DECISION
 DECEMBER 11, 1980

NOTE: THIS PAGE WAS COPIED FROM
 THE MAP USED BY THE COMMISSION
 DURING ITS DECEMBER 11, 1980
 MEETING

Statement to Legislative Teleconference
Hearing Regarding Nome Annexation

IV. - L. Widom - City Manager

I must apologize for not being able to appear before you in person today, but I had a trip scheduled outside for over a month now and couldn't change my plans. The City of Nome is fortunate to have the opportunity to discuss our annexation request once again. In fact, we are excited by the fact that we can tell the tale of annexation to someone who is interested in our situation.

I won't go into a long history. However, some of our past is relevant to this hearing. Nome was incorporated in 1901 and we are celebrating our 80th anniversary this year. Since that time, the boundaries of the City have been .85 square miles. No, your eyes and ears are not wrong, we still are today less than 1 square mile in size. This is for a city that once had over 10,000 population during the early years.

Today, our State recognized population is 2,892, the largest and only first-class city in northwest Alaska. Several attempts to annex over the years have ended in failure. One of the most recent ended up leaving the City the same way it has always been. In 1968, the City petitioned the Boundary Commission to annex 15.32 sq. miles. This action was subsequently challenged by what is now Alaska Gold and invalidated by the Court in 1971. The Supreme Court took this action because the Boundary Commission didn't have the required standards.

The current annexation has been in progress for almost 4 years. Numerous public hearings were held to inquire from and inform the public. In August of 1978, the Council passed an ordinance to annex 235.65 sq. mi. While this might seem to be a great deal of territory, there are at least 2 other cities in Alaska much larger that have been approved by the Boundary Commission. Valdez has 274 sq. mi. and Skagway is 443 sq. mi. Other cities in Alaska with much smaller populations include Nightmute, pop. 135 with 102 sq. mi., Togiak, pop. 474 is 42 sq. mi., McGrath, pop. 382 is 48 sq. mi., & Stebbins, pop. 309 is 35 sq. mi. The City was justified in requesting that much land

because the area is under influence of the City and that territory influences Nome as well.

The real issue is why does the City of Nome want to increase its boundaries? In the first place, our airport, our junior & senior high school, a major subdivision and at least 252 people (latest count) live outside the City and are dependent on the City for services in one way or another. Most of these people live within 1.5 miles of the present City limits in a major subdivision, FAA and State housing as well as dormitory housing at the Nome/Beltz complex.

The City of Nome is growing. We want to put a 5,000 foot causeway into Norton Sound and have 7 million bond dollars obligated for that purpose. The proposed land area for the port is not presently inside the City limits. While the problems are not insurmountable, we still have to gain title to the land and tidelands. Not having this area inside the City makes this situation a difficult one. The State of Alaska has \$6,989,000 to build a new jail and would like to do so inside the City. At the present time, all water & sewer is inside the City and we want to keep it that way. This annexation would certainly allow us more flexibility in choosing a site for the State jail.

The junior, senior high school is also outside the City. We feel that it is necessary to have this facility inside City limits because it is City-owned. Our water supply, Moonlight Springs, also should be brought into the City. The State airport should be part of the City of Nome. We are looking at an OCS sale in Sept., 1982. From all indications, the City of Nome and especially the airport, will be impacted by any exploration and development when it occurs. The City should be involved in the planning for this facility, not as a courtesy of the State, but as an integral part of the City's comprehensive plan and future development.

It is also important for you to realize that the City of Nome & the Seward Peninsula will soon be impacted by mineral development. There are 40% of the U.S. known tin reserves located just 210 miles northwest of Nome. Both Anaconda and Kennecott copper are actively discussing development of resources to the north and northeast of Nome. Other known minerals besides gold and silver are uranium, beryllium, fluorite tungsten, lead, zinc & copper. Sizeable coal deposits are also located here.

One of the key issues in this annexation is Alaska Gold's concern over taxation & ability to develop their holdings. All of the land to be annexed (except for the airport and a few hundred other acres) are in privately held mining claims. These undeveloped claims by State law can be taxed at the maximum rate of \$20 per 200 acres. Any development that takes place could be better controlled if it were in the City since the majority of their holdings are currently in the unorganized borough without any planning at all.

A concern of the natives was that they desire to control their own land. The Boundary Commission took that concern & others into consideration and cut the City's request from 235 sq. mi. to 17.83 sq. mi. This annexation would enlarge the City from its present .85 sq. mi. and make us a total of 18.68 sq. mi., certainly not a huge entity that many organizations were originally concerned about.

I have already described many of the consequences of our not being allowed to annex. There are more that I will not go into. Hopefully, you will understand our plight and not take action to destroy our opportunity to positively plan for our future. As you are aware, if this annexation is disapproved by the legislature, then the City of Nome will remain .85 sq. mi. in size.

Thank you.

STATE OF ALASKA
LOCAL BOUNDARY COMMISSION

Petition for annex-)
ation of territory)
to the City of Nome)

STATEMENT OF DECISION

WHEREAS, on July 14, 1980 the City of Nome submitted a petition to the Local Boundary Commission (hereinafter "Commission") through the Alaska Department of Community and Regional Affairs (hereinafter "Department") in accordance with applicable laws and regulations of the State of Alaska, requesting the annexation of approximately 235.65 square miles; and

WHEREAS, on July 25, 1980 the Department determined the petition to be acceptable as to form and content; and

WHEREAS, the Department caused to be published, proper notice of filing of the petition for annexation; and

WHEREAS, on November 21, 1980 the Commission conducted a physical inspection of the area proposed for annexation and held a public hearing, with prescribed notice, on the petition for annexation; and

WHEREAS, on December 11, 1980 the Commission held, with prescribed notice, a meeting to render a decision on the petition for annexation;

NOW, THEREFORE, based upon the extensive briefings of the Petitioner and the Respondents, the investigation and the report as amended by the Department, the physical inspection of the territory by two members of the Commission, and the information obtained from the public hearing, the Commission makes the following findings of fact and enters its decision pursuant thereto:

Much of the area proposed for annexation by the City of Nome is uninhabited, unlikely to be developed in the foreseeable future, and does not otherwise satisfy the standards for annexation set forth in 19 AAC 05.010. However, the territory described on page six of this Statement of Decision, and outlined, approximately, in red on "Attachment A" to this Statement of Decision, warrants annexation to the present corporate boundaries of the City of Nome for the following reasons:

1. The territory is urban in character. Approximately 246 of the estimated 252 residents of the area proposed for annexation by the Petitioner reside in this territory. Virtually all of the population in the territory stems from actual growth of the City of

Nome beyond its legal boundaries, to the extent that approximately eight percent of the greater-Nome population is now found in the territory. Icy View, a large subdivision, is located in the territory. Most of the land is in private ownership. Much of the property has been mined by dredging, and is appropriately included within the territory to be annexed by reason of its suitability for prospective urban purposes due to the gravel base and melted permafrost. Some of the land in private ownership has been held for sale in the past.

2. The territory is in need of municipal services which the City of Nome can provide most efficiently. There is no other municipality in the region. The City of Nome is providing many services to the territory at the present time, and the City of Nome is capable of, and willing to extend additional services to the territory. The municipal services necessary to the territory include fire protection, law enforcement, schools and education, street maintenance and snow removal, solid waste disposal, water, electricity, animal control and health regulation.
3. The history of Nome and the present trend indicates that future growth and development of the community will likely occur within the territory. Potential development of remaining lots within the existing boundaries of the City

of Nome is hampered by extensive wetland problems, substantial private holdings not for sale during the past decades, and the availability of more attractive lots for development on melted permafrost at such locations as Icy View Subdivision. Annexation of the territory will enable the City of Nome to plan for and control that development which has occurred, and which will continue to occur within the territory.

4. The health and safety of City residents presently is endangered by problems relating to animal control, flood control, fire protection, law enforcement, and solid waste disposal existing in the territory. Annexation will alleviate these conditions by expanding enforcement jurisdiction enabling planning and regulation, and producing a tax base necessary for extending services to the territory.
5. The formal extension of police, fire protection, health, education and planning services to the territory is necessary to enable the City of Nome to provide adequate services to City residents. It is legally impossible and economically impractical for the City of Nome to extend these services effectively unless the territory is within the boundaries of the City.

6. Residents of, and owners of property in the territory receive the benefit of City services without commensurate tax contributions. These services include education and schools, fire protection and solid waste disposal. Differential pricing of water and electrical utilities, where in effect, does not contribute to the bonding base necessary to replace or upgrade aging capital facilities. No alternative method for offsetting the costs of providing services has been found satisfactory to the Department or this Commission.
7. The annexation is otherwise necessary to accomplish the valid public purpose of enfranchising the residents of the territory who are already receiving substantial services without participation in government. Annexation of the territory is also necessary to accomplish the valid public purpose of unifying the educational jurisdiction of the public school system. More generally, annexation is necessary to accomplish the public purpose of promoting a sense of community in the entire Nome area.
8. The Commission finds as further support for annexation of the territory described below, the statement of facts pertaining thereto by the Petitioner and the Department.

THEREFORE, the Commission hereby approves and will recommend to the First Session of the Twelfth Legislature of the State of Alaska, annexation of the following described territory to the City of Nome:

Beginning at the protracted NW corner of Section 11, T11S, R34W, Kateel River Meridian; thence east to the protracted NE corner of Section 7, T11S, R33W, K.R.M.; thence south to the protracted SE corner of Section 31, T11S, R33W, K.R.M.; thence continuing south along the same line to a point 4,000 feet seaward of the mean high tide line of Norton Sound; thence meandering northwesterly along a line 4,000 feet seaward of and paralleling the mean high tide line of Norton Sound to a point due south of the protracted SW corner of the SE 1/4 of the SE 1/4 of Section 28, T11S, R34W, K.R.M.; thence north to the protracted NW corner of the NE 1/4 of the NE 1/4 of Section 21, T11S, R34W, K.R.M.; thence east to the protracted SE corner of Section 15, T11S, R34W, K.R.M.; thence north to the protracted NW corner of Section 11, T11S, R34W, K.R.M., the point of beginning, excluding the existing boundaries of the City of Nome, containing 17.83 square miles, more or less, situated in the Second Judicial District, State of Alaska, as outlined, approximately, in red on "Attachment A" hereto.

Decided this 11th Day of December, 1980.

LOCAL BOUNDARY COMMISSION

By:

Sheila Gallagher
Sheila Gallagher, Chairman

A Short History of the Proposed Annexation
of Territory to the City of Nome

1968. Nome annexes approximately 14 square miles of territory.

1971. The Alaska Supreme Court invalidates the annexation on the grounds that the Local Boundary Commission had not promulgated standards for annexation.

August 28, 1978. Nome City Council adopts an ordinance authorizing the annexation of certain territory.

July 14, 1980. City of Nome petitions for the annexation of 235.65 square miles of land.

July 25, 1980. The petition is determined to be sufficient as to form and content and is accepted by the Department of Community and Regional Affairs.

Oct. 29, 1980. A report from the Department to the Local Boundary Commission recommends a smaller area of approximately 14 square miles be annexed.

November, 1980. The City Council passes a resolution to correct a discrepancy between the authorizing ordinance of August 28, 1978, and the petition of July 14, 1980, concerning the description of the land to be annexed.

Nov. 21, 1980. A public hearing is held in Nome. The petition is opposed by the Alaska Gold Company, Bering Straits Native Corp. and Sitnasuak Corp., all of which file extensive briefs stating various procedural and substantive objections.

Dec. 11, 1980. The Local Boundary Commission issues a statement of decision stating that the proposed annexation (235.65 square miles) does not meet the standards set forth in 19 AAC 05.010 (see attachment). However, the LBC decides that a smaller parcel of 17.8 square miles does meet the standards and should be annexed. The LBC notes in its decision that the annexation meets standards 3 through 9. 19 AAC 05.010 requires that one or more of the 9 standards must be met for annexation.

Most of the land belonging to the two Native Corporations is eliminated from annexation by the reduction of territory to the 17.8 square mile parcel. This largely removes the basis for opposition by these two groups.

The Alaska Gold Co., which has substantial holdings of land within the 17.8 square mile annexation, remains adamantly opposed to the annexation. In its post hearing brief, the Gold Co. alleges that:

1. the annexation petition is defective;
2. the LBC misapplied its standards;
3. the LBC made improper contacts with the city;
4. the LBC cannot independently alter an annexation petition; and
5. the only reason the City wishes to annex is to bring the Gold Co. within its taxing jurisdiction and that it has no plans to extend services to the annexed area.

TELECONFERENCE PROCEDURES

Participating in a teleconference is a relatively simple procedure, with only a few basic rules and protocols required for effective participation. Please note the following:

HAVE YOU SIGNED-IN? Witnesses and observers should complete sign-in sheets.

TO BEGIN A TELECONFERENCE Prior to the beginning of the telemeeting, the teleconference Moderator will poll each of the participating sites and share pertinent information. The teleconference is then turned over to the meeting/hearing Chairman, who calls the teleconference to order and proceeds with his or her agenda (which has previously been copied to each site).

ORDER OF APPEARANCE The Chairman will announce the order of witness participation, and call upon each site when appropriate.

TIME LIMITS The Chairman may request that testimony be limited to a certain length of time; it is important to participate within such constraints.

PROCEDURE When you are called upon to testify, take a chair at the nearest microphone, or, if you are already seated at the table, set the nearest mike in front of you. The Moderator will already have given instructions of the operation of the microphones.

Speak directly into the mike from a distance of about 3 inches.

Before beginning your testimony, state your name and who you are representing. Try to remember to identify yourself each time you speak.

Indicate to the Chairman when you have concluded your testimony.

There may be questions from the Chairman and/or other informational exchange between sites. Pause briefly before responding to questions, to allow for lag in voice transmission. The system will not accommodate two simultaneous conversations.

TESTIMONY FROM OTHER SITES Testimony from other sites can be heard at all times from your teleconference center. Mikes are open here only when witnesses are testifying, but since some of the people attending are interested in the testimony from other sites, please don't converse while other sites are "talking".

If you find it necessary to interject comment/response that is outside the planned agenda, to avoid undue interruption it is appropriate to signal or send a note to your Moderator, indicating your desire to so participate.

WRITTEN TESTIMONY Comments on bills, back-up material or other documentation on the teleconference may be sent to the LTN Coordinator, Pouch Y, Juneau 99811. If the teleconference is a public hearing, written testimony/material may be sent to the Legislative Committee Chairman, Pouch V, Juneau 99811.

FUTURE TELECONFERENCES Teleconferences are scheduled and coordinated through the Legislative Teleconference Coordinator, Room 30, Capitol, telephone 465-4890.

*****TELECONFERENCES ARE NOT DIFFERENT FROM FACE-TO-FACE MEETINGS WHERE IT IS IMPORTANT TO FOLLOW THE ACENDA AND THE TOPIC. IF BACK-UP MATERIAL HAS BEEN PROVIDED PRIOR TO THE CONFERENCE, BE SURE TO FAMILIARIZE YOURSELF WITH IT, SO AS TO AVOID STRAYING FROM THE SUBJECT MATTER AND THUS CAUSING DELAY OR DETRACTING FROM THE MEETING.*****

TO: CINDA
3875

MSG 81-00004863 PRTY 1 02/17/81 12:14:34 ORIG: LN00 IN= 0002 OUT= 0027
FROM: CARY IN NOME TO: DEBORAH
TARGET: LHM2 SUBJ: PERSONS TESTIFYING NOME T/C 2/17/81 PAGE 0001

THE FOLLOWING PERSONS WILL BE TESTIFYING TODAY:

LINDA CONLEY-----CITY CLERK
VIRGINIA WHITE-----COUNCILWOMAN
ROSEMARY PHILLIPS--COUNCILWOMAN
LEO RASMUSSEN-----MAYOR
ROBERT BALDWIN-----MANAGER, ALASKA GOLD CO.
DAN KARMUN-----BOARD MEMBER, NOME PUBLIC SCHOOLS
BILL RUDLY-----ATTORNEY, ALASKA GOLD CO. (WOULD LIKE TO TESTIFY LAST)

WE ARE EXPECTING ABOUT 20 PEOPLE...BUT THIS IS ALL WHO HAVE SIGNED UP.

TELECONFERENCE PROCEDURES

Participating in a teleconference is a relatively simple procedure, with only a few basic rules and protocols required for effective participation. Please note the following:

HAVE YOU SIGNED-IN? Witnesses and observers should complete sign-in sheets.

TO BEGIN A TELECONFERENCE Prior to the beginning of the telemeeting, the teleconference Moderator will poll each of the participating sites and share pertinent information. The teleconference is then turned over to the meeting/hearing Chairman, who calls the teleconference to order and proceeds with his or her agenda (which has previously been copied to each site).

ORDER OF A PEARANCE The Chairman will announce the order of witness participation, and call upon each site when appropriate.

TIME LIMITS The Chairman may request that testimony be limited to a certain length of time; it is important to participate within such constraints.

PROCEDURE When you are called upon to testify, take a chair at the nearest microphone, or, if you are already seated at the table, set the nearest mike in front of you. The Moderator will already have given instructions of the operation of the microphones.

Speak directly into the mike from a distance of about 3 inches.

Before beginning your testimony, state your name and who you are representing. Try to remember to identify yourself each time you speak.

Indicate to the Chairman when you have concluded your testimony.

There may be questions from the Chairman and/or other informational exchange between sites. Pause briefly before responding to questions, to allow for lag in voice transmission. The system will not accommodate two simultaneous conversations.

TESTIMONY FROM OTHER SITES Testimony from other sites can be heard at all times from your teleconference center. Mikes are open here only when witnesses are testifying, but since some of the people attending are interested in the testimony from other sites, please don't converse while other sites are "talking".

If you find it necessary to interject comment/response that is outside the planned agenda, to avoid undue interruption it is appropriate to signal or send a note to your Moderator, indicating your desire to so participate.

WRITTEN TESTIMONY Comments on bills, back-up material or other documentation on the teleconference may be sent to the LTN Coordinator, Pouch Y, Juneau 99811. If the teleconference is a public hearing, written testimony/material may be sent to the Legislative Committee Chairman, Pouch V, Juneau 99811.

FUTURE TELECONFERENCES Teleconferences are scheduled and coordinated through the Legislative Teleconference Coordinator, Room 30, Capitol, telephone 465-4890.

*****TELECONFERENCES ARE NOT DIFFERENT FROM FACE-TO-FACE MEETINGS WHERE IT IS IMPORTANT TO FOLLOW THE AGENDA AND THE TOPIC. IF BACK-UP MATERIAL HAS BEEN PROVIDED PRIOR TO THE CONFERENCE, BE SURE TO FAMILIARIZE YOURSELF WITH IT, SO AS TO AVOID STRAYING FROM THE SUBJECT MATTER AND THUS CAUSING DELAY OR DETRACTING FROM THE MEETING.*****

TELECONFERENCE PROCEDURES

Participating in a teleconference is a relatively simple procedure, with only a few basic rules and protocols required for effective participation. Please note the following:

HAVE YOU SIGNED-IN? Witnesses and observers should complete sign-in sheets.

TO BEGIN A TELECONFERENCE Prior to the beginning of the telemeeting, the teleconference Moderator will poll each of the participating sites and share pertinent information. The teleconference is then turned over to the meeting/hearing Chairman, who calls the teleconference to order and proceeds with his or her agenda (which has previously been copied to each site).

ORDER OF APPEARANCE The Chairman will announce the order of witness participation, and call upon each site when appropriate.

TIME LIMITS The Chairman may request that testimony be limited to a certain length of time; it is important to participate within such constraints.

PROCEDURE When you are called upon to testify, take a chair at the nearest microphone, or, if you are already seated at the table, set the nearest mike in front of you. The Moderator will already have given instructions of the operation of the microphones.

Speak directly into the mike from a distance of about 3 inches.

Before beginning your testimony, state your name and who you are representing. Try to remember to identify yourself each time you speak.

Indicate to the Chairman when you have concluded your testimony.

There may be questions from the Chairman and/or other informational exchange between sites. Pause briefly before responding to questions, to allow for lag in voice transmission. The system will not accommodate two simultaneous conversations.

TESTIMONY FROM OTHER SITES Testimony from other sites can be heard at all times from your teleconference center. Mikes are open here only when witnesses are testifying, but since some of the people attending are interested in the testimony from other sites, please don't converse while other sites are "talking".

If you find it necessary to interject comment/response that is outside the planned agenda, to avoid undue interruption it is appropriate to signal or send a note to your Moderator, indicating your desire to so participate.

WRITTEN TESTIMONY Comments on bills, back-up material or other documentation on the teleconference may be sent to the LTN Coordinator, Pouch Y, Juneau 99811. If the teleconference is a public hearing, written testimony/material may be sent to the Legislative Committee Chairman, Pouch V, Juneau 99811.

FUTURE TELECONFERENCES Teleconferences are scheduled and coordinated through the Legislative Teleconference Coordinator, Room 30, Capitol, telephone 465-4890.

*****TELECONFERENCES ARE NOT DIFFERENT FROM FACE-TO-FACE MEETINGS WHERE IT IS IMPORTANT TO FOLLOW THE AGENDA AND THE TOPIC. IF BACK-UP MATERIAL HAS BEEN PROVIDED PRIOR TO THE CONFERENCE, BE SURE TO FAMILIARIZE YOURSELF WITH IT, SO AS TO AVOID STRAYING FROM THE SUBJECT MATTER AND THUS CAUSING DELAY OR DETRACTING FROM THE MEETING.*****

A Short History of the Proposed Annexation
of Territory to the City of Nome

1968. Nome annexes approximately 14 square miles of territory.

1971. The Alaska Supreme Court invalidates the annexation on the grounds that the Local Boundary Commission had not promulgated standards for annexation.

August 28, 1978. Nome City Council adopts an ordinance authorizing the annexation of certain territory.

July 14, 1980. City of Nome petitions for the annexation of 235.65 square miles of land.

July 25, 1980. The petition is determined to be sufficient as to form and content and is accepted by the Department of Community and Regional Affairs.

Oct. 29, 1980. A report from the Department to the Local Boundary Commission recommends a smaller area of approximately 14 square miles be annexed.

November, 1980. The City Council passes a resolution to correct a discrepancy between the authorizing ordinance of August 28, 1978, and the petition of July 14, 1980, concerning the description of the land to be annexed.

Nov. 21, 1980. A public hearing is held in Nome. The petition is opposed by the Alaska Gold Company, Bering Straits Native Corp. and Sitnasuak Corp., all of which file extensive briefs stating various procedural and substantive objections.

Dec. 11, 1980. The Local Boundary Commission issues a statement of decision stating that the proposed annexation (235.65 square miles) does not meet the standards set forth in 19 AAC 05.010 (see attachment). However, the LBC decides that a smaller parcel of 17.8 square miles does meet the standards and should be annexed. The LBC notes in its decision that the annexation meets standards 3 through 9. 19 AAC 05.010 requires that one or more of the 9 standards must be met for annexation.

Most of the land belonging to the two Native Corporations is eliminated from annexation by the reduction of territory to the 17.8 square mile parcel. This largely removes the basis for opposition by these two groups.

The Alaska Gold Co., which has substantial holdings of land within the 17.8 square mile annexation, remains adamantly opposed to the annexation. In its post hearing brief, the Gold Co. alleges that:

1. the annexation petition is defective;
2. the LBC misapplied its standards;
3. the LBC made improper contacts with the city;
4. the LBC cannot independently alter an annexation petition; and
5. the only reason the City wishes to annex is to bring the Gold Co. within its taxing jurisdiction and that it has no plans to extend services to the annexed area.

Linda:

Have say this really
goes to you.

Betty
Sen. Gilman's
office

TO: LINDA ~~W~~ GIEY
S. CNTY 3 REG. AFFAIRS
BETHLEHEM, PA 203

[Handwritten signature]

TELECONFERENCE HEARINGS



SEND TO LINDA

TELECONFERENCE CONTACT SHEET

TAKEN BY DEBORAH

TOPIC: LOCAL BOUNDARY BE COMMISSION REPORT - ANNEXATION TO CITY OF NOME

CONTACT LINDA OTEY

PHONE 465-3875

COMMITTEE: JOINT SENATE & HOUSE COMMUNITY & REGIONAL AFFAIRS

DATE SCHEDULED 2/9/81

DATE: 2/17/81 DAY: TUESDAY

LOCATION NOME

TIME: 12:00 P.M. (AST) SCHEDULED DURATION: 2 hrs
3:00 P.M. (PST)

MODERATOR POLLINS

SITES PARTICIPATING: JNU; NOME, ANCH

CONFERENCE MODE: Audio Video

PUBLICITY:

PERSONS PARTICIPATING

SITE

Invitational

Committee making contacts

PSAs date quantity

News Release date quantity

Summary to be provided

Text to be provided

Quotes to be provided

Direct Mail date quantity

Phone LOCAL CONTACTS/MEDIA date quantity

Post at Info. Office

Post other local locations

SPECIAL NOTES:

* BACK-UP INFO (COMM REPORT) WILL BE SENT

* PLEASE CALL MEDIA SOURCES A.S.A.P.

JUNEAU LOCATION:

BEHREND'S BLDG, 1st FL. CONF. RM

586-1062

POST-TELECONFERENCE NOTE:

Participants _____

Observers _____

Total _____

Alaska State Legislature

TELECONFERENCE HEARINGS



DATE: 2/17/81

LOCATION: NOME

SUBJECT: NOME ASSOCIATION

NAME	REPRESENTING	ADDRESS	PHONE	HERE TO OBSERVE	HERE TO TESTIFY
Finca E. Conly	City of Nome	Box 281 - Nome	443-5242		X
Leo B. Rasmussen	CITY OF NOME	Box 2 Nome	443-2919 or 2198		X
Bill Ruddy	AK Gold	Box 1211 Juneau	586-3340		X
ROBERT F. BALDWIN	ALASKA GOLD	Box 640 Nome	443-5272		X
+ STANLEY SUMMERS	KICU AM/FM	Box 820 Nome	443-2213	X	
ROBERT WALSH	Wien	Box 730 NOME	443-2322		X <small>DID NOT TESTIFY (LATELY)</small>
Dorise Widom	City - Nome	Box 1510 - Nome	443-5554	X	
Ernest Charles Wheeler	Super Subd. - Nome	Box 190 Nome	443-5533		X
Vernon Kuznetsov	Self - Village	Box 833 Nome			X
John I. Pulluck	King Island Native	Box 992	443-5497	X	X
Walter P. Jensen	Bering Stg. Native Corp	Box 1008 Nome	443-5252	X	

Alaska State Legislature

TELECONFERENCE HEARINGS



DATE: 2/17/81

LOCATION: NOME

SUBJECT: NOME

ANNEXATION

NAME	REPRESENTING	ADDRESS	PHONE	HERE TO OBSERVE	HERE TO TESTIFY
Doug Doyle ✓	C M Reader	Box 355 Nome	2315		X
Allan H. Dye ✓	Self	Box 146 Nome	2306		✓
Bob Reshaw ✓	Self	Box 671 Nome	2198		✓
Judy McKeown ✓	Family	Box 52 Nome	2508		X
John M. Poling ✓	Self	Box 578 Nome	2459		X
Jim McLaughlin -	St Pauls	Box 990	5377	X	
Wanda C. Johnson ✓	Nome School Board	Box 59	2111		X
Regina White ✓	City	Box 55	2574		X
Chuck Dinger -	Self	Box 124	2932	✓	
Rosemary Arcus ✓	Gov + Staff	Box 370	2565		✓
Charles Johnson ✓	Bering Straights Native Corp	Box 1005	5252		X

TELECONFERENCE HEARINGS



DATE: 2/17/81

LOCATION: NOME

SUBJECT: NOME
ANNEXATION

NAME	REPRESENTING	ADDRESS	PHONE	HERE TO OBSERVE	HERE TO TESTIFY
NEAL R FOSTER ✓	AIRTAXIS Nome STATE AIRPORT	STATE AIRPORT Nome	443 5292	X	X
Thom Frank	Alaska Miners Assoc.	Box 638 Nome	443- 2847	DID NOT TESTIFY X	X
Linda J Ellanna -	myself	Box 1538, Nome	443- 215383	X	
Bob Weisinger -	MEDIA KNOM RADIO	Box 988 Nome AK 99762	443- 2777	X	
Ava Sawyer	Self	Box 280, Nome	443 5515	X	DID NOT TESTIFY X
James Loucheux -	Self	Box 280 Nome	443- 5515	X	
John E. Hansen	SNC & Self	Box 905 Nome	443- 5226	X	

TELECONFERENCE HEARINGS



EVALUATION FORM

Please check the appropriate responses:

1) I have participated in other legislative teleconferences...

No Yes () If "yes", how many? _____

2) I used the Network as a representative of...

- Myself _____
- Organized group _____
- Business _____
- Local government _____
- State agency _____
- Federal agency _____

3) I learned of this teleconference hearing...

- Advised by legislator(s) _____
- Advised by information office _____
- Newspaper story _____
- Radio announcement _____
- Television news _____
- Other _____

4) I would have participated in legislative hearings if the network was not available...

Yes No

5) If "yes" to 4) above, I used the network...

- Instead of travel _____
- Instead of phone conversations _____
- Instead of mailed testimony _____

6) Please use the reverse side for comments or suggestions you would like to make...

OPTIONAL

Name Judy Mortensen
 Address Box 52 - Nome
 Phone 2598

TELECONFERENCE HEARINGS



EVALUATION FORM

Please check the appropriate responses:

1) I have participated in other legislative teleconferences...
No () Yes () If "yes", how many? _____

2) I used the Network as a representative of...
Myself _____ ()
Organized group _____ ()
Business _____ ()
Local government _____ ()
State agency _____ ()
Federal agency _____ ()

3) I learned of this teleconference hearing...
Advised by legislator(s) _____ ()
Advised by information office _____ ()
Newspaper story _____ (✓)
Radio announcement _____ (✓)
Television news _____ ()
Other _____ ()

4) I would have participated in legislative hearings if the network was not available...
Yes (✓) No ()

5) If "yes" to 4) above, I used the network...
Instead of travel _____ ()
Instead of phone conversations _____ ()
Instead of mailed testimony _____ ()

6) Please use the reverse side for comments or suggestions you would like to make...

OPTIONAL

Name Walter H. Anderson
Address Box 67 Nome
Phone 947-2108

TELECONFERENCE HEARINGS



EVALUATION FORM

Please check the appropriate responses:

1) I have participated in other legislative teleconferences...

No () Yes () If "yes", how many? _____

2) I used the Network as a representative of...

- Myself _____ ()
- Organized group _____ ()
- Business _____ ()
- Local government _____ ()
- State agency _____ ()
- Federal agency _____ ()

3) I learned of this teleconference hearing...

- Advised by legislator(s) _____ ()
- Advised by information office _____ ()
- Newspaper story _____ ()
- Radio announcement _____ ()
- Television news _____ ()
- Other _____ ()

4) I would have participated in legislative hearings if the network was not available...

Yes () No ()

5) If "yes" to 4) above, I used the network...

- Instead of travel _____ ()
- Instead of phone conversations _____ ()
- Instead of mailed testimony _____ ()

6) Please use the reverse side for comments or suggestions you would like to make...

OPTIONAL

Name Dan...

Address ...

Phone ...

TELECONFERENCE HEARINGS



EVALUATION FORM

Please check the appropriate responses:

1) I have participated in other legislative teleconferences...

No (X)

Yes ()

If "yes", how many? _____

2) I used the Network as a representative of...

- Myself _____ ()
- Organized group _____ ()
- Business _____ (X)
- Local government _____ ()
- State agency _____ ()
- Federal agency _____ ()

3) I learned of this teleconference hearing...

- Advised by legislator(s) _____ ()
- Advised by information office _____ (X)
- Newspaper story _____ ()
- Radio announcement _____ ()
- Television news _____ ()
- Other _____ ()

4) I would have participated in legislative hearings if the network was not available...

Yes (X)

No ()

5) If "yes" to 4) above, I used the network...

- Instead of travel _____ (X)
- Instead of phone conversations _____ (X)
- Instead of mailed testimony _____ (X)

6) Please use the reverse side for comments or suggestions you would like to make...

OPTIONAL

Name AR FOSTER

Address Name

Phone 4435292

TELECONFERENCE HEARINGS



EVALUATION FORM

Please check the appropriate responses:

1) I have participated in other legislative teleconferences...

No ()

Yes (X)

If "yes", how many? 4

2) I used the Network as a representative of...

- Myself _____ ()
- Organized group _____ (X)
- Business _____ ()
- Local government _____ ()
- State agency _____ ()
- Federal agency _____ ()

3) I learned of this teleconference hearing...

- Advised by legislator(s) _____ ()
- Advised by information office _____ (X)
- Newspaper story _____ ()
- Radio announcement _____ ()
- Television news _____ ()
- Other _____ ()

4) I would have participated in legislative hearings if the network were not available...

Yes (X)

No ()

5) If "yes" to 4) above, I used the network...

- Instead of travel _____ (X)
- Instead of phone conversations _____ ()
- Instead of mailed testimony _____ (X)

6) Please use the reverse side for comments or suggestions you would like to make...

OPTIONAL

Name Charles Johnson

Address Box 1018 Nome AK

Phone 443 5252

TELECONFERENCE HEARINGS



EVALUATION FORM

Please check the appropriate responses:

1) I have participated in other legislative teleconferences...

No ()

Yes (X)

If "yes", how many? 1

2) I used the Network as a representative of...

Myself _____ ()

Organized group _____ ()

Business _____ ()

Local government _____ (X)

State agency _____ ()

Federal agency _____ ()

3) I learned of this teleconference hearing...

Advised by legislator(s) _____ (X)

Advised by information office _____ ()

Newspaper story _____ ()

Radio announcement _____ ()

Television news _____ ()

Other _____ ()

4) I would have participated in legislative hearings if the network was not available...

Yes ()

No (X)

5) If "yes" to 4) above, I used the network...

Instead of travel _____ (X)

Instead of phone conversations _____ ()

Instead of mailed testimony _____ ()

6) Please use the reverse side for comments or suggestions you would like to take...

OPTIONAL

Name _____

Address _____

Phone _____

TELECONFERENCE HEARINGS



EVALUATION FORM

Please check the appropriate responses:

1) I have participated in other legislative teleconferences...
No (X) Yes () If "yes", how many? _____

2) I used the Network as a representative of...
Myself _____ ()
Organized group _____ ()
Business _____ (X)
Local government _____ ()
State agency _____ ()
Federal agency _____ ()

3) I learned of this teleconference hearing...
Advised by legislator(s) _____ ()
Advised by information of office _____ (X)
Newspaper story _____ ()
Radio announcement _____ ()
Television news _____ ()
Other _____ ()

4) I would have participated in legislative hearings if the network was not available...
Yes () No (X)

5) If "yes" to 4) above, I used the network...
Instead of travel _____ ()
Instead of phone conversations _____ ()
Instead of mailed testimony _____ ()

6) Please use the reverse side for comments or suggestions you would like to make...

OPTIONAL
Name: Douglas A. Doyle for CM Reader
Address: Box 355 Name _____
Phone: 443-2315

TELECONFERENCE HEARINGS



EVALUATION FORM

Please check the appropriate responses:

1) I have participated in other legislative teleconferences...
No () Yes () If "yes", how many? _____

2) I used the Network as a representative of...
Myself _____ ()
Organized group _____ ()
Business _____ ()
Local government _____ ()
State agency _____ ()
Federal agency _____ ()

3) I learned of this teleconference hearing...
Advised by legislator(s) _____ ()
Advised by information office _____ ()
Newspaper story _____ ()
Radio announcement _____ ()
Television news _____ ()
Other Self _____ ()

4) I would have participated in legislative hearings if the network was not available...
Yes () No () ?

5) If "yes" to 4) above, I used the network...
Instead of travel _____ ()
Instead of phone conversations _____ ()
Instead of mailed testimony _____ ()

6) Please use the reverse side for comments or suggestions you would like to make...

OPTIONAL

Name ROBERT WALSH
Address Box 1031 NOME, AK
Phone 443-2953

TELECONFERENCE HEARINGS



EVALUATION FORM

Please check the appropriate responses:

1) I have participated in other legislative teleconferences...
No () Yes () If "yes", how many: _____

2) I used the Network as a representative of...
Myself _____ ()
Organized group _____ ()
Business _____ ()
Local government _____ ()
State agency _____ ()
Federal agency _____ ()

3) I learned of this teleconference hearing...
Advised by legislator(s) _____ ()
Advised by information office _____ ()
Newspaper story _____ ()
Radio announcement _____ ()
Television news _____ ()
Other _____ ()

4) I would have participated in legislative hearings if the network was not available...
Yes () No ()

5) If "yes" to 4) above, I used the network...
Instead of travel _____ ()
Instead of phone conversations _____ ()
Instead of mailed testimony _____ ()

6) Please use the reverse side for comments or suggestions you would like to make...

OPTIONAL

Name _____

Address _____

Phone _____

TELECONFERENCE HEARINGS



EVALUATION FORM

Please check the appropriate responses:

1) I have participated in other legislative teleconferences...
No () Yes (X) If "yes", how many? several

2) I used the Network as a representative of...
Myself _____ (X)
Organized group _____ (X)
Business _____ ()
Local government _____ ()
State agency _____ ()
Federal agency _____ ()

3) I learned of this teleconference hearing...
Advised by legislator(s) _____ ()
Advised by information office _____ ()
Newspaper story _____ ()
Radio announcement _____ ()
Television news _____ ()
Other _____ (X)

4) I would have participated in legislative hearings if the network was not available...
Yes () No (X)

5) If "yes" to 4) above, I used the network...
Instead of travel _____ ()
Instead of phone conversations _____ ()
Instead of mailed testimony _____ ()

6) Please use the reverse side for comments or suggestions you would like to make...

OPTIONAL

Name L. Ann Fitzgerald
Address Box 833 Nome, AK 99762
Phone _____

TELECONFERENCE HEARINGS



EVALUATION FORM

Please check the appropriate responses:

1) I have participated in other legislative teleconferences...

No ()

Yes (X)

If "yes", how many? 1

2) I used the Network as a representative of...

- Myself _____ ()
- Organized group _____ (X)
- Business _____ ()
- Local government _____ ()
- State agency _____ ()
- Federal agency _____ ()

3) I learned of this teleconference hearing...

- Advised by legislator(s) _____ ()
- Advised by information office _____ (X)
- Newspaper story _____ ()
- Radio announcement _____ ()
- Television news _____ ()
- Other _____ ()

4) I would have participated in legislative hearings if the network was not available...

Yes (X)

No ()

5) If "yes" to 4) above, I used the network...

- Instead of travel _____ (X)
- Instead of phone conversations _____ ()
- Instead of mailed testimony _____ ()

6) Please use the reverse side for comments or suggestions you would like to make...

OPTIONAL:

Name

John I. Pullack

Address

Box 992 Nome

Phone

493-5494

TELECONFERENCE HEARINGS



EVALUATION FORM

Please check the appropriate responses:

1) I have participated in other legislative teleconferences...
No () Yes () If "yes", how many? _____

2) I used the Network as a representative of...
Myself _____ ()
Organized group _____ ()
Business _____ ()
Local government _____ ()
State agency _____ ()
Federal agency _____ ()

3) I learned of this teleconference hearing...
Advised by legislator(s) _____ ()
Advised by information of office _____ ()
Newspaper story _____ ()
Radio announcement _____ ()
Television news _____ ()
Other _____ ()

4) I would have participated in legislative hearings if the network was not available...
Yes () No ()

5) If "yes" to 4) above, I used the network...
Instead of travel _____ ()
Instead of phone conversations _____ ()
Instead of mailed testimony _____ ()

6) Please use the reverse side for comments or suggestions you would like to make...

OPTIONAL

Name _____

Address _____

Phone _____

TELECONFERENCE HEARINGS



EVALUATION FORM

Please check the appropriate responses:

1) I have participated in other legislative teleconferences...

No (X)

Yes ()

If "yes", how many? _____

2) I used the Network as a representative of...

- Myself _____ ()
- Organized group _____ ()
- Business _____ ()
- Local government _____ ()
- State agency _____ ()
- Federal agency _____ ()

3) I learned of this teleconference hearing...

- Advised by legislator(s) _____ ()
- Advised by information office _____ (X)
- Newspaper story _____ ()
- Radio announcement _____ ()
- Television news _____ ()
- Other _____ ()

4) I would have participated in legislative hearings if the network was not available...

Yes (X)

No ()

5) If "yes" to 4) above, I used the network...

- Instead of travel _____ ()
- Instead of phone conversations _____ (X)
- Instead of mailed testimony _____ ()

6) Please use the reverse side for comments or suggestions you would like to make...

OPTIONAL

Name _____

Mr. F. Robinson

Address _____

Box 640 Nome

Phone _____

443-5272

TELECONFERENCE HEARINGS



EVALUATION FORM

Please check the appropriate responses:

1) I have participated in other legislative teleconferences...

No ()

Yes

If "yes", how many? _____

2) I used the Network as a representative of...

- Myself _____
- Organized group _____ ()
- Business _____ ()
- Local government _____ ()
- State agency _____ ()
- Federal agency _____ ()

3) I learned of this teleconference hearing...

- Advised by legislator(s) _____ ()
- Advised by information office _____
- Newspaper story _____ ()
- Radio announcement _____ ()
- Television news _____ ()
- Other _____ ()

4) I would have participated in legislative hearings if the network was not available...

Yes

No ()

5) If "yes" to 4) above, I used the network...

- Instead of travel _____ ()
- Instead of phone conversations _____ ()
- Instead of mailed testimony _____

6) Please use the reverse side for comments or suggestions you would like to make...

OPTIONAL

Name

R. P. White

Address

Box 190 Nome AK 99762

Phone

443-5533

TELECONFERENCE HEARINGS



EVALUATION FORM

Please check the appropriate responses:

1) I have participated in other legislative teleconferences...
No () Yes (X) If "yes", how many? _____

9 times in 1978

2) I used the Network as a representative of...

- Myself _____ (X)
- Organized group _____ (X)
- Business _____ (X)
- Local government _____ (X)
- State agency _____ (X)
- Federal agency _____ (X)

3) I learned of this teleconference hearing...

- Advised by legislator(s) _____ (X)
- Advised by information office _____ (X)
- Newspaper story _____ (X)
- Radio announcement _____ (X)
- Television news _____ (X)
- Other _____ (X)

4) I would have participated in legislative hearings if the network was not available...

Yes (X) No ()

5) If "yes" to 4) above, I used the network...

- Instead of travel _____ (X)
- Instead of phone conversations _____ (X)
- Instead of mailed testimony _____ (X)

6) Please use the reverse side for comments or suggestions you would like to make...

OPTIONAL

Name LEO B. RASMUSSEN

Address Box 2 - Noone

Phone 443-2919 or 2798

TELECONFERENCE HEARINGS



EVALUATION FORM

Please check the appropriate responses:

1) I have participated in other legislative teleconferences...

No ()

Yes (X)

If "yes", how many? 2

2) I used the Network as a representative of...

- Myself _____ (X)
- Organized group _____ (X)
- Business _____ ()
- Local government _____ (X)
- State agency _____ ()
- Federal agency _____ ()

3) I learned of this teleconference hearing...

- Advised by legislator(s) _____ ()
- Advised by information office _____ (X)
- Newspaper story _____ ()
- Radio announcement _____ ()
- Television news _____ ()
- Other _____ ()

4) I would have participated in legislative hearings if the network was not available...

Yes (X)

No ()

5) If "yes" to 4) above, I used the network...

- Instead of travel _____ (X)
- Instead of phone conversations _____ (X)
- Instead of mailed testimony _____ (X)

6) Please use the reverse side for comments or suggestions you would like to make...

OFFICIAL:

Name _____

Linda E Conley, City Clerk

Address _____

City of Nome, Alaska

Phone _____

943-5242

TELECONFERENCE HEARINGS



This proceeding may be broadcast live or recorded
for later broadcast by radio or television stations.
I consent to this broadcast or recording for later
broadcast.

Location of
Teleconference Nome

Date 2-17-81

Signed [Signature]

TELECONFERENCE HEARINGS



This proceeding may be broadcast live or recorded
for later broadcast by radio or television stations.
I consent to this broadcast or recording for later
broadcast.

Location of
Teleconference Nome, AK

Date 2-17-81

Signed Virginia White

TELECONFERENCE HEARINGS



This proceeding may be broadcast live or recorded
for later broadcast by radio or television stations.
I consent to this broadcast or recording for later
broadcast.

Location of
Teleconference

None

Date

17~~8~~ Feb 81

Signed

[Signature]

TELECONFERENCE HEARINGS



This proceeding may be broadcast live or recorded
for later broadcast by radio or television stations.
I consent to this broadcast or recording for later
broadcast.

Location of
Teleconference Nome

Date 2-17-81

Signed Linda E. Conley

Alaska State Legislature

TELECONFERENCE HEARINGS



This proceeding may be broadcast live or recorded
for later broadcast by radio or television stations.
I consent to this broadcast or recording for later
broadcast.

Location of
Teleconference None AK

Date 2-16-81

Signed Chels NG

Alaska State Legislature

TELECONFERENCE HEARINGS



This proceeding may be broadcast live or recorded
for later broadcast by radio or television stations.
I consent to this broadcast or recording for later
broadcast.

Location of
Teleconference

Nome

Date

Feb 17, 1981

Signed

Garrett R. Cameron Jr

TELECONFERENCE HEARINGS



This proceeding may be broadcast live or recorded
for later broadcast by radio or television stations.
I consent to this broadcast or recording for later
broadcast.

Location of
Teleconference

Nome

Date

2/17/71

Signed

Robert G. Rossman

TELECONFERENCE HEARINGS



This proceeding may be broadcast live or recorded
for later broadcast by radio or television stations.
I consent to this broadcast or recording for later
broadcast.

Location of
Teleconference

None

Date

17 Feb 81

Signal

Paul Foster

near R FOSTER

TELECONFERENCE HEARINGS



This proceeding may be broadcast live or recorded
for later broadcast by radio or television stations.
I consent to this broadcast or recording for later
broadcast.

Location of
Teleconference None

Date 2-17-84

Signature Judy Matheson

TELECONFERENCE HEARINGS



This proceeding may be broadcast live or recorded
for later broadcast by radio or television stations.
I consent to this broadcast or recording for later
broadcast.

Location of
Teleconference

Name

Date

2-17-81

Signed

Allan G. Drake

TELECONFERENCE HEARINGS



This proceeding may be broadcast live or recorded
for later broadcast by radio or television stations.
I consent to this broadcast or recording for later
broadcast.

Location of
Teleconference

Nome

Date

2/17/81

Signature

Sam K. ...

TELECONFERENCE HEARINGS



This proceeding may be broadcast live or recorded
for later broadcast by radio or television stations.
I consent to this broadcast or recording for later
broadcast.

Location of
Teleconference

Nome

Date

2/17/81

Signed

[Handwritten Signature]

TELECONFERENCE HEARINGS



This proceeding may be broadcast live or recorded
for later broadcast by radio or television stations.
I consent to this broadcast or recording for later
broadcast.

Location of
Teleconference

Nome

Date

2-17-81

Signed

J. J. Bell

TELECONFERENCE HEARINGS



This proceeding may be broadcast live or recorded
for later broadcast by radio or television stations.
I consent to this broadcast or recording for later
broadcast.

Location of
Teleconference

Nome

Date

2-17-81

Signed

Terrence S. Strydom

TELECONFERENCE HEARINGS



This proceeding may be broadcast live or recorded
for later broadcast by radio or television stations.
I consent to this broadcast or recording for later
broadcast.

Location of
Teleconference

Nome

Date

2-17-81

Signer

Robert F. Baldwin

TELECONFERENCE HEARINGS



This proceeding may be broadcast live or recorded
for later broadcast by radio or television stations.
I consent to this broadcast or recording for later
broadcast.

Location of Teleconference Nome

Date Jul 17 1981

Signed [Signature]

ALASKA

STATE LEGISLATURE

MEMORANDUM

TO: Cheryl Frasca
FROM: Linda Otey
RE: Nome Teleconference Testimony List

DATE: February 19, 1981

Linda Conley, Nome
Read statement by City Manager

Virginia White, Nome City Council

Rosemary Phillips - Nome City Council

Leo Rasmussen - Mayor of Nome

Robert Baldwin - Manager of Alaska Gold Co. in Nome

Dan Karman - Nome School Board

Bill Ruddy - Attorney for Alaska Gold Co.

Charlie Johnson - Bering Straits Native Assoc.

John VanWinkle - Attorney for Sitnuasak Native Corp.

Judy Martinson - Nome resident

Chuck Readerer - Nome resident, Business owner

John Poling - Nome resident

Al Doyle - Nome resident

Neil Foster - Nome resident

John Kelup - Native Assoc. in Nome

Vernon Kussendorf - Nome resident

Bob Renshaw - Nome resident, former mayor

Elmer Wheeler - Nome Homeowners Assoc.

Mr. Hicks - Attorney for City of Nome

Memo to Cheryl
Page 2
2/19/81

Dave Heterly Smith - Mining Association

Shelia Gallagher - Chairman LBC

C. Bettisworth - Member of the LBC

Dan Bockhorst - Dept C&RA

Ken Satre - Asst. Principal, Nome Beltz High

Q Council
Dandolph
Bylsma
Grussendorf

Zeeh
Colletta
Ferguson
Gilman
Sturgesenti

Called to order @ 3pm - Feb 17, 1981
Joint Senate & House

Minutes
Televised
Joint Clerk

Brief intro and description of annexation situation

Linda Conley - Wome - statement by City Manager

1901 - incorporated - less than 1 sq. mile in size

2892 - population -

1968 - City petitioned for 3.2 miles - invalidated by courts
& challenged by Gold Co.

6 million for jail state jail

Wome .82 sq. miles
in size

Spoke in favor of annexation

Virginia White - City Council - for annexation - strong com. support -

300 sig in support of annexation - to Ferguson & Kullen -
urge annexation

Bylsma - Is Council union for annexation

White - not certain at this time

Rosemary Phillips - Wome City Council - by majority in favor of
annexation - Concerned w/ Port facility, being outside city
limits. Jr: Sr High Schools - outside city limit. Intend to
continue statement of support.

fear 1) taxation - added prop. tax

2) mining co. will financially go under

3) native lands lost to city of Wome

10 out of 138 names refused to sign.

Feb 17, 1981

Sturpelowski - re: school situation - how fit into REAA -

Phillips - City has own school district. City owns Nome Beltz - not member of REAA - we operate Beltz facility

Leo Rasmussen - Mayor - of Nome - 4 years - small business owner - prop inside & outside city limits. 12-14 years trying to annex. Area has had free service from City of Nome for quite some time. Services available to all citizens. Mining Company town. Considering plans for prop tax etc. 8-10 mill reduction in prop tax.

Dismayed at Boundary Comm. recommendations.

No questions asked Mayor

Robert Baldwin - Mgr. Ak. Gold Co. in Nome -

large scale mining requires

1 million oz = ~~1 mill~~ 1200 acres dredgeable grounds last min of 25 years. - reactivated in 1974 - 12 mill in capital improvement - no profit 2 dredge to 4 dredge operation would increase payroll to 5 million? would need permits if annexed. Most of ground annexed would contain

402 undeveloped lots / include 170 ~~lot~~ lots - subj. to flooding - 50 acres sold to city.

1/2 area overlies a pay zone -

Mentioned port plan. Sugg. operation would cease if all of them

- Gilman - how many employees -

Baldwin - 50 men now - 165 men in middle season

Dan Karmun - School Board - support annexation
Free Betty High School - with cost of living - ~~low~~
low tax base.

Bill Ruddy - Atty. for Wk. Gold - townsite is small but no
smaller than

- City Hall tries to get em.

too are outside because they want to avoid city.

- Place mining co.'s. City cannot live on top of one another

- Co. is just now coming back. Comm had been instructed
to check out annexation. 10 years later - they're
back.

City has never come & attempt to find out what
the needs are for both parties.

Randolph - work out lesser - annexation -

Ruddy - Very interested in Port Development - no dialogue

Byrson - What services in return for taxation they would
get. - ~~fire~~

Ruddy - Aside from Fire Service - they have no need for
municipal services

Rep Pullen - Does tribal Co want to see Wone grow & expand?

Ruddy - I don't determine policy - maybe Mgr. could
answer.

Grossendorf - Have you ever approached City Hall - 43%
city's operation. used outside city limit.
Overlap of interests.

Rep Pullen - what % are local hire?

Puddy - Roughly 50 or 60 full time residences built by gold company.

Arch. has 3 witnesses -
Hicks - City of Home -

~~Charlie Johnson~~ Native Corp - Charlie Johnson -
Bering Street - Native Assoc.

Committee needs boundary lines - City made little effort in including Native corp. - Mtg scheduled when Native leadership out of town - Would be supportive but Native pop should be involved in initial planning.

Randolph - Annexation more than adequate? or necessary
Johnson - Doesn't need as much land - Much area would be conveyed to City or State anyway under D-2.

Current proposal goes beyond needs (as far as land)

John Van Winkle - Attorney from Nome. Rep. Sit. ~~Native~~ ^{represent} Native Corp. ~~is~~

Proceedings are not without conflict.

235 sq. miles original / cut back to 16 sq. miles so focus changed.

Not totally opposed - land that Sit. owns - ^{expect} one limited within 16 sq. mile area. - Scattered pockets - (1,000 acres) undeveloped - doesn't require city services.

No clearcut projections for growth - only port facility which Sit approves of.

Bla Bla

pro-III
" "
con-III IIII

Judy Martinson - Mi 1 Nome/Teller thru - opposed to annexation - cannot offer any other services.

fire services: only necessary

- 74-75 - 2185 / 252 outside Nome -

No growth in Nome (from 1980 Census)

Husband employ of Pt. Gold. - Shown no schedule of useful means of taxes. Council would not allow people to vote on it.

Chuck Reader - Trucking Co. - 30 year resident - 10 to 30 people employ. 81.69 acres - largest indiv. land owner affected by annexation. - Violently opposed to annexation of anything other than - school - dump - etc.

John Potting? 19 yr. resident. - support annexation

Al Doyle - longtime resident / former mayor - support annexation -

Weil Foster - Air taxi owner / Airport does not meet standards of annexation necessities - opposed to annexation.

If city takes over - inefficient

John Ketchup - Native Assoc. - opposed to annexation

Vernor Kussendorf - opposed / Agree w/ Pt. Gold & Air Taxi

Bob Renshaw - former Mayor - 32 yrs. - Don't need ^{total} area of annexation - need employment instead of taxation - opposed.

Elmer Whalen - Homeowners Assoc. - current comp. growth & develop. plan needed - not enough planning.
Nome Over :-

Ferguson - appears to be suff. grounds to sustain court challenge to annexation.

Claims 44 260 A - AS 44 967 A

Asked Sen^{or} CRA for Res to Disapprove of annexation

Rep Bullen - ~~hope~~ re: port facility - hope Gold C. City can get together for port facility.

Anch. Site:

Mr Hicks - Atty Gen of Nome - "Boundary Comm" shall consider changes. Summarized mtgs & hearings in Nome re: annexation - plenty of public participation.

Need annexation for port facility

Heterly Dave Smith with Mining Assoc. opposed to annexation

Shelia Gallagher - Chairman. agree w/ Hicks - do not agree w/ Chenoweth or Bill Ruddy - copy of written decision considered all standards. Comm was unan in its decision it fully complies w/ statutes.

Sturg - Feeling in community? - not communicating

Gallagher - Mr. Win set forth budget & plan as to what would be done w/ annexation.

Quilatta -

Byzma - problem w/ boundaries

Bettsworth - Their mtg. resp for boundary final determined 2-11, - 250 residents followed procedures

Keegerson - It disapproved - how long would it take -
Bettsworth 1 year delay from this date

Not met by Ivan Witem - Toned areas in annexation - 235 sq. miles. Only contact w/ City Mgr. - No unpub. mtg on Comm behalf w/ people of City of Home

Dept C/A/A - Don Bockhorst - 6 pg. Statement of decision
attached for Decision on Dec. 11

Ken Satre - Asst. Perm. Wore Pultr Hi. - Support Annexation

REVENUE
SHARING

Municipal Revenue Sharing Ch. 98 - Ch 90 combined

	1	2	3
	Entitlement	Entitlement	Net
	33,500,000	51,900,000	Increase
Boroughs:			
Municipality of Anchorage	14941.6	20190.0	5248.4
Bristol Bay Borough	197.9	502.0	304.1
Fairbanks North Star Borough	1314.7	2737.1	1422.4
Haines Borough	18.3	48.1	29.8
Juneau Borough	1719.9	4007.5	2287.6
Kenai Peninsula Borough	342.1	680.2	338.1
Ketchikan Borough	290.1	711.5	421.4
Kodiak Borough	301.4	552.5	251.1
Mat-Su Borough	954.1	1208.6	654.5
North Slope Borough	352.5	443.3	86.8
Sitka Borough	447.7	623.7	176.0
First Class Cities:			
Barrow	47.8	56.5	8.7
Cordeva	259.7	508.9	249.2
Craig	37.7	80.5	42.8
Dillingham	111.3	265.4	154.1
Fairbanks	2948.5	4255.6	1287.1
Galena	53.2	97.0	43.8
Haines	72.2	156.5	83.3
Homer	106.6	202.5	101.9
Hoonah	54.9	64.3	9.4
Hydaburg	19.9	22.5	3.7
Kake	39.6	84.7	45.1
Kenai	307.3	639.9	332.6
Ketchikan	789.0	1499.9	710.9
King Cove	36.0	66.2	30.2
Klawock	19.4	24.0	4.6
Kodiak	230.3	391.9	161.6
Nenana	51.9	90.2	38.3
Nome	292.7	502.6	209.9
North Pole	40.9	64.1	23.2
Palmer	177.8	281.7	103.9
Politan	20.8	37.4	16.6
Petersburg	250.1	520.9	270.8
Sand Point	58.5	114.3	55.8
Saint Mary's	76.5	161.6	85.1

	1	2	3
	Entitlement	Entitlement	Net
	33,500,000	59,100,000	Increase
First class cities (cont.)			
Seldovia	33.2	47.9	14.7
Seward	256.6	396.1	139.5
Skegway	52.0	94.5	42.5
Soldotna	133.8	268.2	134.4
Unalaska	220.3	337.0	116.7
Valdez	301.3	356.0	54.7
Wrangell	227.0	452.2	225.2
Yakutat	27.8	61.3	33.5
Second Class Cities:			
Akiak	20.1	26.1	6.0
Akiachak	35.1	41.5	6.4
Akiak	25.6	31.9	6.3
Aholmiut	92.0	110.6	18.6
Akutan	24.1	30.4	6.3
Alakanuk	37.8	50.9	13.1
Aleknagik	24.9	30.9	6.0
Allakaket	26.5	33.1	6.6
Amóler	28.3	34.1	5.8
Anaktuvuk Pass	26.0	32.8	6.8
Anderson	27.7	33.7	6.0
Angoon	32.7	38.6	5.9
Aniak	77.3	94.5	17.2
Anvik	26.5	33.0	6.5
Atemautluak	30.7	36.3	5.6
Bethel	329.6	422.0	92.4
Brevig Mission	26.5	33.1	6.6
Buckland	26.0	32.8	6.8
Chefornak	25.6	31.9	6.3
Chevak	25.7	32.0	6.3
Chuathbaluk	29.1	34.3	5.2
Clark's Point	20.6	30.7	10.1
Deering	26.5	33.1	6.6
Delta Junction	36.1	42.7	6.6
Diomedes	24.1	30.7	6.6
Eagle	22.3	27.6	5.3

	1	2	3	
	Entitlement 33,500,000	Entitlement 51,900,000	Net Increase	
1	Second Class Cities (cont)			
2				
3	Eek	256	319	63
4	Ekwok	246	307	61
5	Elim	265	331	66
6	Emmonak	285	478	193
7	Fort Yukon	620	914	294
8	Fortuna Hedge	272	328	56
9	Gambell	263	325	62
10	Galovin	265	328	63
11	Goodnews Bay	250	316	66
12	Grayling	260	334	74
13	Holy Cross	279	338	59
14	Hooper Bay	250	316	66
15	Houston	673	907	234
16	Hughes	277	337	60
17	Huslia	579	701	122
18	Kachemak	201	253	52
19	Kaktovik	260	328	68
20	Kaktog	266	331	65
21	Kasaan	186	237	51
22	Kiana	260	328	68
23	Kivalina	260	328	68
24	Kobuk	273	335	62
25	Kotlik	256	319	63
26	Kotzebue	1565	1794	229
27	Koyuk	260	328	68
28	Koyukuk	270	331	61
29	Kupreanof	193	244	51
30	Kwethluk	256	319	63
31	Larsen Bay	201	260	59
32	Lower Kalskag	828	923	95
33	Manokotak	248	311	63
34	McGrath	381	469	88
35	Makaruk	256	399	143
36	Mountain Village	546	645	99
37	Napakiaik	264	323	59
38	Napaskiak	256	319	63
39	Newhalen	246	304	58
40	New Seuyahok	276	307	61

	1	2	3	
	Entitlement 33,500,000	Entitlement 51,900,000	Net Increase	
1	Second Class Cities (cont.)			
2				
3	Newtok	25.6	31.9	6.3
4	Nightmute	25.9	32.1	6.2
5	Nikolai	26.0	32.8	6.8
6	Nondalton	24.7	30.6	5.9
7	Noorvik	27.3	33.5	6.2
8	Nulato	28.1	34.0	5.9
9	Nuiqsut	26.0	32.8	6.8
10	Old Harbor	21.2	26.0	4.8
11	Ouzinkie	26.1	25.3	5.2
12	Pilot Station	25.7	31.9	6.2
13	Platinum	28.5	43.1	14.6
14	Point Hope	26.0	32.8	6.8
15	Port Alexander	19.3	24.4	5.1
16	Port Heiden	27.5	42.5	15.0
17	Port Lions	20.7	25.7	5.0
18	Quinhagak	26.0	32.1	6.1
19	Ruby	26.0	32.7	6.7
20	Russian Mission	25.6	31.6	6.0
21	Saint Michael	26.5	33.1	6.6
22	Saint Paul	119.0	164.8	45.8
23	Savoonga	26.0	32.8	6.8
24	Saxman	19.4	23.9	4.5
25	Scammon Bay	26.0	32.1	6.1
26	Solawik	26.0	32.8	6.8
27	Shageluk	26.0	32.8	6.8
28	Shaktolik	42.0	56.1	9.1
29	Sheldon Point	25.6	31.6	6.0
30	Shishmaref	26.0	32.8	6.8
31	Shungnak	26.5	37.1	6.6
32	Stebbins	26.5	33.1	6.6
33	Tanana	88.4	218.1	129.7
34	Teller	27.4	37.1	9.7
35	Tenakee Springs	19.9	24.4	4.5
36	Togiak	26.2	31.6	5.4
37	Toksook Bay	25.6	31.9	6.3
38	Tuluksak	63.1	57.5	(1.6)
39	Tununak	25.0	31.9	6.9
40				

	1	2	3
	Entitlement	Entitlement	Net
	33,500,000	51,900,000	Increase

Second Class Cities (cont.)

Unalakleet	47.4	61.6	14.2
Upper Kalskag	26.8	33.2	6.4
Wainwright	26.0	32.8	6.8
Wales	24.1	30.4	6.3
Wasilla	103.4	85.5	(17.9)
White Mountain	24.1	30.4	6.3
Whittier	63.8	98.6	44.8

NATIVE VILLAGE GOVERNMENTS
THAT WILL RECEIVE FUNDING UNDER THE FY 1981
STATE REVENUE SHARING PROGRAM

Arctic Village
Beaver
Cantwell
Chickaloon
Chignik Lake
Chitina
Circle
Crooked Creek
Eagle
English Bay
Gulkana
Igiugig
Karluck
Klukwan
Koliganek
Kwigillingok
Lime Village
Metlakatla
Nikolski
Pedro Bay
Pilot Point
Port Graham
Red Devil
South Naknek
Stony River
Tanacross
Tazlina
Tetlin
Twin Hills
Venetie

Atka
Birch Creek
Chalkyitsik
Chignik
Chignik Lagoon
Chistochina
Copper Center
Dot Lake
Egegik
Evansville
Healy Lake
Iliamna
Kipnuk
Kokhanok
Kongiganak
Levelock
Mentasta Lake
Minto
Northway
Perryville
Portage Creek
Rampart
Saint George
Stevens Village
Takotna
Tatitlek
Telida
Tuntutuliak
Ugashik

Total 59

AS 29,890,500

\$25,000 per village

The following alphabetized listing consists of legislators, legislative personnel (permanent and sessional) and Legislative Affairs Agency personnel.

If there are any corrections or changes, please contact Legislative Affairs Agency, either Lois or Helen, at 465-3800.

ABOOD, Mitchell, E., Jr. ***	4919	REPRESENTATIVE
ACCORD, Audrey	4949	Secretary/Rep. Phillips
ADAIR, Gloria	4919	Secretary/Rep. Abood
ADAMS, Albert P. ***	3877	REPRESENTATIVE
ADAMS, Amy	4989	A.A./Sen. Ferguson
ADAMSON, Eric	3869	House Page
ALECK, Beverly	3791	A.A./Sen. Bradley
ALTON, Natalie	3725	Ass't. Chief Clerk/House
ANDERSON, Charles G. ***	4942	REPRESENTATIVE
ARNOLD, Roberta	278-3668	Teleconf. Mod(Anch)/Pub. Svcs/LAA
ASPER, Linn	4627	Attorney/Legal Svcs/LAA
AUSTERMAN, Richard	4951	A.A./Rep. Zharoff
BAIM, Virginia	4925	Secretary/Rep. Rogers
BALTES, Kathi	278-3668	Teleconf. Mgr(Anch)/Pub. Svcs/LAA
BARCLAY, Gloria	4942	A.A./Rep. Anderson
BARLOW, Connie	3991	Issues Analyst/House Research
BARNES, Ramona L. ***	4927	REPRESENTATIVE
BARRIL, Tony	3730	Senior Lounge Attendant
BARTON, Betty	3991	Issues Analyst/House Research
BEASON, Evelyn	3783	Secretary/Rep. Martin
BEIRNE, Michael F. ***	3759	REPRESENTATIVE
BELANGEP, Bob	3778	Print Shop/LAA
BENNETT, Don ***	3714	SENATOR
BENNETT, Nellie	3737	Documents Clerk/LAA
BERG, Laurie	4916	Researcher/Rep. Ellason
BERG, Marla	3877	A.A./Rep. Adams
BERG, Richard	3850	Director/Admin. Svcs/LAA
BERNALDO, Jaime	3708	Maintenance/LAA
BERNIER, Billy	3867	Director/Legal Svcs/LAA
BERRY, Randolph	3897	Attorney/Legal Svcs/LAA
BERRY, Robert	4934	Researcher/Sen. Gilman
BETTISWORTH, Robert H. ***	4967	REPRESENTATIVE
BIGB, Sally	3753	Secretary/Sen. Dankworth
BICKENHEUSER, Charles	747-6276	Info. Offr(Sitka)/Pub. Svcs/LAA
BIGGS, Carol	3991	A.A./House Research
BIXBY, Julie	3730	Junior Lounge Attendant
BLUME, Allen	4840	A.A./Admin. Regulation Review
BOLANOS, Linda	3869	House Page
BOLLING, Cary	443-5554	Resv. Employee(Nome)/Pub. Svcs/LAA
BORDERS, Ellen	766-2885	Teleconf. Mod(Haines)/Pub. Svcs/LAA
BOWEN, Nevette	4987	Senate Page
BRADLEY, Brad ***	3791	SENATOR

BRADLEY, Richard 3898
 BRELSFORD, Ginna 3777
 BREWSTER, Perry 4648
 BRODY, Susan 3991
 BROWN, Fred E. *** 3718
 BROOKS, Teresa 747-6276
 BRUCE, Brenda 3789
 BRUCE, Kevin 3717
 BRYSON, Cynthia (202) 624-5873
 BUCHANAN, Katherine 3888
 BUCHHOLDT, Thelma *** 4992
 BURNSIDE, Carol 4858
 BYINGTON, Bill 3864
 BYINGTON, Gwen 3764
 BYINGTON, Jeannie 3855
 BYLSMA, Bernard C. *** 4978

CALDAROLA, Effie 274-8518
 CALHOON, Pamela 3850
 CARGILL, Mary 4984
 CARLSON, Phyllis 4978
 CARNEY, Patrick J. *** 3727
 CARRILLO, Felix 3708
 CARRILLO, Julia 3708
 CARTER, Edith 3725
 CASHEN, Heather 3701
 CASHEN, Irene 3725
 CASHEN, Jim 3778
 CATO, Bette M. *** 4858
 CHAMBERLAIN, Darlene 3822
 CHARNEY, M.R. 3800
 CHENOWETH, John 3837
 CHUCKWUK, Joseph *** 3892
 CHYTHLOOK, Helen 3869
 CIRAULO, Ron 4987
 CLOCKSIN, Donald E. *** 3777
 COHEN, Norman 4931
 COLLETTA, Mike *** 3732
 COLLINS, Miles 3853
 CONVERSE, Maria 3753
 COOK, Tamara 4996
 COOPER, Marylou 3850
 COPE, Violet 4907
 CORPUZ, Edrigis 3708
 COSTELLO, Pat 3869
 COTTEN, Samuel R. *** 3706
 CRAMER, Teresa 4442
 CRANDALL, John 4937
 CRASS, Tom 3850
 CRAWFORD, Judith 3766
 CROW, Glenn 3827

Attorney/Legal Svcs/LAA
 A.A./Rep. Clocksin
 Teleconf. Mod(Jnu)/Info. Svcs/LAA
 Issues Analyst/Actg. Dir/House Research
 REPRESENTATIVE
 Resv. Employee(Sikta)/Pub. Svcs/LAA
 Secretary/Rep. Fuller
 A.A./Sen. Rodey
 A.A./Wash., D.C. Info. Off/LAA
 Ass't./Media Center/LAA
 REPRESENTATIVE
 A.A./Rep. Cato
 Coord/Behrends Bldg.
 A.A./Rep. Smith
 Messenger/Legal Svcs/LAA
 REPRESENTATIVE

Staff Ass't(Anch)/Pub. Svcs/LAA
 Pers. Officer/Admin. Svcs/LAA
 Secretary/Rep. Montgomery
 Secretary/Rep. Bylsma
 REPRESENTATIVE
 Maintenance/LAA
 Maintenance/LAA
 Ass't. Chief Clerk/House
 Ass't. Senate Secretary
 Chief Clerk/House
 Messenger/Print Shop/LAA
 REPRESENTATIVE
 Secretary/Sen. Kelly
 Executive Director/LAA
 Attorney/Legal Svcs/LAA
 REPRESENTATIVE
 House Page
 Researcher/Senate Staff
 REPRESENTATIVE
 A.A./Rep. Vaska
 SENATOR
 Prop. Officer/Admin. Svcs/LAA
 A.A./Sen. Dankworth
 Attorney/Legal Svcs/LAA
 Accountant/Admin. Svcs/LAA
 Secretary/Sen. Parr
 Maintenance/LAA
 House Page
 REPRESENTATIVE
 A.A./Blue Ribbon Commission
 A.A./Rep. Meekins
 Progr. Analyst/Data Proc/LAA
 Secretary/Sen. Zackett
 Extern/Legal Svcs/LAA

CROW, Sharon 3759
CUDDY, David W. *** 4905
CUTLER, Louisiana 4992

Secretary/Rep. Buirne
REPRESENTATIVE
A.A./Rep. Buchholdt

DANKWORTH, M.E. *** 3753
DAHL, Elizabeth 4987
DAVIS, Merridy 3728
DETRICK, Nancy 4907
DEMEKSA, Elsa 3880
DENTON, Hali 4990
DeVRIES, Anne 3991
DICKASON, Carol 278-3668
DICKINSON, Annella 835-2111
DOWLING, Ginger 4987
DRENNAN, Katie 3850
DUMAOP, Hernando 3708
DUNAYSKI, Charles 3746
DUNCAN, Jim *** 3720
DYE, David 4934

SENATOR
Senate Page
Xerox Operator/Print Shop/LAA
Researcher/Sen. Parr
Researcher/Sen. Hohman
A.A./Rep. Moss
Issues Analyst/Hcuse Research
Info. Net. Coord(Anch)/Pub. Svcs/LAA
Resv. Employee(Valdez)/Pub. Svcs/LAA
Senate Page
A.A./Staff Training/LAA
Maintenance/LAA
Maintenance/LAA
REPRESENTATIVE
A.A./Sen. Gilman

EADEN, Gary 3850
EADY, Rhoda 262-9364
ELIASON, Richard I. *** 4916
ELVERS, Sharon 262-9364
EVANTS, Pat 235-7878

Data Processing/LAA
Info. Offr(Kenai)/Pub. Svcs/LAA
SENATOR
Resv. Employee(Kenai)/Pub. Svcs/LAA
Teleconf. Mod(Homer)/Pub. Svcs/LAA

FANNING, Kenneth J. *** 4833
FAHPENKAMP, Bettye *** 3762
FARNAN, Allison 3771
FERGUSON, Frank *** 4989
FISCHER, Vic *** 4954
FLEMING, Laura 4954
FOSKIN, Bridget 3991
FOUSE, Melissa 3818
FRASCA, Cheryl 4840
FREEMAN, Oral E. *** 4914
FREER, Peter 3720
FRIDGE, Susan 3725
FRIEND, Teresa 4987
FROELICH, Pete 3991
FULLER, John G. *** 3789

REPRESENTATIVE
SENATOR
Researcher/Sen. Kerttula
SENATOR
SENATOR
Secretary/Sen. Fischer
Secretary/House Research
A.A./Sen. Sturgulewski
A.A./Admin. Regulation Review
REPRESENTATIVE
A.A./Rep. Duncan
Ass't. Chief Clerk/House
Sgt-At-Arms/Senate
Issues Analyst/House Research
REPRESENTATIVE

GAMBLE, Marge 3725
GARDINER, Terry *** 3734
GARRET, Shannon 4992
GAY, Debra 835-2111
GAZAWAY, Deborah 4648
GIBSON, Dana 3746

Secretary/Chie. Clerk's Office/House
REPRESENTATIVE
Staff Aide/Rep. Buchholdt
Resv. Employee(Vldz)/Pub. Svcs/LAA
Teleconf. Mgr(Jnu)/Pub. Svcs/LAA
Maintenance/LAA

GIFFORD, Max 3714
 GILMAN, Donald E. *** 4934
 GLEASON, Bruce 3806
 GLENN, Laraine 3824
 GODKIN, Lorene 3701
 GOTTSCHALK, Archie 3892
 GOTTSTEIN, David 3771
 GOWDY, Helen 3800
 GOWDY, Lisa 385
 GROH, Clifford, Jr. 484
 GROSZEK, Nancy 495
 GRUENING, Bonnie 3867
 GRUSSENDORF, Ben F. *** 3824
 GUTHRIE, Joseph 3894

A.A./Sen. Bennett
 SENATOR
 Machine Opr./Print Shop/LAA
 A.A./Rep. Grussendorf
 Ass't. Senate Secretary
 Researcher/Rep. Chuckwuk
 A.A./Senate Research
 Executive Secretary/LAA
 Receptionist/Admin. Svcs/LAA
 A.A./Rep. Gardiner
 A.A./Sen. Fischer
 Secretary/Legal Svcs/LAA
 REPRESENTATIVE
 Attorney/Legal Svcs/LAA

HAIGHT, Kristen 3892
 HAKALA, Mary 3734
 HALE, John 4937
 HALFORD, Richard W. *** 4924
 HALVERSON, Robin 3762
 HAMMOCK, David 4976
 HANSON, Sally 3771
 HARDAGE, Linda 4989
 HARDER, Kristine 4951
 HARMON, Darrell 3746
 HARRIGAN, Charles 3806
 HARRIS, Linda 895-4236
 HART, Karla 3869
 HARTLE, John 4925
 HATHAWAY, Kathy 4922
 HAUGEN, E.J. *** 3879
 HAYES, Joe L. *** 3740
 HEIN, Ed 3822
 HENLEY, Troy 3844
 HENRY, Jean 3808
 HERRMANN, Adelheid 3892
 HICKOK, Pat 835-2111
 HOGBERG, Harold 3746
 HOHMAN, George H., Jr. *** 3880
 HOK, Alexander 3991
 HOLCOMB, Stephanie 4914
 HOLM, Deborah 3732
 HOPKINS, Judy 274-8518
 HORTER, Lacen 852-7111
 HOWARD, Robyn 3850
 HURLBERT, Vernon L. *** 3873
 HUNT, Matthew 4648
 HURLEY, Lorraine 3850
 NUSS, Bernie 4808

Secretary/Rep. Chuckwuk
 A.A./Rep. Gardiner
 A.A./Rep. Meekins
 REPRESENTATIVE
 A.A./Sen. Fahrenkamp
 A.A./Rep. Metcalfe
 A.A./Sen. Kerttula
 Secretary/Sen. Ferguson
 A.A./Rep. Zharoff
 Maintenance/LAA
 Machine Opr/Print Shop/LAA
 Info. Ass't(Delta Junc)/Pub. Svcs/LAA
 Sgt.-At-Arms/House
 A.A./Rep. Rogers
 A.A./Sen. Ferguson
 REPRESENTATIVE
 REPRESENTATIVE
 A.A./Sen. Kelly
 A.A./Sen Mulcahy
 Librarian/Legal Svcs/LAA
 Researcher/Rep. Chuckwuk
 Teleconf. Mod(Vldz)/Pub. Svcs/LAA
 Maintenance/LAA
 SENATOR
 Issues Analyst/House Research
 Secretary/Rep. Freeman
 Secretary/Sen. Colletta
 Ass't. to Dir(Anch)/Pub. Svcs/LAA
 Info. Offr(Barrow)/Pub. Svcs/LAA
 Text Proc. Tech/Data Proc/LAA
 REPRESENTATIVE
 Messenger(Jnu)/Pub. Svcs/LAA
 Accountant/Admin. Svcs/LAA
 A.A./Rep. O'Connell

IMBSEN, Marlene	3867	Enrolling Clerk/Legal Svcs/LAA
IRVING, Kathy	452-4448	Resv. Employee(Fbks)/Pub. Svcs/LAA
JACK, Bonnie	279-3471	A.A.(Anch)/Rep. Hayes
JACKINSKY, Alice	3850	Accountant/Admin. Svcs/LAA
JACKINSKY, Autumn	3771	A.A./Sen. Kerttula
JACKSON, Gordon	4843	A.A./Rep. Gardiner
JENNINGS, Dennis	3869	Ass't. Sgt-At-Arms/House
JENSEN, Cherilyn	3808	Library Ass't/Legal Svcs/LAA
JERABEK, Cheryl	543-3541	Info. Ass't(Bethel)/Pub. Svcs/LAA
JOHNSON, Christine	3991	Issues Analyst/House Research
JOHNSON, Thomas	3762	Researcher/Sen. Fahrenkamp
JOHNSTON, Judith	3719	A.A./Sen. Bennett
KADOW, Charity	274-8518	Director(Anch)/Public Svcs/LAA
KANDBINDER, Patrick	3850	Data Entry Clk/Data Proc/LAA
KASSON, Joan	4843	A.A./Rep. Malone
KELLER, Ed	3850	Data Ctr. Mgr/Data Proc/LAA
KELLY, Jim	3717	A.A./Sen. Rodey
KELLY, Tim ***	3822	SENATOR
KENNEDY, Eugene	(202)624-5873	Director/Wash., D.C. Info. Off/LAA
KERTTULA, Jalmar M. ***	3771	SENATOR
KIEFER, Elizabeth	4934	Secretary/Sen. Gilman
KIMLINGER, Rosemary	3780	Proofreader/Legal Svcs/LAA
KING, Jolene	224-3717	Teleconf. Mod(Swrd)/Pub. Svcs/LAA
KING, Resa	3762	Secretary/Sen. Fahrenkamp
KINNEY, Pete	3850	A.A./Data Proc/LAA
KIRK, Dorothy	4967	Secretary/Rep. Bettisworth
KLEPPEN, Dennis	3850	EDP Progmr/Data Proc/LAA
KNAPP, Nancy	4987	Senate Page
KNIGHTLINGER, Lorretta	4442	Secretary/Blue Ribbon Commission
KOBY, Jack	3778	Spec.-Dup. Svcs/Print Shop/LAA
KOCSIS, Rob	4849	A.A./Sen. Hohman
KREINHEDER, Jack	3991	Issues Analyst/House Research
KREKELBERG, Ann	4922	A.A./Sen. Ray
KROSSA, Landa	3743	Researcher/Sen. Ziegler
KUNZELMAN, Janet	3719	Secretary/Sen. Bennett
KV/LHEIM, Mary	376-3704	Info. Offr(Wsla)/Pub. Svcs/LAA
LANDI, Rob	3778	Dup. Mach. Clk/Print Shop/LAA
LANG, Beverly	4927	Secretary/Rep. Barnes
LARSON, Dean	4987	Ass't. Sgt-At-Arms/Senate
LARSON, Dorothy	842-5319	Info. Offr(Dhm)/Pub. Svcs/LAA
LAUBER, Leslie	3737	Documents Clerk/LAA
LAWLER, Patrick	4940	A.A./Rep. Sutcliffe
LeDOUX, Karen	4951	Secretary/Rep. Zharoff
LEE, Frank	3791	A.A./Sen. Bradley
LESH, JoAnn	3764	A.A./Rep. Smith

LEVAN, Mary	4916	A.A./Sen. Eliason
LEVY, Keith	3805	Extern/Legal Svcs/LAA
LOCHMAN, Roberta	486-4881	Resv. Employee(Kdk)/Pub. Svcs/LAA
LOGENBAUGH, Leslie	3991	Research Ass't/House Research
LONG, Beverly	4648	Info. Ass't(Jnu)/Pub. Svcs/LAA
LONG, Nancy	3888	Tech. Dir/Media Ctr/LAA
LORD, Nancy	4925	A.A./Rep. Rogers
LOWNDES, Neoma	4922	Researcher/Sen. Ray
LUMBA, Delfin	3708	Custodian/Maintenance/LAA
LUMBA, Dominador	3708	Custodian/Maintenance/LAA
MALLEY, Charles	3718	A.A./Rep. Brown
MALONE, Hugh ***	4843	REPRESENTATIVE
MANLEY, Jonn	4833	A.A./Rep. Fanning
MARSHALL, Nancy	3867	Enrolling Clerk/Legal Svcs/LAA
MARTIN, Carolyn	3880	Researcher/Sen. Hohman
MARTIN, Lawrence	3850	Comm. Dispatcher/Data Proc/LAA
MARTIN, Terry ***	3783	REPRESENTATIVE
MARTINSON, Kathy	3753	A.A./Sen. Dankworth
MASON, Merle	3850	A.A./Admin. Svcs/LAA
MATHERLY, Nancy	4931	Secretary/Rep. Vaska
MATHEWS, Joan	3727	A.A./Rep. Carney
MATTINGLEY, Mickl	278-3658	Teleconf. Ass't(Anch)/Pub. Svcs/LAA
McCARTHY, Kevin	4843	A.A./Joint Gas Pipeline
McCORMICK, Robert	3806	Machine Opr/Print Shop/LAA
McCORMICK, Tony	3806	Sr. Spec./Dup. Svcs/Print Shop/LAA
McDANIEL, Annette	3777	Secretary/Rep. Clocksin
McFADDEN, Tammy	452-4448	Resv. Employee(Fbks)/Pub. Svcs/LAA
McGHIE, Julie	3725	Ass't. Chief Clerk/House
McGREGOR, Malcolm	3708	Building Supvr/LAA
McINTYRE, Drena	3718	Secretary/Rep. Brown
McKEOWN, Wade	3853	Supply Clk/Admin. Svcs/LAA
McKENDRY, Millie	262-9364	Resv. Employee(Kenal)/Pub. Svcs/LAA
McINTIRE, Sally	3967	Legal Editor/Legal Svcs/LAA
McEKIN, Marilyn	3776	Collator/Print Shop/LAA
McEKINS, Russ, Jr. ***	4937	REPRESENTATIVE
MELTON, Laurie	3727	Secretary/Rep. Carney
MERRITT, Krista	3850	A.A./Staff Training/LAA
METCALFE, Ray H. ***	4976	REPRESENTATIVE
MILLER, Mike ***	3364	REPRESENTATIVE
MITCHELL, Kay	4919	A.A./Rep. Abood
MOE, Judith	4942	Secretary/Rep. Anderson
MOEN, Randall	3740	A.A./Rep. Hayes
MOFFAT, William	3783	A.A./Rep. Martin
MONTGOMERY, Joe D. ***	4984	REPRESENTATIVE
MOORE, Katherine	442-3880	Resv. Employee(Ktzb)/Pub. Svcs/LAA
MOORE, Kim	(202)624-5873	Secretary/Wash., D.C. Info. Off/LAA
MORRIS, Alephe	3766	A.A./Sen. Sackatt
MORRISON, George	3850	Spec. Ass't./Senate Research
MORROW, Wendy	3850	Data Control Spec/Data Proc/LAA
MORTELL, James	3746	Maintenance/LAA

MURTENSEN, Linda	3867	Enrolling Clerk/Legal Svcs/LAA
MOSIER, D.J.	4987	Senate Page
MOSS, F. Pappy ***	4990	REPRESENTATIVE
MULCAHY, Bob ***	3844	SENATOR
MULLIGAN, Peggy	3701	Senate Secretary
MURKOWSKI, Lisa	3740	Researcher/Rep. Hayes
NEUBAUER, Annie	452-4448	Info. Ass't(Fbks)/ A. Svcs/LAA
NOAH, Jennie	3867	A.A./Legal Svcs/LAA
NOE, Judy	3719	A.A./Sen. Bennett
NORDLING, Gail	4833	Secretary/Rep. Fanning
NORELL, Barbara	278-3668	Teleconf. Mod(Anch)/Pub. Svcs/LAA
NUSBAUM, Sandra	4924	A.A./Rep. Halford
O'CONNELL, Patrick M. ***	4808	REPRESENTATIVE
OHMER, Judy	3879	A.A./Rep. Haugen
OLSEN, Emma	3736	Hallroom Spvr/LAA
OTEY, Linda	3824	A.A./Rep. Grussendorf
OTNESS, Terry	3879	Secretary/Rep. Haugen
PALMER, James	3762	A.A./Sen. Fahrenkamp
PARKER, Janelle	3800	A.A./Ex. Dir. Office/LAA
PARKER, Lisa	3706	A.A./Rep. Cotten
PARR, CHARLES H. ***	4907	SENATOR
PEEL, Donna	3737	Documents Clerk/LAA
PEGUES, Donna	3825	Attorney/Legal Svcs/LAA
PEGUES, June	3720	Secretary/Rep. Duncan
PEKOVICH, Helen	3844	Secretary, Sen. Mulcahy
PEKOVICH, Sam	3806	Mgr-Dup. Svcs/Print Shop/LAA
PERRY-PROVOST, Sandra	3701	Ass't. Engrossing Clerk/Senate
PETERS, Ralph	3746	Maintenance/LAA
PETERSON, Larry	3873	Researcher/Rep. Hurlbert
PETERSON, Rosie	3713	A.A./Sen. Stimson
PETERSON, Sheila	4916	Secretary/Sen. Ellason
PETRICH, Jeff	4964	A.A./Rep. Miller
PHELPS-MUNSON, Ne I	3740	A.A./Rep. Hayes
PHILLIPS, Randy E. ***	4949	REPRESENTATIVE
PICENO, Felicia	3713	A.A./Sen. Stimson
PITTMAN, Lou	278-3668	Info. Ass't(Anch)/Pub. Svcs/LAA
PLOOG, Hollie	3777	A.A./Rep. Clocksin
PLOTNICK-WELLER, Rocky	4907	A.A./Sen. Parr
PLUMMER, Sioux	4648	Teleconf. Net. Coord/Media Ctr. Coord(Jnu)/Pub. Svcs/LAA
POMEROY, Deb	3991	Secretary/House Research
POTTER, Bonnie	225-9675	Info. Ass't(Ktkn)/Pub. Svcs/LAA
POWERS, Bev	3740	Secretary/Rep. Hayes
PRICE, Nadine	235-7878	Teleconf. Mod(Hmr)/Pub. Svcs/LAA
PRINCE, Earl	3778	Collator/Print Shop/LAA
PURDY, Barbara	4978	A.A./Rep. Bylsma

PUTMAN, Sumner	4854	A.A./Sen. Fischer
PUZZO, Susan	3730	Junior Lounge Attendant
QUESNEL, Paul	4843	A.A./Rep. Malone
QUINTO, Nancy	3701	Ass't. Senate Secretary
RADER, Wendy	3877	Researcher/Rep. Adams
RANDOLPH, Richard L. ***	4821	REPRESENTATIVE
RAY, Bill ***	4922	SENATOR
READ, Duncan	3991	Director/House Research
REHFELD, Marcella	4937	Researcher/Rep. Meekins
REITNER, Barbara	4976	Secretary/Rep. Metcalfe
RICHARDSON, Ruth	543-3541	Info. Offr(Bthl)/Pub. Svcs/LAA
RIEDERER, Jean	4905	Secretary/Rep. Cuddy
ROARK, Robert	4954	Researcher/Sen. Fischer
ROBINSON, Mary Elizabeth	4940	Secretary/Rep. Sutcliffe
ROBINSON, Mim	4821	Secretary/Rep. Randolph
RODEY, Patrick M. ***	3717	SENATOR
RODRIGUEZ, Lois	3800	Secretary/Ex. Dir. Office/LAA
ROGERS, Brian E. ***	4925	REPRESENTATIVE
ROSIER, Jeannette	3850	Text Comp. Progr Trainee/ Data Processing/LAA
ROWHEDER, Marcia	4964	Secretary/Rep. Miller
ROWLAND, Stew	3855	Messenger/Legal Svcs/LAA
ROZKYDAL, Martha	376-3704	Resv. Employee(Plmr)/Pub. Svcs/LAA
SACKETT, John C. ***	3766	SENATOR
SCANLON, Kevin	3778	Collator/Print Shop/LAA
SCAVERA, Paula	3791	Researcher/Sen. Bradley
SCHAEFFER, Mary	442-3880	Info Offr(Ktzb)/Pub. Svcs/LAA
SCHELLE, Darlene	3717	Secretary/Sen. Rodey
SCHELLE, Elizabeth	4992	Aide/Rep. Buchholdt
SCOTT, Bob	443-5555	Info. Offr(Nome)/Pub. Svcs/LAA
SEARS, David	4914	A.A./Rep. Freeman
SEIGEL, Victoria	224-3713	Teleconf. Mod(Swd)/Pub. Svcs/ 'A
SEITZ, Janet	4949	A.A./Rep. Phillips
SHARROCK, Marcie	278-3668	Info. Ass't(Anch)/Pub. Svcs/LAA
SHELLEY, Robert	4821	A.A./Rep. Randolph
SHELTON, Kay	3808	Librarian/Legal Svcs/LAA
SIMMONS, MaryJo	486-4881	Info. Offr (Kdk)/Pub. Svcs/LAA
SIMMONS, Oleta	3717	Researcher/Sen. Rodey
SIMONSON, Diane	3822	A.A./Sen. Kelly
SLATER, Marshall	3850	Mgr-Tech. Svcs./Data Proc/LAA
SMITH, Debi	4648	Info. Spec(Jnu)/Pub. Svcs/LAA
SMITH, Sally ***	3764	REPRESENTATIVE
SMITH, Teresa	3873	Researcher/Rep. Hurlbert
SMITH, Tina	3743	Researcher/Sen. Ziegler
SMOYER, Nancy	452-4448	Resv. Employee(Fbks)/Pub. Svcs/LAA
SOENKSEN, Steve	4858	Researcher/Rep. Cato

SOFN, Tom	4626	Attorney/Legal Svcs/LAA
SORENSEN, Anna	842-5319	Resv. Employee(Dhm)/Pub. Svcs/LAA
SPEED, Bob	3743	A.A./Rep. Gardiner
SPELLMAN, Carmie	3713	Secretary/Sen. Stimson
SPRAY, Ken	3873	Researcher/Rep. Hurlbert
STALEY, Dale	3720	A.A./Rep. Duncan
STEELMAN, Lorna	486-4881	Resv. Employee(Kdk)/Pub. Svcs/LAA
STEVENSON, Monica	3850	Text Comp. Progr. Trainee/ Data Processing/LAA
STIMSON, Terry ***	3713	SENATOR
STOCKDALE, Gordon	3720	A.A./Rep. Duncan
STOOPS, Lee	3766	Researcher/Sen. Sackett
STRINGER, Sandra	4907	A.A./Sen. Parr
STURGULEWSKI, Arliss ***	3818	SENATOR
STURM, Janos	3888	Tech. Producer/Media Ctr/LAA
STURROCK, Sharon	3850	Bdgt. & Acctg. Offr/Adm. Svcs/LAA
SUND, John	3743	A.A./Rep. Gardiner
SUTCLIFFE, Eric G. ***	4940	REPRESENTATIVE
SUTTIE, Joan	4648	Secretary(Jnu)/Pub. Svcs/LAA
SWAIN, Dick	3732	A.A./Sen. Collet a
TAUC Stella	3706	Researcher/Rep. Cotten
TEHAN, Valeria	3883	Extern/Legal Svcs/LAA
TERREL, Paula	3791	Researcher/Sen. Bradley
TESAR, Katherine	3824	Secretary/Rep. Grussendorf
THILL, Mike	3844	Researcher/Sen. Mulcahy
TOPE, Gordon	4843	A.A./Joint Gas P weli e Committee
TOPE, Sandy	3771	Secretary/Sen. Kerttula
TOUTONGHI, Steve	3869	House Page
TUBBS, Sue	3771	Secretary/Sen. Kerttula
TUDTUD, Pantaleon	3708	Custodian, Maintenance/LAA
TUGGLE, Bernie	3807	Extern/Legal Svcs/LAA
TYONE, Sharon	4858	Rescarcher/Rep. Cato
VAN DOREN, Guy	3743	A.A./Sen. Ziegler
VASKA, Anthony N. ***	4931	REPRESENTATIVE
VOGT, Earl	3850	Dep. Dir/Admin. Svcs/LAA
WAHTO, Doris	3737	Documents Clerk/LAA
WAHTO, Joan	3736	Mailroom/LAA
WAID, Kirsten	3867	Enrolling Clerk/Legal Svcs/LAA
WALDEN, Judith	4843	Secretary/Rep. Malone
WALKER, David	3896	Attorney/Legal Svcs/LAA
WALKER, Rosalie	3720	Secretary/Rep. Duncan
WALSH, Catherine	4878	Secretary/Code Revision Commission
WALTON, Maxine	452-4448	Info. Offr(Fbks)/Pub. Svcs/LAA
WARD, Beverly	4967	A.A./Rep. Bettisworth
WARD, Marge	766-2885	Teleconf. Mod(Hns)/Pub. Svcs/LAA
WARREN, Peggy	3850	Data Entry Clk/Data Proc/LAA
WATTS, Jerrold	3822	A.A./Sen. Kelly
WELLER, Royce	4843	A.A./Rep. Malone

WELLS, Susan 4990
 WENDTE, Sandra 225-9675
 WHALIN, Cynthia 4937
 WHEADON, Leo 3850
 WHITCRAFT, Ron 3720
 WILD, Linda 4843
 WILLIAMSON, Debbie 4922
 WILLIS, Charlie 3706
 WINOGRAD, Ira 3991
 WOLCOTT, Jon 3850
 WOOLDRIDGE, Milo 3850
 WRIGHT, Joshua 3740
 WRIGHT, Lucille 4987

YOUNG, David 3850

ZACHARES, Camille 442-3080
 ZACHARY, Denise 3743
 ZEHBE, Jens 3759
 ZHAROFF, Fred F. *** 4951
 ZIEGLER, Robert H., Sr. *** 3743

Secretary/Rep. Moss
 Info. Ass't(Ktkn)/Pub. Svcs/LAA
 Researcher/Rep. Meekins
 Supply Offr/Adm. Svcs/LAA
 A.A./Rep. Duncan
 Staff Aide/Admin. Regulation Review
 Researcher/Sen. Ray
 Researcher/Rep. Cotten .
 Issues Analyst/House Research
 Dup. Svcs. Spec./Print Shop/LAA
 Progrm Analyst/Data Proc/LAA
 Secretary/Rep. Hayes
 Senate Page

Supply Clk/Admin. Svcs/LAA

Info. Ass't(Ktzb)/Pub. Svcs/LAA
 Secretary/Rep. Gardiner
 A.A./Rep. Beirne
 REPRESENTATIVE
 SENATOR