

Leg. Finance-House & Senate Finance Comte Files (1991-1992) 793 90

STATE OF ALASKA

WALTER J. HICKEL, GOVERNOR

DEPARTMENT OF ADMINISTRATION

OLDER ALASKANS COMMISSION

OFFICE OF THE LONG TERM
CARE OMBUDSMAN
THE FRONTIER BUILDING
3601 C STREET, SUITE 260
ANCHORAGE, ALASKA 99503-5209
PHONE: (907) 279-2222
(907) 583-6393
FAX: (907) 582-3040

TOLL FREE 1-800-478-9996

May 5, 1992

Ms. Karen Martz
Administrator
Division of Medical Assistance
Health Facilities Licensing and Certification
4433 Business Park Boulevard, Bldg. H
Anchorage, Alaska 99503

Re: KOTZEBUE SENIOR CITIZENS CULTURAL CENTER
Case No. 91-0077-NE11/H2

Dear Ms. Martz:

I have conducted an investigation into the complaints surrounding the above captioned facility, with specific emphasis on the facility structure and the food preparation area, food handling, and food service methods.

FACILITY STRUCTURE

The facility is managed by the Manillaq Association as a nursing facility and adult residential care facility. Originally built as a Pioneers' Home, the building has been utilized as a senior center and combination nursing and adult residential care facility.

The building consists of a central core area and four radiating wings. The central core area contains the large dining area, the administrative offices, the boiler room, the kitchen which also contains the walk-in freezer, cooler, the traditional doctor's office, and the nurses station for the nursing wing.

The nursing wing consists of five resident rooms, soiled and clean utility, bath and shower room, a medical room, and an area presently used to store oxygen tanks and other medical equipment.

Ms. Karen Martz
Administrator
Division of Medical Assistance
Health Facilities Licensing and Certification
Re: Kotzebue Senior Citizens Cultural Center
May 6, 1992
Page 2

The East wing consists of seven resident rooms and a lounge area. Each room has a bathroom and exit doors leading to the porch/walkway which runs on the outside of the building.

The South wing consists of three resident rooms and a lounge area. Each room has a bathroom and an exit door leading outside to a porch/walkway which connects to the other walkways surrounding the building.

A smaller wing located in the Southwest corner of the core area consists of dry food storage and the sprinkler valves and water tank. The exit door leads to the area of the main entrance.

I made a cursory inspection of the facility, noting structural defects and anomalies which translate to code deficiencies and life safety hazards. The findings are summarized as follows:

The East and South wings show evidence of undercarriage movement of the structure, leaving some internal and most external doors offset in their casements which bind and in most instances do not open and prevent egress to the outside of the building. The movement appears to be differential, inasmuch as at least two directions of movement are in evidence: movement of the extreme ends of the wings distant from the core area appears to be upward from frost heaving; the lateral movement of the wings to the Northwest appears to be from slippage of the fill which was set upon permafrost and on a gradient. The areas of siting of the wings were reported to be used at one time as a municipal landfill and reportedly contain materials both inorganic and organic in composition.

In addition to the area reportedly being used at one time as a landfill, evidence of ponding of water to the Northeast of the core building and extending beneath the South and East wings was described. The pond is reportedly visible in the Summer months and shoring has been placed to limit ground movement into the pond. A small, underground stream bed located about at the midpoint of the South wing, and extending West underneath the East wing (reportedly approximately underneath rooms 4 and 7) was also described. The stream once flowed above ground from the Northwest to a pond (reportedly, the pond that now exists during Summer months) and into the bay. Test drill holes done in the past were described as striking water in one location, and ice some

Ms. Karen Martz
Administrator
Division of Medical Assistance
Health Facilities Licensing and Certification
Re: Kotzebue Senior Citizens Cultural Center
May 5, 1992
Page 3

eight feet away in another location.

The nursing, East and South wings undercarriage are built on fill which was described as laid over permafrost during construction. The fill generally sets beneath the wings, but evidence of movement suggest that the buildings are "sliding" down the slope to the Northwest. The area adjacent to the building toward which the sliding is taking place is topographically lower than the fill underlying the foundation of the building.

The movement of the building, occurring at a differential rate, is causing the utility corridor attached underneath the undercarriage of the building to be subjected to stress. Given that limited flexibility is maintained for differential movement for utilities, e.g. electricity and sewage, evidence of stress breaks and short circuits in electric lines are reported to have occurred at least 4 or 5 times during the past eighteen months. Sewage also backs up in the line due to differential elevations both within the halls of wings and the outward ends of the building.

In discussing the building deficiencies with Chester E. WEGER, Deputy Fire Marshal, State Fire Prevention Office, he indicated that the doors exiting individual rooms on both residential wings do not have to open to the outside, nor do windows have to be operable due to the fact that the facility has a fire sprinkler system. He cited that the building has two distinct fire ratings, I-1 for the nursing wing and I-2 for the two residential wings. Both classifications, according to WEGER, are not required to have operating doors exiting individual rooms when a fire sprinkler system is installed. However, he did express concern from a fire safety point of view the movement of the building and the potential that exists for problems. He expressed that this problem has been cited in previous fire inspections. We also discussed the porch areas at the end and outside of the East wing which would serve as resident safety zones in the event of evacuation from the building. The porches are made of wood and are attached to the building structure and extend only about ten to fifteen feet away from the building. There exists a drop to the ground of approximately three to four feet. There does not appear to be a safety zone around the perimeter of the building since the walkways are blocked with accumulated ice and snow. He did state that does present a problem which can be easily fixed by having the walkways maintained clear of ice and snow. He also suggested that a walkway be built connecting the wings at the extreme end to terminate in the parking lot area as an additional, albeit above fire code, precaution.

Ms. Karen Martz
Administrator
Division of Medical Assistance
Health Facilities Licensing and Certification
Re: Kotzebue Senior Citizens Cultural Center
May 5, 1992
Page 4

One last deficiency noted during the investigation deals with the limited insulation and destruction of the vapor barrier placed in the attic in the residential wings. It was reported that only three inches of insulation exist in the attic space. Due to insufficient insulation, and defeat of the vapor barrier, condensation travels through the walls into the fire detectors and sets them off periodically. As a result, residents and staff may become acclimated to the fire alarm limiting their immediate response and effectiveness to escape from hazard. I understand that an upgrade to the smoke detectors has been scheduled for this coming Summer. Hopefully, this problem area of limited insulation and resultant condensation, will be taken into account.

The nursing wing has had major improvements in internal and exterior structure. The major problem of structural movement was addressed by refrigeration of the ground below grade to prevent thawing and slumping of the fill. Some 14,460 feet of copper pipe were placed below the surface with a refrigerant/coolant circulating through the system to thermosiphon heat away from the permafrost. The residents of the adult residential care facility are residing in that portion of the structure that has had retrofit changes made to it to upgrade its condition. The refrigeration and cooling system, however, has not been consistently monitored for the past year and a half as required to determine if the retrofit actually works in preventing thawing. Thermistors, or temperature sensors, placed below ground to monitor subsurface temperature conditions reportedly have not been maintained, nor the results recorded, to determine long-period changes in subsurface temperatures. Additionally, the refrigeration coolant solution/gas pressure has not been monitored since installation and the system may not be working effectively as designed. Considerable structural damage continues to occur.

In summary, I believe that the existing building presents considerable life safety issues which are a direct result of the structure movement.

ADULT RESIDENTIAL CARE SERVICES

At present, Manillaq Association holds a Nursing Facility license granted by the Division of Medical Assistance, Health Facilities Certification and Licensing. The residential wings are unlicensed. I discovered during my investigation of the administration of the facility that a conscious decision was made by Manillaq management not to seek licensing given the "red tape" that the Association would have to go through maintaining accountability to the Division of Family and Youth Services.

Ms. Karen Martz
Administrator
Division of Medical Assistance
Health Facilities Licensing and Certification
Re: Kotzebue Senior Citizens Cultural Center
May 5, 1992
Page 5

There presently exists some twenty four residents of the South and East residential facility wings. Many are frail and have serious socio-medical needs. The trauma of transfer of the residents to other facilities around the State needs to be weighed against the potential life safety issues inherent in the structural deficiencies.

ADULT RESIDENTIAL CARE LICENSE

As stated above, the present facility is not licensed to provide adult residential care services. Some twenty four residents are presently residing in the two wings serving as residential care. As a result of your staffs' assessment of residents' medical conditions, some of the residents in the residential care portion of the facility have medical needs exceeding what is allowable under existing law and/or regulations for provision of care within that type of licensure. Consequently, an argument could be made to transfer those residents that exceed levels of care allowable for residential care to other facilities outside of the Kotzebue area. However, such transfer brings with it a likelihood, if not direct probability based upon studies of mortality associated with transfer trauma, that residents' quality of life would be severely diminished and bring about impending death as a probable outcome.

I addressed the issue of provision of "level three" care to adult residential care residents in a May 14, 1991 letter to Pat O'Brien, DFYS, and again to Michael Price, DFYS, on May 23, 1991. The issue arose out of an investigation into provision of care to residents at Alternative Solutions last year. This would be a new level of care, allowing persons whose medical needs exceeded the level of care allowable under level two licensure, but not requiring the level of care afforded in a nursing facility. Granting "level three" status to the Kotzebue facility could negate moving some of the residents whose needs exceed level two. Of course, the provisional license would also address the fire safety issues and other code problems brought about by the unstable building structure. That issue, building safety, could be addressed in the provisional license by indicating that licensure was permitted upon completion of the engineering study recommended by my office and contingent upon successful retrofit to the structure of whatever modifications might be necessary to resolve fire and life safety issues. Unfortunately, I have never had a response from DFYS addressing "level three" services, nor has any planning taken place involving my office into such level of care issues.

However, I do believe that those problems presented in your recent Kotzebue

Ms. Karen Martz
Administrator
Division of Medical Assistance
Health Facilities Licensing and Certification
Re: Kotzebue Senior Citizens Cultural Center
May 5, 1992
Page 6

nursing facility survey which systemically affect the residents of the nursing facility, as well as the ARC portion of the facility, such as resident assessment, dietary, nursing, administration, and quality of care would have to be addressed in the provisional license as well. The Kotzebue facility, albeit nursing facility or ARC, works together as an entity and, as such, must function for the welfare and safety of all residents.

Another major issue which faces the Kotzebue facility in the immediate future is that of residents getting older and with advanced age, becoming more infirm. Medical needs are increasing in the census group and eventually one of two things will have to take place: either the facility will expand the nursing facility to accommodate growth; or the citizens of Kotzebue will face moving older Alaskans from their community to other, more distant environs. The census history and projections I have seen show that the residents of the ARC facility are experiencing increasing medical needs which will require, in the immediate future, if not now, more nursing facility accommodations.

Any engineering recommendation which includes the likelihood of new construction as an addition to the building, or a new building, of necessity must also include increasing the accommodations within the nursing facility or the potential residents will be relocated elsewhere in the State.

FOOD PREPARATION, FOOD HANDLING, AND FOOD SERVICE

I investigated the kitchen area, food preparation areas, food handling and food service methods. The kitchen appeared to be fairly modern and serviceable. I found the same degree of problem in the storage areas as we discussed on the phone, such as ice buildup on the wall between the freezer and the refrigerator compartments, dry storage areas inadequately stocked with fresh produce, and a few onions stored in a large tray with about three quarters full of old onion skins .

I also found problems in hygiene, such as food service personnel failing to wash hands between handling residents and their effects; no evidence of gloves for food service personnel to handle food plates and utensils were evident. Gloves were being used by kitchen staff for food preparation in handling raw foodstuff.

The overriding dietary problem identified during my observation is in food service to residents. The food servers were serving meals that were pre-portioned by kitchen

Ms. Karen Martz
Administrator
Division of Medical Assistance
Health Facilities Licensing and Certification
Re: Kotzebue Senior Citizens Cultural Center
May 5, 1992
Page 7

staff. The food servers failed to offer seconds to residents although, during interviews, residents expressed still feeling hungry after meals. The food service personnel failed take the initiative to seek out residents who wanted seconds or additional portions of foodstuff. It was also evident that a lack of positive initiative, follow through, and management control also appeared to be carried over into facility management in several areas, such as interface between nursing personnel and physicians, administrator and management, etc. I mentioned to Nancy FARRINGTON, administrator, the need for food service personnel to be more soliciting of residents to actively seek out those residents still expressing desire for food.

RECOMMENDATIONS

It was reported that the movement of the structure has been noted since it having been built in 1975 as a Pioneer's Home. It was also reported that the building has never been "accepted" by the State as finished, and Manillaq Association has expressed no interest in acquiring the building until movement has been remedied.

In order to safely utilize the building as a residential facility for elderly and infirmed, I recommend the following steps be taken by the Manillaq Association.

1. An engineering study of the structure and adjacent land be undertaken immediately so as to determine what methods might limit movement of the building and stabilize fill creeping. The study could be effective in understanding the geo-mechanical forces at work in the area. Additionally, the study could evaluate what effect, if any, the present retrofit refrigeration system has had on the stability of the subsurface. Through such an engineering study a systemic approach might be proposed to control the effects of frost heaving and subsurface slippage to prevent further structural damage, flexing of the electric and utility lines, and the probability of resultant fire.

2. Upon completion of the engineering study, work begin as soon as practicable to implement the resolutions proposed as a result of the study to lessen damage to the building structure.

3. If additional construction to the present facility is recommended as a result of the engineering study, such construction be comprehensive in scope of design to include additional nursing facility space for increasing numbers of residents who need

Ms. Karen Martz
Administrator
Division of Medical Assistance
Health Facilities Licensing and Certification
Re: Kotzebue Senior Citizens Cultural Center
May 5, 1992
Page 8

or will soon require such level of care.

In conclusion, I am very concerned about the residents residing in the two residential wings. I sincerely hope that the engineering study will be funded as soon as practicable, and certainly in time for this construction season, so that life safety issues can be addressed. Then, once the problems and solutions are identified, resolution of the problems will lead to a safe and enjoyable residence for the elderly of Kotzebue.

I wish to thank Joan Fullbright, RN, and Geri Desmarais, RN, for their expertise and professional leadership. They were most enjoyable, eagerly offered assistance to all of us, and demonstrated a high degree of professionalism in their approach to the task. Their involvement was greatly appreciated by all of us and I look forward to working with them again in the future.

If I can be of further service to your agency, please do not hesitate to contact me.

Very truly yours,

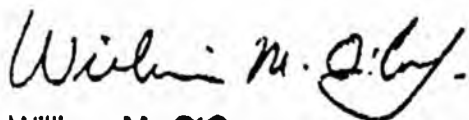

William M. O'Connor
Ombudsman

Encl. Building schematic drawing

cc: Senator Al Adams Office
 %Elmer Lindstrom

Marle Green, president
Manillaq Association

Jay Livey, Deputy Commissioner, DHSS

Kim Busch - DMA

Ms. Karen Martz
Administrator
Division of Medical Assistance
Health Facilities Licensing and Certification
Re: Kotzebue Senior Citizens Cultural Center
May 5, 1992
Page 9

Pat O'Brien - DFYS

Chester Weger - Fire Prevention

Connie J. Sipe - OAC

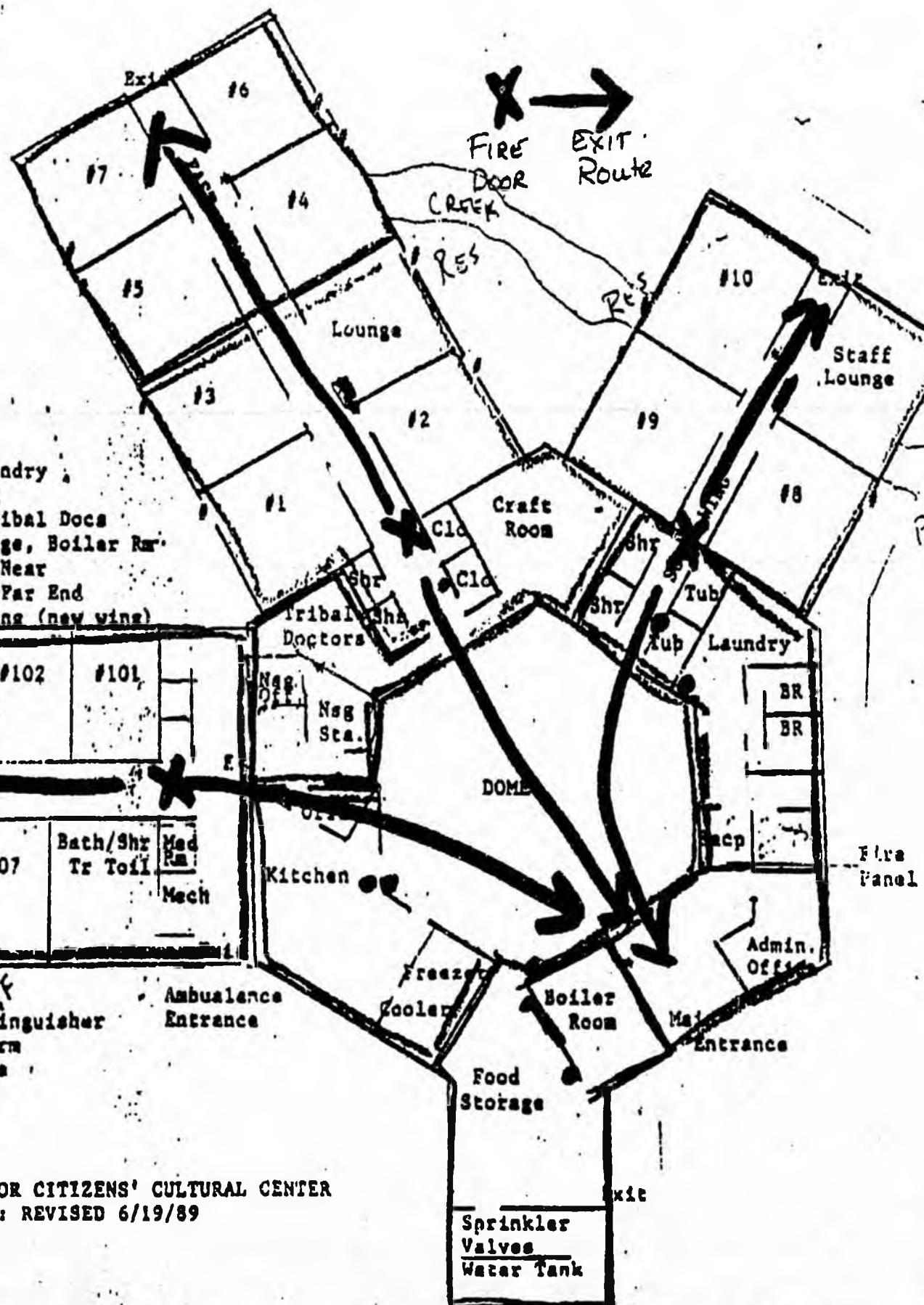
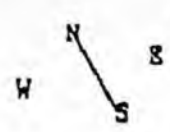

FIRE ZONES

- Zone 1: Kitchen
- Zone 2: Admin, Laundry
- Zone 3: South Wing
- Zone 4: Nsg Sta, Tibal Docs
- Zone 5: Food Storage, Boiler Rm
- Zone 6: East Wing Near
- Zone 7: East Wing Far End
- Zone 8: Nursing Wing (new wing)

#104	BR	#102	#101
	Soiled Utility		
#105	Glean Utility	#107	Bath/Shr Tr Toile
			Mech

- - Fire Extinguisher
 - * - Fire Alarm
 - Fire Hose
- Ambulance Entrance

KOTZEBUE SENIOR CITIZENS' CULTURAL CENTER
SCHEMATIC: REVISED 6/19/89

Sprinkler Valves
 Water Tank

MEMORANDUM

To: Senator Al Adams

From: Elmer A. Lindstrom
Aide

Date: May 1, 1992

Subj: Maniilaq Senior Center
Facility Evaluation/Survey

This morning I spoke to Mr. William O'Connor, long-term care ombudsman, Older Alaskans' Commission. Mr. O'Connor was in Kotzebue this week with an evaluation team from the Division of Family & Youth Services to review the operation of the residential program (not the nursing/Medicaid wing) at the Maniilaq Senior Center.

Mr. O'Connor will be drafting a report on the facility for release next week. He indicated that he has numerous concerns regarding life/health safety aspects of the facility--doors, windows, the electrical system, emergency exit access and others--as well as a concern over the condition of the building's foundation.

Mr. O'Connor believes that given the many problems, it would be prudent to have a qualified firm do a complete evaluation of the facility to identify all problems and the costs associated with the necessary improvements. I asked Mr. O'Connor if he had any idea how much such an evaluation would cost and he referred me to the firm of Rodney P. Inney Associates, Inc. for an informal estimate. Attached is the estimate provided by Mr. Kinney. The total is \$95,000 which includes installation of temperature monitoring equipment to gain an understanding of the recurring permafrost/structural movement problem.

Senior Center Evaluation

Page 2

I have also asked the Department of Health & Social Services to provide an estimate of the cost of this type of evaluation. I have not yet received a response from the department.

An appropriation for this purpose would be suitable for inclusion in the capital budget. I suggest that the appropriation should be made to the Department of Administration, Older Alaskans' Commission. The commission would then contract for these services through the normal procurement process. Presumably, the commission would then be in a position to support the required capital projects in FY 94 to fix these problems. In the past, we have had little success in obtaining agency support for improvements to the facility.

On a related matter, we have submitted a reappropriation request to transfer the \$230,000 appropriated last year to the Department of Health and Social Services for stabilizing the center foundation to the Older Alaskans' Commission for payment as a grant to Maniilaq. The language is broadened to allow for other emergency repairs. Mr. O'Connor believes the foundation problem will cost far more than the \$230,000 appropriated last year. The \$230,000 would be available this year to meet the most pressing maintenance and renovation needs. A letter from the Department of Health and Social Services in support of the reappropriation is attached along with last year's capital budget request from Maniilaq.

Attachments

cc: Representative Eileen MacLean

FAX MEMO

TO: Senator Al Adams
c/o Elmer Lindstrom
Fax #463-4867

DATE: May 1, 1992

SUBJECT: Manilaq Senior Center
Kotzebue, Alaska

This fax reiterates my telephone conversation with you today regarding the structural movement and building distress occurring at the subject site. We have been aware of this problem for some time and Manilaq is aware of our professional qualifications, which will not be repeated here other than by reference. Our opinions are:

1. The permafrost and degree of restabilization of the last thermal retrofit should be assessed. Our approach would be similar to one we are conducting for UAF at Bethel; basically a phased approach. Phase 1 would be a site inspection, level loop of the floor surface, measurement of the refrigerant pressure, etc.; Phase 2 would be installation of at least two slanted test holes with thermistor installation for temperature monitoring. If accomplished by equivalent RPKA standards, it is estimated that Phases 1 & 2 would cost \$15k and \$45k respectively (assumes a local drill rig is available).
2. A structural, architectural, ME/EE code inspection and report is estimated at \$30 to \$35k.

In both cases, no working drawing or specifications would be included and would be extra. Since we have no idea what must be done now, we will not give you an estimate on this. With respect to any fixes, my initial impression is that it will take much more than is currently estimated.

Very truly yours,
RODNEY P. KINNEY ASSOCIATES, INC.

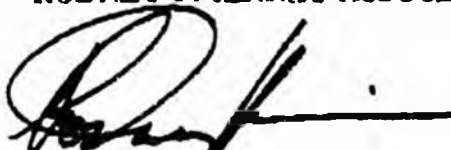

Rodney P. Kinney, Sr., P.E.

RPK:dmt

5-12-92

Adopted

Incorporated in SCS (Fin) 470

1 * SEC. 3 THE FOLLOWING APPROPRIATION ITEMS ARE FOR
 2 CAPITAL PROJECTS AND GRANTS FROM THE GENERAL FUND OR
 3 OTHER FUNDS AS SET OUT IN SECTION 4 OF THIS ACT BY
 4 FUNDING SOURCE TO THE AGENCIES NAMED AND FOR THE
 5 PURPOSES EXPRESSED.

6		ALLOCATIONS	APPROPRIATION ITEMS	APPROPRIATION FUND SOURCES	GENERAL FUND	OTHER FUNDS
8	*****		*****			
9	*****	OFFICE OF THE GOVERNOR	*****			
10	*****		*****			
11	DEVELOPMENT					
12			500,000	500,000		
	ARCTIC NATIONAL WILDLIFE REFUGE NATIONAL EDUCATION EFFORT (ED 99)					
13			219,000	219,000		
	NATURE CONSERVANCY (ED 99)					
14	GENERAL GOVERNMENT					
15			100,000	100,000		
	DIVISION OF ELECTIONS - VOTING EQUIPMENT PURCHASE (ED 99)					
16	*****		*****			
17	*****	DEPARTMENT OF ADMINISTRATION	*****			
18	*****		*****			
19	SOCIAL SERVICES					
20			2,000,000	2,000,000		
	PIONEERS' HOME REPAIRS AND RENOVATION (ED 99)					
21	ADMINISTRATION OF JUSTICE					
22			239,000	239,000		
	PUBLIC DEFENDER LEGAL BRIEFS AND RESEARCH/CASELOAD MANAGEMENT COMPUTERIZATION (ED 99)					
23			124,200	124,200		
	OFFICE OF PUBLIC ADVOCACY WORD PROCESSING/CASE MANAGEMENT/TRUST ACCOUNT COMPUTERIZATION (ED 99)					

1 DEPARTMENT OF ADMINISTRATION (CONT.)					1
2					2
3					3
4 GENERAL GOVERNMENT					4
5 COMBINED RETIREMENT DATA PROCESSING SYSTEM (ED 99)					5
6 DATA PROCESSING SOFTWARE AND HARDWARE SYSTEM					6
7 CAMPAIGN DISCLOSURE FILING BY DISKETTE (ED 99)					7
8					8
9					9
10					10
11 GENERAL GOVERNMENT					11
12 FEDERAL LAWSUITS (ED 99)					12
13					13
14					14
15					15
16 SOCIAL SERVICES					16
17 CHILD SUPPORT COMPUTER IMAGING MANAGEMENT SYSTEM					17
18					18
19					19
20					20
21 EDUCATION					21
22 SCHOOL CONSTRUCTION GRANT ACCOUNT PROJECTS					22
23 LOWER KUSKOKWIM SCHOOLS - AKIUK SCHOOL REPLACEMENT					23
PHASE II (ED 25)					
		ALLOCATIONS	APPROPRIATION	APPROPRIATION FUND SOURCES	
			ITEMS	GENERAL FUND	OTHER FUNDS
			750,000		750,000
			1,200,000	1,200,000	
			31,200	31,200	
	*****	*****			
	***** DEPARTMENT OF LAW *****				
	*****	*****			
			1,200,000	1,200,000	
	*****	*****			
	***** DEPARTMENT OF REVENUE *****				
	*****	*****			
			2,540,000	254,000	2,286,000
	*****	*****			
	***** DEPARTMENT OF EDUCATION *****				
	*****	*****			
			23,184,900	23,184,900	
		6,913,000			

1	DEPARTMENT OF EDUCATION (CONT.)				1
2			APPROPRIATION	APPROPRIATION	FUND SOURCES
3		ALLOCATIONS	ITEMS	GENERAL FUND	OTHER FUNDS
4	KETCHIKAN GATEWAY BOROUGH SCHOOLS - KETCHIKAN HIGH SCHOOL PHASE III (ED 1)	5,623,700			
5	NOME-BELTZ SCHOOL LIFE SAFETY UPGRADE/ASBESTOS (ED 23)	885,000			
6	LOWER KUSKOKWIM SCHOOLS - NUNAPITCHUK ELEMENTARY SCHOOL ADDITION (ED 25)	2,500,000			
7	KODIAK ISLAND BOROUGH SCHOOLS - OLD HARBOR K-12 STRUCTURAL REPAIR (ED 27)	525,000			
8	HOONAH CITY SCHOOLS - SPRINKLER SYSTEM/LIFE/SAFETY PHASE II (ED 2)	1,738,200			
9	ALASKA GATEWAY SCHOOLS - TOK SCHOOL REPLACEMENT (ED 17)	5,000,000			
10	REGIONAL BOARDING SCHOOL FEASIBILITY STUDY (ED 99)		200,000	200,000	
11	ALASKA VOCATIONAL TECHNICAL CENTER MAINTENANCE/EQUIPMENT/DORMITORY (ED 6)		250,000	250,000	
12	MT. EDGEKUMBE - NEW DORMITORY CONSTRUCTION SUPPLEMENTAL FUNDING (ED 3)		545,000	545,000	
13	MT. EDGEKUMBE - REPAIR AND MAINTENANCE (ED 3)		200,000	200,000	
14	MT. EDGEKUMBE - CONTAMINATED SITE CLEANUP (ED 3)		430,000		430,000
15	STATE LIBRARY MATERIALS, EQUIPMENT AND FURNITURE (ED 99)		200,000	200,000	
16	PUBLIC LIBRARY CONSTRUCTION GRANTS (ED 99)		140,000		140,000
17	GENERAL GOVERNMENT				
18	MICROGRAPHICS LABORATORY VENTILATION (ED 4)		77,700	77,700	

1		ALLOCATIONS	APPROPRIATION ITEMS	APPROPRIATION GENERAL FUND	FUND SOURCES OTHER FUNDS	1
2						2
3		*****	*****			3
4		***** DEPARTMENT OF HEALTH & SOCIAL SERVICES	*****			4
5		*****	*****			5
6	SOCIAL SERVICES					6
7	MCLAUGHLIN YOUTH CENTER					7
8	FIRE ALARM REPLACEMENT (ED 7-15)		250,000	250,000		8
9	EDUCATION FACILITY REPLACEMENT (ED 7-15)		5,250,000	5,250,000		9
10	HEALTH					10
11	CENTRAL LABORATORY FEASIBILITY STUDY (ED 99)		25,000	25,000		11
12	RENOVATION, REPAIR, EQUIPMENT AND DEFERRED MAINTENANCE (ED 99)		1,200,000	1,200,000		12
13	MENTAL HEALTH FACILITIES					13
14	ALASKA PSYCHIATRIC INSTITUTE INTERIM REPAIRS (ED 99)		1,000,000	1,000,000		14
15	ALASKA PSYCHIATRIC INSTITUTE BUILDING REPLACEMENT (ED 99)		2,000,000	2,000,000		15
16	MENTAL HEALTH FACILITY GRANTS		2,635,000	2,635,000		16
17	HOPE COTTAGES HOUSING PURCHASE (ED 7-15)	400,000				17
18	WORONZOF ALCOHOL TREATMENT CENTER HANDICAPPED ACCESS/GAS CONVERSION (ED 7-15)	450,000				18
19	ALASKA ALLIANCE FOR THE MENTALLY ILL - ANCHORAGE HOMELESS HOUSING (ED 7-15)	200,000				19
20	FAIRBANKS NATIVE ASSOCIATION LONG-TERM CARE FACILITY (ED 19-21)	900,000				20
21	KODIAK ISLAND MENTAL HEALTH CENTER - TOWNHOUSES REHABILITATION FOR YOUTH PROGRAM (ED 27)	25,000				21

1	DEPARTMENT OF HEALTH & SOCIAL SERVICES (CONT.)				1
2			APPROPRIATION	APPROPRIATION	FUND SOURCES
3		ALLOCATIONS	ITEMS	GENERAL FUND	OTHER FUNDS
4	JUNEAU ALLIANCE FOR THE MENTALLY ILL - WIRING RENOVATIONS/BATHROOM RENOVATION (ED 4)	150,000			
5	YUKON - KUSKOKWIM HEALTH CORPORATION EMERGENCY SERVICES, RECEPTION AREA, DETOXIFICATION FACILITY (ED 25)	150,000			
6	NORTH SLOPE BOROUGH DETOXIFICATION CENTER REMODELING (ED 22)	80,000			
7	MANTILAQ COUNSELING SERVICES - VEHICLE PURCHASE (ED 22)	20,000			
8	NORTON SOUND HEALTH CORPORATION - REGIONAL HOSPITAL REMODELING FOR PSYCHIATRIC BEDS (ED 23)	50,000			
9	LIFEQUEST YOUTH EMERGENCY SHELTER PURCHASE - WASILLA (ED 16)	80,000			
10	SEWARD LIFE ACTION REPAIR AND UPGRADE MULTI-PROGRAM FACILITY (ED 6)	10,000			
11	DAYBREAK CENTER FACILITY IMPROVEMENTS - PALMER (ED 16)	20,000			
12	CENTRAL PENINSULA COUNSELING SERVICES SENIOR PROGRAM FACILITY (ED 5)	100,000			
13		*****	*****		
14		***** DEPARTMENT OF LABOR *****			
15		*****	*****		
16	SOCIAL SERVICES				
17	GOVERNOR'S COMMITTEE ON EMPLOYMENT OF PEOPLE WITH DISABILITIES - FACILITIES ASSESSMENT - AMERICANS WITH DISABILITIES ACT (ED 99)		30,000	30,000	
18	IT IS THE INTENT OF THE LEGISLATURE THAT THE DEPARTMENT				
19	OF TRANSPORTATION AND PUBLIC FACILITIES WORK WITH THE				
20	GOVERNOR'S COMMITTEE ON EMPLOYMENT OF PEOPLE WITH				

1	DEPARTMENT OF LABOR (CONT.)				1
2			APPROPRIATION	APPROPRIATION	FUND SOURCES
3		ALLOCATIONS	ITEMS	GENERAL FUND	OTHER FUNDS
4	DISABILITIES TO DEVELOP A PRIORITIZED LIST OF BARRIER				
5	FREE ACCESS IMPROVEMENT PROJECTS.				
6	ENHANCED ACCESS TO DEPARTMENTAL INFORMATION AND SERVICES (ED 99)		1,706,500	143,800	1,562,700
7	*****		*****		
8	***** DEPARTMENT OF COMMERCE & ECONOMIC DEVELOPMENT		*****		
9	*****		*****		
10	PUBLIC PROTECTION				
11	RECODIFICATION OF THE BANKING CODE (ED 99)		125,000	125,000	
12	DEVELOPMENT				
13	ECONOMIC DEVELOPMENT MATCHING GRANT PROGRAM (ED 99)		700,000	700,000	
14	EXPANDING ALASKA'S SMALL BUSINESS SECTOR (ED 99)		253,000	253,000	
15	NORTHERN SEA ROUTE DEVELOPMENT (ED 99)		200,000	200,000	
16	NORTHERN FORUM EQUIPMENT (ED 99)		50,000	50,000	
17	EAGLE GLACIER NORDIC TRAINING CAMP COMPLETION (ED 7-15)		70,000	70,000	
18	NORTHWEST ARCTIC COAL DEVELOPMENT (ED 99)		500,000	500,000	
19	ALASKA ENERGY AUTHORITY				
20	OPERATION, TECHNICAL AND EMERGENCY ASSISTANCE (ED 99)		1,700,000	1,700,000	
21	ELECTRIC SYSTEM LIFE, HEALTH AND SAFETY IMPROVEMENTS (ED 99)		1,500,000	1,500,000	
22	RURAL POWER SYSTEM UPGRADES (ED 99)		2,000,000	2,000,000	

1	DEPARTMENT OF COMMERCE & ECONOMIC DEVELOPMENT (CONT.)				1
2			APPROPRIATION	APPROPRIATION FUND SOURCES	2
3		ALLOCATIONS	ITEMS	GENERAL FUND	OTHER FUNDS
4	BULK FUEL EMERGENCY REPAIR/UPGRADES (ED 99)		1,000,000	1,000,000	4
5	STATEWIDE ELECTRIC AND POWER PROJECT DEVELOPMENT (ED 99)		250,000	250,000	5
6	WASTE HEAT PROGRAM (ED 99)		250,000	250,000	6
7	ENERGY ENHANCEMENTS (ED 99)		250,000	250,000	7
8	ELECTRICAL SERVICE EXTENSION FUND (ED 99)		750,000	750,000	8
9	KING COVE HYDROELECTRIC PROJECT CONSTRUCTION (ED 26)		2,500,000	2,500,000	9
10	*****		*****		10
11	***** DEPARTMENT OF MILITARY & VETERANS AFFAIRS *****				11
12	*****		*****		12
13	PUBLIC PROTECTION				13
14	ARMY GUARD FACILITIES				14
15	SCHEDULED RENEWAL/REPLACEMENT/CODE UPGRADE (ED 99)		250,000	250,000	15
16	CONSTRUCTION/CONTINGENCY/PLANNING (ED 99)		2,000,000		2,000,000 16
17	*****		*****		17
18	***** DEPARTMENT OF NATURAL RESOURCES *****				18
19	*****		*****		19
20	HEALTH				20
21	MENTAL HEALTH TRUST LAND SETTLEMENT IMPLEMENTATION (ED 99)		1,500,000	1,500,000	21
22	NATURAL RESOURCE MANAGEMENT				22
23	STATE LAND STATUS GEOGRAPHIC INFORMATION SYSTEM PROJECT (ED 99)		300,000	300,000	23

1	DEPARTMENT OF NATURAL RESOURCES (CONT.)				1
2		ALLOCATIONS	APPROPRIATION ITEMS	APPROPRIATION GENERAL FUND	FUND SOURCES OTHER FUNDS 2
3					3
4	RECORDER'S OFFICE/UCC RECORDS PROTECTION AND ACCESS PROJECT (ED 99)		50,000	50,000	4
5	OIL AND GAS ROYALTY ACCOUNTING SYSTEM HARDWARE AND SOFTWARE UPGRADES (ED 99)		50,000	50,000	5
6	LAND AND WATER MANAGEMENT				6
7	STATEHOOD ENTITLEMENT SELECTIONS (ED 99)		1,500,000	1,500,000	7
8	FORESTRY				8
9	FOREST HEALTH INITIATIVE (ED 99)		45,000	45,000	9
10	FORESTRY DEFERRED FACILITY MAINTENANCE (ED 99)		95,000	95,000	10
11	CONTAMINATED SITE CLEANUP - PENINSULA GREENHOUSE, SOLDOTNA (ED 5)		178,000		178,000 11
12	PETROLEUM MANAGEMENT				12
13	CONTAMINATED SITE CLEANUP - FORWARD PAD (LEASE TRACTS 75 AND 76), DEADHORSE (ED 22)		490,000		490,000 13
14	CONTAMINATED SITE CLEANUP - CHILDS PAD (LEASE TRACT 54), DEADHORSE (ED 22)		300,000		300,000 14
15	GEOLOGICAL MANAGEMENT				15
16	GEOPHYSICAL/GEOLOGICAL MINERAL INVENTORY (ED 99)		600,000	600,000	16
17	PARKS MANAGEMENT				17
18	NATIONAL HISTORIC PRESERVATION FUND AND FEDERAL GRANTS (ED 99)		640,000		640,000 18
19	CONTAMINATED SITE CLEANUP - TOK RIVER CAMPGROUND (ED 17)		38,000		38,000 19
20	DEVELOPMENT				20
21	PARKS MANAGEMENT				21
22	LAND AND WATER CONSERVATION FUND FEDERAL GRANTS (ED 99)		1,000,000		1,000,000 22

1	DEPARTMENT OF NATURAL RESOURCES (CONT.)				1
2			APPROPRIATION	APPROPRIATION	FUND SOURCES
3		ALLOCATIONS	ITEMS	GENERAL FUND	OTHER FUNDS
4	NEW RECREATION/TOURISM FACILITY DEVELOPMENT (ED 99)		245,000	245,000	
5	REHABILITATION AND EXPANSION OF TOURIST FACILITIES (ED 99)		800,000	800,000	
6		*****			
7		***** DEPARTMENT OF FISH & GAME *****			
8		*****			
9	NATURAL RESOURCE MANAGEMENT				
10	KUSKOKWIM RIVER, YUKON RIVER, AND NORTON SOUND FISHERIES INITIATIVE (ED 99)		200,000	200,000	
11	GROUND FISH FISHERIES ECONOMIC RETURNS TO THE STATE (ED 99)		200,000	200,000	
12	GENETIC FISH STOCK IDENTIFICATION (ED 99)		500,000	500,000	
13	DEFERRED MAINTENANCE, RENEWAL, AND REPLACEMENT (ED 99)		750,000	750,000	
14	VESSELS MAJOR MAINTENANCE (ED 99)		100,000	100,000	
15	PUBLIC ACCESS DEVELOPMENT STATEWIDE		1,600,000	400,000	1,200,000
16	PILLARS RAMP DEVELOPMENT (ED 99)	450,000			
17	MARINE BOATING ACCESS (ED 99)	250,000			
18	SPORTSMEN'S RAMP ACQUISITION (ED 99)	350,000			
19	EAGLE RIVER ACCESS IMPROVEMENTS (ED 7-15)	150,000			
20	SKALL ACCESS PROJECTS (ED 99)	400,000			
21	HATCHERY FACILITY MAINTENANCE AND REPAIR (ED 99)		500,000	500,000	
22	HATCHERY IMPROVEMENTS TO PREPARE FOR TRANSFER OF FACILITIES (ED 1)		2,725,000	2,725,000	

		ALLOCATIONS	APPROPRIATION ITEMS	APPROPRIATION GENERAL FUND	APPROPRIATION OTHER FUNDS	FUND SOURCES
1						1
2						2
3		*****	*****			3
4		***** DEPARTMENT OF PUBLIC SAFETY	*****			4
5		*****	*****			5
6	PUBLIC PROTECTION					6
7	LICENSE PLATES / DRIVERS MANUALS / EQUIPMENT / STATUTES (ED 99)		700,000	700,000		7
8	MOTOR VEHICLE PUBLIC SERVICES IMPROVEMENTS (ED 99)		200,000	200,000		8
9	FISH AND WILDLIFE PROTECTION EQUIPMENT REPLACEMENT (ED 99)		200,000	200,000		9
10	AIRCRAFT EQUIPMENT/OVERHAUL/REPAIR (ED 99)		250,000	250,000		10
11	ENFORCEMENT VESSEL REPAIRS (ED 99)		800,000	800,000		11
12	ALASKA STATE TROOPER EQUIPMENT REPLACEMENT (ED 99)		400,000	400,000		12
13	LAW ENFORCEMENT AIRCRAFT (ED 99)		1,600,000	1,600,000		13
14	FACILITIES RENEWAL AND REPLACEMENT (ED 99)		500,000	500,000		14
15		*****	*****			15
16		***** DEPARTMENT OF TRANSPORTATION/PUBLIC FACILITIES	*****			16
17		*****	*****			17
18	TRANSPORTATION					18
19	STATEWIDE PROGRAMS					19
20	GENERAL FUND MATCH FOR FEDERAL-AID HIGHWAYS (ED 99)		25,000,000	25,000,000		20
21	GENERAL FUND MATCH FOR FEDERAL-AID AVIATION (ED 99)		5,500,000	5,500,000		21
22	STATE EQUIPMENT FLEET REFURBISHMENT AND REPLACEMENT PROGRAM (ED 99)		12,300,000		12,300,000	22
23	DOT&PF MAINTAINED FACILITIES ENERGY AND CODE UPGRADE (ED 99)		2,000,000	2,000,000		23

1	DEPARTMENT OF TRANSPORTATION/PUBLIC FACILITIES (CONT.)				1	
2		ALLOCATIONS	APPROPRIATION ITEMS	APPROPRIATION FUND SOURCES	2	
3				GENERAL FUND	OTHER FUNDS	
3					3	
4	CORPS OF ENGINEERS PROGRAM (ED 99)		1,500,000	1,500,000		4
5	STATEWIDE ANNUAL PLANNING WORK PROGRAM (ED 99)		4,750,000	550,000	4,200,000	5
6	STATEWIDE FACILITIES MAJOR REPAIR, RENOVATION AND EQUIPMENT (ED 99)		1,000,000	1,000,000		6
7	HIGHWAY/AVIATION NON-ROUTINE MAINTENANCE EXCEPT THE COPPER RIVER HIGHWAY BETWEEN MILLION DOLLAR BRIDGE AND O'BRIEN CREEK (ED 99)		1,000,000	1,000,000		7
8	PORTS AND HARBORS NON-ROUTINE MAJOR REPAIRS (ED 99)		1,000,000	1,000,000		8
9	ANNUAL BRIDGE INSPECTION AND INVENTORY (ED 99)		870,000	120,000	750,000	9
10	STATEWIDE ADVANCED PROJECT DEFINITION EXCEPT THE COPPER RIVER HIGHWAY BETWEEN MILLION DOLLAR BRIDGE AND O'BRIEN CREEK (ED 99)		300,000	300,000		10
11	FACILITIES ASSESSMENT - AMERICANS WITH DISABILITIES ACT (ED 99)		170,000	170,000		11
12	IT IS THE INTENT OF THE LEGISLATURE THAT THE DEPARTMENT					12
13	OF TRANSPORTATION AND PUBLIC FACILITIES WORK WITH THE					13
14	GOVERNOR'S COMMITTEE ON EMPLOYMENT OF PEOPLE WITH					14
15	DISABILITIES TO DEVELOP A PRIORITIZED LIST OF BARRIER					15
16	FREE ACCESS IMPROVEMENT PROJECTS.					16
17	MANDATORY STORM WATER POLLUTION CONTROL (ED 99)		500,000		500,000	17
18	HIGHWAY REST STOPS AND TOURISM CENTERS (ED 99)		400,000		400,000	18
19	FEDERAL TRANSIT ADMINISTRATION METROPOLITAN GRANTS (ED 99)		200,000		200,000	19
20	FEDERAL TRANSIT ADMINISTRATION GRANTS (ED 99)		815,000	15,000	800,000	20
21	STATEWIDE URBAN AREA PLANNING (ED 99)		700,000		700,000	21

1	DEPARTMENT OF TRANSPORTATION/PUBLIC FACILITIES (CONT.)				1
2			APPROPRIATION	APPROPRIATION	FUND SOURCES
3		ALLOCATIONS	ITEMS	GENERAL FUND	OTHER FUNDS
4	STATEWIDE NATIONAL HIGHWAY INSTITUTE TRAINING PROGRAM (ED 99)		300,000		300,000
5	STRATEGIC HIGHWAY RESEARCH PROGRAM SEASONAL MONITORING STUDY (ED 99)		215,000		215,000
6	STATEWIDE RURAL TECHNOLOGY ASSISTANCE PROGRAM (ED 99)		200,000		200,000
7	STATEWIDE SURVEY AND ENGINEERING EQUIPMENT REPLACEMENT (ED 99)		200,000		200,000
8	STATEWIDE TOTAL QUALITY MANAGEMENT (ED 99)		200,000		200,000
9	STATEWIDE U.S. GEOLOGICAL SURVEY FLOOD ANALYSIS (ED 99)		200,000		200,000
10	STANDARDS MANUALS PUBLISHING (ED 99)		80,000	80,000	
11	RAILROAD PLANNING (ED 99)		36,000		36,000
12	STATEWIDE FEDERAL HIGHWAYS EXPERIMENTAL FEATURES PROGRAM (ED 99)		30,000		30,000
13	MAINTENANCE STATION SITE CONTAMINATION ASSESSMENTS (ED 99)		250,000	250,000	
14	RURAL VILLAGE SEWER, WATER AND SANITATION ROADS (ED 99)		3,200,000		3,200,000
15	CENTRAL REGION FEDERAL HIGHWAY PROGRAM		144,437,200		144,437,200
16	MINNESOTA DRIVE, TUDOR TO INTERNATIONAL AIRPORT ROAD RECONSTRUCTION (ED 7-15)	16,854,900			
17	PARKS HIGHWAY, MP 44-71 REHABILITATION (ED 16)	15,881,400			
18	GLENH HIGHWAY, HILAND INTERCHANGE REHABILITATION (ED 7-15)	2,335,500			
19	SEWARD HIGHWAY, MP 50-65.5 RECONSTRUCTION (ED 6)	15,414,300			

1 DEPARTMENT OF TRANSPORTATION/PUBLIC FACILITIES (CONT.)

2		ALLOCATIONS	APPROPRIATION	APPROPRIATION	FUND SOURCES	2
3			ITEMS	GENERAL FUND	OTHER FUNDS	3
4	FEDERAL HIGHWAYS ADMINISTRATION PRELIMINARY ENGINEERING (ED 99)	15,883,000				4
5	IT IS THE INTENT OF THE LEGISLATURE THAT NO PART OF THIS					5
6	APPROPRIATION MAY BE SPENT ON ACTIVITIES RELATED TO THE					6
7	BRAGAW STREET EXTENSION OR THE NORTHSIDE CORRIDOR					7
8	PROPOSALS.					8
9	GLENN HIGHWAY, EKLUTNA TO PARKS PAVING/BRIDGES/ INTERCHANGES (ED 16)	12,677,500				9
10	SEWARD HIGHWAY, BIRD POINT TO GIRWOOD RECONSTRUCT EMBANKMENT (ED 7-15)	16,815,600				10
11	KENAI SPUR ROAD, MP 2.8-10.7 RECONSTRUCTION (ED 5)	5,104,800				11
12	STERLING HIGHWAY, MP 79-82 RECONSTRUCTION/UPGRADE (ED 5)	5,000,000				12
13	STERLING HIGHWAY, MP 174-179 PAVEMENT REHABILITATION (ED 5)	3,456,500				13
14	KODIAK - REZANOF DRIVE REHABILITATION (ED 27)	3,858,900				14
15	ABBOTT ROAD, NEW SEWARD HIGHWAY TO 88TH REALIGNMENT (ED 7-15)	3,016,100				15
16	PORT ACCESS BRIDGE REHABILITATION (ED 7-15)	2,500,000				16
17	EAST 5TH AVENUE/GAMBLE TO MCCARREY PAVEMENT REHABILITATION (ED 7-15)	3,970,300				17
18	GLENN HIGHWAY, SOUTH EAGLE RIVER ACCESS INTERCHANGE (ED 7-15)	1,644,200				18
19	SEWARD HIGHWAY, PORTAGE ROAD/ALASKA RAILROAD MODIFICATIONS (ED 7-15)	1,620,000				19
20	FIREWEED LANE, SEWARD HIGHWAY TO SPENARD SAFETY UPGRADES (ED 7-15)	1,584,000				20

1	DEPARTMENT OF TRANSPORTATION/PUBLIC FACILITIES (CONT.)				1
2			APPROPRIATION	APPROPRIATION FUND SOURCES	2
3		ALLOCATIONS	ITEMS	GENERAL FUND	OTHER FUNDS
3					3
4	CENTRAL REGION SAFETY PROGRAM (ED 99)	1,350,000			4
5	JEWEL LAKE ROAD, DIMOND TO INTERNATIONAL AIRPORT ROAD PAVEMENT REHABILITATION (ED 7-15)	1,241,900			5
6	OLD SEWARD HIGHWAY INTERSECTIONS PAVEMENT REHABILITATION (ED 7-15)	1,214,500			6
7	KODIAK - REZANOF DRIVE INTERSECTION IMPROVEMENTS (ED 27)	1,153,200			7
8	RABBIT CREEK ROAD PAVEMENT REHABILITATION (ED 7-15)	1,027,600			8
9	SEWARD HIGHWAY, BIRD POINT TO GIRDWOOD RECONSTRUCTION (ED 7-15)	1,401,300			9
10	BETHEL BROWN'S SLOUGH BRIDGE REPLACEMENT (ED 25)	1,419,400			10
11	ANCHORAGE CAPACITY IMPROVEMENTS (ED 7-15)	709,700			11
12	MATANUSKA-SUSITNA VARIOUS INTERSECTION UPGRADES (ED 16)	640,100			12
13	EAST ANCHORAGE SAFETY PROGRAM (ED 7-15)	562,500			13
14	CENTRAL REGION SIGNING AND TURNOUT UPGRADES (ED 99)	450,000			14
15	ANCHORAGE TRANSIT CAPITAL PROJECTS (ED 7-15)	443,600			15
16	EXIT GLACIER ROAD, MP 0-3.9 RECONSTRUCTION (ED 6)	443,600			16
17	HILLSIDE DRIVE/DEARMOND TO O'MALLEY PAVEMENT REHABILITATION (ED 7-15)	373,300			17
18	OLD GLENN HIGHWAY, PALMER TO CLARK-WOLVERINE ROAD RECONSTRUCTION (ED 16)	354,800			18
19	STERLING HIGHWAY, SOLDOTNA URBAN/KENAI RIVER BRIDGE UPGRADE (ED 5)	310,500			19
20	WEST ANCHORAGE SAFETY PROGRAM (ED 7-15)	297,000			20

1	DEPARTMENT OF TRANSPORTATION/PUBLIC FACILITIES (CONT.)				1	
2			APPROPRIATION	APPROPRIATION FUND SOURCES	2	
3		ALLOCATIONS	ITEMS	GENERAL FUND	OTHER FUNDS	
3					3	
4	ANCHORAGE RIDESHARING PROGRAM (ED 7-15)	270,000				4
5	KENAI SPUR ROAD, MP 0-2.8 RECONSTRUCTION PHASE II (ED 5)	230,600				5
6	STERLING HIGHWAY, MP 157-174 RECONSTRUCTION/UTILITY RELOCATION (ED 5)	887,100				6
7	KENAI SPUR ROAD, MAIN STREET SIGNALIZATION (ED 5)	225,000				7
8	MULDOON ROAD, 36TH TO GLENN PAVEMENT REHABILITATION (ED 7-15)	1,214,500				8
9	INTERSTATE PAVEMENT PREVENTIVE MAINTENANCE (ED 99)	600,000				9
10	CENTRAL REGION STATE HIGHWAY PROGRAM					10
11	BONIFACE/NORTHERN LIGHTS, DEBARR CONTAMINATED SITE ASSESSMENT (ED 7-15)		250,000		250,000	11
12	CENTRAL REGION FEDERAL AVIATION PROGRAM		39,101,700		39,101,700	12
13	CHIGNIK LAGOON AIRPORT RECONSTRUCTION/LAND ACQUISITION/RELOCATION (ED 27)	4,900,000				13
14	CHENEGA BAY AIRPORT DEVELOPMENT (ED 6)	3,328,200				14
15	UNALASKA AIRPORT STORM PROTECTION (ED 26)	2,200,000				15
16	HOMER AIRPORT IMPROVEMENTS (ED 5)	1,137,500				16
17	KODIAK AIRPORT FENCING (ED 27)	703,100				17
18	COLD BAY ARFF BUILDING CONSTRUCTION (ED 26)	656,300				18
19	OLD HARBOR AIRPORT RECONSTRUCTION/RELOCATION (ED 27)	600,000				19
20	KING SALMON AIRPORT RUNWAY LIGHTING (ED 26)	515,600				20
21	TOKSOOK BAY AIRPORT MASTER PLAN (ED 25)	187,500				21

1	DEPARTMENT OF TRANSPORTATION/PUBLIC FACILITIES (CONT.)				1
2			APPROPRIATION	APPROPRIATION	FUND SOURCES
3		ALLOCATIONS	ITEMS	GENERAL FUND	OTHER FUNDS
4	UNALASKA AIRPORT FENCING (ED 26)	150,000			
5	HOOPER BAY AIRPORT SNOW REMOVAL EQUIPMENT (ED 23)	129,400			
6	TWIN HILLS AIRPORT IMPROVEMENTS (ED 26)	1,406,300			
7	AIRPORT IMPROVEMENT PROJECTS PRELIMINARY ENGINEERING (ED 99)	1,500,200			
8	KING SALMON AIRPORT FENCING AND EQUIPMENT BUILDING (ED 26)	1,359,400			
9	NONDALTON AIRPORT APRON CONSTRUCTION/RUNWAY RECONSTRUCTION (ED 26)	3,000,000			
10	IGIUGIG AIRPORT IMPROVEMENTS (ED 26)	1,125,000			
11	SELDON POINT AIRPORT IMPROVEMENTS (ED 23)	2,343,800			
12	KONGIGANEK AIRPORT IMPROVEMENTS (ED 25)	1,875,000			
13	NEW KOLIGANEK AIRPORT RECONSTRUCTION/RELOCATION (ED 26)	1,781,300			
14	ST. MARY'S AIRPORT IMPROVEMENTS (ED 24)	800,000			
15	EGEBIK AIRPORT RECONSTRUCTION/RELOCATION (ED 26)	562,500			
16	ST. MARY'S ARFF VEHICLE/BUILDING UPGRADE (ED 24)	1,000,000			
17	SAND POINT AIRPORT EMBANKMENT, SURFACING AND LIGHTING (ED 26)	1,400,000			
18	WASILLA AIRPORT EQUIPMENT BUILDING AND SNOW REMOVAL EQUIPMENT (ED 16)	440,600			
19	ST. PAUL AIRPORT IMPROVEMENTS (ED 26)	6,000,000			
20	CENTRAL REGION FACILITIES				
21	ANCHORAGE STATE EQUIPMENT FLEET BUILDING REPLACEMENT/PURCHASE (ED 7-15)		1,000,000	1,000,000	

1	DEPARTMENT OF TRANSPORTATION/PUBLIC FACILITIES (CONT.)				1
2			APPROPRIATION	APPROPRIATION FUND SOURCES	2
3		ALLOCATIONS	ITEMS	GENERAL FUND	OTHER FUNDS
4	CONTAMINATED SITE CLEANUP - DOT/PF MAINTENANCE STATION, SOLDOTNA (ED 5)		157,000		157,000
5	CENTRAL REGION BARRIER FREE ACCESS PROJECTS		458,000	458,000	
6	KODIAK COMBINED FACILITY/REGIONAL OFFICE BARRIER FREE IMPROVEMENTS (ED 27)	135,000			
7	ANCHORAGE FISH AND GAME BUILDING BARRIER FREE IMPROVEMENTS (ED 7-15)	120,000			
8	KENAI COURT BUILDING AND VOCATIONAL REHABILITATION ACCESS IMPROVEMENTS (ED 5)	90,000			
9	DILLINGHAM COMBINED FACILITY BARRIER FREE IMPROVEMENTS (ED 26)	70,000			
10	ALASKA PSYCHIATRIC INSTITUTE BARRIER FREE IMPROVEMENTS (ED 7-15)	43,000			
11	CENTRAL REGION DEFERRED MAINTENANCE (ED 99)		1,500,000	1,500,000	
12	IT IS THE INTENT OF THE LEGISLATURE THAT THE DEPARTMENT				
13	OF TRANSPORTATION AND PUBLIC FACILITIES PROVIDE A SIX				
14	MONTH STATUS REPORT, BY REGION, TO THE LEGISLATIVE				
15	BUDGET AND AUDIT COMMITTEE DETAILING EXPENDITURES FROM				
16	THIS APPROPRIATION.				
17	NORTHERN REGION FEDERAL HIGHWAY PROGRAM		65,015,000		65,015,000
18	PARKS HIGHWAY FOUR LANE WIDENING (ED 19-21)	11,500,000			
19	STEESE HIGHWAY, MP 10 NORTH REHABILITATION (ED 19-21)	6,500,000			
20	DALTON HIGHWAY, 21 MILE HILL CONSTRUCTION (ED 24)	6,000,000			
21	DALTON HIGHWAY, MP 364 SOUTH REHABILITATION (ED 22)	6,000,000			

1	DEPARTMENT OF TRANSPORTATION/PUBLIC FACILITIES (CONT.)	1	
2		2	
3	ALLOCATIONS	3	
4	APPROPRIATION ITEMS	4	
5	APPROPRIATION GENERAL FUND	5	
6	APPROPRIATION OTHER FUNDS	6	
7	NORTHERN REGION PRELIMINARY ENGINEERING, RIGHT OF WAY AND UTILITIES (ED 99)	3,480,000	7
8	BADGER ROAD RECONSTRUCTION (ED 18)	5,000,000	8
9	TELLER HIGHWAY, MP 0 WEST REHABILITATION (ED 23)	3,250,000	9
10	TDK CUT-OFF, MP 23 EROSION CONTROL (ED 17)	3,000,000	10
11	1ST/2ND/WILBUR UPGRADE (ED 19-21)	1,910,000	11
12	SHEEP CREEK ROAD REHABILITATION (ED 19-21)	1,800,000	12
13	GLENN HIGHWAY, MP 118-127 RECONSTRUCTION (ED 16)	1,300,000	13
14	COPPER RIVER HIGHWAY, ENVIRONMENTAL ASSESSMENT (ED 6)	500,000	14
15	UNIVERSITY AVENUE/REWAK INTERSECTION RECONSTRUCTION (ED 19-21)	875,000	15
16	DALTON HIGHWAY TO BETTLES PRELIMINARY ENGINEERING (ED 24)	600,000	16
17	NORTHERN REGION SAFETY PROGRAM (ED 99)	800,000	17
18	LATHROP STREET, EXPRESSWAY TO 19TH RECONSTRUCTION/UPGRADE (ED 19-21)	800,000	18
19	VALDEZ AIRPORT ROAD INTERSECTION UPGRADE (ED 6)	150,000	19
20	PARKS HIGHWAY, MP 262 NORTH REHABILITATION (ED 19-21)	5,000,000	20
21	DALTON HIGHWAY, MP 111-174 PRELIMINARY ENGINEERING (ED 24)	1,000,000	21
22	NORTHERN REGION GUARDRAIL UPGRADE (ED 99)	1,000,000	22
23	INTERSTATE PAVEMENT PREVENTIVE MAINTENANCE (ED 99)	900,000	23
24	DALTON HIGHWAY, SLOPE MOUNTAIN SOUTH REHABILITATION/ PRELIMINARY ENGINEERING (ED 99)	750,000	24

1	DEPARTMENT OF TRANSPORTATION/PUBLIC FACILITIES (CONT.)				1		
2			ALLOCATIONS	APPROPRIATION	APPROPRIATION FUND SOURCES	2	
3				ITEMS	GENERAL FUND	OTHER FUNDS	3
4	EUREKA-RAMPART ROAD CONSTRUCTION PRELIMINARY ENGINEERING (ED 99)	600,000					4
5	REMINGTON/JACK WARREN/CLEARWATER - DELTA AREA ROAD IMPROVEMENTS (ED 17)	2,300,000					5
6	NORTHERN REGION FEDERAL AVIATION PROGRAM			45,176,000		45,176,000	6
7	DEADHORSE RUNWAY RECONSTRUCTION (ED 22)	6,350,000					7
8	NOME RUNWAY IMPROVEMENTS (ED 23)	5,000,000					8
9	NORTHERN REGION AVIATION PRELIMINARY ENGINEERING, RIGHT OF WAY AND UTILITIES (ED 99)	2,610,000					9
10	SAVOONGA AIRPORT RESURFACING (ED 23)	2,500,000					10
11	BUCKLAND AIRPORT IMPROVEMENTS (ED 22)	1,700,000					11
12	SHISHMAREF AIRPORT IMPROVEMENTS (ED 23)	1,250,000					12
13	STEBBINS AIRPORT RESURFACING (ED 23)	1,500,000					13
14	CORDOVA AIRPORT IMPROVEMENTS (ED 6)	1,320,000					14
15	NORTHERN REGION AIRPORT MASTER PLANS (ED 99)	1,200,000					15
16	NORTHWAY AIRPORT IMPROVEMENTS (ED 17)	1,500,000					16
17	ST. MICHAEL AIRPORT RELOCATION PHASE II (ED 23)	1,000,000					17
18	NOATAK AIRPORT IMPROVEMENTS (ED 22)	2,300,000					18
19	CLEAR AIRPORT IMPROVEMENTS (ED 17)	700,000					19
20	KANTISHNA AIRPORT IMPROVEMENTS (ED 17)	700,000					20
21	GULKANA AIRPORT IMPROVEMENTS PHASE II (ED 17)	670,000					21
22	TOK AIRPORT IMPROVEMENTS (ED 17)	400,000					22
23	NULATO AIRPORT IMPROVEMENTS (ED 24)	150,000					23

1	DEPARTMENT OF TRANSPORTATION/PUBLIC FACILITIES (CONT.)				1
2			APPROPRIATION	APPROPRIATION FUND SOURCES	2
3		ALLOCATIONS	ITEMS	GENERAL FUND	OTHER FUNDS
4	RUBY AIRPORT IMPROVEMENTS (ED 24)	850,000			
5	POINT HOPE RESURFACING (ED 22)	1,700,000			
6	NORTHERN REGION AIRPORT SNOW REMOVAL EQUIPMENT (ED 99)	1,951,000			
7	BARROW ARFF BUILDING (ED 22)	1,600,000			
8	BIRCH CREEK AIRPORT IMPROVEMENTS (ED 24)	1,600,000			
9	CHALKYSIK AIRPORT IMPROVEMENTS (ED 24)	1,500,000			
10	CIRCLE CITY AIRPORT IMPROVEMENTS (ED 19-21)	1,300,000			
11	CHANDALAR LAKE AIRPORT IMPROVEMENTS (ED 24)	800,000			
12	KOBUK SNOW REMOVAL EQUIPMENT/BUILDING UPGRADE (ED 22)	725,000			
13	VALDEZ SAND STORAGE BUILDING (ED 6)	400,000			
14	GOLOVIN AIRPORT IMPROVEMENTS (ED 23)	1,900,000			
15	NORTHERN REGION FACILITIES		200,000	200,000	
16	NORTHERN REGION BARRIER FREE PROGRAM (ED 99)	200,000			
17	NORTHERN REGION DEFERRED MAINTENANCE		3,225,000	3,225,000	
18	FUNDS FOR THE COPPER RIVER HIGHWAY MAY ONLY BE SPENT FOR				
19	THE MITIGATION OF ANY DAMAGE OR TO PREVENT FUTURE				
20	POTENTIAL DAMAGE TO STREAMS, RIVERS AND WETLANDS SO				
21	DIRECTED BY A COURT OR AGREED TO BY ALL APPROPRIATE				
22	STATE AND FEDERAL AGENCIES.				
23	IT IS THE INTENT OF THE LEGISLATURE THAT THE DEPARTMENT				
24	OF TRANSPORTATION AND PUBLIC FACILITIES PROVIDE A SIX				
25	MONTH STATUS REPORT, BY REGION, TO THE LEGISLATIVE				

1	DEPARTMENT OF TRANSPORTATION/PUBLIC FACILITIES (CONT.)				1
2			APPROPRIATION	APPROPRIATION FUND SOURCES	2
3		ALLOCATIONS	ITEMS	GENERAL FUND	OTHER FUNDS
4	BUDGET AND AUDIT COMMITTEE DETAILING EXPENDITURES FROM				
5	THIS APPROPRIATION.				
6	NORTHERN REGION AIRPORTS DEFERRED MAINTENANCE (ED 99)	750,000			
7	INTERIOR DISTRICT DEFERRED MAINTENANCE (ED 99)	1,225,000			
8	SOUTHCENTRAL DISTRICT DEFERRED MAINTENANCE (ED 99)	750,000			
9	WESTERN DISTRICT DEFERRED MAINTENANCE (ED 99)	500,000			
10	SHISHMAREF EROSION CONTROL (ED 23)		90,000	90,000	
11	SOUTHEAST REGION FEDERAL HIGHWAY PROGRAM		20,070,000		20,070,000
12	ZIMOVIA HIGHWAY, BERGER STREET TO MILL RECONSTRUCTION (ED 1)	4,310,000			
13	NORTH DOUGLAS HIGHWAY, KOWEE CREEK TO EAGLECREST ROAD IMPROVEMENTS (ED 4)	3,220,000			
14	HAINES HIGHWAY, MILEPOST 24 TO BORDER RECONSTRUCTION (ED 2)	1,700,000			
15	GLACIER HIGHWAY, BROTHERHOOD BRIDGE TO ENGINEER'S CUT-OFF TURN LANES (ED 4)	1,700,000			
16	KETCHIKAN VIADUCTS REPLACEMENT PRELIMINARY ENGINEERING (ED 1)	2,500,000			
17	EGAN EXPRESSWAY SAFETY IMPROVEMENTS (ED 4)	1,200,000			
18	JUNEAU ACCESS ROUTE FEASIBILITY STUDY (ED 4)	200,000			
19	JUNEAU AREAWIDE GUARDRAIL IMPROVEMENTS (ED 4)	660,000			
20	MITKOF HIGHWAY, SCOW BAY TO PAPKE'S LANDING CONSTRUCTION SUPPLEMENTAL (ED 1)	600,000			
21	GLACIER HIGHWAY, SALMON CREEK TO VANDERBILT IMPROVEMENTS (ED 4)	530,000			

1	DEPARTMENT OF TRANSPORTATION/PUBLIC FACILITIES (CONT.)		1
2		ALLOCATIONS	2
3		APPROPRIATION	3
4		ITEMS	4
5		GENERAL FUND	5
6		OTHER FUNDS	6
4	MITKOF HIGHWAY, PAPKE'S LANDING TO CRYSTAL LAKE OVERLAY SUPPLEMENTAL (ED 1)	450,000	4
5	HAINES HIGHWAY, FERRY TERMINAL TO MILEPOST 24 PRELIMINARY ENGINEERING (ED 2)	400,000	5
6	HIGHWAY SAFETY IMPROVEMENT PROGRAM (ED 99)	400,000	6
7	DOUGLAS HIGHWAY, CORDOVA STREET TO BRIDGE IMPROVEMENTS SUPPLEMENTAL (ED 4)	375,000	7
8	DEERMOUNT STREET WIDENING PRELIMINARY ENGINEERING (ED 1)	285,000	8
9	GLACIER HIGHWAY, LOOP ROAD TO EGAN DRIVE PRELIMINARY ENGINEERING (ED 4)	280,000	9
10	KAKE ROAD, GUNNUK CREEK TO BOAT HARBOR PAVING SUPPLEMENTAL (ED 2)	270,000	10
11	NORTH TONGASS HIGHWAY, WARD COVE TO WHIPPLE CREEK PRELIMINARY ENGINEERING (ED 1)	200,000	11
12	SOUTH TONGASS HIGHWAY, SOUTH CITY LIMITS TO HERRING BAY PRELIMINARY ENGINEERING (ED 1)	200,000	12
13	GLACIER HIGHWAY, HIGHLAND DRIVE TO EGAN EXPRESSWAY IMPROVEMENTS (ED 4)	175,000	13
14	NORTH DOUGLAS HIGHWAY PAVEMENT OVERLAY SUPPLEMENTAL (ED 4)	175,000	14
15	GLACIER HIGHWAY, SHRINE TO ECHO COVE PAVING PRELIMINARY ENGINEERING (ED 4)	100,000	15
16	SOUTHEAST REGION TRAFFIC SIGNAL SYSTEMS UPGRADE AND PRELIMINARY ENGINEERING (ED 99)	40,000	16
17	JUNEAU-DOUGLAS AND LAWSON CREEK BRIDGES JOINT REPLACEMENTS (ED 4)	100,000	17
18	SOUTHEAST REGION FEDERAL AVIATION PROGRAM	3,050,000	3,050,000 18

1 DEPARTMENT OF TRANSPORTATION/PUBLIC FACILITIES (CONT.)		1
2	ALLOCATIONS	2
3	APPROPRIATION	3
4	ITEMS	4
5	GENERAL FUND	5
6	OTHER FUNDS	6
7 KETCHIKAN APRON/TAXIWAY IMPROVEMENTS PHASE II (ED 1)	1,500,000	7
8 SITKA AIRPORT SNOW REMOVAL EQUIPMENT (ED 3)	350,000	8
9 YAKUTAT AIRPORT SNOW REMOVAL EQUIPMENT (ED 2)	350,000	9
10 COFFMAN COVE SEAPLANE FLOAT (ED 2)	200,000	10
11 POINT BAKER SEAPLANE FLOAT (ED 2)	200,000	11
12 SITKA AIRPORT MASTER PLAN (ED 3)	200,000	12
13 GUSTAVUS AIRPORT MASTER PLAN UPDATE (ED 2)	150,000	13
14 WRANGELL AIRPORT SNOW REMOVAL EQUIPMENT (ED 1)	100,000	14
15 SOUTHEAST REGION FACILITIES		15
16 JUNEAU PUBLIC SAFETY BUILDING RESTROOM MODIFICATION (ED 4)	65,000	16
17 SOUTHEAST REGION DEFERRED MAINTENANCE (ED 99)	910,000	17
18 IT IS THE INTENT OF THE LEGISLATURE THAT THE DEPARTMENT		18
19 OF TRANSPORTATION AND PUBLIC FACILITIES PROVIDE A SIX		19
20 MONTH STATUS REPORT, BY REGION, TO THE LEGISLATIVE		20
21 BUDGET AND AUDIT COMMITTEE DETAILING EXPENDITURES FROM		21
22 THIS APPROPRIATION.		22
23 ALASKA INTERNATIONAL AIRPORT SYSTEM	1,755,000	23
24 ALASKA INTERNATIONAL AIRPORT SYSTEM ADVANCED PROJECT DESIGN (ED 99)	1,005,000	24
25 ALASKA INTERNATIONAL AIRPORT SYSTEM ENVIRONMENTAL ASSESSMENT AND CLEANUP (ED 99)	750,000	25

1 DEPARTMENT OF TRANSPORTATION/PUBLIC FACILITIES (CONT.)					1
					2
					3
					4
					5
					6
					7
					8
					9
					10
					11
					12
					13
					14
					15
					16
					17
					18
			ALLOCATIONS	APPROPRIATION	APPROPRIATION FUND SOURCES
				ITEMS	GENERAL FUND OTHER FUNDS
4	ANCHORAGE INTERNATIONAL AIRPORT SYSTEM			7,540,000	7,540,000
5	ANCHORAGE INTERNATIONAL AIRPORT, TAXIWAY "K" SAFETY AREA WIDENING (ED 7-15)		2,890,000		
6	ANCHORAGE INTERNATIONAL AIRPORT, TERMINAL AUTO RAMP DECK REPAIR (ED 7-15)		1,100,000		
7	ANCHORAGE INTERNATIONAL AIRPORT, TERMINAL REHABILITATION (ED 7-15)		1,000,000		
8	ANCHORAGE INTERNATIONAL AIRPORT, ANNUAL IMPROVEMENTS (ED 7-15)		650,000		
9	ANCHORAGE INTERNATIONAL AIRPORT, FAA SIGN SYSTEM COMPLIANCE (ED 7-15)		600,000		
10	ANCHORAGE INTERNATIONAL AIRPORT, CONVEYOR SYSTEM RENOVATION/UPGRADE (ED 7-15)		500,000		
11	ANCHORAGE INTERNATIONAL AIRPORT, MASTER PLAN STUDY UPDATE (ED 7-15)		500,000		
12	ANCHORAGE INTERNATIONAL AIRPORT, TAXIWAY "M" PAVEMENT OVERLAY (ED 7-15)		300,000		
13	FAIRBANKS INTERNATIONAL AIRPORT			1,690,800	1,690,800
14	FAIRBANKS INTERNATIONAL AIRPORT, ANNUAL IMPROVEMENTS (ED 19-21)		300,000		
15	FAIRBANKS INTERNATIONAL AIRPORT, FAA SIGN SYSTEM COMPLIANCE (ED 19-21)		300,000		
16	FAIRBANKS INTERNATIONAL AIRPORT, ARFF DRAINAGE CONSTRUCTION (ED 19-21)		275,000		
17	FAIRBANKS INTERNATIONAL AIRPORT, MAINTENANCE EQUIPMENT (ED 19-21)		272,000		
18	FAIRBANKS INTERNATIONAL AIRPORT, DRAINAGE STUDY (ED 19-21)		65,000		

1	DEPARTMENT OF TRANSPORTATION/PUBLIC FACILITIES (CONT.)				1
2			APPROPRIATION	APPROPRIATION FUND SOURCES	2
3		ALLOCATIONS	ITEMS	GENERAL FUND	OTHER FUNDS
3					3
4	FAIRBANKS INTERNATIONAL AIRPORT WEST INDUSTRIAL ROAD UTILITIES, PHASE I (ED 19-21)	478,800			4
5	MARINE HIGHWAY SYSTEM FEDERAL PROGRAM		25,867,000		25,867,000
6	MARINE HIGHWAY SYSTEM PRELIMINARY ENGINEERING (ED 99)	2,550,000			6
7	COLUMBIA MODERNIZATION (ED 99)	5,322,600			7
8	TUSTUMENA REPOWER (ED 99)	4,098,400			8
9	SHIPBOARD WASTE HANDLING SYSTEM (ED 99)	3,548,400			9
10	AUKE BAY STAGING AREA EXPANSION (ED 4)	2,297,600			10
11	AURORA AND LECONTE HANDICAP ACCESS (ED 99)	1,330,600			11
12	KAKE MOORING IMPROVEMENTS (ED 2)	1,197,600			12
13	AUKE BAY EASTERN PONTOON UPGRADE (ED 4)	909,300			13
14	SITKA UPLANDS IMPROVEMENTS (ED 3)	789,500			14
15	HAINES UPLAND IMPROVEMENTS (ED 2)	470,300			15
16	COLUMBIA AUXILLIARY REPOWER (ED 99)	500,000			16
17	WRANGELL FENDERING AND MOORING (ED 1)	443,500			17
18	AURORA LIFE RAFT SLIDE AND RESCUE BOAT (ED 99)	372,600			18
19	LECONTE LIFE RAFT SLIDE AND RESCUE BOAT (ED 99)	372,600			19
20	SKAGWAY SLOPE STABILIZATION (ED 2)	200,000			20
21	KETCHIKAN TERMINAL BUILDING REPLACEMENT (ED 1)	1,464,000			21
22	MARINE HIGHWAY SYSTEM STATE PROGRAM				22
23	NEW VESSEL DESIGN AND CONSTRUCTION (ED 99)		8,100,000		8,100,000

1	DEPARTMENT OF TRANSPORTATION/PUBLIC FACILITIES (CONT.)				1		
2			ALLOCATIONS	APPROPRIATION	APPROPRIATION FUND SOURCES	2	
3				ITEMS	GENERAL FUND	OTHER FUNDS	3
4	MARINE HIGHWAY SYSTEM ADMINISTRATION BUILDING CONSTRUCTION (ED 99)			1,500,000		1,500,000	4
5	ALASKA MARINE HIGHWAY SYSTEM IMPROVEMENTS AND OVERHAUL (ED 99)			4,500,000	4,500,000		5
6	*****			*****			6
7	***** DEPARTMENT OF ENVIRONMENTAL CONSERVATION			*****			7
8	*****			*****			8
9	NATURAL RESOURCE MANAGEMENT						9
10	FIFTY PERCENT MUNICIPAL MATCHING GRANTS PROGRAM			15,233,500	15,233,500		10
11	BRISTOL BAY BOROUGH - LEADER CREEK SEWER (ED 26)	1,654,900					11
12	SEWARD - RESTORE LOWELL POINT LAGOON (ED 6)	924,000					12
13	BRISTOL BAY BOROUGH - KING SALMON SEWER PHASE II (ED 26)	1,702,300					13
14	KAKE - GUNNUCK CREEK SEWER PHASE II (ED 2)	501,000					14
15	WASILLA - SEWAGE TREATMENT UPGRADE (ED 16)	500,000					15
16	KLAWOCK - SEWAGE TREATMENT UPGRADE (ED 2)	1,600,000					16
17	NORTH SLOPE BOROUGH - WAINWRIGHT WATER/SEWER TANKS (ED 22)	500,000					17
18	HAINES - TREATMENT PLANT/SEWER UPGRADE (ED 2)	351,300					18
19	ANCHORAGE WATER/WASTEWATER/SOLID WASTE FACILITIES (ED 7-15)	3,100,000					19
20	KENAI WATER AND SEWER PROJECTS (ED 5)	900,000					20
21	FAIRBANKS WATER AND SEWER PROJECTS (ED 19-21)	1,000,000					21
22	NOME - ICY VIEW SEWER AND WATER (ED 23)	1,500,000					22

1	DEPARTMENT OF ENVIRONMENTAL CONSERVATION (CONT.)				1
2			APPROPRIATION	APPROPRIATION	FUND SOURCES
3		ALLOCATIONS	ITEMS	GENERAL FUND	OTHER FUNDS
4	JUNEAU - BACK LOOP SEWERAGE - PHASE I (ED 4)	1,000,000			
5	VILLAGE SAFE WATER		21,627,600	21,627,600	
6	TALKEETNA - EASTSIDE WATER/SEWER (ED 16)	1,200,000			
7	THORNE BAY - SEWERAGE SYSTEM AND SOLID WASTE (ED 2)	1,250,000			
8	KOTZEBUE - SEWAGE COLLECTION SYSTEM (ED 22)	1,293,000			
9	AKIAK - SEWAGE LAGOON/BACKWASH DISPOSAL (ED 25)	500,000			
10	ALAKANUK - WATER/SEWER MASTER PLAN AND DESIGN (ED 23)	500,000			
11	NIKOLAI - WATER/SEWER IMPROVEMENTS (ED 24)	80,000			
12	MOUNTAIN POINT - WATER/SEWER PHASE III (ED 1)	1,800,900			
13	MOUNTAIN VILLAGE - SOLID WASTE PROJECT (ED 24)	61,700			
14	BETHEL - KILBUCK WASTEWATER PUMPING (ED 25)	125,000			
15	BETHEL - CITY SUBDIVISION WASTEWATER (ED 25)	125,000			
16	BETHEL - BETHEL HEIGHTS SEWER (ED 25)	800,000			
17	UNALAKLEET - AIRPORT UTILITIES PROJECT (ED 23)	1,366,000			
18	EMMONAK - WATER AND SEWER PROJECT (ED 23)	1,500,000			
19	MEKORYUK - SEWAGE HAUL PROJECT (ED 25)	170,000			
20	ELIM-SEWAGE OUTFALL LINE EXTENSION (ED 23)	431,000			
21	ANCHOR POINT - COMMUNITY WATER SYSTEM (ED 5)	289,000			
22	CHEVAK PHASE I (ED 23)	551,000			
23	KIANA - WATER/SEWER INSTALLATION AND SEWAGE (ED 22)	230,000			
24	PORT LIONS WATER AND SEWER PROJECT (ED 27)	250,000			

1	DEPARTMENT OF ENVIRONMENTAL CONSERVATION (CONT.)				1
2			APPROPRIATION	APPROPRIATION	FUND SOURCES
3		ALLOCATIONS	ITEMS	GENERAL FUND	OTHER FUNDS
4	SHAKTOOLIK MAINTENANCE EQUIPMENT (ED 23)	210,000			
5	BETHEL "MAIN" WASTEWATER PUMP STATION (ED 25)	140,000			
6	BETHEL "CITY SUBDIVISION" PIPED WATER (ED 25)	200,000			
7	KONGIGANAK WATER AND SEWER IMPROVEMENTS (ED 25)	500,000			
8	TOKSOOK BAY WATER SYSTEM IMPROVEMENT (ED 25)	150,000			
9	KALTAG WATER AND SEWER EXTENSION PHASE I (ED 24)	342,400			
10	KOTZEBUE SOLID WASTE STUDY (ED 22)	150,000			
11	MCGRATH WASTE DISPOSAL IMPROVEMENTS (ED 24)	600,000			
12	NOORVIK WATER/SEWER SYSTEM UPGRADE (ED 22)	1,150,000			
13	NULATO WATER AND SEWER SYSTEM PHASE III (ED 24)	2,665,000			
14	GLENNALLEN SEWER SYSTEM EXPANSION (ED 17)	800,000			
15	KIPNUK WASHETERIA (ED 25)	800,000			
16	KOYUK SOLID WASTE DISPOSAL FACILITY (ED 23)	400,000			
17	NORTHWEST ARCTIC BOROUGH - LOCAL UTILITY MATCHING PROGRAM (ED 22)	400,000			
18	CHIGNIK SEWER UPGRADE/SOLID WASTE (ED 27)	180,000			
19	STATEWIDE PROJECT ADMINISTRATIVE SUPPORT (ED 99)	338,500			
20	COMMUNITY HAZARDOUS WASTE STORAGE AND TRANSFER FACILITY (ED 99)		350,000	350,000	
21	ANALYTICAL EQUIPMENT AND ANALYSES (ED 99)		218,000	218,000	

1		ALLOCATIONS	APPROPRIATION ITEMS	APPROPRIATION FUND SOURCES	1	
2				GENERAL FUND	OTHER FUNDS	2
3	*****		*****			3
4	***** DEPARTMENT OF COMMUNITY & REGIONAL AFFAIRS		*****			4
5	*****		*****			5
6	PUBLIC PROTECTION					6
7	CONTAMINATED SITE CLEANUP - CHATHAM STRAIT FISH COMPANY, NEW CHENEBA (ED 6)		30,000		30,000	7
8	DEVELOPMENT					8
9	SUPPLEMENTAL HOUSING DEVELOPMENT FUND (ED 99)		8,200,000		8,200,000	9
10	IT IS THE INTENT OF THE LEGISLATURE THAT FUNDING FOR					10
11	SUPPLEMENTAL HOUSING DEVELOPMENT COME FROM THE ALASKA					11
12	HOUSING FINANCE CORPORATION.					12
13	HOUSING AND URBAN DEVELOPMENT FEDERAL HOME GRANT PROGRAM (ED 99)		3,000,000		3,000,000	13
14	COMMUNITY DEVELOPMENT BLOCK GRANTS (ED 99)		3,000,000		3,000,000	14
15	WEATHERIZATION AND ENERGY CONSERVATION (ED 99)		3,600,000		3,600,000	15
16	IT IS THE INTENT OF THE LEGISLATURE THAT \$1,800,000 FOR					16
17	WEATHERIZATION AND ENERGY CONSERVATION COME FROM THE					17
18	ALASKA HOUSING FINANCE CORPORATION.					18

1	2	3	4	5	6	APPROPRIATION		APPROPRIATION FUND SOURCES		1
						ALLOCATIONS	ITEMS	GENERAL FUND	OTHER FUNDS	
3		*****		*****						3
4		***** DEPARTMENT OF CORRECTIONS		*****						4
5		*****		*****						5
6		ADMINISTRATION OF JUSTICE								6
7		DEFERRED MAINTENANCE, REPAIR, REPLACEMENT, REMODELING AND EQUIPMENT (ED 99)				1,250,000		1,250,000		7
8		MASTER PLAN IMPLEMENTATION AND WOMEN'S HOUSING/ PROGRAMS (ED 99)				1,350,000		1,350,000		8
9		*****		*****						9
10		***** UNIVERSITY OF ALASKA		*****						10
11		*****		*****						11
12		UNIVERSITY OF ALASKA								12
13		UNIVERSITY OF ALASKA - FIRE TRAINING CENTER REPAIR AND EQUIPMENT ACQUISITION (ED 99)				150,000			150,000	13
14		UNIVERSITY OF ALASKA, FAIRBANKS								14
15		UNIVERSITY OF ALASKA, FAIRBANKS - REPAIR BUILDINGS PER CODE COMPLIANCE ORDER (ED 19-21)				5,000,000		5,000,000		15
16		UNIVERSITY OF ALASKA, FAIRBANKS - DEFERRED MAINTENANCE (ED 99)				2,000,000		2,000,000		16
17		UNIVERSITY OF ALASKA, FAIRBANKS - CONSTRUCT PHASE V OF BUTROVICH BUILDING (ED 19-21)				5,000,000		5,000,000		17
18		UNIVERSITY OF ALASKA, ANCHORAGE								18
19		UNIVERSITY OF ALASKA, ANCHORAGE - SOLDOTNA FIRE TRAINING CONTAMINATED SITE CLEANUP (ED 5)				320,000			320,000	19
20		UNIVERSITY OF ALASKA, ANCHORAGE - TUDOR LAND ACQUISITION (ED 7-15)				1,622,300		1,622,300		20

1	UNIVERSITY OF ALASKA (CONT.)				1
2			APPROPRIATION	APPROPRIATION	FUND SOURCES
3		ALLOCATIONS	ITEMS	GENERAL FUND	OTHER FUNDS
4	UNIVERSITY OF ALASKA, ANCHORAGE - CONSTRUCT COMPLETION OF CLASS/LAB BUILDING (ED 7-15)		2,800,000	2,800,000	4
5	UNIVERSITY OF ALASKA, MATANUSKA-SUSITNA COLLEGE CLASSROOM ADDITION AND ALTERATION (ED 16)		1,500,000	1,500,000	5
6	UNIVERSITY OF ALASKA, SOUTHEAST				6
7	UNIVERSITY OF ALASKA, SOUTHEAST - CLASSROOM WING ADDITION EGAN LIBRARY - PHASE I (ED 4)		2,000,000	2,000,000	7
8		*****	*****		8
9		***** ALASKA COURT SYSTEM *****			9
10		*****	*****		10
11	ADMINISTRATION OF JUSTICE				11
12	ANCHORAGE COURTHOUSE EXPANSION - PHASE I CONSTRUCTION (ED 7-15)		19,750,000	19,750,000	12
13	COURT TECHNOLOGY ENHANCEMENTS (ED 99)		437,500	437,500	13
14		*****	*****		14
15		***** GRANTS TO MUNICIPALITIES (AS 37.05.315) *****			15
16		*****	*****		16
17	GENERAL GOVERNMENT				17
18	ED 1 KETCHIKAN - WRANGELL - PETERSBURG				18
19	CITY OF KETCHIKAN HOSPITAL CONSTRUCTION AND RENOVATION (ED 1)		6,000,000	6,000,000	19
20	ED 26 BRISTOL BAY - ALEUTIAN ISLANDS				20
21	CITY OF UNALASKA - ILIULIUK MEDICAL CENTER CONSTRUCTION (ED 26)		1,000,000	1,000,000	21

1	GRANTS TO MUNICIPALITIES (AS 37.05.315) (CONT.)				1
2			APPROPRIATION	APPROPRIATION FUND SOURCES	2
3		ALLOCATIONS	ITEMS	GENERAL FUND	OTHER FUNDS
4	ED 27 KODIAK - EAST ALASKA PENINSULA				4
5	KODIAK ISLAND BOROUGH - HOSPITAL CONSTRUCTION (ED 27)		3,000,000	3,000,000	5
6	* SEC. 4 THE FOLLOWING SETS OUT THE FUNDING BY AGENCY				6
7	FOR THE APPROPRIATIONS MADE IN SECTION 3 OF THIS ACT.				7
8	CAPITAL PROJECTS				8
9	FEDERAL RECEIPTS	375,732,600			9
10	GENERAL FUND MATCH	33,822,000			10
11	GENERAL FUND	169,884,800			11
12	GENERAL FUND/PROGRAM RECEIPTS	255,000			12
13	GENERAL FUND/MENTAL HEALTH TRUST	7,227,700			13
14	STATE CORPORATION RECEIPTS	10,000,000			14
15	HIGHWAY WORKING CAPITAL FUND	12,300,000			15
16	INTERNATIONAL AIRPORT REVENUE FUND	6,529,800			16
17	PUBLIC EMPLOYEES RETIREMENT FUND	375,000			17
18	TEACHERS RETIREMENT SYSTEM FUND	337,500			18
19	JUDICIAL RETIREMENT SYSTEM	37,500			19
20	UNIVERSITY RESTRICTED RECEIPTS	150,000			20
21	OIL/HAZARDOUS RESPONSE FUND	2,193,000			21
22	CAPITAL IMPROVEMENT PROJECT RECEIPTS	200,000			22
23	MARINE HIGHWAY SYSTEM FUND	1,500,000			23
24	VESSEL REPLACEMENT FUND	8,100,000			24
25	*** TOTAL FUNDING ***	628,644,900			25

1 CAPITAL PROJECTS (CONT.)
26 ***** TOTAL BUDGET *****

\$628,644,900

1
1

FISCAL YEAR 1993 BUDGET SUMMARY BY FUNDING SOURCE

FUNDING SOURCE	OPERATING BUDGET	LOANS BUDGET	NEW LEGISLATION BUDGET	CAPITAL BUDGET	TOTAL BUDGET
FEDERAL RECEIPTS				375,732,600	375,732,600
GENERAL FUND MATCH				33,822,000	33,822,000
GENERAL FUND				169,884,800	169,884,800
GENERAL FUND/PROGRAM RECEIPTS				255,000	255,000
GENERAL FUND/MENTAL HEALTH TRUST				7,227,700	7,227,700
STATE CORPORATION RECEIPTS				10,000,000	10,000,000
HIGHWAY WORKING CAPITAL FUND				12,300,000	12,300,000
INTERNATIONAL AIRPORT REVENUE FUND				6,529,800	6,529,800
PUBLIC EMPLOYEES RETIREMENT FUND				375,000	375,000
TEACHERS RETIREMENT SYSTEM FUND				337,500	337,500
JUDICIAL RETIREMENT SYSTEM				37,500	37,500
UNIVERSITY RESTRICTED RECEIPTS				150,000	150,000
OIL/HAZARDOUS RESPONSE FUND				2,193,000	2,193,000
CAPITAL IMPROVEMENT PROJECT RECEIPTS				200,000	200,000
MARINE HIGHWAY SYSTEM FUND				1,500,000	1,500,000
VESSEL REPLACEMENT FUND				8,100,000	8,100,000
**** TOTALS ****				\$628,644,900	\$628,644,900

111

1 * SEC. 5 THE FOLLOWING APPROPRIATION ITEMS ARE FOR 1
 2 CAPITAL PROJECTS AND GRANTS FROM THE GENERAL FUND OR 2
 3 OTHER FUNDS AS SET OUT IN SECTION 6 OF THIS ACT BY 3
 4 FUNDING SOURCE TO THE AGENCIES NAMED AND FOR THE 4
 5 PURPOSES EXPRESSED. 5

6
 7
 8 IT IS THE INTENT OF THE LEGISLATURE THAT MUNICIPAL AND 8
 9 LOCAL GOVERNMENTS WILL DEMONSTRATE LOCAL MATCH OR EFFORT 9
 10 FOR A PORTION OF THE FOLLOWING PROJECTS. THE OFFICE OF 10
 11 MANAGEMENT AND BUDGET SHALL DEVELOP MATCH GRANT 11
 12 CRITERIA. THIS CRITERIA SHALL BE SUBMITTED TO THE 12
 13 LEGISLATIVE BUDGET AND AUDIT COMMITTEE FOR REVIEW. 13

14 * * * * * 14
 15 * * * * * DEPARTMENT OF ADMINISTRATION * * * * * 15
 16 * * * * * 16

	ALLOCATIONS	APPROPRIATION ITEMS	APPROPRIATION FUND SOURCES GENERAL FUND	OTHER FUNDS	
17	SOCIAL SERVICES				17
18	GRANTS TO NAMED RECIPIENTS: (AS 37.05.316)				18
19	SALVATION ARMY OLDER ALASKANS PROGRAM - VAN PURCHASE (ED 7-15)	44,600	44,600		19
20	GENERAL GOVERNMENT				20
21	ALASKA PUBLIC BROADCASTING COMMISSION				21
22	KRBD FM - FACILITY UPGRADE (ED 1)	10,000	10,000		22
23	KSTK FM - EQUIPMENT PURCHASE (ED 1)	10,000	10,000		23
24	KFSK FM - EQUIPMENT PURCHASE (ED 1)	10,000	10,000		24
25	SITKA - KCAW EQUIPMENT REPLACEMENT (ED 3)	70,000	70,000		25

1	DEPARTMENT OF ADMINISTRATION (CONT.)				1
2		ALLOCATIONS	APPROPRIATION ITEMS	APPROPRIATION FUND SOURCES	2
3				GENERAL FUND	OTHER FUNDS
3					3
4	ELFIN COVE - KCAW TRANSLATOR (ED 3)		9,500	9,500	4
5	KTOO RADIO AND TV TRANSMITTER SITE - PHASE I (ED 4)		35,000	35,000	5
6	PUFFIN RADIO - EQUIPMENT PURCHASE (ED 6)		7,000	7,000	6
7	CITY OF VALDEZ - KCHU/PURCHASE - COMMUNICATION FACILITY UPGRADE (ED 6)		100,000	100,000	7
8	KENAI PENINSULA BOROUGH - TELEVISION SIGNAL UPGRADE (ED 6)		11,000	11,000	8
9	ALASKA PUBLIC RADIO NETWORK - COSTS FOR STARTING ON-AIR FUNDRAISING GAME (ED 11)		50,000	50,000	9
10	ALASKA PUBLIC RADIO NETWORK - ROOF REPAIR (ED 12)		10,800	10,800	10
11	ALASKA PUBLIC RADIO NETWORK - ROOF REPAIR (ED 13)		10,800	10,800	11
12	ALASKA PUBLIC RADIO NETWORK (APRN) - EQUIPMENT (ED 7-15)		20,500	20,500	12
13	ALASKA INFORMATION RADIO READING AND EDUCATION SERVICE - EQUIPMENT (ED 7-15)		4,400	4,400	13
14	KAKM - VIDEO/AUDIO EQUIPMENT (ED 7-15)		22,000	22,000	14
15	KSKA - FACILITY CONSTRUCTION (ED 7-15)		100,000	100,000	15
16	TALKEETNA RADIO REPEATER STATION CONSTRUCTION WITH LOCAL ACCESS (ED 16)		24,000	24,000	16
17	KOTZ BUILDING IMPROVEMENTS/BACK-UP POWER (ED 22)		60,000	60,000	17
18	KBRW TRANSMITTER UPGRADE (ED 22)		60,000	60,000	18
19	KCUK EQUIPMENT AND INSTALLATION (ED 23)		83,700	83,700	19
20	KDLB RADIO - DILLINGHAM - BUILDING FACILITY DESIGN AND CONSTRUCTION (ED 26)		30,000	30,000	20
21	KMXT BUILDING CONSTRUCTION/EQUIPMENT PURCHASE (ED 27)		25,000	25,000	21

1		ALLOCATIONS	APPROPRIATION ITEMS	APPROPRIATION GENERAL FUND	APPROPRIATION OTHER FUNDS	FUND SOURCES
2						1
3	*****		*****			2
4	***** DEPARTMENT OF EDUCATION		*****			3
5	*****		*****			4
6	EDUCATION					5
7	GRANTS TO NAMED RECIPIENTS: (AS 37.05.316)					6
8	SOLDOTNA HISTORICAL SOCIETY AND MUSEUM, INCORPORATED - PHASE II EXHIBIT ENCASEMENT RENOVATIONS (ED 5)		45,000	45,000		7
9	WHITTIER - CHUGACH SCHOOL DISTRICT VOCATIONAL EDUCATION FACILITY CONSTRUCTION (ED 6)		25,000	25,000		8
10	RAILBELT SCHOOL DISTRICT CANTWELL SCHOOL GYM (ED 17)		300,500	300,500		9
11	NENANA COMMUNITY SCHOOLS - RESTROOMS - RENOVATION AND CODE UPGRADE (ED 17)		36,000	36,000		10
12	DELTA/GREELY SCHOOL DISTRICT - TELEPHONE SYSTEM (ED 17)		30,000	30,000		11
13	DELTA/GREELY SCHOOL DISTRICT - DESKS (ED 17)		25,000	25,000		12
14	ALASKA GATEWAY SCHOOL DISTRICT - ALCAN/BORDER SCHOOL (ED 17)		120,000	120,000		13
15	COPPER RIVER SCHOOL DISTRICT - SLANA SCHOOL (ED 17)		200,000	200,000		14
16	ALEUTIAN REGION SCHOOL DISTRICT - NIKOLSKI - SCHOOL WINDOW REPLACEMENT (ED 26)		20,000	20,000		15

		ALLOCATIONS	APPROPRIATION ITEMS	APPROPRIATION GENERAL FUND	FUND SOURCES OTHER FUNDS	
1						1
2						2
3		*****	*****			3
4		***** DEPARTMENT OF HEALTH & SOCIAL SERVICES	*****			4
5		*****	*****			5
6	HEALTH					6
7	GRANTS TO NAMED RECIPIENTS: (AS 37.05.316)					7
8	GATEWAY HUMAN SERVICES ALCOHOL DIVISION - TRANSITIONAL LIVING CENTER (ED 1)		150,000	150,000		8
9	JUNEAU - GRUENING PARK HOUSING REPAIRS (ED 4)		50,000	50,000		9
10	JUNEAU - REACH INDIVIDUAL ASSISTED LIVING PROJECT (ED 4)		100,000	100,000		10
11	SOUTH PENINSULA MENTAL HEALTH ASSOCIATION, INCORPORATED - DEVELOPMENTALLY DELAYED BUILDING ACQUISITION (ED 5)		50,000	50,000		11
12	CENTRAL PENINSULA HOSPITAL - AUXILIARY POWER GENERATOR PURCHASE (ED 5)		100,000	100,000		12
13	SOUTH PENINSULA HOSPITAL - MATCHING GRANT - DIETARY DEPARTMENT RENOVATIONS (ED 5)		50,000	50,000		13
14	I CARE PATIENTS NETWORK - EQUIPMENT (ED 12)		2,500	2,500		14
15	I CARE PATIENTS NETWORK - EQUIPMENT (ED 13)		2,500	2,500		15
16	ALASKA YOUTH AND PARENT FOUNDATION FACILITY IMPROVEMENTS (ED 14)		10,000	10,000		16
17	DISABLED AMERICAN VETERANS EQUIPMENT/VAN (ED 14)		10,000	10,000		17
18	ALASKA AIDS ASSISTANCE ASSOCIATION - HOUSING REHABILITATION (ED 7-15)		75,000	75,000		18
19	ALASKA ASSOCIATION OF THE DEAF, INCORPORATION - CLOSED CAPTION PROGRAMMING (ED 7-15)		36,800	36,800		19
20	ALASKA CENTER FOR BLIND AND DEAF ADULTS - HANDICAPP ACCESSIBILITY (ED 7-15)		18,000	18,000		20

1	DEPARTMENT OF HEALTH & SOCIAL SERVICES (CONT.)				1
2			APPROPRIATION	APPROPRIATION	FUND SOURCES
3		ALLOCATIONS	ITEMS	GENERAL FUND	OTHER FUNDS
4	BEAN'S CAFE - VAN (ED 7-15)		22,600	22,600	4
5	CATHOLIC SOCIAL SERVICES - CLARE HOUSE FACILITY EXPANSION (ED 7-15)		120,000	120,000	5
6	HOPE COTTAGES - VEHICLES PURCHASE (ED 7-15)		250,000	250,000	6
7	I CARE PATIENTS NETWORK INCORPORATED - EQUIPMENT (ED 7-15)		50,000	50,000	7
8	LUTHERAN SOCIAL SERVICES - NATIVE OUTREACH MINISTRY - VAN (ED 7-15)		23,000	23,000	8
9	VALLEY FAMILY HEALTH SERVICES/OPERATIONS AND MAINTENANCE (ED 17)		25,000	25,000	9
10	HEALY SENIOR CENTER UPGRADE AND REFURBISH (ED 17)		10,000	10,000	10
11	WENANA SENIOR CENTER HEALTH CODE UPGRADE AND REFURBISH (ED 17)		8,000	8,000	11
12	CITY OF FAIRBANKS - HEALTH CENTER CONSTRUCTION INCLUDING INTEREST (ED 19-21)		3,000,000	3,000,000	12
13	GREATER FAIRBANKS COMMUNITY HOSPITAL FOUNDATION - DENALI CENTER CONSTRUCTION INCLUDING INTEREST (ED 19-21)		2,395,000	2,395,000	13
14	HANIILAQ ASSOCIATION - UPPER KODUK CULTURAL CAMP (ED 22)		260,000	260,000	14
15	YUKON-KUSKOKWIM HEALTH CORPORATION - ANIAK SUB-REGIONAL CLINIC (ED 24)		740,000	740,000	15
16	HUGHES VILLAGE COUNCIL - HUGHES HEALTH CLINIC PROJECT (ED 24)		85,000	85,000	16
17	GRANTS TO NAMED RECIPIENTS: (AS 37.05.316)				17
18	SOUTHEAST REGION EMERGENCY MEDICAL SERVICES - EQUIPMENT PURCHASE (ED 1)		94,500	94,500	18

1	DEPARTMENT OF HEALTH & SOCIAL SERVICES (CONT.)				1
2			APPROPRIATION	APPROPRIATION	FUND SOURCES
3		ALLOCATIONS	ITEMS	GENERAL FUND	OTHER FUNDS
4	SOUTHEAST REGION EMERGENCY MEDICAL SERVICES ELECTION DISTRICT 2 EQUIPMENT (ED 2)		30,000	30,000	4
5	SOUTHEAST REGION EMERGENCY MEDICAL SERVICES COUNCIL ED 3 EQUIPMENT (ED 3)		37,800	37,800	5
6	SOUTHEAST REGION EMERGENCY MEDICAL SERVICES COUNCIL EQUIPMENT (ED 4)		28,000	28,000	6
7	SAINT ANN'S NURSING HOME VENTILATION SYSTEM (ED 4)		140,000	140,000	7
8	SAINT VINCENT DE PAUL SOCIETY SHELTER (ED 4)		100,000	100,000	8
9	NINILCHIK VOLUNTEER FIRE DEPARTMENT - EMERGENCY FIRE EQUIPMENT PURCHASE/STATION UPGRADES (ED 5)		25,000	25,000	9
10	BEAR CREEK EMERGENCY MEDICAL SERVICES BUILDING ROOF REPAIR (ED 6)		20,000	20,000	10
11	COOPER LANDING EMERGENCY MEDICAL SERVICES AMBULANCE PURCHASE (ED 6)		40,000	40,000	11
12	SOUTHERN REGION EMERGENCY MEDICAL SERVICES AMBULANCE - HOUSING CONSTRUCTION (ED 6)		100,000	100,000	12
13	SOUTHERN REGION EMERGENCY MEDICAL SERVICES - FIRE DEPARTMENT CPR MANNEQUINS PURCHASE (ED 6)		3,800	3,800	13
14	SOUTHERN REGION EMERGENCY MEDICAL SERVICES - WHITTIER AMBULANCE PURCHASE (ED 6)		75,000	75,000	14
15	SOUTHERN REGION EMERGENCY MEDICAL SERVICES - WHITTIER FIELD EQUIPMENT (ED 6)		4,000	4,000	15
16	DENALI PARK - EMERGENCY MEDICAL SERVICES (ED 17)		1,300	1,300	16
17	TRI-VALLEY EMERGENCY MEDICAL SERVICES UPGRADE (ED 17)		20,000	20,000	17
18	COPPER RIVER EMERGENCY MEDICAL SERVICES EQUIPMENT (ED 17)		5,000	5,000	18

1	DEPARTMENT OF HEALTH & SOCIAL SERVICES (CONT.)				1
2		ALLOCATIONS	APPROPRIATION	APPROPRIATION	FUND SOURCES
3			ITEMS	GENERAL FUND	OTHER FUNDS
4	NORTHWAY EMERGENCY MEDICAL SERVICES EQUIPMENT (ED 17)		5,000	5,000	
5	EAGLE EMERGENCY MEDICAL SERVICES EQUIPMENT (ED 17)		5,000	5,000	
6	DELTA JUNCTION EMERGENCY MEDICAL SERVICES EQUIPMENT (ED 17)		5,000	5,000	
7	TOK EMERGENCY MEDICAL SERVICES EQUIPMENT (ED 17)		5,000	5,000	
8	INTERIOR REGION EMERGENCY MEDICAL SERVICES COUNCIL, INCORPORATED - CHENA HOT SPRINGS ROAD COMMUNICATIONS (ED 18)		67,000	67,000	
9	INTERIOR REGION EMERGENCY MEDICAL SERVICES COUNCIL, INCORPORATED - MISCELLANEOUS TRAINING EQUIPMENT (ED 18)		10,000	10,000	
10	MANIILAQ ASSOCIATION - EMERGENCY MEDICAL SERVICE EQUIPMENT (ED 22)		70,000	70,000	
11	MANIILAQ ASSOCIATION - SEARCH AND RESCUE (ED 22)		50,000	50,000	
12	NORTON SOUND HEALTH CORPORATION - EMERGENCY MEDICAL SERVICES EQUIPMENT (ED 25)		76,400	76,400	
13	INTERIOR REGION EMERGENCY MEDICAL SERVICES - NIKOLAI 911 SYSTEM UPGRADE (ED 24)		12,500	12,500	
14	EMERGENCY MEDICAL SERVICES - SOUTHERN REGION - TRAINING EQUIPMENT (ED 7-15)		15,600	15,600	

1		APPROPRIATION	APPROPRIATION FUND SOURCES	1
2		ALLOCATIONS	GENERAL FUND	OTHER FUNDS
3	*****	*****		
4	***** DEPARTMENT OF COMMERCE & ECONOMIC DEVELOPMENT	*****		
5	*****	*****		
6	DEVELOPMENT			6
7	ALASKA ENERGY AUTHORITY			7
8	ATMAUTLUAK TRADITIONAL COUNCIL - ELECTRICAL METERING SYSTEM (ED 25)	60,000	60,000	8
9	INNNEC - TAZIMINA HYDROELECTRIC PROJECT SITE SURVEY AND ROAD CONSTRUCTION (ED 26)	50,000	50,000	9
10	PORT ALSWORTH - ELECTRICAL UPGRADE SYSTEM (ED 26)	75,000	75,000	10
11	CITY OF PORT HEIDEN - ELECTRICAL SYSTEM UPGRADE (ED 26)	75,000	75,000	11
12	KOLIGANEK - ELECTRICAL UPGRADE (ED 26)	100,000	100,000	12
13	KOKHANOK - ELECTRICAL UPGRADE (ED 26)	100,000	100,000	13
14	IVANOF BAY ELECTRICAL SYSTEM UPGRADE (ED 27)	60,000	60,000	14
15	KARLUK ELECTRICAL SYSTEM UPGRADE (ED 27)	50,000	50,000	15
16	GRANTS TO NAMED RECIPIENTS: (AS 37.05.316)			16
17	ANCHORAGE ECONOMIC DEVELOPMENT CORPORATION - TOURISM DEVELOPMENT PROJECTS (ED 7-15)	250,000	250,000	17
18	LOWER KUSKOKWIM ECONOMIC DEVELOPMENT COUNCIL - MINK FESTIVAL (ED 25)	10,000	10,000	18

		ALLOCATIONS	APPROPRIATION ITEMS	APPROPRIATION GENERAL FUND	FUND SOURCES OTHER FUNDS	
1						1
2						2
3	*****		*****			3
4	***** DEPARTMENT OF NATURAL RESOURCES		*****			4
5	*****		*****			5
6	NATURAL RESOURCE MANAGEMENT					6
7	GLACIER/WINNER CREEK RESORT DEVELOPMENT (ED 7-15)		665,000	665,000		7
8	IT IS THE INTENT OF THE LEGISLATURE THAT THE					8
9	GLACIER/WINNER CREEK LANDS, WHEN SELECTED AND					9
10	TRANSFERRED, BE MANAGED UNDER A MASTER PLAN THAT IS					10
11	DESIGNED TO MAXIMIZE THE RESORT DEVELOPMENT POTENTIAL IN					11
12	THE AREA, IS SENSITIVE TO COMMUNITY INTERESTS, AND IS					12
13	COMPATIBLE WITH EXISTING AND PLANNED RESORT INVESTMENTS					13
14	ADJACENT TO THE SELECTED LAND.					14
15	FORESTRY					15
16	GLENNALLEN FORESTRY PROJECTS (ED 17)		50,000	50,000		16
17	TANANA VALLEY STATE FOREST FIREBREAK AND ACCESS ROADS (ED 17)		125,000	125,000		17
18	PARKS MANAGEMENT					18
19	KETCHIKAN AREA STATE PARKS IMPROVEMENT PROJECTS (ED 1)		335,000	335,000		19
20	CHILKAT BALD EAGLE PRESERVE INTERPRETIVE SIGNS (ED 2)		50,000	50,000		20
21	SITKA STATE PARK HALIBUT POINT RECREATION AREA BARRIER ROCK (ED 3)		30,000	30,000		21
22	ANCHOR POINT CAMPGROUND REHABILITATION (ED 5)		100,000	100,000		22

1	DEPARTMENT OF NATURAL RESOURCES (CONT.)				1
2		ALLOCATIONS	APPROPRIATION	APPROPRIATION	FUND SOURCES
3			ITEMS	GENERAL FUND	OTHER FUNDS
4	DEEP CREEK/NINILCHIK RECREATIONAL AREA IMPROVEMENTS MATCHING GRANT (ED 5)		150,000	150,000	4
5	EAGLE RIVER GREENBELT DEVELOPMENT (ED 7-15)		600,000	600,000	5
6	ALCAN PARK IMPROVEMENTS/UPGRADE (ED 17)		25,000	25,000	6
7	PARKS - COMMUNICATION EQUIPMENT (ED 19-21)		67,000	67,000	7
8	KODIAK STATE PARK IMPROVEMENTS (ED 27)		40,000	40,000	8
9	GRANTS TO NAMED RECIPIENTS: (AS 37.05.316)				9
10	SOUTHEAST ALASKA STATE FAIR BOOTH REBUILDING AND REPLACEMENT (ED 2)		15,000	15,000	10
11	ALASKA TRAILS COUNCIL (ED 4)		5,000	5,000	11
12	NINILCHIK FAIR ASSOCIATION - LAND ACQUISITION MATCHING GRANT (ED 5)		50,000	50,000	12
13	NORDIC SKI CLUB OF ANCHORAGE - TRAIL GROOMING EQUIPMENT (ED 11)		21,500	21,500	13
14	TRAILSIDE DISCOVERY - VANS (MATCHING GRANT) (ED 12)		5,000	5,000	14
15	TRAILSIDE DISCOVERY VANS (MATCHING GRANT) (ED 13)		5,000	5,000	15
16	ANCHORAGE SKI CLUB - ALPENLOW SKI AREA - LIGHTING (ED 7-15)		85,000	85,000	16
17	SALCHA FAIR ASSOCIATION - SALCHA FAIRGROUNDS IMPROVEMENTS (ED 18)		10,000	10,000	17

		ALLOCATIONS	APPROPRIATION ITEMS	APPROPRIATION GENERAL FUND	APPROPRIATION OTHER FUNDS	FUND SOURCES
1						1
2						2
3		*****	*****			3
4		***** DEPARTMENT OF FISH & GAME	*****			4
5		*****	*****			5
6	NATURAL RESOURCE MANAGEMENT					6
7	M/V STELLER REPLACEMENT (ED 1)		100,000	100,000		7
8	GRANTS TO NAMED RECIPIENTS: (AS 37.05.316)					8
9	DEER MOUNTAIN HATCHERY FACILITY ENHANCEMENTS (ED 1)		145,000	145,000		9
10	RABBIT CREEK RIFLE RANGE ACQUISITION AND UPGRADE FACILITIES (ED 9)		25,000	25,000		10
11	UNGULATE ENHANCEMENT/40 MILE REGION (ED 17)		30,000	30,000		11
12		*****	*****			12
13		***** DEPARTMENT OF PUBLIC SAFETY	*****			13
14		*****	*****			14
15	PUBLIC PROTECTION					15
16	ALASKA PUBLIC SAFETY ACADEMY RE-ROOFING AND REPAIRS (ED 3)		180,000	180,000		16
17	GRANTS TO NAMED RECIPIENTS: (AS 37.05.316)					17
18	AWARE SEWER SYSTEM (ED 4)		40,000	40,000		18
19	SOUTH PENINSULA WOMEN'S SERVICES, INCORPORATED - FACILITY ACQUISITION (ED 5)		84,000	84,000		19
20	ABUSED WOMEN'S AID IN CRISIS, INCORPORATED/BUILDING IMPROVEMENTS AND UPGRADE (ED 9)		70,500	70,500		20
21	ABUSED WOMEN'S AID IN CRISIS INCORPORATED - VAN (ED 7-15)		23,000	23,000		21
22	ABUSED WOMEN'S AID IN CRISIS INCORPORATED - HEATING/ SECURITY/UPGRADE (ED 7-15)		50,000	50,000		22

1		APPROPRIATION	APPROPRIATION	FUND SOURCES	1	
2		ALLOCATIONS	ITEMS	GENERAL FUND	OTHER FUNDS	2
3	*****		*****			3
4	***** DEPARTMENT OF TRANSPORTATION/PUBLIC FACILITIES *****		*****			4
5	*****		*****			5
6	TRANSPORTATION					6
7	CENTRAL REGION STATE HIGHWAY PROGRAM					7
8	MCCARTHY - 30 MILES MCCARTHY ROAD - SAFETY MAINTENANCE - BRUSH CUTTING (ED 6)		10,300	10,300		8
9	CHURCH ROAD IMPROVEMENTS, CONSTRUCTION AND MATERIALS (ED 16)		50,000	50,000		9
10	PITTMAN ROAD IMPROVEMENTS - PAVING, MAINTENANCE AND OPERATIONS (ED 16)		400,000	400,000		10
11	HATCHER PASS ROAD UPGRADE AND PULLOUT (ED 16)		60,000	60,000		11
12	HYER ROAD REPAIR AND UPGRADE (ED 16)		120,000	120,000		12
13	MATANUSKA-SUSITNA BOROUGH - SCOTT ROAD (ED 16)		50,000	50,000		13
14	TALKEETNA - SCHOOL ZONE SAFETY IMPROVEMENTS (ED 16)		10,000	10,000		14
15	CENTRAL REGION STATE AVIATION PROGRAM					15
16	LEVELOCK - RUNWAY LIGHTING (ED 26)		100,000	100,000		16
17	NORTHERN REGION STATE HIGHWAY PROGRAM					17
18	MORDALE AND FREEMAN ROADS SURFACE REPAIRS IMPROVEMENTS (ED 18)		90,000	90,000		18
19	PLACE, NELSON, REPP AND BROCK ROADS SURFACE REPAIR (ED 18)		100,000	100,000		19
20	SOUTHEAST REGION STATE HIGHWAY PROGRAM					20
21	PONT REEF AREA ROADS - ASPHALT SURFACE TREATMENT (ED 1)		98,000	98,000		21

1	DEPARTMENT OF TRANSPORTATION/PUBLIC FACILITIES (CONT.)				1
2			APPROPRIATION	APPROPRIATION	FUND SOURCES
3		ALLOCATIONS	ITEMS	GENERAL FUND	OTHER FUNDS
4	KNUDSON COVE ROAD AND SPUR - ASPHALT SURFACE TREATMENT (ED 1)		82,000	82,000	4
5	SUNSET AND SHORELINE DRIVE - ASPHALT TREATMENT (ED 1)		184,000	184,000	5
6	SOUTH POINT HIGGINS - ASPHALT SURFACE TREATMENT (ED 1)		139,000	139,000	6
7	CRANBERRY ROAD - ASPHALT SURFACE TREATMENT (ED 1)		29,000	29,000	7
8	SOUTHEAST REGION WATERS AND HARBORS				8
9	POINT BAKER - GANGWAY TO STATE FLOAT (ED 2)		15,000	15,000	9
10	*****		*****		10
11	***** DEPARTMENT OF ENVIRONMENTAL CONSERVATION *****		*****		11
12	*****		*****		12
13	NATURAL RESOURCE MANAGEMENT				13
14	FIFTY PERCENT CONSTRUCTION GRANT PROGRAM				14
15	KETCHIKAN CENTRAL WATERFRONT REDEVELOPMENT PROJECT SEWER AND WATER (ED 1)		130,000	130,000	15
16	MCBAHAN WATER - REPAIR CONTAMINATED SYSTEM, FINAL FUNDING PHASE (ED 7)		100,000	100,000	16
17	CROOKED CREEK WATER/SEWER/DUMPSITE STUDY (ED 24)		25,000	25,000	17
18	STONY RIVER WATER AND SOLID WASTE PROJECT (ED 24)		50,000	50,000	18
19	AKIACHAK WATER AND SEWER PROJECT (ED 25)		300,000	300,000	19
20	CITY OF NAPAIAK - FULL DEMONSTRATION FLUSH TANK AND HAUL PROJECT (ED 25)		170,000	170,000	20
21	CITY OF NAPASKIAK - WATER WELL SYSTEM (ED 25)		300,000	300,000	21

1	DEPARTMENT OF ENVIRONMENTAL CONSERVATION (CONT.)				1
2			APPROPRIATION	APPROPRIATION	FUND SOURCES
3		ALLOCATIONS	ITEMS	GENERAL FUND	OTHER FUNDS
4	CITY OF MUNAPITCHUK - HONEY BUCKET HAUL SYSTEM (ED 25)		100,000	100,000	4
5	TUNTUTULIAK - WASTE DISPOSAL STUDY/WATERING POINT (ED 25)		50,000	50,000	5
6	CITY OF ALEKNAGIK - ATTIK ISLAND WATER AND SEWER (ED 26)		100,000	100,000	6
7	IGIUBIG - WATER AND SEWER IMPROVEMENTS (ED 26)		100,000	100,000	7
8	CITY OF TOGIK - WATER AND SEWER PROJECT (ED 26)		80,000	80,000	8
9	PORT LIONS WATER AND SEWER CONSTRUCTION (ED 27)		150,000	150,000	9
10	CHIGNIK WATER AND SEWER IMPROVEMENTS (ED 27)		100,000	100,000	10
11	CHIGNIK LAKE LANDFILL AND ROAD CONSTRUCTION (ED 27)		100,000	100,000	11
12	*****		*****		12
13	***** DEPARTMENT OF COMMUNITY & REGIONAL AFFAIRS *****		*****		13
14	*****		*****		14
15	DEVELOPMENT				15
16	GRANTS TO NAMED RECIPIENTS: (AS 37.05.316)				16
17	YAKUTAT NATIVE ASSOCIATION CULTURE CAMP SUPPLIES (ED 2)		5,000	5,000	17
18	BETTY ELIASON CHILD CARE CENTER EQUIPMENT AND REPAIRS (ED 3)		23,200	23,200	18
19	SENIOR CITIZENS SUPPORT SERVICES, INCORPORATED - JUNEAU SENIOR HOUSING CONSTRUCTION GRANT (ED 4)		500,000	500,000	19
20	PERSEVERANCE THEATRE LAND ACQUISITION (ED 4)		52,000	52,000	20
21	KENAI LITTLE LEAGUE, INCORPORATED - SAFETY IMPROVEMENTS (ED 5)		25,000	25,000	21

1 DEPARTMENT OF COMMUNITY & REGIONAL AFFAIRS (CONT.)				
2		APPROPRIATION	APPROPRIATION	FUND SOURCES
3		ALLOCATIONS	GENERAL FUND	OTHER FUNDS
4		ITEMS		
4	SOLDOTNA LITTLE LEAGUE, INCORPORATED - SAFETY IMPROVEMENTS FINAL PHASE (ED 5)	25,000	25,000	
5	FUNNY RIVER CHAMBER OF COMMERCE - MATCHING GRANT COMMUNITY CENTER CONSTRUCTION (ED 5)	50,000	50,000	
6	ANCHOR POINT SENIOR CITIZENS, INCORPORATED - MATCHING GRANT SENIOR CENTER REHABILITATION/PURCHASE (ED 5)	100,000	100,000	
7	MINILCHIK SENIOR CITIZENS, INCORPORATED - MATCHING GRANT SENIOR CENTER BUILDING IMPROVEMENTS (ED 5)	100,000	100,000	
8	STERLING AREA SENIOR CITIZENS, INCORPORATED - SENIOR CENTER COMPLETION (ED 5)	120,000	120,000	
9	EARTH, INCORPORATED - TRANSPORT AND ACQUISITION OF EQUIPMENT (ED 9)	5,000	5,000	
10	EARTH INCORPORATED - SALMON DISTRIBUTION TRANSPORTATION/DISTRIBUTION COSTS (ED 11)	5,000	5,000	
11	ALASKA BOTANICAL GARDENS, INCORPORATED - SITE PLAN DEVELOPMENT (ED 12)	10,000	10,000	
12	BIRD TREATMENT AND LEARNING CENTER - SITE ACQUISITION (ED 12)	10,000	10,000	
13	EARTH, INCORPORATED - EQUIPMENT/OPERATIONS (ED 12)	10,000	10,000	
14	KOREAN COMMUNITY OF ANCHORAGE - EQUIPMENT/DEBT PAYMENT (ED 12)	2,500	2,500	
15	AFRICAN AMERICAN BUSINESS - COUNCIL ALASKA (ED 12)	8,000	8,000	
16	ALASKA BOTANICAL GARDENS, INCORPORATED - SITE PLAN DEVELOPMENT (ED 13)	10,000	10,000	
17	BIRD TREATMENT AND LEARNING CENTER - SITE ACQUISITION (ED 13)	10,000	10,000	

1 DEPARTMENT OF COMMUNITY & REGIONAL AFFAIRS (CONT.)					1
					2
					3
					4
					5
					6
					7
					8
					9
					10
					11
					12
					13
					14
					15
					16
					17
					18
2			APPROPRIATION	APPROPRIATION FUND SOURCES	2
3		ALLOCATIONS	ITEMS	GENERAL FUND	OTHER FUNDS
4	EARTH, INCORPORATED - EQUIPMENT/OPERATIONS (ED 13)		10,000	10,000	
5	KOREAN COMMUNITY OF ANCHORAGE - EQUIPMENT/DEBT PAYMENT (ED 13)		5,000	5,000	
6	IDITAROD TRAIL COMMITTEE (ED 13)		10,000	10,000	
7	MUSK OX - COLONY BARN (ED 13)		7,500	7,500	
8	AFRICAN AMERICAN BUSINESS COUNCIL - ALASKA (ED 13)		5,000	5,000	
9	AFRICAN AMERICAN BUSINESS COUNCIL OF ALASKA - APPLIED RESEARCH INSTITUTE (ED 14)		25,000	25,000	
10	MOST WORSHIPFUL PRINCE GRAND LODGE BUILDING RENOVATIONS (ED 14)		10,000	10,000	
11	ALASKA BOTANICAL GARDENS, INCORPORATED SITE PLAN DEVELOPMENT (ED 14)		10,000	10,000	
12	AFRICAN AMERICAN BUSINESS COUNCIL OF ALASKA - VAN AND EQUIPMENT PURCHASE (ED 7-15)		23,000	23,000	
13	ALASKA MEDICAL AND REHABILITATIVE HOUSING INCORPORATED - PROPERTY DEBT AND MULTI-PURPOSE HOUSING DESIGN (ED 7-15)		50,000	50,000	
14	BOOTSTRAPS OF AMERICA, INCORPORATED - EQUIPMENT AND TRAINING (ED 7-15)		50,000	50,000	
15	DISABLED AMERICAN VETERANS - ANCHORAGE CHAPTER - VAN/EQUIPMENT (ED 7-15)		20,000	20,000	
16	KOREAN COMMUNITY OF ANCHORAGE INCORPORATED - EQUIPMENT/BUILDING REPAIRS (ED 7-15)		24,000	24,000	
17	AHTNA HERITAGE FOUNDATION "POSITIVE PATHWAYS" (ED 17)		45,000	45,000	
18	NENANA VALLEY DEVELOPMENT AUTHORITY - UPGRADE AND REFURBISH VISITOR CENTER (ED 17)		6,000	6,000	

1	DEPARTMENT OF COMMUNITY & REGIONAL AFFAIRS (CONT.)				1
2		ALLOCATIONS	APPROPRIATION ITEMS	APPROPRIATION GENERAL FUND	FUND SOURCES OTHER FUNDS 2
3					3
4	INTERIOR AND ARCTIC ALASKA AERONAUTICAL FOUNDATION - GOLD DOME HEATING SYSTEM (ED 19-21)		56,000	56,000	4
5	NORDIC SKI CLUB OF FAIRBANKS - MAINTENANCE EQUIPMENT (ED 19-21)		20,000	20,000	5
6	YUKON QUEST INTERNATIONAL SLED DOG RACE MISCELLANEOUS EQUIPMENT (ED 19-21)		42,000	42,000	6
7	NORTH STAR LITTLE LEAGUE - BALL FIELD CONSTRUCTION (ED 19-21)		150,000	150,000	7
8	FAIRBANKS HISTORICAL PRESERVATION FOUNDATION - RIVERBOAT NENANA RESTORATION (ED 19-21)		75,000	75,000	8
9	MAINSTREET FAIRBANKS - SMALL BUSINESS INCUBATOR (ED 19-21)		100,000	100,000	9
10	FAIRBANKS NEIGHBORHOOD HOUSING SERVICES - REVOLVING LOAN FUND (ED 19-21)		150,000	150,000	10
11	THE BREADLINE - OLD USO BUILDING PURCHASE (ED 19-21)		150,000	150,000	11
12	ALASKA GOLDPANNERS - PHASE V COMPLETION (ED 19-21)		54,000	54,000	12
13	FAIRBANKS COMMUNITY FOOD BANK - DEBT RETIREMENT (ED 19-21)		25,000	25,000	13
14	MIDNIGHT SUN BOY SCOUTS - DINING HALL CONSTRUCTION (ED 19-21)		205,000	205,000	14
15	FARTHEST NORTH GIRL SCOUT COUNCIL - MULTIPURPOSE BUILDING CONSTRUCTION (ED 19-21)		205,000	205,000	15
16	DOYON FOUNDATION - DOYON HOUSE PROJECT (ED 22)		50,000	50,000	16
17	IDITAROD TRAIL COMMITTEE (ED 22)		5,000	5,000	17
18	SHISHMAREF TANNERY PROJECT (ED 23)		60,900	60,900	18
19	NOME ESKIMO COMMUNITY - BUILDING IMPROVEMENTS/ FISHERIES ENHANCEMENT PROJECT (ED 23)		18,800	18,800	19

1	DEPARTMENT OF COMMUNITY & REGIONAL AFFAIRS (CONT.)				1
2			APPROPRIATION	APPROPRIATION FUND SOURCES	2
3		ALLOCATIONS	ITEMS	GENERAL FUND	OTHER FUNDS
4	IDITAROD TRAIL COMMITTEE (ED 23)		5,000	5,000	4
5	KUSKOKWIM ECONOMIC DEVELOPMENT COUNCIL - MIDDLE KUSKOKWIM REGION COMMUNICATION-PILOT PROJECT (ED 24)		14,000	14,000	5
6	DOYON FOUNDATION - DOYON HOUSE PROJECT (ED 24)		50,000	50,000	6
7	ASSOCIATION OF VILLAGE COUNCIL PRESIDENTS (AVCP) - OFFICE EXPANSION (ED 25)		340,000	340,000	7
8	ASSOCIATION OF VILLAGE COUNCIL PRESIDENTS (AVCP) - EMERGENCY RUNWAY LIGHTS (ED 25)		6,000	6,000	8
9	KODIAK SENIOR CENTER COMPLEX IMPROVEMENTS/EXPANSION (ED 27)		150,000	150,000	9
10		*****			10
11		***** UNIVERSITY OF ALASKA *****			11
12		*****			12
13	UNIVERSITY OF ALASKA				13
14	UNIVERSITY OF ALASKA - COUNCIL ON ECONOMIC EDUCATION, PUBLISHING COSTS (ED 1)		5,000	5,000	14
15	UNIVERSITY OF ALASKA - COUNCIL ON ECONOMIC EDUCATION, PUBLISHING COSTS (ED 9)		10,000	10,000	15
16	UNIVERSITY OF ALASKA - COUNCIL ON ECONOMIC EDUCATION, PUBLISHING COSTS (ED 11)		5,000	5,000	16
17	UNIVERSITY OF ALASKA - COUNCIL ON ECONOMIC EDUCATION, PUBLISHING COSTS (ED 12)		2,500	2,500	17
18	UNIVERSITY OF ALASKA - COUNCIL ON ECONOMIC EDUCATION, PUBLISHING COSTS (ED 13)		2,500	2,500	18
19	UNIVERSITY OF ALASKA - COUNCIL ON ECONOMIC EDUCATION, PUBLISHING COSTS (ED 19-21)		5,000	5,000	19

1	UNIVERSITY OF ALASKA (CONT.)				1
2		ALLOCATIONS	APPROPRIATION ITEMS	APPROPRIATION FUND SOURCES GENERAL FUND	OTHER FUNDS
3					3
4	UNIVERSITY OF ALASKA, FAIRBANKS				4
5	4-H FISHERIES EDUCATION (ED 13)		2,500	2,500	5
6	DOYON HOUSE CONSTRUCTION (ED 19-21)		200,000	200,000	6
7	MUSEUM COLLECTIONS - ACQUISITION AND CONSERVATION (ED 19-21)		100,000	100,000	7
8	UNIVERSITY OF FAIRBANKS - KUAC - TELEVISION - NETWORK RECORD/PLAYBACK AUTOMATION (ED 19-21)		31,000	31,000	8
9	UNIVERSITY OF FAIRBANKS - GEOPHYSICAL BUILDING EXPANSION (ED 19-21)		300,000	300,000	9
10	4-H YUKON FISHERIES EDUCATION AND YOUTH DEVELOPMENT PROGRAM - FISHERIES SCIENCE PROGRAM (ED 19-21)		20,000	20,000	10
11	KODIAK - FISHERY INDUSTRIAL TECHNOLOGY CENTER LABORATORY EQUIPMENT (ED 27)		50,000	50,000	11
12	UNIVERSITY OF ALASKA, ANCHORAGE				12
13	VALDEZ - PRINCE WILLIAM SOUND COMMUNITY COLLEGE/ ACADEMIC TRAINING EQUIPMENT (ED 6)		65,000	65,000	13
14	PRINCE WILLIAM SOUND COMMUNITY COLLEGE - REPAIR HEATING VENTILATION AND AIR CONDITIONING (ED 6)		75,000	75,000	14
15	UNIVERSITY OF ALASKA, ANCHORAGE - SCHOOL OF EDUCATION FURNISHINGS AND EQUIPMENT (ED 10)		25,000	25,000	15
16	UNIVERSITY OF ALASKA, ANCHORAGE - DESIGN AVIATION TECHNOLOGY BUILDING (MATCHING) (ED 10)		300,000	300,000	16
17	UNIVERSITY OF ALASKA, ANCHORAGE - LIBRARY UPGRADES (ED 12)		15,000	15,000	17
18	UNIVERSITY OF ALASKA ANCHORAGE - FIRE CODE COMPLIANCE (ED 7-15)		1,000,000	1,000,000	18
19	UNIVERSITY OF ALASKA ANCHORAGE - CONSTRUCTION COMPLETION OF CLASS/LABORATORY BUILDING (ED 7-15)		700,000	700,000	19