

ALASKA LEGISLATURE COMMITTEE BILL FILES - 1987 - 1988 8879

SB 360 thru SB 362 . FILED 110

SR

360

SENATE COMMITTEE REPORT

FURTHER

2/3/88

DATE TURNED INTO OFFICE 3/16/88

Mr. President:

Finance Committee considered SB 360

repealing the termination date of the Delta Junction Bison Range area

and recommended

replace with CS SB 360 (Res)  same title  
 or adopt CS  new title

attached amendment(s) and

do pass

do not pass

no recommendation

individual recommendations

further referral to \_\_\_\_\_

letter of intent adopted \_\_\_\_\_

Committee  attached or  adopted fiscal note(s)

new  updated or  previous

zero  fiscal impact

MEMBERS SIGNING DO PASS

OTHER RECOMMENDATIONS

*Jim Leung*  
*Pat He*  
*Paul Frank*  
*W. Kennedy*  
*Debra*

\_\_\_\_\_  
\_\_\_\_\_  
\_\_\_\_\_  
\_\_\_\_\_  
\_\_\_\_\_

*Rich Halford do pass*  
Chairman signature and recommendation

Committee Backup attached

Original sponsor: Coghill

1 IN THE SENATE BY THE RESOURCES COMMITTEE  
2 CS FOR SENATE BILL NO. 360 (Resources)  
3 IN THE LEGISLATURE OF THE STATE OF ALASKA  
4 FIFTEENTH LEGISLATURE - SECOND SESSION  
5 A BILL  
6 For an Act entitled: "An Act repealing termination dates related to the  
7 Delta Junction Bison Range area."  
8 BE IT ENACTED BY THE LEGISLATURE OF THE STATE OF ALASKA:  
9 \* Section 1. Section 3, ch. 39, SLA 1979, as amended by sec. 1, ch. 73,  
10 SLA 1980 is repealed.  
11 \* Sec. 2. Sections 2, 4, and 6, ch. 118, SLA 1984 are repealed.

FISCAL NOTE

REQUEST:

Revision Date: \_\_\_\_\_  
Title: An Act Repealing the Termination of  
the Delta Junction Bison Range Area  
Sponsor: SR360- Coghill; HB383 - Schultz  
Requestor: Senate Resources

Agency Affected: DNR & Fish & Game  
BRU: Game DIVISION  
Components: Game

EXPENDITURES/REVENUES: (Thousands of Dollars)

OPERATING	FY 88	FY 89	FY 90	FY 91	FY 92	FY 93
PERSONAL SERVICES	0	0	10.5	10.5	10.5	10.5
TRAVEL	0	0	0.2	0.2	0.2	0.2
CONTRACTUAL	0	0	5.0	5.0	5.0	5.0
SUPPLIES	0	0	30.0	30.0	30.0	30.0
EQUIPMENT	0	0	0.5	0.5	0.5	0.5
LAND & STRUCTURES						
GRANTS, CLAIMS						
MISCELLANEOUS	0	0	3.8	3.8	3.8	3.8
TOTAL OPERATING	0	0	50.0	50.0	50.0	50.0

CAPITAL						
---------	--	--	--	--	--	--

REVENUE	0	0	50.0	50.0	50.0	50.0
---------	---	---	------	------	------	------

FUNDING: (Thousands of Dollars)

GENERAL FUND						
FEDERAL FUNDS						
OTHER Prg. Rcpts	0	0	50.0	50.0	50.0	50.0
TOTAL						

POSITIONS:

FULL-TIME	1	1				
PART-TIME	2	2				
TEMPORARY						

ANALYSIS : (Attach a separate page if necessary)

Actual annual income from program receipts is variable. Presently the authorized ceiling is \$50,000. Source is an additional \$5 charge per permit application for the Delta bison herd drawing permit hunt. (continued next page)

Prepared by: Don McKnight  
Division: Game

Phone: 465-4190  
Date: January 29, 1988

Approved by Commissioner: Alvin K. Peterson  
Agency: Fish and Game

Date: 1-29-88

Distribution (by preparer):  
Legislative Finance  
Legislative Sponsor  
Requestor  
Office of Management and Budget  
Impacted Agency(ies)

RECEIVED  
FEB 1 1988  
page \_\_\_\_\_ of \_\_\_\_\_

ANALYSIS: (continued)

Development costs of the Delta Junction Bison Range through FY89 are paid from a CIP established in 1984 (Chapter 39 SLA 1984). If SB360 or HB383 pass, the Bison Range will continue, and program receipts from the permit application fee will continue to pay for maintenance level operations. General funds would not be involved. The principal costs would be fertilizer for bison food production (perennial grasses and some barley), field personnel, fuel for equipment, and potentially some contracting for specialized work for which department staff is untrained. Line item expenditures are estimates which may change.



STATE OF ALASKA  
OFFICE OF THE GOVERNOR

**BILL ANALYSIS**

DEPARTMENT Fish and Game	DIVISION Game	BILL NUMBER HB383; SB360	SPONSOR Senator Coghill and Representative Schultz
SHORT TITLE OF BILL An act repealing the termination date of the Delta Junction Bison Range area			
DEPARTMENT POSITION Favor/support			
PREPARED BY Dick Bishop	DATE 1/28/88	COMMISSIONER'S SIGNATURE <i>W. G. Allenworth</i>	DATE 1-29-88

**SUMMARY**

OTHER AGENCIES AFFECTED BY BILL Department of Natural Resources	CONSTITUENT GROUP(S) AFFECTED BY BILL See Section 1 on Page 2
ORGANIZATIONAL SUPPORT FOR BILL See Section 2 on Page 2	ORGANIZATIONAL OPPOSITION TO BILL None to date

FISCAL IMPACT:  NONE  FISCAL NOTE ATTACHED

**BACKGROUND/LEGISLATIVE INTENT** Legislative intent in establishing and funding development of the Bison Range was to provide additional winter range for the Delta bison herd, and to alleviate damage by bison to crops on the Delta Agricultural Project. The Delta Junction Bison Range was established in 1979 with a 3 year sunset provision (Chap 39 SLA 1979). In 1980 the sunset provision was extended to 10 years (August 1989) to provide time to develop the range and test its effectiveness (Chap 73 SLA 1980). In 1984, a 1.5 million dollar CIP was approved to fund range development (Chap 39 SLA 1984). In 1984, the (continued next page)

**ANALYSIS OF BILL/PROGRAM EFFECTS**

The two bills, HB383 and SB360, are identical. Their effect would be to eliminate the statutory mandate that the Bison Range, the related hunting permit fee increase, and the timber management provisions cease to exist at "sunset," August 1, 1989. Elimination of the sunset provision would enable the ADF&G to continue to maintain the Bison Range for its original purpose, which it is successfully fulfilling.

**RECEIVED**  
FEB 1 1988  
LEGISLATIVE FINANCE

**AMENDMENTS PROPOSED**

Line 10 in both bills, "Section 4" should read "Section 6." Section 6 addresses both Section 2 (dealing with \$10 permit fee) and Section 4 (timber management provisions).

PLEASE ATTACH A SEPARATE SHEET FOR ADDITIONAL COMMENTS OR ANALYSIS.

Bill Analysis

Page 2

BACKGROUND/LEGISLATIVE INTENT (continued)

the drawing permit fee for the Delta bison hunt was raised to \$10 to provide range maintenance and management funds (\$5/permit).

Section 1:

CONSTITUENT GROUPS AFFECTED BY BILL (continued)

Salcha-Big Delta Soil Conservation District  
Delta Bison Range Ad Hoc Committee  
Delta Fish and Game Advisory Committee  
Delta Junction Chamber of Commerce  
Alaska Farmers and Stock Growers Association  
Delta Junction Area Residents  
Deltana Corporation  
Bison Range Neighbors (Alaska Highway Residents)

Section 2:

ORGANIZATIONAL SUPPORT FOR BILL (continued)

Salcha-Big Delta Soil Conservation District  
Delta Bison Range Ad Hoc Committee  
Delta Fish and Game Advisory Committee (no quorum)  
Delta Junction Chamber of Commerce  
Delta Trappers Association  
Delta Sportsmen's Association  
Alaska Farmers and Stock Growers Association (only for 5-year extension)  
Deltana Corporation (only for 5-year extension)  
Bison Range Neighbors (Alaska Highway Residents)

Senator John B. (Jack) Coghill  
Alaska State Legislature

Box V  
Juneau, Alaska 99811  
(907) 465-4797

Box 55028  
North Pole, Alaska 99705  
(907) 488-0862



M E M O R A N D U M

TO: Members of the Senate Finance Committee  
FROM: Senator Coghill  
RE: SB 360, "An Act repealing the termination date of the  
Delta Bison Range"  
DATE: March 16, 1988

The Delta Bison Range was established in 1979 to prevent wholesale destruction of grain crops grown by farmers in Delta I and Delta II. Sunset provisions in the act were extended from three years to ten years in 1980. Without an extension the program will now sunset in 1989.

From the Fish and Game Department analysis it can be seen that the program has been successful in preventing the bison herd from foraging agricultural crops and is supported by the entire community.

Program receipts from hunting permits and applications help cover expenses of maintaining the bison range.

I urge the committee to support this bill.

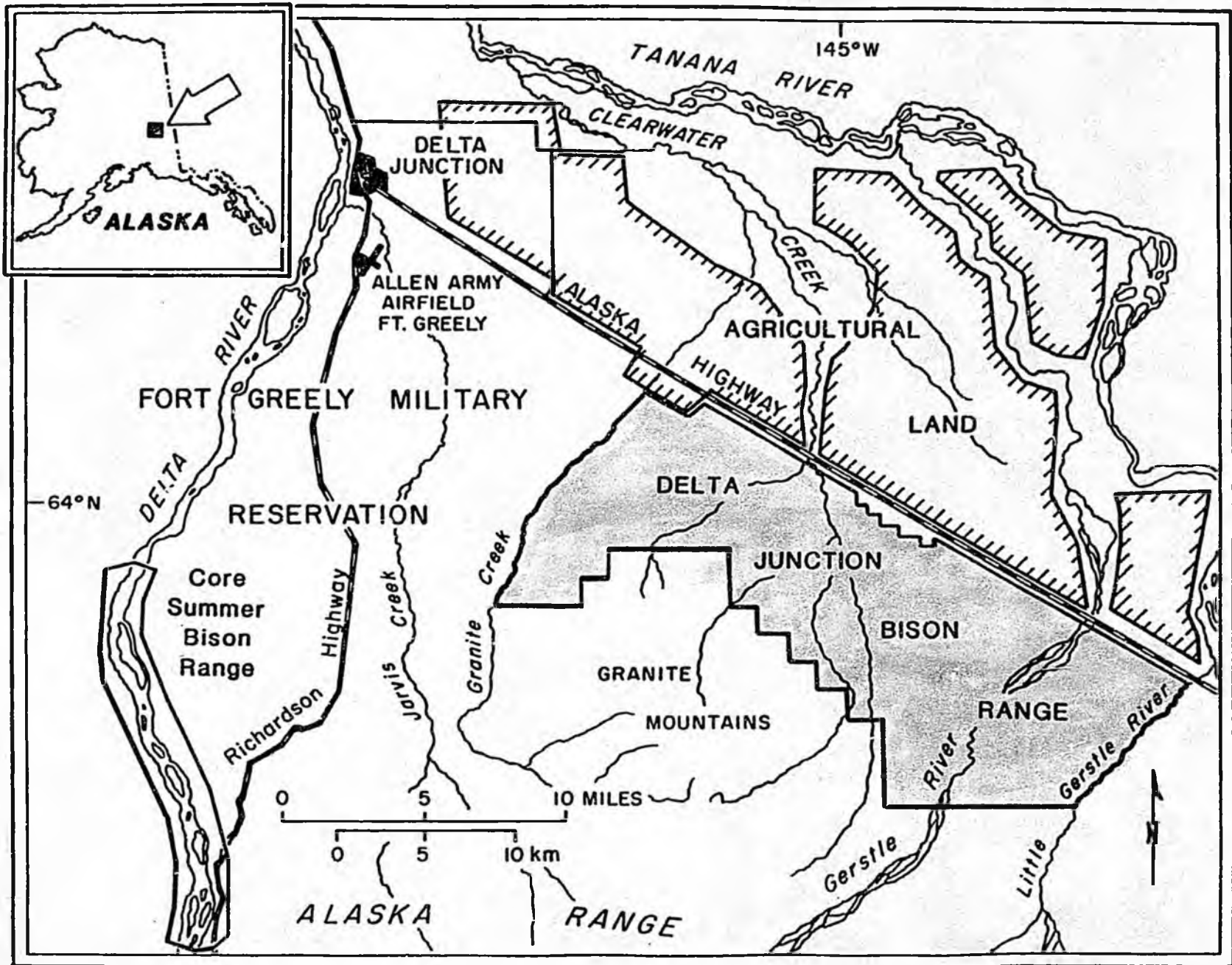

# **CORRECTION**

**THIS DOCUMENT  
HAS BEEN REPHOTOGRAPHED  
TO ASSURE LEGIBILITY**

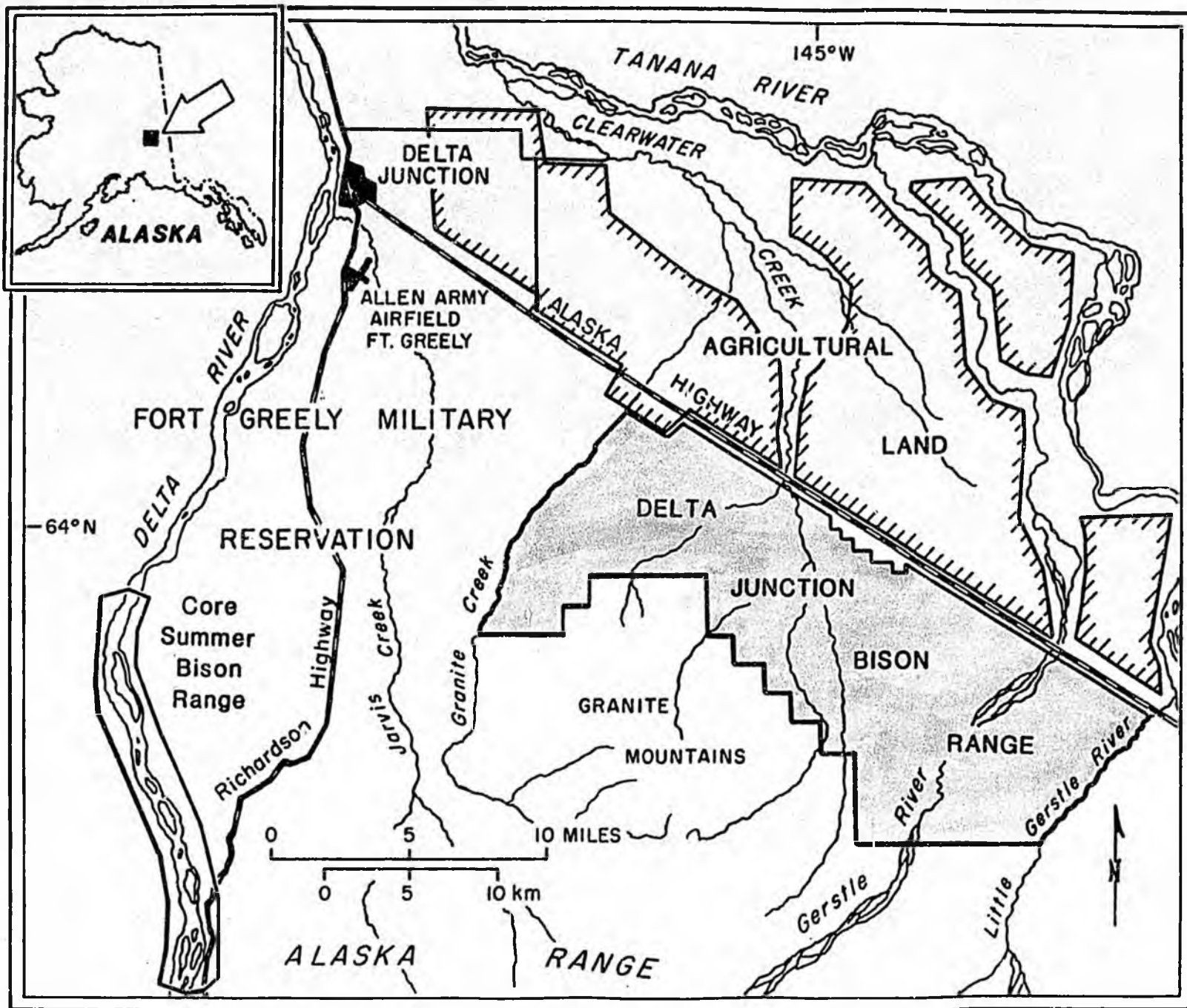

## FACTS AND FIGURES ABOUT THE DELTA JUNCTION BISON RANGE

### Chronology of Bison Range Legislation

- 1979--Creation of Delta Junction Legislation (Ch. 39, SLA 1979)
- 1980--Original 3 year sunset clause changed to 10 years effective August 1979 (Ch. 73, SLA 1980)
- 1984--Special appropriation of \$1.544 million (Ch. 59, SLA 1984)
  - Bison hunt permit application fee increased to \$10 (Ch. 118, SLA 1984)

### Bison Range Habitat Development Since 1979

- Acres cleared = 2800
- Acres planted = 2100 (700 acres are covered by berm piles)
- Forage planted = nugget bluegrass, arctared fescue, barley
- Water site = drilled well to provide water to stock tanks

### Equipment Purchased With Special Appropriation

- 120 horse power tractor
- field disk
- rotary brush cutter
- 4 ton capacity fertilizer spreader
- dozer
- used 2 ton flat bed truck and tilt bed trailer
- used 40 ft. X 60 ft. metal storage building



# LAWS OF ALASKA

1979

**Source**

CS 2d SSHB 31 am S

**Chapter No.**

39

**AN ACT**

Creating the Delta Junction Bison Range Area.

---

**BE IT ENACTED BY THE LEGISLATURE OF THE STATE OF ALASKA:**

**THE ACT FOLLOWS ON PAGE 1, LINE 8**

Approved by the Governor: May 3, 1979  
Actual Effective Date: August 1, 1979

Aug 1, 1979

1  
2  
3  
4  
5  
6  
7  
8  
9  
10  
11  
12  
13  
14  
15  
16  
17  
18  
19  
20  
21  
22  
23  
24  
25  
26  
27  
28  
29

AN ACT

Creating the Delta Junction Bison Range Area.

\* Section 1. It is the purpose of this Act to perpetuate free-ranging bison on the land described in this Act by management of the habitat to provide an adequate winter range for the bison. It is also the purpose of this Act to alter seasonal movements of bison herds on the land in order to diminish the damage caused by the herds to agriculturally developed land.

\* Sec. 2. AS 16.20 is amended by adding new sections to read:

ARTICLE 6. STATE RANGE AREAS.

Sec. 16.20.300. DELTA JUNCTION BISON RANGE. The following described areas, excluding valid existing rights, are established as the Delta Junction Bison Range Area:

- (1) Township 11 South, Range 12 East, Fairbanks Meridian
  - Section 28: S 1/2 SW 1/4, SW 1/4 SE 1/4 and that portion of the NW 1/4 SW 1/4 east of the west bank of Granite Creek excluding A.S.L.S. 78-93, Tract A, Unit 1
  - Sections 29, 32: those lands east of the west bank of Granite Creek
  - Section 33: all, excluding A.S.L.S. 78-93, Tract A, Unit 1
  - Section 34: S 1/2 NW 1/4, excluding A.S.L.S. 78-93, Tract A, Unit 1, S 1/2
  - Section 35: S 1/2, S 1/2 NW 1/4, that portion of the NE 1/4 lying south of the Alaska Highway excluding a corridor

Chapter 39

- 1 extending 1320 feet from the center line of the highway
- 2           Section 36: that portion lying south of the Alaska
- 3 Highway excluding a corridor extending 1320 feet from the center-
- 4 line of the highway
- 5           (2) Township 12 South, Range 11 East, Fairbanks Meridian
- 6                Sections 13, 24-26, 35, 36: all
- 7                Sections 1, 11, 12, 14, 22, 23, 27, 34: those lands east
- 8 of the west bank of Granite Creek
- 9           (3) Township 12 South, Range 12 East, Fairbanks Meridian
- 10               Sections 1-4, 7-25, 30, 36: all
- 11               Sections 5, 6: those lands east of the west bank of
- 12 Granite Creek
- 13           (4) Township 12 South, Range 13 East, Fairbanks Meridian
- 14               Sections 5, 6, 9: that portion lying south of the Alaska
- 15 Highway excluding a corridor extending 1320 feet from the center-
- 16 line of the highway
- 17               Section 7: all
- 18               Section 8: all, excluding a corridor extending 1320 feet
- 19 from the centerline of the Alaska Highway
- 20               Section 10: that portion of the SW 1/4 lying south of
- 21 the Alaska Highway excluding a corridor extending 1320 feet from
- 22 the centerline of the highway
- 23               Section 14: S 1/2 S 1/2 SW 1/4
- 24               Section 15: S 1/2, NW 1/4, excluding a corridor
- 25 extending 1320 feet from the centerline of the Alaska Highway
- 26               Sections 16-22: all
- 27               Section 23: S 1/2, NW 1/4, S 1/2 NE 1/4, S 1/2 N 1/2 NE
- 28 1/4
- 29               Section 24: SW 1/4, S 1/2 NW 1/4, excluding a corridor

1 extending 1320 feet from the centerline of the Alaska Highway, S  
2 1/2 S 1/2 SE 1/4

3 Sections 25-36: all

4 (5) Township 12 South, Range 14 East, Fairbanks Meridian

5 Sections 19, 28-30, 33-35: that portion lying south of  
6 the Alaska Highway excluding a corridor extending 1320 feet from  
7 the centerline of the highway

8 Sections 31, 32: all

9 (6) Township 13 South, Range 13 East, Fairbanks Meridian

10 Sections 1-5, 9-15; 23-25, 36: all

11 (7) Township 13 South, Range 14 East, Fairbanks Meridian

12 Section 1: that portion lying south of the Alaska High-  
13 way excluding a corridor extending 1320 feet from the centerline of  
14 the highway

15 Sections 2-36: all

16 (8) Township 13 South, Range 15 East, Fairbanks Meridian

17 Sections 5, 6, 8-10, 15: that portion lying south of the  
18 Alaska Highway excluding a corridor extending 1320 feet from the  
19 centerline of the highway

20 Sections 7, 16-20, 30: all

21 Sections 21, 22, 28, 29, 31, 32: that portion lying west  
22 of the east bank of the Little Gerstle River

23 (9) Township 14 South, Range 14 East, Fairbanks Meridian

24 Section 1: that portion lying west of the east bank of  
25 the Little Gerstle River

26 Sections 2-6: all

27 (10) Township 14 South, Range 13 East, Fairbanks Meridian

28 Section 1: all

29 (11) Township 14 South, Range 15 East, Fairbanks Meridian

Sec. 12, 11, 10, 15

Chapter 39

1                   Section 6: that portion lying west of the east bank of  
2 the Little Gerstle River

3                   Sec. 16.20.310. GAME MANAGEMENT PLAN. (a) The commissioner of  
4 fish and game shall develop and may amend a game management plan for  
5 bison in the area described in AS 16.20.300. After holding public  
6 hearings in accordance with AS 44.62.310 and 44.62.312, the commissioner  
7 shall implement the game management plan.

8                   (b) The game management plan shall include, but is not limited to.

9                   (1) planting grains for bison and planting other wildlife  
10 forage;

11                   (2) altering existing plant cover to create additional range  
12 and year-round habitat for bison and other animal species in the area:

13                   (3) tilling to produce forage.

14                   (c) The commissioner of fish and game shall develop and amend the  
15 game management plan to coordinate, as closely as possible, the game  
16 management plan with the activities of the Agricultural Development  
17 Authority, Department of Natural Resources, relating to the Big Delta  
18 agricultural development project.

19                   Sec. 16.20.320. ACTIVITIES ON RANGE AREA. Nothing in AS 16.20.-  
20 300 - 16.20.320 shall be construed as prohibiting activities on land  
21 described in AS 16.20.300 which are otherwise permitted in accordance  
22 with the laws and regulations of this state, including, but not limited  
23 to, hunting, trapping, engaging in recreational activities, using the  
24 land for access to adjacent areas and a 300-foot Alaska Railroad right-  
25 of-way.

26                   \* Sec. 3. The provisions of secs. 1 and 2 of this Act terminate <sup>10</sup> ~~three~~  
27 years after the effective date of this Act unless the legislature provides  
28 otherwise by law.



## LAWS OF ALASKA

1984

Source

HCS CSSB 337(Res)

Chapter No.

118

### AN ACT

Relating to the Delta Junction bison range; and providing for an effective date.

BE IT ENACTED BY THE LEGISLATURE OF THE STATE OF ALASKA:

THE ACT FOLLOWS ON PAGE 1, LINE 9

Approved by the Governor: June 20, 1984  
Actual Effective Date: Sections 1 and 3 take effect  
July 1, 1984; sections 2 and 4  
take effect August 1, 1989

AN ACT

Relating to the Delta Junction bison range; and providing for an effective date.

\* Section 1. AS 16.05.346 is repealed and reenacted to read:

Sec. 16.05.346. PERMIT APPLICATIONS. (a) If the Board of Game establishes an open season for musk oxen and has not reduced or eliminated the \$500 resident tag fee under AS 16.05.340(a)(16), the department shall conduct a drawing for permits to take the musk oxen. If the Board of Game establishes an open season for musk oxen for which the Board of Game has reduced or eliminated the resident tag fee, the department shall issue permits to take the musk oxen in the order in which applications are received by the department. A person is not eligible for more than one musk oxen permit a year. The department may not charge a fee for an application for a musk oxen permit for an open season in which the Board of Game has reduced or eliminated the resident tag fee under AS 16.05.340(a)(16). In all other cases the application fee for a musk oxen permit is \$10.

(b) The application fee for a drawing permit issued by the department for the hunting of bison in the Delta Junction bison range area is \$10.

(c) Except as provided in (a) and (b) of this section, the permit application fee for all species for which a limited drawing is conducted is \$5.

\* Sec. 2. AS 16.05.346 is repealed and reenacted to read:

Chapter 118

1           Sec. 16.05.346., PERMIT APPLICATIONS. (a) If the Board of Game  
2 declares an open season for musk oxen and has not reduced or  
3 eliminated the \$500 resident tag fee under AS 16.05.340(a)(16), the  
4 department shall conduct a drawing for permits to take the musk oxen.  
5 If the Board of Game declares an open season for musk oxen for which  
6 the Board of Game has reduced or eliminated the resident tag fee, the  
7 department shall issue permits to take the musk oxen in the order in  
8 which applications are received by the department. A person is not  
9 eligible for more than one musk oxen permit a year. The department  
10 may not charge a fee for an application for a musk oxen permit for an  
11 open season in which the Board of Game has reduced or eliminated the  
12 resident tag fee under AS 16.05.340(a)(16). In all other cases the  
13 application fee for a musk oxen permit is \$10.

14           (b) Except as provided in (a) of this section, the permit  
15 application fee for all species for which a limited drawing is  
16 conducted is \$5.

17 \* Sec. 3. AS 16.20 is amended by adding a new section to read:

18           Sec. 16.20.315. BISON RANGE TIMBER SALES. The Department of  
19 Natural Resources, division of forestry, shall provide for the sale of  
20 timber in the Delta Junction bison range area in a manner that does  
21 not delay implementation of the game management plan required under  
22 AS 16.20.310.

23 \* Sec. 4. AS 16.20.315 is repealed.

24 \* Sec. 5. Sections 1 and 3 of this Act take effect July 1, 1984.

25 \* Sec. 6. Sections 2 and 4 of this Act take effect August 1, 1989.

*Handwritten notes:*  
\$10 → from 6.20.315  
depends sec. 1 +  
repeals w/ sec. 2  
depends  
sec. 3  
timber sales

Introduced: 1/20/88  
Referred: Resources Committee

5-1632A

1 IN THE SENATE

BY COGHILL

2

SENATE BILL NO. 360

3

IN THE LEGISLATURE OF THE STATE OF ALASKA

4

FIFTEENTH LEGISLATURE - SECOND SESSION

5

A BILL

6

For an Act entitled: "An Act repealing the termination date of the Delta

7

Junction Bison Range area."

8

BE IT ENACTED BY THE LEGISLATURE OF THE STATE OF ALASKA:

9

\* Section 1. Section 3, ch. 39, SLA 1979, as amended by sec. 1, ch. 73,

10

SLA 1980, and sec. 4, ch. 118, SLA 1984 are repealed.

SENATE COMMITTEE REPORT

FIRST COMMITTEE OF REFERRAL

Date of \_\_\_\_\_ 5-DAY NOTICE  
IN ACCORDANCE WITH UNIFORM RULE 23

*Further referred  
passed  
Kills*  
FURTHER: \_\_\_\_\_

\*\*FISCAL NOTE(S) ATTACHED  \*\*  
IN ACCORDANCE WITH AS 24.08.035  
(see below)

1/20/88 DATE TURNED INTO OFFICE \_\_\_\_\_  
Mr. President:

Resources \_\_\_\_\_ Committee considered SB 360

repealing the termination date of the Delta Junction Bison Range area

and recommended:

replace with CS SB 360 (res)  same title  
*+ majority do pass*  new title  
 attached amendment(s) and

do pass

do not pass

no recommendation

individual recommendations

further referral to \_\_\_\_\_

letter of intent adopted and attached

\*\* Committee  attached or  adopted fiscal note(s)  
 zero  fiscal impact

MEMBERS SIGNING DO PASS

OTHER RECOMMENDATIONS

\_\_\_\_\_  
*Paul Fink*  
\_\_\_\_\_  
*Stan Dinger*  
\_\_\_\_\_  
*W. E. Mason*  
\_\_\_\_\_  
*Arthur Angulo*

\_\_\_\_\_  
\_\_\_\_\_  
\_\_\_\_\_  
\_\_\_\_\_  
\_\_\_\_\_

*John A. Dolars*  
Chairman signature and recommendation

Committee Backup Attached

C S S B

B 6 O

# HOUSE COMMITTEE REPORT

(11)

Date referred: 4/5/88

FURTHER REFERRALS:

(Resources waived 4/5)

DATE: 4-28-88

The Finance Committee has considered CSSB 360(Res)

"An Act repealing termination dates related to the Delta Junction Bison Range area."

**RECOMMENDS:**

- replace with \_\_\_\_\_  the same title
- attached amendment(s)  a new title
- do pass
- do not pass
- no recommendation
- individual recommendations
- additional referral to the \_\_\_\_\_ Committee

**ADOPTS:**  \_\_\_\_\_ letter of intent

**ATTACHES NEW FISCAL NOTE(S):**

- fiscal impact  same as previous fiscal note published 2/3/88 Senate
- zero fiscal note  same as previous zero fiscal note published \_\_\_\_\_
- zero with analysis

**SIGNING/DO PASS:**

ADAMS Al Adams

POURCHOT [Signature]

LARSON Ronald J. Larson

SWACK [Signature]

WOYER Mark Boyer

RIEGER [Signature]

FRANK [Signature]

DAVIS Mike Davis

**SIGNING OTHER RECOMMENDATIONS:**

GOLL [Signature]

WALLIS [Signature]

BROWN [Signature]

Al Adams  
Chairman's signature

FISCAL NOTE

REQUEST:

Revision Date: \_\_\_\_\_ Agency Affected: DNR & Fish & Game  
Tide: An Act Repealing the Termination of BRU: Game Division  
the Delta Junction Bison Range Area  
Sponsor: SB360- Coghill; HB383 - Schultz Components: Game  
Requestor: Senate Resources

EXPENDITURES/REVENUES: (Thousands of Dollars)

OPERATING	FY 88	FY 89	FY 90	FY 91	FY 92	FY 93
PERSONAL SERVICES	0	0	10.5	10.5	10.5	10.5
TRAVEL	0	0	0.2	0.2	0.2	0.2
CONTRACTUAL	0	0	5.0	5.0	5.0	5.0
SUPPLIES	0	0	30.0	30.0	30.0	30.0
EQUIPMENT	0	0	0.5	0.5	0.5	0.5
LAND & STRUCTURES						
GRANTS, CLAIMS						
MISCELLANEOUS	0	0	3.8	3.8	3.8	3.8
TOTAL OPERATING	0	0	50.0	50.0	50.0	50.0

CAPITAL						
---------	--	--	--	--	--	--

REVENUE	0	0	50.0	50.0	50.0	50.0
---------	---	---	------	------	------	------

FUNDING: (Thousands of Dollars)

GENERAL FUND						
FEDERAL FUNDS						
OTHER Prg. Rcpts	0	0	50.0	50.0	50.0	50.0
TOTAL						

POSITIONS:

FULL-TIME	1	1				
PART-TIME	2	2				
TEMPORARY						

ANALYSIS : (Attach a separate page if necessary)

Actual annual income from program receipts is variable. Presently the authorized ceiling is \$50,000. Source is an additional \$5 charge per permit application for the Delta bison herd drawing permit hunt. (continued next page)

Prepared by: Don McKnight Phone: 465-4190  
Division: Game Date: January 29, 1988

Approved by Commissioner: Don McKnight Date: 1-29-88  
Agency: Fish and Game

Distribution (by preparer):

Legislative Finance  
Legislative Sponsor  
Requestor  
Office of Management and Budget  
Impacted Agency(ies)

RECEIVED  
FEB 1 1988  
page \_\_\_\_\_ of \_\_\_\_\_

LEGISLATIVE FINANCE

ANALYSIS: (continued)

Development costs of the Delta Junction Bison Range through FY89 are paid from a CIP established in 1984 (Chapter 39 SLA 1984). If SB360 or HB383 pass, the Bison Range will continue, and program receipts from the permit application fee will continue to pay for maintenance level operations. General funds would not be involved. The principal costs would be fertilizer for bison food production (perennial grasses and some barley), field personnel, fuel for equipment, and potentially some contracting for specialized work for which department staff is untrained. Line item expenditures are estimates which may change.

Original sponsor: Coghill

1 IN THE SENATE

BY THE RESOURCES COMMITTEE

2

CS FOR SENATE BILL NO. 360 (Resources)

3

IN THE LEGISLATURE OF THE STATE OF ALASKA

4

FIFTEENTH LEGISLATURE - SECOND SESSION

5

A BILL

6 For an Act entitled: "An Act repealing termination dates related to the

7

Delta Junction Bison Range area."

8

BE IT ENACTED BY THE LEGISLATURE OF THE STATE OF ALASKA:

9

\* Section 1. Section 3, ch. 39, SLA 1979, as amended by sec. 1, ch. 73,

10

SLA 1980 is repealed.

11

\* Sec. 2. Sections 2, 4, and 6, ch. 118, SLA 1984 are repealed.



STATE OF ALASKA  
OFFICE OF THE GOVERNOR

**BILL ANALYSIS**

DEPARTMENT Fish and Game	DIVISION Game	BILL NUMBER HB383; SB360	SPONSOR Senator Coghill and Representative Schultz
SHORT TITLE OF BILL An act repealing the termination date of the Delta Junction Bison Range area			
DEPARTMENT POSITION Favor/support			
PREPARED BY Dick Bishop	DATE 1/28/88	COMMISSIONER'S SIGNATURE <i>W. M. Kelly</i>	DATE 1-29-88

**SUMMARY**

OTHER AGENCIES AFFECTED BY BILL Department of Natural Resources	CONSTITUENT GROUP(S) AFFECTED BY BILL See Section 1 on Page 2
ORGANIZATIONAL SUPPORT FOR BILL See Section 2 on Page 2	ORGANIZATIONAL OPPOSITION TO BILL None to date

FISCAL IMPACT:  NONE  FISCAL NOTE ATTACHED

**BACKGROUND/LEGISLATIVE INTENT** Legislative intent in establishing and funding development of the Bison Range was to provide additional winter range for the Delta bison herd, and to alleviate damage by bison to crops on the Delta Agricultural Project. The Delta Junction Bison Range was established in 1979 with a 3 year sunset provision (Chap 39 SLA 1979). In 1980 the sunset provision was extended to 10 years (August 1989) to provide time to develop the range and test its effectiveness (Chap 73 SLA 1980). In 1984, a 1.5 million dollar CIP was approved to fund range development (Chap 39 SLA 1984). In 1984, the (continued next page)

**ANALYSIS OF BILL/PROGRAM EFFECTS**

The two bills, HB383 and SB360, are identical. Their effect would be to eliminate the statutory mandate that the Bison Range, the related hunting permit fee increase, and the timber management provisions cease to exist at "sunset," August 1, 1989. Elimination of the sunset provision would enable the ADF&G to continue to maintain the Bison Range for its original purpose, which it is successfully fulfilling.

**RECEIVED**  
FEB 1 1988  
LEGISLATIVE FINANCE

**AMENDMENTS PROPOSED**

Line 10 in both bills, "Section 4" should read "Section 6." Section 6 addresses both Section 2 (dealing with \$10 permit fee) and Section 4 (timber management provisions).

PLEASE ATTACH A SEPARATE SHEET FOR ADDITIONAL COMMENTS OR ANALYSIS.

## Bill Analysis

Page 2

### BACKGROUND/LEGISLATIVE INTENT (continued)

the drawing permit fee for the Delta bison hunt was raised to \$10 to provide range maintenance and management funds (\$5/permit).

Section 1:

### CONSTITUENT GROUPS AFFECTED BY BILL (continued)

Salcha-Big Delta Soil Conservation District  
Delta Bison Range Ad Hoc Committee  
Delta Fish and Game Advisory Committee  
Delta Junction Chamber of Commerce  
Alaska Farmers and Stock Growers Association  
Delta Junction Area Residents  
Deltana Corporation  
Bison Range Neighbors (Alaska Highway Residents)

Section 2:

### ORGANIZATIONAL SUPPORT FOR BILL (continued)

Salcha-Big Delta Soil Conservation District  
Delta Bison Range Ad Hoc Committee  
Delta Fish and Game Advisory Committee (no quorum)  
Delta Junction Chamber of Commerce  
Delta Trappers Association  
Delta Sportsmen's Association  
Alaska Farmers and Stock Growers Association (only for 5-year extension)  
Deltana Corporation (only for 5-year extension)  
Bison Range Neighbors (Alaska Highway Residents)



## THE DELTA JUNCTION BISON RANGE

### History of Bison in Alaska

Historically, Alaska has been very important to bison in North America. Bison colonized North America after migrating from Asia to Alaska over the Bering land bridge. Bison were once the most abundant large mammal in Alaska, but became extinct about 500 years ago due to changing climatic conditions. Before their extinction, bison inhabited the Delta River near Delta Junction.

### Facts About the Delta Bison Herd

In 1928, 23 bison were transplanted from the National Bison Range in Montana to their former range along the Delta River. By 1947 the herd had increased to 400 animals. Hunting began in 1951 and is currently used to limit the herd to a precalving population of 275-300 bison. The herd is maintained at this size to reduce potential for damage to agricultural crops and to keep the herd within the carrying capacity of its summer range. About 6,000-11,000 people apply annually for an average of 40 permits to hunt Delta bison. Delta bison have been used to start three other herds in the State.

The Delta herd's summer range is along the Delta River southwest of Delta Junction. In the fall, bison migrate from the Delta River toward Delta Junction. Prior to agricultural development, the winter range included country east of Delta Junction between the Granite Mountains and Tanana Hills. With development of agriculture, bison began using farms extensively during the fall and winter.

### Bison and Agriculture in the Delta Junction Area

Delta bison began to use hay and cereal grains for part of their fall and winter feed when farms were developed in the herd's traditional winter range. Most damage occurred when bison used crops prior to fall harvest. Problems began in the 1950's, continued through the 1970's, and escalated with development of the Delta Agricultural Project in 1979.

### History of the Delta Junction Bison Range

In 1979, the Alaska Legislature established the 90,000-acre Delta Junction Bison Range. The purpose of the Bison Range was to perpetuate free-ranging bison by providing adequate winter range, and to alter seasonal movements of bison to reduce damage to agriculture. However, no money was appropriated for Bison Range development, and only small scale habitat development was initially possible. As the Delta Agricultural Project was developed in the early 1980's, conflicts between bison and agriculture increased. Because both bison and agriculture are important to Delta Junction, the community became concerned about the growing problem. They urgently requested a special appropriation from the Alaska Legislature to fund Bison Range habitat development. In 1984, the Legislature appropriated \$1.54 million for Bison Range development, and increased the bison hunt application fee from \$5 to \$10. Funds from the fee increase were for management of the Bison Range.

## Results of Bison Range Development

Habitat development produced 2800 acres of bison forage on the Bison Range, and significantly reduced problems between bison and agriculture in the Delta Junction area. During the fall migration, bison now leave the Delta River and migrate directly to the Bison Range instead of migrating to the Delta Agricultural Project as in the early 1980's. Bison damage to farms was significantly reduced in 1985 with the first substantial habitat development on the Bison Range. Continued development in 1986 and 1987 resulted in no fall crop damage those years. The appropriation has also been used to purchase farm equipment for forage production, develop bison watering sites, construct an equipment storage building, provide Bison Range staff, and other projects.

## Other Uses of the Bison Range

The Bison Range is managed for a wide variety of public uses. Public groups are encouraged to use the Bison Range if the use is compatible with bison management. For example, the 1987 Alaska State Blackpowder Rendezvous was held on the Bison Range during 3 days in July. The Bison Range is also used for timber sales, hunting, cross-country skiing, agricultural research, dog sledding, trapping, wildlife viewing, fishing, and other activities.

## Economic Impact of the Bison Range to Delta Junction

The Delta bison herd and Bison Range make an important contribution to the economy of Delta Junction. About 40 hunting parties travel to Delta Junction each year to hunt bison. Each group spends about \$290 in Delta Junction on lodging, gasoline, meals, and groceries. In addition, the Bison Range appropriation has been used to pay nearly \$1 million to local businesses for habitat development. Salary paid to Bison Range staff has also contributed to the Delta Junction economy.

## Future of the Bison Range

The Bison Range has benefited the Delta bison herd, farmers, and the community of Delta Junction. If the Bison Range and \$10 application fee are retained, it will become increasingly effective in providing fall and winter bison forage, contributing to the economy of Delta Junction, and providing public recreation for the people of Delta Junction and Alaska.

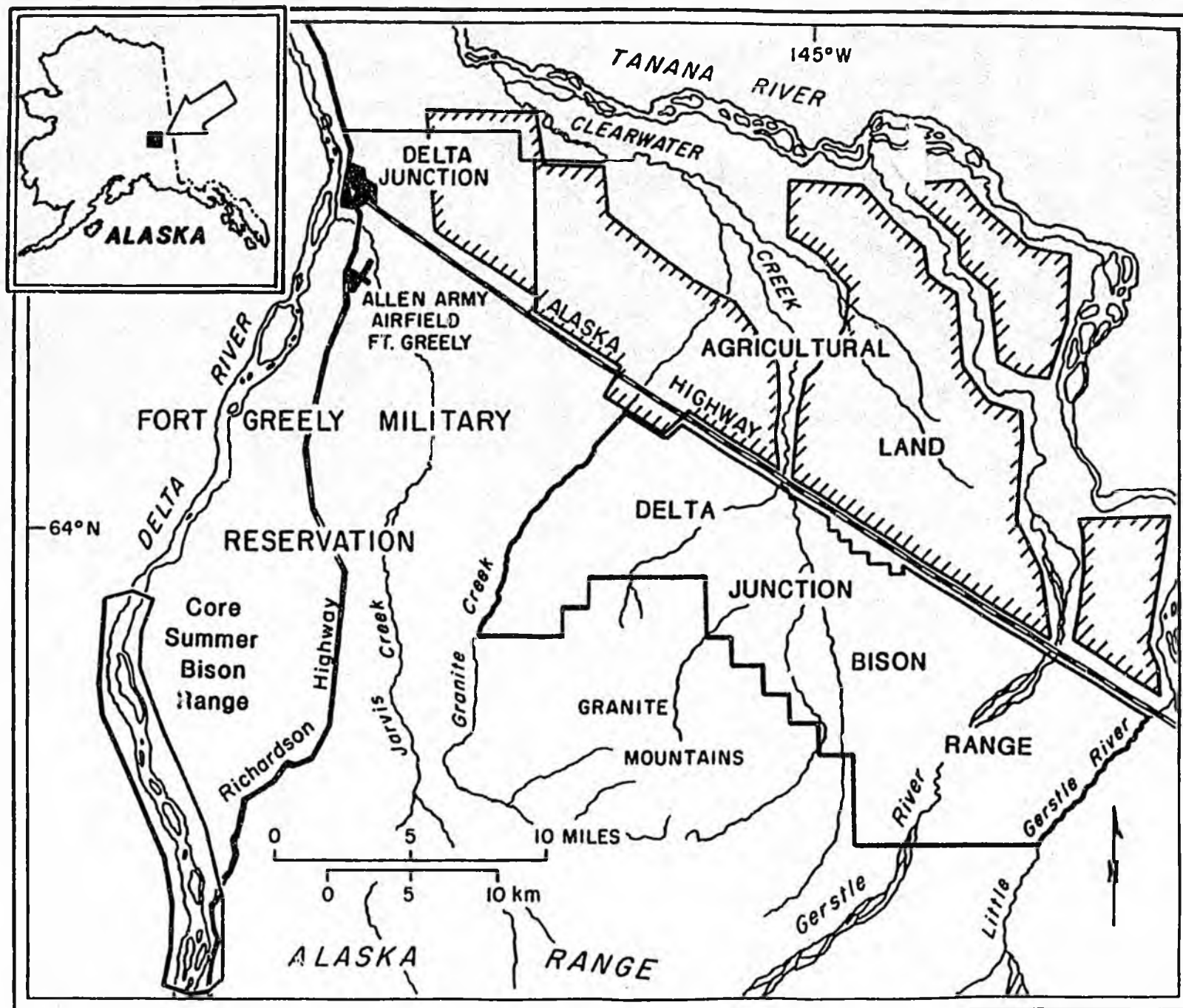

## FACTS AND FIGURES ABOUT THE DELTA JUNCTION BISON RANGE

### Chronology of Bison Range Legislation

1979--Creation of Delta Junction Legislation (Ch. 39, SLA 1979)

1980--Original 3 year sunset clause changed to 10 years effective August 1979 (Ch. 73, SLA 1980)

1984--Special appropriation of \$1.544 million (Ch. 59, SLA 1984)

Bison hunt permit application fee increased to \$10 (Ch. 118, SLA 1984)

### Bison Range Habitat Development Since 1979

Acres cleared = 2800

Acres planted = 2100 (700 acres are covered by berm piles)

Forage planted = nugget bluegrass, arctared fescue, barley

Water site = drilled well to provide water to stock tanks

### Equipment Purchased With Special Appropriation

120 horse power tractor

field disk

rotary brush cutter

4 ton capacity fertilizer spreader

dozer

used 2 ton flat bed truck and tilt bed trailer

used 40 ft. X 60 ft. metal storage building



**Salcha-Big Delta Soil and Water Conservation District**  
P.O. Box 547 - Delta Junction, Alaska 99737 - (907) 895-4241

March 3, 1988

Honorable Richard Shultz  
Alaska State Legislature  
P. O. Box V (MS 3100)  
Juneau, Alaska 99811

RE: HB 383 - Bison Range Termination

Dear Dick:

The impending termination of the Delta Bison Range should not occur, nor should the hunt permit fee be lowered.

The Delta Bison Range has reached a stage of development where it can and does function as intended. The termination of the range would restore the prior conflict between bison and farmers, and a need for another solution. That is neither necessary nor desirable.

Please move HB 383 along to a final affirmative vote.

Thank you.

Sincerely,

CHARLES G. FORCK  
Secretary-Treasurer

CGF/pd

1 IN THE SENATE

BY COGHILL

2

SENATE BILL NO. 360

3

IN THE LEGISLATURE OF THE STATE OF ALASKA

4

FIFTEENTH LEGISLATURE - SECOND SESSION

5

A BILL

6

For an Act entitled: "An Act repealing the termination date of the Delta

7

Junction Bison Range area."

8

BE IT ENACTED BY THE LEGISLATURE OF THE STATE OF ALASKA:

9

\* Section 1. Section 3, ch. 39, SLA 1979, as amended by sec. 1, ch. 73,

10

SLA 1980, and sec. 4, ch. 118, SLA 1984 are repealed.

SR

362

STATE OF ALASKA  
1988 LEGISLATIVE SESSION

BILL VERSION: CSSB 362 (Res)  
PUBLISH DATE: \_\_\_\_\_

4/6/88  
H (Res)  
then Fin

FISCAL NOTE

REQUEST:

Revision Date: \_\_\_\_\_  
Title: Dude Creek Critical Habitat Area  
Sponsor: Senator Eliason  
Requestor: House Resources

Agency Affected: Natural Resources  
BRU: Land and Water Management  
Components: \_\_\_\_\_

EXPENDITURES/REVENUES: (Thousands of Dollars)

OPERATING	FY 88	FY 89	FY 90	FY 91	FY 92	FY 93
PERSONAL SERVICES		0	0	0	0	0
TRAVEL						
CONTRACTUAL						
SUPPLIES						
EQUIPMENT						
LAND & STRUCTURES						
GRANTS, CLAIMS						
MISCELLANEOUS						
TOTAL OPERATING		0	0	0	0	0
CAPITAL						
REVENUE						

FUNDING: (Thousands of Dollars)

GENERAL FUND						
FEDERAL FUNDS						
OTHER						
TOTAL		0	0	0	0	0

POSITIONS:

FULL-TIME						
PART-TIME						
TEMPORARY						

ANALYSIS : (Attach a separate page if necessary)

Legislative designation will not preclude this parcel from being appraised as part of the Mental Health Settlement. There may be some administrative savings because the public notice will be unnecessary; however, these savings will be less than \$100.

Prepared by: Janet Burleson Phone: 465-3400  
Division: Land and Water Management Date: 3/16/88

Approved by Commissioner: AB Date: \_\_\_\_\_  
Agency: Department of Natural Resources

Distribution (by preparer):  
Legislative Finance  
Legislative Sponsor  
Requestor  
Office of Management and Budget  
Impacted Agency(ies)

RECEIVED

APR 6 1988

LEGISLATIVE FINANCE

SENATE COMMITTEE REPORT

FURTHER

DATE TURNED INTO OFFICE 2/16/88

2/16/88  
Mr. President:

Finance Committee considered SB 362

establishing the Dude Creek Critical Habitat Area

and recommended

replace with CS SB 362 (Ris)  same title  
 or adopt CS  new title

attached amendment(s) and

do pass

do not pass

no recommendation

individual recommendations

further referral to \_\_\_\_\_

letter of intent adopted \_\_\_\_\_

Committee  attached or  adopted fiscal note(s)

2  new  updated or  previous

<sup>DAR</sup><sub>FKG</sub>  zero  fiscal impact

MEMBERS SIGNING DO PASS

OTHER RECOMMENDATIONS

[Signature]  
[Signature]  
[Signature]  
[Signature]  
[Signature]

\_\_\_\_\_  
\_\_\_\_\_  
\_\_\_\_\_  
\_\_\_\_\_  
\_\_\_\_\_

[Signature] do pass  
Chairman signature and recommendation

Committee Backup attached

FISCAL NOTE

REQUEST:

Revision Date: \_\_\_\_\_  
Title: Nude Creek Critical Habitat Area  
Sponsor: Senator Eliason  
Requestor: Senate Finance

Agency Affected: Natural Resources  
BRU: Land and Water Management  
Components: \_\_\_\_\_

EXPENDITURES/REVENUES: (Thousands of Dollars)

OPERATING	FY 88	FY 89	FY 90	FY 91	FY 92	FY 93
PERSONAL SERVICES		0				
TRAVEL						
CONTRACTUAL						
SUPPLIES						
EQUIPMENT						
LAND & STRUCTURES						
GRANTS, CLAIMS						
MISCELLANEOUS						
TOTAL OPERATING		0				

CAPITAL						
---------	--	--	--	--	--	--

REVENUE						
---------	--	--	--	--	--	--

FUNDING: (Thousands of Dollars)

GENERAL FUND						
FEDERAL FUNDS						
OTHER						
TOTAL		0				

POSITIONS:

FULL-TIME						
PART-TIME						
TEMPORARY						

ANALYSIS : (Attach a separate page if necessary)

Legislative designation will not preclude this parcel from being appraised as part of the Mental Health Settlement. There may be some administrative savings because the public notice will be unnecessary; however, these savings will be less than \$100.

Prepared by: Janet Burleson Phone: 465-3400  
Division: Land and Water Management Date: 3/16/88

Approved by Commissioner: Judith M. Bur Date: \_\_\_\_\_  
Agency: Department of Natural Resources

Distribution (by preparer):  
Legislative Finance  
Legislative Sponsor  
Requestor  
Office of Management and Budget  
Impacted Agency(ies)

RECEIVED MAR 1 1988

STATE OF ALASKA  
1988 LEGISLATIVE SESSION

BILL VERSION: CSSB362 (Res.)  
PUBLISH DATE: \_\_\_\_\_

FISCAL NOTE

REQUEST:

Revision Date: \_\_\_\_\_  
Title: Dude Creek Critical Habitat  
Area  
Sponsor: Eliason  
Requestor: \_\_\_\_\_

Agency Affected: Department of Fish and Game  
BRU: Habitat  
Components: \_\_\_\_\_

EXPENDITURES/REVENUES: (Thousands of Dollars)

OPERATING	FY 88	FY 89	FY 90	FY 91	FY 92	FY 93
PERSONAL SERVICES		0				
TRAVEL		0				
CONTRACTUAL		0				
SUPPLIES		0				
EQUIPMENT						
LAND & STRUCTURES						
GRANTS, CLAIMS						
MISCELLANEOUS						
TOTAL OPERATING		0*				
CAPITAL						
REVENUE						

FUNDING: (Thousands of Dollars)

GENERAL FUND		0				
FEDERAL FUNDS						
OTHER		0				
TOTAL						

POSITIONS:

FULL-TIME						
PART-TIME						
TEMPORARY						

ANALYSIS : (Attach a separate page if necessary)

Preparation of the Dude Creek Critical Habitat Area Management Plan

Prepared by: Bruce H. Baker  
Division: Habitat Division

Phone: 465-4105  
Date: 3/10/88

Approved by Commissioner: Norman Olsen  
Agency: Department of Fish and Game

Date: 3/11/88

Distribution (by preparer): \*If existing schedule of one plan per year is adhered to, and no "date certain" is set for preparation of the Legislative Finance Dude Creek Management Plan, the operating budget would be Legislative Sponsor adequate. However, if two plans are to be prepared con- Requestor currently, the cost for the second 1 2 Office of Management and Budget plan would be 50.5. page of Impacted Agency(ies)

## Dude Creek Critical Habitat Area

-Preparation of the Dude Creek Critical Habitat Area Management Plan will take one year to complete and require the following expenses (in thousands) if conducted concurrently with preparation of any other critical habitat area management plan:

### Personnel

Habitat Biologist	(18c)	6 months	4.5/month	27.0
Game Biologist	(16c)	2 months	4.0/month	8.0
Drafting Tech.	(14d)	1 month	3.5/month	3.5
Clerk/Typist	( 8a)	1 month	2.3/month	2.3
				<u>\$40.8</u>

### Travel

Staff travel to Gustavus and Juneau	\$2.0
-------------------------------------	-------

### Contractual

Telephone	0.75/month x 12 months	0.9
Photocopy	0.10/month x 12 months	0.1
Advertising /public notices		1.0
Aerial photography		0.7
printing/ photographic/ blueprinting		4.0
		<u>\$ 6.7</u>

### Supplies

Office supplies	1.0
-----------------	-----

TOTAL	\$ 50.5
-------	---------

Original sponsor: Eliason

1 IN THE SENATE BY THE RESOURCES COMMITTEE

2 CS FOR SENATE BILL NO. 362 (Resources)

3 IN THE LEGISLATURE OF THE STATE OF ALASKA

4 FIFTEENTH LEGISLATURE - SECOND SESSION

5 A BILL

6 For an Act entitled: "An Act establishing the Dude Creek Critical Habitat  
7 Area; and providing for an effective date."

8 BE IT ENACTED BY THE LEGISLATURE OF THE STATE OF ALASKA:

9 \* Section 1. AS 16.20 is amended by adding a new section to read:

10 Sec. 16.20.610. DUDE CREEK CRITICAL HABITAT AREA. (a) The  
11 purpose of the Dude Creek Critical Habitat Area is the protection and  
12 enhancement of the wet meadow habitat that is the key roosting area  
13 for migrating lesser sandhill cranes, for the protection of lesser  
14 sandhill cranes, and for the continued public use and enjoyment of the  
15 area.

16 (b) The following described area is established as the Dude  
17 Creek Critical Habitat Area:

18 Township 40 South, Range 58 East, Copper River Meridian

19 Section 2: W1/2

20 Section 3

21 Sections 9 - 10

22 Section 11: W1/2NE1/4, W1/2

23 Section 14: Lot 3, NW1/4, N1/2SW1/4, SW1/4SW1/4

24 Section 15

25 Section 16: N1/2, SE1/4

26 (c) The Dude Creek Critical Habitat Area described in (b) of  
27 this section shall be managed under a management plan prepared by the  
28 department in consultation with the community of Gustavus and approved  
29 by the Board of Game.

1           (d) The department shall permit public access, grazing, firewood  
2 harvesting, wildlife viewing, hiking, and berry picking under the  
3 management plan adopted under (c) of this section to the extent that  
4 the activities are compatible with the purpose for which the Dude  
5 Creek Critical Habitat Area was established.

6           (e) The legislature understands that a portion of the state land  
7 described in (b) of this section is mental health trust land of the  
8 state and the legislature intends that the land retain its status as  
9 mental health trust land, notwithstanding its inclusion in the Dude  
10 Creek Critical Habitat Area.

11 \* Sec. 2. This Act takes effect immediately under AS 01.10.070(c).

ALASKA STATE LEGISLATURE . SENATE

SENATOR RICHARD I. ELIASON



RULES COMMITTEE, CHAIRMAN  
LABOR & COMMERCE COMMITTEE, VICE-CHAIRMAN  
LEGISLATIVE COUNCIL  
RESOURCES COMMITTEE  
FISHERIES SUBCOMMITTEE, CHAIRMAN

P.O. BOX 143  
SITKA, ALASKA 99835  
P.O. BOX V  
JUNEAU, ALASKA 99811  
(907) 465-4916

M E M O R A N D U M

TO: Senator Rick Halford, co-chair  
Senator John Binkley, co-chair  
Senate Finance Committee

FROM: Senator Dick Eliason *Dick Eliason*

RE: CSSB 362 (Res) - An Act establishing the Dude Creek  
Critical Habitat Area

DATE: February 24, 1988

I would appreciate your consideration in scheduling CSSB 362 (Res) for a hearing before the Senate Finance Committee at the earliest possible time.

CSSB362 (Res) establishes the Dude Creek Critical Habitat area near Gustavus. This legislation is a direct response to a request from the residents of Gustavus. In January, 1984, the community of Gustavus overwhelming passed a referendum requesting the establishment of a critical habitat area for the protection and enhancement of a key roosting area for migrating Lesser Sandhill Cranes.

In 1985 similar legislation passed the House unanimously, but as the majority of the land in question was mental health trust land, the Senate decided to delay action on the legislation until an equitable solution to the trust land issue was found. Passage of Chapter 48, SLA 1987, provided the answer. Under the enactment of this law, 3,443 acres of mental health trust land located within the proposed critical habitat area will remain in the mental health trust corpus and the Department of Natural Resources will not need to find replacement lands for this acreage. George Rogers, chairman, Interim Mental Health Trust Commission, supports the passage of SB 362.

The designation of a critical habitat area would allow all traditional uses of the land while providing wildlife habitat protection.

# Gustavus Community Association

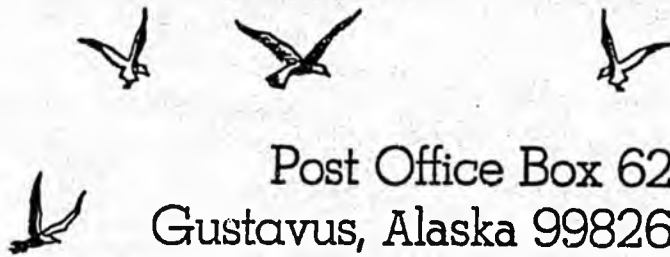

Post Office Box 62  
Gustavus, Alaska 99826

January 27, 1988

Senator Dick Eliason  
Poueh V  
Juneau, AK 99801

Dear Senator Eliason,

With the settling of the mental health land issue, the way again seems clear for CSHB 312, the bill for an act to establish the Dude Creek Critical Habitat Area.

I would like to take this opportunity to encourage your support for this bill. Work was begun toward the possibility of the critical habitat designation in 1978 and through a lengthy process of negotiation and compromise a proposal was reached that does meet the needs and wishes of most people.

The community demonstrated majority support for this bill in January, 1984, in a referendum ballot polling every registered voter. The response was 66 in favor and 25 opposed. In 1985, the Gustavus Community Association endorsed the bill.

The critical habitat designation would allow all traditional uses of the land to continue, i.e., hunting, fishing, clamming, berry picking, collection of beach logs, kelping, grazing, hiking and use of recreational vehicles, while providing enduring wildlife habitat protection.

Thank you for your consideration.

Best regards,  
*Dan Mills*  
Dan Mills  
President

DM/an

# STATE OF ALASKA

## DEPARTMENT OF NATURAL RESOURCES

OFFICE OF THE COMMISSIONER

STEVE COWPER, GOVERNOR

POUCH M  
JUNEAU, ALASKA 99811  
PHONE: 907-465-2400

February 1, 1988

Senator Richard I. Eliason  
P.O. Box V  
Juneau, Alaska 99811

Dear Senator Eliason:

I am pleased to inform you that the Interim Mental Health Trust Commission (IMHTC) is able to support the passage of SB 362- establishing the Dude Creek Critical Habitat Area. This support was made possible through the enactment of ch. 48 SLA 1987. Should SB 362 become law prior to the reconstitution of the mental health trust corpus, the work of the DNR and the IMHTC will be reduced by leaving 3,443 acres more of the original trust land in the reconstituted trust corpus than would be if it is not passed.

If I can be of further assistance please feel free to contact me.

Sincerely,



George Rogers, Chairman  
Interim Mental Health Trust Commission

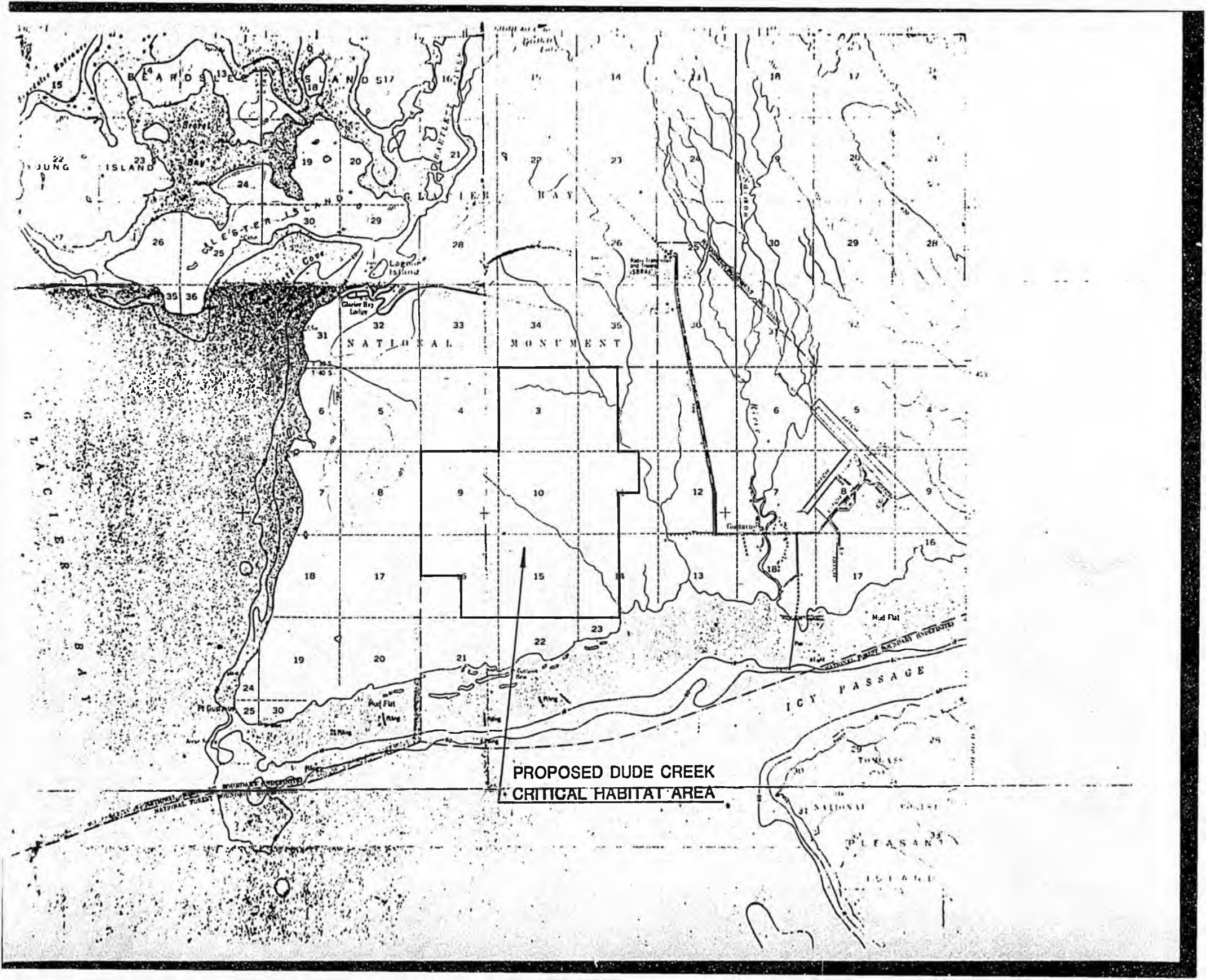

Senator Dick Eliason  
Alaska State Legislature  
Pouch V  
Juneau, AK 99811

Dear Senator Eliason,

In January, 1984, a referendum (enclosure 1) was sent to all registered Gustavus voters, asking whether they favored creation of a 4100-acre Critical Habitat Area to protect migrating sandhill cranes. This capped a two-year community effort to research the need for protection and the various protective options available. About 180 ballots were sent out; 91 people chose to vote; 66 favored the proposal and 25 opposed it.

A committee of Gustavus residents was then formed to act on this mandate. In consultation with Debra Clausen, ADF&G, Habitat Division, we developed a package of background information (enclosure 2), a proposed draft of enabling legislation (enclosure 3), and a boundary map (enclosure 4). This material has now been displayed at the post office for several weeks, and to date we have received no adverse comment on it. We hope that you and Representative Goll will now begin the process of enactment into law.

In the course of our work on the crane issue, three clearcut community opinions have emerged. First, there is strong sentiment in favor of crane protection. Second, people favor the idea of a Critical Habitat if the community is fully involved in preparing legislation and management plan. And third, many feel that human use should be regulated only to the extent necessary. In particular, the following public uses and activities should be allowed: wildlife viewing, firewood harvesting, mechanical and non-mechanical access, hiking, berry picking, and grazing, unless such activities are documented to be detrimental to the migrating sandhill cranes or their habitat.

There is general agreement that present use types and amounts are not threatening the cranes or their habitat in the area proposed for legislative action. The protective effort was begun because cranes have been substantially excluded from other parts of Gustavus and could be eliminated throughout if future use and development proceed in an unplanned fashion.

Lloyd Prouty, Debbie Woodruff, Morgan DeBoer and I will be glad to provide further information or assist in any way you wish.

Sincerely,

Greg Streveler, Chairman  
"Crane Committee"

Box 94  
Gustavus 99826

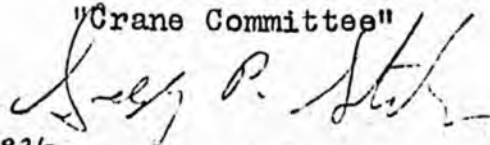

Gustavus Community Association Referendum JANUARY, 1984

Established two years ago, the referendum was initiated to sample the opinions of the whole community, that is the registered voters of this election district. While not legally binding it is nonetheless recognized by the State of Alaska as a valid polling device.

Those responding are requested to return the completed referendum questions no later than Feb. 5th by mailing them to Box 62 Gustavus, AK 99826.

\*\*\*\*\*

I. Road Maintenance-

Fact: In 1983 the Alaska State Legislature appropriated \$115,000 to upgrade Tong Road, Same Old Road, Salmon River Road and Rink River Road. An additional 27 thousand dollars was appropriated which was not used. The question arises on whether or not to spend this money for the maintenance of existing roads or upgrading other roads or returning the money to the state. Since receiving this request for this referendum, solicited legal opinion states that the GCA can be held liable for damages incurred as a result of this recent upgrade or any future maintenance or improvements to the roads or the Goode River Bridge.

Question:

1. The \$27,000 should be used for maintaining the four recently upgraded roads. Yes No
2. The \$27,000 should be used to upgrade other local access roads. Yes No
3. The \$27,000 should be used to hire a professional engineer to inspect the recently upgraded roads and to pay for any necessary corrections for safety, therefore minimizing liability to GCA. Yes No
4. The \$27,000 should be returned to the State. Yes NO

Pro Statement:

The \$27,000 could be used for several years to maintain local access roads, including snow removal. It has been estimated that it would cost somewhere between \$3,000 and \$6,000 a year to maintain these local access roads.

Winter snow removal would allow access year round and would allow the Fire Department and EMTs to respond to fire and medical emergencies. Pot holes could be filled in the spring and the roads could be graded throughout the spring.

Con Statement:

The acceptance of the \$27,000 will put the community in the road maintenance business while the intent of the \$115,000 was to bring the roads up to standard. Acceptance establishes a precedent for other new roads that will be built, with the community expected to maintain them. This also represents another step in our inertia towards local government, and if and when Gustavus incorporated road maintenance and liability costs would be substantial.

## II. Jetfoil Service-

Fact: In early December of 1983, representatives from Boeing Marine and the State Division of Marine Transportation met with the community, informing residents of their plan to bring jetfoil service to Gustavus. Plans called for a 240 passenger boat coming once a week with a 40 lb. baggage limit at a price of \$30 on a test basis for the summer of '84, with alterations planned for the existing float. In response to protest expressed at the meeting the state agreed to postpone service until the question was put to the community in the form of a referendum. (P.S. On 12/13/83, a phonecall was received from DOT stating they could not wait for results of this referendum to do their schedule and therefore

Question: were removing Gustavus from the 1984 summer route. The GCA would still like your opinion on this matter so please answer the question.

1. Should the State of Alaska bring jetfoil service to the community of Gustavus? Yes  No

### Pro Statement:

Jetfoil service would provide a cheaper means of transportation and would thus enable more people to visit who would spend tourist dollars in our community. Other communities would be more accesible and may lead to full-time ferry service, which would allow increased freight and vehicular services. This would be an alternative for those who do not like to fly.

### Con Statement:

The community has repeatedly petitioned against regular ferry service in the past and jetfoil service represents the same. Alterations to the existing float could possibly imperil local usage and existing barge service. There are no existing facilities to handle a large influx of visitors and subsequent impact could be substantial and detrimental to the community.

## III. Dude Creek Meadows Protection-

Fact: In May of 1983 a questionnaire was sent to the registered voters of Gustavus asking if the sandhill cranes which, during migration, feed and rest along Dude Creek be given some sort of protection. Eighty-one percent of those questioned replied "yes." A committee was established to research the options available for protecting sandhill cranes and recommended the Community Association request the state legislature through Fish and Game, establish some 4,000 acres along Dude Creek as sandhill crane critical habitat.

### Question:

- (Option 1) See Map
1. Should approximately 4,000 acres, paralleling Dude Creek be designated as 'critical habitat' for the sandhill crane? 36 Yes  No 25
2. If "no", would you support inclusion of only the area west of Dude Creek (Option 2), or some other type of protection other than "critical habitat" ?
- Yes No Specify \_\_\_\_\_

Pro Statement:

The setting aside of approximately 4,000 acres of Gustavus wetlands for a critical habitat designation for the approximately 7,000 sandhill cranes who rest and feed annually in the Dude Creek meadows signifies the commitment to the well-being of a particular species of waterfowl. Boundaries protect only the areas most heavily used by the cranes. All traditional uses such as hunting, trapping, firewood harvest and all-terrain vehicle use will continue as long as they do not interfere with the species. The area would serve for perpetuity as a recreational area. Community input on the area's management can be very strong if we help write the legislation and management plan.

Con Statement:

Because Gustavus is already surrounded by 2 million acres of Park, any lands restricted for use within our community would only hinder further growth and is merely an attempt to lock up more of our state. Agricultural and recreational uses may be restricted by Fish & Game and/or "environmental concerns" and others who may not be truly in touch with our needs - this could be dangerous. To lock up lands used only a couple months a year by the cranes, and likely to change by natural succession is unwise.

Icy Passage

Beach

Park Boundary

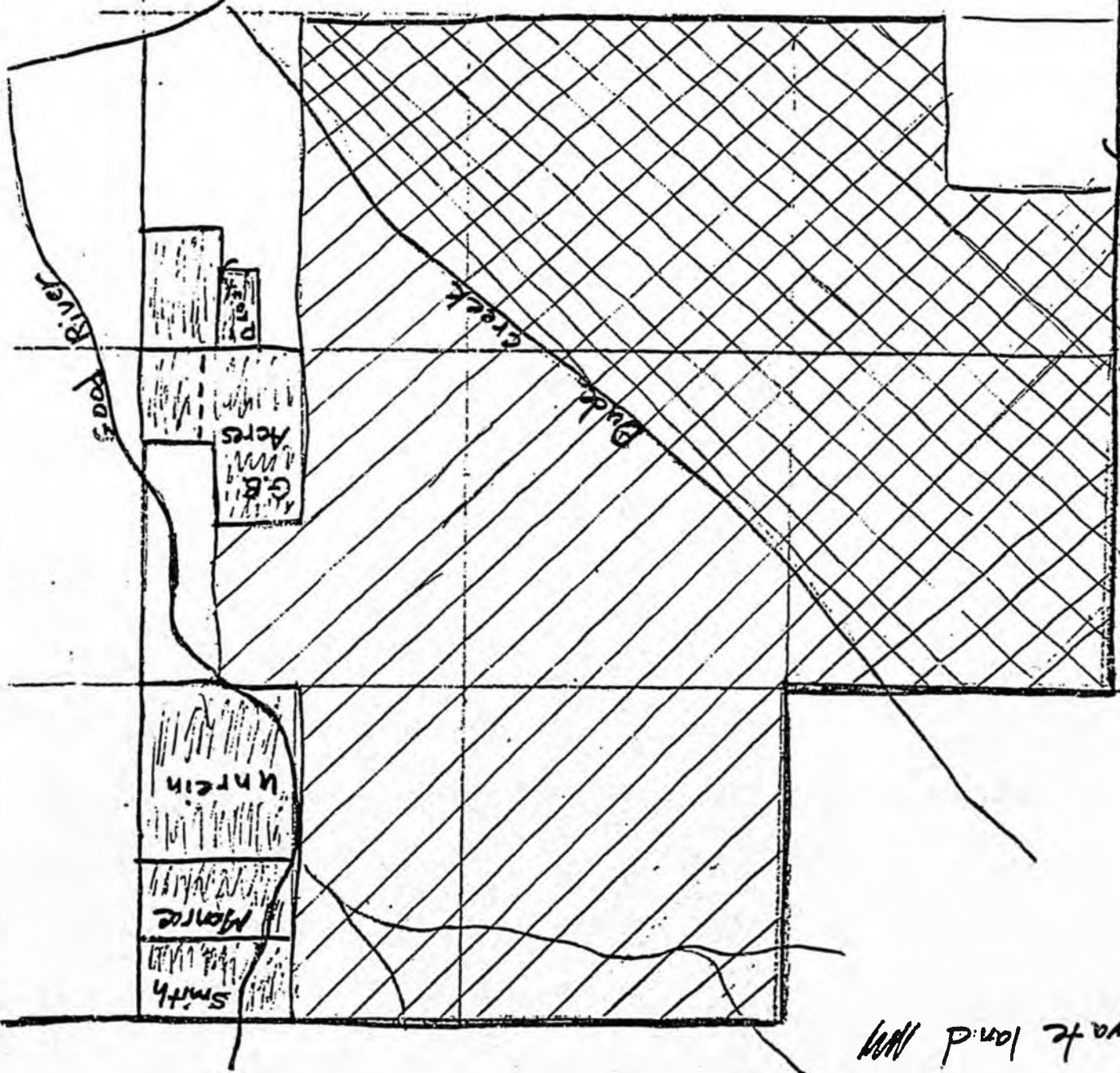

option 1  about 4100 acres

option 2  about 1800 acres

private land  NW

DUDE CREEK CRITICAL HABITAT AREA

Letter of Intent

It is the intent of the Senate Resources Committee that surface vegetation and soils be maintained to preserve the wetlands nature of the critical habitat area and provide protection to migrating Lesser Sandhill Cranes.

In creating the Dude Creek Critical Habitat Area, the Senate Resources Committee also intends that hunting, fishing, and trapping activities will continue to occur in accordance with harvest regulations as established by the Boards of Fisheries and Game. The following public uses and activities: wildlife viewing; firewood harvesting; mechanized and non-mechanized access; hiking; berry picking; and grazing will be allowed to the extent that they are compatible with the purpose for which the area is established. The Department of Fish and Game will conduct specific fact finding, including public hearings in Gustavus, prior to making final determination of the compatibility of above uses.

The Department of Fish and Game is to consult with the community of Gustavus in the preparation and implementation of a management plan for the Dude Creek Critical Habitat Area. In the event that the community forms an Advisory Committee, the department will work closely with that committee in preparation of the plan.



STATE OF ALASKA  
OFFICE OF THE GOVERNOR  
**BILL ANALYSIS**

DEPARTMENT Fish and Game	DIVISION Habitat	BILL NUMBER CSSB362 (Res.)	SPONSOR Eliason
SHORT TITLE OF BILL Dude Creek Critical Habitat Area			
DEPARTMENT POSITION Support			
PREPARED BY Bruce H. Baker <i>Bruce H. Baker</i>	DATE 2/24/88	COMMISSIONER'S SIGNATURE <i>Chick Williams</i>	DATE 2-28-88

**SUMMARY**

OTHER AGENCIES AFFECTED BY BILL Department of Natural Resources	CONSTITUENT GROUP(S) AFFECTED BY BILL Community of Gustavus
ORGANIZATIONAL SUPPORT FOR BILL Community of Gustavus	ORGANIZATIONAL OPPOSITION TO BILL None known

FISCAL IMPACT:  NONE  FISCAL NOTE ATTACHED

BACKGROUND/LEGISLATIVE INTENT

The purpose of establishing the Dude Creek Critical Habitat Area is to protect and enhance the wet meadow habitat that is the key roosting area for migrating lesser sandhill cranes, to protect lesser sandhill cranes, and for the continued public use and enjoyment of the area.

ANALYSIS OF BILL/PROGRAM EFFECTS

1. Establishes the Dude Creek Critical Habitat Area.
2. Identifies the purpose for which the area is established.
3. Provides for the management of the Dude Creek Critical Habitat Area including the development of a management plan.
4. Clarifies the status of mental health lands in the Dude Creek Critical Habitat Area.

AMENDMENTS PROPOSED

None

PLEASE ATTACH A SEPARATE SHEET FOR ADDITIONAL COMMENTS OR ANALYSIS.

Removed from  
members' files  
and replaced with  
updated note.

STATE OF ALASKA  
1988 LEGISLATIVE SESSION

BILL VERSION: CS SB362 (Rev)  
PUBLISH DATE: 2-16-88

2/15/88  
S(LS)  
Han Fin

B

FISCAL NOTE

REQUEST:

Revision Date: \_\_\_\_\_  
Title: Dude Creek Critical Habitat  
Area  
Sponsor: \_\_\_\_\_  
Requestor: \_\_\_\_\_

Agency Affected: Department of Fish and Game  
BRU: Habitat Division

Components: \_\_\_\_\_

EXPENDITURES/REVENUES: (Thousands of Dollars)

OPERATING	FY 88	FY 89	FY 90	FY 91	FY 92	FY 93
PERSONAL SERVICES		\$40,800				
TRAVEL		2,000				
CONTRACTUAL		6,720				
SUPPLIES		1,000				
EQUIPMENT						
LAND & STRUCTURES						
GRANTS, CLAIMS						
MISCELLANEOUS						
TOTAL OPERATING		\$50,520*				

CAPITAL						
---------	--	--	--	--	--	--

REVENUE						
---------	--	--	--	--	--	--

FUNDING: (Thousands of Dollars)

GENERAL FUND		\$50,520				
FEDERAL FUNDS						
OTHER		\$50,520				
TOTAL						

POSITIONS:

FULL-TIME						
PART-TIME						
TEMPORARY						

ANALYSIS : (Attach a separate page if necessary)

Preparation of the Dude Creek Critical Habitat Area Management Plan

FEB 13 1988

Prepared by: Bruce H. Baker  
Division: Habitat Division

Phone: 465-4105  
Date: 2/12/88

Approved by Commissioner: Han W. Hill FOR  
Agency: Department of Fish and Game

Date: 2/12/88

Distribution (by preparer): \*Amount required if two plans are prepared concurrently.  
Legislative Finance If existing schedule of one plan per year is adhered to,  
Legislative Sponsor the operating budget would be adequate and this fiscal  
Requestor note would not be necessary.  
Office of Management and Budget  
Impacted Agency(ies)

SB 362

## Dude Creek Critical Habitat Area

-Preparation of the Dude Creek Critical Habitat Area Management Plan will take one year to complete and require the following expenses:

### Personnel

Habitat Biologist	(18c)	6 months	4500/month	27,000
Game Biologist	(16c)	2 months	4000/month	8,000
Drafting Technician	(14d)	1 month	3500/month	3,500
Clerk/Typist	( 8a)	1 month	2300/month	2,300
				<u>\$40,800</u>

### Travel

Staff travel to Gustavus and Juneau				2,000
-------------------------------------	--	--	--	-------

### Contractual

Telephone	75/month x 12 months	900
Photocopy	10/month x 12 months	120
Advertising /public notices		1,000
Aerial photography		700
Printing/photographic/blueprinting		<u>4,000</u>
		<u>\$6,720</u>

### Supplies

Office supplies		1,000
-----------------	--	-------

TOTAL		\$50,520
-------	--	----------



STATE OF ALASKA  
OFFICE OF THE GOVERNOR  
BILL ANALYSIS

DEPARTMENT Fish and Game	DIVISION Habitat	BILL NUMBER SB362	SPONSOR Eliason
SHORT TITLE OF BILL Dude Creek Critical Habitat Area			
DEPARTMENT POSITION Support			
PREPARED BY Bruce H. Baker	DATE 2/12/88	COMMISSIONER'S SIGNATURE <i>Wm. H. Delany FOR D. Callinsworth</i>	DATE 2/12/88

SUMMARY

OTHER AGENCIES AFFECTED BY BILL Department of Natural Resources	CONSTITUENT GROUP(S) AFFECTED BY BILL Community of Gustavus
ORGANIZATIONAL SUPPORT FOR BILL Community of Gustavus	ORGANIZATIONAL OPPOSITION TO BILL None known

FISCAL IMPACT:  NONE  FISCAL NOTE ATTACHED

BACKGROUND/LEGISLATIVE INTENT

The purpose of establishing the Dude Creek Critical Habitat Area is to protect and enhance the wet meadow habitat that is the key roosting area for migrating lesser sandhill cranes, to protect lesser sandhill cranes, and for the continued public use and enjoyment of the area.

ANALYSIS OF BILL/PROGRAM EFFECTS

1. Establishes the Dude Creek Critical Habitat Area.
2. Identifies the purpose for which the area is established.
3. Provides for the management of the Dude Creek Critical Habitat Area including the development of a management plan.
4. Clarifies the status of mental health lands in the Dude Creek Critical Habitat Area.

AMENDMENTS PROPOSED

Clarifying amendments:

The purpose statement should appear in statute, therefore, it should have a statute number, probably AS 16.20.610(b).

A final section should be added which states, "This Act takes effect immediately under AS 01.10.070(c)."

**FISCAL NOTE**

**REQUEST:**

Revision Date: \_\_\_\_\_  
Title: Dude Creek Critical Habitat  
Area  
Sponsor: Eliason  
Requestor: \_\_\_\_\_

Agency Affected: Department of Fish and Game  
BRU: Habitat  
Components: \_\_\_\_\_

**EXPENDITURES/REVENUES: (Thousands of Dollars)**

OPERATING	FY 88	FY 89	FY 90	FY 91	FY 92	FY 93
PERSONAL SERVICES		\$40.8				
TRAVEL		2.0				
CONTRACTUAL		6.7				
SUPPLIES		1.0				
EQUIPMENT						
LAND & STRUCTURES						
GRANTS, CLAIMS						
MISCELLANEOUS						
<b>TOTAL OPERATING</b>		<b>50.5*</b>				

CAPITAL						
---------	--	--	--	--	--	--

REVENUE						
---------	--	--	--	--	--	--

**FUNDING: (Thousands of Dollars)**

GENERAL FUND		50.5				
FEDERAL FUNDS						
OTHER		50.5				
<b>TOTAL</b>						

**POSITIONS:**

FULL-TIME						
PART-TIME						
TEMPORARY						

**ANALYSIS :** (Attach a separate page if necessary)

Preparation of the Dude Creek Critical Habitat Area Management Plan

Prepared by: Bruce H. Baker Phone: 465-4105  
Division: Habitat Division Date: 2/25/88

Approved by Commissioner: *Maurice H. Willy* Date: \_\_\_\_\_  
Agency: Department of Fish and Game

Distribution (by preparer): \*Amount required if two plans are prepared concurrentl  
Legislative Finance If existing schedule of one plan per year is adhered to,  
Legislative Sponsor the operating budget would be adequate and this fiscal  
Requestor note would not be necessary.  
Office of Management and Budget  
Impacted Agency(ies)

## Dude Creek Critical Habitat Area

-Preparation of the Dude Creek Critical Habitat Area Management Plan will take one year to complete and require the following expenses (in thousands):

### Personnel

Habitat Biologist	(18c)	6 months	4.5/month	27.0
Game Biologist	(16c)	2 months	4.0/month	8.0
Drafting Tech.	(14d)	1 month	3.5/month	3.5
Clerk/Typist	( 8a)	1 month	2.3/month	2.3
				<hr/>
				\$40.8

### Travel

Staff travel to Gustavus and Juneau	\$2.0
-------------------------------------	-------

### Contractual

Telephone	0.75/month x 12 months	0.9
Photocopy	0.10/month x 12 months	0.1
Advertising /public notices		1.0
Aerial photography		0.7
printing/ photographic/ blueprinting		4.0
		<hr/>
		\$ 6.7

### Supplies

Office supplies	1.0
TOTAL	\$ 50.5



STATE OF ALASKA  
OFFICE OF THE GOVERNOR

BILL ANALYSIS

DEPARTMENT Fish and Game	DIVISION Habitat	BILL NUMBER CSSB362 (Res.)	SPONSOR Eliason
SHORT TITLE OF BILL Dude Creek Critical Habitat Area			
DEPARTMENT POSITION Support			
PREPARED BY Bruce H. Baker <i>Bruce H. Baker</i>	DATE 2/24/88	COMMISSIONER'S SIGNATURE <i>Chick Williams</i>	DATE 2-28-88

SUMMARY

OTHER AGENCIES AFFECTED BY BILL Department of Natural Resources	CONSTITUENT GROUP(S) AFFECTED BY BILL Community of Gustavus
ORGANIZATIONAL SUPPORT FOR BILL Community of Gustavus	ORGANIZATIONAL OPPOSITION TO BILL None known

FISCAL IMPACT:  NONE  FISCAL NOTE ATTACHED

BACKGROUND/LEGISLATIVE INTENT

The purpose of establishing the Dude Creek Critical Habitat Area is to protect and enhance the wet meadow habitat that is the key roosting area for migrating lesser sandhill cranes, to protect lesser sandhill cranes, and for the continued public use and enjoyment of the area.

ANALYSIS OF BILL/PROGRAM EFFECTS

1. Establishes the Dude Creek Critical Habitat Area.
2. Identifies the purpose for which the area is established.
3. Provides for the management of the Dude Creek Critical Habitat Area including the development of a management plan.
4. Clarifies the status of mental health lands in the Dude Creek Critical Habitat Area.

AMENDMENTS PROPOSED

None

PLEASE ATTACH A SEPARATE SHEET FOR ADDITIONAL COMMENTS OR ANALYSIS.

1 IN THE SENATE

BY ELIASON

2

SENATE BILL NO. 362

3

IN THE LEGISLATURE OF THE STATE OF ALASKA

4

FIFTEENTH LEGISLATURE - SECOND SESSION

5

A BILL

6 For an Act entitled: "An Act establishing the Dude Creek Critical Habitat  
7 Area."

8 BE IT ENACTED BY THE LEGISLATURE OF THE STATE OF ALASKA:

9 \* Section 1. PURPOSES. The purpose of the Dude Creek Critical Habitat  
10 Area is the protection and enhancement of the wet meadow habitat that is  
11 the key roosting area for migrating lesser sandhill cranes, for the protec-  
12 tion of lesser sandhill cranes, and for the continued public use and enjoy-  
13 ment of the area.

14 \* Sec. 2. AS 16.20 is amended by adding a new section to read:

15 Sec. 16.20.610. DUDE CREEK CRITICAL HABITAT AREA. (a) The  
16 following described area is established as the Dude Creek Critical  
17 Habitat Area:

18 Township 40 South, Range 58 East, Copper River Meridian

19 Section 2: W1/2

20 Section 3

21 Sections 9 - 10

22 Section 11: W1/2NE1/4, W1/2

23 Section 14: Lot 3, NW1/4, N1/2SW1/4, SW1/4SW1/4

24 Section 15

25 Section 16: N1/2, SE1/4

26 (b) The Dude Creek Critical Habitat Area described in (a) of  
27 this section shall be managed under a management plan prepared by the  
28 department in consultation with the community of Gustavus and approved  
29 by the Board of Game.

1           (c) The department shall permit public access, grazing, firewood  
2 harvesting, wildlife viewing, hiking, and berry picking under the  
3 management plan adopted under (b) of this section to the extent that  
4 the activities are compatible with the purpose for which the Dude  
5 Creek Critical Habitat Area was established.

6           (d) The legislature understands that a portion of the state land  
7 described in (a) of this section is mental health trust land of the  
8 state and the legislature intends that the land retain its status as  
9 mental health trust land, notwithstanding its inclusion in the Dude  
10 Creek Critical Habitat Area.

1 IN THE SENATE

BY ELIASON

2

SENATE BILL NO. 362

3

IN THE LEGISLATURE OF THE STATE OF ALASKA

4

FIFTEENTH LEGISLATURE - SECOND SESSION

5

A BILL

6

For an Act entitled: "An Act establishing the Dude Creek Critical Habitat Area."

7

8

BE IT ENACTED BY THE LEGISLATURE OF THE STATE OF ALASKA:

9 \* Section 1. PURPOSES. The purpose of the Dude Creek Critical Habitat  
10 Area is the protection and enhancement of the wet meadow habitat that is  
11 the key roosting area for migrating lesser sandhill cranes, for the protec-  
12 tion of lesser sandhill cranes, and for the continued public use and enjoy-  
13 ment of the area.

14 \* Sec. 2. AS 16.20 is amended by adding a new section to read:

15 Sec. 16.20.610. DUDE CREEK CRITICAL HABITAT AREA. (a) The  
16 following described area is established as the Dude Creek Critical  
17 Habitat Area:

18 Township 40 South, Range 58 East, Copper River Meridian

19 Section 2: W1/2

20 Section 3

21 Sections 9 - 10

22 Section 11: W1/2NE1/4, W1/2

23 Section 14: Lot 3, NW1/4, N1/2SW1/4, SW1/4SW1/4

24 Section 15

25 Section 16: N1/2, SE1/4

26 (b) The Dude Creek Critical Habitat Area described in (a) of  
27 this section shall be managed under a management plan prepared by the  
28 department in consultation with the community of Gustavus and approved  
29 by the Board of Game.

1           (c) The department shall permit public access, grazing, firewood  
2 harvesting, wildlife viewing, hiking, and berry picking under the  
3 management plan adopted under (b) of this section to the extent that  
4 the activities are compatible with the purpose for which the Dude  
5 Creek Critical Habitat Area was established.

6           (d) The legislature understands that a portion of the state land  
7 described in (a) of this section is mental health trust land of the  
8 state and the legislature intends that the land retain its status as  
9 mental health trust land, notwithstanding its inclusion in the Dude  
10 Creek Critical Habitat Area.

SENATE COMMITTEE REPORT

FIRST COMMITTEE OF REFERRAL

Date of 5-1 5-DAY NOTICE  
IN ACCORDANCE WITH UNIFORM RULE 23

FURTHER: Finance

\*\*FISCAL NOTE(S) ATTACHED  \*\*  
IN ACCORDANCE WITH AS 24.08.035  
(see below)

1/21/88  
Mr. President:

DATE TURNED INTO OFFICE \_\_\_\_\_

Resources \_\_\_\_\_ Committee considered SB 362

establishing the Dude Creek Critical Habitat Area

and recommended:

replace with CS SB 362 (res) ~~same title~~  
 attached and maj. do pass amendment(s) and  new title

do pass

do not pass

no recommendation

individual recommendations

further referral to \_\_\_\_\_

letter of intent adopted and attached

\*\* Committee  attached or  adopted fiscal note(s)  
 zero  fiscal impact

MEMBERS SIGNING DO PASS

OTHER RECOMMENDATIONS

[Signature]  
[Signature]  
[Signature]  
[Signature]

\_\_\_\_\_  
\_\_\_\_\_  
\_\_\_\_\_  
\_\_\_\_\_

[Signature]  
Chairman signature and recommendation

Committee Backup Attached