

LEG. FINANCE - BILLS 1983 - 1984 2005

SB 18 cont. - SB 19 2005

ALASKA TELETYPE UNIT 150730 12 027 1700

Northwest Arctic School District

BOX 51,  
KOTZEBUE, ALASKA 99752  
(907) 442-3472

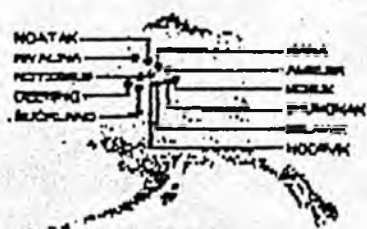

March 29, 1983

Senator Frank R. Ferguson  
Alaska State Senate  
Pouch V  
Juneau, Alaska 99811

Dear Frank:

In response to Mike's telephone call of March 29, 1983, enclosed is the information he requested concerning the Ambler Elementary/Secondary Upgrade Addition, Selawik Multi-purpose Addition, Deering Classrooms and Buckland Classrooms.

If you need additional information, please contact me at your convenience.

Sincerely,

John L. Rogers  
Assistant Superintendent:  
Administrative Services

JLR/isj  
Enclosures: as stated

90745537007-3

Ambler Elem/Sec Upgrade and Addition

This is a consolidation of many project requests at Ambler School.

1. Ambler High School Industrial Education/Storage addition:

This project would encompass an Industrial Education shop addition, appropriate storage facilities and the remodeling of the existing shop into a general purpose classroom. Said project would provide a physical component of sufficient size to conduct a meaningful shop program and provide a general purpose classroom to house academic classes which are presently being conducted in the gym area.

The new classroom and storage addition would be 1,400 square feet of classroom space and 500 square feet of storage space and 200 square feet of miscellaneous space for hallways, mechanical, (etc.) Estimated cost is \$217.00/square foot.

2. General Purpose Storage Addition:

This project would enclose the gym thus creating 2 secure storage areas. At the present time the building only has 338 square feet of storage which has resulted in multi items being stored in classrooms and other non secured areas with a subsequent disruption of classroom activities and loss of materials and supplies.

Existing square footage that is not suitable by code for instructional purpose.

The estimated cost of this remodel is \$ 16.00/square foot.

3. Elementary School Facilities Upgrade:

The insulation of hot water pipes in the classroom, replacement of defective obsolete exterior windows, repair of a substantial roof leak and painting of the exterior of the building, reduce future expenditures and create a physical environment that is more conducive to learning.

This is not a request for additional square footage. This is a request to maintain the existing building. Estimated cost \$11.00/square foot.

4. Air Handling System Modification:

The elementary school presently has no mechanical provisions for air changing which results in the teachers resorting to opening and closing the windows. This causes a substantial heat loss as well as a negative effect on the children due to a lack of proper air circulation and drafts when the windows are opened. The installation of a heat exchanger would substantially reduce the heat to preheat incoming air resulting in a significant fuel savings and greater system functionality.

Again this is not a request for additional space. This is renovation of the existing Elementary School. Estimated cost \$ 14.00/square foot.

5. High School Facility Upgrade:

The insulation of hot water pipes and replacement of the oil fired cook stove will both save operating costs and significantly reduce the generation of excessive heat (kitchen) which is having a very detrimental effect on the kitchen personnel.

There is no cost/square footage calculation for this because the major expenditure would be for equipment.

6. Emergency Power Upgrade:

The installation of an automatic transfer panel and new diesel generator will enable both schools to be run off the same generator and will eliminate freeze-ups and motors burning out due to power fluctuations and outages. This will substantially reduce maintenance costs and frequency of schools closures due to the above.

Because the major expenditure for this project is equipment to be used by both the elementary and high school, the estimated cost is based upon the square footage of both buildings. Estimated cost \$18.00/square foot.

### Selawik Multi-purpose Addition

At the present time the high school gym serves as a multi-purpose room/cafeteria for grades K-12 due to the high educational needs and low instruction space availability. As a result students are forced to eat in this area at times corresponding with physical ed/recreation activities which is hazardous to their physical well being. This project would enclose an adjoining porch area and convert it to multi-purpose room/cafeteria which would be used for elementary physical ed. classes when the gym was for high school classes large group instruction and student dining.

This project would renovate the existing deck at the Selawik High School. It would increase usable space at this school by approximately 2201 square feet. Estimated cost \$241.00/square foot.

### Deering Elementary Classrooms

The present Deering Elementary building simply cannot accommodate the program. It consists of two old buildings which do not have adequate square footage to house the students in accordance with Department of Education Guidelines. These buildings do not meet State Building codes as required for school facilities.

This addition or new facility would provide 3 additional classrooms at approximately 600 square feet each for the elementary program, and 1,200 square feet of supplementary space for a small library, mechanical room, rest rooms (etc.) Estimate cost \$300.00 per square foot.

A break down of square footage costs are:

|  |                      |
|--|----------------------|
| Architectural-Administration               | \$45.00/square foot  |
| Construction                               | \$204.00/square foot |
| Equipment                                  | \$22.00/square foot  |
| Miscellaneous (Art in Public Places, ect.) | \$29.00/square foot  |

Buckland Elementary Classrooms.

The present Buckland Elementary building simply cannot accommodate the program. Life safety and general upgrade of facility cost would be high enough to justify new construction.

This addition or new facility would provide 3 additional classrooms at approximately 600 square feet each for the elementary program and 1,200 square feet of supplementary space for a small library, mechanical room, rest rooms, (etc.) Estimate cost \$300.00 per square foot.

A break down of square footage costs are:

|  |                      |
|--|----------------------|
| Architectural-Administration-----          | \$45.00/square foot  |
| Construction-----                          | \$204.00/square foot |
| Equipment-----                             | \$22.00/square foot  |
| Miscellaneous (Art in Public Places, ect.) | \$29.00/square foot  |

DISTRICT N.W.A.S.D. SCHOOL Andler Elementary School

K-6 39 7-8 \_\_\_\_\_ 9-12 \_\_\_\_\_  
 DESIGN ENROLLMENT PROJECT NAME Elementary School Facility Upgrade

PROJECT TYPE  NEW CONSTRUCTION  HEALTH OR LIFE SAFETY  
 ADDITION  UNHOUSED STUDENTS  
 REMODELING  PROTECTION OF STRUCTURE  
 REPLACEMENT  FUNCTIONAL UPGRADE  
 MAJOR MAINTENANCE  CODE UPGRADE  
 UTILITIES  OPERATING COST SAVINGS  
 OTHER  OTHER

CONSTRUCTION START June 83. COMPLETION DATE June 84

PROJECT ESTIMATED TO  INCREASE  DECREASE DISTRICT OPERATING BUDGET \$ 1,000

SCHOOL SITE:  EXISTING OR  NEW SITE; IF NEW, ACQUISITION COST \$ \_\_\_\_\_

PRIMARY UTILITIES: WILL THIS PROJECT INCLUDE THE FOLLOWING UTILITIES ON SITE? N.A.  
 OIL STORAGE \_\_\_\_\_ GALLONS  WATER SUPPLY  
 FULL ELECTRICAL POWER GENERATION \_\_\_\_\_ KW  SEWAGE DISPOSAL

ALTERNATIVES. LIST TWO OR MORE ALTERNATIVES TO THIS CONSTRUCTION AND WHY REJECTED.

1. Postpone Project: This alternative was rejected due to the negative impact of the existing conditions to the educational environment and accelerated maintenance/operational costs.

2. Eliminate Project: This alternative was eliminated due to the accelerated maintenance/operational costs caused by these deficiencies and their negative impact on the learning environment.

COMPLETE FOR NEW CONSTRUCTION, ADDITIONS, REPLACEMENT OR REMODELING PROJECTS ONLY: N.A.

| PROGRAM AREA             | GROSS SQUARE FEET OF FLOOR SPACE |          |           |                | DOE USE ONLY |
|--------------------------|----------------------------------|----------|-----------|----------------|--------------|
|                          | GUIDELINES                       | EXISTING | REQUESTED | PROPOSED TOTAL |              |
| ELEMENTARY CLASSROOMS    |                                  |          |           |                |              |
| SECONDARY CLASSROOMS     |                                  |          |           |                |              |
| LIBRARY/MEDIA            |                                  |          |           |                |              |
| SCIENCE                  |                                  |          |           |                |              |
| INDUSTRIAL ED            |                                  |          |           |                |              |
| BUSINESS ED              |                                  |          |           |                |              |
| HOME SCIENCE             |                                  |          |           |                |              |
| MULTI PURPOSE            |                                  |          |           |                |              |
| SUPPLEMENTARY ( _____ %) |                                  |          |           |                |              |
| TOTAL                    |                                  |          |           |                |              |

AGE & CONDITION OF EXISTING FACILITIES: Original Construction 1960, retrofitted 1965

JUSTIFICATION & COMMENTS (ATTACH AVAILABLE DOCUMENTATION, E.G., INSPECTION REPORTS FROM STATE FIRE MARSHALL, AND HEALTH & SOCIAL SERVICES, ETC.):

The insulation of hot water pipes in the classroom, replacement of defective obsolete exterior windows, repair of a substantial roof leak and painting of the exterior of the building will reduce operating costs, preserve the building, reduce future expenditures and create a physical environment that is more conducive to learning.

*Remain to reduce heating and operating costs*

FOUNDATION FORMULA ENROLLMENT PROJECTIONS:

|                             | PRESENT   | AFTER CONSTRUCTION |
|-----------------------------|-----------|--------------------|
| ELEMENTARY (GRADES K TO 6 ) | <u>39</u> | <u>39</u>          |
| SECONDARY (GRADES 7 TO 12 ) | _____     | _____              |
| SPECIAL ED F.T.E.           | _____     | _____              |
| VOCATIONAL ED F.T.E.        | _____     | _____              |

SUBMITTED BY: \_\_\_\_\_ SIGNATURE 201 DATE \_\_\_\_\_

|  |   |
|--|---|
| DISTRICT   | SCHOOL <u>Ambler High School</u>  |
| K-6 _____ 7-8 <u>16</u> 9-12 <u>20</u><br>DESIGN ENROLLMENT  | PROJECT NAME<br><u>Industrial Education/Storage Addi</u>  |
| PROJECT TYPE<br><input type="checkbox"/> NEW CONSTRUCTION<br><input checked="" type="checkbox"/> ADDITION<br><input type="checkbox"/> REMODELING<br><input type="checkbox"/> REPLACEMENT<br><input type="checkbox"/> MAJOR MAINTENANCE<br><input type="checkbox"/> UTILITIES<br><input type="checkbox"/> OTHER | PROJECT JUSTIFICATION<br><input type="checkbox"/> HEALTH OR LIFE SAFETY<br><input checked="" type="checkbox"/> UNHOUSED STUDENTS<br><input type="checkbox"/> PROTECTION OF STRUCTURE<br><input type="checkbox"/> FUNCTIONAL UPGRADE<br><input type="checkbox"/> CODE UPGRADE<br><input type="checkbox"/> OPERATING COST SAVINGS<br><input type="checkbox"/> OTHER |

|                                   |                                |
|-----------------------------------|--------------------------------|
| CONSTRUCTION START <u>June 83</u> | COMPLETION DATE <u>June 84</u> |
|-----------------------------------|--------------------------------|

PROJECT ESTIMATED TO  INCREASE  DECREASE

DISTRICT OPERATING BUDGET \$ 2,000

SCHOOL SITE:  EXISTING, OR  NEW SITE; IF NEW, ACQUISITION COST \$ \_\_\_\_\_

PRIMARY UTILITIES: WILL THIS PROJECT INCLUDE THE FOLLOWING UTILITIES ON SITE?

OIL STORAGE \_\_\_\_\_ GALLONS  WATER SUPPLY

FULL ELECTRICAL POWER GENERATION \_\_\_\_\_ KW  SEWAGE DISPOSAL

ALTERNATIVES. LIST TWO OR MORE ALTERNATIVES TO THIS CONSTRUCTION AND WHY REJECTED.

1. Postpone Project: this alternative was rejected due to the inadequacy of the existing shop to house the industrial education program, the need for additional general purpose classroom space, and a critical shortage of storage space.
2. Eliminate Project: this alternate was rejected due to the critical need for additional space in which to effectively existing/projected educational program for this school.

COMPLETE FOR NEW CONSTRUCTION, ADDITIONS, REPLACEMENT OR REMODELING PROJECTS ONLY:

| PROGRAM AREA          | GROSS SQUARE FEET OF FLOOR SPACE |          |           |                | DOE USE ONLY |
|-----------------------|----------------------------------|----------|-----------|----------------|--------------|
|                       | GUIDELINES                       | EXISTING | REQUESTED | PROPOSED TOTAL |              |
| ELEMENTARY CLASSROOMS |                                  |          |           |                |              |
| SECONDARY CLASSROOMS  |                                  |          |           |                |              |
| LIBRARY/MEDIA         |                                  |          |           |                |              |
| SCIENCE               | 800                              | 900      | 1,400     | 1,400          |              |
| INDUSTRIAL ED         |                                  |          |           |                |              |
| BUSINESS ED           |                                  |          |           |                |              |
| HOME SCIENCE          |                                  |          |           |                |              |
| MULTI PURPOSE         |                                  |          |           |                |              |
| SUPPLEMENTARY (____%) | 2,000                            | 1,566    | 500       | 2,066          |              |
| TOTAL                 | 2,800                            | 2,466    | 2,100     | 3,466          |              |

AGE & CONDITION OF EXISTING FACILITIES: Built 1978 good condition

JUSTIFICATION & COMMENTS (ATTACH AVAILABLE DOCUMENTATION, E.G., INSPECTION REPORTS FROM STATE FIRE MARSHALL, AND HEALTH & SOCIAL SERVICES, ETC.):

This project would encompass an Industrial Education shop addition, appropriate storage facilities and the remodeling of the existing shop into a general purpose classroom. Said project would provide a physical component of sufficient size to conduct a meaningful shop program and provide a general purpose classroom to house academic classes which are presently being conducted in the gym area.

*Convert existing space into space for shop, add size windows*

| FOUNDATION FORMULA ENROLLMENT PROJECTIONS: | PRESENT   | AFTER CONSTRUCTION |
|--|-----------|--------------------|
| ELEMENTARY (GRADES TO )                    | _____     | _____              |
| SECONDARY (GRADES 7 TO 12 )                | <u>35</u> | <u>36</u>          |
| SPECIAL ED F.T.E.                          | _____     | _____              |
| VOCATIONAL ED F.T.E.                       | _____     | _____              |

SUBMITTED BY: \_\_\_\_\_

SIGNATURE 203 DATE \_\_\_\_\_

|  |   |
|--|---|
| DISTRICT <u>N.W.A.S.D.</u>   | SCHOOL <u>Ambler Elem/High School</u>   |
| K-6 <u>39</u> 7-8 <u>16</u> 9-12 <u>20</u><br>DESIGN ENROLLMENT  | PROJECT NAME <u>Air Handling System Modification</u>  |
| PROJECT TYPE<br><input type="checkbox"/> NEW CONSTRUCTION<br><input type="checkbox"/> ADDITION<br><input type="checkbox"/> REMODELING<br><input type="checkbox"/> REPLACEMENT<br><input checked="" type="checkbox"/> MAJOR MAINTENANCE<br><input type="checkbox"/> UTILITIES<br><input type="checkbox"/> OTHER | PROJECT JUSTIFICATION<br><input checked="" type="checkbox"/> HEALTH OR LIFE SAFETY<br><input type="checkbox"/> UNHOUSED STUDENTS<br><input type="checkbox"/> PROTECTION OF STRUCTURE<br><input checked="" type="checkbox"/> FUNCTIONAL UPGRADE<br><input type="checkbox"/> CODE UPGRADE<br><input checked="" type="checkbox"/> OPERATING COST SAVINGS<br><input type="checkbox"/> OTHER |

|   |   |
|---|---|
| CONSTRUCTION START <u>June 83</u>   | COMPLETION DATE <u>June 84</u>            |
| PROJECT ESTIMATED TO<br><input type="checkbox"/> INCREASE<br><input checked="" type="checkbox"/> DECREASE | DISTRICT OPERATING BUDGET \$ <u>3,000</u> |

SCHOOL SITE:  EXISTING, OR  NEW SITE; IF NEW, ACQUISITION COST \$ \_\_\_\_\_

PRIMARY UTILITIES: WILL THIS PROJECT INCLUDE THE FOLLOWING UTILITIES ON SITE? N.A.

OIL STORAGE \_\_\_\_\_ GALLONS  WATER SUPPLY

FULL ELECTRICAL POWER GENERATION \_\_\_\_\_ KW  SEWAGE DISPOSAL

ALTERNATIVES. LIST TWO OR MORE ALTERNATIVES TO THIS CONSTRUCTION AND WHY REJECTED.

1. Postpone Project: This alternative was rejected due to the negative impact of the present environment on the educational development and physical welfare of the students and the fiscal impact of rising fuel costs on the educational program.
2. Eliminate Project: This alternative was rejected because of the negative impact on the educational development and physical welfare of the students and escalating fuel costs.

COMPLETE FOR NEW CONSTRUCTION, ADDITIONS, REPLACEMENT OR REMODELING PROJECTS ONLY: N.A.

| PROGRAM AREA          | GROSS SQUARE FEET OF FLOOR SPACE |          |           |                |              |
|-----------------------|----------------------------------|----------|-----------|----------------|--------------|
|                       | GUIDELINES                       | EXISTING | REQUESTED | PROPOSED TOTAL | DOE USE ONLY |
| ELEMENTARY CLASSROOMS |                                  |          |           |                |              |
| SECONDARY CLASSROOMS  |                                  |          |           |                |              |
| LIBRARY/MEDIA         |                                  |          |           |                |              |
| SCIENCE               |                                  |          |           |                |              |
| INDUSTRIAL ED         |                                  |          |           |                |              |
| BUSINESS ED           |                                  |          |           |                |              |
| HOME SCIENCE          |                                  |          |           |                |              |
| MULTI PURPOSE         |                                  |          |           |                |              |
| SUPPLEMENTARY (____%) |                                  |          |           |                |              |
| <b>TOTAL</b>          |                                  |          |           |                |              |

AGE & CONDITION OF EXISTING FACILITIES: Elem. Built 1978, remodeled 1980, H.S. built 1978

JUSTIFICATION & COMMENTS (ATTACH AVAILABLE DOCUMENTATION, E.G., INSPECTION REPORTS FROM STATE FIRE MARSHALL, AND HEALTH & SOCIAL SERVICES, ETC.):

The elementary school presently has no mechanical provisions for air changing which results in the teachers resorting to opening and closing the windows. This causes a substantial heat loss as well as a negative on the children due to a lack of proper air circulation and drafts when the windows are opened. The installation of a heat exchanger in the H.S. would substantially reduce the heat to preheat incoming air resulting in a significant fuel savings and greater system functionality.

FOUNDATION FORMULA ENROLLMENT PROJECTIONS:

|                             | PRESENT | AFTER CONSTRUCTION |
|-----------------------------|---------|--------------------|
| ELEMENTARY (GRADES K TO 6 ) | 39      | 39                 |
| SECONDARY (GRADES 7 TO 12 ) | 36      | 36                 |
| SPECIAL ED P.T.E.           |         |                    |
| VOCATIONAL ED P.T.E.        |         |                    |

SUBMITTED BY: \_\_\_\_\_

SIGNATURE 215 DATE \_\_\_\_\_

|   |   |
|---|---|
| DISTRICT <u>N.W.A.S.D.</u>  | SCHOOL <u>Ambler High School</u>  |
| K-6 _____ 7-8 <u>16</u> 9-12 <u>20</u><br>DESIGN ENROLLMENT   | PROJECT NAME <u>High School Facility Upgrade</u>  |
| PROJECT TYPE<br><input type="checkbox"/> NEW CONSTRUCTION<br><input type="checkbox"/> ADDITION<br><input checked="" type="checkbox"/> REMODELING<br><input type="checkbox"/> REPLACEMENT<br><input checked="" type="checkbox"/> MAJOR MAINTENANCE<br><input type="checkbox"/> UTILITIES<br><input type="checkbox"/> OTHER | PROJECT JUSTIFICATION<br><input checked="" type="checkbox"/> HEALTH OR LIFE SAFETY<br><input type="checkbox"/> UNHOUSED STUDENTS<br><input type="checkbox"/> PROTECTION OF STRUCTURE<br><input checked="" type="checkbox"/> FUNCTIONAL UPGRADE<br><input type="checkbox"/> CODE UPGRADE<br><input checked="" type="checkbox"/> OPERATING COST SAVINGS<br><input type="checkbox"/> OTHER |

|                                   |                                |
|-----------------------------------|--------------------------------|
| CONSTRUCTION START <u>June 83</u> | COMPLETION DATE <u>June 84</u> |
|-----------------------------------|--------------------------------|

|   |   |
|---|---|
| PROJECT ESTIMATED TO <input type="checkbox"/> INCREASE <input checked="" type="checkbox"/> DECREASE | DISTRICT OPERATING BUDGET \$ <u>1,000</u> |
|---|---|

SCHOOL SITE:  EXISTING, OR  NEW SITE: IF NEW, ACQUISITION COST \$ \_\_\_\_\_

PRIMARY UTILITIES: WILL THIS PROJECT INCLUDE THE FOLLOWING UTILITIES ON SITE? N.A.

|  |  |
|--|--|
| <input type="checkbox"/> OIL STORAGE _____ GALLONS                 | <input type="checkbox"/> WATER SUPPLY    |
| <input type="checkbox"/> FULL ELECTRICAL POWER GENERATION _____ KW | <input type="checkbox"/> SEWAGE DISPOSAL |

ALTERNATIVES. LIST TWO OR MORE ALTERNATIVES TO THIS CONSTRUCTION AND WHY REJECTED.

1. Postpone Project: This alternative was rejected due to the negative impact of these deficiencies on the health/welfare of the staff and the negative impact on the learning environment.
2. Eliminate Project: This alternative was rejected due to the need to alleviate this situation which is jeopardizing the health/welfare of the staff and impacting the educational program.

COMPLETE FOR NEW CONSTRUCTION, ADDITIONS, REPLACEMENT OR REMODELING PROJECTS ONLY: N.A.

| PROGRAM AREA            | GROSS SQUARE FEET OF FLOOR SPACE |          |           |                |              |
|-------------------------|----------------------------------|----------|-----------|----------------|--------------|
|                         | GUIDELINES                       | EXISTING | REQUESTED | PROPOSED TOTAL | DOE USE ONLY |
| ELEMENTARY CLASSROOMS   |                                  |          |           |                |              |
| SECONDARY CLASSROOMS    |                                  |          |           |                |              |
| LIBRARY/MEDIA           |                                  |          |           |                |              |
| SCIENCE                 |                                  |          |           |                |              |
| INDUSTRIAL ED           |                                  |          |           |                |              |
| BUSINESS ED             |                                  |          |           |                |              |
| HOME SCIENCE            |                                  |          |           |                |              |
| MULTI PURPOSE           |                                  |          |           |                |              |
| SUPPLEMENTARY ( _____%) |                                  |          |           |                |              |
| <b>TOTAL</b>            |                                  |          |           |                |              |

AGE & CONDITION OF EXISTING FACILITIES: Built 1978, Condition good.

JUSTIFICATION & COMMENTS (ATTACH AVAILABLE DOCUMENTATION, E.G., INSPECTION REPORTS FROM STATE FIRE MARSHALL, AND HEALTH & SOCIAL SERVICES, ETC.):

The insulation of hot water pipes and replacement of the oil fired cook stove will both save operating costs and significantly reduce the generation of excessive heat (kitchen) which is having a very detrimental effect on the kitchen personnel.

| FOUNDATION FORMULA ENROLLMENT PROJECTIONS: | PRESENT   | AFTER CONSTRUCTION |
|--|-----------|--------------------|
| ELEMENTARY (GRADES 10 )                    | _____     | _____              |
| SECONDARY (GRADES 7 TO 12 )                | <u>36</u> | <u>36</u>          |
| SPECIAL ED F.T.E.                          | _____     | _____              |
| VOCATIONAL ED F.T.E.                       | _____     | _____              |

SUBMITTED BY: \_\_\_\_\_

SIGNATURE 2/6 DATE \_\_\_\_\_

FY 84 CAPITAL BUDGET, REQUEST. — PROJECT SHEET DUE: June 15, 1982

DISTRICT N.W.A.S.D. SCHOOL Ambler High School

K-6 \_\_\_\_\_ 7-8 16 9-12 20 PROJECT NAME General Purpose storage expansion  
 DESIGN ENROLLMENT

PROJECT TYPE  NEW CONSTRUCTION  HEALTH OR LIFE SAFETY  
 ADDITION  UNHOUSED STUDENTS  
 REMODELING  PROTECTION OF STRUCTURE  
 REPLACEMENT  FUNCTIONAL UPGRADE  
 MAJOR MAINTENANCE  CODE UPGRADE  
 UTILITIES  OPERATING COST SAVINGS  
 OTHER  OTHER

CONSTRUCTION START June 83 COMPLETION DATE June 84

PROJECT ESTIMATED TO  INCREASE DISTRICT OPERATING BUDGET \$ no impact  
 DECREASE

SCHOOL SITE:  EXISTING, OR  NEW SITE; IF NEW, ACQUISITION COST \$ \_\_\_\_\_

PRIMARY UTILITIES: WILL THIS PROJECT INCLUDE THE FOLLOWING UTILITIES ON SITE? N.A.  
 OIL STORAGE \_\_\_\_\_ GALLONS  WATER SUPPLY  
 FULL ELECTRICAL POWER GENERATION \_\_\_\_\_ KW  SEWAGE DISPOSAL

ALTERNATIVES. LIST TWO OR MORE ALTERNATIVES TO THIS CONSTRUCTION AND WHY REJECTED.  
 1. Postpone Project: This alternate was rejected due to the negative impact the severe shortage of storage facilities is having on the educational program.  
 2. Eliminate Project: This alternative was rejected due to the reason cited above.

COMPLETE FOR NEW CONSTRUCTION, ADDITIONS, REPLACEMENT OR REMODELING PROJECTS ONLY:

| PROGRAM AREA             | GROSS SQUARE FEET OF FLOOR SPACE |          |           |                |              |
|--------------------------|----------------------------------|----------|-----------|----------------|--------------|
|                          | GUIDELINES                       | EXISTING | REQUESTED | PROPOSED TOTAL | DOE USE ONLY |
| ELEMENTARY CLASSROOMS    |                                  |          |           |                |              |
| SECONDARY CLASSROOMS     |                                  |          |           |                |              |
| LIBRARY/MEDIA            |                                  |          |           |                |              |
| SCIENCE                  |                                  |          |           |                |              |
| INDUSTRIAL ED            |                                  |          |           |                |              |
| BUSINESS ED              |                                  |          |           |                |              |
| HOME SCIENCE             |                                  |          |           |                |              |
| MULTI PURPOSE            |                                  |          |           |                |              |
| SUPPLEMENTARY ( _____ %) |                                  | 334      | 768*      | 1,102          |              |
| TOTAL                    |                                  | 334      | 768*      | 1,102          |              |

AGE & CONDITION OF EXISTING FACILITIES: Built 1978, Condition good

JUSTIFICATION & COMMENTS (ATTACH AVAILABLE DOCUMENTATION, E.G., INSPECTION REPORTS FROM STATE FIRE MARSHALL, AND HEALTH & SOCIAL SERVICES, ETC.):  
 This project would enclose the gym balcony thus creating 2 secure storage areas. At the present time the building only has 338 sq. ft. of storage which has resulted in multi items being stored in classrooms and other non secured areas with a subsequent disruption of classroom activities and loss of materials and supplies.  
 \* Existing square footage that is not suitable by code for instructional purposes.

FOUNDATION FORMULA ENROLLMENT PROJECTIONS:

|                             | PRESENT | AFTER CONSTRUCTION |
|-----------------------------|---------|--------------------|
| ELEMENTARY (GRADES TO )     | _____   | _____              |
| SECONDARY (GRADES 7 TO 12 ) | 36      | 36                 |
| SPECIAL ED F.T.E.           | _____   | _____              |
| VOCATIONAL ED F.T.E.        | _____   | _____              |

SUBMITTED BY: \_\_\_\_\_ SIGNATURE 209 DATE \_\_\_\_\_

|  |  |
|--|--|
| DISTRICT N.W.A.S.D.  | SCHOOL Deering   |
| K-6 <u>31</u> 7-8 <u>5</u> 9-12 <u>14</u><br>DESIGN ENROLLMENT   | PROJECT NAME Water storage expansion   |
| PROJECT TYPE<br><input type="checkbox"/> NEW CONSTRUCTION<br><input checked="" type="checkbox"/> ADDITION<br><input type="checkbox"/> REMODELING<br><input type="checkbox"/> REPLACEMENT<br><input type="checkbox"/> MAJOR MAINTENANCE<br><input type="checkbox"/> UTILITIES<br><input type="checkbox"/> OTHER | PROJECT JUSTIFICATION<br><input checked="" type="checkbox"/> HEALTH OR LIFE SAFETY<br><input type="checkbox"/> UNHOUSED STUDENTS<br><input type="checkbox"/> PROTECTION OF STRUCTURE<br><input checked="" type="checkbox"/> FUNCTIONAL UPGRADE<br><input type="checkbox"/> CODE UPGRADE<br><input type="checkbox"/> OPERATING COST SAVINGS<br><input type="checkbox"/> OTHER |

CONSTRUCTION START June 1982 COMPLETION DATE September 1984

PROJECT ESTIMATED TO  INCREASE  DECREASE DISTRICT OPERATING BUDGET \$ \_\_\_\_\_

SCHOOL SITE:  EXISTING, OR  NEW SITE. IF NEW, ACQUISITION COST \$ \_\_\_\_\_

PRIMARY UTILITIES: WILL THIS PROJECT INCLUDE THE FOLLOWING UTILITIES ON SITE?  
 OIL STORAGE \_\_\_\_\_ GALLONS  WATER SUPPLY  
 FULL ELECTRICAL POWER GENERATION \_\_\_\_\_ KW  SEWAGE DISPOSAL

ALTERNATIVES. LIST TWO OR MORE ALTERNATIVES TO THIS CONSTRUCTION AND WHY REJECTED.

Postpone project: This alternative was rejected due to the critical need to enlarge the water storage capacity of the school to prevent re-occurring water shortages which have resulted in health hazards to the student-body and staff at the school.

Eliminate project: This alternative was rejected for the same reasons as stated in above.

COMPLETE FOR NEW CONSTRUCTION, ADDITIONS, REPLACEMENT OR REMODELING PROJECTS ONLY:

| PROGRAM AREA             | GROSS SQUARE FEET OF FLOOR SPACE |          |           |                |              |
|--------------------------|----------------------------------|----------|-----------|----------------|--------------|
|                          | GUIDELINES                       | EXISTING | REQUESTED | PROPOSED TOTAL | DOE USE ONLY |
| ELEMENTARY CLASSROOMS    |                                  |          |           |                |              |
| SECONDARY CLASSROOMS     |                                  |          |           |                |              |
| LIBRARY/MEDIA            |                                  |          |           |                |              |
| SCIENCE                  |                                  |          |           |                |              |
| INDUSTRIAL ED            |                                  |          |           |                |              |
| BUSINESS ED              |                                  |          |           |                |              |
| HOME SCIENCE             |                                  |          |           |                |              |
| MULTI PURPOSE            |                                  |          |           |                |              |
| SUPPLEMENTARY ( _____ %) |                                  |          |           |                |              |
| TOTAL                    |                                  |          |           |                |              |

AGE & CONDITION OF EXISTING FACILITIES:

JUSTIFICATION & COMMENTS (ATTACH AVAILABLE DOCUMENTATION, E.G., INSPECTION REPORTS FROM STATE FIRE MARSHALL, AND HEALTH & SOCIAL SERVICES, ETC.):

This project is essential to maintain an adequate water supply for the school throughout the school year as required by the State of Alaska. Water shortages which have occurred in the past have occurred in the past have had a negative impact on the health and safety of the students and staff in this school.

*Water storage expansion - need additional information*

FOUNDATION FORMULA ENROLLMENT PROJECTIONS:

|                         | PRESENT | AFTER CONSTRUCTION |
|-------------------------|---------|--------------------|
| ELEMENTARY (GRADES TO ) | _____   | _____              |
| SECONDARY (GRADES TO )  | _____   | _____              |
| SPECIAL ED F.T.E.       | _____   | _____              |
| VOCATIONAL ED F.T.E.    | _____   | _____              |

SUBMITTED BY: \_\_\_\_\_ SIGNATURE \_\_\_\_\_ DATE \_\_\_\_\_

DISTRICT N.W.A.S.D. SCHOOL Deering

K-6 31 7-8 5 9-12 14 PROJECT NAME General purpose storage building  
 DESIGN ENROLLMENT

PROJECT TYPE  NEW CONSTRUCTION  
 ADDITION  
 REMODELING  
 REPLACEMENT  
 MAJOR MAINTENANCE  
 UTILITIES  
 OTHER

PROJECT JUSTIFICATION  HEALTH OR LIFE SAFETY  
 UNHOUSED STUDENTS  
 PROTECTION OF STRUCTURE  
 FUNCTIONAL UPGRADE  
 CODE UPGRADE  
 OPERATING COST SAVINGS  
 OTHER

CONSTRUCTION START June 1983 COMPLETION DATE September 1984

PROJECT ESTIMATED TO  INCREASE  DECREASE DISTRICT OPERATING BUDGET \$ 25,000

SCHOOL SITE:  EXISTING, OR  NEW SITE: IF NEW, ACQUISITION COST \$ \_\_\_\_\_

PRIMARY UTILITIES: WILL THIS PROJECT INCLUDE THE FOLLOWING UTILITIES ON SITE?  
 OIL STORAGE \_\_\_\_\_ GALLONS  WATER SUPPLY  
 FULL ELECTRICAL POWER GENERATION \_\_\_\_\_  SEWAGE DISPOSAL

ALTERNATIVES. LIST TWO OR MORE ALTERNATIVES TO THIS CONSTRUCTION AND WHY REJECTED.

Postpone project: This alternative was rejected due to the negative impact the storage of expensive materials and supplies in the school building is having on the educational program and the high loss and damage to the stored materials due to improper storage and security.

Eliminate project: This alternative was rejected for the same reason as stated in above.

COMPLETE FOR NEW CONSTRUCTION, ADDITIONS, REPLACEMENT OR REMODELING PROJECTS ONLY:

| PROGRAM AREA             | GROSS SQUARE FEET OF FLOOR SPACE |          |           |                |              |
|--------------------------|----------------------------------|----------|-----------|----------------|--------------|
|                          | GUIDELINES                       | EXISTING | REQUESTED | PROPOSED TOTAL | DOE USE ONLY |
| ELEMENTARY CLASSROOMS    |                                  |          |           |                |              |
| SECONDARY CLASSROOMS     |                                  |          |           |                |              |
| LIBRARY/MEDIA            |                                  |          |           |                |              |
| SCIENCE                  |                                  |          |           |                |              |
| INDUSTRIAL ED            |                                  |          |           |                |              |
| BUSINESS ED              |                                  |          |           |                |              |
| HOME SCIENCE             |                                  |          |           |                |              |
| MULTI PURPOSE            |                                  |          |           |                |              |
| SUPPLEMENTARY ( _____ %) |                                  | 188      | 576       | 764            |              |
| TOTAL                    |                                  | 188      | 576       | 764            |              |

AGE & CONDITION OF EXISTING FACILITIES: Built 1976 Good

JUSTIFICATION & COMMENTS (ATTACH AVAILABLE DOCUMENTATION, E.G., INSPECTION REPORTS FROM STATE FIRE MARSHALL, AND HEALTH & SOCIAL SERVICES, ETC.):

This facility is needed to remove supplies, materials, equipment and food supplies from the instructional areas of the school, which has resulted in a negative impact on the educational programs and safety of the students as well as the damage and location of these supplies.

*Storage facility - Total building size decreased*

Adequate storage is a major problem in the remote village schools due to the necessity to order large quantities of supplies at one time.

FOUNDATION FORMULA ENROLLMENT PROJECTIONS:

|                             | PRESENT   | AFTER CONSTRUCTION |
|-----------------------------|-----------|--------------------|
| ELEMENTARY (GRADES K TO 6 ) | <u>31</u> | <u>31</u>          |
| SECONDARY (GRADES 7 TO 12 ) | <u>19</u> | <u>19</u>          |
| SPECIAL ED F.T.E.           | _____     | _____              |
| VOCATIONAL ED F.T.E.        | _____     | _____              |

SUBMITTED BY: \_\_\_\_\_ SIGNATURE \_\_\_\_\_ DATE \_\_\_\_\_

DISTRICT N.W.A.S.D. SCHOOL Buckland

K-6 42 7-8 9 9-12 21 PROJECT NAME General purpose storage building  
DESIGN ENROLLMENT

PROJECT TYPE  NEW CONSTRUCTION  
 ADDITION  
 REMODELING  
 REPLACEMENT  
 MAJOR MAINTENANCE  
 UTILITIES  
 OTHER

PROJECT JUSTIFICATION  HEALTH OR LIFE SAFETY  
 UNHOUSED STUDENTS  
 PROTECTION OF STRUCTURE  
 FUNCTIONAL UPGRADE  
 CODE UPGRADE  
 OPERATING COST SAVINGS  
 OTHER

CONSTRUCTION START June 83 COMPLETION DATE September 1984

PROJECT ESTIMATED TO  INCREASE  DECREASE DISTRICT OPERATING BUDGET \$ 25,000

SCHOOL SITE:  EXISTING, OR  NEW SITE: IF NEW, ACQUISITION COST \$ \_\_\_\_\_

PRIMARY UTILITIES: WILL THIS PROJECT INCLUDE THE FOLLOWING UTILITIES ON SITE?  
 OIL STORAGE \_\_\_\_\_ GALLONS  WATER SUPPLY  
 FULL ELECTRICAL POWER GENERATION \_\_\_\_\_ KW  SEWAGE DISPOSAL

ALTERNATIVES. LIST TWO OR MORE ALTERNATIVES TO THIS CONSTRUCTION AND WHY REJECTED.  
 Postpone project: This alternative was rejected due to the negative impact the storage of expensive materials and supplies in the school building is having on the educational program and the high loss and damage to the stored materials due to improper storage and security.  
 Eliminate project: This alternative was rejected for the same reasons as stated in above.

COMPLETE FOR NEW CONSTRUCTION, ADDITIONS, REPLACEMENT OR REMODELING PROJECTS ONLY:

| PROGRAM AREA          | GROSS SQUARE FEET OF FLOOR SPACE |          |           |                | DOE USE ONLY |
|-----------------------|----------------------------------|----------|-----------|----------------|--------------|
|                       | GUIDELINES                       | EXISTING | REQUESTED | PROPOSED TOTAL |              |
| ELEMENTARY CLASSROOMS |                                  |          |           |                |              |
| SECONDARY CLASSROOMS  |                                  |          |           |                |              |
| LIBRARY/MEDIA         |                                  |          |           |                |              |
| SCIENCE               |                                  |          |           |                |              |
| INDUSTRIAL ED         |                                  |          |           |                |              |
| BUSINESS ED           |                                  |          |           |                |              |
| HOME SCIENCE          |                                  |          |           |                |              |
| MULTI PURPOSE         |                                  |          |           |                |              |
| SUPPLEMENTARY (____%) |                                  | 380      | 576       | 956            |              |
| TOTAL                 |                                  | 380      | 576       | 956            |              |

AGE & CONDITION OF EXISTING FACILITIES: Built 1976 Good

JUSTIFICATION & COMMENTS (ATTACH AVAILABLE DOCUMENTATION, E.G., INSPECTION REPORTS FROM STATE FIRE MARSHALL, AND HEALTH & SOCIAL SERVICES, ETC.):

This facility is needed to remove supplies, materials, equipment and food products from the instructional areas of the school which has resulted in a negative impact on the educational program and safety of the students as well as results in damage and loss of these supplies and materials.

Adequate storage is a major problem in the remote village schools due to the necessity to acquire and store large quantities of materials, supplies and food products at one time.

FOUNDATION FORMULA ENROLLMENT PROJECTIONS:

|                            | PRESENT | AFTER CONSTRUCTION |
|----------------------------|---------|--------------------|
| ELEMENTARY (GRADES K TO 6) | 30      | 30                 |
| SECONDARY (GRADES 7 TO 12) |         |                    |
| SPECIAL ED F.T.E.          |         |                    |
| VOCATIONAL ED F.T.E.       |         |                    |

SUBMITTED BY: \_\_\_\_\_ SIGNATURE DATE

DISTRICT N.W.A.S.D. | SCHOOL Buckland

K-6 42 7-8 9 9-12 21 | PROJECT NAME Vocational education shop remodeling  
 DESIGN ENROLLMENT

PROJECT TYPE  NEW CONSTRUCTION  
 ADDITION  
 REMODELING  
 REPLACEMENT  
 MAJOR MAINTENANCE  
 UTILITIES  
 OTHER

PROJECT JUSTIFICATION  HEALTH OR LIFE SAFETY  
 UNHOUSED STUDENTS  
 PROTECTION OF STRUCTURE  
 FUNCTIONAL UPGRADE  
 CODE UPGRADE  
 OPERATING COST SAVINGS  
 OTHER

CONSTRUCTION START June 1983 | COMPLETION DATE September 1983

PROJECT ESTIMATED TO  INCREASE  DECREASE | DISTRICT OPERATING BUDGET \$ No impact

SCHOOL SITE:  EXISTING, OR  NEW SITE; IF NEW, ACQUISITION COST \$ \_\_\_\_\_

PRIMARY UTILITIES: WILL THIS PROJECT INCLUDE THE FOLLOWING UTILITIES ON SITE?  
 OIL STORAGE \_\_\_\_\_ GALLONS  WATER SUPPLY  
 FULL ELECTRICAL POWER GENERATION \_\_\_\_\_ KW  SEWAGE DISPOSAL

ALTERNATIVES. LIST TWO OR MORE ALTERNATIVES TO THIS CONSTRUCTION AND WHY REJECTED.  
 Postpone project: This alternative was rejected due to the health, life safety hazards in the present shop and the need to upgrade this facility to provide a more comprehensive vocational educational education program.  
 Eliminate project: This alternative was rejected due to the above reasons.

COMPLETE FOR NEW CONSTRUCTION, ADDITIONS, REPLACEMENT OR REMODELING PROJECTS ONLY:

| PROGRAM AREA          | GROSS SQUARE FEET OF FLOOR SPACE |          |           |                |              |
|-----------------------|----------------------------------|----------|-----------|----------------|--------------|
|                       | GUIDELINES                       | EXISTING | REQUESTED | PROPOSED TOTAL | DOE USE ONLY |
| ELEMENTARY CLASSROOMS |                                  |          |           |                |              |
| SECONDARY CLASSROOMS  |                                  |          |           |                |              |
| LIBRARY/MEDIA         |                                  |          |           |                |              |
| SCIENCE               |                                  |          |           |                |              |
| INDUSTRIAL ED         | 800                              | 754      | 754       | 754            |              |
| BUSINESS ED           |                                  |          |           |                |              |
| HOME SCIENCE          |                                  |          |           |                |              |
| MULTI PURPOSE         |                                  |          |           |                |              |
| SUPPLEMENTARY (____%) |                                  |          |           |                |              |
| TOTAL                 | 800                              | 754      | 754       | 754            |              |

AGE & CONDITION OF EXISTING FACILITIES: Built 1978 Good

JUSTIFICATION & COMMENTS (ATTACH AVAILABLE DOCUMENTATION, E.G., INSPECTION REPORTS FROM STATE FIRE MARSHALL, AND HEALTH & SOCIAL SERVICES, ETC.):  
 This project is necessitated to upgrade the shop, to eliminate electrical/ventilation deficiencies and facilitate the use of more extensive power equipment and welding. Said project will eliminate existing health/safety hazards and enable the school to expand the scope of it's vocational education program.  
*Eliminate health/safety hazards in shop*

FOUNDATION FORMULA ENROLLMENT PROJECTIONS:

|                             | PRESENT   | AFTER CONSTRUCTION |
|-----------------------------|-----------|--------------------|
| ELEMENTARY (GRADES K TO ) 6 | <u>42</u> | <u>42</u>          |
| SECONDARY (GRADES 7 TO 12 ) | <u>30</u> | <u>30</u>          |
| SPECIAL ED F.T.E.           | _____     | _____              |
| VOCATIONAL ED F.T.E.        | _____     | _____              |

SUBMITTED BY: \_\_\_\_\_  
 SIGNATURE 210 | DATE \_\_\_\_\_

# **CORRECTION**

**THIS DOCUMENT  
HAS BEEN REPHOTOGRAPHED  
TO ASSURE LEGIBILITY**

FY 94 CAPITAL BUDGET, REQUEST --- PROJECT SHEET DUE: June 15, 1982

DISTRICT N.W.A.S.D. SCHOOL Buckland

K-6 42 7-8 9 9-12 21 PROJECT NAME Vocational education shop remodeling

DESIGN ENROLLMENT

PROJECT TYPE  NEW CONSTRUCTION  ADDITION  REMODELING  REPLACEMENT  MAJOR MAINTENANCE  UTILITIES  OTHER

PROJECT JUSTIFICATION  HEALTH OR LIFE SAFETY  UNHOUSED STUDENTS  PROTECTION OF STRUCTURE  FUNCTIONAL UPGRADE  CODE UPGRADE  OPERATING COST SAVINGS  OTHER

CONSTRUCTION START June 1983 COMPLETION DATE September 1983

PROJECT ESTIMATED TO  INCREASE  DECREASE DISTRICT OPERATING BUDGET \$ No impact

SCHOOL SITE:  EXISTING, OR  NEW SITE; IF NEW, ACQUISITION COST \$ \_\_\_\_\_

PRIMARY UTILITIES: WILL THIS PROJECT INCLUDE THE FOLLOWING UTILITIES ON SITE?

OIL STORAGE \_\_\_\_\_ GALLONS  WATER SUPPLY

FULL ELECTRICAL POWER GENERATION \_\_\_\_\_ KW  SEWAGE DISPOSAL

ALTERNATIVES LIST TWO OR MORE ALTERNATIVES TO THIS CONSTRUCTION AND WHY REJECTED.

Postpone project: This alternative was rejected due to the health, life safety hazards in the present shop and the need to upgrade this facility to provide a more comprehensive vocational educational education program.

Eliminate project: This alternative was rejected due to the above reasons.

COMPLETE FOR NEW CONSTRUCTION, ADDITIONS, REPLACEMENT OR REMODELING PROJECTS ONLY:

| PROGRAM AREA          | GROSS SQUARE FEET OF FLOOR SPACE |          |           |                | DOE USE ONLY |
|-----------------------|----------------------------------|----------|-----------|----------------|--------------|
|                       | GU'DELINES                       | EXISTING | REQUESTED | PROPOSED TOTAL |              |
| ELEMENTARY CLASSROOMS |                                  |          |           |                |              |
| SECONDARY CLASSROOMS  |                                  |          |           |                |              |
| LIBRARY/MEDIA         |                                  |          |           |                |              |
| SCIENCE               |                                  |          |           |                |              |
| INDUSTRIAL ED         | 800                              | 754      | 754       | 754            |              |
| BUSINESS ED           |                                  |          |           |                |              |
| HOME SCIENCE          |                                  |          |           |                |              |
| MULTI PURPOSE         |                                  |          |           |                |              |
| SUPPLEMENTARY (____%) |                                  |          |           |                |              |
| TOTAL                 | 800                              | 754      | 754       | 754            |              |

AGE & CONDITION OF EXISTING FACILITIES: Built 1978 Good

JUSTIFICATION & COMMENTS (ATTACH AVAILABLE DOCUMENTATION, E.G., INSPECTION REPORTS FROM STATE FIRE MARSHALL, AND HEALTH & SOCIAL SERVICES, ETC.):

This project is necessitated to upgrade the shop, to eliminate electrical/ventilation deficiencies and facilitate the use of more extensive power equipment and welding. Said project will eliminate existing health/safety hazards and enable the school to expand the scope of it's vocational education program.

*Eliminate health/safety hazards in shop.*

FOUNDATION FORMULA ENROLLMENT PROJECTIONS:

|                             | PRESENT | AFTER CONSTRUCTION |
|-----------------------------|---------|--------------------|
| ELEMENTARY (GRADES K TO ) 6 | _____   | 42                 |
| SECONDARY (GRADES 7 TO 12 ) | _____   | 30                 |
| SPECIAL ED F.T.E.           | _____   | _____              |
| VOCATIONAL ED F.T.E.        | _____   | _____              |

SUBMITTED BY: \_\_\_\_\_ SIGNATURE 210 DATE \_\_\_\_\_

174831

**FY 82 CAPITAL BUDGET REQUEST — PROJECT SHEET** DUE: July 24, 1981

DISTRICT Bering Strait REAA SCHOOL Savoonga High School

K-6 \_\_\_\_\_ 7-8 13 9-12 42  
 DESIGN ENROLLMENT PROJECT NAME Savoonga Classroom Addition

|  |   |
|--|---|
| PROJECT TYPE<br><input type="checkbox"/> NEW CONSTRUCTION<br><input checked="" type="checkbox"/> ADDITION<br><input type="checkbox"/> REMODELING<br><input type="checkbox"/> REPLACEMENT<br><input type="checkbox"/> MAJOR MAINTENANCE<br><input type="checkbox"/> UTILITIES<br><input type="checkbox"/> OTHER | PROJECT JUSTIFICATION<br><input type="checkbox"/> HEALTH OR LIFE SAFETY<br><input checked="" type="checkbox"/> UNHOUSED STUDENTS<br><input type="checkbox"/> PROTECTION OF STRUCTURE<br><input type="checkbox"/> FUNCTIONAL UPGRADE<br><input type="checkbox"/> CODE UPGRADE<br><input type="checkbox"/> OPERATING COST SAVINGS<br><input type="checkbox"/> OTHER |
|--|---|

CONSTRUCTION START Spring, 1983 COMPLETION DATE Winter, 1983

PROJECT ESTIMATED TO  INCREASE  DECREASE DISTRICT OPERATING BUDGET \$ 15,700.00

SCHOOL SITE:  EXISTING, OR  NEW SITE; IF NEW, ACQUISITION COST \$ \_\_\_\_\_

PRIMARY UTILITIES: WILL THIS PROJECT INCLUDE THE FOLLOWING UTILITIES ON SITE?  
 OIL STORAGE \_\_\_\_\_ GALLONS  WATER SUPPLY  
 FULL ELECTRICAL POWER GENERATION \_\_\_\_\_ KW  SEWAGE DISPOSAL

ALTERNATIVES. LIST TWO OR MORE ALTERNATIVES TO THIS CONSTRUCTION AND WHY REJECTED.

1. Continue sharing space with BIA in elementary classrooms. Rejected due to overcrowding and reduced instructional periods.
2. Send students to Gambell. Rejected due to Tobeluk.

**COMPLETE FOR NEW CONSTRUCTION, ADDITIONS, REPLACEMENT OR REMODELING PROJECTS ONLY:**

| PROGRAM AREA             | GROSS SQUARE FEET OF FLOOR SPACE |              |              |                | DOE USE ONLY |
|--------------------------|----------------------------------|--------------|--------------|----------------|--------------|
|                          | GUIDELINES                       | EXISTING     | REQUESTED    | PROPOSED TOTAL |              |
| ELEMENTARY CLASSROOMS    | 1,200                            | -0-          | 1,200        | 1,200          |              |
| SECONDARY CLASSROOMS     | 1,300                            | -0-          | 1,300        | 1,300          |              |
| LIBRARY/MEDIA            | 900                              | -0-          | -0-          | -0-            |              |
| SCIENCE                  | 1,000                            | 825          | -0-          | 825            |              |
| INDUSTRIAL ED            | 300                              | -0-          | -0-          | -0-            |              |
| BUSINESS ED              | 400                              | -0-          | -0-          | -0-            |              |
| HOME SCIENCE             | 4,200                            | 4,950        | -0-          | 4,950          |              |
| MULTI PURPOSE            | 2,790                            | 2,829        | 750          | 3,579          |              |
| SUPPLEMENTARY ( _____ %) |                                  |              |              |                |              |
| <b>TOTAL</b>             | <b>12,090</b>                    | <b>8,604</b> | <b>3,250</b> | <b>11,854</b>  |              |

AGE & CONDITION OF EXISTING FACILITIES: '78 const. has some life safety, maint. & handicapped deficiencies

JUSTIFICATION & COMMENTS (ATTACH AVAILABLE DOCUMENTATION, E.G., INSPECTION REPORTS FROM STATE FIRE MARSHALL, AND HEALTH & SOCIAL SERVICES, ETC.):

The original high school design included these classroom spaces but excessive costs prohibited their construction. The sharing of space with the BIA elementary school will continue under this proposal.

| FOUNDATION FORMULA ENROLLMENT PROJECTIONS: | PRESENT | AFTER CONSTRUCTION |
|--|---------|--------------------|
| ELEMENTARY (GRADES TO )                    | _____   | _____              |
| SECONDARY (GRADES TO )                     | 46      | 55                 |
| SPECIAL ED F.T.E.                          | _____   | _____              |
| VOCATIONAL ED F.T.E.                       | _____   | _____              |

SUBMITTED BY: \_\_\_\_\_ DATE July 24, 1981

SIGNATURE \_\_\_\_\_ DATE \_\_\_\_\_

DISTRICT Lower Yukon SCHOOL Hooper Bay High School

K-6 \_\_\_\_\_ 7-8 \_\_\_\_\_ 9-12 \_\_\_\_\_  
 DESIGN ENROLLMENT PROJECT NAME Classroom Addition

PROJECT TYPE  NEW CONSTRUCTION  ADDITION  REMODELING  REPLACEMENT  MAJOR MAINTENANCE  UTILITIES  OTHER

PROJECT JUSTIFICATION  HEALTH OR LIFE SAFETY  UNHOUSED STUDENTS  PROTECTION OF STRUCTURE  FUNCTIONAL UPGRADE  CODE UPGRADE  OPERATING COST SAVINGS  OTHER

CONSTRUCTION START July 1, 1983 COMPLETION DATE June 30, 1984

PROJECT ESTIMATED TO  INCREASE  DECREASE DISTRICT OPERATING BUDGET \$ 50,000

SCHOOL SITE:  EXISTING, OR  NEW SITE; IF NEW, ACQUISITION COST \$ \_\_\_\_\_

PRIMARY UTILITIES: WILL THIS PROJECT INCLUDE THE FOLLOWING UTILITIES ON SITE? Yes--ALL  
 OIL STORAGE \_\_\_\_\_ GALLONS  WATER SUPPLY  
 FULL ELECTRICAL POWER GENERATION \_\_\_\_\_ KW  SEWAGE DISPOSAL

ALTERNATIVES. LIST TWO OR MORE ALTERNATIVES TO THIS CONSTRUCTION AND WHY REJECTED.  
 1. Use of Community facilities. None available.  
 2. Send students elsewhere. Parents object to this type of treatment.

COMPLETE FOR NEW CONSTRUCTION, ADDITIONS, REPLACEMENT OR REMODELING PROJECTS ONLY:

| PROGRAM AREA          | GROSS SQUARE FEET OF FLOOR SPACE |               |               |                | DOE USE ONLY |
|-----------------------|----------------------------------|---------------|---------------|----------------|--------------|
|                       | GUIDELINES                       | EXISTING      | REQUESTED     | PROPOSED TOTAL |              |
| ELEMENTARY CLASSROOMS |                                  |               |               |                |              |
| SECONDARY CLASSROOMS  | 2,400                            | 570           | 2,400         | +1,830         |              |
| LIBRARY/MEDIA         | 1,100                            | 493           | 1,100         | + 607          |              |
| SCIENCE               |                                  |               |               |                |              |
| INDUSTRIAL ED         | 1,500                            | 809           | 1,500         | + 691          |              |
| BUSINESS ED           |                                  |               |               |                |              |
| HOME SCIENCE          | 700                              | 551           | 700           | + 147          |              |
| MULTI PURPOSE         |                                  |               |               |                |              |
| SUPPLEMENTARY (25%)   | 3,225                            | 5,310         | 3,225         | + 315          |              |
| OFFICE SPACE          | 200                              | 252           | 200           | - 52           |              |
| <b>TOTAL</b>          | <b>16,125</b>                    | <b>11,551</b> | <b>16,125</b> | <b>+4,574</b>  |              |

AGE & CONDITION OF EXISTING FACILITIES: 1974 GOOD

JUSTIFICATION & COMMENTS (ATTACH AVAILABLE DOCUMENTATION, E.G., INSPECTION REPORTS FROM STATE FIRE MARSHALL, AND HEALTH & SOCIAL SERVICES, ETC.):  
 Health, Safety, Equal Educational Opportunity, Self Concept.

FOUNDATION FORMULA ENROLLMENT PROJECTIONS:

|                            | PRESENT | AFTER CONSTRUCTION |
|----------------------------|---------|--------------------|
| ELEMENTARY (GRADES TO )    |         |                    |
| SECONDARY (GRADES 9 TO 12) | 85      | 100                |
| SPECIAL ED F.T.E.          | 12      | 18                 |
| VOCATIONAL ED F.T.E. 2 FTU | 11-25   | 41                 |

SUBMITTED BY: Walter E. Brown SIGNATURE DATE 6/1/82

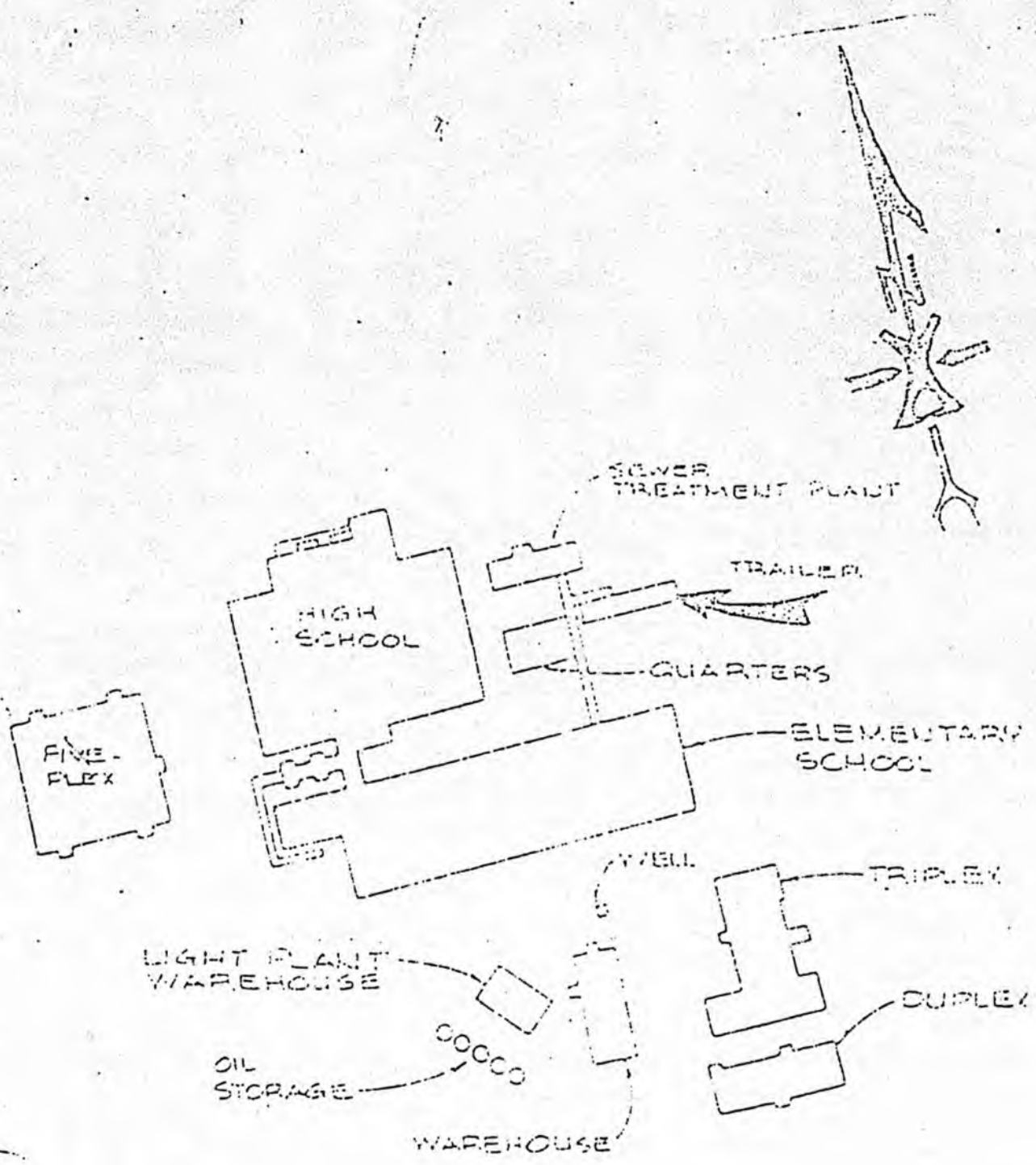

HOOPER BAY  
SITE PLAN

NO SCALE

PRIORITY # 3 HOOPER BAY HIGH SCHOOL CLASSROOM ADDITION

The Hooper Bay High School was constructed in 1976 for approximately 50 students. Currently grades 9-12 have a total of 91 students, therefore, providing substantial overcrowding in the existing High School facility. The proposed High School Classroom Addition would be approximately 4,574 S.F. to accommodate the additional student load.

DISTRICT Lower Yukon | SCHOOL Alakanuk High School

K-6 \_\_\_\_\_ 7-8 \_\_\_\_\_ 9-12 53  
 DESIGN ENROLLMENT PROJECT NAME Classroom Addition

|              |  |                       |  |
|--------------|--|-----------------------|--|
| PROJECT TYPE | <input type="checkbox"/> NEW CONSTRUCTION<br><input checked="" type="checkbox"/> ADDITION<br><input type="checkbox"/> REMODELING<br><input type="checkbox"/> REPLACEMENT<br><input type="checkbox"/> MAJOR MAINTENANCE<br><input type="checkbox"/> UTILITIES<br><input type="checkbox"/> OTHER | PROJECT JUSTIFICATION | <input type="checkbox"/> HEALTH OR LIFE SAFETY<br><input checked="" type="checkbox"/> UNHOUSED STUDENTS<br><input type="checkbox"/> PROTECTION OF STRUCTURE<br><input type="checkbox"/> FUNCTIONAL UPGRADE<br><input type="checkbox"/> CODE UPGRADE<br><input type="checkbox"/> OPERATING COST SAVINGS<br><input type="checkbox"/> OTHER |
|--------------|--|-----------------------|--|

CONSTRUCTION START July 1, 1983 | COMPLETION DATE June 30, 1984

PROJECT ESTIMATED TO  INCREASE  DECREASE | DISTRICT OPERATING BUDGET \$ 50,000

SCHOOL SITE:  EXISTING, OR  NEW SITE; IF NEW, ACQUISITION COST \$ \_\_\_\_\_

PRIMARY UTILITIES: WILL THIS PROJECT INCLUDE THE FOLLOWING UTILITIES ON SITE? Yes--ALL

|  |  |
|--|--|
| <input type="checkbox"/> OIL STORAGE _____ GALLONS                 | <input type="checkbox"/> WATER SUPPLY    |
| <input type="checkbox"/> FULL ELECTRICAL POWER GENERATION _____ KW | <input type="checkbox"/> SEWAGE DISPOSAL |

ALTERNATIVES. LIST TWO OR MORE ALTERNATIVES TO THIS CONSTRUCTION AND WHY REJECTED.

1. Use of Community Facilities. None available.
2. Send students elsewhere. Parents object to this type of treatment.

COMPLETE FOR NEW CONSTRUCTION, ADDITIONS, REPLACEMENT OR REMODELING PROJECTS ONLY:

| PROGRAM AREA          | GROSS SQUARE FEET OF FLOOR-SPACE |              |               |                |              |
|-----------------------|----------------------------------|--------------|---------------|----------------|--------------|
|                       | GUIDELINES                       | EXISTING     | REQUESTED     | PROPOSED TOTAL | DOE USE ONLY |
| ELEMENTARY CLASSROOMS | 1,200                            | 744          | 1,200         | + 456          |              |
| SECONDARY CLASSROOMS  | 1,200                            | 744          | 1,200         | +1,200         |              |
| LIBRARY MEDIA         |                                  |              |               | + 158          |              |
| SCIENCE               |                                  |              |               | + 558          |              |
| INDUSTRIAL ED         | 1,000                            | 628          | 1,000         | + 328          |              |
| BUSINESS ED           |                                  |              |               | + 118          |              |
| HOME SCIENCE          | 4,200                            | 4,000        | 4,200         | + 200          |              |
| MULTI PURPOSE         |                                  |              |               | +1,420         |              |
| SUPPLEMENTARY ( 30 %) | 2,200                            | 780          | 2,200         |                |              |
| OFFICE                | 100                              | -0-          | 100           | + 100          |              |
| <b>TOTAL</b>          | <b>11,840</b>                    | <b>8,868</b> | <b>11,500</b> | <b>+2,972</b>  |              |

AGE & CONDITION OF EXISTING FACILITIES: 1974 GOOD

JUSTIFICATION & COMMENTS (ATTACH AVAILABLE DOCUMENTATION, E.G., INSPECTION REPORTS FROM STATE FIRE MARSHALL, AND HEALTH & SOCIAL SERVICES, ETC.):

Health, Safety, Equal Educational Opportunity, Self Concept.

*Would exceed quality guidelines if funded.*

|  |           |                    |
|--|-----------|--------------------|
| FOUNDATION FORMULA ENROLLMENT PROJECTIONS: | PRESENT   | AFTER CONSTRUCTION |
| ELEMENTARY (GRADES TO )                    | _____     | _____              |
| SECONDARY (GRADES 9 TO 12)                 | <u>53</u> | <u>70</u>          |
| SPECIAL ED F.T.E.                          | _____     | _____              |
| VOCATIONAL ED F.T.E.                       | <u>13</u> | <u>20</u>          |

SUBMITTED BY: Walter E. Brown  
 SIGNATURE

6/1/82  
 DATE



OSTER STREET

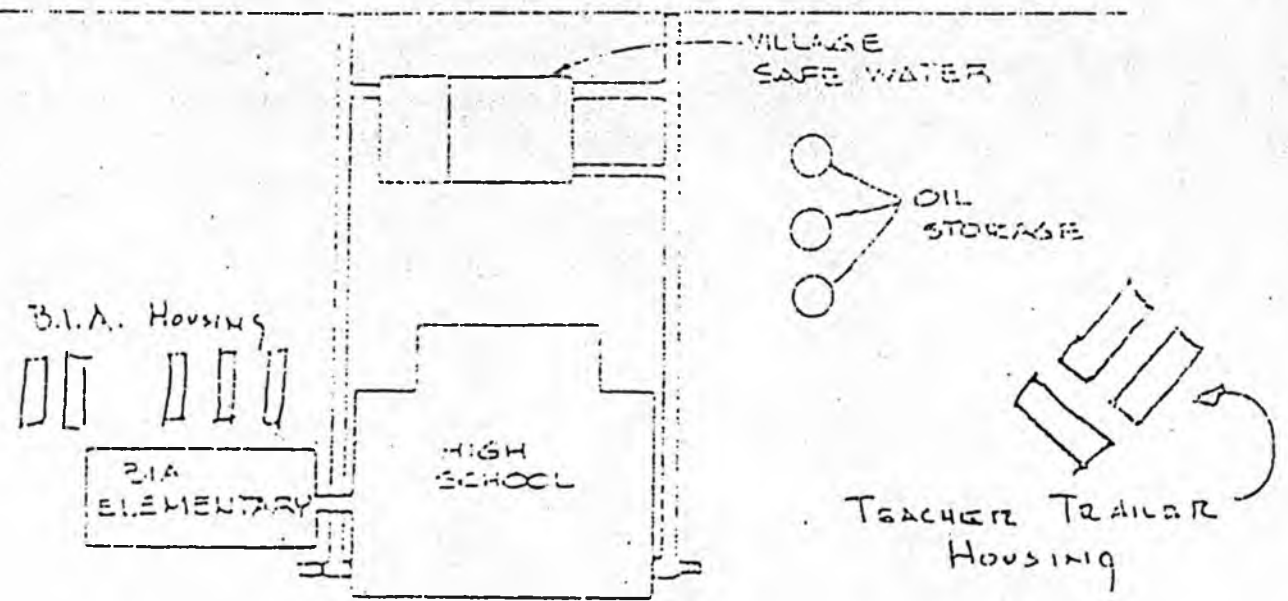

~~MARKED~~  
~~FOR SALE~~  
FOR SALE

PRIORITY # 4 ALAKANUK HIGH SCHOOL CLASSROOM ADDITION

The existing Alakanuk High School does not provide adequate classroom space to accommodate the current program. The classroom addition is proposed with an area of approximately 2,972 S.F. to supplement the existing space to serve 64 students in grades 9-12.

Matanuska-Susitna Borough School Board  
District Wide Maintenance and Upgrade Priorities  
March, 1983

1. Summer Maintenance \$200,000  
Funding is extremely important to carry out summer maintenance in the schools around the district.
2. Wasilla High School Roof Repair \$1,400,000  
This appropriation is necessary to prevent further deterioration of the high school roof. Engineering and architectural design will soon be completed and the project will be bid ready in June.
3. Big Lake Elementary Addition \$3,750,000  
This appropriation would suffice for the design and construction of a 2nd story addition to the elementary school where has been tremendous population impact in the last 3 years. Without this funding the school district would have to locate portable classrooms at the school for the coming academic term.
4. Swanson Elementary Roof and Insulation Upgrade \$1,000,000  
Roof repair and insulation for one wall of the structure would be supplied with this funding. The insulation sub-contract was never completed and this funding would alleviate the inadequacy. The roof repair would prevent further deterioration of the structure.
5. Computerized Energy Management System - District wide \$300,000  
Funding this request would result in significant savings in energy costs to the school district.
6. Palmer Area Playgrounds Upgrade \$250,000  
This appropriation would allow rehabilitation of playgrounds: grading, fencing and removal of boulders at the Swanson, Sherrod, Snowshoe and Butte Elementary Schools. At some of the locales, dogs have been allowed to access to the playground since there has been no fencing.
7. Susitna Valley Art Room Addition \$400,000  
This construction would enable this sorely needed program to be included in the curriculum.

COMMITTEE REPORT  
SENATE

FURTHER: FINANCE

1/18/83

Date: 2/23/83

Mr. President:

The Committee on Health, Ed. & Soc. Serv. has had SENATE BILL NO 18

An Act making appropriations to the University of Alaska for construction of classrooms facilities; eff. date.

under consideration and (a majority of the committee) (the committee) reports it back with the following recommendations:

- do pass  do not pass
- do pass with attached amendments(s)
- replace with CS for SB 18 (HESS)  same title  new title
- and recommends do pass
- AND attaches a "Letter of Intent"  New Fiscal Note
- reports it back without recommendation
- referred to the \_\_\_\_\_ Committee

MEMBERS SIGNING  
DO PASS

1 Paul Joseph

2 Rich Helted

3 Paul Fude

4 Walter Fischer

5 A. W. Pappas

MEMBERS HAVING  
OTHER RECOMMENDATIONS:

\_\_\_\_\_

\_\_\_\_\_

\_\_\_\_\_

\_\_\_\_\_

Paul Joseph  
CHAIRMAN

Offered: 2/25/83  
Referred: Finance

Original Sponsors: Kerttula, Sturgulewski,  
Josephson, et al

|                            |              |
|----------------------------|--------------|
| <u>Funding Information</u> |              |
| General Fund               | \$82,761,000 |
| Other Funds                | - 0 -        |
|                            | <u>\$82</u>  |

1 IN THE SENATE

BY THE FINANCE COMMITTEE

*Prior versions  
of SB 18 -  
Not Acted  
Upon*

inance)  
OF ALASKA  
SESSION

6 For an Act entitle

appropriations for certain  
planning for educational  
for an effective date."

9 BE IT ENACTED BY THE LEGISLATURE OF THE STATE OF ALASKA:

10 \* Section 1. The sum of \$25,300,000 is appropriated from the general  
11 fund to the University of Alaska for construction of classroom facilities  
12 at the Anchorage campus.

13 \* Sec. 2. The sum of \$1,000,000 is appropriated from the general fund  
14 to the Anchorage Community College for design of a classroom and adminis-  
15 trative facility.

16 \* Sec. 3. The sum of \$3,800,000 is appropriated from the general fund  
17 to the University of Alaska for construction of an agricultural classroom  
18 facility at the Matanuska-Susitna Community College.

19 \* Sec. 4. The sum of \$450,000 is appropriated from the general fund to  
20 Prince William Sound Community College for design of a classroom,  
21 laboratory and office facility.

22 \* Sec. 5. The sum of \$50,000 is appropriated from the general fund to  
23 the Anchorage Community College for planning and design of outreach facil-  
24 ities for Eagle River and South Anchorage.

25 \* Sec. 6. The sum of \$1,500,000 is appropriated from the general fund  
26 to the University of Alaska for design of classroom facilities at the  
27 Fairbanks campus.

28 \* Sec. 7. The sum of \$600,000 is appropriated from the general fund to  
29 the University of Alaska for the petroleum engineering building at the  
X

Offered: 2/25/83  
Referred: Finance

Original Sponsors: Kerttula, Sturgulewski,  
Josephson, et al

Funding Information  
General Fund \$82,761,000  
Other Funds - -0-  
\$82,761,000

1 IN THE SENATE

BY THE FINANCE COMMITTEE

2 CS FOR SENATE BILL NO. 18 (Finance)

3 IN THE LEGISLATURE OF THE STATE OF ALASKA

4 THIRTEENTH LEGISLATURE - FIRST SESSION

5 A BILL

6 For an Act entitled: "An Act making special appropriations for certain  
7 capital projects and planning for educational  
8 facilities; and providing for an effective date."

9 BE IT ENACTED BY THE LEGISLATURE OF THE STATE OF ALASKA:

10 \* Section 1. The sum of \$25,300,000 is appropriated from the general  
11 fund to the University of Alaska for construction of classroom facilities  
12 at the Anchorage campus.

13 \* Sec. 2. The sum of \$1,000,000 is appropriated from the general fund  
14 to the Anchorage Community College for design of a classroom and adminis-  
15 trative facility.

16 \* Sec. 3. The sum of \$3,800,000 is appropriated from the general fund  
17 to the University of Alaska for construction of an agricultural classroom  
18 facility at the Matanuska-Susitna Community College.

19 \* Sec. 4. The sum of \$450,000 is appropriated from the general fund to  
20 Prince William Sound Community College for design of a classroom,  
21 laboratory and office facility.

22 \* Sec. 5. The sum of \$50,000 is appropriated from the general fund to  
23 the Anchorage Community College for planning and design of outreach facil-  
24 ities for Eagle River and South Anchorage.

25 \* Sec. 6. The sum of \$1,500,000 is appropriated from the general fund  
26 to the University of Alaska for design of classroom facilities at the  
27 Fairbanks campus.

28 \* Sec. 7. The sum of \$600,000 is appropriated from the general fund to  
29 the University of Alaska for the petroleum engineering building at the  
X

1 Fairbanks campus.

2 \* Sec. 8. The sum of \$2,300,000 is appropriated from the general fund  
3 to the University of Alaska for construction of the Duckering Building  
4 addition at the Fairbanks campus.

5 \* Sec. 9. The sum of \$1,500,000 is appropriated from the general fund  
6 to Tanana Valley Community College for phase II design for a campus  
7 facility.

8 \* Sec. 10. The sum of \$4,100,000 is appropriated from the general fund  
9 to the University of Alaska for construction of a forestry sciences  
10 laboratory at the Juneau campus.

11 \* Sec. 11. The sum of \$570,000 is appropriated from the general fund to  
12 Sitka Community College for phase II design of a classroom facility.

13 \* Sec. 12. The sum of \$3,040,000 is appropriated from the general fund  
14 to the Northwest Arctic School District for construction of facilities at  
15 Selawik, Buckland, Deering and Ambler.

16 \* Sec. 13. The sum of \$1,340,000 is appropriated from the general fund  
17 to the Bering Strait School District for construction of high school  
18 classrooms at Savoonga.

19 \* Sec. 14. The sum of \$1,542,000 is appropriated from the general fund  
20 to the Lower Yukon School District for construction of facilities at Hooper  
21 Bay and Alakanuk.

22 \* Sec. 15. The sum of \$3,468,000 is appropriated from the general fund  
23 to the Department of Education for the Chatham School District for  
24 construction of school facilities at Klukwan.

25 \* Sec. 16. The sum of \$3,200,000 is appropriated from the general fund  
26 to the Iditarod School District for construction of school facilities at  
27 Nikolai and McGrath.

28 \* Sec. 17. The sum of \$2,000,000 is appropriated from the general fund  
29 to the Kuspuk School District for construction of school facilities at  
X

1 Stony River and Chuathbaluk.

2 \* Sec. 18. The sum of \$7,305,000 is appropriated from the general fund  
3 to the Lower Kuskokwim School District for construction of school  
4 facilities at Kwethluk, Bethel and Nightmute.

5 \* Sec. 19. The sum of \$350,000 is appropriated from the general fund to  
6 the Yukon Flats School District for purchase and improvements for  
7 relocatables.

8 \* Sec. 20. The sum of \$2,000,000 is appropriated from the general fund  
9 to the Yukon-Koyukuk School District for facilities code upgrade.

10 \* Sec. 21. The sum of \$300,000 is appropriated from the general fund to  
11 the St. Mary's School District for upgrade of the elementary school at St.  
12 Mary's.

13 \* Sec. 22. The sum of \$1,800,000 is appropriated from the general fund  
14 to the Yukon Flats School District for construction of the Northern Lights  
15 school.

16 \* Sec. 23. The sum of \$2,400,000 is appropriated from the general fund  
17 to the Fairbanks North Star Borough for major repairs and rehabilitation of  
18 borough schools.

19 \* Sec. 24. The sum of \$2,307,000 is appropriated from the general fund  
20 to the Fairbanks North Star Borough for fire and life safety code upgrades  
21 of borough schools.

22 \* Sec. 25. The sum of \$2,900,000 is appropriated from the general fund  
23 to the King Cove School District for construction of school facilities at  
24 King Cove.

25 \* Sec. 26. The sum of \$4,535,000 is appropriated from the general fund  
26 to the Southwest Region School District for construction of school  
27 facilities at Levelock and Clark's Point.

28 \* Sec. 27. The sum of \$1,300,000 is appropriated from the general fund  
29 to the Alaska Gateway School District for code upgrade and multi-purpose

1 room addition at Dot Lake.

2 \* Sec. 28. The sum of \$900,000 is appropriated from the general fund to  
3 the Nenana School District for school code upgrade and roof repair at  
4 Nenana.

5 \* Sec. 29. The sum of \$895,000 is appropriated from the general fund to  
6 the Delta-Greely School District for completion of the vocational education  
7 facility at Delta Junction.

8 \* Sec. 30. The appropriations made by Secs. 1-11 of this Act are for  
9 capital projects and are subject to AS 37.25.020.

10 \* Sec. 31. This Act takes effect immediately in accordance with AS 01.-  
11 10.070(c).

12  
13  
14  
15  
16  
17  
18  
19  
20  
21  
22  
23  
24  
25  
26  
27  
28  
29  
X

Offered: 2/25/83  
Referred: Finance

Original Sponsors: Kerttula, Sturgulewski,  
Josephson, et al

Funding Information  
General Fund \$82,761,000  
Other Funds -0-  
\$82,761,000

1 IN THE SENATE

BY THE FINANCE COMMITTEE

2 CS FOR SENATE BILL NO. 18 (Finance)

3 IN THE LEGISLATURE OF THE STATE OF ALASKA

4 THIRTEENTH LEGISLATURE - FIRST SESSION

5 A BILL

6 For an Act entitled: "An Act making special appropriations for certain  
7 capital projects and planning for educational  
8 facilities; and providing for an effective date."

9 BE IT ENACTED BY THE LEGISLATURE OF THE STATE OF ALASKA:

10 \* Section 1. The sum of \$25,300,000 is appropriated from the general  
11 fund to the University of Alaska for construction of classroom facilities  
12 at the Anchorage campus.

13 \* Sec. 2. The sum of \$1,000,000 is appropriated from the general fund  
14 to the Anchorage Community College for design of a classroom and adminis-  
15 trative facility.

16 \* Sec. 3. The sum of \$3,800,000 is appropriated from the general fund  
17 to the University of Alaska for construction of an agricultural classroom  
18 facility at the Matanuska-Susitna Community College.

19 \* Sec. 4. The sum of \$450,000 is appropriated from the general fund to  
20 Prince William Sound Community College for design of a classroom,  
21 laboratory and office facility.

22 \* Sec. 5. The sum of \$50,000 is appropriated from the general fund to  
23 the Anchorage Community College for planning and design of outreach facil-  
24 ities for Eagle River and South Anchorage.

25 \* Sec. 6. The sum of \$1,500,000 is appropriated from the general fund  
26 to the University of Alaska for design of classroom facilities at the  
27 Fairbanks campus.

28 \* Sec. 7. The sum of \$600,000 is appropriated from the general fund to  
29 the University of Alaska for the petroleum engineering building at the

1 Fairbanks campus.

2 \* Sec. 8. The sum of \$2,300,000 is appropriated from the general fund  
3 to the University of Alaska for construction of the Duckering Building  
4 addition at the Fairbanks campus.

5 \* Sec. 9. The sum of \$1,500,000 is appropriated from the general fund  
6 to Tanana Valley Community College for phase II design for a campus  
7 facility.

8 \* Sec. 10. The sum of \$4,100,000 is appropriated from the general fund  
9 to the University of Alaska for construction of a forestry sciences  
10 laboratory at the Juneau campus.

11 \* Sec. 11. The sum of \$570,000 is appropriated from the general fund to  
12 Sitka Community College for phase II design of a classroom facility.

13 \* Sec. 12. The sum of \$3,040,000 is appropriated from the general fund  
14 to the Northwest Arctic School District for construction of facilities at  
15 Selawik, Buckland, Deering and Ambler.

16 \* Sec. 13. The sum of \$1,340,000 is appropriated from the general fund  
17 to the Bering Strait School District for construction of high school  
18 classrooms at Savoonga.

19 \* Sec. 14. The sum of \$1,542,000 is appropriated from the general fund  
20 to the Lower Yukon School District for construction of facilities at Hooper  
21 Bay and Alakanuk.

22 \* Sec. 15. The sum of \$3,468,000 is appropriated from the general fund  
23 to the Department of Education for the Chatham School District for  
24 construction of school facilities at Klukwan.

25 \* Sec. 16. The sum of \$3,200,000 is appropriated from the general fund  
26 to the Iditarod School District for construction of school facilities at  
27 Nikolai and McGrath.

28 \* Sec. 17. The sum of \$2,000,000 is appropriated from the general fund  
29 to the Kuspuk School District for construction of school facilities at

1 Stony River and Chuathbaluk.

2 \* Sec. 18. The sum of \$7,305,000 is appropriated from the general fund  
3 to the Lower Kuskokwim School District for construction of school  
4 facilities at Kwethluk, Bethel and Nightmute.

5 \* Sec. 19. The sum of \$350,000 is appropriated from the general fund to  
6 the Yukon Flats School District for purchase and improvements for  
7 relocatables.

8 \* Sec. 20. The sum of \$2,000,000 is appropriated from the general fund  
9 to the Yukon-Koyukuk School District for facilities code upgrade.

10 \* Sec. 21. The sum of \$300,000 is appropriated from the general fund to  
11 the St. Mary's School District for upgrade of the elementary school at St.  
12 Mary's.

13 \* Sec. 22. The sum of \$1,800,000 is appropriated from the general fund  
14 to the Yukon Flats School District for construction of the Northern Lights  
15 school.

16 \* Sec. 23. The sum of \$2,400,000 is appropriated from the general fund  
17 to the Fairbanks North Star Borough for major repairs and rehabilitation of  
18 borough schools.

19 \* Sec. 24. The sum of \$2,307,000 is appropriated from the general fund  
20 to the Fairbanks North Star Borough for fire and life safety code upgrades  
21 of borough schools.

22 \* Sec. 25. The sum of \$2,900,000 is appropriated from the general fund  
23 to the King Cove School District for construction of school facilities at  
24 King Cove.

25 \* Sec. 26. The sum of \$4,535,000 is appropriated from the general fund  
26 to the Southwest Region School District for construction of school  
27 facilities at Levelock and Clark's Point.

28 \* Sec. 27. The sum of \$1,300,000 is appropriated from the general fund  
29 to the Alaska Gateway School District for code upgrade and multi-purpose

1 room addition at Dot Lake.

2 \* Sec. 28. The sum of \$900,000 is appropriated from the general fund to  
3 the Nenana School District for school code upgrade and roof repair at  
4 Nenana.

5 \* Sec. 29. The sum of \$895,000 is appropriated from the general fund to  
6 the Delta-Greely School District for completion of the vocational education  
7 facility at Delta Junction.

8 \* Sec. 30. The appropriations made by Secs. 1-11 of this Act are for  
9 capital projects and are subject to AS 37.25.020.

10 \* Sec. 31. This Act takes effect immediately in accordance with AS 01.-  
11 10.070(c).

Offered: 2/25/83  
Referred: Finance

Original Sponsors: Kerttula, Sturgulewski,  
Josephson, et al

Funding Information

|              |                     |
|--------------|---------------------|
| General Fund | \$82,761,000        |
| Other Funds  | -0-                 |
|              | <u>\$82,761,000</u> |

1 IN THE SENATE

BY THE FINANCE COMMITTEE

2 CS FOR SENATE BILL NO. 18 (Finance)

3 IN THE LEGISLATURE OF THE STATE OF ALASKA

4 THIRTEENTH LEGISLATURE - FIRST SESSION

5 A BILL

6 For an Act entitled: "An Act making special appropriations for certain  
7 capital projects and planning for educational  
8 facilities; and providing for an effective date."

9 BE IT ENACTED BY THE LEGISLATURE OF THE STATE OF ALASKA:

10 \* Section 1. The sum of \$25,300,000 is appropriated from the general  
11 fund to the University of Alaska for construction of classroom facilities  
12 at the Anchorage campus.

13 \* Sec. 2. The sum of \$1,000,000 is appropriated from the general fund  
14 to the Anchorage Community College for design of a classroom and adminis-  
15 trative facility.

16 \* Sec. 3. The sum of \$3,800,000 is appropriated from the general fund  
17 to the University of Alaska for construction of an agricultural classroom  
18 facility at the Matanuska-Susitna Community College.

19 \* Sec. 4. The sum of \$450,000 is appropriated from the general fund to  
20 Prince William Sound Community College for design of a classroom,  
21 laboratory and office facility.

22 \* Sec. 5. The sum of \$50,000 is appropriated from the general fund to  
23 the Anchorage Community College for planning and design of outreach facil-  
24 ities for Eagle River and South Anchorage.

25 \* Sec. 6. The sum of \$1,500,000 is appropriated from the general fund  
26 to the University of Alaska for design of classroom facilities at the  
27 Fairbanks campus.

28 \* Sec. 7. The sum of \$600,000 is appropriated from the general fund to  
29 the University of Alaska for the petroleum engineering building at the

1 Fairbanks campus.

2 \* Sec. 8. The sum of \$2,300,000 is appropriated from the general fund  
3 to the University of Alaska for construction of the Duckering Building  
4 addition at the Fairbanks campus.

5 \* Sec. 9. The sum of \$1,500,000 is appropriated from the general fund  
6 to Tanana Valley Community College for phase II design for a campus  
7 facility.

8 \* Sec. 10. The sum of \$4,100,000 is appropriated from the general fund  
9 to the University of Alaska for construction of a forestry sciences  
10 laboratory at the Juneau campus.

11 \* Sec. 11. The sum of \$570,000 is appropriated from the general fund to  
12 Sitka Community College for phase II design of a classroom facility.

13 \* Sec. 12. The sum of \$3,040,000 is appropriated from the general fund  
14 to the Northwest Arctic School District for construction of facilities at  
15 Selawik, Buckland, Deering and Ambler.

16 \* Sec. 13. The sum of \$1,340,000 is appropriated from the general fund  
17 to the Bering Strait School District for construction of high sch  
18 classrooms at Savoonga.

19 \* Sec. 14. The sum of \$1,542,000 is appropriated from the general fund  
20 to the Lower Yukon School District for construction of facilities at Hooper  
21 Bay and Alakanuk.

22 \* Sec. 15. The sum of \$3,468,000 is appropriated from the general fund  
23 to the Department of Education for the Chatham School District for  
24 construction of school facilities at Klukwan.

25 \* Sec. 16. The sum of \$3,200,000 is appropriated from the general fund  
26 to the Iditarod School District for construction of school facilities at  
27 Nikolai and McGrath.

28 \* Sec. 17. The sum of \$2,000,000 is appropriated from the general fund  
29 to the Kuspuk School District for construction of school facilities at

1 Stony River and Chuathbaluk.

2 \* Sec. 18. The sum of \$7,305,000 is appropriated from the general fund  
3 to the Lower Kuskokwim School District for construction of school  
4 facilities at Kwethluk, Bethel and Nightmute.

5 \* Sec. 19. The sum of \$350,000 is appropriated from the general fund to  
6 the Yukon Flats School District for purchase and improvements for  
7 relocatables.

8 \* Sec. 20. The sum of \$2,000,000 is appropriated from the general fund  
9 to the Yukon-Koyukuk School District for facilities code upgrade.

10 \* Sec. 21. The sum of \$300,000 is appropriated from the general fund to  
11 the St. Mary's School District for upgrade of the elementary school at St.  
12 Mary's.

13 \* Sec. 22. The sum of \$1,800,000 is appropriated from the general fund  
14 to the Yukon Flats School District for construction of the Northern Lights  
15 school.

16 \* Sec. 23. The sum of \$2,400,000 is appropriated from the general fund  
17 to the Fairbanks North Star Borough for major repairs and rehabilitation of  
18 borough schools.

19 \* Sec. 24. The sum of \$2,307,000 is appropriated from the general fund  
20 to the Fairbanks North Star Borough for fire and life safety code upgrades  
21 of borough schools.

22 \* Sec. 25. The sum of \$2,900,000 is appropriated from the general fund  
23 to the King Cove School District for construction of school facilities at  
24 King Cove.

25 \* Sec. 26. The sum of \$4,535,000 is appropriated from the general fund  
26 to the Southwest Region School District for construction of school  
27 facilities at Levelock and Clark's Point.

28 \* Sec. 27. The sum of \$1,300,000 is appropriated from the general fund  
29 to the Alaska Gateway School District for code upgrade and multi-purpose

1 room addition at Dot Lake.

2 \* Sec. 28. The sum of \$900,000 is appropriated from the general fund to  
3 the Nenana School District for school code upgrade and roof repair at  
4 Nenana.

5 \* Sec. 29. The sum of \$895,000 is appropriated from the general fund to  
6 the Delta-Greely School District for completion of the vocational education  
7 facility at Delta Junction.

8 \* Sec. 30. The appropriations made by Secs. 1-11 of this Act are for  
9 capital projects and are subject to AS 37.25.020.

10 \* Sec. 31. This Act takes effect immediately in accordance with AS 01.-  
11 10.070(c).

Offered: 2/25/83  
Referred: Finance

Original Sponsors: Kerttula, Sturgulewski,  
Josephson, et al

Funding Information  
General Fund \$82,761,000  
Other Funds - -0-  
\$82,761,000

1 IN THE SENATE

BY THE FINANCE COMMITTEE

2 CS FOR SENATE BILL NO. 18 (Finance)

3 IN THE LEGISLATURE OF THE STATE OF ALASKA

4 THIRTEENTH LEGISLATURE - FIRST SESSION

5 A BILL

6 For an Act entitled: "An Act making special appropriations for certain  
7 capital projects and planning for educational  
8 facilities; and providing for an effective date."

9 BE IT ENACTED BY THE LEGISLATURE OF THE STATE OF ALASKA:

10 \* Section 1. The sum of \$25,300,000 is appropriated from the general  
11 fund to the University of Alaska for construction of classroom facilities  
12 at the Anchorage campus.

13 \* Sec. 2. The sum of \$1,000,000 is appropriated from the general fund  
14 to the Anchorage Community College for design of a classroom and adminis-  
15 trative facility.

16 \* Sec. 3. The sum of \$3,800,000 is appropriated from the general fund  
17 to the University of Alaska for construction of an agricultural classroom  
18 facility at the Matanuska-Susitna Community College.

19 \* Sec. 4. The sum of \$450,000 is appropriated from the general fund to  
20 Prince William Sound Community College for design of a classroom,  
21 laboratory and office facility.

22 \* Sec. 5. The sum of \$50,000 is appropriated from the general fund to  
23 the Anchorage Community College for planning and design of outreach facil-  
24 ities for Eagle River and South Anchorage.

25 \* Sec. 6. The sum of \$1,500,000 is appropriated from the general fund  
26 to the University of Alaska for design of classroom facilities at the  
27 Fairbanks campus.

28 \* Sec. 7. The sum of \$600,000 is appropriated from the general fund to  
29 the University of Alaska for the petroleum engineering building at the

1 Fairbanks campus.

2 \* Sec. 8. The sum of \$2,300,000 is appropriated from the general fund  
3 to the University of Alaska for construction of the Duckering Building  
4 addition at the Fairbanks campus.

5 \* Sec. 9. The sum of \$1,500,000 is appropriated from the general fund  
6 to Tanana Valley Community College for phase II design for a campus  
7 facility.

8 \* Sec. 10. The sum of \$4,100,000 is appropriated from the general fund  
9 to the University of Alaska for construction of a forestry sciences  
10 laboratory at the Juneau campus.

11 \* Sec. 11. The sum of \$570,000 is appropriated from the general fund to  
12 Sitka Community College for phase II design of a classroom facility.

13 \* Sec. 12. The sum of \$3,040,000 is appropriated from the general fund  
14 to the Northwest Arctic School District for construction of facilities at  
15 Selawik, Buckland, Deering and Ambler.

16 \* Sec. 13. The sum of \$1,340,000 is appropriated from the general fund  
17 to the Bering Strait School District for construction of high school  
18 classrooms at Savoonga.

19 \* Sec. 14. The sum of \$1,542,000 is appropriated from the general fund  
20 to the Lower Yukon School District for construction of facilities at Hooper  
21 Bay and Alakanuk.

22 \* Sec. 15. The sum of \$3,468,000 is appropriated from the general fund  
23 to the Department of Education for the Chatham School District for  
24 construction of school facilities at Klukwan.

25 \* Sec. 16. The sum of \$3,200,000 is appropriated from the general fund  
26 to the Iditarod School District for construction of school facilities at  
27 Nikolai and McGrath.

28 \* Sec. 17. The sum of \$2,000,000 is appropriated from the general fund  
29 to the Kuspuk School District for construction of school facilities at

1 Stony River and Chuathbaluk.

2 \* Sec. 18. The sum of \$7,305,000 is appropriated from the general fund  
3 to the Lower Kuskokwim School District for construction of school  
4 facilities at Kwethluk, Bethel and Nightmute.

5 \* Sec. 19. The sum of \$350,000 is appropriated from the general fund to  
6 the Yukon Flats School District for purchase and improvements for  
7 relocatables.

8 \* Sec. 20. The sum of \$2,000,000 is appropriated from the general fund  
9 to the Yukon-Koyukuk School District for facilities code upgrade.

10 \* Sec. 21. The sum of \$300,000 is appropriated from the general fund to  
11 the St. Mary's School District for upgrade of the elementary school at St.  
12 Mary's.

13 \* Sec. 22. The sum of \$1,800,000 is appropriated from the general fund  
14 to the Yukon Flats School District for construction of the Northern Lights  
15 school.

16 \* Sec. 23. The sum of \$2,400,000 is appropriated from the general fund  
17 to the Fairbanks North Star Borough for major repairs and rehabilitation of  
18 borough schools.

19 \* Sec. 24. The sum of \$2,307,000 is appropriated from the general fund  
20 to the Fairbanks North Star Borough for fire and life safety code upgrades  
21 of borough school.

22 \* Sec. 25. The sum of \$2,900,000 is appropriated from the general fund  
23 to the King Cove School District for construction of school facilities at  
24 King Cove.

25 \* Sec. 26. The sum of \$4,535,000 is appropriated from the general fund  
26 to the Southwest Region School District for construction of school  
27 facilities at Levelock and Clark's Point.

28 \* Sec. 27. The sum of \$1,300,000 is appropriated from the general fund  
29 to the Alaska Gateway School District for code upgrade and multi-purpose

1 room addition at Dot Lake.

2 \* Sec. 28. The sum of \$900,000 is appropriated from the general fund to  
3 the Nenana School District for school code upgrade and roof repair at  
4 Nenana.

5 \* Sec. 29. The sum of \$895,000 is appropriated from the general fund to  
6 the Delta-Greely School District for completion of the vocational education  
7 facility at Delta Junction.

8 \* Sec. 30. The appropriations made by Secs. 1-11 of this Act are for  
9 capital projects and are subject to AS 37.25.020.

10 \* Sec. 31. This Act takes effect immediately in accordance with AS 01.-  
11 10.070(c).

Offered: 2/25/83  
Referred: Finance

Original Sponsors: Kerttula, Sturgulewski,  
Josephson, et al

Funding Information

|              |                     |
|--------------|---------------------|
| General Fund | \$82,761,000        |
| Other Funds  | -0-                 |
|              | <u>\$82,761,000</u> |

1 IN THE SENATE

BY THE FINANCE COMMITTEE

2 CS FOR SENATE BILL NO. 18 (Finance)

3 IN THE LEGISLATURE OF THE STATE OF ALASKA

4 THIRTEENTH LEGISLATURE - FIRST SESSION

5 A BILL

6 For an Act entitled: "An Act making special appropriations for certain  
7 capital projects and planning for educational  
8 facilities; and providing for an effective date."

9 BE IT ENACTED BY THE LEGISLATURE OF THE STATE OF ALASKA:

10 \* Section 1. The sum of \$25,300,000 is appropriated from the general  
11 fund to the University of Alaska for construction of classroom facilities  
12 at the Anchorage campus.

13 \* Sec. 2. The sum of \$1,000,000 is appropriated from the general fund  
14 to the Anchorage Community College for design of a classroom and adminis-  
15 trative facility.

16 \* Sec. 3. The sum of \$3,800,000 is appropriated from the general fund  
17 to the University of Alaska for construction of an agricultural classroom  
18 facility at the Matanuska-Susitna Community College.

19 \* Sec. 4. The sum of \$450,000 is appropriated from the general fund to  
20 Prince William Sound Community College for design of a classroom,  
21 laboratory and office facility.

22 \* Sec. 5. The sum of \$50,000 is appropriated from the general fund to  
23 the Anchorage Community College for planning and design of outreach facil-  
24 ities for Eagle River and South Anchorage.

25 \* Sec. 6. The sum of \$1,500,000 is appropriated from the general fund  
26 to the University of Alaska for design of classroom facilities at the  
27 Fairbanks campus.

28 \* Sec. 7. The sum of \$600,000 is appropriated from the general fund to  
29 the University of Alaska for the petroleum engineering building at the

1 Fairbanks campus.

2 \* Sec. 8. The sum of \$2,300,000 is appropriated from the general fund  
3 to the University of Alaska for construction of the Duckering Building  
4 addition at the Fairbanks campus.

5 \* Sec. 9. The sum of \$1,500,000 is appropriated from the general fund  
6 to Tanana Valley Community College for phase II design for a campus  
7 facility.

8 \* Sec. 10. The sum of \$4,100,000 is appropriated from the general fund  
9 to the University of Alaska for construction of a forestry sciences  
10 laboratory at the Juneau campus.

11 \* Sec. 11. The sum of \$570,000 is appropriated from the general fund to  
12 Sitka Community College for phase II design of a classroom facility.

13 \* Sec. 12. The sum of \$3,040,000 is appropriated from the general fund  
14 to the Northwest Arctic School District for construction of facilities at  
15 Selawik, Buckland, Deering and Ambler.

16 \* Sec. 13. The sum of \$1,340,000 is appropriated from the general fund  
17 to the Bering Strait School District for construction of high school  
18 classrooms at Savoonga.

19 \* Sec. 14. The sum of \$1,542,000 is appropriated from the general fund  
20 to the Lower Yukon School District for construction of facilities at Hooper  
21 Bay and Alakanuk.

22 \* Sec. 15. The sum of \$3,468,000 is appropriated from the general fund  
23 to the Department of Education for the Chatham School District for  
24 construction of school facilities at Klukwan.

25 \* Sec. 16. The sum of \$3,200,000 is appropriated from the general fund  
26 to the Iditarod School District for construction of school facilities at  
27 Nikolai and McGrath.

28 \* Sec. 17. The sum of \$2,000,000 is appropriated from the general fund  
29 to the Kuspuk School District for construction of school facilities at

1 Stony River and Chuathbaluk.

2 \* Sec. 18. The sum of \$7,305,000 is appropriated from the general fund  
3 to the Lower Kuskokwim School District for construction of school  
4 facilities at Kwethluk, Bethel and Nightmute.

5 \* Sec. 19. The sum of \$350,000 is appropriated from the general fund to  
6 the Yukon Flats School District for purchase and improvements for  
7 relocatables.

8 \* Sec. 20. The sum of \$2,000,000 is appropriated from the general fund  
9 to the Yukon-Koyukuk School District for facilities code upgrade.

10 \* Sec. 21. The sum of \$300,000 is appropriated from the general fund to  
11 the St. Mary's School District for upgrade of the elementary school at St.  
12 Mary's.

13 \* Sec. 22. The sum of \$1,800,000 is appropriated from the general fund  
14 to the Yukon Flats School District for construction of the Northern Lights  
15 school.

16 \* Sec. 23. The sum of \$2,400,000 is appropriated from the general fund  
17 to the Fairbanks North Star Borough for major repairs and rehabilitation of  
18 borough schools.

19 \* Sec. 24. The sum of \$2,307,000 is appropriated from the general fund  
20 to the Fairbanks North Star Borough for fire and life safety code upgrades  
21 of borough schools.

22 \* Sec. 25. The sum of \$2,900,000 is appropriated from the general fund  
23 to the King Cove School District for construction of school facilities at  
24 King Cove.

25 \* Sec. 26. The sum of \$4,535,000 is appropriated from the general fund  
26 to the Southwest Region School District for construction of school  
27 facilities at Levelock and Clark's Point.

28 \* Sec. 27. The sum of \$1,300,000 is appropriated from the general fund  
29 to the Alaska Gateway School District for code upgrade and multi-purpose

1 room addition at Dot Lake.

2 \* Sec. 28. The sum of \$900,000 is appropriated from the general fund to  
3 the Nenana School District for school code upgrade and roof repair at  
4 Nenana.

5 \* Sec. 29. The sum of \$895,000 is appropriated from the general fund to  
6 the Delta-Greely School District for completion of the vocational education  
7 facility at Delta Junction.

8 \* Sec. 30. The appropriations made by Secs. 1-11 of this Act are for  
9 capital projects and are subject to AS 37.25.020.

10 \* Sec. 31. This Act takes effect immediately in accordance with AS 01.-  
11 10.070(c).

Referred: Finance

3/31/83

Original Sponsors: Kerttula, Sturgulewski,  
Josephson, et al

|                            |              |
|----------------------------|--------------|
| <u>Funding Information</u> |              |
| General Fund               | \$60,290,520 |
| Other Funds                | -0-          |
|                            | <hr/>        |
|                            | \$60,290,520 |

1 IN THE SENATE

BY THE FINANCE COMMITTEE

2 CS FOR SENATE BILL NO. 18 (Finance)

3 IN THE LEGISLATURE OF THE STATE OF ALASKA

4 THIRTEENTH LEGISLATURE - FIRST SESSION

5 A BILL

6 For an Act entitled: "An Act making special appropriations for certain  
7 capital projects and planning for educational  
8 facilities; and providing for an effective date."

9 BE IT ENACTED BY THE LEGISLATURE OF THE STATE OF ALASKA:

10 \* Sec. 1. The sum of \$3,040,000 is appropriated from the general fund  
11 to the Northwest Arctic School District for construction of facilities at  
12 Selawik, Buckland, Deering and Ambler.

13 \* Sec. 2. The sum of \$1,340,000 is appropriated from the general fund  
14 to the Bering Strait School District for construction of high school  
15 classrooms at Savoonga.

16 \* Sec. 3. The sum of \$1,542,000 is appropriated from the general fund  
17 to the Lower Yukon School District for construction of facilities at Hooper  
18 Bay and Alakanuk.

19 \* Sec. 4. The sum of \$3,468,000 is appropriated from the general fund  
20 to the Department of Education for the Chatham School District for  
21 construction of school facilities at Klukwan.

22 \* Sec. 5. The sum of \$3,200,000 is appropriated from the general fund  
23 to the Iditarod School District for construction of school facilities at  
24 Nikolai and McGrath.

25 \* Sec. 6. The sum of \$2,000,000 is appropriated from the general fund  
26 to the Kuspuk School District for construction of school facilities at  
27 Stony River and Chuathbaluk.

28 \* Sec. 7. The sum of \$6,749,000 is appropriated from the general fund  
29 to the Lower Kuskokwim School District for construction of school

1 facilities at Kwethluk, Nightmute, Kilbuk, Nelson Island, Kwigillingok, and  
2 Kipnuk.

3 \* Sec. 8. The sum of \$2,000,000 is appropriated from the general fund  
4 to the Yukon-Koyukuk School District for facilities code upgrade.

5 \* Sec. 9. The sum of \$300,000 is appropriated from the general fund to  
6 the St. Mary's School District for upgrade of the elementary school at St.  
7 Mary's.

8 \* Sec. 10. The sum of \$906,000 is appropriated from the general fund to  
9 the Yukon Flats School District for relocatables and district code upgrade.

10 \* Sec. 11. The sum of \$2,400,000 is appropriated from the general fund  
11 to the Fairbanks North Star Borough for major repairs and rehabilitation of  
12 borough schools.

13 \* Sec. 12. The sum of \$2,307,000 is appropriated from the general fund  
14 to the Fairbanks North Star Borough for handicapped, fire and life safety  
15 code upgrades of borough schools.

16 \* Sec. 13. The sum of \$2,900,000 is appropriated from the general fund  
17 to the King Cove School District for construction of school facilities at  
18 King Cove.

19 \* Sec. 14. The sum of \$4,535,000 is appropriated from the general fund  
20 to the Southwest Region School District for construction of school  
21 facilities at Levelock and Clark's Point.

22 \* Sec. 15. The sum of \$1,300,000 is appropriated from the general fund  
23 to the Alaska Gateway School District for code upgrade and multi-purpose  
24 room addition at Dot Lake.

25 \* Sec. 16. The sum of \$900,000 is appropriated from the general fund to  
26 the Nenana School District for school code upgrade and roof repair at  
27 Nenana.

28 \* Sec. 17. The sum of \$895,000 is appropriated from the general fund to  
29 the Delta-Greely School District for completion of the vocational education

1 facility at Delta Junction.

2 \* Sec. 18. The sum of \$12,858,520 is appropriated from the general fund  
3 to the Department of Education for the Anchorage School District for school  
4 health, safety and emergency repairs and other projects.

5 \* Sec. 19. The sum of \$3,550,000 is appropriated from the general fund  
6 to the Department of Education for the Matanuska-Susitna Borough School  
7 District for district-wide school facilities maintenance and upgrade.

8 \* Sec. 20. The sum of \$4,100,000 is appropriated from the general fund  
9 to the Skagway City School District for the purpose of construction of  
10 school facilities at Skagway.

11 \* Sec. 21. The appropriations made by this Act are for capital projects  
12 and are subject to AS 37.25.020.

13 \* Sec. 22. This Act takes effect immediately in accordance with AS 01.-  
14 10.070(c).

15  
16  
17  
18  
19  
20  
21  
22  
23  
24  
25  
26  
27  
28  
29  
X

COMMITTEE REPORT  
HOUSE

(11)

FURTHER:

5/3/83

Date: 6-22-83

Mr. Speaker:

The Committee on FINANCE has had CSSB 19(Fin)(Title Chng.)  
(etc fld)

"An Act making special appropriations for postsecondary education, capital projects and land acquisition for educational purposes."

under consideration and reports it back as follows:

- do pass  do not pass
- do pass with attached amendments(s)
- replace with <sup>H</sup>CS for CSSB 19 (Hess)  same title  
 new title
- and recommends No Recommendation
- AND <sup>submits separate</sup> attaches a "Letter of Intent"  New Fiscal Note
- reports it back without recommendation  Zero Fiscal Note Attached
- referred to the \_\_\_\_\_ Committee

MEMBERS SIGNING  
DO PASS

\_\_\_\_\_

Paul F. Starnoff

\_\_\_\_\_

\_\_\_\_\_

\_\_\_\_\_

\_\_\_\_\_

\_\_\_\_\_

\_\_\_\_\_

MEMBERS HAVING  
OTHER RECOMMENDATIONS:

Edith Wood Kline

Gene Ward No Rec

V. V. K... ..

Gene... ..

Don... ..

Don... .. (no rec)

Albert... .. Do NOT Pass

Chairman  
CHAIRMAN

Offered: 5/3/83  
Referred: Finance

Original sponsors: Kerttula, Sturgulewski,  
Jrsephson, et al

Funding Information  
General Fund \$30,957,000  
Other Funds -0-  
\$30,957,000

BY THE HEALTH, EDUCATION AND  
SOCIAL SERVICES COMMITTEE

1 IN THE SENATE

2 HOUSE CS FOR CS FOR SENATE BILL NO. 19 (HESS)

3 IN THE LEGISLATURE OF THE STATE OF ALASKA

4 THIRTEENTH LEGISLATURE - FIRST SESSION

5 A BILL

6 For an Act entitled: "An Act making special appropriations for postsecon-  
7 dary education, capital projects and land acquisition  
8 for educational purposes."

9 BE IT ENACTED BY THE LEGISLATURE OF THE STATE OF ALASKA:

10 \* Section 1. The sum of \$9,900,000 is appropriated from the general  
11 fund to the University of Alaska for acquisition of approximately 40 acres  
12 of land from Alaska Pacific University under an option-to-purchase agree-  
13 ment executed in June 1982 for the Anchorage campus.

14 \* Sec. 2. The sum of \$11,000,000 is appropriated from the general fund  
15 to the University of Alaska for construction of student housing at the  
16 Fairbanks campus.

17 \* Sec. 3. The sum of \$500,000 is appropriated from the general fund to  
18 the University of Alaska for access acquisition and road construction for  
19 student housing at the Juneau campus.

20 \* Sec. 4. The sum of \$650,000 is appropriated from the general fund to  
21 the University of Alaska for planning, including preparation of engineering  
22 plans, for student housing at the Kenai Community College campus.

23 \* Sec. 5. The sum of \$2,200,000 is appropriated from the general fund  
24 to the University of Alaska for the construction of student housing at the  
25 Kuskokwim Community College campus.

26 \* Sec. 6. The sum of \$107,000 is appropriated from the general fund to  
27 the University of Alaska to be used to move an office building in Bethel to  
28 the Kuskokwim Community College campus.

29 \* Sec. 7. The sum of \$6,600,000 is appropriated from the general fund

1 to the Department of Education for payment of a grant to the Northwest  
2 Arctic School District for construction of student housing at the Kotzebue  
3 Technical Center.

4 \* Sec. 8. The appropriation made by sec. 1 of this Act lapses into the  
5 general fund July 1, 1984.

6 \* Sec. 9. The appropriations made by secs. 2 - 7 of this Act are for  
7 capital projects and are subject to AS 37.25.020.

Sponsors: Faiks, Fischer, V., Josephson,  
Ray

SENATE LETTER OF INTENT RE CSSB 19 (Finance)

It is the intention of the Senate that construction of student housing at the University of Alaska-Anchorage and the Anchorage Community College, and the University of Alaska-Juneau, shall proceed as expeditiously as possible.

The FY 83 capital supplemental appropriation bill, now before the Governor, contains design funds for these projects.

Sec. 1 of CSSB 19 also contains 9.9 million dollars for necessary land acquisition in Anchorage, related to student housing.

It is the intention of the Senate that construction funds for student housing at these campuses will be appropriated when the projects are design-ready and the land is in state ownership.

Adopted by the Senate 4/7/83

Offered: 5/3/83  
Referred: Finance

Original sponsors: Kerttula, Sturgulewski,  
Josephson, et al

Funding Information  
General Fund \$30,957,000  
Other Funds -0-  
\$30,957,000

BY THE HEALTH, EDUCATION AND  
SOCIAL SERVICES COMMITTEE

1 IN THE SENATE

2 HOUSE CS FOR CS FOR SENATE BILL NO. 19 (HESS)

3 IN THE LEGISLATURE OF THE STATE OF ALASKA

4 THIRTEENTH LEGISLATURE - FIRST SESSION

5 A BILL

6 For an Act entitled: "An Act making special appropriations for postsecond-  
7 dary education, capital projects and land acquisition  
8 for educational purposes."

9 BE IT ENACTED BY THE LEGISLATURE OF THE STATE OF ALASKA:

10 \* Section 1. The sum of \$9,900,000 is appropriated from the general  
11 fund to the University of Alaska for acquisition of approximately 40 acres  
12 of land from Alaska Pacific University under an option-to-purchase agree-  
13 ment executed in June 1982 for the Anchorage campus.

14 \* Sec. 2. The sum of \$11,000,000 is appropriated from the general fund  
15 to the University of Alaska for construction of student housing at the  
16 Fairbanks campus.

17 \* Sec. 3. The sum of \$500,000 is appropriated from the general fund to  
18 the University of Alaska for access acquisition and road construction for  
19 student housing at the Juneau campus.

20 \* Sec. 4. The sum of \$650,000 is appropriated from the general fund to  
21 the University of Alaska for planning, including preparation of engineering  
22 plans, for student housing at the Kenai Community College campus.

23 \* Sec. 5. The sum of \$2,200,000 is appropriated from the general fund  
24 to the University of Alaska for the construction of student housing at the  
25 Kuskokwim Community College campus.

26 \* Sec. 6. The sum of \$107,000 is appropriated from the general fund to  
27 the University of Alaska to be used to move an office building in Bethel to  
28 the Kuskokwim Community College campus.

29 \* Sec. 7. The sum of \$6,600,000 is appropriated from the general fund

1 to the Department of Education for payment of a grant to the Northwest  
2 Arctic School District for construction of student housing at the Kotzebue  
3 Technical Center.

4 \* Sec. 8. The appropriation made by sec. 1 of this Act lapses into the  
5 general fund July 1, 1984.

6 \* Sec. 9. The appropriations made by secs. 2 - 7 of this Act are for  
7 capital projects and are subject to AS 37.25.020.

C O R R E C T I O N

Discard CSSB19(FIN)(TITLE CHNG)(EFDPLD)  
and retain this corrected version.

Offered: 3/25/83  
Referred: Rules

Original sponsors: Kerttula, Sturgulewski,  
Josephson, et al

Funding Information  
General Fund \$30,307,000  
Other Funds -0-  
\$30,307,000

1 IN THE SENATE BY THE FINANCE COMMITTEE  
2 CS FOR SENATE BILL NO. 19(Finance)(title change)(efd failed)  
3 IN THE LEGISLATURE OF THE STATE OF ALASKA  
4 THIRTEENTH LEGISLATURE - FIRST SESSION  
5 A BILL  
6 For an Act entitled: "An Act making special appropriations for postsec-  
7 dary education, capital projects and land acquisition  
8 for educational purposes."  
9 BE IT ENACTED BY THE LEGISLATURE OF THE STATE OF ALASKA:  
10 \* Section 1. The sum of \$9,900,000 is appropriated from the general  
11 fund to the University of Alaska for acquisition of approximately 40 acres  
12 of land from Alaska Pacific University under an option to purchase agree-  
13 ment executed in June 1982 for the Anchorage campus.  
14 \* Sec. 2. The sum of \$11,000,000 is appropriated from the general fund  
15 to the University of Alaska for construction of student housing at the  
16 Fairbanks campus.  
17 \* Sec. 3. The sum of \$500,000 is appropriated from the general fund to  
18 the University of Alaska for access acquisition and road construction for  
19 student housing at the Juneau campus.  
20 \* Sec. 4. The sum of \$6,600,000 is appropriated from the general fund  
21 to the Northwest Arctic School District for construction of student housing  
22 at the Kotzebue Technical Center.  
23 \* Sec. 5. The sum of \$2,200,000 is appropriated from the general fund  
24 to the University of Alaska for the construction of student housing at the  
25 Kuskokwim Community College campus.  
26 \* Sec. 6. The sum of \$107,000 is appropriated from the general fund to  
27 the University of Alaska to be used to move an office building in Bethel to  
28 the Kuskokwim Community College campus.  
29 \* Sec. 7. The appropriation made by sec. 1 of this Act lapses into the

1 general fund July 1, 1984.

2 \* Sec. 8. The appropriations made by secs. 2 - 6 of this Act are for  
3 capital projects and are subject to AS 37.25.020.

COMMITTEE REPORT  
SENATE

FURTHER:

2/21/83

Date: 3/25/83

Mr. President:

The Committee on FINANCE has had SB 19

Making appropriations to the University of Alaska for construction of dormitory complexes; eff. date

under consideration and (a majority of the committee) (the committee) reports it back with the following recommendations:

- do pass  do not pass
- do pass with attached amendments(s)
- replace with CS for SB 19 (Finance)  same title  
 new title
- and recommends no pass
- AND attaches a "Letter of Intent"  New Fiscal Note
- reports it back without recommendation
- referred to the \_\_\_\_\_ Committee

MEMBERS SIGNING  
DO PASS

MEMBERS HAVING  
OTHER RECOMMENDATIONS:

[Signature]

[Signature]

[Signature]

\_\_\_\_\_

\_\_\_\_\_

\_\_\_\_\_

\_\_\_\_\_

\_\_\_\_\_

\_\_\_\_\_

[Signature]

\_\_\_\_\_

\_\_\_\_\_

\_\_\_\_\_

\_\_\_\_\_

[Signature]

CHAIRMAN

Offered: 2/21/83  
Referred: Finance

Original sponsors: Kerttula, Sturgulewski,  
Josephson, et al

Funding Information

General Fund \$53,250,000  
Other Funds -0-  
~~\$53,250,000~~ 30,307,000

*BY THE Finance Committee*  
~~BY THE HEALTH, EDUCATION AND  
SOCIAL SERVICES COMMITTEE~~

1 IN THE SENATE

2 CS FOR SENATE BILL NO. 19 *Finance* ~~(HESS)~~

3 IN THE LEGISLATURE OF THE STATE OF ALASKA

4 THIRTEENTH LEGISLATURE - FIRST SESSION

5 A BILL

6 For an Act entitled: "An Act making special appropriations for capital  
7 ~~projects and land acquisition to be used for~~  
8 ~~Alaska for student housing and land acquisition; and~~  
9 ~~educational purposes~~  
10 ~~providing for an effective date."~~

11 BE IT ENACTED BY THE LEGISLATURE OF THE STATE OF ALASKA:

12 \* Section 1. The sum of \$9,900,000 is appropriated from the general  
13 fund to the University of Alaska for acquisition of <sup>approximately 40 acres of land</sup> ~~land~~ for the Anchorage <sup>from Alaska Pacific University</sup>  
14 campus. <sup>under</sup> ~~and purchase~~ <sup>an opti.</sup> ~~agreement executed~~

15 <sup>in Jan. of 1980</sup> ~~Sec. 2. The sum of \$1,000,000 is appropriated from the general fund~~  
16 ~~to the University of Alaska for planning, including preparation of engi-~~  
17 ~~neering plans, for student housing at the Anchorage campus.~~

18 \* Sec. <sup>2</sup> ~~3~~. The sum of \$11,000,000 is appropriated from the general fund  
19 to the University of Alaska for construction of student housing at the  
20 Fairbanks campus.

21 \* Sec. <sup>3</sup> ~~4~~. The sum of <sup>500,000</sup> ~~\$1,000,000~~ is appropriated from the general fund  
22 to the University of Alaska for planning, <sup>necessacquisitions and road construction</sup> ~~including preparation of engi-~~  
23 ~~neering plans, for student housing at the Juneau campus.~~

24 \* Sec. 5. The sum of \$650,000 is appropriated from the general fund to  
25 the University of Alaska for planning, including preparation of engineering  
26 plans, for student housing at the Kenai Community College campus.

27 \* Sec. 6. The sum of \$10,000,000 is appropriated from the general fund  
28 to the University of Alaska for construction of student housing at the  
29 University of Alaska, Anchorage and the Anchorage Community College  
30 campuses.

31 \* Sec. 7. The sum of \$13,200,000 is appropriated from the general fund

1 ~~to the University of Alaska for construction of student housing at the~~  
2 ~~Juneau campus.~~

3 \* ~~Sec. 8. The sum of \$6,500,000 is appropriated from the general fund~~  
4 ~~to the University of Alaska for construction of student housing at the~~  
5 ~~Kenai Community College campus.~~

6 \* Sec. ~~7~~<sup>7</sup>. The appropriation made by sec. 1 of this Act lapses into the  
7 general fund July 1, 1984.

8 \* Sec. ~~10~~<sup>8</sup>. The appropriations made by secs. 2 - ~~8~~<sup>6</sup> of this Act are for  
9 capital projects and are subject to AS 37.25.020.

10 \* Sec. ~~11~~<sup>9</sup>. Sections 1 - ~~5~~<sup>6</sup> of this Act takes effect immediately in  
11 accordance with AS 01.10.070(c).

12 ~~\* Sec. 12. Sections 6 - 8 of this Act take effect May 1, 1984.~~

*Add* →

Sec. 4. The sum of \$6,600,000 is appropriated from the general fund to the Northwest Arctic School District for construction of student housing at the Kotzebue Technical Center.

Sec. 5. The sum of \$2,200,000 is appropriated from the general fund to the University of Alaska for the construction of student housing at the Kuskokwim Community College campus.

Sec. 6. The sum of \$107,000 is appropriated from the general fund to the University of Alaska to be used to move an office building in Bethel to the Kuskokwim Community College campus.

CS 5B <sup>19</sup> ~~18~~ (Finance)  
working from (Hess) CS

53,250,000

Delete

|                                  |            |            |
|----------------------------------|------------|------------|
| Sec. 2                           | 1,000,000  |            |
| Sec. 3/4                         |            |            |
| (reduce 1,000,000<br>to 500,000) | 500,000    |            |
| Sec. 5                           | 650,000    |            |
| Sec. 6                           | 10,000,000 |            |
| Sec. 7                           | 13,200,000 |            |
| Sec. 8                           | 6,500,000  |            |
|                                  | <hr/>      |            |
|                                  | 31,850,000 |            |
|                                  |            | <hr/>      |
|                                  |            | 31,850,000 |
|                                  |            | <hr/>      |
|                                  |            | 21,400,000 |

Add. New Sec.'s

|        |           |              |
|--------|-----------|--------------|
| Sec. 4 | 6,600,000 |              |
| Sec. 5 | 2,200,000 |              |
| Sec. 6 | 107,000   |              |
|        | <hr/>     |              |
|        | 8,907,000 |              |
|        |           | <hr/>        |
|        |           | 8,907,000    |
|        |           | <hr/>        |
|        |           | # 30,307,000 |



F/KCC

University of Alaska  
P.O. Box 368 • Bethel, Alaska 99559  
(907) 543-2621

February 18, 1983

Senator John Sackett  
Alaska State Legislature  
Pouch U  
Juneau, Alaska 99811

Dear John:

I am writing to update you on the status of the office building released by the Department of Administration to the Community College.

We have had difficulty in obtaining cost estimates to move the building from its present location at the old PHS Hospital site to the College. The contractors that we have contacted in Bethel have indicated the building is oversized and, therefore, will be costly to move. To date we have not been able to secure detailed cost estimates from the local contractors.

Working with the University's Division of Facilities Planning, we have, however, developed the following estimates to relocate the building to our campus.

Site Work

|   |           |
|---|-----------|
| Fill with Classified - 900 cu. yd. @ \$10/yd. | \$ 9,000  |
| Install Freeze Back Piling - 14 @ \$1,200 ea. | 16,800    |
| Install 12x12 Beams - 4 @ \$750 each          | 3,000     |
|   | <hr/>     |
|   | \$ 28,800 |

Move Building

|                        |                   |        |
|------------------------|-------------------|--------|
| Disconnect Utilities - |                   |        |
| Electrical             | 4 hrs. @ \$50/hr. | 200    |
| Plumbing (sewage)      | 8 hrs. @ \$60/hr. | 480    |
| Plumbing (water)       | 4 hrs. @ \$60/hr. | 240    |
| Mechanical (oil)       | 1 hr. @ \$50/hr.  | 50     |
|                        |                   | <hr/>  |
|                        |                   | \$ 970 |

Senator John Sackett  
Page Two  
February 18, 1983

Disconnect Sections

|                       |                     |                  |
|-----------------------|---------------------|------------------|
| Labor                 | 80 hrs. @ \$45/hr.  | \$ 3,600         |
| Move Sections to Site | 1000/Section        | 5,000            |
| Set Sections on Site  | 80 hrs. @ \$45/hr.  | 3,600            |
| Rent Crane            | 80 hrs. @ \$100/hr. | 8,000            |
|                       |                     | <u>\$ 20,200</u> |

Install New Roof

|                |                  |           |
|----------------|------------------|-----------|
| Labor/Material | 2200 SF @ \$6/SF | \$ 13,500 |
|----------------|------------------|-----------|

Mechanical

|                     |                    |          |
|---------------------|--------------------|----------|
| Sewage Connection - |                    |          |
| Labor               | 40 hrs. @ \$60/hr. | \$ 2,400 |
| Material            |                    | 2,000    |
| Install Oil Tank    |                    | 1,000    |

Water

|                       |                    |          |
|-----------------------|--------------------|----------|
| Labor                 | 20 hrs. @ \$60/hr. | \$ 1,200 |
| Trench/Labor/Material | 200' @ \$12.50/ft. | 5,000    |

Power

|                     |  |        |
|---------------------|--|--------|
| Connect New Service |  | \$ 500 |
| New Ground System   |  | 1,000  |

Exterior Modifications

|                   |                    |                  |
|-------------------|--------------------|------------------|
| Install New Entry | 60 hrs. @ \$50/hr. | \$ 3,000         |
| Install New Ramp  | 200 SF @ \$40/SF   | 8,000            |
|                   |                    | <u>\$ 11,000</u> |

Interior Modifications

|        |                     |                 |
|--------|---------------------|-----------------|
| Carpet | 2200 SF @ \$3.40/SF | \$ 7,480        |
| Base   | 700 LF @ \$2/LF     | 1,400           |
|        |                     | <u>\$ 8,880</u> |

Sub Total \$ 96,450

Contingency @ 10% 9,645

TOTAL \$ 106,095

Sorry for the delay in getting this information to you. Obtaining good cost data has been much more difficult than expected.

If you need additional information, please contact me.

Sincerely,

Fred Ali  
Campus President

FA:mw

SFC 3/10/83  
Ferguson offered

ADD ON SB19

- \* The sum of \$2,200,000 is appropriated from the general fund to the University of Alaska for the construction of student housing at the Kuskokwim Community College campus.



KUSKOKWIM COMMUNITY COLLEGE

University of Alaska  
P.O. Box 368 907 - 543-2621  
Bethel, Alaska 99559

Representative Anthony Vaska  
Alaska State Legislature  
Pouch V (MS. 3100)  
Juneau, Alaska 99811

Dear Tony:

As we have discussed on numerous occasions, student housing is the single most important need at Kuskokwim Community College. The ability of the College to meet the post-secondary educational needs of this region is dependent upon the provision of stable, student housing in Bethel. Your support for our student housing project is greatly appreciated.

Over the past two months I have been working with local contractors and the University's Division of Facilities Planning to develop cost estimates for the proposed housing complex. We are still working with two design concepts: duplexes or a single dormitory building. Our Community College Council will make a final decision on the type of housing desired following further discussion with faculty, students, and community members. In the interim, we have developed cost estimates that would allow for the construction of a single dormitory or duplexes to house approximately 40-45 students. These costs are as follows:

|                                      |              |
|--------------------------------------|--------------|
| Design planning and engineering..... | \$185,000.00 |
| Construction.....                    | 1,807,500.00 |
| Equipment and occupancy costs.....   | 97,500.00    |
| Construction management costs.....   | 110,000.00.. |

---

TOTAL COST            \$2,200,000.00

Life cycle cost information, comparing duplex vs. dormitory construction, is being developed by the Division of Facilities Planning. This information will be used by the College Council in making a final decision on the design of the housing project.

If you have any questions regarding the cost estimates or if you need additional information, please contact me.

Sincerely,

Fred Ali, Campus President

FEB 7 1983



KUSKOKWIM COMMUNITY COLLEGE

University of Alaska  
P.O. Box 368 907 - 543-2621  
Bethel, Alaska 99559

February 2, 1983

Senator John Sackett  
Alaska State Legislature  
Pouch U  
Juneau, Alaska 99811

Dear John:

In January I forwarded a letter to your office outlining preliminary cost estimates for student housing in Bethel. The purpose of this letter is to provide you with additional information on our student housing request.

Kuskokwim Community College has always enrolled students from the villages within its service area. From 1975 to 1980 the College leased an apartment building owned by the Bethel Native Corporation for student housing. A number of problems were associated with this arrangement. The building was not designed as a dormitory and major architectural changes would have been necessary to efficiently house students. Rental costs had escalated to the point where financial aid was not sufficient to cover housing costs. Finally, the building was located some distance from the College making transportation for students difficult, especially in inclement weather. In 1980, therefore, the College cancelled its lease of the building.

There is no doubt that the absence of a student housing facility in Bethel has adversely effected student enrollment. Currently, village students must live with relatives or in boarding homes. Our Student Services Division finds that there are a limited number of acceptable boarding homes in Bethel, approximately 30 to 35. Therefore, full-time student enrollments are restricted by the lack of acceptable housing in Bethel. When the apartment building was being used as a student dormitory, the College enrolled between 70 to 100 full-time students. Currently, full-time student enrollment averages between 40 and 50.

Based on existing instructional and student financial aid resources available to the College and its students, a full-time student population of between 65-70 students appears optimum. The College's student housing proposal envisions construction of a facility that would house between 40-45 students. The balance of the full-time students would either be Bethel residents or continue to live in boarding homes. Discussions with students on campus indicate that a small percentage would prefer to remain in boarding homes even with the availability of University-owned housing.

**KUSKOKWIM COMMUNITY COLLEGE**  
University of Alaska

Senator John Sackett  
February 2, 1983  
Page 2

In addition to allowing the College to increase its full-time enrollment, there are other reasons that support the request for student housing in Bethel. Students living in boarding homes often confront problems that hinder their ability to study and remain in school. Many of the boarding homes are small and a space for quiet study is not available. Meal times and other household schedules and requirements can conflict with the class schedules and needs of the student. Additionally, many boarding homes are some distance from the main campus which makes transportation difficult.

Many parents in the Delta are also reluctant to have their children attend school in Bethel because of student housing problems. Parents would like the College to guarantee that their children will be housed in a comfortable environment where personal security and group discipline are ensured. In public meetings throughout the region, I have repeatedly been told by parents that they would feel comfortable sending their children to college in Bethel if well maintained housing were available. It is our judgement that construction of University-owned and maintained housing on our campus in Bethel is the most effective method of providing the residential and learning environment desired by students and parents of this region.

The proposal to build student housing on the College campus has received broad support throughout the Delta. Enclosed are resolutions and letters of support for student housing received by the College during the past two years. I am also forwarding copies of floor plans developed by the University's Division of Facilities Planning and Construction. As we have discussed, the College is considering two design concepts for student housing: duplexes or a single dormitory building. The drawings outline floor plans for each of these concepts.

As we develop additional information on the student housing proposal, I will forward it to your office. If you have any questions or need specific information, please contact me.

Sincerely,

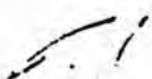

Fred Ali  
Campus President

FA:mw

Enclosures



# CITY OF BETHEL

P.O. Box 388 • Bethel, Alaska 99559

543-2297—Area Code 907

March 16, 1982

The Honorable Nels Anderson  
Senator, State of Alaska  
Pouch V  
Juneau, Alaska 99811

Dear Senator Anderson:

At its February 8, 1982 City Council meeting, a resolution was passed in support of a college dormitory for the Kuskokwim Community College in Bethel. As Mayor of Bethel, I would encourage your support for this project.

The Kuskokwim Community College has struggled with fluctuating student enrollments for the past several years, due not only to program needs but even more critically, housing. As an observer of this situation over the last several years, I have watched K.C.C. attempt to resolve its housing in several unsuccessful ways. A student dormitory, on campus, appears to be the most viable solution. Students from regional villages need the stability, companionship and continuity that an on-campus dormitory can provide.

Thank you for your continued support,

Sincerely,

John Guinn,  
Mayor

JG:kcc

RESOLUTION # 366

A RESOLUTION OF THE CITY COUNCIL OF THE CITY OF BETHEL SUPPORTING THE KUSKOKWIM COMMUNITY COLLEGE'S EFFORTS TO OBTAIN A STUDENT DORMITORY IN BETHEL.

WHEREAS, KUSKOKWIM COMMUNITY COLLEGE PROVIDES VALUED POSTSECONDARY EDUCATIONAL PROGRAMS TO BETHEL AND THE YUKON/KUSKOKWIM DELTA, AND

WHEREAS, THE COLLEGE PROVIDES PROGRAMS WHICH ENHANCE THE DEVELOPMENT OF LOCAL COMMUNITIES, AND

WHEREAS, THE COLLEGE PROVIDES A FORUM FOR THE INVESTIGATION AND SHARING OF COMMUNITY CONCERNS, AND

WHEREAS, THERE IS AT PRESENT NO STABLE PROVISION FOR STUDENT HOUSING:  
AND

WHEREAS, STUDENT HOUSING WILL BECOME A MAJOR FACTOR IN THE CONTINUED ACCREDITATION OF KUSKOKWIM COMMUNITY COLLEGE.

NOWHEREFORE BE IT RESOLVED, THAT THE CITY OF BETHEL SUPPORTS KUSKOKWIM COMMUNITY COLLEGE'S EFFORT TO OBTAIN A STUDENT DORMITORY FOR THE HOUSING OF STUDENTS WHO COME INTO THE COLLEGE FROM THE 57 VILLAGES OF THE YUKON-KUSKOKWIM DELTA.

PASSED AND APPROVED:

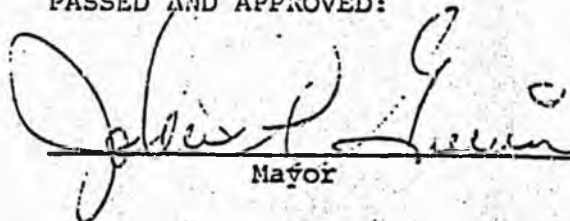
  
Mayor

ATTEST:

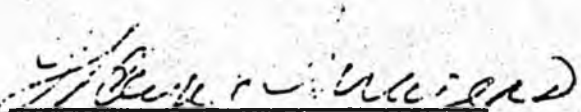
  
City Clerk

1 2/8/82

RESOLUTION S2-28

WHEREAS the Board of the Association of Village Council Presidents formed the AVCP Committee on Educational Development to advise the Board on matters educational and

WHEREAS the AVCP Committee on Educational Development requires, with rare exception, that first-year College students spend at least one semester at Kuskokwim Community College and

WHEREAS the majority of students funded by AVCP are from villages outside of Bethel and

WHEREAS housing for students in Bethel is extremely limited and

WHEREAS the Board and the President of Kuskokwim Community College are submitting a proposal to the Alaska State Legislature to appropriate funds to build a badly needed dormitory for our students:

NOW THEREFORE BE IT RESOLVED that the full Board of the Association of Village Council Presidents give its full support to the efforts of KCC to acquire funding for the dormitory.

ATTEST:

Edward Hoffmann Jr. CHAIRMAN

Mary Lee SECRETARY

RESOLUTION 82-28

WHEREAS the Board of the Association of Village Council Presidents formed the AVCP Committee on Educational Development to advise the Board on matters educational and

WHEREAS the AVCP Committee on Educational Development requires, with rare exception, that first-year College students spend at least one semester at Kuskokwim Community College and

WHEREAS the majority of students funded by AVCP are from villages outside of Bethel and

WHEREAS housing for students in Bethel is extremely limited and

WHEREAS the Board and the President of Kuskokwim Community College are submitting a proposal to the Alaska State Legislature to appropriate funds to build a badly needed dormitory for our students:

NOW THEREFORE BE IT RESOLVED that the full Board of the Association of Village Council Presidents give its full support to the efforts of KCC to acquire funding for the dormitory.

ATTEST:

Edward Hoffman Sr CHAIRMAN

Moses Paul SECRETARY

Lower Kuskokwim  
School District  
Resolution

82-05

WHEREAS, Kuskokwim Community College provides valued postsecondary educational programs to Bethel and the Yukon/Kuskokwim Delta; and

WHEREAS, the college provides programs which enhance the development of local communities; and

WHEREAS, the college provides a forum for the investigation and sharing of community concerns; and

WHEREAS, there is a severe housing shortage in Bethel; and

WHEREAS, there is at present no stable provision for student housing; and

WHEREAS, student housing will become a major factor in the continued accreditation of Kuskokwim Community College;

THEREFORE, BE IT RESOLVED that the Lower Kuskokwim School District Board of Education supports Kuskokwim Community College's efforts to obtain a student dormitory for the housing of students who come into the college from the 57 villages of the Yukon/Kuskokwim Delta.

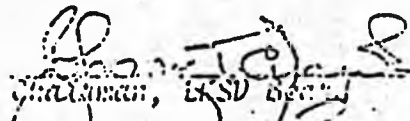
  
Chairman, LKSD Board

1-22-82  
Date

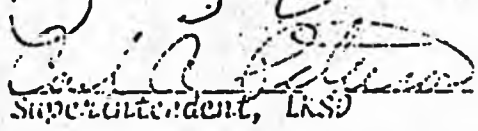
  
Superintendent, LKSD

22 / Jan / 82  
Date

TESTIMONY BEFORE THE HOUSE SUBCOMMITTEE ON THE UNIVERSITY BUDGET, FEBRUARY 1, 1983

Good morning Chairman Martin and members of the Subcommittee. My name is Moses Ayagalria. I am a full-time student at Kuskokwim Community College. I have been coming to school here since the Fall Semester. KCC is called a community college but the students here come from 50 villages scattered over 100,000 square miles. We all need suitable housing in order to get a good education. Just like all KCC students, I have been living in a boarding home. To live in a boarding home is no fun. It is no fun because it not only puts a burden on that family, but also on the student. The students suffer countless problems living in a boarding home, some of which are:

\*Housing in Bethel is inadequate. Families are large. Even when homes are suitable, there is no privacy.

\*The student can't burn midnight oil if he wants.

\*Young children in the boarding home are distracting for students doing homework.

\*Some boarding homes are a long distance from the College.

\*Students miss out on the social benefits of dormitory living.

What I would like to stress is that this institution is growing and is in need of student housing to accommodate that growth. The student housing will give a tremendous amount of encouragement to the students and to the potential students. A college education is becoming very important to young people in this region. However, many parents will not let their children come here to College because of the poor living situations they would encounter. I do not want to make myself too long on this subject lest our true need be obliterated. I only ask that our plea be considered for us and the future generation. Thank you.

Respectfully submitted,

*Moses Ayagalria*

3/22/83

Version #2  
Cook  
3/14/83 ✓

Original sponsors: Kerttula, Sturgulewski,  
Josephson, et al

3/25/83 Not Adopted

|                            |                     |
|----------------------------|---------------------|
| <u>Funding Information</u> |                     |
| General Fund               | \$63,307,000        |
| Other Funds                | -0-                 |
|                            | <u>\$63,307,000</u> |

1 IN THE SENATE

BY THE FINANCE COMMITTEE

2 CS FOR SENATE BILL NO. 19 (Finance)

3 IN THE LEGISLATURE OF THE STATE OF ALASKA

4 THIRTEENTH LEGISLATURE - FIRST SESSION

5 A BILL

6 For an Act entitled: "An Act making special appropriations for capital  
7 projects and land acquisition to be used for educa-  
8 tional purposes; and providing for an effective  
9 date."

10 BE IT ENACTED BY THE LEGISLATURE OF THE STATE OF ALASKA:

11 *Adopted* \* Section 1. The sum of \$9,900,000 is appropriated from the general  
12 fund to the University of Alaska for acquisition of land for the Anchorage  
13 campus. *Falks*  
*By 1000000 of ...*  
*also ...*

14 *Delete* ~~Sec. 2. The sum of \$1,000,000 is appropriated from the general fund~~  
15 ~~to the University of Alaska for planning, including preparation of engi-~~  
16 ~~neering plans, for student housing at the Anchorage campus.~~

17 *Adopted* \* Sec. 3. The sum of \$11,000,000 is appropriated from the general fund  
18 to the University of Alaska for construction of student housing at the  
19 Fairbanks campus. *Bennett*

20 *Adopted* \* Sec. 4. The sum of \$1,000,000 <sup>500,000</sup> is appropriated from the general fund  
21 to the University of Alaska for <sup>acquisition of ...</sup> planning, including preparation of engi-  
22 neering plans, for student housing at the Juneau campus.

23 *Delete* ~~Sec. 5. The sum of \$650,000 is appropriated from the general fund to~~  
24 ~~the University of Alaska for planning, including preparation of engineering~~  
25 ~~plans, for student housing at the Kenai Community College campus.~~

26 \* Sec. 6. The sum of \$6,600,000 is appropriated from the general fund  
27 to the Northwest Arctic School District for construction of student housing  
28 at the Kotzebue Technical Center.

29 \* Sec. 7. The sum of \$2,200,000 is appropriated from the general fund

*Sen. Fairbairn eliminate 5-10*

1 to the University of Alaska for the construction of student housing at the  
2 Kuskokwim Community College campus.

3 \* Sec. 8. The sum of \$7,000,000 is appropriated from the general fund  
4 to the Yukon-Koyukuk Regional Educational Attendance Area for phase I  
5 construction of the Ruby Technical Center.

6 \* Sec. 9. The sum of \$650,000 is appropriated from the general fund to  
7 the University of Alaska for the construction of the Galena Learning Cen-  
8 ter.

9 \* Sec. 10. The sum of \$107,000 is appropriated from the general fund to  
10 the University of Alaska to be used to move an office building in Bethel to  
11 the Kuskokwim Community College campus.

12 \* Sec. 11. The sum of \$10,000,000 is appropriated from the general fund  
13 to the University of Alaska for construction of student housing at the  
14 University of Alaska, Anchorage and the Anchorage Community College campus-  
15 es.

16 \* Sec. 12. The sum of \$13,200,000 is appropriated from the general fund  
17 to the University of Alaska for construction of student housing at the  
18 Juneau campus.

19 \* Sec. 13. The appropriation made by sec. 1 of this Act lapses into  
20 the general fund July 1, 1984.

21 \* Sec. 14. The appropriations made by secs. 2 - 12 of this Act are for  
22 capital projects and are subject to AS 37.25.020.

23 \* Sec. 15. Sections 1 - 10 of this Act takes effect immediately in  
24 accordance with AS 01.10.070(c).

25 \* Sec. 16. Sections 11 and 12 of this Act take effect May 1, 1984.  
26  
27  
28  
29

COMMITTEE REPORT  
SENATE

1/18/83

FURTHER: FINANCE

Date: 16 Feb, 1983

Mr. President:

The Committee on HEALTH, ED. & SOC. SERV has had SENATE BILL NO. 19

An Act making appropriations to the University of Alaska for construction of dormitory complexes: eff. date.

under consideration and (a majority of the committee) (the committee) reports it back with the following recommendations:

- do pass  do not pass
- do pass with attached amendments(s)
- replace with CS for SB 19 (HESS) with  new title  same title
- and recommends may be done
- AND with attaches a "Letter of Intent"  New Fiscal Note
- reports it back without recommendation
- referred to the \_\_\_\_\_ Committee

MEMBERS SIGNING  
DO PASS

V. T. Johnson

H. Pappas

Rick Halford

---

---

---

---

---

---

---

---

---

---

MEMBERS HAVING  
OTHER RECOMMENDATIONS:

---

---

---

---

---

---

---

---

---

---

Joe P. Johnson. do pass  
CHAIRMAN

February 16, 1983

HESS Committee Letter of Intent

Subject: CSSB 19 (Appropriations to University of Alaska  
for Student Housing and Land Acquisition)

Mr. President:

Your Committee on Health Education and Social Services has had Senate Bill 19 under consideration, and the Committee recommends that the Bill be replaced by Committee Substitute for Senate Bill 19, and that the Committee Substitute (CSSB 19) do pass.

The HESS Committee intends to reflect, through CSSB 19, a commitment that student housing on the Anchorage, Fairbanks, Juneau and Kenai campuses will be provided as expeditiously and cost-effectively as possible.

CSSB 19 contemplates that the University will expedite housing construction. Because architectural and engineering work for the Fairbanks (College) campus has been performed, actual construction at that location could begin during the 1983 construction season.

On the other campuses mentioned, architectural and engineering work is required to be done. Funds for that purpose are made available in CSSB 19. In addition, however, appropriations are also provided for construction at Anchorage, Juneau, and Kenai with an appropriation effective date of May 1, 1984. In this way, we avoid having to legislate for student housing appropriations in two separate measures and we stress our commitment to this program.

The May 1, 1984 appropriation effective date has another purpose. It permits the University to analyze, and to report to the second session of the Thirteenth Legislature in January, 1984 with respect to, the possibility of other funding options for student housing construction. For example, some mixture of revenue bonds, appropriations from the general fund, and private sector investment, might be appropriate in one or more of these cases and might provide student housing at housing rates affordable to Alaska students. If those possibilities can be demonstrated to exist, the second session of the Thirteenth Legislature could make necessary adjustments. If not, the appropriations for housing construction at Anchorage, Juneau and Kenai would be in place without the necessity of additional action by the Legislature.

*Joseph H. Josephson*

---

---

---

MAR 3 1983

Reminder - 3/4/83  
Not for distribution



Official Business

# Alaska State Legislature

Senate

Office of the President

*Paul*

Pouch V  
State Capitol  
Juneau, Alaska 99811

MEMORANDUM:

Date: February 28, 1983

To: Senator John Sackett, Chairman Senate Finance  
Senator Don Bennett, Chairman Senate Finance ✓

From: Senate President Jay Kerttula

RE: ~~SB19 amendment~~

To amend SB19, Section 1, to read "the sum of \$9,900,000.00 is appropriated from the general fund to the University of Alaska for the acquisition of approximately forty (40) acres of Alaska Pacific University land as per option to purchase agreement of FY 83.

I have contacted Legislative Legal Services to draft the above amendment.

JK/ak

EXCLUSIVE OPTION TO PURCHASE REAL PROPERTY

THIS AGREEMENT is made and entered into this 17th day of June, 1982, by and between Alaska Pacific University, an Alaska non-profit corporation (hereinafter referred to as "Optionor") whose address of record is President's Office, Alaska Pacific University, E. Wesley Drive, Anchorage, Alaska 99504, and the University of Alaska, a constitutional corporation (hereinafter referred to as "Optionee") whose address of record is President's Office, University of Alaska, 101 Bunnell Building, 303 Tanana Drive, Fairbanks, Alaska 99701.

WHEREAS, the parties were unsuccessful in their attempts to secure \$10,900,000 from the 1982 Legislature to effect an immediate sale of the following described real property, and

WHEREAS, the parties believe it is to their mutual advantage to secure the Optionee's right to purchase that property at a given price within a time certain in the future;

NOW, THEREFORE, the parties mutually agree as follows:

1. Exclusive Option to Purchase

Subject to the terms and conditions contained herein, Optionor grants Optionee an exclusive option to purchase that certain real property (hereinafter referred to as "Property") described as follows:

A portion of Section 28, Township 13 North, Range 3 West, Seward Meridian, Alaska, more particularly described as follows:

That portion of the Northeast quarter of the Southeast quarter and the Southeast quarter of the Northeast quarter of Section 28 lying west

9/25/82 XC CHRIS ATTY