

**HB**

**135**

<TARGET><BILL>HB 135</BILL><SUBJECT>HB  
135</SUBJECT><COMM>SRES28</COMM></TARGET>

# ALASKA STATE LEGISLATURE

Sen. Cathy Giessel, Chair  
Sen. Fred Dyson, Vice Chair  
Sen. Lesil McGuire  
Sen. Anna Fairclough  
Sen. Click Bishop  
Sen. Peter Micciche  
Sen. Hollis French



State Capitol, Room 427  
Juneau AK 99801-1182  
907-465-4843  
Fax: 907-465-3871  
800-465-4843

## Senate Resources Committee

Butrovich Room 205  
Monday, March 17, 2014  
3:30 p.m. - 5:00 p.m.

## AGENDA

- **HB 135 Petersville Recreational Mining Area**
  
- **SB 160 DNR: Hunting Guides, Concession Program**

Teleconference

# SENATE COMMITTEE REPORT

DATE: 3/12/14

FURTHER:

DATE TURNED IN TO OFFICE: 3/17/14

**Resources Committee** considered HOUSE BILL NO. 135

## HB 135-PETERSVILLE RECREATIONAL MINING AREA

"An Act relating to the reservation of certain mining claims from all uses incompatible with the purposes for establishing the Petersville Recreational Mining Area."

and recommends:

- be replaced with SCS \_\_\_\_\_ (\_\_\_\_\_)  Same Title  Technical Title Change  
 New Title/SCR No. \_\_\_\_\_
- adopt previous SCS \_\_\_\_\_ (\_\_\_\_\_)  Same Title  Technical Title Change  
 New Title/SCR No. \_\_\_\_\_
- attached amendment(s)
- adopt \_\_\_\_\_ Letter of Intent
- further referral to \_\_\_\_\_ Committee

| Dept Abbr. |     |
|------------|-----|
| ADM        | LWF |
| CED        | LAW |
| COR        | LEG |
| CRT        | MVA |
| EED        | DNR |
| DEC        | DPS |
| DFG        | REV |
| GOV        | DOT |
| DHS        | UA  |

| NEW FISCAL NOTE(S) |        |        |      |      |
|--------------------|--------|--------|------|------|
| Dept.              | Fiscal | Indet. | Zero | FN # |
|                    |        |        |      |      |
|                    |        |        |      |      |
|                    |        |        |      |      |
|                    |        |        |      |      |
|                    |        |        |      |      |
|                    |        |        |      |      |
|                    |        |        |      |      |

| PREVIOUS FISCAL NOTE(S) |        |        |      |      |
|-------------------------|--------|--------|------|------|
| Dept.                   | Fiscal | Indet. | Zero | FN # |
| DNR                     |        |        | ✓    | 1    |
|                         |        |        |      |      |
|                         |        |        |      |      |
|                         |        |        |      |      |
|                         |        |        |      |      |
|                         |        |        |      |      |
|                         |        |        |      |      |

APPROPRIATION - no fiscal note

| SIGNATURES AND RECOMMENDATIONS: | PRINTED LAST NAME | Do PASS | Do NOT PASS | No REC | AMEND |
|---------------------------------|-------------------|---------|-------------|--------|-------|
|                                 | MICCICHE          | ✓       |             |        |       |
|                                 | BISHOP            | ✓       |             |        |       |
|                                 | McCreure          | ✓       |             |        |       |
|                                 |                   |         |             |        |       |
|                                 |                   |         |             |        |       |
| CHAIR:                          | Dussan            | ✓       |             |        |       |
|                                 | Gessel            | ✓       |             |        |       |

# ALASKA STATE LEGISLATURE

***Interim:***

**600 East Railroad Avenue  
Wasilla, Alaska 99654  
Phone (907) 373-1842  
Fax: (907) 373-4729**



***Session:***

**State Capitol Building  
Juneau, Alaska 99801-1182  
Phone: (907) 465-2186  
Fax: (907) 465-3818**

## REPRESENTATIVE WES KELLER

### Sponsor Statement HB 135

**“An Act relating to the reservation of certain mining claims from all uses incompatible with the purposes for establishing the Petersville Recreational Mining Area.”**

House Bill 135 is legislation to correct errors made in 1997 which resulted in a section of the Petersville area remaining closed to recreational mining while two adjoining sections were opened. It was not the intent to keep this area closed but the language remains in place.

HB 135 gives the Department of Natural Resources the necessary language to negotiate with the federal Bureau of Land Management for transfer of the referenced southern region to the state. Once that transfer is complete the region can be opened to recreational mining with state oversight.

Your support of HB 135 will establish a clear definition of the specific areas to be freed up. It opens the door to transfer land from the feds, and adds approximately 200 acres of Alaska for resource development.

E-Mail: [Representative.Wes.Keller@akleg.gov](mailto:Representative.Wes.Keller@akleg.gov)  
Call Juneau Toll free: (800) 468-2186  
Website: [www.housemajority.org/keller/](http://www.housemajority.org/keller/)

# Fiscal Note

State of Alaska  
2014 Legislative Session

Bill Version: HB 135  
Fiscal Note Number: \_\_\_\_\_  
( ) Publish Date: \_\_\_\_\_

Identifier: HB135-DNR-MLW-2-14-14  
Title: PETERSVILLE RECREATIONAL MINING AREA  
Sponsor: KELLER  
Requester: House Resources

Department: Department of Natural Resources  
Appropriation: Land & Water Resources  
Allocation: Mining, Land & Water  
OMB Component Number: 3002

**Expenditures/Revenues**

Note: Amounts do not include inflation unless otherwise noted below.

(Thousands of Dollars)

|                               | FY2015                  | Included in               | Out-Year Cost Estimates |                |                |                |                |
|-------------------------------|-------------------------|---------------------------|-------------------------|----------------|----------------|----------------|----------------|
|                               | Appropriation Requested | Governor's FY2015 Request | FY 2016                 | FY 2017        | FY 2018        | FY 2019        | FY 2020        |
| <b>OPERATING EXPENDITURES</b> | <b>FY 2015</b>          | <b>FY 2015</b>            | <b>FY 2016</b>          | <b>FY 2017</b> | <b>FY 2018</b> | <b>FY 2019</b> | <b>FY 2020</b> |
| Personal Services             |                         |                           |                         |                |                |                |                |
| Travel                        |                         |                           |                         |                |                |                |                |
| Services                      |                         |                           |                         |                |                |                |                |
| Commodities                   |                         |                           |                         |                |                |                |                |
| Capital Outlay                |                         |                           |                         |                |                |                |                |
| Grants & Benefits             |                         |                           |                         |                |                |                |                |
| Miscellaneous                 |                         |                           |                         |                |                |                |                |
| <b>Total Operating</b>        | <b>0.0</b>              | <b>0.0</b>                | <b>0.0</b>              | <b>0.0</b>     | <b>0.0</b>     | <b>0.0</b>     | <b>0.0</b>     |

**Fund Source (Operating Only)**

|              |            |            |            |            |            |            |            |
|--------------|------------|------------|------------|------------|------------|------------|------------|
| None         |            |            |            |            |            |            |            |
| <b>Total</b> | <b>0.0</b> | <b>0.0</b> | <b>0.0</b> | <b>0.0</b> | <b>0.0</b> | <b>0.0</b> | <b>0.0</b> |

**Positions**

|           |  |  |  |  |  |  |  |
|-----------|--|--|--|--|--|--|--|
| Full-time |  |  |  |  |  |  |  |
| Part-time |  |  |  |  |  |  |  |
| Temporary |  |  |  |  |  |  |  |

**Change in Revenues**

|  |  |  |  |  |  |  |  |
|--|--|--|--|--|--|--|--|
|  |  |  |  |  |  |  |  |
|--|--|--|--|--|--|--|--|

Estimated SUPPLEMENTAL (FY2014) cost: 0.0 (separate supplemental appropriation required)  
(discuss reasons and fund source(s) in analysis section)

Estimated CAPITAL (FY2015) cost: 0.0 (separate capital appropriation required)  
(discuss reasons and fund source(s) in analysis section)

**ASSOCIATED REGULATIONS**

Does the bill direct, or will the bill result in, regulation changes adopted by your agency? No  
If yes, by what date are the regulations to be adopted, amended or repealed? N/A

**Why this fiscal note differs from previous version:**

|                 |
|-----------------|
| Initial Version |
|-----------------|

|   |                           |
|---|---------------------------|
| Prepared By: Brent Goodrum, Director    | Phone: (907)269-8600      |
| Division: Mining, Land & Water          | Date: 02/14/2014 05:00 PM |
| Approved By: Joe Balash, Commissioner   | Date: 02/14/14            |
| Agency: Department of Natural Resources |                           |

**FISCAL NOTE ANALYSIS**

**STATE OF ALASKA  
2014 LEGISLATIVE SESSION**

**BILL NO. HB135**

**Analysis**

HB 135 amends AS 46.23.630(f) by removing certain lands from the Petersville Recreational Mining Area.

DNR expects there to be no fiscal impact on the State and does not anticipate needing additional resources to implement these provisions.

# ALASKA STATE LEGISLATURE

**Interim:**

600 East Railroad Avenue  
Wasilla, Alaska 99654  
Phone (907) 373-1842  
Fax: (907) 373-4729



**Session:**

State Capitol Building  
Juneau, Alaska 99801-1182  
Phone: (907) 465-2186  
Fax: (907) 465-3818

## REPRESENTATIVE WES KELLER

### MEMO

To: Senator Cathy Giessel  
Chair, Senate Resources Committee

Fm: Rep. Wes Keller

A handwritten signature in black ink that reads "Wes Keller".

Date: March 6, 2014

Re: Request to hear HB 135 (28-LS0190\A)

---

Please consider this as a request to schedule HB 135, "An Act relating to the reservation of certain mining claims from all uses incompatible with the purposes for establishing the Petersville Recreational Mining Area" pending referral before the Senate Resources Committee. I have included a packet of information and an electronic version has been sent via email to staff.

HB 135 will allow the state to negotiate with the feds on the transfer of approximately 200 acres of land in the southern portion of the Petersville area of Alaska. It will correct an oversight that took place in 1997 when the district was inadvertently deleted from legislation that designated the Petersville mining district for recreational mining.

Passage of the bill will play a major role in transferring the land to the state. If you have questions please do not hesitate to contact my office.

The information contained in this memo is **CONFIDENTIAL** and/or privileged. This memo is intended to be reviewed initially by only the individual named above. If the reader of this page is not the intended recipient or a representative of the intended recipient, you are hereby notified that any review, dissemination, or copying of this memo or the information contained herein is prohibited. If you have received this memo in error, please immediately notify the sender by telephone and return this memo to the sender at the above address.

Thank you

E-Mail: [Representative.Wes.Keller@akleg.gov](mailto:Representative.Wes.Keller@akleg.gov)  
Call Juneau Toll free: (800) 468-2186  
Website: [www.akrepublicans.org/keller/](http://www.akrepublicans.org/keller/)

# LEGAL SERVICES

DIVISION OF LEGAL AND RESEARCH SERVICES  
LEGISLATIVE AFFAIRS AGENCY  
STATE OF ALASKA

(907) 465-3867 or 465-2450  
FAX (907) 465-2029  
Mail Stop 3101

State Capitol  
Juneau, Alaska 99801-1182  
Deliveries to: 129 6th St., Rm. 329

## MEMORANDUM

January 29, 2013

**SUBJECT:** Amending the land description for the Petersville Recreational Mining Area (Work Order No. 28-LS0190\A)

**TO:** Representative Wes Keller  
Att: Jim Freund

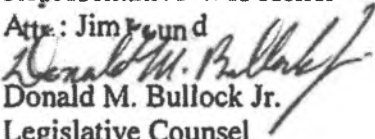
**FROM:**   
Donald M. Bullock Jr.  
Legislative Counsel

The bill delivered to you earlier amends the description of land and water that are included in the Petersville Recreational Mining Area (Petersville). You asked whether this bill violates the prohibition against local and special legislation in art. II, sec. 19, Constitution of the State of Alaska.<sup>1</sup> Passage of the bill is not prohibited by art. II, sec. 19.

The establishment of the area is authorized by art. VIII, sec. 7, Constitution of the State of Alaska. Section 7 authorizes the legislature to acquire special purpose sites and to preserve and administer the sites for the "use, enjoyment, and welfare of the people."<sup>2</sup> A description of the area is consistent with acquiring and administering a specific area for the people, and this bill amends the description of Petersville.

While a description of any limited area in the state is necessarily local, the constitutional authority to acquire and administer Petersville necessarily requires a description of the

---

<sup>1</sup> Article II, sec. 19. Local or Special Acts. The legislature shall pass no local or special act if a general act can be made applicable. Whether a general act can be made applicable shall be subject to judicial determination. Local acts necessitating appropriations by a political subdivision may not become effective unless approved by a majority of the qualified voters voting thereon in the subdivision affected.

<sup>2</sup> Article VIII, sec. 7. Special Purpose Sites.

The legislature may provide for the acquisition of sites, objects, and areas of natural beauty or of historic, cultural, recreational, or scientific value. It may reserve them from the public domain and provide for their administration and preservation for the use, enjoyment, and welfare of the people.



Representative Wes Keller  
January 29, 2013  
Page 2

area within Petersville. This bill amends the description of that area. Given the context, the local or special prohibition is likely inapplicable.

You may wish to review the reasons for excluding the mining claims listed in the bill. Although the designation of the specific area may be necessary for the establishment and administration of the area, the basis for excluding previously included land and water should be consistent with the management of Petersville for the people of the state.

If I may be of further assistance, please advise.

DMB:Ind  
13-050.Ind

# STATE OF ALASKA

DEPARTMENT OF NATURAL RESOURCES

DIVISION OF MINING, LAND AND WATER

SEAN PARNELL, GOVERNOR

DIRECTOR'S OFFICE  
550 W. 7<sup>th</sup> AVE., SUITE 1070  
ANCHORAGE, ALASKA 99501-3578

PHONE (907) 269-8800  
FAX (907) 269-8904

April 9, 2010

The Honorable Charlie Huggins  
Alaska State Senate  
State Capitol  
Juneau, Alaska 99801

Re: Your Letter of January 29, 2010 on the Petersville Recreational Mining Area

Dear Senator Huggins:

Your letter of January 29, 2010 asked what steps would be needed to reverse the recreational mining designation for the southern portion of the Petersville Recreational Mining Area. The Petersville Recreational Mining Area was enacted under House Bill 46 in 1997 and consists of two areas near Petersville. One area now open for recreational mining is referred to as the northern area and covers 300 acres. The other area is not yet state owned, therefore it is closed to recreational and other mining. This is referred to as the southern area covering 200 acres. The southern area is closed because the federal Bureau of Land Management (BLM) has not yet conveyed the land to the State. The holdup on conveyance has been because of a lease that the BLM is issuing to Michele Stevens for 5 acres within this southern area. We believe that the lease is scheduled to be issued in the near future. Since 1997, the northern recreational mining area has not had much use due in part to difficult access.

~~To terminate the legislative designation of the southern area, the enabling statute (AS 41.23.630) will need to be modified. In AS 41.23.630 - Petersville Recreational Mining Area, the following verbiage under Section (f)(1) would have to be removed from the statute in order eliminate the southern portion of the Petersville Recreational Mining Area:~~

[SECTIONS 21 AND 28; ALDER NO. 1; ALDER NO. 2; COTTONWOOD NO. 3; COTTONWOOD NO. 4; SEATTLE NO. 2; CONTACT NO. 1; CONTACT NO. 2; WILLOW CLAIM; KORTER BENCH.]

If the above statutory language were removed, the Commissioner of DNR would then need to issue a Mineral Opening Order to make these lands open to mineral entry (under AS 38.05.185). The land transfer from the BLM would also need to occur before the lands can be open to mineral entry, although "At Risk" claims could be staked by anyone prior to the land transfer. These at risk claims would

*"Develop, Conserve, and Enhance Natural Resources for Present and Future Alaskans."*

convert to regular state claims following conveyance of the lands to the State by the BLM.

We believe that these recreational mining areas represent a unique opportunity for weekend enthusiasts and visitors to our State to enjoy the outdoors and the fun of non-mechanized mining. If the area is open to mining claims, we expect that a few recreational suction dredge miners may object to then being locked out by the new claimants that would stake mining claims. Other than Ms. Stevens, DNR has not heard from any other members of the public that the Recreational Mining Area should be terminated. In addition, there is no assurance that Michelle Stevens would be the first to stake claims for the law is in favor of whoever stakes the claim first after the land becomes open. It is likely that a number of claimants would end up with conflicting claims. It is likely that the Department of Fish and Game may have concerns about any large-scale mining on the active portion of the Creek.

Please feel free to contact me if you would like additional information.

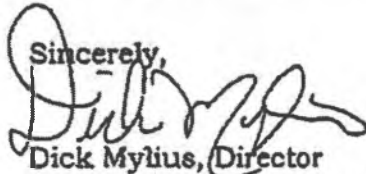
Sincerely,  

Dick Mylius, Director  
DNR Division of Mining, Land and Water

cc: Michele Stevens  
Tom Irwin, Commissioner, DNR  
Rick Fredericksen, DNR, DMLW, Mining Section Chief

### Article 3. RECREATIONAL MINING AREAS

#### Section

- 600. Purpose.
- 610. Management and regulations.
- 620. Caribou Creek Recreational Mining Area.
- 630. Petersville Recreational Mining Area.

#### **Sec. 41.23.600. Purpose.**

The purpose of AS 41.23.600 - 41.23.620 is to establish the area described in AS 41.23.620 as the Caribou Creek Recreational Mining Area. The Caribou Creek Recreational Mining Area is established to provide for a public recreational mining area to permit public recreational activities and to allow other multiple use activities to continue as long as the activities do not detract from the primary purpose for the establishment of the Caribou Creek Recreational Mining Area.

(( 1 ch 67 SLA 1990))

#### **Sec. 41.23.610. Management and regulations.**

(a) The commissioner is responsible for the management of the surface and subsurface estate within the Caribou Creek Recreational Mining Area necessary to carry out the purposes of AS 41.23.600. The commissioner shall adopt and may revise a management plan and shall adopt regulations for the management, use, and development of the Caribou Creek Recreational Mining Area.

(b) The management plan, including any revisions, and regulations adopted by the commissioner shall be developed in consultation with the commissioner of fish and game and the commissioner of transportation and public facilities. The management plan and regulations shall address, but not be limited to,

- (1) the methods of mining permitted within the Caribou Creek Recreational Mining Area;
- (2) the types of mining equipment that may be used within the Caribou Creek Recreational Mining Area;
- (3) the protection of habitat within the Caribou Creek Recreational Mining Area; and
- (4) other restrictions consistent with the purposes stated in AS 41.23.600.

(c) Except as provided in this subsection, the Caribou Creek Recreational Mining Area is open to recreational mining under AS 41.23.600 - 41.23.620. The commissioner of fish and game is responsible for the management of the fish and game resources and the public use of fish and wildlife resources within the Caribou Creek Recreational Mining Area consistent with the purposes stated in AS 41.23.600. The commissioner of fish and game shall issue a general permit to the public authorizing recreational mining activities subject to seasonal restrictions on the mining activities within specified waterbody areas necessary to maintain fishery resources within the Caribou Creek Recreational Mining Area.

(d) The Caribou Creek Recreational Mining Area is closed to mineral entry under AS 38.05.185 - 38.05.275.

(e) The commissioner shall permit the construction and realignment of the Glenn Highway by the commissioner of transportation and public facilities within the Caribou Creek Recreational Mining Area as follows:

- (1) Township 20 North, Range 10 East, Seward Meridian

Section 29: The centerline of the realigned Glenn Highway is described as commencing at the Southwest corner of Section 29; thence on a state plane, Zone 4 bearing of North 2 degrees 09'55" West, along the West boundary of Section 29, 1481.55 feet to proposed centerline Station 692+58.19 and the True Point of Beginning; thence South 85 degrees 52'40" East, a distance of 3395.32 feet to proposed centerline Station 726+53.51; thence along a curve to the left, having a radius of 916.73 feet, through an arc of 121 degrees 37'14", a distance of 1945.93 feet to P.C.C. Station 745+99.44; thence along a compound curve to the left, having a radius of 1637.02 feet, through an arc of 30 degrees 01'50", a distance of 858.01 feet to Point of Tangent Station 754+57.45; thence North 57 degrees 31'44" West, a distance of 453.00 feet to P.C. Station 759+10.45; thence along a curve to the right, having a radius of 996.45 feet, through an arc of 144 degrees 30'28", a distance of 2513.18 feet to Point of Tangent Station 784+23.63 BACK = 741+49.55 AHEAD; thence North 86 degrees 58'44" East, a distance of 1347.13 feet to Station 754+96.68, a point on the east boundary of Section 29, said point is South 2 degrees 09'55" East, a distance of 115.88 feet from the Northeast corner of Section 29;

(2) the right-of-way lines that cross Caribou Creek Recreational Mining Area extend varying distances from the centerline as follows:

(A) from Station 760+00 to Station 765+00 the right-of-way extends 300 feet on the left of centerline and 150 feet on the right;

(B) from Station 765+00 to Station 780+00, the right-of-way extends 300 feet on each side of the centerline;

(C) from Station 780+00 to P.T. Station 784+23.63 the right-of-way extends 300 feet on the left and 400 feet to the right of the centerline.

(( 1 ch 67 SLA 1990))

#### **Sec. 41.23.620. Caribou Creek Recreational Mining Area.**

The vacant and unappropriated state-owned land and water and the state land and water acquired in the future that lie within 100 feet of either ordinary high water or mean high tide of the banks of the creeks or rivers described in this section are designated as the Caribou Creek Recreational Mining Area, are reserved from all uses incompatible with the purposes of AS 41.23.600, and are assigned to the department for control and management:

Township 20 North, Range 10 East, Seward Meridian

(1) That portion of Caribou Creek located in

Section 28: W1/2

Section 29: E1/2

(2) That portion of the Matanuska River located in

Section 32: SE1/4

Section 33: NE1/4, NW1/4, SW1/4.

(( 1 ch 67 SLA 1990; am 6 ch 9 SLA 1994))

#### **Sec. 41.23.630. Petersville Recreational Mining Area.**

(a) The purpose of this section is to establish the area described in (f) of this section as the Petersville Recreational Mining Area. The Petersville Recreational Mining Area is established to provide for a public recreational mining area to permit public recreational activities and to allow

other multiple-use activities to continue as long as the activities do not detract from the primary purpose for the establishment of the Petersville Recreational Mining Area.

(b) The commissioner is responsible for the management of the surface and subsurface estate within the Petersville Recreational Mining Area necessary to carry out the purposes of this section. The commissioner shall adopt and may revise a management plan and shall adopt regulations for the management, use, and development of the Petersville Recreational Mining Area. The management plan, including any revisions, and regulations adopted by the commissioner shall be developed in consultation with the commissioner of fish and game and the commissioner of transportation and public facilities. The management plan and regulations must address, but not be limited to,

(1) the methods of mining permitted within the Petersville Recreational Mining Area;

(2) the types of mining equipment that may be used within the Petersville Recreational Mining Area;

(3) the protection of habitat within the Petersville Recreational Mining Area; and

(4) other restrictions consistent with the purposes stated in this section.

(c) Except as provided in this subsection, the Petersville Recreational Mining Area is open to recreational mining under this section. The commissioner of fish and game is responsible for the management of the fish and game resources and the public use of fish and wildlife resources within the Petersville Recreational Mining Area consistent with the purposes stated in this section. The commissioner of fish and game shall issue a general permit to the public authorizing recreational mining activities subject to seasonal restrictions on the mining activities within specified waterbody areas necessary to maintain fishery resources within the Petersville Recreational Mining Area.

(d) The Petersville Recreational Mining Area is closed to mineral entry under AS 38.05.185 - 38.05.275.

(e) The commissioner shall permit the construction and realignment of the Petersville Road within the Petersville Recreational Mining Area as is determined necessary by the commissioner of transportation and public facilities.

(f) The vacant and unappropriated state-owned land and water and the state land and water acquired in the future that lie within the following described mining claims described in United States Mineral Survey No. 2384 are reserved from all uses incompatible with the purposes of this section and are assigned to the department for control and management as the Petersville Recreational Mining Area:

(1) Township 28 North, Range 8 West, Seward Meridian

Sections 6 - 8: Daisy No. 2; Hidden Treasure No. 1; Hidden Treasure No. 2; Flora No. 1; Flora No. 2; Moose No. 1; Beaver No. 1; Alexander No. 1; Alexander No. 2; Lost Shovel No. 1; Lost Shovel No. 2; Peters Creek No. 8; Peters Creek No. 9; Peters Creek No. 10; Peters Creek No. 11;

Sections 21 and 28: Alder No. 1; Alder No. 2; Cottonwood No. 3; Cottonwood No. 4; Seattle No. 1; Seattle No. 2; Contact No. 1; Contact Claim No. 2; Willow Claim; Korter Bench.

(2) Township 28 North, Range 9 West, Seward Meridian

Section 1: Daisy No. 2; Hidden Treasure No. 1.

(( 18 ch 56 SLA 1997))

SEC 21 TOWNSHIP 28N RANGE 8W OF THE SEWARD MERIDIAN, ALASKA

LEGEND

BASE INFORMATION

- TELEGRAPHY
- SURVEY LINE
- SURVEY LOT LINE
- TOWNSHIP/SECTION GRID
- 1/4 SECTION LINE
- HIGHWAY
- ROAD
- TRAIL
- RAILROAD
- • • • • QUADRANT BOUNDARY LINE
- • • • • SECTION LINE
- • • • • SECTION
- • • • • AIRPORT AIRSIDE STRIP
- • • • • HORIZONTAL CENTERLINE
- • • • • WATER WOUND

STATUS INFORMATION

- TITLE
- BOUNDARY
- CLASSIFICATION
- USFS/BLM
- MUNICIPAL
- COUNTY
- FEDERAL ACTION
- MENTAL HEALTH TRUST
- • • • • LIMB OF ACTION
- • • • • NATIONAL AID
- • • • • CABIN PERMIT
- • • • • TRAPPER CABIN PERMIT
- • • • • TRESPASS LOCATION
- • • • • SURFACE WATER RIGHTS APPLICATION PERMIT
- • • • • CERTIFICATE
- • • • • NON-SURFACE WATER RIGHTS APPLICATION PERMIT
- • • • • CERTIFICATE
- • • • • IN STREAM FISH REGENERATION APPLICATION
- • • • • CERTIFICATE
- • • • • BANK WORK BARBER APPLICATION PERMIT
- • • • • CERTIFICATE

6 5 4 3 2 1  
 S 2 1 2  
 10 11 16 14 15  
 18 20 22 23 24  
 2 10 12 17 18 20  
 17 18 23 24 25 26

VICINITY MAP

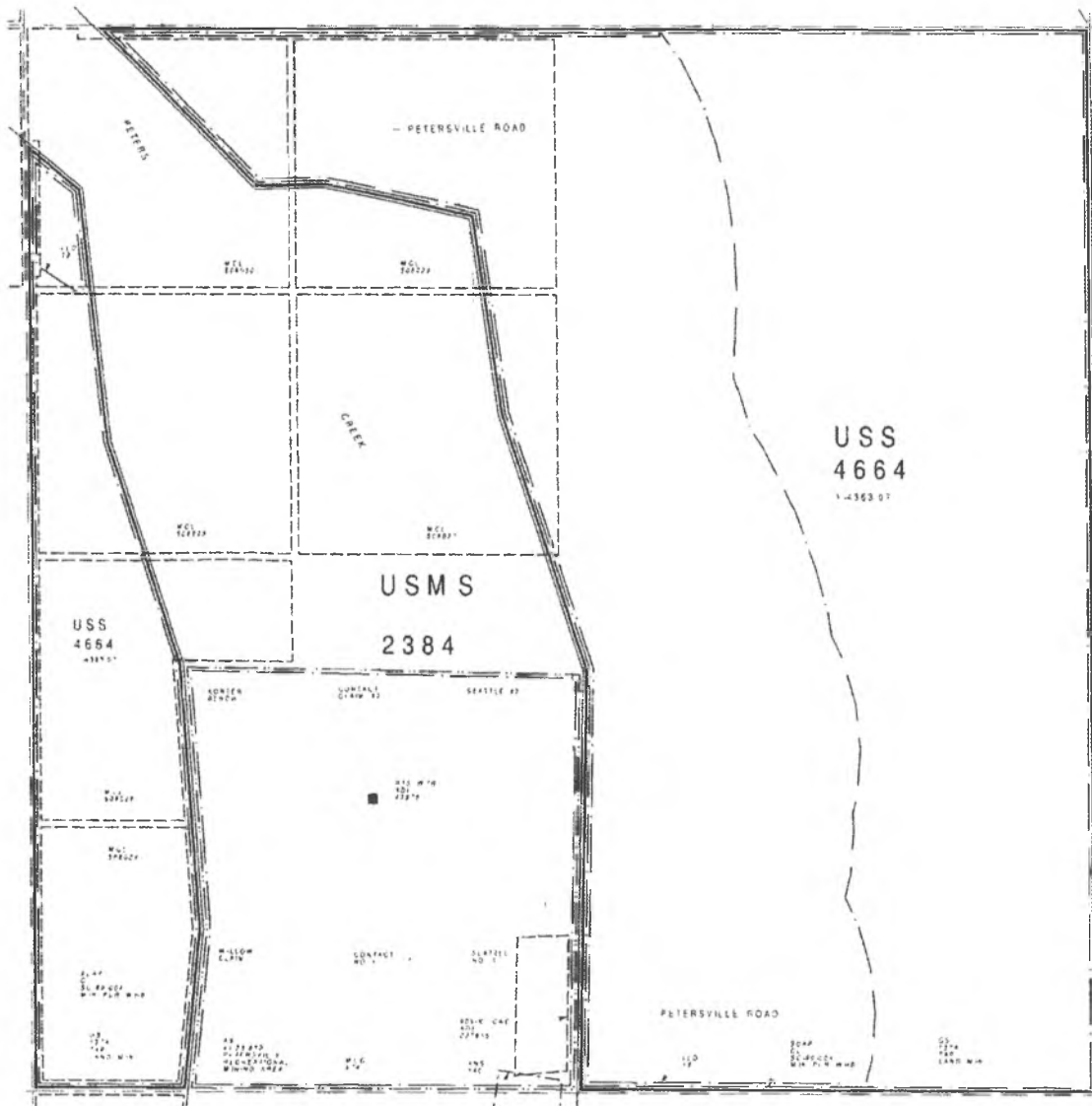

STATUS PLAT

THIS STATE OWNS ALL LAND UNDER WATER THAT ARE AVAILABLE IN FACT ARE SUBJECT TO THE FEE AND FLOW IN THE RIDES OR ARE RESERVED OR ATTACHED TO ISLANDS OWNED BY THE STATE

DATED 196

COORDINATES  
 ALASKA STATE PLANS JOHN P  
 OF COURTESY OF TOWNSHIP  
 T 28N R 8W  
 T 28N R 8W  
 T 28N R 8W  
 T 28N R 8W

INFORMATION  
 THIS PLAT WAS PREPARED BY BLM FROM  
 AERIAL HIGH ALTITUDE PHOTOGRAPHS 1978 DATA

LAND USE  
 BLM FERTILIZATION PROGRAM 1978 APPROVED 21 JULY  
 FISH REGENERATION PERMIT 1978 APPROVED 21 JULY  
 FISH REGENERATION PERMIT 1978 APPROVED 21 JULY  
 FISH REGENERATION PERMIT 1978 APPROVED 21 JULY

OTHER ACTIONS AFFECTING DECISION ON THIS PLAT SHOULD  
 SEE THE LAND OFFICE ON TOWNSHIP 28N R 8W FOR ADDITIONAL  
 ADDITIONAL INFORMATION

EXTRACT FROM NATIONAL SYSTEM BOUNDARY  
 ENTIRE FOR CANCELLATION RESTORING SYSTEM  
 SUBJECT TO BOUNDARY AREA PLAN  
 1978 PARTIAL BOUNDARY PERMIT ACCEPTED 21 JULY  
 1978 PARTIAL BOUNDARY PERMIT ACCEPTED 21 JULY  
 1978 PARTIAL BOUNDARY PERMIT ACCEPTED 21 JULY  
 1978 PARTIAL BOUNDARY PERMIT ACCEPTED 21 JULY

USS  
 4664  
 1-4363 07

USMS  
 2384

GRAPHIC ILLUSTRATION ONLY.  
 SOURCE DOCUMENTS REMAIN THE OFFICIAL RECORD  
 CONSULT LAND ADMINISTRATIVE SYSTEM (LASS)  
 CAREFULLY FOR ADDITIONAL INFORMATION



ATTENTION STATUS PLAT USERS: ON THIS PLAT ALL STATUS  
 LINES CLOSE FOR ACTIONS THAT EXTEND INTO ADJACENT TOWNSHIPS,  
 THIS INCLUDING STATUS LINES SUCH AS DEPARTMENTAL, MUNICIPAL, STATE,  
 CLASSIFICATION ETC. PLEASE REFER TO ADJACENT TOWNSHIPS OR LASS  
 TO DETERMINE IF ACTIONS EXTENDING BEYOND THE BOUNDARIES SHOWN ON  
 THIS PLAT REMEMBER TITLE, CLASSIFICATION, AND RESTRICTION LINES  
 ALWAYS CLOSE ON ALL PLATS



U.S. DEPARTMENT OF THE INTERIOR  
 BUREAU OF LAND MANAGEMENT  
 (DEPARTMENT OF NATURAL RESOURCES)  
 LAND RECORDS DIVISION

PLAT IS SUBJECT TO ADJACENT PLATS TO THE TWP  
 STATUS PLAT TRACKING SYSTEM (MAPPING) AND  
 OTHER PENDING ACTIONS ON THIS TOWNSHIP AT

CHECKED BY: DAVE LACK  
 DATE: 1978

SEC 21  
 SP  
 TWP 28N  
 RNG 8W  
 SM

SEC 28 TOWNSHIP 28N RANGE 8W OF THE SEWARD MERIDIAN, ALASKA

LEGEND

BASE INFORMATION

- METACAMPH
- SURVEY LINE
- CURVED METERS
- CONTOUR/SECTION CORNER
- SECTION LINE
- PROPERTY
- ADJUT
- AREA
- BARBERS
- ELECTRICAL POWER LINE
- TELEPHONE LINE
- VILLAGE
- AIRPORT/ANGLER STRIP
- HORIZONTAL CORNER
- CENTER MARK

STATUS INFORMATION

- TITLE
- BOUNDARY
- CLASSIFICATION
- INTEREST
- MOUNTAIN
- CLASSIFIED
- FEDERAL ACTION
- MENTAL HEALTH TRUST
- OPEN SPACE
- NATIONAL OPEN AIR
- LAND PERMIT
- TRASH/DEBRIS
- TRASH/DEBRIS
- SURFACE WATER RIGHTS
- WATER RIGHT
- PERMIT
- RIGHTS AD
- SURFACE WATER RIGHTS
- PERMIT
- RIGHTS AD
- IN STREAM FLOW RESERVATION
- PERMIT
- RIGHTS AD
- DAM WITH BARBER
- PERMIT
- RIGHTS AD

COUNTY MAP

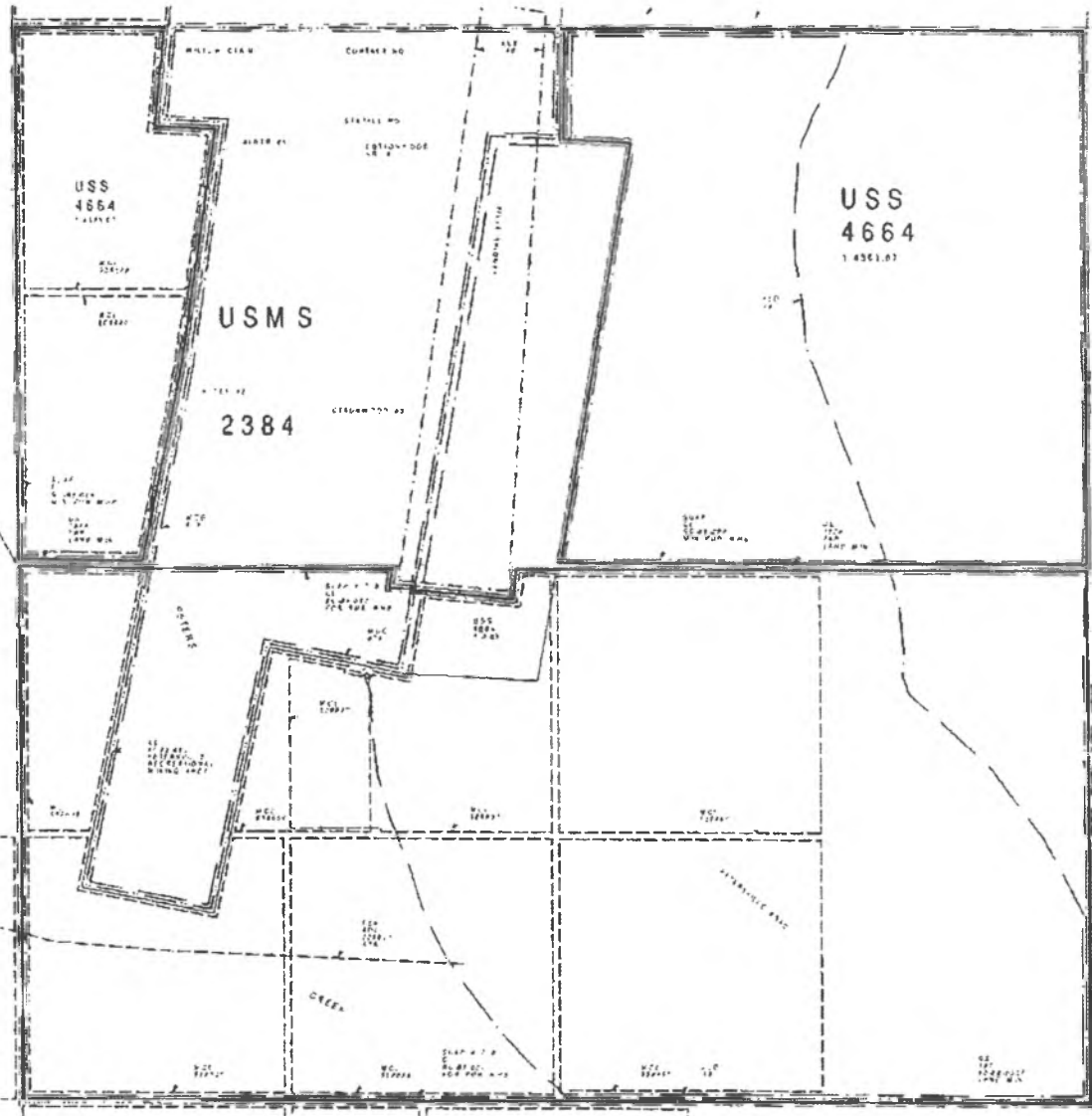
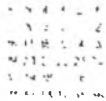

STATUS PLAT

THIS PLAT SHOWS THE CLASSIFICATION AND RESTRICTIONS OF THE LANDS IN THIS TOWNSHIP AS OF THE DATE OF THE SURVEY AND IS SUBJECT TO THE STATE AND FEDERAL LAWS AND REGULATIONS AND ORDINANCES IN EFFECT AT THE TIME OF THE SURVEY.

CLASSIFICATION

CLASSIFIED  
ALASKA STATE LAND (ASL)  
CLASSIFIED BY: [Name]  
DATE: [Date]  
CLASSIFICATION: [Type]

RESTRICTIONS

RESTRICTIONS  
STATE PROHIBITION (S.P.)  
FEDERAL PROHIBITION (F.P.)  
MOUNTAIN (M.)  
CLASSIFIED (C.)

OTHER NOTES: [Additional notes regarding land status and restrictions.]

NOTICE: [Notice regarding the accuracy and use of the plat.]

GRAPHIC ILLUSTRATION ONLY. THE FIELD SURVEYS REMAIN THE ORIGINAL RECORD. CONSULT LAND ADMINISTRATION SYSTEMS AND ASSISTANT FOR ADDITIONAL INFORMATION.

SCALE: 1:50,000

ATTENTION STATUS PLAT USERS: ON THIS PLAT ALL STATUS LINE CORNER OR ACTORS THAT EXISTED IN ADJACENT TOWNSHIPS THIS SECTION WILL BE SHOWN AS USUAL. HOWEVER, THIS CLASSIFICATION ETC. PLEASE REFER TO ADJACENT TOWNSHIPS OR LAY TO DETERMINE IF ACTORS EXISTED IN THE RECORDS SECTION ON THIS PLAT. HOWEVER, THIS CLASSIFICATION AND RESTRICTIONS ARE ALWAYS CORRECT ON ALL PLATS.

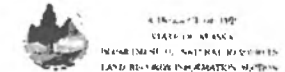

STATE OF ALASKA  
DEPARTMENT OF NATURAL RESOURCES  
LAND RESOURCE INFORMATION SYSTEMS

SEC 28  
SP  
TWP 28N  
RNG 8W  
SM

DATE: [Date]





Petersville, AK, USA Petersville

Petersville Rec. Mining Dist.

Image © 2014 DigitalGlobe  
© 2013 Google



Petersville, AK, USA

TRAPPER CREEK

TALKEETNA

© 2013 Google  
Image © 2014 DigitalGlobe  
Image Landsat

Google Earth  
Mataruska

Imagery Date: 4/9/2013 62°23'33.43" N 150°31'06.74" W elev 932 ft eye alt 27.47 mi

# STATE OF ALASKA / TONY KNOWLES, GOVERNOR

DEPARTMENT OF NATURAL RESOURCES  
DIVISION OF MINING AND WATER MANAGEMENT

3601 C Street, Suite 800  
Anchorage, AK 99503-5935  
Telephone: (907) 269-8600

December 2, 1996

Dear Alaskan:

I am asking for your comment on draft regulations that concern mining-related fees and activities. For the most part, the proposed changes are clarifications and housekeeping changes. The regulations do contain some new material including new fees for processing mining-related applications, extension of leasehold location requirement to new municipal and charitable conveyances, and a definition of "successor in interest" for the purposes of describing who may not re-stake a location within one year of its abandonment.

If you would like to comment, please do so in writing before **February 14, 1997**. We will accept comments by letter, fax, or e-mail at the address below:

Jules V. Tilleson, Director  
Division of Mining and Water Management  
3601 C Street, Suite 800  
Anchorage, Alaska 99503  
Tele: (907) 269-8600  
Fax: (907) 363-1853  
E-mail: JulesT@dmn.state.ak.us

We are asking for your review of the proposed regulations and have prepared this packet to aid your review and comment. We have included an explanation of the proposed changes and a draft of the proposed regulation changes. In addition to any comments on the draft regulations, please indicate any other areas of the department's mining regulations that you believe need change. If you have questions, please do not hesitate to call me, or call Bob Loeffler or Kerwin Krause on my staff. They can also be reached at the address and phone number above.

The regulations were developed in response to review by Division of Mining and Water Management staff, and after working with individuals and groups that have suggested changes to the Division.

Thank you for your consideration. Please write with comments or call with questions.

Sincerely,



Jules V. Tilleson  
Director

Attachments



## Location Map



The northern Petersville Recreational Mining Area has been open to the public since the enabling legislation took effect in 1997. The southern Recreational Mining Area has been closed to the public because the land in this area has not been conveyed to the DNR yet.

### Legend

- RS 2477 trail
- Anadromous Fish Streams
- Closed Federal Mining claims in USMS 2384



# Petersville Recreational Mining Areas (AS 41.23.630)

Albers Projection  
Central Meridian: 46°  
Standard Parallel 20°  
Standard Parallel 60°  
Latitude of Origin: 45°



### Location Map



The northern Petersville Recreational Mining Area has been open to the public since the enabling legislation took effect in 1997.

#### Legend

- RS 2477 trail
- Anadromous Fish Streams
- Closed Federal Mining claims in USMS 2384

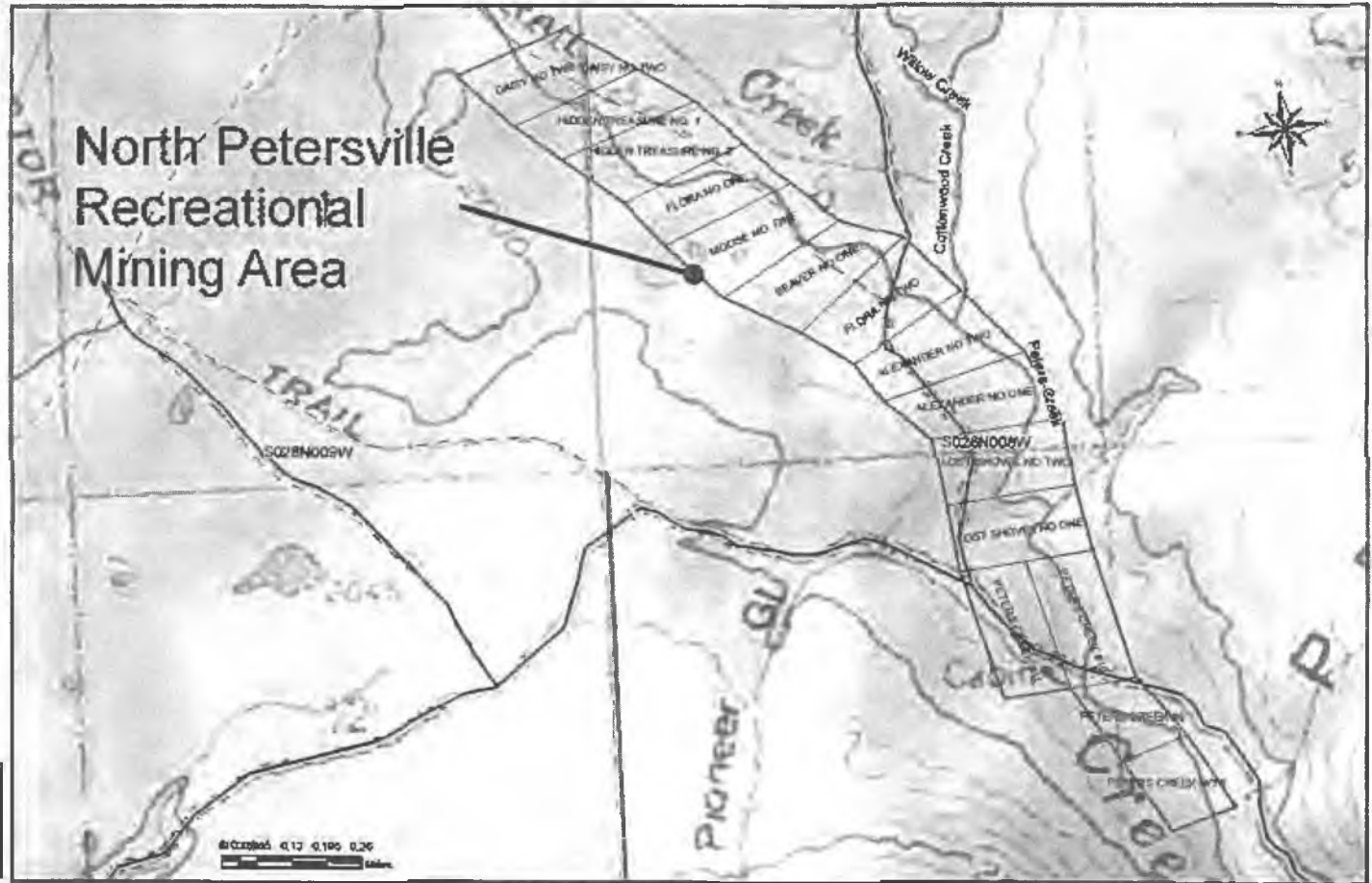

## Petersville Recreational Mining Areas (AS 41.23.630)

Albers Projection  
 Central Meridian: 45  
 True Scale Parallel: 50  
 Latitude of Origin: 50



### Location Map



The southern Recreational Mining Area has been closed to the public because the land in this area has not been conveyed to the DNR yet.

- Legend**
- RS 2477 trail
  - ~ Anadromous Fish Streams
  - Closed Federal Mining claims in USMS 2384



## Petersville Recreational Mining Areas (AS 41.23.630)

Albers Projection  
 Central Meridian: 65  
 1st Standard Parallel: 55  
 2nd Standard Parallel: 65  
 Latitude of Origin: 65



February 18, 2014

**Statement of Support for HB 135 (Petersville Recreation Mining Area) by Jules V. Tileston**

I strongly support enactment of HB 135. For the record, I am Jules V. Tileston, former Director of Mining and Water Management under Governor Hickel and Governor Knowles. Prior to working within DNR, I was the BLM Alaska official responsible for land use and mining on BLM lands in Alaska. My past employment at the Federal and State level provided a working knowledge of both Federal and State Mining Law in 1994.

I was personally involved in the negotiations between Ms. Stevens and the Alaska Department of Natural Resources (DNR) leading to the establishment of the Petersville Recreation Mining Area and the Mineral Closing Order (MCO)# 674 on June 2, 1994. On January 26, 2012, Ms. Marty Rutherford, former Deputy Commissioner ADNR, and I wrote Governor Parnell urging support for legislation to adjust the Petersville Recreation Mining Area established on May 8, 1997. HB 135 fully meets the objectives of the Tileston/Rutherford January 26, 2012 request to Governor Parnell.

The conceptual 1994 agreement between the DNR and Ms. Stevens was:

- Ms. Stevens would relinquish certain mining claims on land selected by the State under the provisions of the Alaska Statehood Act,
- Ms. Stevens' would support DNR's efforts to pursue legislation to establish the Petersville Recreation Mining Area,
- DNR would develop a process that would allow a commercial recreation mining activity on State land, and
- DNR and Ms. Stevens would enter into a commercial lease centered on her private structures and mining equipment in the area encumbered by the MCO and subsequent legislation establishing the Petersville Recreation Mining Area to support recreation mining activities on an area with ready public access and known placer gold resources that otherwise would have become private mining claims under State law when the land transferred from BLM to State ownership.

At the time of the MCO in 1994, DNR recognized there was no existing mechanism that would authorized a non-competitive commercial recreation mining activity on State land. But DNR in good faith with Ms. Stevens firmly believed there could be a mechanism that would accomplish both an opportunity to provide public recreation mining and a commercial private enterprise to support recreation mining on State land. It took until 2006 for DNR to develop this procedure. The final process requires the commercial recreation mining lease must also have a valid mining



claim under State law. In the case of the Petersville Recreation Mining Area, MCO# 674 prohibits a mining claim under State law. HB 135 would correct this issue by allowing Ms. Stevens to re-establish part of her former mining claims located on State Selected Land and enter into a commercial recreation mining lease. The remainder of the Petersville Recreation Mining Area encompassing approximately 380 acres along Peters Creek and the Petersville Road adjacent to the area affected by HB 135 will remain open to public recreation mining .

In summary, Ms. Stevens voluntarily gifted the State of Alaska valuable placer gold resources with the intent she would be provided an opportunity to enter into a commercial recreation mining lease with DNR.

My understanding is that the DNR supports enactment of HB 135 as does the Alaska Miners Association. I respectfully urge enactment of HB 135.

Jules V. Tileston

4780 Cambridge Way  
Anchorage, AK 99503



# ALASKA MINERS ASSOCIATION, INC.

121 W. Fireweed Lane, Suite 120 Anchorage, Alaska 99503 (907) 563-9229 [www.alaskaminers.org](http://www.alaskaminers.org)

January 18, 2014

Representative Eric Feige, Co-Chair  
Representative Dan Saddler, Co-Chair  
House Resources Committee  
State Capitol Building  
Juneau, AK 99801

Re: AMA Support of HB135

Dear Representative Feige and Representative Saddler:

Thank you for the opportunity to submit a support letter for HB135, an Act establishing the Petersville Recreational Mining Area.

The Alaska Miners Association (AMA) is a non-profit membership organization established in 1939 to represent the mining industry in Alaska. We are composed of more than 1,500 individual prospectors, geologists, engineers, vendors, suction dredge miners, small family mines, junior mining companies, and major mining companies. Our members look for and produce gold, silver, platinum, molybdenum, lead, zinc, copper, coal, limestone, sand and gravel, crushed stone, armor rock, and other materials.

The history behind the introduction of HB135 is long and complex. In 1994, Ms. Michele Stevens negotiated with the Alaska Department of Natural Resources (DNR) to establish the Petersville Recreational Mining Area, and as a result, Mineral Closing Order 674 (MCO #674). The concepts behind this agreement included: Ms. Stevens would relinquish certain mining claims on land the State of Alaska under the Alaska Statehood Act; Ms. Stevens would support Legislation to create the Petersville Mining Recreational Area; DNR would then develop a mechanism to allow commercial recreational mining on State land; and subsequently, DNR and Ms. Stevens would enter into a commercial lease on Ms. Stevens' private structures and mining equipment located on this land.

In 2006, DNR developed the process of commercial recreational mining on State land; however, it does require a valid mining claim under state law. MCO #674 prohibits a mining claim under State law. HB135 would correct this issue and allow Ms. Stevens to reestablish some of her former claims and enter into the commercial recreational mining lease with DNR, as originally intended in the 1994 agreement.

It should be noted that Ms. Stevens has gifted the State of Alaska with acres of placer gold resources that will remain open for public recreational mining, with the intent that she be allowed to enter into the commercial recreational mining agreement with DNR.

It is our understanding that DNR is fully supportive of HB135, as is the Yentna Mining District. AMA is very supportive of this legislation and we urge quick passage of this bill.

Thank you for the opportunity to submit a letter of support, and please do not hesitate to contact me if you have questions.

Sincerely,

Deantha Crockett  
Executive Director



# ALASKA MINERS ASSOCIATION, INC.

121 W. Fireweed Lane, Suite 120 Anchorage, Alaska 99503 (907) 563-9229 [www.alaskaminers.org](http://www.alaskaminers.org)

March 10, 2014

Senator Cathy Giessel, Co-Chair  
Senator Fred Dyson, Co-Chair  
Senate Resources Committee  
State Capitol Building  
Juneau, AK 99801

Re: AMA Support of HB135

Dear Senator Giessel and Senator Dyson:

Thank you for the opportunity to submit a support letter for HB135, an Act establishing the Petersville Recreational Mining Area.

The Alaska Miners Association (AMA) is a non-profit membership organization established in 1939 to represent the mining industry in Alaska. We are composed of more than 1,500 individual prospectors, geologists, engineers, vendors, suction dredge miners, small family mines, junior mining companies, and major mining companies. Our members look for and produce gold, silver, platinum, molybdenum, lead, zinc, copper, coal, limestone, sand and gravel, crushed stone, armor rock, and other materials.

The history behind the introduction of HB135 is long and complex. In 1994, Ms. Michele Stevens negotiated with the Alaska Department of Natural Resources (DNR) to establish the Petersville Recreational Mining Area, and as a result, Mineral Closing Order 674 (MCO #674). The concepts behind this agreement included: Ms. Stevens would relinquish certain mining claims on land the State of Alaska under the Alaska Statehood Act; Ms. Stevens would support Legislation to create the Petersville Mining Recreational Area; DNR would then develop a mechanism to allow commercial recreational mining on State land; and subsequently, DNR and Ms. Stevens would enter into a commercial lease on Ms. Stevens' private structures and mining equipment located on this land.

In 2006, DNR developed the process of commercial recreational mining on State land; however, it does require a valid mining claim under state law. MCO #674 prohibits a mining claim under State law. HB135 would correct this issue and allow Ms. Stevens to reestablish some of her former claims and enter into the commercial recreational mining lease with DNR, as originally intended in the 1994 agreement.

It should be noted that Ms. Stevens has gifted the State of Alaska with acres of placer gold resources that will remain open for public recreational mining, with the intent that she be allowed to enter into the commercial recreational mining agreement with DNR.

It is our understanding that DNR is fully supportive of HB135, as is the Yentna Mining District. AMA is very supportive of this legislation and we urge quick passage of this bill.

Thank you for the opportunity to submit a letter of support, and please do not hesitate to contact me if you have questions.

Sincerely,

Deantha Crockett  
Executive Director