

H B

4 6 6

STATE OF ALASKA

DEPARTMENT OF NATURAL RESOURCES

OFFICE OF THE COMMISSIONER

STEVE COWPER, GOVERNOR

400 WILLOUGHBY AVE.
JUNEAU, ALASKA 99801-1796
PHONE: (907) 465-2400

March
~~May~~ 8, 1988

The Honorable Sam Cotten
The Honorable Adelheid Herrmann
Co-Chairs, House Resources Committee
P.O. Box V
Juneau, Alaska 99811

Dear Representatives Cotten and Herrmann:

Subject: HB 466, An Act establishing the Caribou Creek Recreational Mining area.

Background: A recreational mining area will provide a location for recreational gold panners and suction dredges to mine as a recreation activity rather than as a commercial operation. Such a location should be free of mining claims and be managed with standard stipulations and "over the counter" permits. Each summer, the Mining Information Offices receive numerous inquiries about locations for such activities. Creation of this type of area would meet a real public need.

Position: The Department supports the idea of a recreational mining area. However, the Department of Fish and Game has identified this portion of Caribou Creek as anadromous. The bill contemplates a relatively small area for designation and the Department is confident that, should there be any problem with this particular site, that an equally or more suitable site is available and wishes to work with the sponsor, committee staff and other agencies to identify such a site.

We look foreword to working with the sponsor and committee staff as this bill progresses through the legislative process.

Sincerely,

Jennie Gornik
for Judith M. Brady
Commissioner

cc. Members, House Resources Committee
Bill Sponsors
Rod Swope
Bob Evans
Commissioner Collinsworth

FISCAL NOTE

REQUEST:

Revision Date: _____
Title: HB 466 An Act Establishing the Caribou Creek Recreational Mining area
Sponsor: Larsen and Menard
Requestor: House Resources

Agency Affected: DNR
BRU: Mineral Managemet
Components : _____

EXPENDITURES/REVENUES: (Thousands of Dollars)

OPERATING	FY 88	FY 89	FY 90	FY 91	FY 92	FY 93
PERSONAL SERVICES	0	0	0	0	0	0
TRAVEL						
CONTRACTUAL						
SUPPLIES						
EQUIPMENT						
LAND & STRUCTURES						
GRANTS, CLAIMS						
MISCELLANEOUS						
TOTAL OPERATING						
CAPITAL						
REVENUE						

FUNDING: (Thousands of Dollars)

GENERAL FUND	0	0	0	0	0	0
FEDERAL FUNDS						
OTHER						
TOTAL						

POSITIONS:

FULL-TIME	0	0	0	0	0	0
PART-TIME						
TEMPORARY						

ANALYSIS : (Attach a separate page if necessary)

The Department anticipates no additional expenditures with respect to this legislation.

Prepared by: Lawrence Ostrovsky Phone: 3/8/88
Division: Commissioner's Office Date: 3/8/88
Approved by Commissioner: *Jenni Gorsuch* Date: 3/8/88
Agency: DNR

Distribution (by preparer):
Legislative Finance
Legislative Sponsor
Requestor
Office of Management and Budget
Impacted Agency(ies)

Alaska State Legislature



Session Address:
STATE CAPITOL BUILDING
BOX V
JUNEAU, ALASKA 99811
(907) 465-3727

Interim Address:
BOX 53
PALMER, ALASKA 99645
(907) 745-3826 Palmer
(907) 376-8628 Wasilla

Representative Ronald L. Larson
District 16B

To: House Resources Committee
From: Representative Ronald Larson *R.L.*
Re: HB 466; Caribou Creek Recreational Mining Area
Date: March 7, 1988

The Caribou Creek Recreational Mining Area is proposed to establish a designated recreational gold-panning location in the Mat-Su Valley. Such a tourist destination will permit a popular, historical activity to occur on state land.

The proposed legislation sets forth the primary purpose of recreational gold mining, yet maintains other compatible multiple-use activities within the area.

The Departments of Natural Resources and Fish and Game are instructed to manage the land, fish and wildlife resources within the designated area.

The following amendment is requested:

Pg. 2, line 16:

Section 29: NE 1/4, SE 1/4 [SW 1/4]

I encourage your suggestions and support of HB 466.

Stream: Caribou Creek, South Fork Matanuska River.

Location: Eastern portion of the Matanuska Susitna Borough, Township 20N, Range 10E, Seward Meridian, Sec. 28, 32, 33.

Access Point: Glenn Highway, south side near Caribou Creek bridge.

Discussion: Caribou Creek flows southerly from the Talkeetna Mountains to its confluence with the South Fork of the Matanuska River on the south side of the Glenn Highway. Caribou Creek is one of several streams draining the western portion of the Nelchina Mining district. Caribou Creek from the Glenn Highway bridge northward into the Talkeetna Mountains is heavily staked with mining claims.

The section of stream proposed here lies south of the Glenn Highway bridge and is approximately a mile in length to its confluence with the South Fork of the Matanuska River. South of the confluence, approximately a mile and one-half of stream on the South Fork is also proposed.

Below the highway bridge, Caribou Creek forms a broad flood plain with numerous gravel bars. Large amounts of sediment is flushed through the canyon above the bridge during spring runoff replenishing the gravel bar each year. Gold is present in this drainage, although probably not in commercial quantity. Access would be off the south side of the Glenn Highway down a one lane gravel road along the east bank of Caribou Creek.

Land Status: This township is presently state selected.

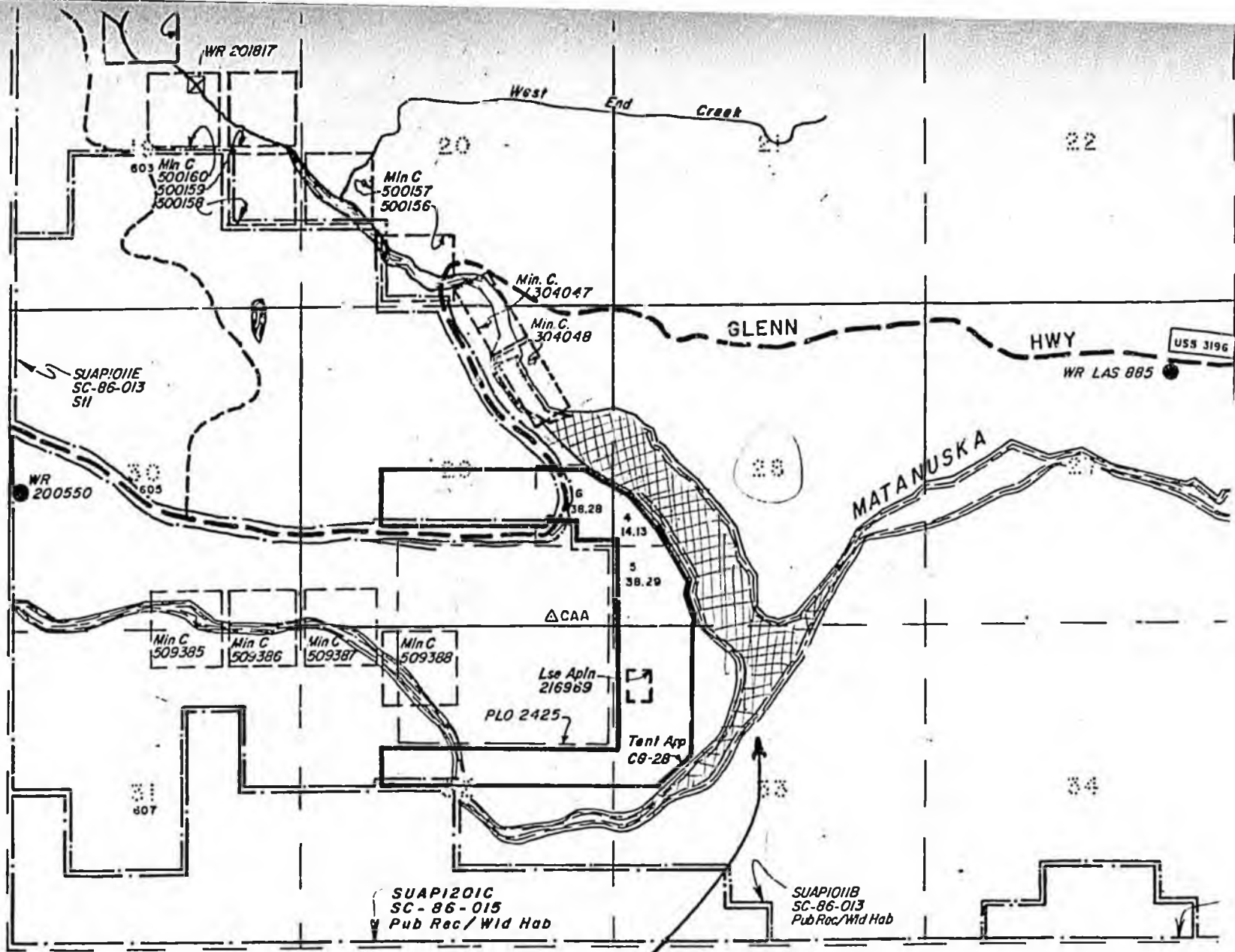

area proposed

