

H

B

/

8

9

COMMITTEE REPORT

HOUSE

FURTHER: FINANCE

2/19/81

Date: 2-19-81

Mr. Speaker:

The Committee on COMMUNITY & REGIONAL AFFAIRS has had HB 189

"An Act making a special appropriation to the Department of Transportation and Public Facilities for a sports arena complex in the Matanuska-Susitna Borough; and providing for an effective date."

under consideration and (a majority of the committee) (the committee) reports it back with the following recommendations:

- do pass do not pass
- do pass with attached amendments(s)
- replace with CS for _____ same title
 new title
- and recommends _____
- AND attaches a "Letter of Intent" New Fiscal Note
- reports it back without recommendation
- referred to the _____ Committee

MEMBERS SIGNING
DO PASS

Jan Mull

MEMBERS HAVING
OTHER RECOMMENDATIONS:

[Signature]

CHAIRMAN



Alaska State Legislature

House of Representatives

Committee on

Community & Regional Affairs

Rep. Ben Grussendorf
Chairman
465-3870

Pouch V
State Capitol
Juneau, Alaska 99811

Summary - HB 189

"An Act making a special appropriation to the Department of Transportation and Public Facilities for a sports arena complex in the Matanuska-Susitna Borough; and providing for an effective date."

The bill is self explanatory. Attached information has been provided by Rep. Carney's office. A fiscal note was requested from the Dept. of Transportation but not received as yet. We were told that there is no fiscal impact in regard to the Department.

VII.

Project Development Schedule

Introduction

It is likely that funding will not be forthcoming in an amount sufficient to construct the entire complex at once. Therefore, an initial phase was determined, based upon facilities that appear to be virtually "self-supporting," i.e., revenues roughly equal operating costs. (See cost/benefit section.) This first phase includes a hockey rink, a running track, handball/racquetball courts, and an exercise facility. The estimated cost of constructing this initial phase is \$5.9 million. Additional facilities could be constructed individually over time, added in several phases, or built as one single second phase. The linear design concept is included for illustrative purposes, with a shaded area to indicate the suggested first phase. This is shown in Figure VII-1.

Development Schedule

The amount of time required before the recreational/cultural complex can be opened is dependent upon funding procedures, property acquisition, design phases, and construction stages. With respect to funding, it is expected that the Legislature will receive a request for appropriations early in January. It is likely that the process of committee review, legislative debate, and executive approval will take several months. Actual transfer of funds to the Borough would probably not take place until July of 1981. However, prior to that date some work could be accomplished with respect to final site selection and negotiation as well as selection of an architect. It may even be possible for some of the design work to be done via funding from a special state revolving fund.

Assuming, however, that by mid-summer the site and funds are available, architectural design work could proceed. By the end of 1981, a complete package of construction documents (plans and specifications) should be

completed, so that the project could be put out to bid early in 1982. Construction could commence in the spring, with completion of the project scheduled for December of 1982. There may be ways of compressing this schedule to some extent, but the total time span is considered to be reasonable. It may be possible for some components of the complex to be finished earlier than others in order to allow for seasonal space commitments.

Prior to actual opening, it will be necessary to establish the management and staffing of the facility. Whether the complex is operated by the Borough or by a private contractor is premature at this point. However, the Borough would be well-advised to solicit bids from qualified management companies.

Figure VII-2 illustrates the development schedule.

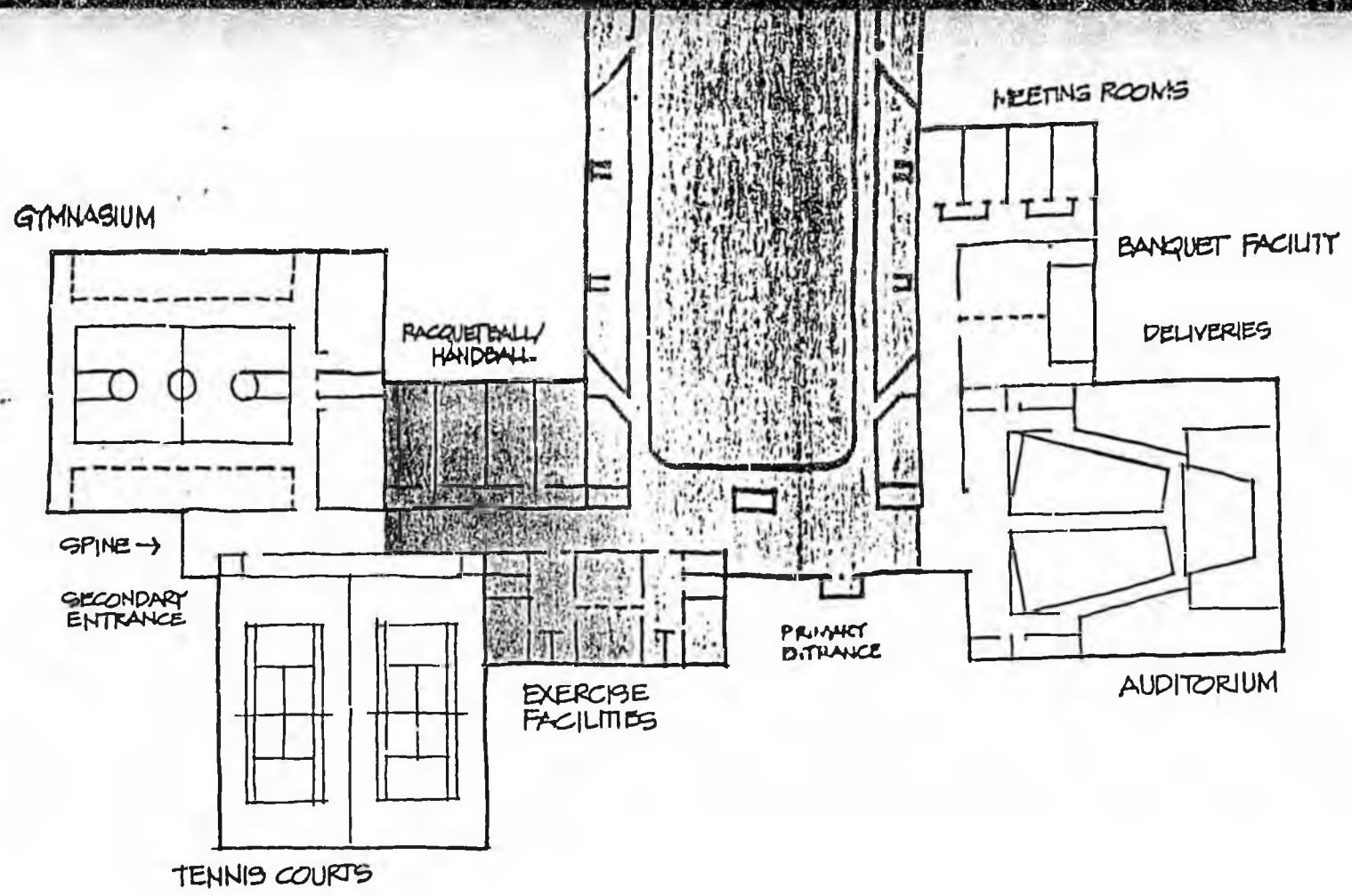

Feasibility Study: RECREATIONAL/CULTURAL COMPLEX

Matanuska - Susitna Borough

TRA/Farr