

YKHC JVCP APPLICATION

NOVEMBER, 2014





View from east illustrating existing hospital to the left and new clinic to the right.

TABLE OF CONTENTS

- | | |
|---|--|
| A1 Aerial Rendering / Table of Contents | A7 Clinic Second Floor Plan |
| A2 Project Description | A8 Clinic Third Floor Plan |
| A3 Master Plan | A9 Building Section |
| A4 Overall Plan | A10 Exterior - Entry Rendering |
| A5 Hospital Renovation Plan | A11 Interior - Gathering Space Rendering |
| A6 Clinic First Floor Plan | A12 Hospital Renovation Phasing Plan |



JVCP NEW CLINIC AND HOSPITAL RENOVATION
BETHEL, ALASKA



YUKON-KUSKOKWIM HEALTH CORPORATION

Working Together to Achieve Excellent Health

BETTISWORTH^{NORTH}

JONES ■ JONES

ZGF
JONES CORP. HEALTH ARCHITECTURE

A1

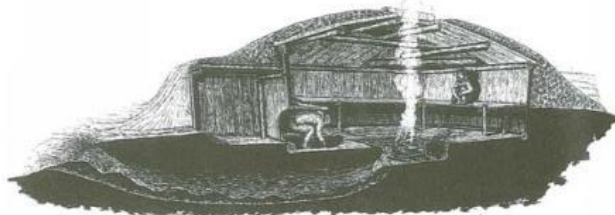

Drawing of a traditional qasgi. Image from *Eskimo Architecture*².



1. Fienup-Riordan, Ann. "Qasgimi: In the Qasgi." Yuongnaqpiallerput: The Way We Genuinely Live. The Anchorage Museum & the Calista Elders Council, 3 Jan. 2008. Web. 22 Nov. 2014. <<http://yupikscience.org/2qasgi/index.html>>.

2. Lee, Molly, and Gregory A. Reinhardt. "Southwest Alaska, Bering Sea, Siberia, and Gulf of Alaska." *Eskimo Architecture: Dwellings and Structures in the Early Historic Period*. Fairbanks: U of Alaska, 2003. 128. Print.

- This project is an opportunity to create a sustainable healthcare community and improve the greater YKHC campus with a facility that is designed for the future, is culturally respectful, and provides the apex in contemporary health care and wellness.

- The ramping entry drive reduces distance and eliminates stairs between drop-off and entry; it's connectivity to existing boardwalks and gentle ramp create a pedestrian friendly environment & access point.

- An efficient circulation spine connects the existing hospital and new clinic; consistent circulation & public areas on all three levels of new clinic improves efficiency and wayfinding.

- Clinic waiting areas on each floor are provided with views and daylight; a new atrium in the hospital provides daylight to renovated patient rooms.

- Modular layouts are used throughout the new clinic, from exam rooms to integrated team work areas, allowing for flexibility and growth.

- The Primary Care, Wellness Center, & Lab are located on the first level of the clinic, in close proximity to the relocated Pharmacy and main entry.

- The clinical departments of Specialty Clinic, Audiology, & Dental are located adjacent to one another north of the circulation spine on the second level of the clinic, with support spaces to the south.

- On the third level of the clinic, a new shared conference room has views to the river and mountains beyond; Rehabilitation Services and the Behavioral Health Suite share the third level clinical spaces.

- Vertical elements on the clinic exterior echo the texture of traditional wood-framed structures; ribbons of color emulate the hues and rhythm of salmon drying on racks with sunlight streaming between.

- The greater volume of the new clinic steps down to the scale of the existing hospital through the main entry/connector volume.

- Similar scale massing and matching materials and fenestration on the re-skinned hospital and new clinic create visual continuity between the two buildings.

- Paralleling the property line, the new clinic is joined to the existing hospital by the connector volume in a sweeping bend that also parallels the bend of the Kuskokwim River defining Bethel's southern edge.

- The connector between the existing hospital and the new clinic is a gathering space; it is a contemporary take on the traditional qasgi, or communal men's house.

During our ancestors' time, they said that the qasgi was the foundation of a community. A place without a qasgi wasn't recognized as a community.
-Frank Andrew, Kwigillingok¹

- As the principal architectural expression, this gathering space will promote social interaction, enhance the connection to the outdoors with views and daylight, and provide a vital community center within the hospital & clinic, the YKHC healthcare campus, Bethel, and the YK Delta region.



MASTER PLAN FEATURES

- Safe & functional vehicular & pedestrian circulation
- New entry access drive off of Chief Eddie Hoffman Highway
- Main entry drop off loop: Vehicular & pedestrian access to the main entrance at first floor grade
 - Drop off area: Accessible parking, taxi queuing & space for a public transit stop, consideration of space for seasonal parking of ATVs & snow machines
 - Visitor parking: Approximately 150 vehicles
 - Walkways: Safe & convenient access to clinic's main entry
 - Landscaping: Native tundra vegetation and trees in bermed planting beds at the drop off loop, parking areas & pedestrian circulation
 - Consideration of views, solar aspect, seasonal weather patterns, & the seasonal subsistence calendar guide landscape design.
 - Reorganized existing parking area: Main entry aligns directly with Old Hospital Road to provide safe vehicular patterns and a safer intersection for pedestrians

LEGEND

- 1 HOSTEL
- 2 BUILDING 800 STAFF HOUSING
- 3 KEYS HEALTHY HOUSING
- 4 WATER TOWER
- 5 SERVICE ACCESS PLATFORM
- 6 WEST WING ADMINISTRATION BUILDING
- 7 RENOVATED EXISTING YUKON-KUSKOKWIM DELTA REGIONAL HOSPITAL
- 8 NEW CLINIC
- 9 AMBULANCE ACCESS PLATFORM
- 10 COMMUNITY HEALTH SERVICES BUILDING (CHSB)

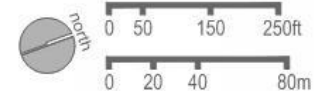

OVERALL PLAN

PRELIMINARY CONCEPT DESIGN - NOVEMBER 2014

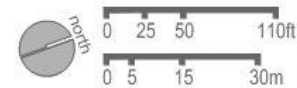
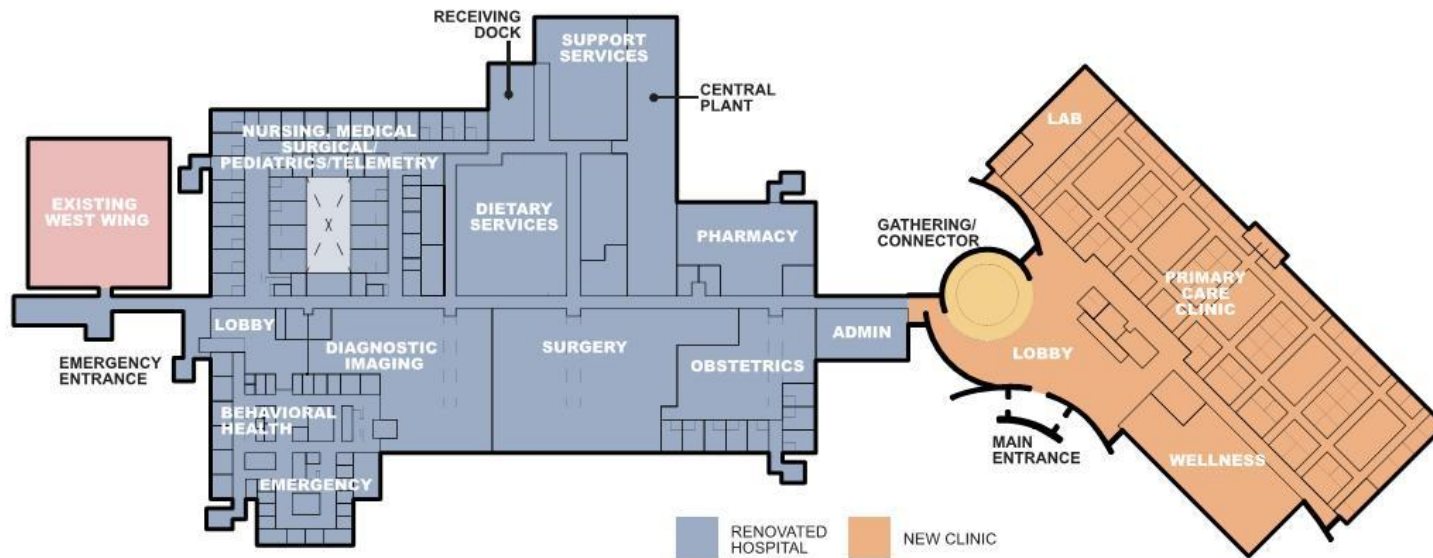

JVCP NEW CLINIC AND HOSPITAL RENOVATION
BETHEL, ALASKA



YUKON-KUSKOKWIM HEALTH CORPORATION

Working Together to Achieve Excellent Health

BETTISWORTH^{NORTH}

JONES ■ JONES

ZGF
JAMES GORDON ARCHITECTURE

A4

HOSPITAL RENOVATION PLAN

PRELIMINARY CONCEPT DESIGN - NOVEMBER 2014

- Provide logical connections between services; e.g. shared procedural support for Obstetrics and Surgery; connectivity of ER to Behavioral Health and to Diagnostic Imaging and Surgery.

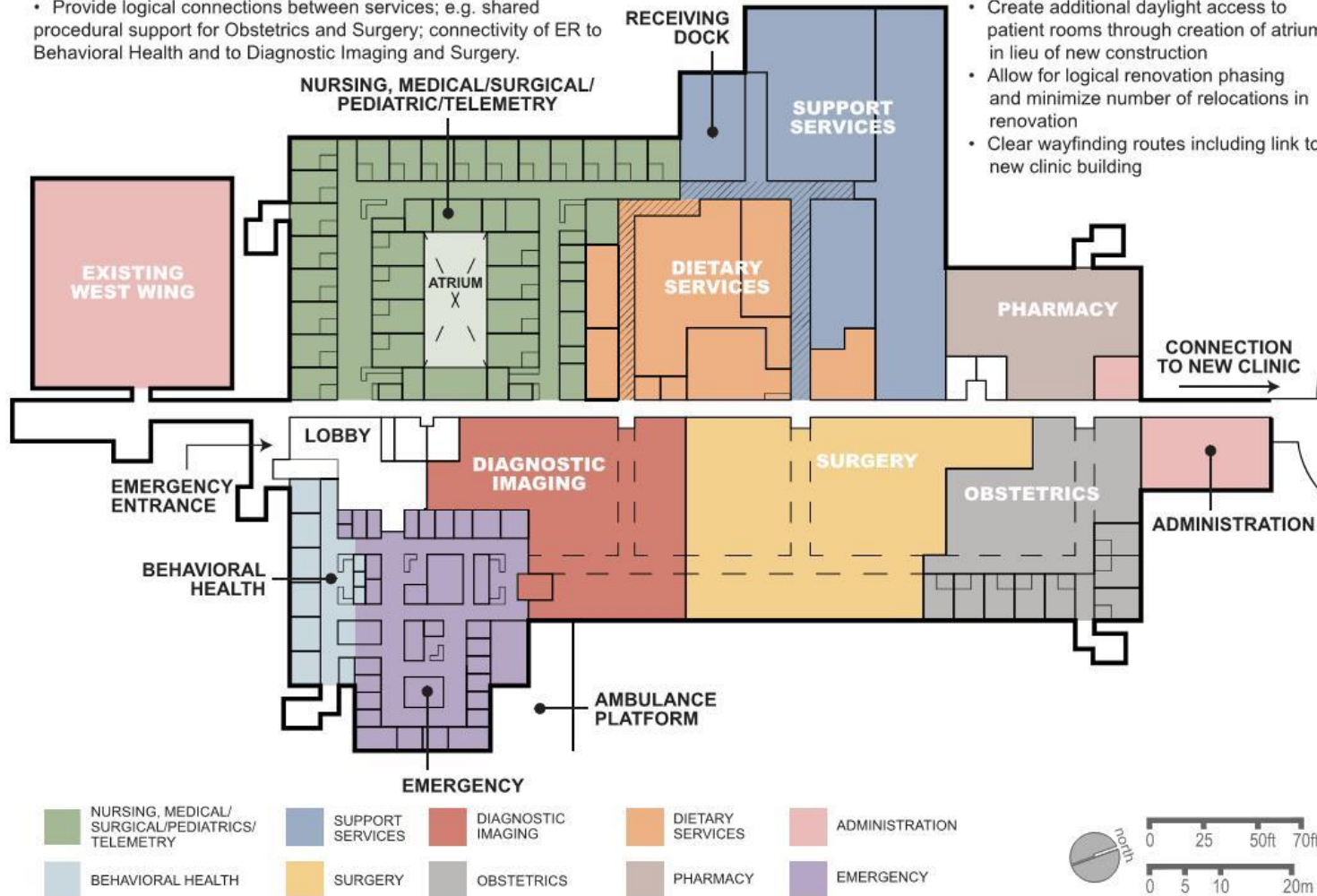

- Create additional daylight access to patient rooms through creation of atrium in lieu of new construction
- Allow for logical renovation phasing and minimize number of relocations in renovation
- Clear wayfinding routes including link to new clinic building



JVCP NEW CLINIC AND HOSPITAL RENOVATION
BETHEL, ALASKA



YUKON-KUSKOKWIM HEALTH CORPORATION

Working Together to Achieve Excellent Health

BETTISWORTH^{NORTH}

JONES ■ JONES

ZGF
JOHN GRIFFIN ARCHITECTURE

A5

CLINIC FIRST FLOOR PLAN

PRELIMINARY CONCEPT DESIGN - NOVEMBER 2014

- Flexible planning module allows for departmental growth and IHS "Improving Patient Care" concepts
- Flexible and adaptable room types allow for multi-use or shared function
- Clinic module designs will be repeated on each floor allowing for familiarity and efficiency
- Clinic module design will allow for natural light and exterior views wherever possible
- Clinic Team Room design will foster collaboration and interaction, while empowering each team member to work to the full capability of their license
- Integrated Care
- Execution of Improving Patient Care program

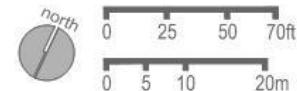
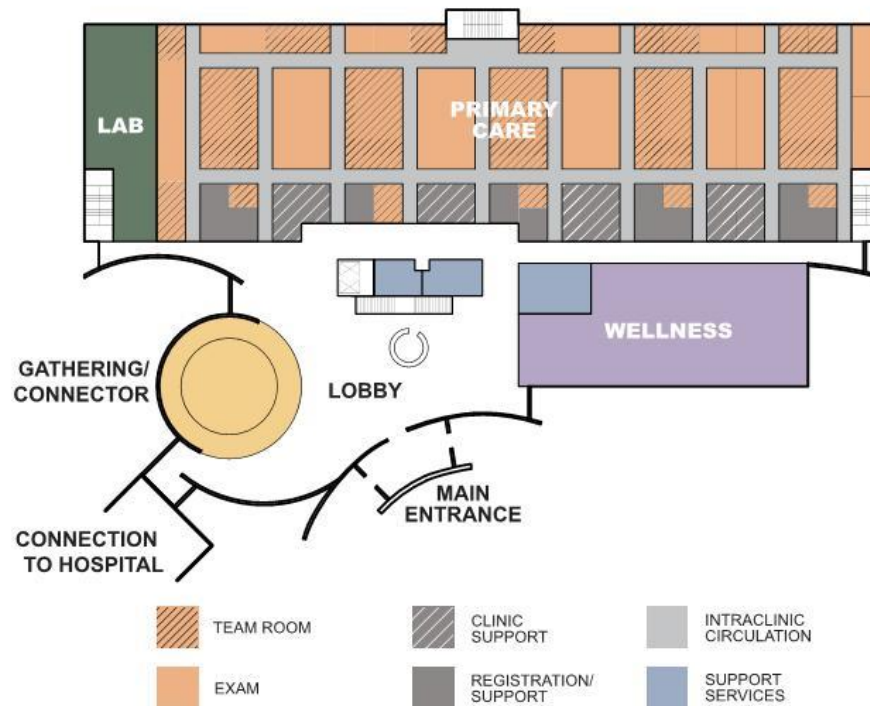

JVCP NEW CLINIC AND HOSPITAL RENOVATION
BETHEL, ALASKA



YUKON-KUSKOKWIM HEALTH CORPORATION

Working Together to Achieve Excellent Health

BETTISWORTH^{NORTH}

JONES ■ JONES

ZGF
JAMES GORDON ARCHITECTURE

A6

CLINIC SECOND FLOOR PLAN

PRELIMINARY CONCEPT DESIGN - NOVEMBER 2014

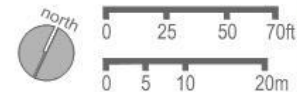
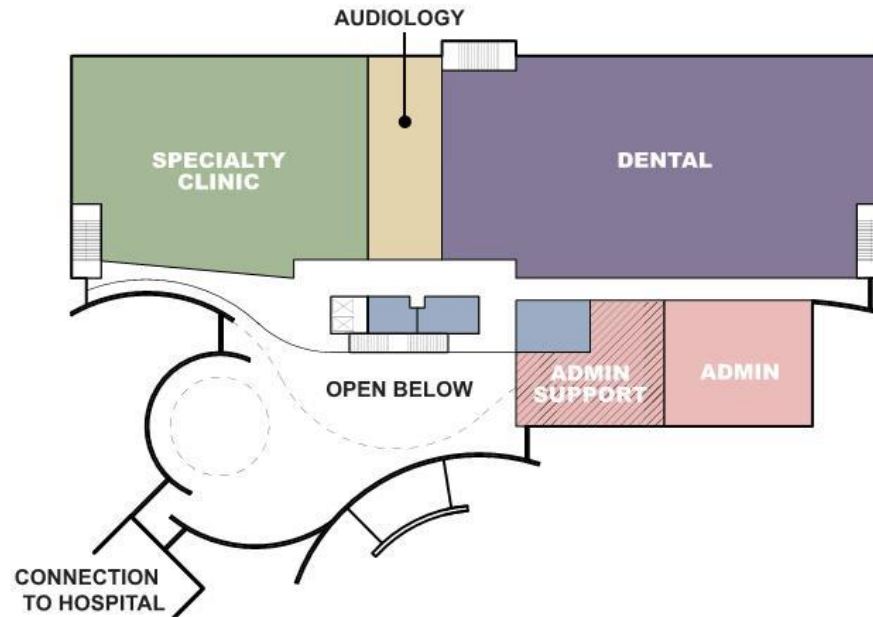

JVCP NEW CLINIC AND HOSPITAL RENOVATION
BETHEL, ALASKA



YUKON-KUSKOKWIM HEALTH CORPORATION

Working Together to Achieve Excellent Health

BETTISWORTH^{NORTH}

JONES ■ JONES

ZGF
JONES CORP. HEALTH ARCHITECTURE

A7

CLINIC THIRD FLOOR PLAN

PRELIMINARY CONCEPT DESIGN - NOVEMBER 2014

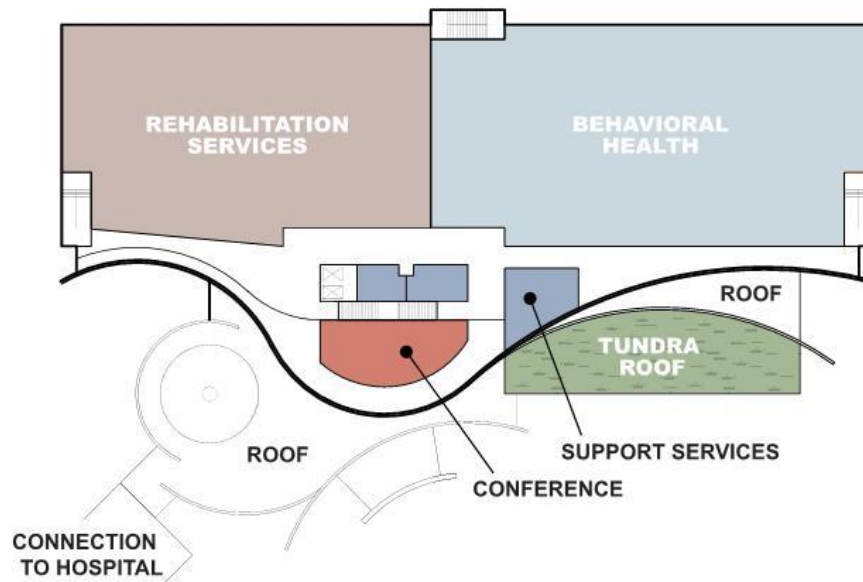

JVCP NEW CLINIC AND HOSPITAL RENOVATION
BETHEL, ALASKA



YUKON-KUSKOKWIM HEALTH CORPORATION

Working Together to Achieve Excellent Health

BETTISWORTH^{NORTH}

JONES ■ JONES

ZGF
JAMES GORDON ARCHITECTURE

A8

EXTERIOR - ENTRY RENDERING

PRELIMINARY CONCEPT DESIGN - NOVEMBER 2014



View of main entry from the east. Vertical elements on the clinic exterior echo the texture of traditional wood-framed structures; ribbons of color emulate the hues and rhythm of salmon drying on racks with sunlight streaming between.



JVCP NEW CLINIC AND HOSPITAL RENOVATION
BETHEL, ALASKA



YUKON-KUSKOKWIM HEALTH CORPORATION

Working Together to Achieve Excellent Health

BETTISWORTH^{NORTH}

JONES ■ JONES

ZGF
JONES CORP. HEALTH CARE ARCHITECTURE

A10



View of interior looking northwest. The connector between the existing hospital and the new clinic is a gathering space. It is a contemporary take on the traditional qasgi, or communal men's house - "the social and ceremonial center of village life³."

3. Fienup-Riordan, Ann. "Qasgimi: In the Qasgi." *Yuunnaqpiallerput: The Way We Genuinely Live*. Seattle, WA: U of Washington, 2007. 31. Print.).



HOSPITAL RENOVATION PHASING PLAN

PRELIMINARY CONCEPT DESIGN - NOVEMBER 2014

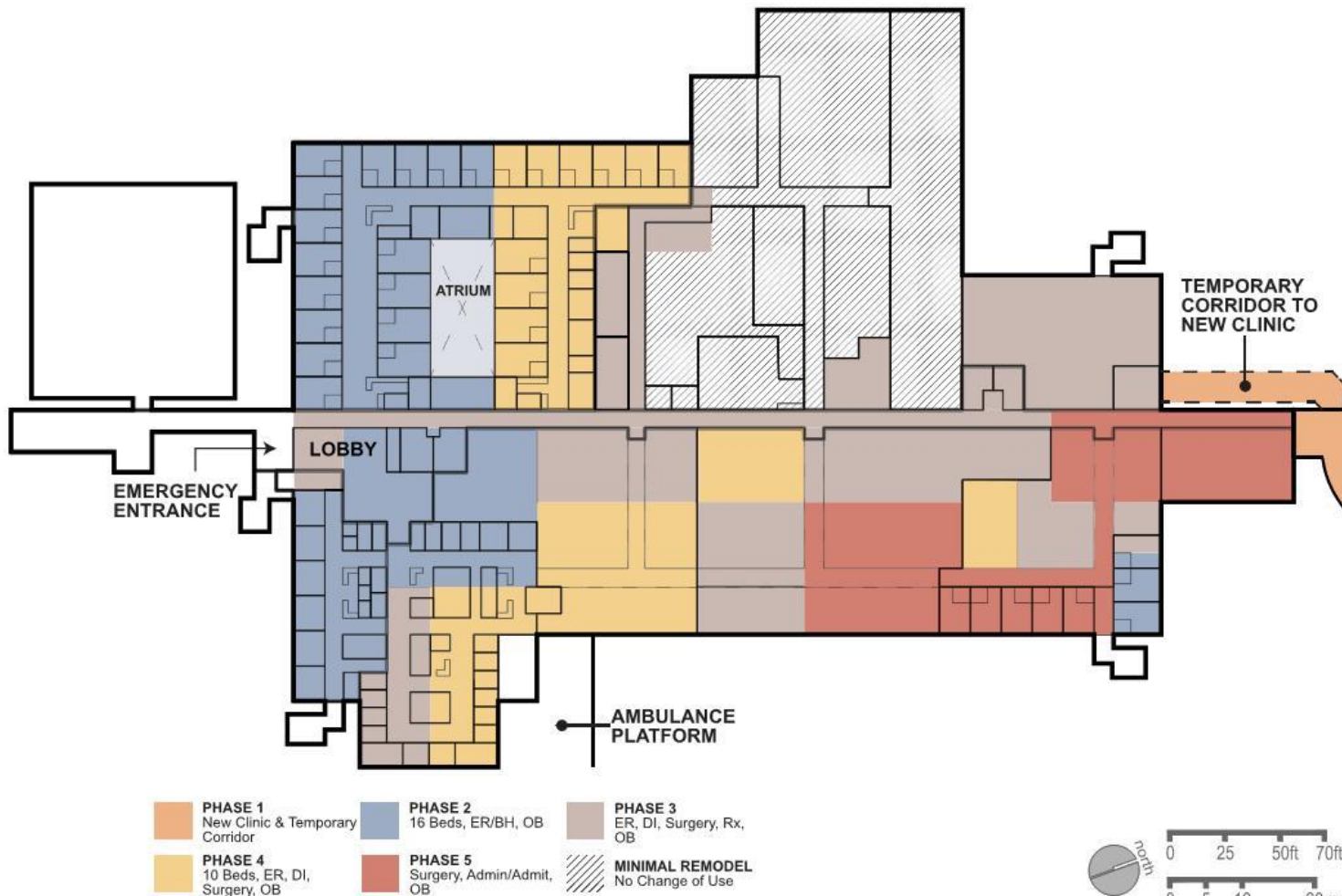

JVCP NEW CLINIC AND HOSPITAL RENOVATION
BETHEL, ALASKA



YUKON-KUSKOKWIM HEALTH CORPORATION

Working Together to Achieve Excellent Health

BETTISWORTH^{NORTH}

JONES ■ JONES

ZGF
JOHN J. GRIFFIN ARCHITECTURE

A12

PROJECT WORK PLAN

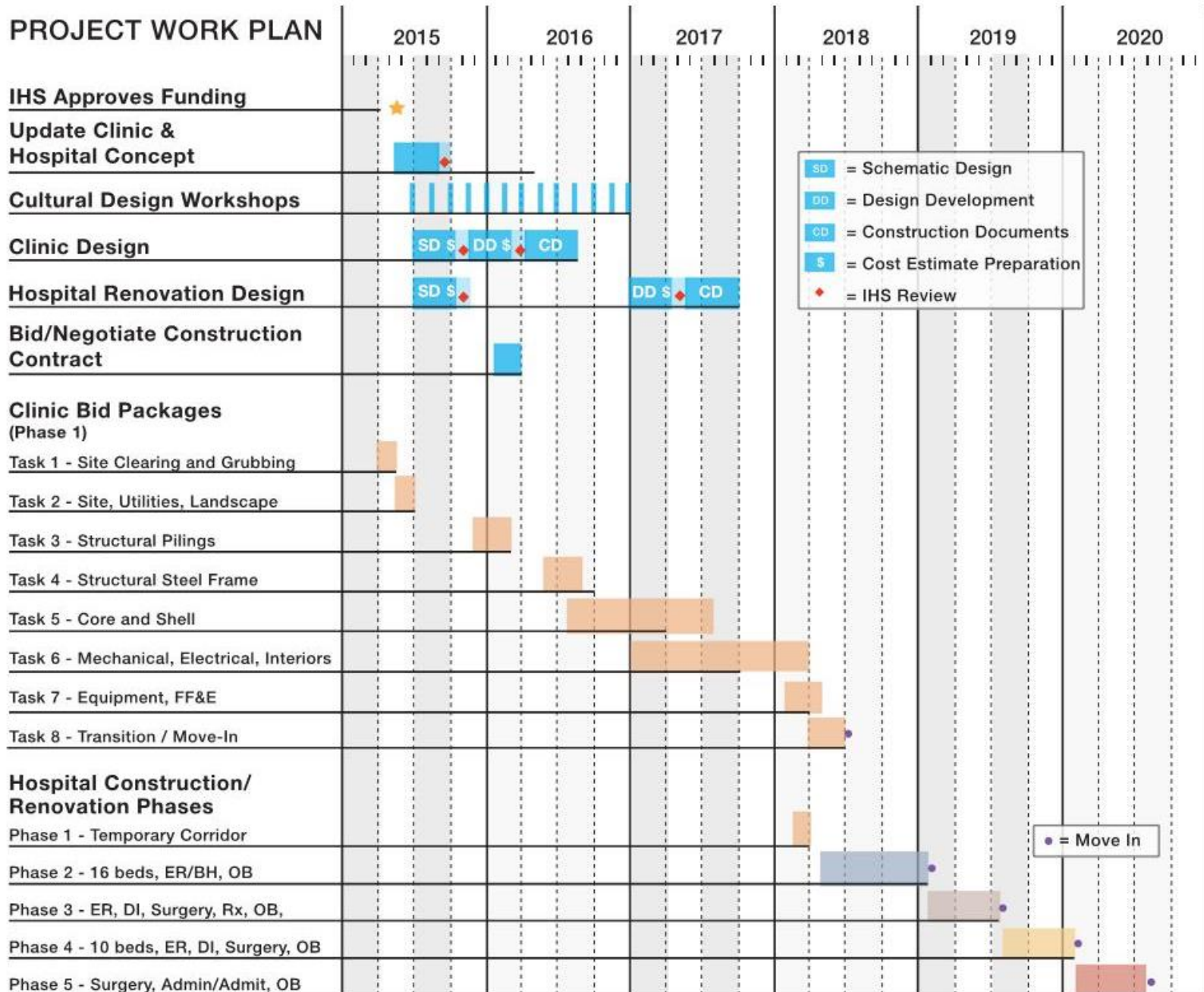

QUESTIONS

