

# Alaska State Legislature

**Senate Majority Leader**

Joint Armed Services Committee

Co-Chairman

Judiciary Committee

Vice-Chairman

Resources Committee

State Affairs Committee

Legislative Council

Rules Committee



**Senator John Coghill**

Session Address:  
State Capitol, Room 119  
Juneau, AK 99801-1182  
(907) 465-3719  
Fax (907) 465-3258

Interim Address:  
1292 Sadler Way, Suite 340  
Fairbanks, AK 99701  
(907) 451-2997  
Fax (907) 451-3526  
877-465-3719

[www.aksenate.org](http://www.aksenate.org)

Amendment to CSSB 19(CRA):

29-LS0326\W.1

At the last Senate CRA meeting, I mentioned there was some disagreement about what AS 29.35.450(c)(3) requires for a boundary change. After consulting with Leg Legal and the attorney for the Fairbanks North Star Borough it has been agreed that subsection (c) requires a vote of the existing service area before a parcel or subdivision is added to the service area.

This is a logical requirement to annex a subdivision because a subdivision has roads that would have to be brought up to code and maintained by the existing service area. There are subdivision that are so out of compliance with codes for service areas that annexing the roads would place an undue burden on the existing service area.

This is not the case with a parcel. The amendment to SB 19 would add subsection 6. Subsection 6 would provide that a parcel can be added to an existing service area if it meets two requirements: (1) a portion of the parcel is already in the service area boundaries; and (2) the only access to the parcel is a road in the service area.

AMENDMENT

OFFERED IN THE SENATE

TO: CSSB 19( ), Draft Version "W"

1 Page 3, line 8, following "area":

2 Insert ":

3 (6) to a change in the boundaries of a road service area to include  
4 a parcel that is partially located in the road service area if roads maintained by  
5 the service area provide the only access to the parcel"



## Ester Lump Road Service Area

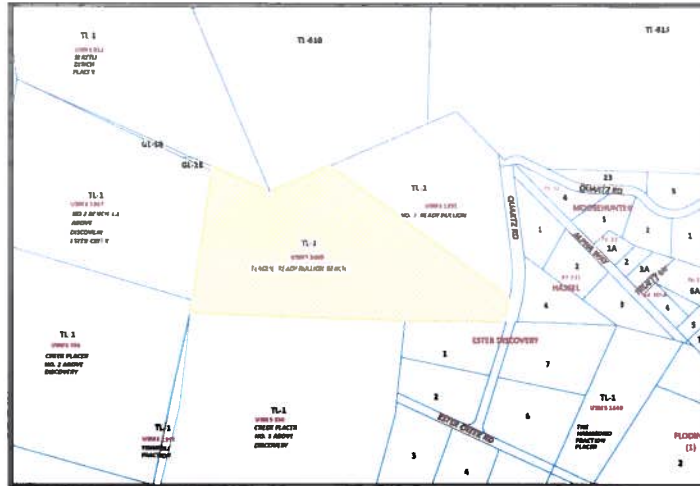

Tax Lot 1 USMS 2000

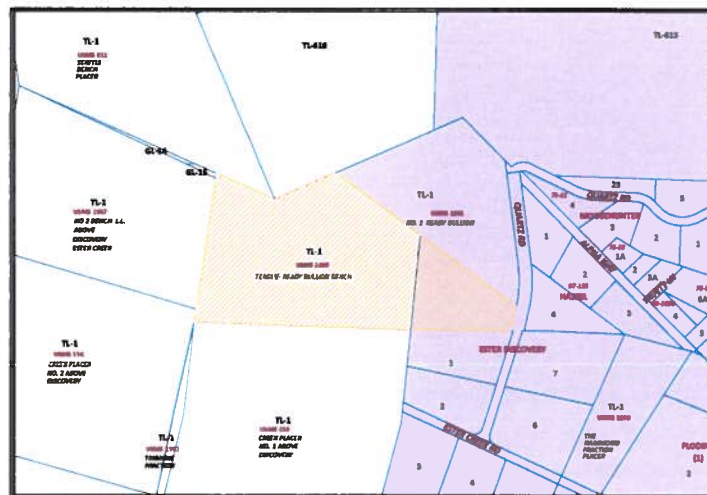

Ester Lump Road Service Area Boundary

In this example, only a portion of Tax Lot 1 USMS 2000 is within the Ester Lump Road Service Area. The service area boundary should match the parcel boundary. Until the service area boundary is changed to include the entire parcel, the tax assessors must split the taxation into two separate millage groups.